

SPECIFICATIONS

Size	526×536×927(mm)	Weight of the product	32.5Kg
Rated input power	400W	Rate volume of wash and spinning	5.5Kg(dry clothes)
Rated voltage	220V~	Maximum water pressure permitted in the water inlet	0.6MPa
Rated frequency	50Hz	Minimum water pressure permitted in the water inlet	0.1MPa

PHILCO® 

GJW55P

USER MANUAL

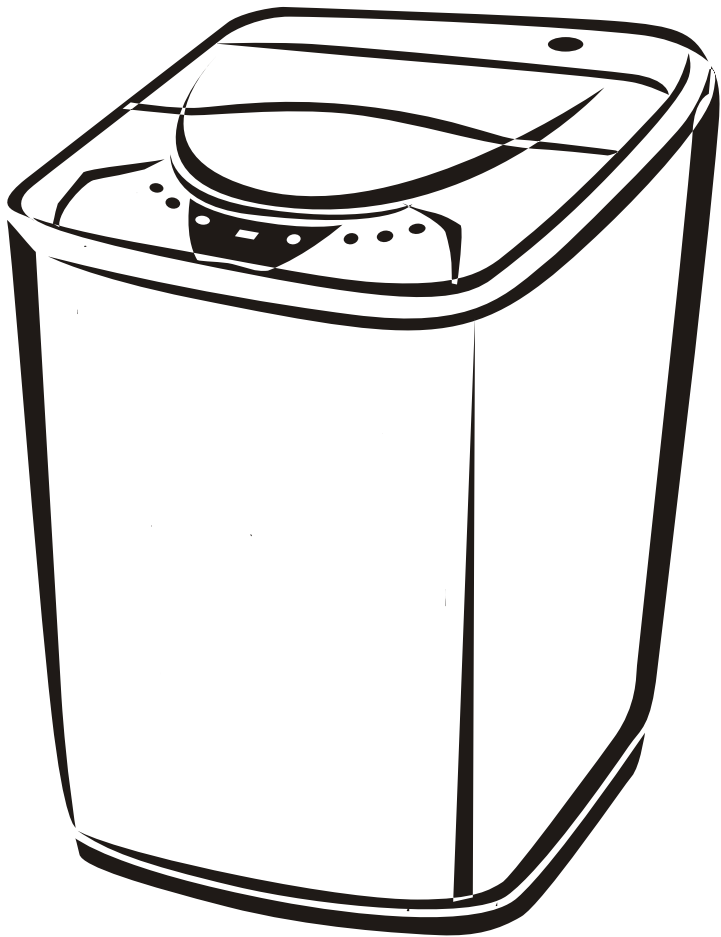

INDEX

Names of parts-----3

Volume of washing and detergent-----4

Functions of buttons -----5

Way of use -----7

 Preparations before using -----7

 Full automatic program-----8

 Self program-----9

 Preset program-----9

 Soak washing-----11

 Wash of blanket -----11

 Use of fabric softener -----11

 Wash of bulk clothes-----11

 Pre-wash of the dirty clothes-----11

Installation-----12

 Placement of the washing machine-----12

 Installation of water inlet hose-----13

 Installation of drain hose-----14

 Power source and grounding-----15

 Installation of the base cover-----15

Precautions-----16

Trouble shooting -----17

Method of maintenance-----18

Specifications-----back cover

NAMES OF PARTS

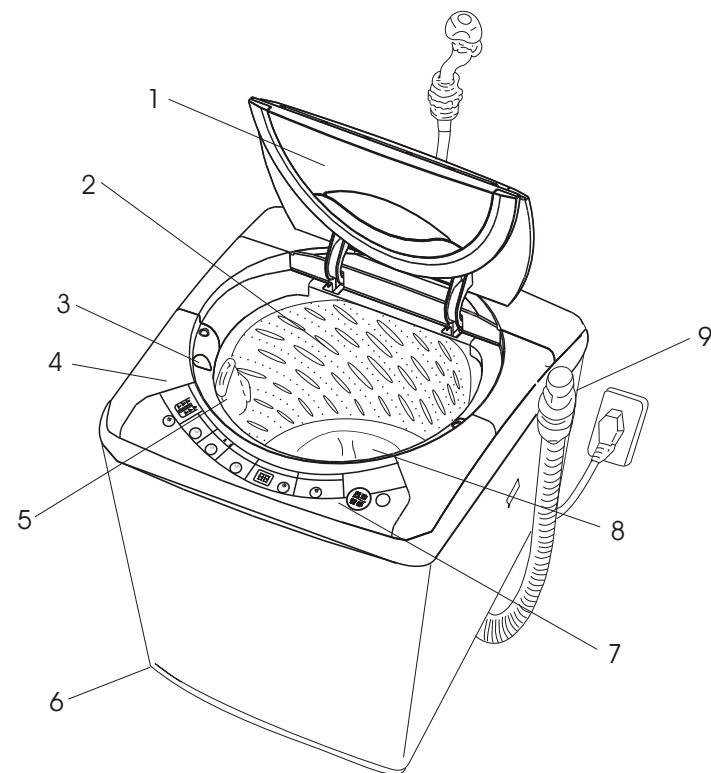

1. Top lid 2. Washing tub 3. Gradienter 4. Top frame 5. lint filter 6. Adjustable foot
7. Operation panel 8. Pulsator 9. Drain hose

Accessories

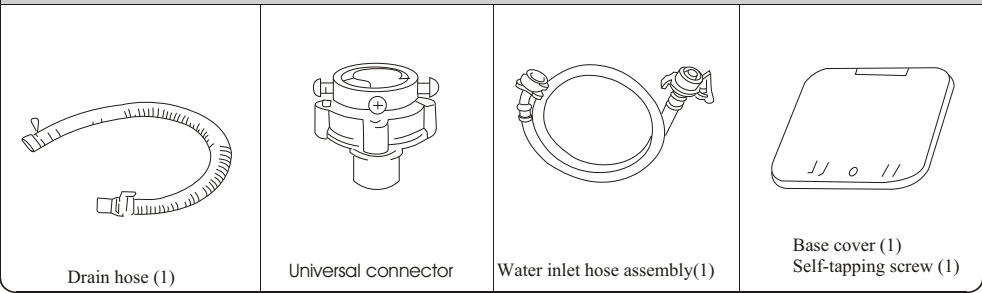

VOLUME OF WASHINGS AND DETERGENT

1. Check

- Whether the drain hose is through
- Whether the tap is open
- Whether the power socket is plugged in
- Take out the coins and other sundries from the pockets and shake off the mud or sand on the clothes

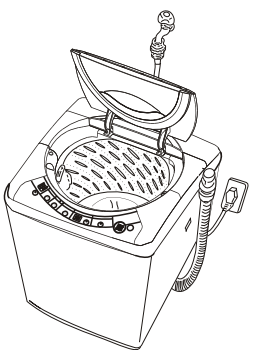

2. Washing put in and detergent

Dosage of common low foam washing powder

Washing Capacity	Dosage of the washing powder
3.6-6.0kg	80g
2.5-3.6kg	70g
1.5-2.5kg	60g
<1.5kg	50g

- Low foam and medium foam washing powder are recommended, and the washing powder had better be dissolved by warm water and be poured into the tub.
- Please refer to the manual of the washing powder about the dosage.

3. Determine water level, move the knob and align the dot to the selected water level

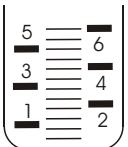

Washing capacity and comparison with the water level

Washing capacity	Water level	Water volume
4.5-6.0kg	6	About 52L
3.5-4.5kg	5	About 45L
3.0-3.5kg	4	About 38L
2.5-3.0kg	3	About 32L
1.5-2.5kg	2	About 25L
<1.5kg	1	About 19L

During washing, you can press the button to change water level in any time.

Notice: when the volume of the clothes is small, the water level can't be too high, otherwise it will waste the washing powder and water will splash out.

4. Cover the lid and press the power switch

After power on, all lights flash, and buzzer, showing washing machine on and at default setting, normal program; 6 water level, wash 12 minutes, rinse 2 times and spin for 5 minutes.



5. Press "Start/ Pause"button, start the washing machine

The 1-4 steps of the full process program and self-programming processes are the same, and as for the use from step 5, please see page 7~12 for details.

Notices:
The washing machine starts after pressing "Start/Pause"button, and pauses when press again.



FUNCTIONS OF BUTTONS

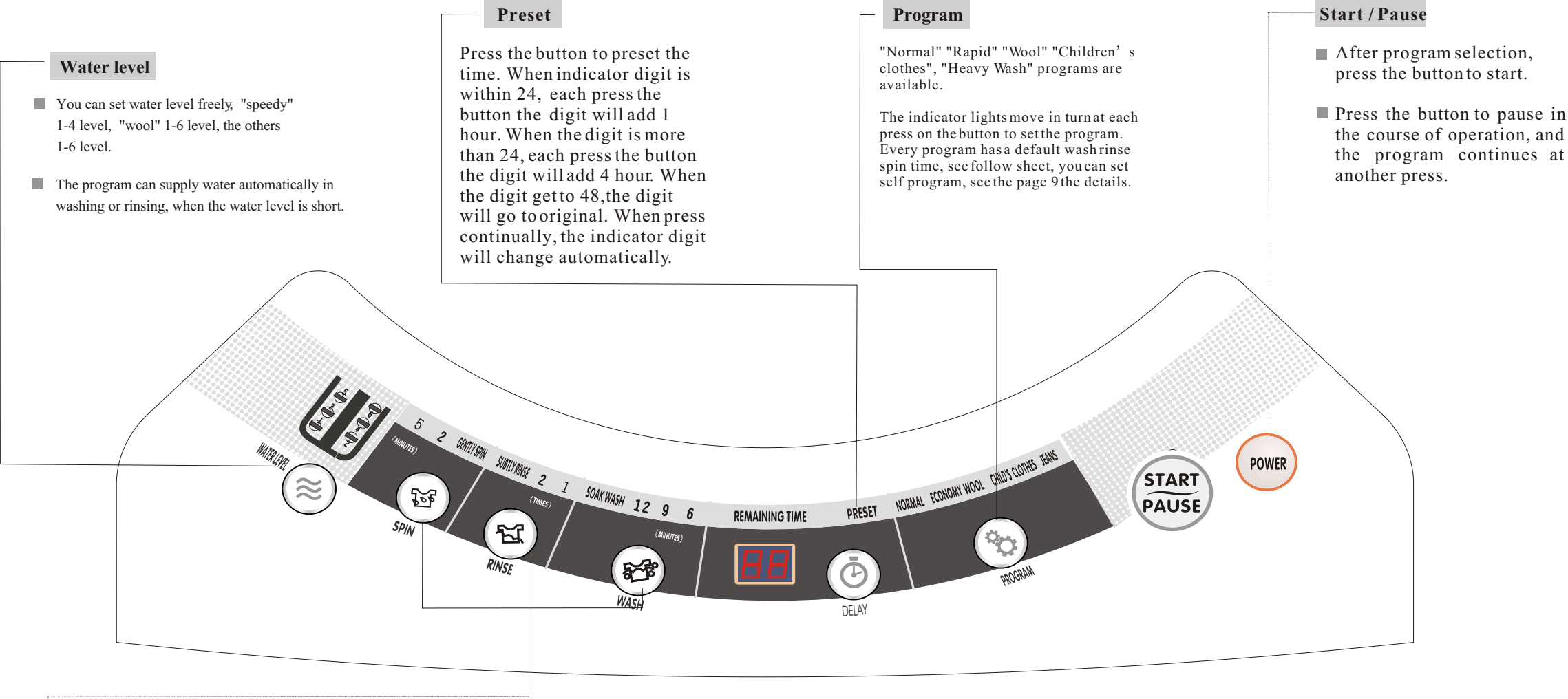

- selection of function**
- "Soak", "Single wash", "Wash/Rinse" "Rinse/Spin" and "Single spin" processes are available.
 - The indicator light moves in turn at each press on the button to set the process.
- Indication of function**
- The flashing light indicates the status of the running program. When setting water level below level 6 (not including level 6) the water level for rinse increase one level automatically.

The default parameter for all programs

	Water level	Wash(mins)	Rinse(times)	Spin(mins)
Normal	6	12	2	5
Rapid	3	6	1	2
Wool	6	6	2	Delicate
Child's clothes	6	12	Injection rinse	5
Heavy wash	6	soak wash	2	5

! In order to protect controller, the interval of switching on and off power should be more than 30 seconds.

WAY OF USE

Preparations before using

- 1. Lay down the drain hose
- 2. Connect the water inlet hose. The loading and unloading method of the water inlet hose can be seen in page 13.
- 3. Put the power plug into the socket.
- 4. Take out the coins and other sundries and shake off the mud and sand on the clothes.

Fully automatic program

There are four fully automatic programs that can automatically complete the whole courses of "Wash", "Rinse", "Spin", and features and usage of each process and the method of use are as below: (preparations before use are the same as the above-mentioned preparations).

Program	Features and usage	Way of use	Washing "Wash" light flashes	Rinse "Rinse"light flashes						Spinning "Spinning" light flashes	Total time										
				Rinse for the first time			Rinse for the second time														
Normal program	Powerful in washing and applicable for washing the whole clothes of a family of 3-4 persons changed in spring, autumn and winter.	Step5: press "Program"button, select the wanted program, and the corresponding light to the selected program will be turned on. Normal Speedy Wool Child’ s clothes Heavy wash <div>PROGRAM</div>	Water injection	Washing for 12 minutes	Water injection	Spinning for 3 minutes and 30 seconds.	drain	Washing for 3 minutes.	Water injection	Spinning for 3 minutes.	Washing for 3 minutes	Spinning for 5 minutes and 30 seconds	About 39 minutes								
Rapid program	Applicable for small volume of washing and the degree of stain of the clothes is light, especially for Rapid wash of the clothes daily changed by a family for once.			Washing for 6 minutes		Spinning for 2 minutes and 30 seconds.		Washing for 1 minutes and 30 seconds.		Note: Injection water rinsing is that injection water in the course of low speed spinning to rinse the detergent.				Spinning for 2 minutes and 30 seconds	About 18 minutes						
Wool program	Suitable for washing woollen sweater and various fine fibre fabrics (the neutral detergent is recommended).			Washing for 6 minutes		Spinning for 2 minutes and 30 seconds.		Washing for 2 minutes		Drain		Spinning with low speed for 1 minute and 50 seconds.		Water injection		Washing for 2 minutes	Spinning for 1 minutes and 30 seconds	About 26 minutes			
Child’ s clothes program	The washing time is short, the times for Rinse is much, and the water level is high, So it can rinse the clothes clearly. Avoiding the remaining detergent in the clothes hurts the skin of children.			Washing for 12 minutes		Injection rinse 2 times Injection rinse is that injection water in the course of rinse and increase rinse time.						Spinning for 5 minutes and 30 seconds				About 43 minutes					
				Dynamic soak for 20 minutes Washing for 12 minutes		Spinning for 2 minutes and 30 seconds.		Water injection				Spinning for 3 minutes and 30 seconds.					Drain		Spinning for 3 minutes.	Water injection	Washing for 3 minutes.
Heavy wash program	Powerful in washing, applicable for seriously stained clothes such as dirty union suit, jeans and etc. and applicable for washing blanket, wool towel, slipcover and other items.	Step6: The washing machine will start at the press on the "Start/Pause" button, and the washing machine will pause at the press on the button in the course of operation. <div>Start Pause</div>	Water injection	Drain	Water injection	Note: Injection water rinsing is that injection water in the course of low speed spinning to rinse the detergent.	Water injection		Washing for 2 minutes	Spinning for 1 minutes and 30 seconds	About 26 minutes										

 **Notice:** The total time needed by all programs has something to do with the pressure of the tap water, and the time may prolong in case of low water pressure.

WAY OF USE

Self program

- 1. Press wash button, the indicator light move in turns, and select wash 12 minutes, soak wash, wash 6 minutes, wash 9 minutes, all lights turning off means no washing course, the details of soak wash program see page 11.
 - 2. Press the rinse button the indicator light move in turn, and corresponding to select rinse to times, injection rinse, rinse one times, all lights turning off means no rinsing course.
 - 3. Press the spin button the indicator light move in turn, and corresponding to select to spin 5 minutes, gentle spin, spin 2minutes, all lights turning off means no spinning course .
- The user can press the wash rinse spin button to compound program freely, the following is some common self programs.

Functions	Features and usage of the programs	Way of use	Function indication	Soak		Wash	Rinse								Spin		
							Rinse for the first time				Rinse for the second time						
Soak Wash	The time and flows for soak, wash, rinse and spin are different from each other, it is applicable when the water temperature is very low in winter and the clothes are very dirty.	Step1-step4 are the same as those of the full automatic programs Step5: Press "wash" button one time, the soak wash light is on. Step6: Press program to select the program which needed. Step7: Press start/pause button, the washing machine will start, press this button again in the operation, the washing machine will pause.	The corresponding lights and design to the process "Soak" "Wash" "Rinse" "Spinning" are all turned on, and the light corresponding to "Soak" will flash after the start.	Water injection	Soak		Wash	Drain	Spin	Water injection	Rinse	Drain	Spin	Water injection	Rinse	Drain	Spin
Single wash	The time and flows for single wash of the 5 programs are different from each other, and it does not drain after the end of wash, it is applicable when the cleansing solution is used for two times.	Step5: Press rinse button 3 times, and the rinse light is off, press spin button the spin light is off. The other steps are same as top step.	The light and design corresponding to "Wash" will be turned on, and it will flash after the start.			Water injection	Wash										
Wash Rinse	The flows, washing time, rinse times of 5 wash and rinse programs are different from each other and it does not drain after the end of rinse, applicable for the case of clothes need not spinning.	Step5: Press the spin button 3 times, the spin light is off. The others steps are same as the top steps.	The light and desgin corresponding to "Wash" and "Rinse" will be turned on, and the light corresponding to "wash" will flash after the start.			Water injection	Wash	Drain	Spin	Water injection	Rinse	Drain	Spin	Water injection	Rinse		
Rinse	Rinse time and number of rinse will be different between the 5 rinse programs. This program is applicable for clothes that requires deep rinse but not applicable for spinning.	Step5: Press the wash 4 times, and the wash light is off, press the spin button 3 times, and the spin light is off. The others steps are same as the top steps.	The light and design corresponding to "Rinse" will be turned on, and the light corresponding to "Rinse" will flash after the start.					Drain	Spin	Water injection	Rinse	Drain	Spin	Water injection	Rinse		
Rinse spin	The rinse times and the spinning time of 5 rinse spin programs are different from each other, applicable for pre-washing seriously stained clothes.	Step5: Press the wash button 4 times, and the wash light is off. The others steps are same as the top steps.	The light design corresponding to "Rinse" and "Spin" will be turned on, and the light corresponding to "Rinse" will flash after the start.					Drain	Spin	Water injection	Rinse	Drain	Spin	Water injection	Rinse	Drain	Spin
Spin	The spin time of 5 programs are different from each other, applicable for drain the residual water or only for spinning the wet clothes.	Step 5: Press the wash button 4 times, and the wash light is off, press the rinse button 3 times, and the rinse light is off. The others steps are same as the top steps.	The light and design corresponding to "Spin" will be turned on, and the light corresponding to "Spinning" will flash after the start.													Drain	Spin

Preset program

Preset time means the starting time of washing.

- 1. Switch on the power.
- 2. Open the tap and lay down the drain hose.
- 3. Put into the washing and detergent.
- 4. Select the proper water level according to the quantity of clothes.
- 5. Select the functions and programs.
- 6. Press "Preset" button to select the starting time of washing.
- 7. Press "Start/Pause" button and close the lid.

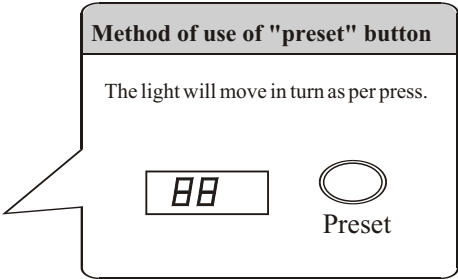

Confirmation of the preset

- After the preset starting, the corresponding light will be turned on, the display digit shows the washing machine starting time.
- After starting preset, you can press the preset button continuously to check the preset status, then loose the preset button, the program returns to preset status, if you open the lid now, the washing machine will alarm.

WAY OF USE

Soak wash

- 1. Switch on the power.
- 2. Open the tap and lay down the drain hose.
- 3. Put in clothes and detergent.
- 4. Select proper water level according to the weight of clothes.
- 5. Select the "Function" and "Program".
- 6. Press the "Function" button, the lights of "Soak" "Wash""Rinse""Spin" will turn on.
- 7. Press "Start/Pause" button and close the lid.

Confirmation of soak:

After pressing on the "Start/Pause" button, the icon "Soak" will flitter.

Wash of blanket

The weight of the blanket should be less than 3kg, and please select the heavy program to wash and it had better use particular mesh bag for the heavy washing and the method is as follows:

- 1. After the detergent is dissolved with proper amount of warm water (below 50℃), pour it into the tub of the washing machine.
- 2. Fold up the blanket and put it into the washing tub.
- 3. Switch on the power and press the "Program" button to select the "Heavy wash" program and "Level 6" or "Level 5" water level.
- 4. Press the "Start/Pause" button, and close the lid.
- 5. After ending of washing, dry in the ventilated place with sunshine.
- 6. Only the blanket with marks "Hand wash" can be washed.

Use of fabric softener

Fill softener into the injection mouth for fabric softener (at the tub mouth).

Wash of bulk clothes

Please put the bulk clothes into mesh bag in time of washing, and then add washing powder and select the full process program to wash them.

Pre-wash of the dirty clothes

As for seriously stained dirty clothes with mud, one of the "Rinse-spin" program can be selected to perform pre-washing, and then add washing powder and select the fully automatic program to wash them.?

INSTALLATION

Placement of the washing machine

The washing machine should be placed inside the room with a flat floor, which is convenient for water supply and drain, has low moisture and no direct sunshine, and does not freeze in winter. All foam packing (including the fixing frame on the base foam) should be taken off, otherwise the washing machine will not work.

Please adjust the washing machine according to the instructions below to make the washing machine run steadily.

- 1. Loose the fixing pole on the adjusting foot, screw in or screw out the adjusting foot to make the four braces placed even on the floor. (the adjusting foot is on the left front bottom of the cabinet).
- 2. When the floor is slanting or uneven, it is not easy to make even only by the adjusting foot. Then the rubber band can be added to the unflat place.
- 3. Open the cover lid and watch gradienter, when the air bladder move to the red circle mark in the gradienter, or see the hole of the top frame and the washing tub are found to be basically in alignment, that is to show that the washing machine is placed flat, just like followed figure.
- 4. After the adjustment the fixing pole should be screwed back and tight.



Notices:

If the washing machine is not placed flat (the inclination angle is over 2”), it may cause great vibration or automatic check and rectification or other abnormal circumstances will often take place in the course of spinning.

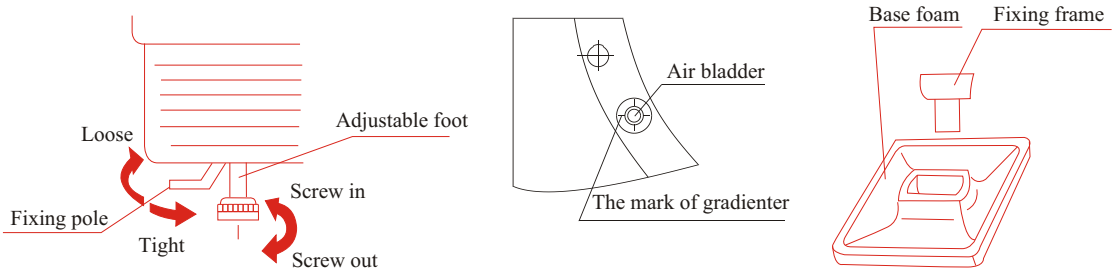

INSTALLATION

Installation of the water inlet hose

- 1. Check the tap mouth. If it is not even, it can be filed even.
- 2. Screw loose the locking ring, but do not let the locking ring drop off. Screw the four screws at the same distance.
- 3. Put the universal connector into the tap and stick to the tap mouth at the most and then screw in the screws.
- 4. Screw tight the locking ring to the right.
- 5. Pull the skirt of one end of the water inlet hose downwards, and then plug in the universal connector. A sound of "KA-TA" means proper connection.
- 6. Grasp the water inlet hose by hand and pull it downward to see whether it is secured
- 7. Screw the nut on the other end of the water inlet hose into the water inlet of the washing machine to the most.

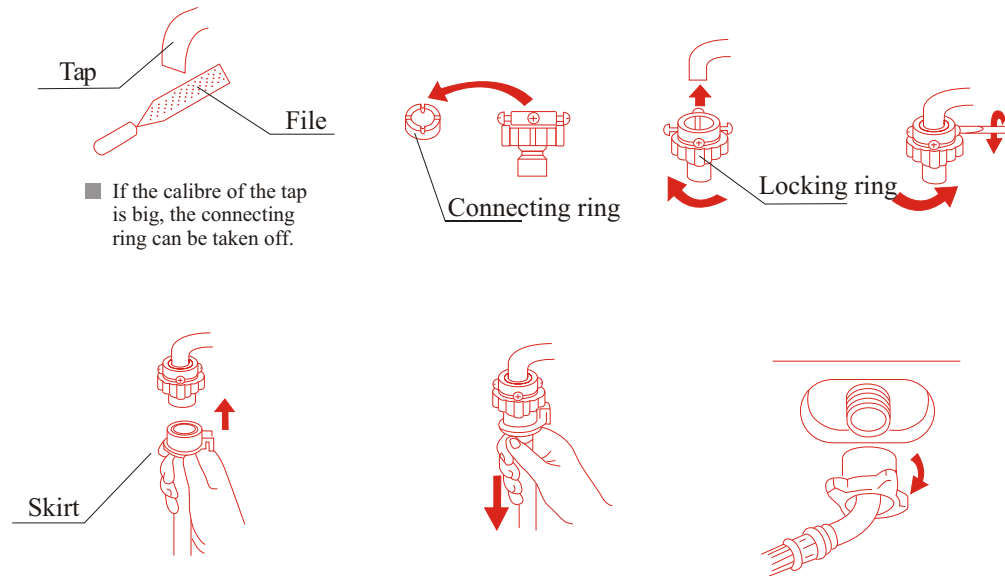

Notices:

After installation, do not start the washing machine in haste. First open the tap to let the water press into the water inlet hose to check whether there is any leakage in the connectors on the both ends. Sometimes it is difficult to fix the water inlet hose due to the problem of the tap, you can ask an experienced man for help or contact the local customer service department. When the pressure is too high, please shut the tap a little to avoid water leakage.

INSTALLATION

Installation of the drain hose

■ Nip the fixing ring with hand to make it loose and engaged on the drain hose and put the drain hose into the leading skirt of drain hose in the bottom of the washing machine to the end at the most (soak the head of the drain hose in warm water, it will make the engagement easy), and loose the fixing ring to let it clasp the drain hose.

■ It had better put the outlet of the drain hose into the nearby drainage permanently, which can save the trouble that the drain hose has to be connected each time before use. If the drainage is far from the washing machine, it can be solved by connection of the drain hoses head with end to extend.

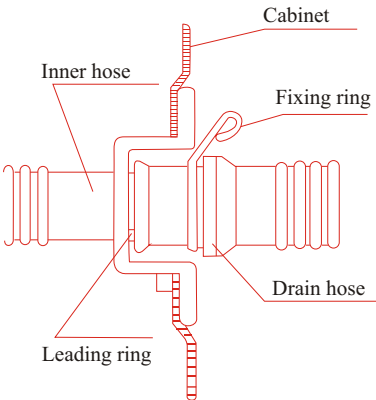

Notices: drain faults will be caused when the drain hose is blocked or after the extension of the hose, it is above the water outlet.

INSTALLATION

Power source and grounding

The washing machine employs alternative current with the rated voltage and frequency . When the voltage fluctuates between $\pm 10\%$ of rated voltage, the washing machine can work normally. A special power socket for the washing machine had better be set beside the washing machine for convenience and safety. The method of connection of the socket is as the figure below.



Notices:

- The socket and the grounding wire must be installed by an electrician to prevent incorrect installation or use of the socket, and to guarantee the safety of use of electricity.
- The power wire of the washing machine employs Y connection and the replacement of the power wire should be carried out by professionals
- No connection of the grounding wire with the neutral wire, otherwise the cabinet will be charged, which is likely to cause the danger of electric shock.

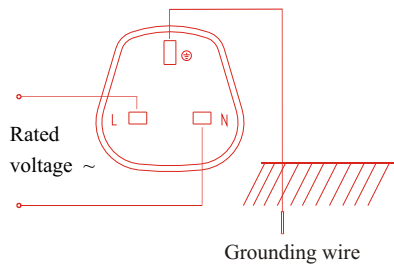

Installation of the base cover

1. Slant the washing machine with angle of 45° in the direction of the arrows showed in the figure, put the side with the clasper to the washing machine and the other side to the ground, insert back lid along the direction of the upper slot of the base from the back side of the washing machine.

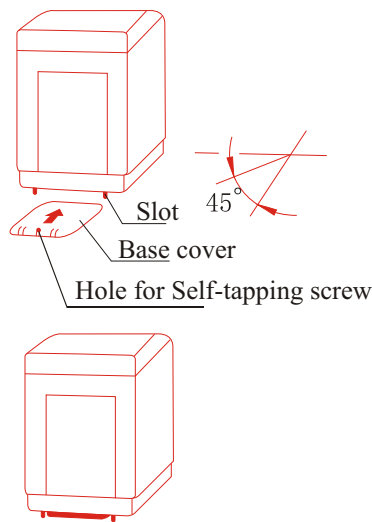

2. Put the base cover straight to the point and then press the back lid upward till there is a sound of "Gaba" and then screw in a self-tapping screw.

PRECAUTIONS

Safe use of power

Please put the power plug into the special rated voltage socket to avoid fire accidents. The plug-in and plug-out of the wire should go on with the plug held with hand.

Avoid damp

Don't place the washing machine in the environment with extreme damp, for the extreme damp will low the functions of the insulation of the machine, which may cause electric shock or faults.

Don't use hot water

Don't use hot water over 50°C to avoid deformation of the plastics.

Don't open the lid in time of spinning

If the lid is open in time of spinning, the washing machine will arrest at once, which will shorten the service life. Please avoid opening the lid in the course of operation, don't put hands into the tub, it is very dangerous that the clothes wind the hand despite of low speed of rotation.

Avoid spray of water

Don't let water spray onto the places for operation switches. That these places sprayed with water will cause electric shock and faults.

Keep away from smoke and fire

Don't place lighted candles, cigarettes, mosquito-repellent incense and thermos bottles nearby to avoid fire accidents or deformation of the plastics.

TROUBLE SHOOTING

Diagnosis of faults

The washing machine is able to automatically judge some faults by sending out buzzing sound to alarm and indicate the cause of faults with several indicator light fluttering.

Symptom	Cause	Solution
Does not work completely	If the power is cut off	Using agin after the power on
	If plug is not plugged tight, or the power switch is not switched on.	Plug the power plug tight and switch on the power switch.
	If no electricity in the socket or the fuse is broken	Send for electrician to check and repair the socket or the fuse (see the circuit diagram)
E1 (Affusion trouble)	If no water in water tap	Power off the washer until water come to use
	If the water tap not open	Open the cover lid and open the water tap and close thecover lid
	If the net of water inletvalve is stopped up	Open the cover lidand clean up the net then closethe cover lid
	If the washer is leakaged	Power off washer,take off theplug and make the machine be repaired
E2 (Door open warning)	If open the cover lid before spinning	Close thecover lid
	If open the cover lid after preset start	Close thecover lid
E3 (Scuff the shell in time of spin)	If the clothes uneven heavily	Open the cover lidand distribute the clothes even, andthen close the lid
E4 (Drain trouble)	If the drain hose is blocked or the mouth of drain is too high	Open the cover lid, eliminate the trouble and close the cover lid.

👉 Notices:

- If the machine is not drain when startup drainage because of air pressure, please lay down the drain hose then put it in the normal position.
- "Automatic rectification" is that the washing machine stops the spinning automatically. After it is changed into water injection, the pulsator will frequently mix the washing clockwise and counterclockwise (which equals to rinse). That the weight of the washing is too much or too little, or that the washing machine is not placed evenly will cause the unbalance in time of spinning and is likely to switch into the automatic rectification and increase the times of rinse. If there is still abnormal circumstances after checking the above-mentioned points, please pull out the power plug and contact with the local customer service department . Don't repair it by yourself.

METHOD OF MAINTENANCE

The following cases are not faults

1. There is the phenomenon of incoming water in time of wash or rinse, which is due to that the water level switch checks the water level and it supplies water automatically due to the water level drop.
2. There is the phenomenon of intermittent spinning in the beginning of spinning, which is performed to achieve better spinning effects.
3. In time of rinse with water injection, there may be no drain in the drain hose, which is caused by that the water level does not reach the overflow mouth due to low water pressure or the low water level set.
4. In the course of spinning, there is a phenomenon of rinsing, which is caused by that the automatic rectification of the lopsideness of the clothes due to unbalance produced in the course of spinning.

Method Of Maintenance

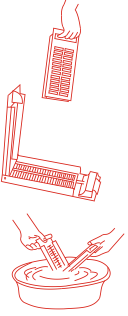
After end of the program	Maintenance of shell
<ul style="list-style-type: none">■ The washing machine will send off the sound of "DOU-DOU" after end of any program operation to remind you to take out the washings or operate it again.■ Please shut off the tap, pull out the plug in time of not in use to avoid water leakage.	<ul style="list-style-type: none">■ Use soft cloth to wipe off the water and dirt on the surface each time after use of the washing machine. Detergent, propellant and other chemicals are not allowed to use to avoid the damages on the surface. 
Cleaning of the lint filter	Cleaning of the water inlet
<p>After using the washing machine for a period, please clean according the following steps:</p> <ol style="list-style-type: none">1. Take out the lint filter.2. Turn the mesh bag outside and wash it clean in the water.3. Restore it and refix it. 	<p>After long time use, the water inlet mesh bag may be blocked with crud, and please clean it according to the following steps:</p> <ol style="list-style-type: none">1. Shut off the tap and switch on the power.2. Start the washing machine and continue for 5 seconds (let the water flow in the water inlet hose run into the tub).3. Load off the water inlet hose, take out the water inlet mesh bag from the water inlet valve, clean the mesh bag, then assemble the mesh bag in the valve and load the water inlet hose. 