

DURATRAX[®]



VENDETTATM SC

ASSEMBLY AND OPERATION MANUAL

duratrax.com

ITEMS INCLUDED

The following items are included with your Vendetta SC.



Chassis
Body
Instruction Manual
Exploded View/Parts Listing

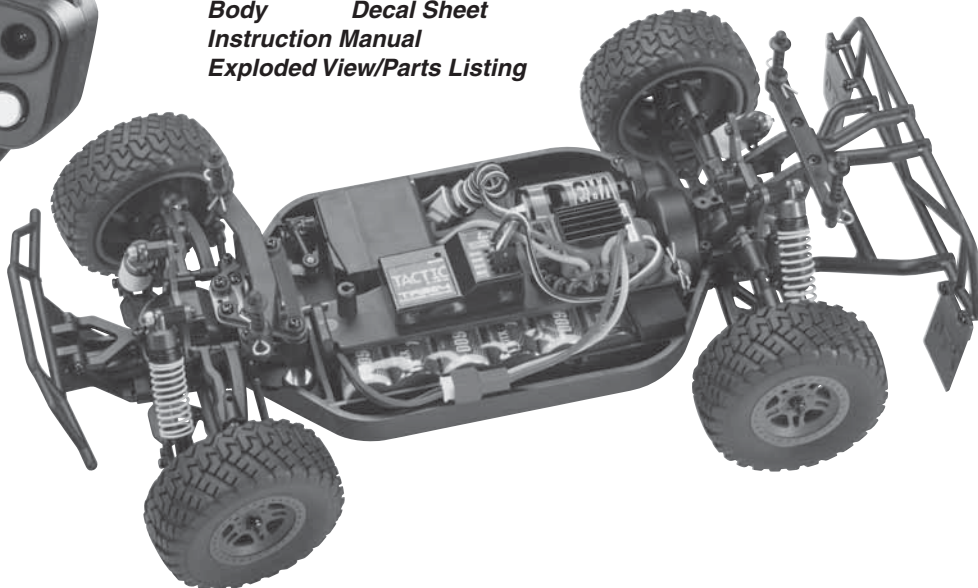

YOU WILL NEED



BATTERY ADAPTER
(FOR CHARGING)
DTXC2210



6-CELL 1600 MAH NIMH BATTERY
DTXC2193



AA x 4



ONYX™ 220 PROGRAMMABLE
PEAK CHARGER
DTXP4220

THINGS TO KNOW

SAFETY PRECAUTIONS

When these safety precautions are followed, the Vendetta SC will provide years of enjoyment. Use care and good sense at all times when operating this radio controlled truck. Failure to use this vehicle in a safe, sensible manner can result in injury or damage to property. You and you alone must ensure that the instructions are carefully followed and all safety precautions are obeyed.

- Do not operate the Vendetta SC near people. Spectators should be behind the driver or at a safe distance away from the vehicle.
- Make sure to read the instructions included with the battery and charger before charging the battery.
- Do not leave any charger unattended during charging. If the battery or charger become hot at any time, disconnect the battery from the charger immediately! Failure to do so may cause permanent damage to the charger and battery and may cause bodily harm or property damage.
- Do not cover the air intake holes on the charger during charging. This may cause the charger to overheat.
- Do not allow the electronic speed control (ESC) or other radio equipment to come into contact with moisture. Water can cause electronics to short out and can cause permanent damage.
- Always turn on the transmitter before turning on the electronic speed control.
- Always turn off the ESC *before* turning off the transmitter.
- Allow the motor and ESC to cool before each run.

HELPFUL HINTS

- Avoid working over a deep pile carpet. If you drop a small part or screw, it may be difficult to find.
- Place a mat or towel over your work area. This will prevent parts from rolling off and protect the work surface.
- Avoid running the truck in cold weather. The plastic and metal parts can become brittle at low temperatures. In addition, grease and oil become thick, causing premature wear and poor performance.
- Test fit all parts before attaching them permanently.

SPECIFICATION AND DESCRIPTION CHANGES

All pictures, descriptions and specifications found in this instruction manual are subject to change without notice. DuraTrax maintains no responsibility for inadvertent errors in this manual. Visit duratrax.com for the latest updates and information for your model.

WARRANTY

- DuraTrax® guarantees this kit to be free from defects in both material and workmanship at the date of purchase. DuraTrax will warranty this kit for 90 days after the purchase date. DuraTrax will repair or replace, at no charge, the incorrectly made part.
- Make sure you save the receipt or invoice you were given when you bought your model! It is your proof of purchase and we must see it before we can honor the warranty. Further, DuraTrax reserves the right to change or modify this warranty without notice.
- In that DuraTrax has no control over the final user assembly or material used for final user assembly, no liability shall be assumed nor accepted for any damage resulting from the use by the user of the final user-assembled product. By the act of using the user-assembled product, the user accepts all resulting liability.

To return your Vendetta SC for repairs covered under warranty, you should send your truck to:

Hobby Services
3002 N. Apollo Drive Suite 1
Champaign, Illinois 61822
Attn: Service Department
Phone: (217) 398-0007
9:00 am–5:00 pm Central Time M-F
E-mail: hobbyservices@hobbico.com
hobbyservices.com

If you are not prepared to accept the liability associated with the use of this product, you are advised to return this kit immediately in new and unused condition to the place of purchase.

STRESS-TECH™ PARTS GUARANTEE

We have engineered the Vendetta SC to take the rough and tumble abuse that makes R/C fun. We are so confident of the quality and durability of the Stress-Tech plastic parts that we will replace any Stress-Tech plastic part you break during the first 12 months you own the truck. Just send in the part to us and we will send you a FREE replacement. Please see the parts list for the items covered under the Stress-Tech guarantee.

To receive your free replacement part please send the following to the Hobby Services address listed under the warranty on the left.

- ☐ 1. The broken part must be included.
- ☐ 2. The part number and description of the broken part.
- ☐ 3. Copy of the dated invoice or purchase receipt.
- ☐ 4. Your name, phone number and shipping address.

REPAIR SERVICE

Repair service is available anytime.

- After the 90 day warranty, you can still have your Vendetta SC repaired for a small charge by the experts at DuraTrax's authorized repair facility, Hobby Services.
- To speed up the repair process, please follow the instructions listed below.

- ☐ 1. Under most circumstances return the ENTIRE vehicle. The exception would be sending in a Stress-Tech part. See the instruction under the Stress-Tech Guarantee.
- ☐ 2. Make sure the transmitter is turned off, and all of the batteries are removed.
- ☐ 3. Send written instructions which include: a list of all items returned, a THOROUGH explanation of the problem, the service needed and your phone number during the day. If you expect the repair to be covered under warranty, be sure to include a proof of date of purchase (your store receipt or purchase invoice).

FINISHING THE VENDETTA SC

TRANSMITTER PREPARATION

- Slide off the battery tray door and install four “AA” batteries. Make sure the polarity is correct.



- Raise the antenna at the top of the transmitter.



- Turn on the transmitter and check the battery light. If the red light glows steadily, the batteries have enough voltage. If the red light blinks, the batteries are low and should be replaced.



6-CELL BATTERY INSTALLATION

- Remove the body clip from the battery strap post.
- Remove the battery strap and foam spacer.
- Install a fully charged 7.2V battery into the chassis.
- Reinstall the battery strap and foam spacer. Secure them in place with the body clip.
- Make sure the ESC is turned "OFF" before plugging the red battery connector into the red ESC connector.

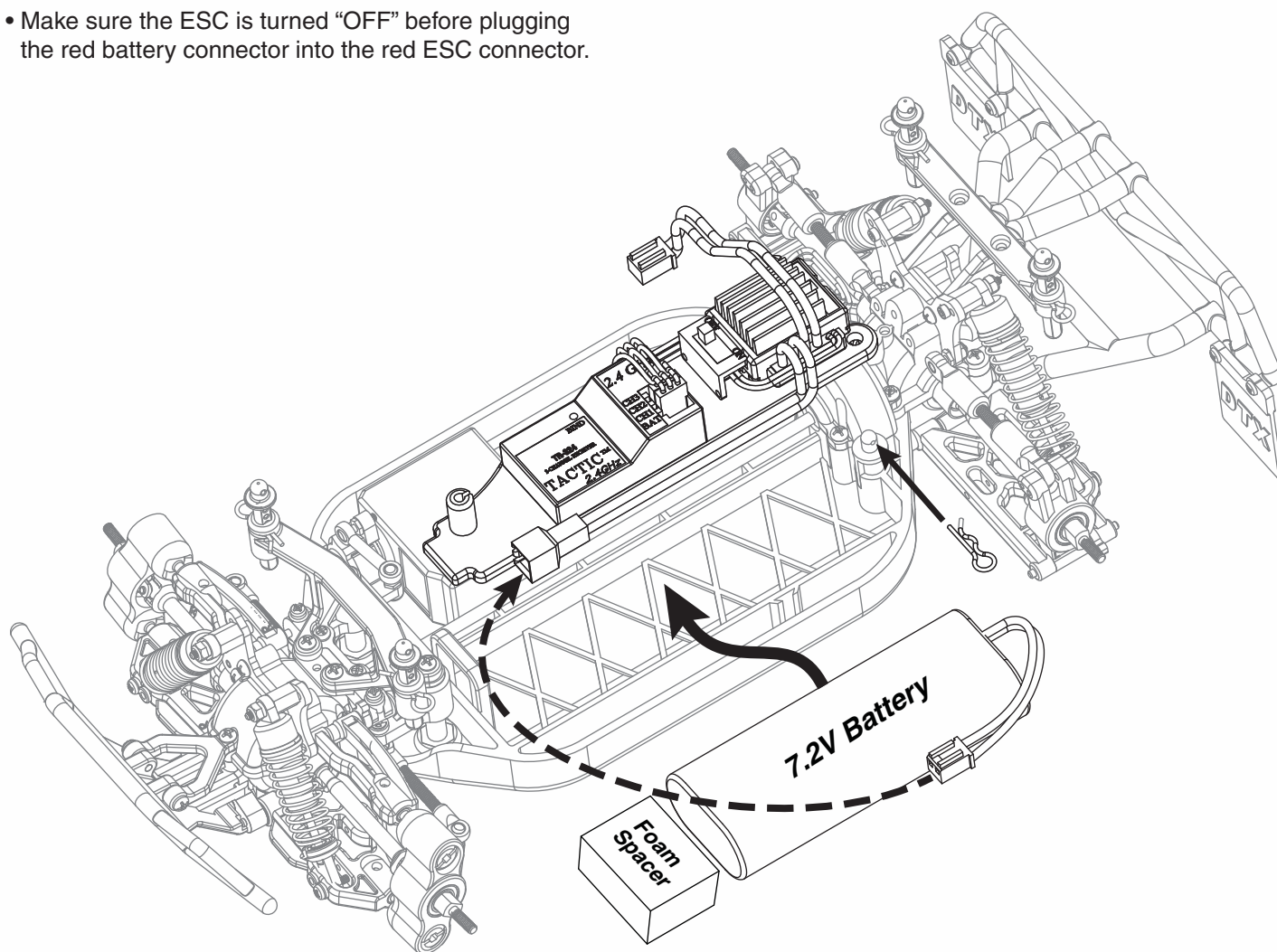

RADIO SYSTEM CHECK

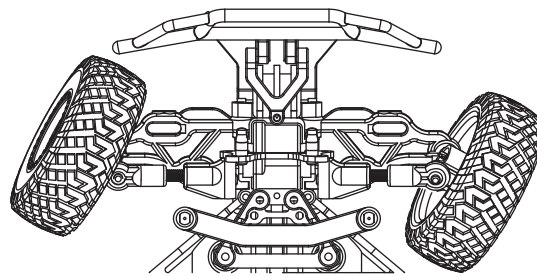
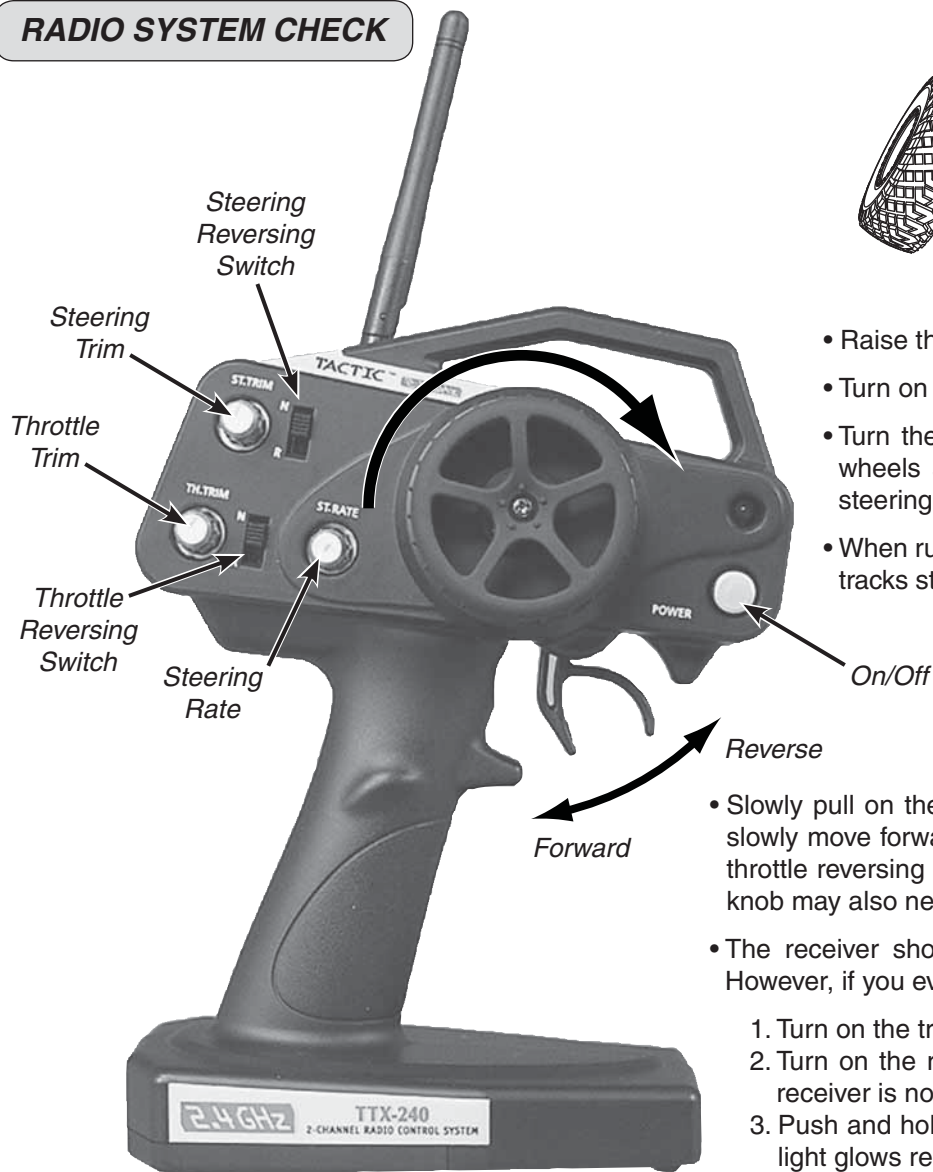

- Raise the antenna.
- Turn on the transmitter before turning on the ESC.
- Turn the transmitter wheel to the right—the front wheels should turn to the right. If not, move the steering servo reverse switch.
- When running, adjust the steering trim so the truck tracks straight.

! ALWAYS CHECK THE RADIO OPERATION BEFORE EACH RUN

- Slowly pull on the throttle trigger. The Vendetta SC should slowly move forward. If the truck goes in reverse, move the throttle reversing switch on the transmitter. The throttle trim knob may also need to be adjusted to find neutral.
- The receiver should be factory bound to the transmitter. However, if you ever need to bind, follow these steps:
 1. Turn on the transmitter.
 2. Turn on the receiver via the switch on the ESC. If the receiver is not bound, the LED light will not be on.
 3. Push and hold the bind button on the receiver until the light glows red.
 4. Release the bind button.
 5. If the binding is successful, the LED will flash once and then remain ON.

SPEED CONTROL SET UP

NOTE: If you do not wish to change the ESC settings, simply wait for the red light to stop flashing (about two seconds) before moving the throttle trigger.

1. Center the throttle trim adjustment and turn on the transmitter.
2. Move the switch on the ESC to the “OFF” position and connect the battery.
3. Lift the chassis so its wheels are off the ground.
4. Turn on the ESC. It will “beep” once and the red light will begin to flash indicating the ESC is in set-up mode.
5. Program the ESC by moving the trigger to the full speed position, then to the full brake position. Return the trigger to the neutral position.

The ESC will beep four times and the green light will come on, indicating the ESC has been set up.



BODY INSTALLATION

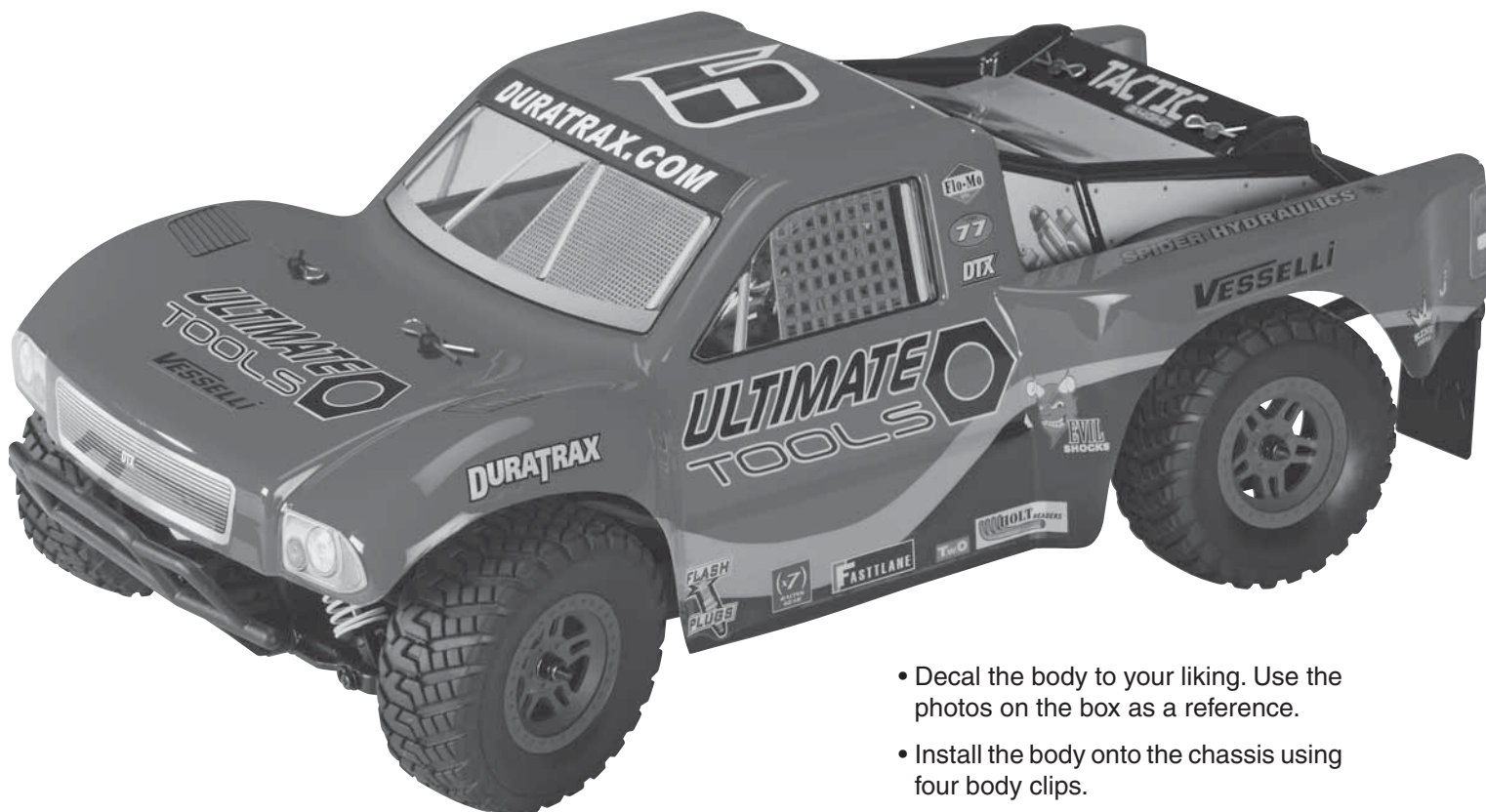

- Decal the body to your liking. Use the photos on the box as a reference.
- Install the body onto the chassis using four body clips.

MAINTENANCE TIPS

BEFORE EACH RUN

- **IMPORTANT:** Check to make sure that all screws are tight. Always use threadlock (DTXR2010) on screws threading into metal.
- Check the condition of your radio system batteries and replace/recharge if necessary.
- Make sure that all of the moving parts of the Vendetta SC move freely and do not bind.
- Turn on the radio and make sure the servo moves easily and in the proper direction.
- Check for any broken or damaged parts. Replace them before running the Vendetta SC. Running the Vendetta SC with broken or damaged parts could damage additional parts.
- Make sure that all wires are properly connected.
- Make sure the ESC, servo and receiver are properly secured.



AFTER EACH RUN

- Clean any debris from the chassis and moving parts.
- Check for any broken or damaged parts. Replace them before the next run.
- Disconnect and remove the battery from the chassis.
- Allow the motor and ESC to cool.

AFTER EVERY 10 RUNS

- Make sure that the bearings are free of dirt and debris, and roll smoothly.
- Check the shocks for oil leakage. Inspect the shafts and O-rings for wear and damage. Replace if necessary. IF a shock shaft has scratches you can feel with a fingernail, it should be replaced.
- Make sure the tires are still securely glued to the rims.

TUNING GUIDE

When tuning the Vendetta SC make sure that you have equal lengths from one side to the other on the shocks, upper rods, and front pivot ball knuckles. Also, make sure to have the shock pre-load adjusters at the same setting from left to right. They do not have to be the same front to rear.

RIDE HEIGHT ADJUSTMENT

The ride height of the Vendetta SC is easily adjusted by using the clip-on pre-load collars. To increase the ride height of the Vendetta SC, add more pre-load collars between the shock cap and the upper shock collar. Make sure you have the same pre-load from side to side. To lower the ride height, remove the pre-load collars. **TIP:** Rough, bumpy surfaces require higher ride height; flat, smooth, or high traction surfaces allow a lower ride height.

PINIONS

The Vendetta SC comes stock with the 12 tooth pinion. To obtain higher top speeds you can install a larger pinion gear onto the motor. This will, however, decrease your acceleration and run time. **TIP:** Smaller pinion equals more torque, less top speed. Larger pinion equals more top speed, less torque. If you use a larger pinion, it is recommended that you either solder your motor wires directly to the ESC or use a high-current motor connector.

WHEELBASE

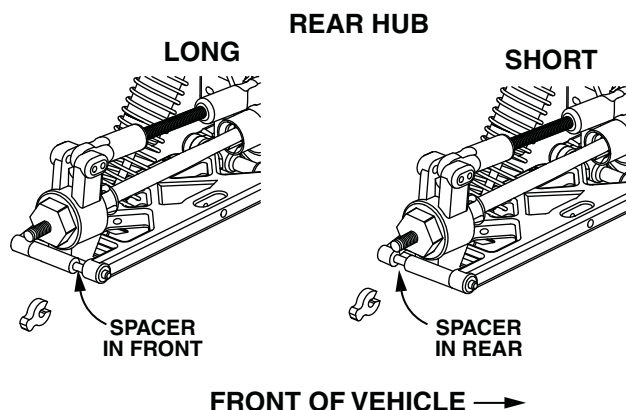

You can adjust the wheelbase on the Vendetta SC by placing the adjuster clips in front of or behind the rear hub carrier. A shorter wheelbase will provide more steering, while a longer wheelbase will be more stable.



SHOCK SPRINGS

The Vendetta SC comes stock with medium springs (yellow, DTXC8952). For low traction or bumpy tracks, use a soft spring (White, DTXC8953). For high traction or smooth tracks, use a firm spring (Green, DTXC8954).

FRONT SHOCK ADJUSTMENT

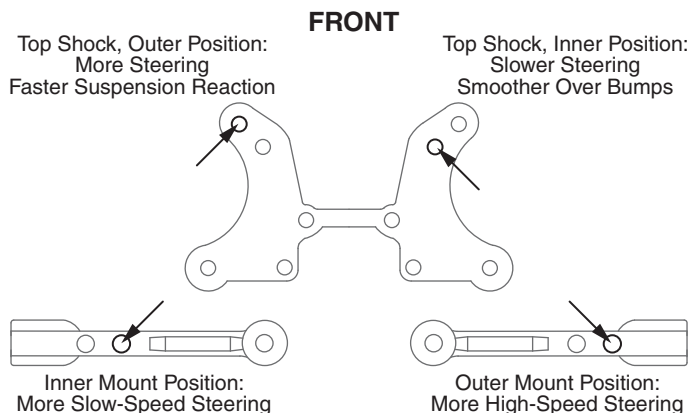

Moving the tops of the shocks to the outer position will increase steering reaction but decrease front traction. Moving the tops of the shocks in will result in slower steering reaction but will be smoother over bumps and have more front traction. Mounting the bottom of the shocks in the inside hole will give more front traction but slower steering reaction. Mounting the bottom of the shocks in the outer position will give less front traction but increase steering reaction. The lower mounting points are for major adjustments and the top mounting points are for minor adjustments.

REAR SHOCK ADJUSTMENT

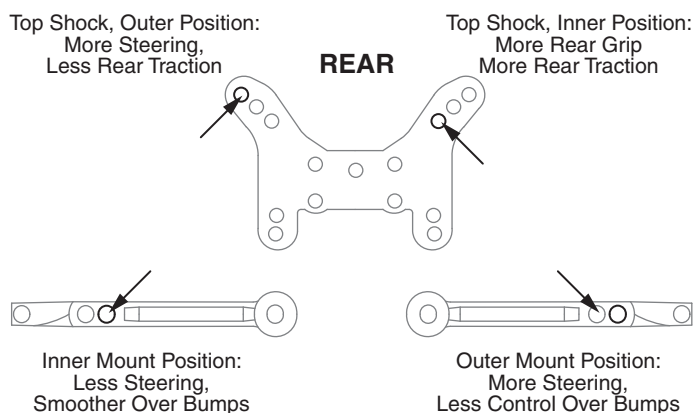

Moving the tops of the shocks out will increase steering reaction and decrease rear traction. Moving the tops of the shocks in will result in slower steering reaction but will be smoother over bumps and have more rear traction. Mounting the bottom of the shocks in the inside hole will give more rear traction. Mounting the bottom of the shocks in the outside hole will give less rear traction and increase steering reaction. The more angled the rear shock is, the more side grip. The more vertical the rear shock is, the less side grip. The lower mounting points are for major adjustments and the top mounting points are for minor adjustments.

SHOCK OIL

The Vendetta SC comes with 30-weight oil in the shocks. The handling of the truck can be tuned by changing the shock oil to either heavier (bigger number) or lighter (smaller number). By putting heavier oil in the shocks, the truck will have less chassis roll and become more responsive. Putting lighter oil in the shocks will cause the truck to be less responsive and have more chassis roll. For smooth, high-traction surfaces, a thicker oil would be best. For low-traction or bumpy surfaces, a lighter oil would be best.

FRONT TRACK WIDTH

The Vendetta SC has adjustable front track width due to its pivot ball knuckle design. To decrease track width, screw in the upper and lower pivot balls equally. To increase track width, screw out the upper and lower pivot balls equally. Make sure that both sides are the same distance from the end of the upper and lower arms. You can check this by measuring from the end of the upper and lower arm to the outside of the knuckle. Track width affects the truck's handling and steering response. Wider front track width decreases steering reaction and front grip. Narrow front track width increases steering reaction and front grip.

TOE-IN AND TOE-OUT

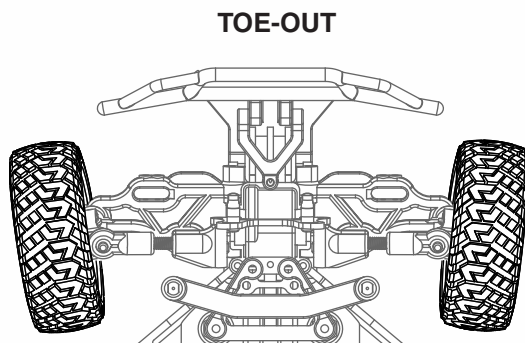
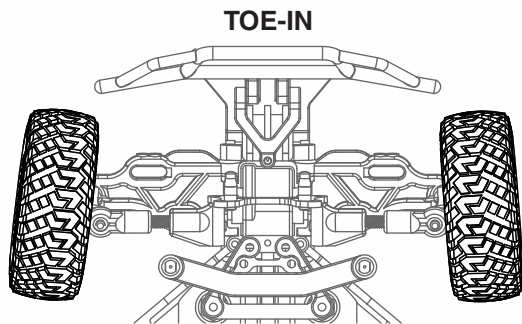

Toe-in is when the fronts of the tires point towards each other. Toe-out is when the fronts of the tires point away from each other. Toe-in increases stability during acceleration and high speed. However, toe-in also decreases steering when entering a corner. Toe-out will increase steering into corners, but will decrease the overall stability during acceleration. The front typically is set up with 0° to 1° of toe-in.

CAMBER

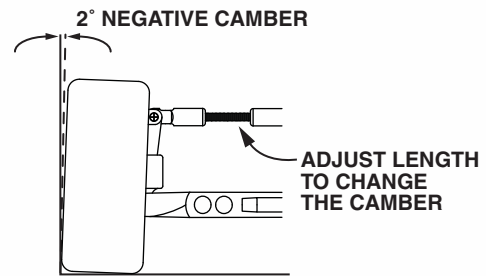

Camber refers to the angle at which the tire and wheel ride in relation to the ground when viewed from the front or rear. Negative camber is when the wheels lean inward and positive camber is when the wheels lean outward. Usually adding a small amount of negative camber (0° to -2°) will increase traction. However, adding too much camber will decrease traction. The objective is to keep as much of the tire as possible in contact with the running surface. Never put in positive camber. Make sure that both sides are equal.



Use the DuraTrax Pit Tech™ Camber Gauge (DTXR1145) to accurately set up your Vendetta SC.

CASTER

The Vendetta SC has adjustable caster. Caster refers to the fore/aft angle of suspension. By placing the adjuster clips behind the front upper arm, you decrease caster angle. This will give more initial turn-in but decrease on-power steering and straight-line stability.

Placing the adjuster clips in front of the front upper arm increases the caster. This will increase on-power steering and straight-line stability, but reduce initial turn-in.

MAINTENANCE GUIDE

The following section is provided to help you with maintenance and repairs to your Vendetta SC.

1

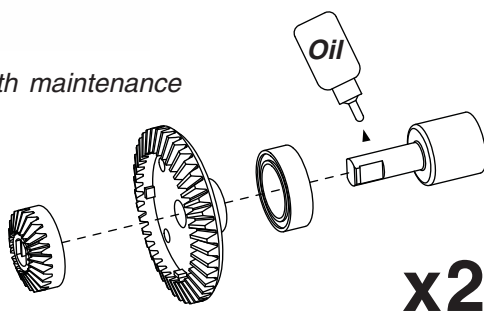
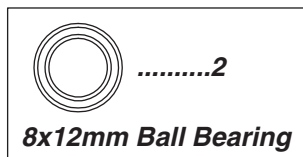

2

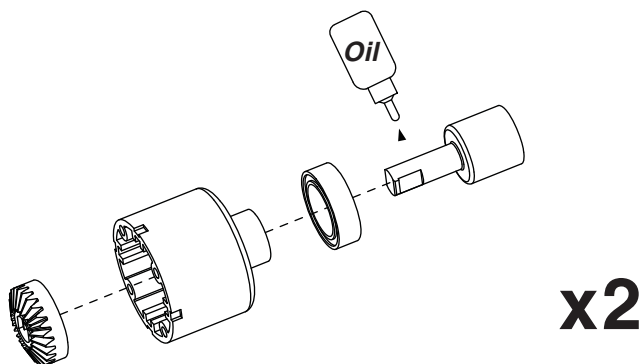
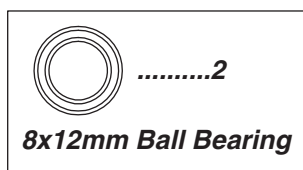

3

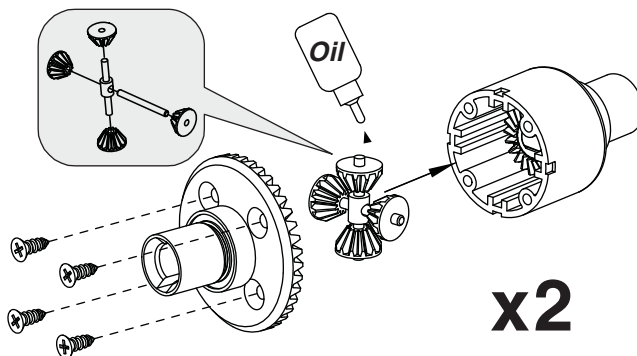
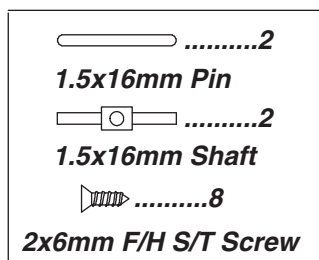

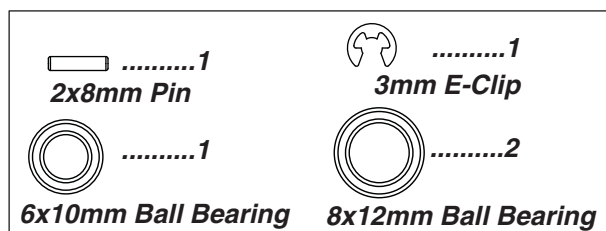
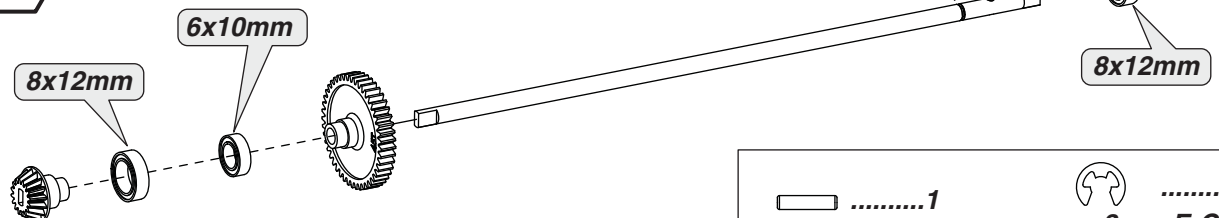

4

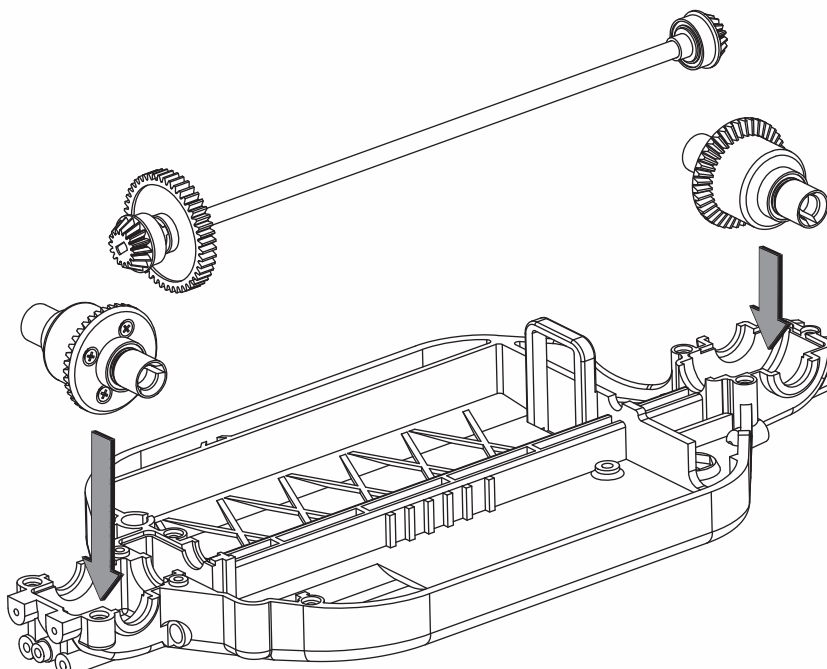

5



6

- 1
2.6x12mm S/T Screw
- 4
2.6x8mm S/T Screw

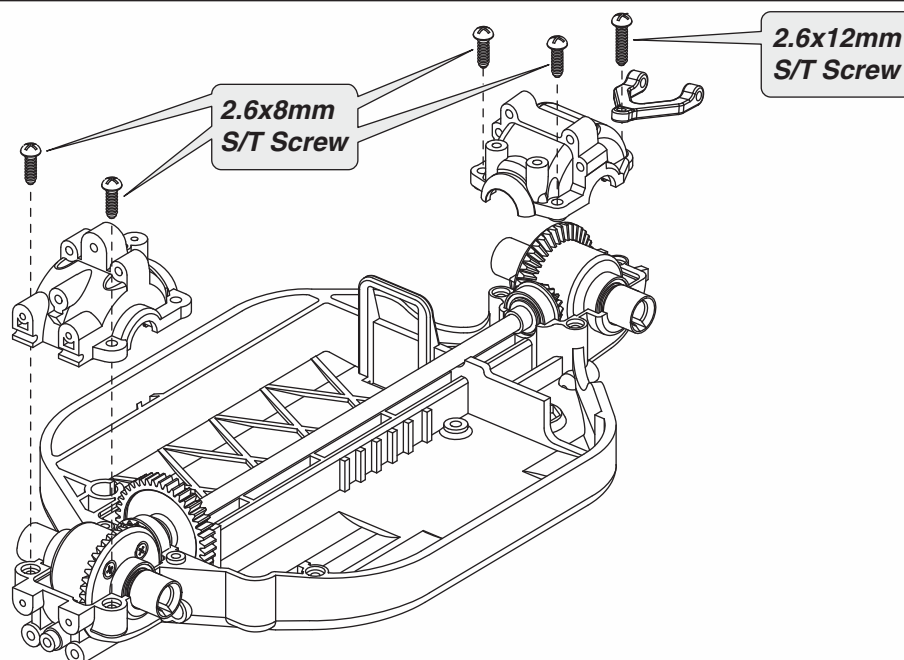

7

- 2
2.6x6mm Screw

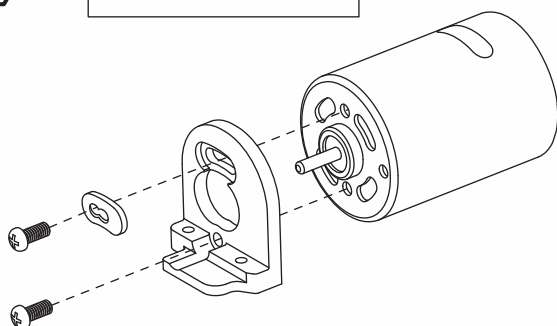

8

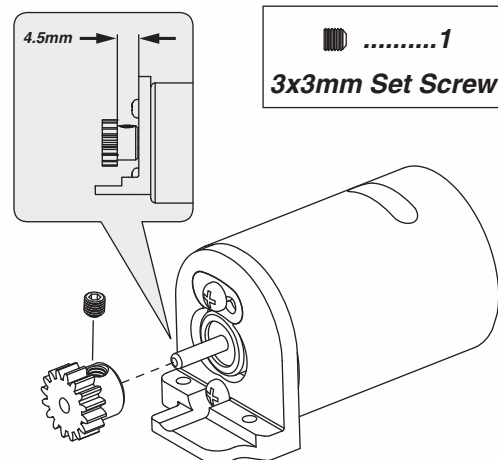

9



2.6x6mm Screw

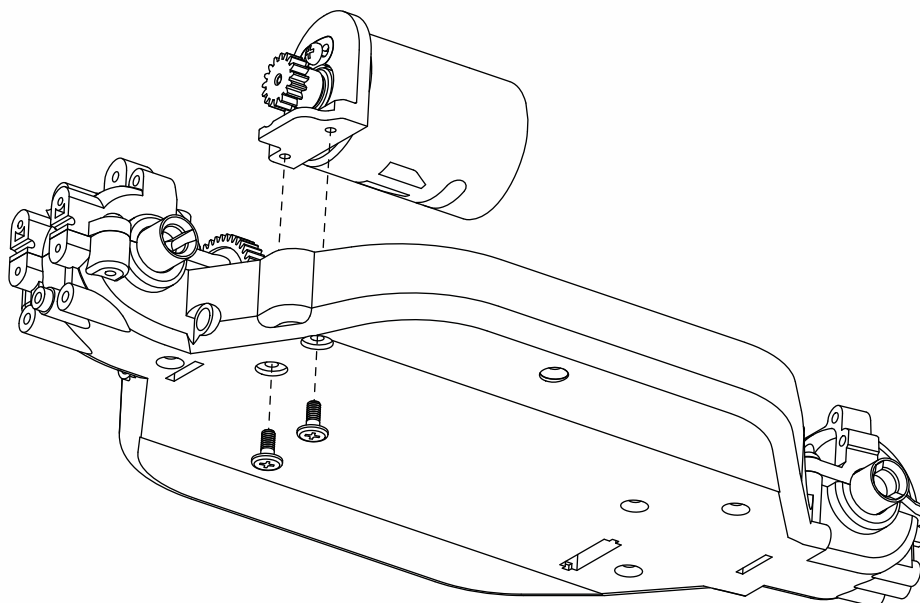

10



2.6x8mm S/T Screw



2.6x12mm S/T Screw

2.6x12mm
S/T Screw

2.6x8mm
S/T Screw

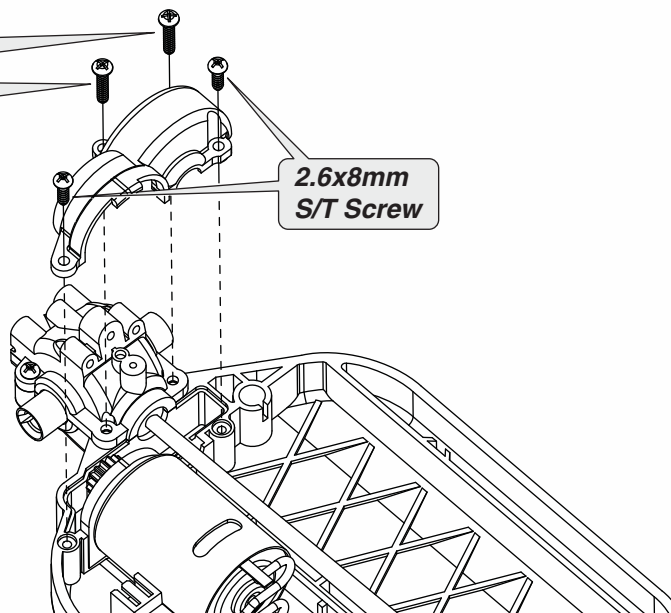

11



2.6x10mm
F/H S/T Screw



2.6x8mm F/H Screw

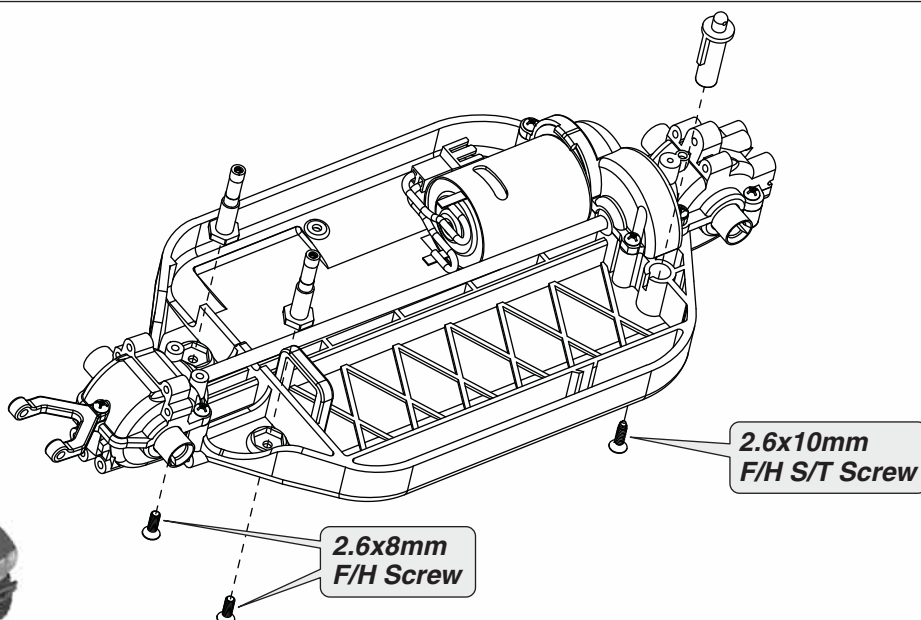

2.6x10mm
F/H S/T Screw

2.6x8mm
F/H Screw



12



.....3
3.8mm Ball Stud

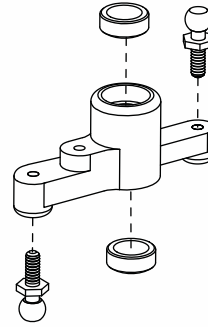
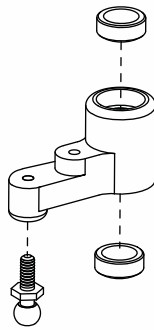

13



.....2
3x25mm
Threaded Shaft

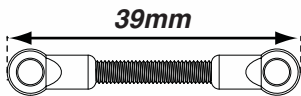
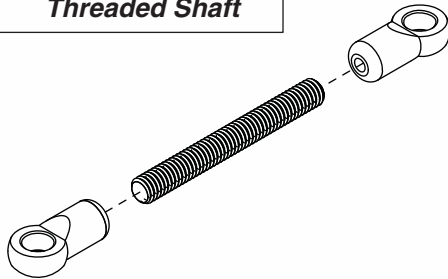

x2

14



.....2
2x6mm S/T Screw

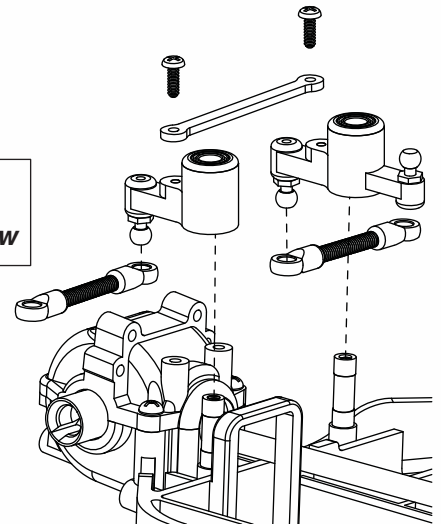

15



.....2
2.6x6mm Screw

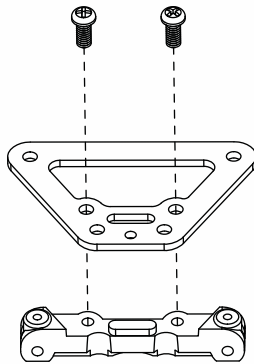

16



.....4
2.6x8mm Screw

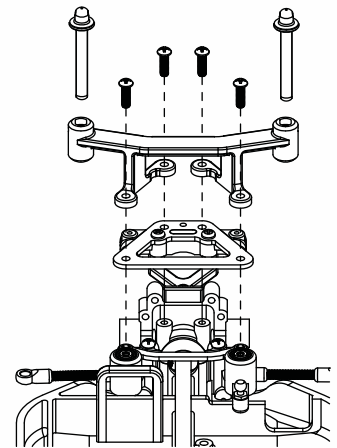

17

.....2
Body Clip

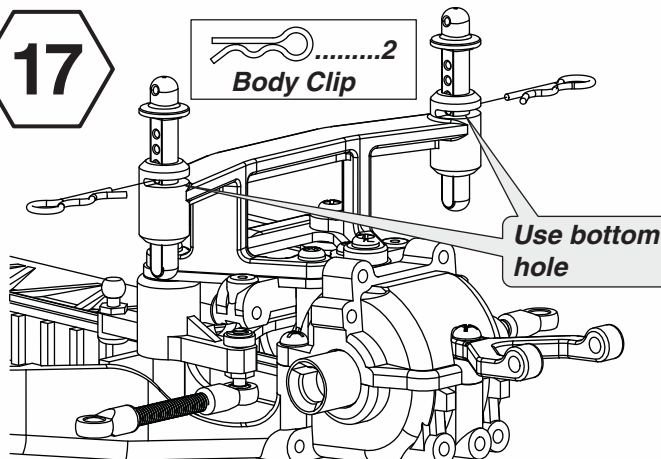

18

.....2
2x16mm Socket
Head Cap Screw

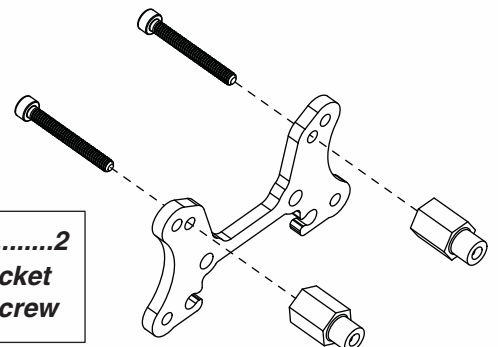

19



.....4
2.6x8mm S/T Screw



.....2
2.6x10mm F/H S/T Screw

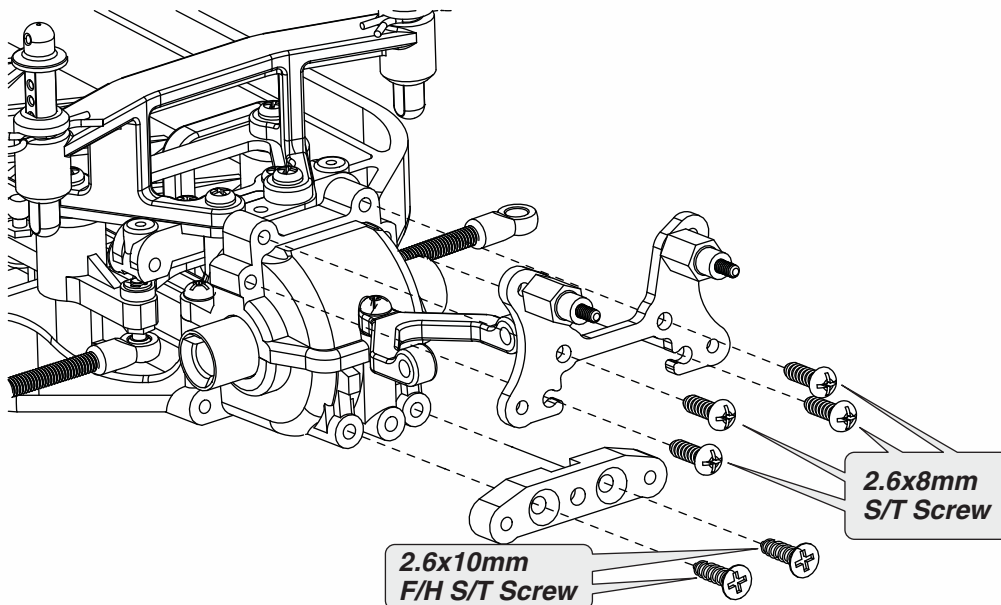

20

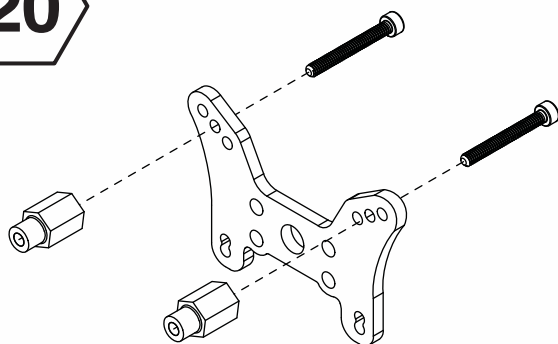

.....2
2x16mm Socket
Head Cap Screw

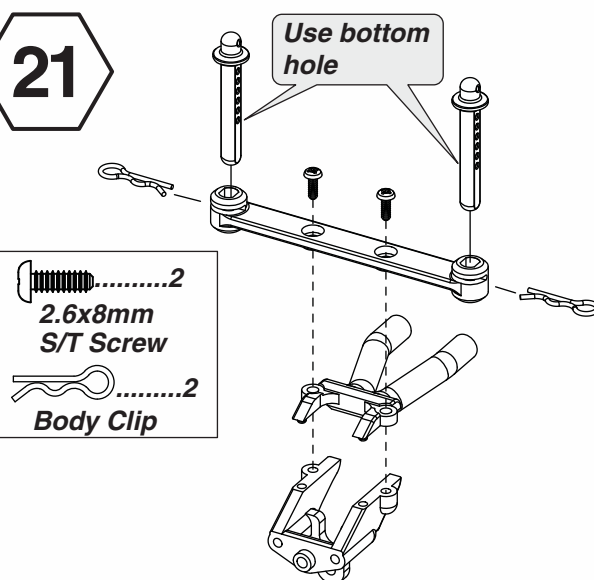

21

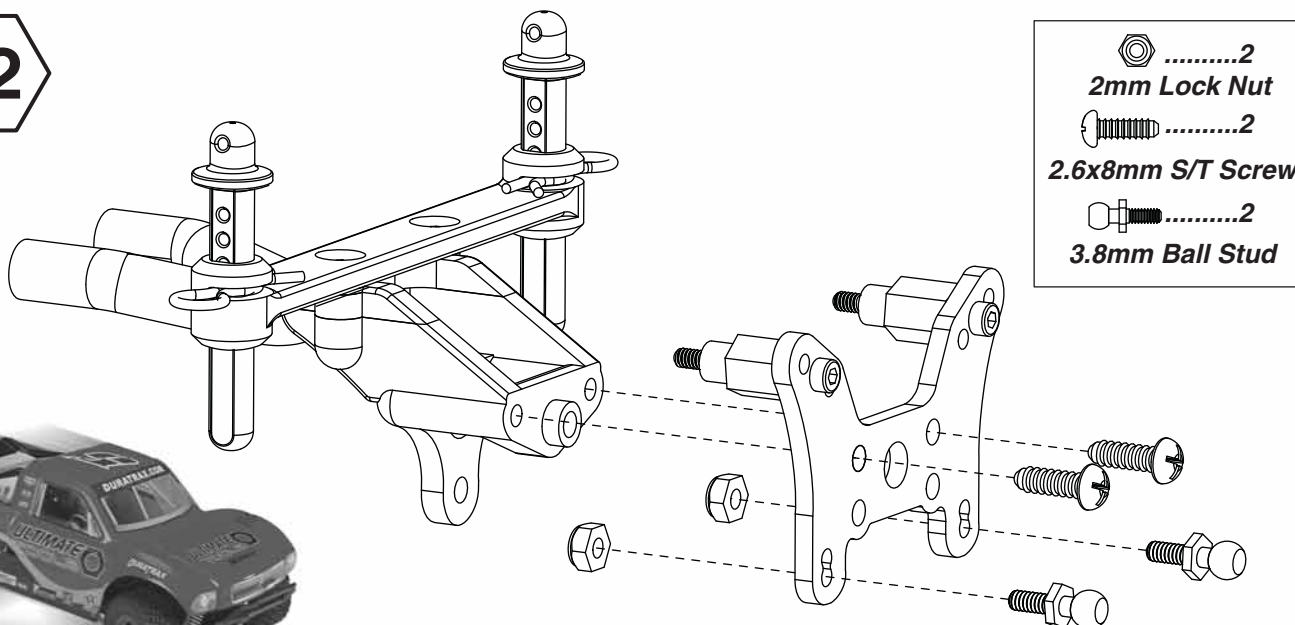

22



23

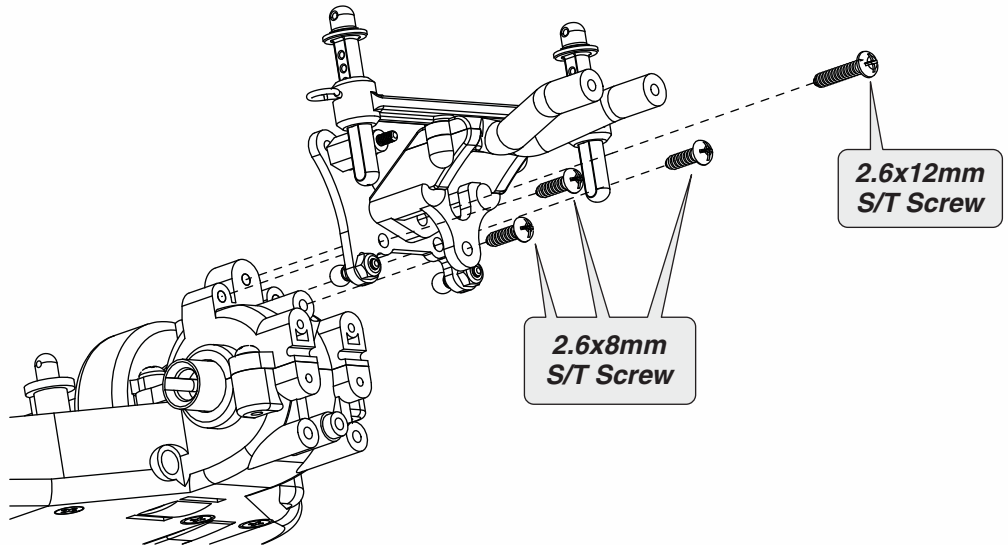

- 3
2.6x8mm S/T Screw
- 1
2.6x12mm S/T Screw

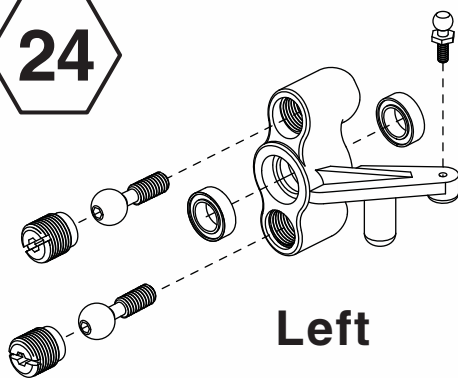

24

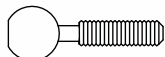

Left

- 4
Pivot Ball Retainer
- 2
3.8mm Ball Stud
- 4
6x10mm Ball Bearing
- 4
Front Knuckle Pivot Ball

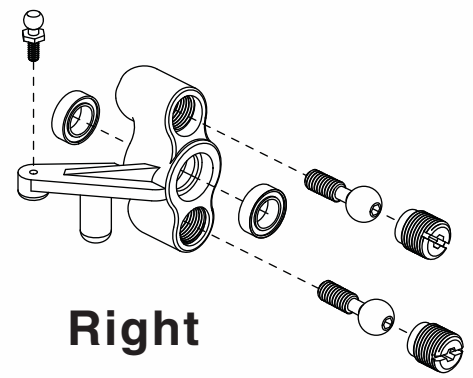

Right

25

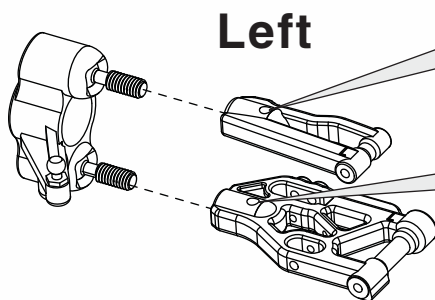

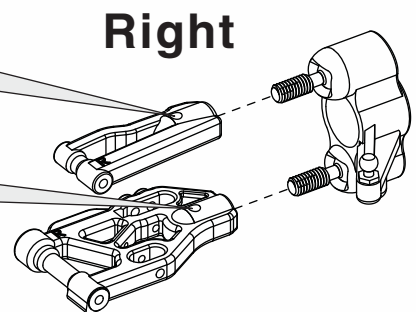
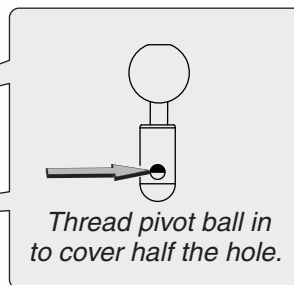

Left



Right

26

- 4
2x8mm Shaft Pin
- 4
1.5x5.8mm Axle Pin

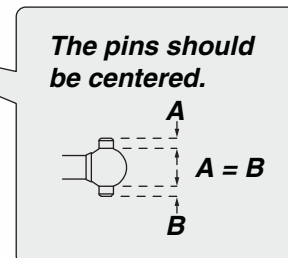
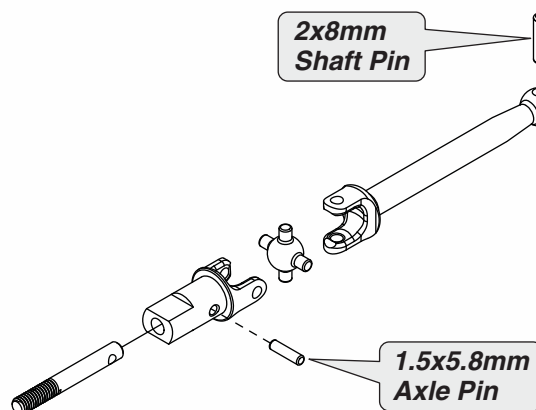

x4

27

Right

Left

2x26.5mm Hinge Pin.....2

2x37.5mm Hinge Pin....2

.....2

2.6x8mm Screw

.....1

2.6x10mm F/H S/T Screw

2x26.5mm
Hinge Pin

2.6x8mm
S/T Screw

2.6x10mm
F/H S/T Screw

2x37.5mm
Hinge Pin

28

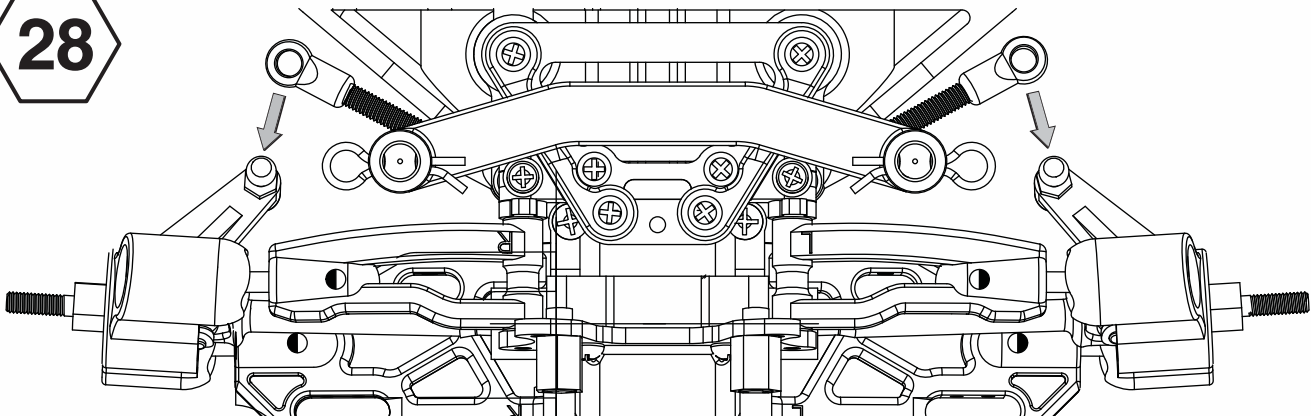

29

.....2

2x6mm S/T Screw

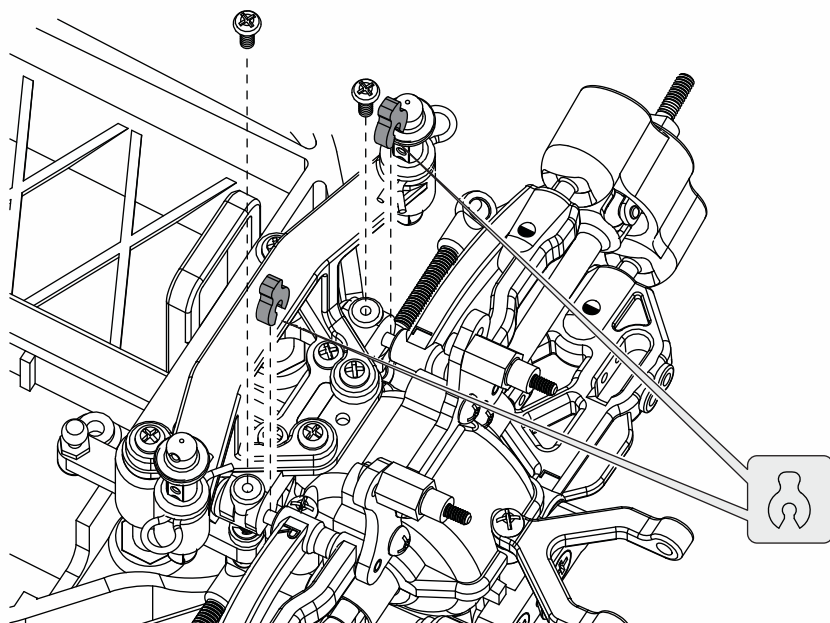

30

2
3x20mm Threaded Shaft

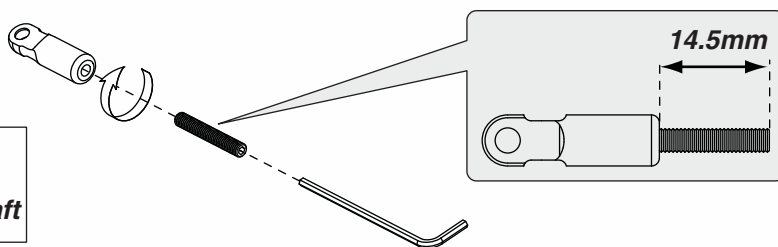

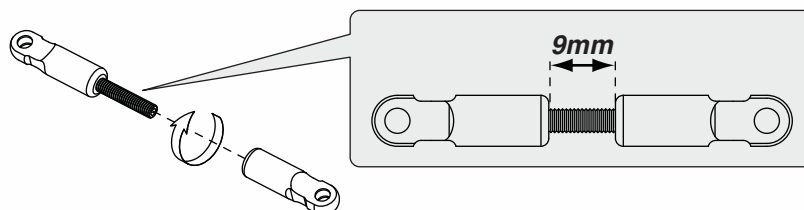

x2

31



x2

32

2
2x12mm R/H Screw
4
6x10mm Ball Bearing
2
2x26.5mm Hinge Pin.....2

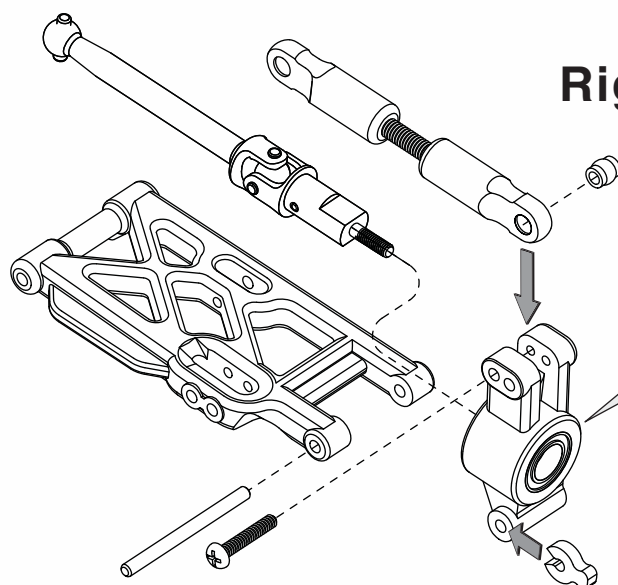

Right

Left

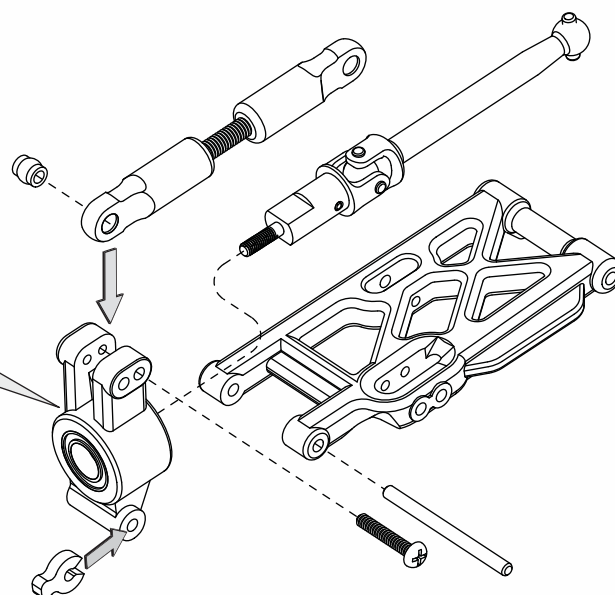
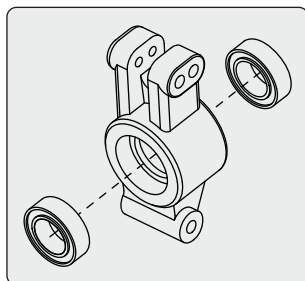



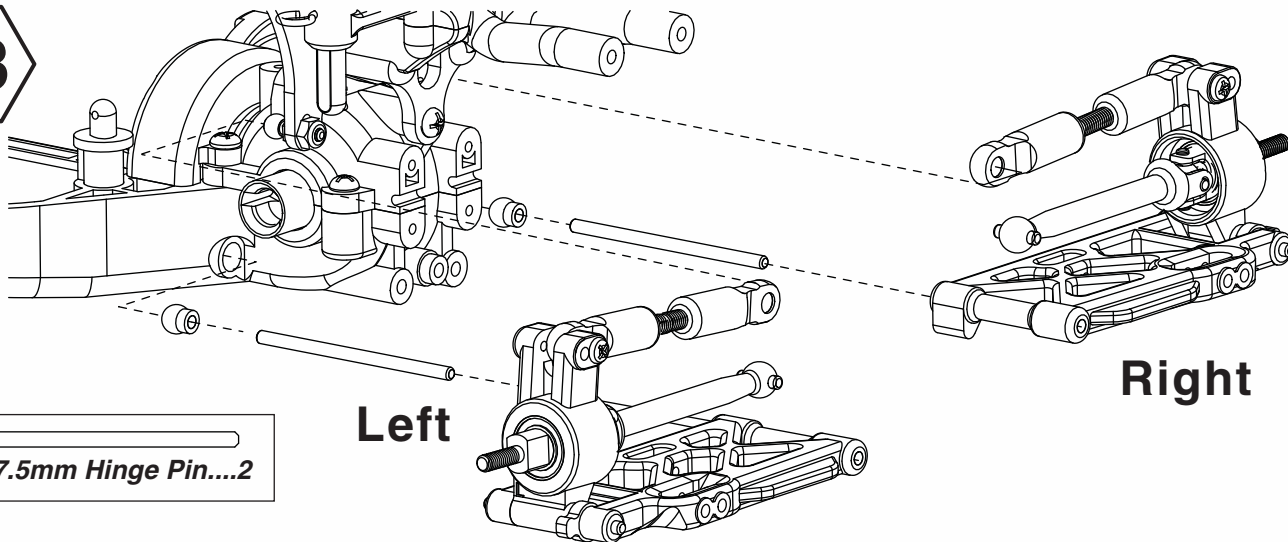

33



2x37.5mm Hinge Pin....2

34

- 4
2.6x6mm Screw
- 4
2x6mm S/T Screw
- 4
2.6x8mm S/T Screw
- 3
2.6x10mm F/H S/T Screw

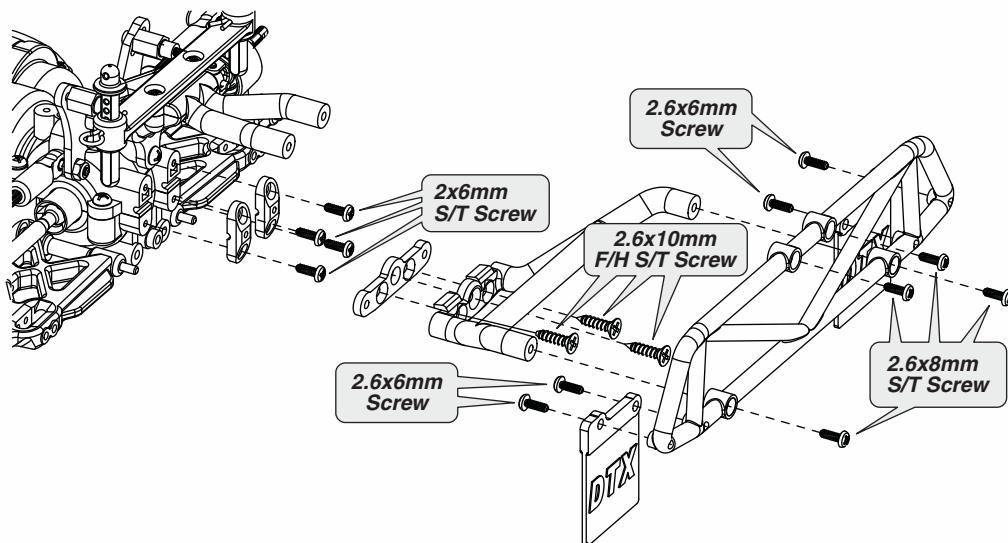

35

- 8
O-Ring
- 8
1.5mm E-Clip

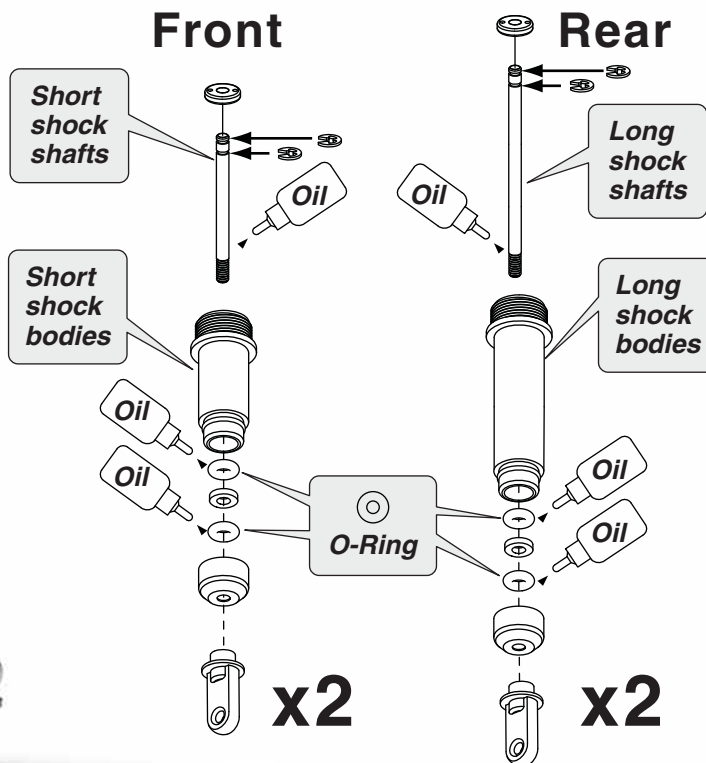

36

Slowly move the shaft up and down to remove trapped air bubbles

x4

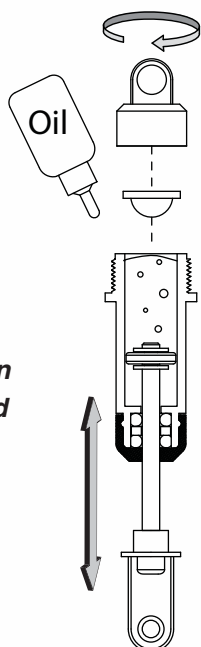

37

Front

Rear

Short springs

Long springs

x2

x2

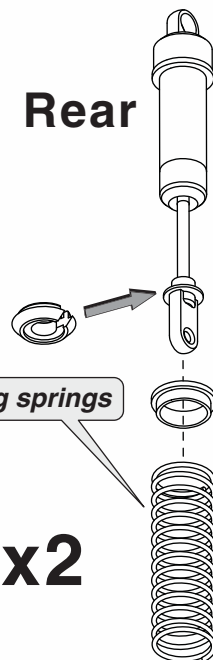
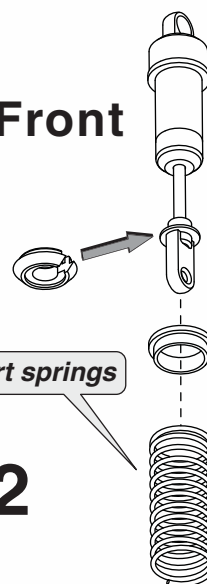

38

Rear

.....4
2x12mm Screw
.....4
2mm Lock Nut

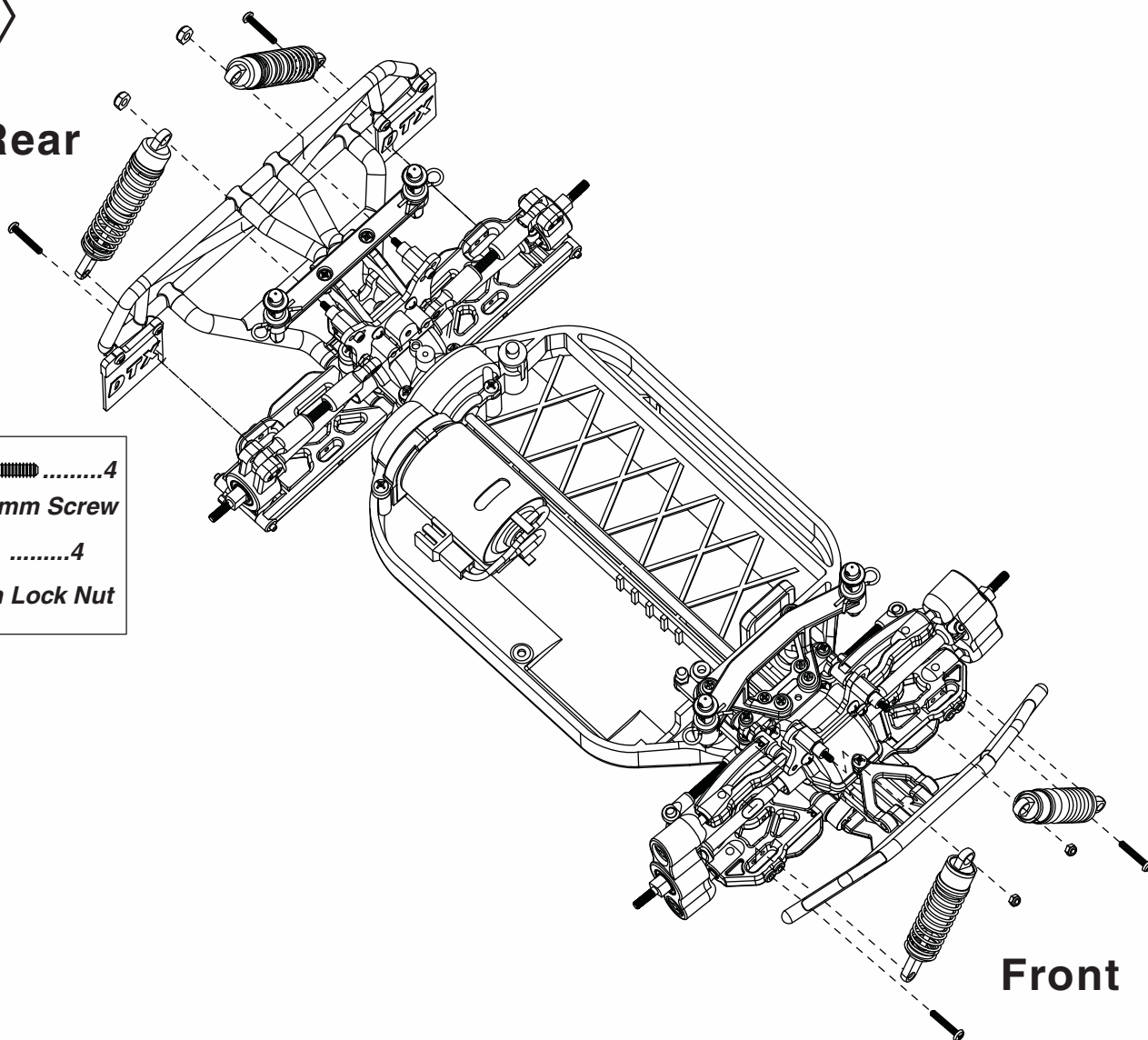

Front

39

-1
3.8mm Ball Stud
- 2.6x12mm R/H Screw

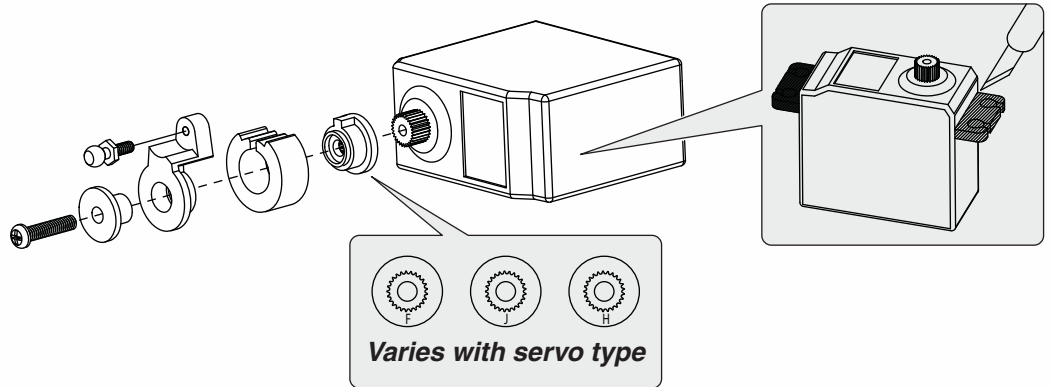

40

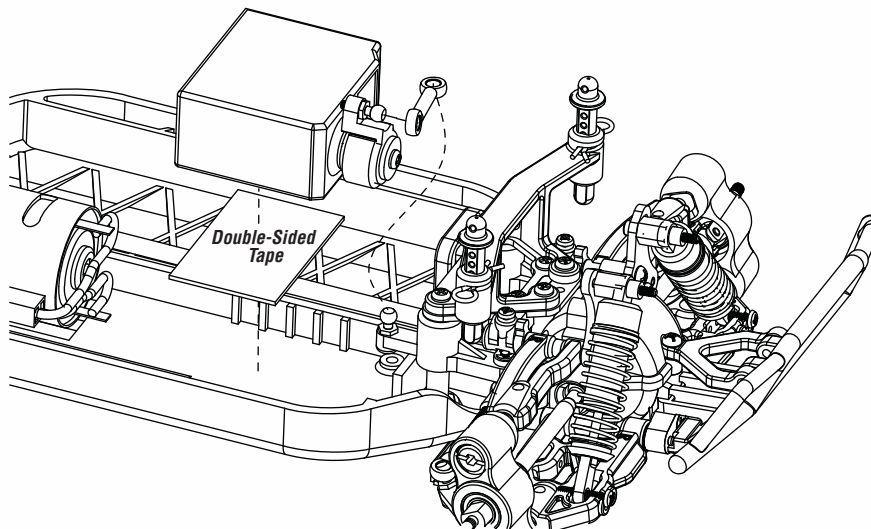

41

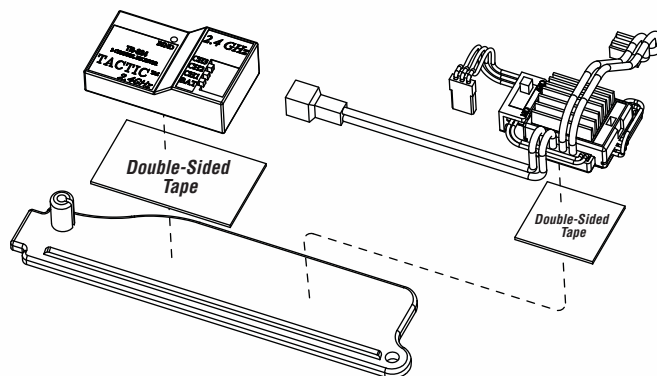

42

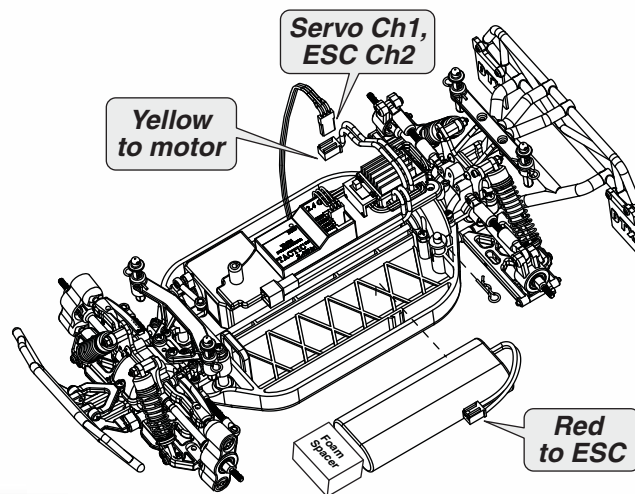

43

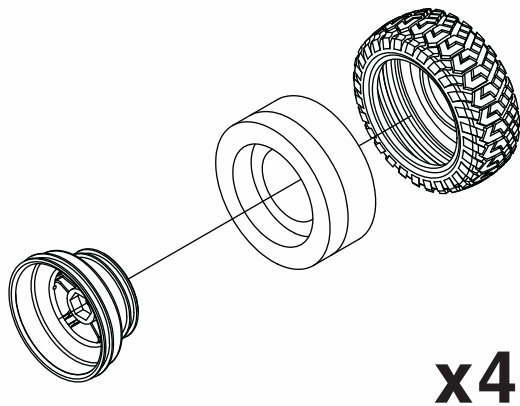

44

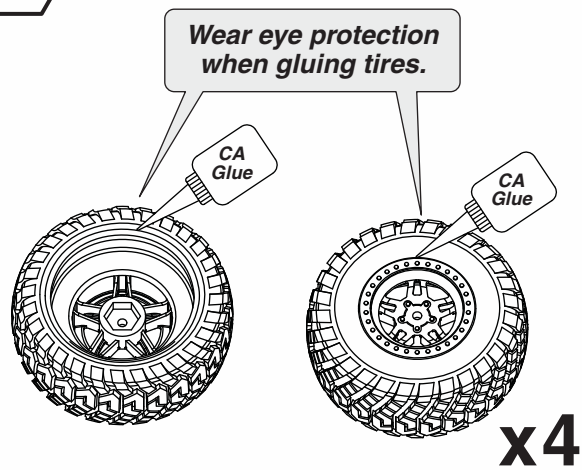

45

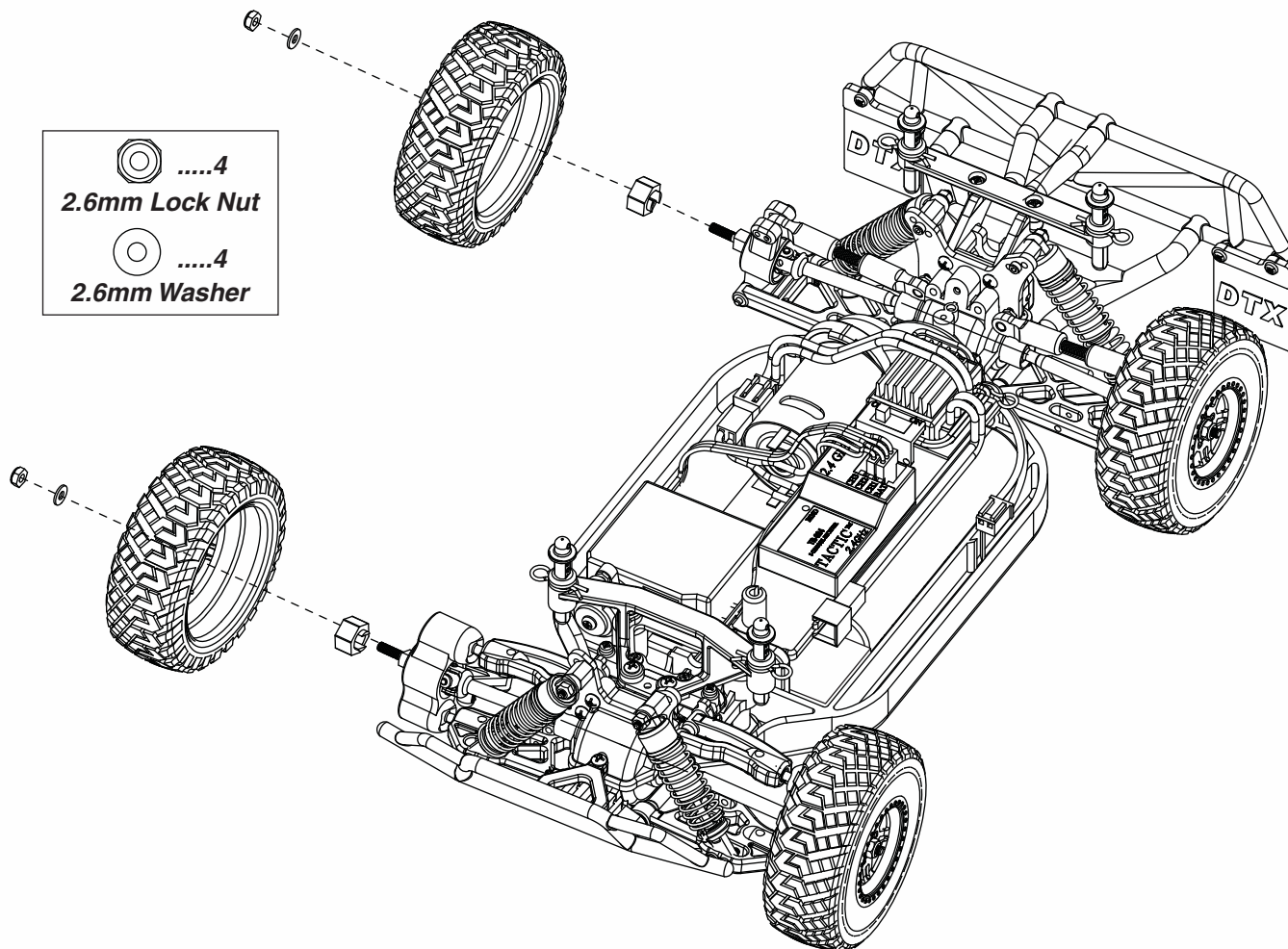

OTHER ITEMS AVAILABLE FOR THE VENDETTA SC

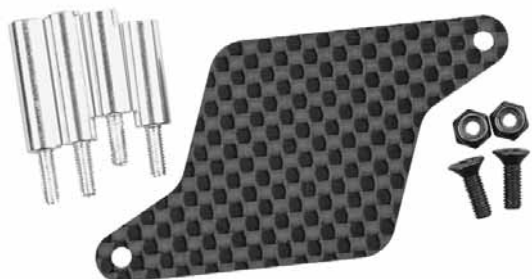

Graphite Steering Servo Hold-Down Set
DTXC8813



Aluminum Motor Heat Sink (Blue)
DTXC8279



Ball Differential
DTXC7348



Graphite Front Brace
DTXC6599



Front Sway Bar Set
DTXC9602



Aluminum Rear Hub (Blue)
DTXC8005



Aluminum Hinge Pin Support Front
DTXC8066

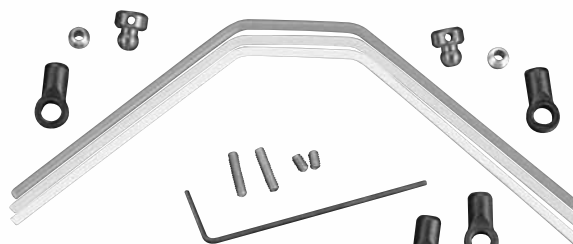

Rear Sway Bar Set
DTXC9603



For more optional parts and accessories, contact your hobby dealer or duratrax.com



6-cell 1600 mAh NiMH Battery
DTXC2193



Onyx 220 Programmable
Peak Charger
DTXP4220



Graphite Front Shock Tower
DTXC9186



Graphite Rear Shock Tower
DTXC9187



Aluminum Shocks
DTXC8997 Front
DTXC8998 Rear

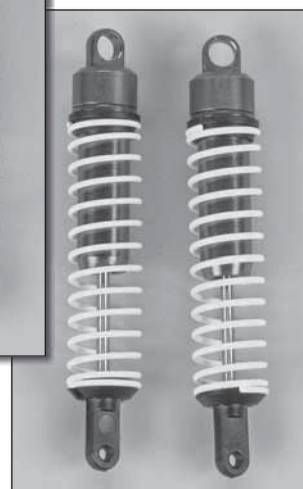

Pit-Tech Mini Car Stand
DTXC2361



DURATRAX®