

WARRANTY

Crosley Radio Products are warranted against defects in material and workmanship for a period of 90 days beginning from the date of sale to the original purchaser.

Should the unit fail under normal usage during the 90 day warranty period, a request for RETURN AUTHORIZATION (R.A.) must be made by the original customer before returning the unit. Call Crosley Radio customer service for Return Authorization at (502) 583-4246 from 9 AM to 5 PM (EST) Monday to Friday.

Upon receiving the RETURN AUTHORIZATION number from the Customer Service Department, properly pack your unit in its original packaging. Include any adapters, parts, & accessories which were originally provided with the product, along with a check or money order for \$19.95 made out to Crosley Radio to cover the handling and return postage. Display the R.A. # on the outside of the carton and ship PREPAID via standard UPS or its equivalent.



ATTN: RETURNS DEPT
2001 PRODUCTION DRIVE
BAY 2 & 3
LOUISVILLE, KY 40299

CROSLEY RADIO assumes no responsibility for units sent without prior Return Authorization.

The purchaser's bill of sale is the only proof of warranty entitlement and must accompany the unit.

The warranty does not cover damage due to acts of nature, accident, misuse, abuse, negligence, commercial use or modification of, or to any part of the product. This warranty does not cover damage due to improper operation or maintenance, connection to improper voltage supply, or attempted repair by anyone other than a facility authorized by Crosley Radio to service the product. This warranty does not cover products sold AS IS or consumables (such as fuses or batteries). This warranty is valid only in the United States.

This warranty gives the purchaser specified legal rights in addition to any rights which may vary from state to state.

In accordance with the "Moss-Magnuson Warranty Act" of July 10, 1975, this is termed a "limited warranty" which in no way compromises Crosley Radio, high standards of Quality and Workmanship.

CROSLEY

ST 73

Richmond Entertainment Center Cabinet

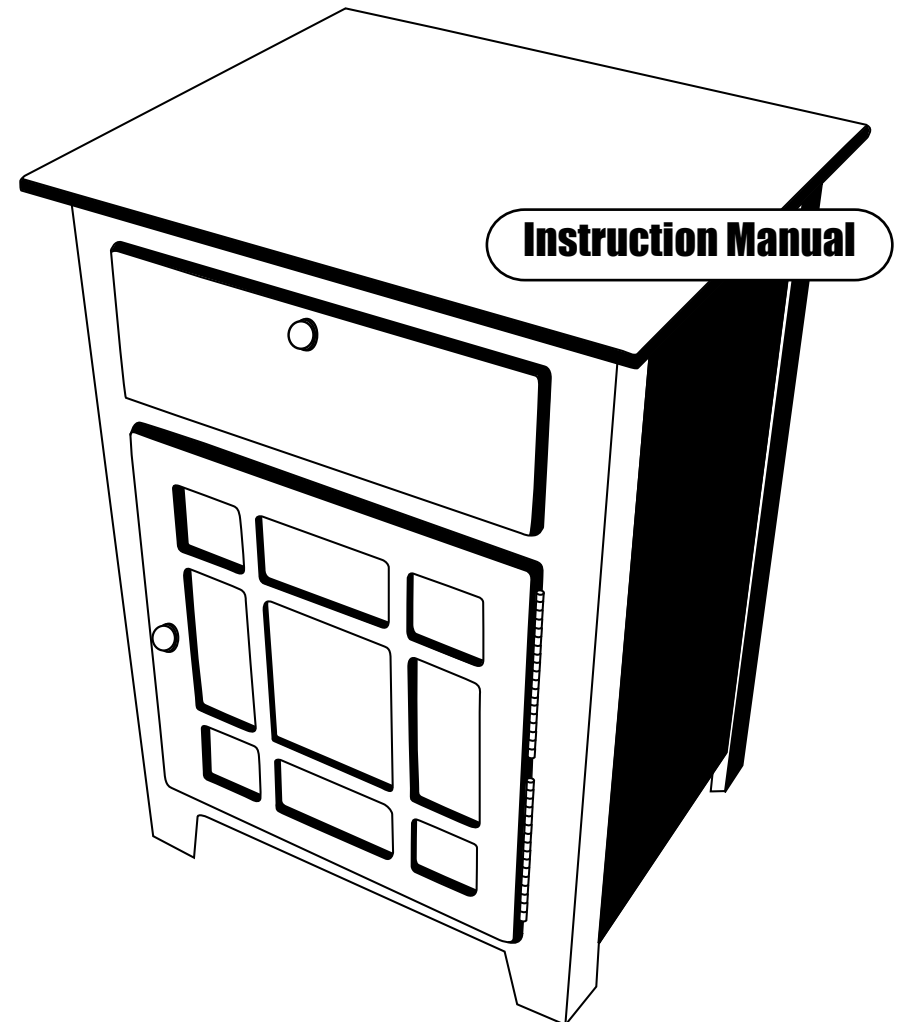

Assembly Instruction

Diagram G

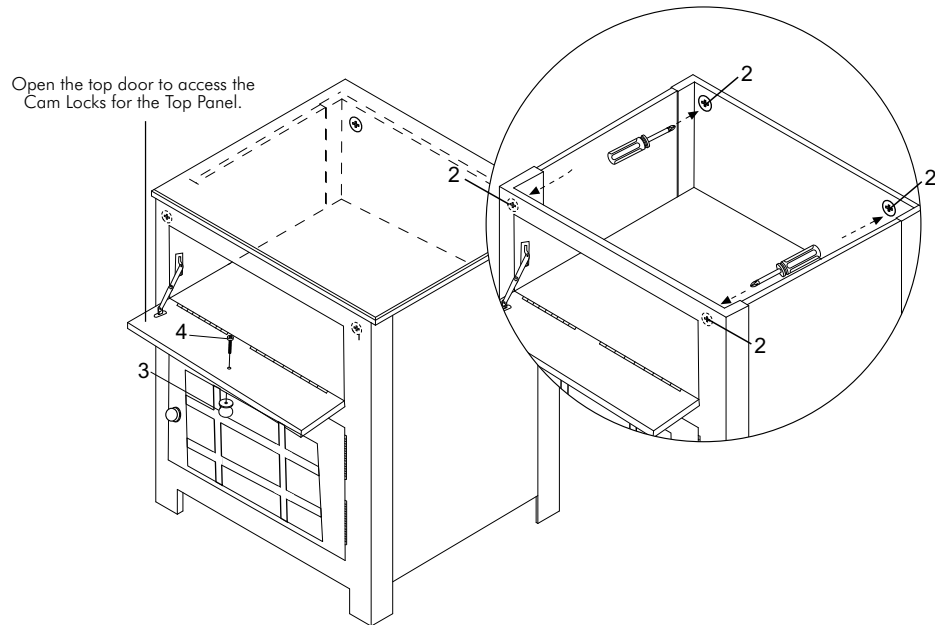
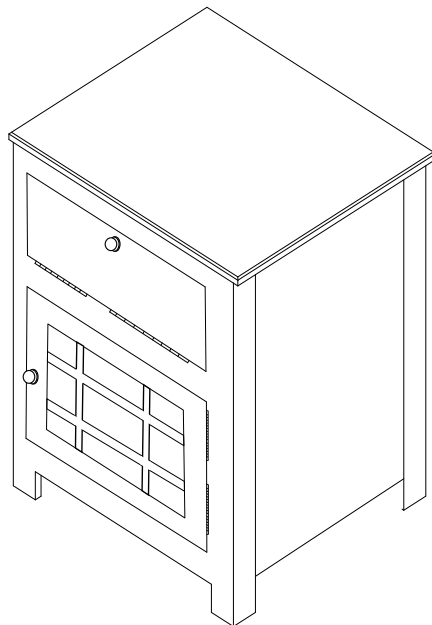

Diagram H

Finished Stand Assembly



Assembly Instruction

Diagram A

Top Panel

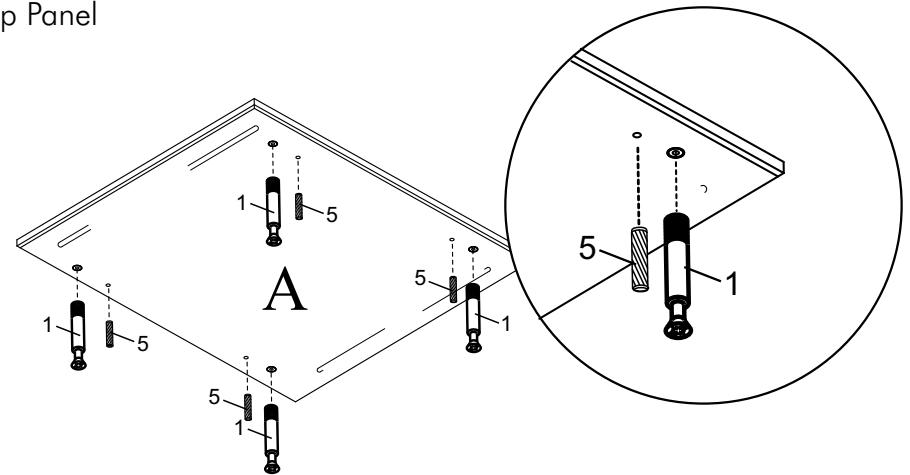
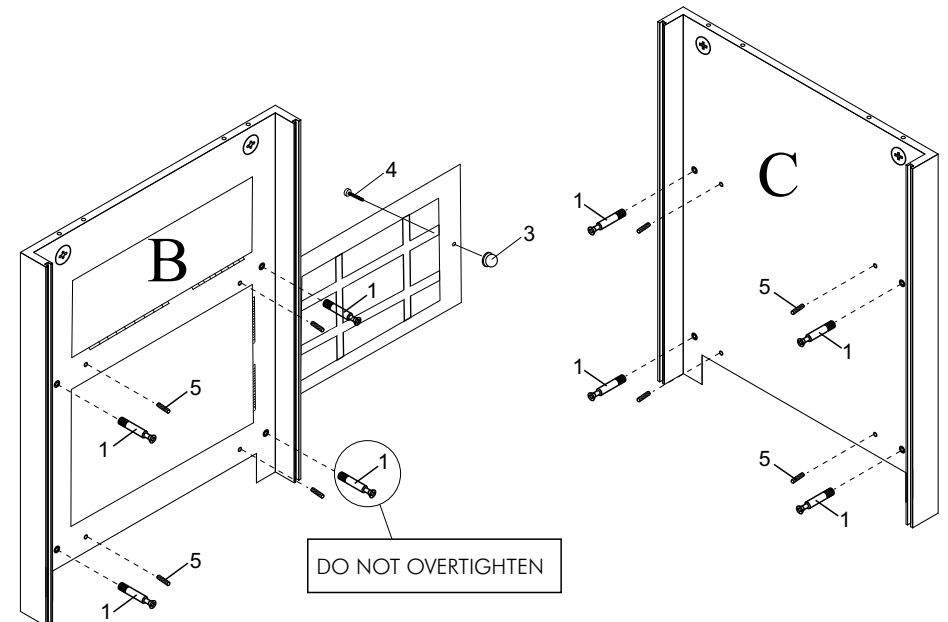

Diagram B

Front & Back Panel



Getting Started

Tools Required

#2 Phillips head screwdriver

Assembly Instructions

1. Screw 4 Cam Bolts (01) into the outer bolt holes of the Top Panel (A). See Diagram A.
2. Insert 4 Wood Dowels (05) into the inner holes of the Top Panel (A). See Diagram A.
3. Screw 4 Cam Bolts (01) into the outer bolt holes of the Front Panel (B) and the Back Panel (C).
4. Insert 4 Wood Dowels (05) into the inner holes of the Front Panel (B) and the Back Panel (C)
5. Attach the Middle Panels (D) to the Front Panel (B). The Cam Locks should be facing towards the bottom of the stand. Using a #2 Phillips head screwdriver, turn the Cam Locks clockwise until they are tight. See Diagram D.
6. Attach the Back Panel (C). Turn the Cam Locks clockwise until they are tight. See Diagram D.
7. Slide the Side Panels (E) into the slots between the Front Panel (B) and the Back Panel (C) from the top of the stand. See Diagram E.
8. Attach the Top Wooden Board (A) to the top of Wooden Front Panel (B) and Wooden Back Panel (C). Turn the Cam Locks clockwise until tight. See Diagram G.
9. Install the Brass Knobs (03) onto the Door and the Drawer Front using the supplied Machine Screw (04). See Diagrams B & G.

PARTS LIST					
PART	DESCRIPTION	QTY	PART	DESCRIPTION	QTY
A	TOP PANEL	1PCS	01	CAM BOLTS	12PCS
B	FRONT PANEL	1PCS	02	CAM LOCKS	12PCS
C	BACK PANEL	1PCS	03	BRASS KNOB	2PCS
D	MIDDLE PANEL	2PCS	04	SCREW	2PCS
E	SIDE PANEL	2PCS	05	WOOD DOWEL	12PCS

Full Assembly Diagram

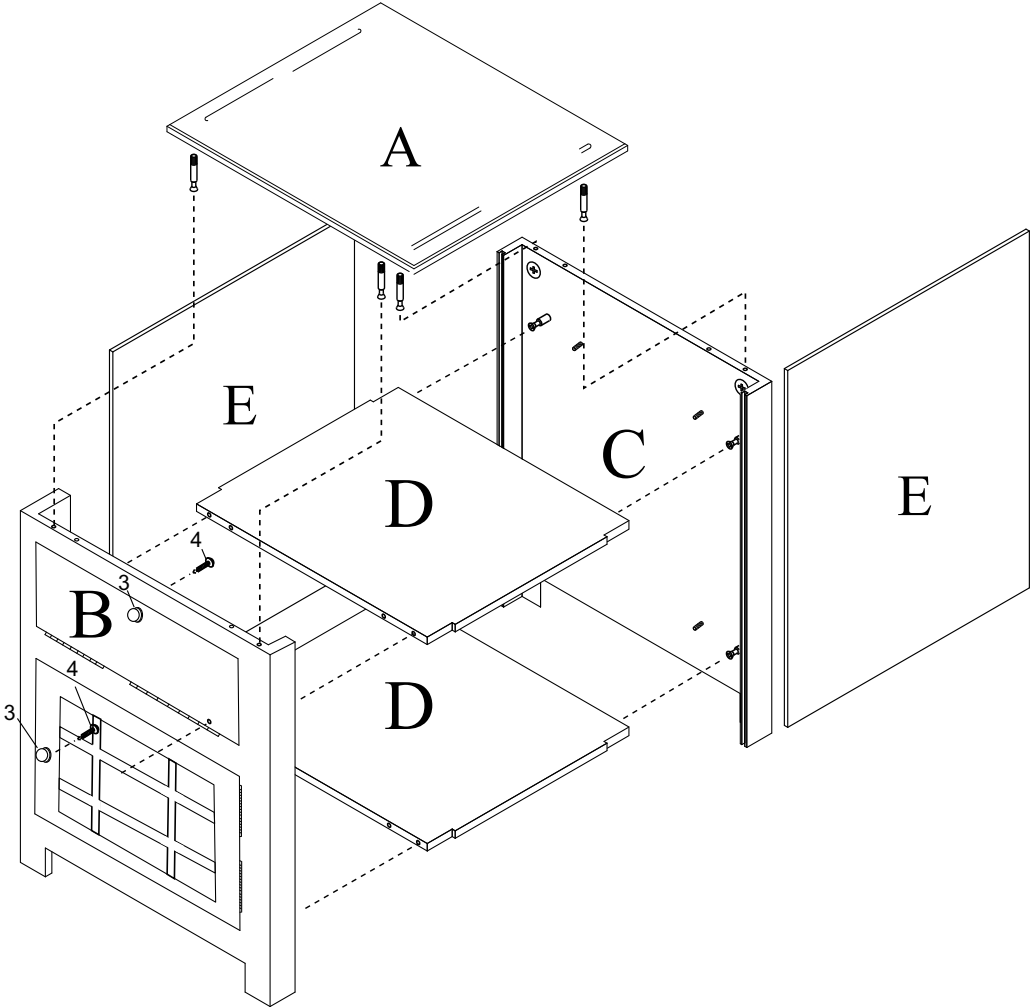

Assembly Instruction

Diagram C

Middle Panel

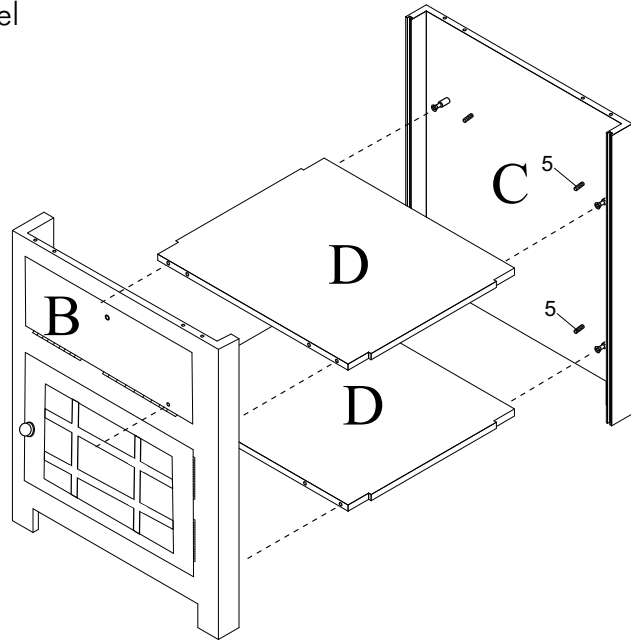
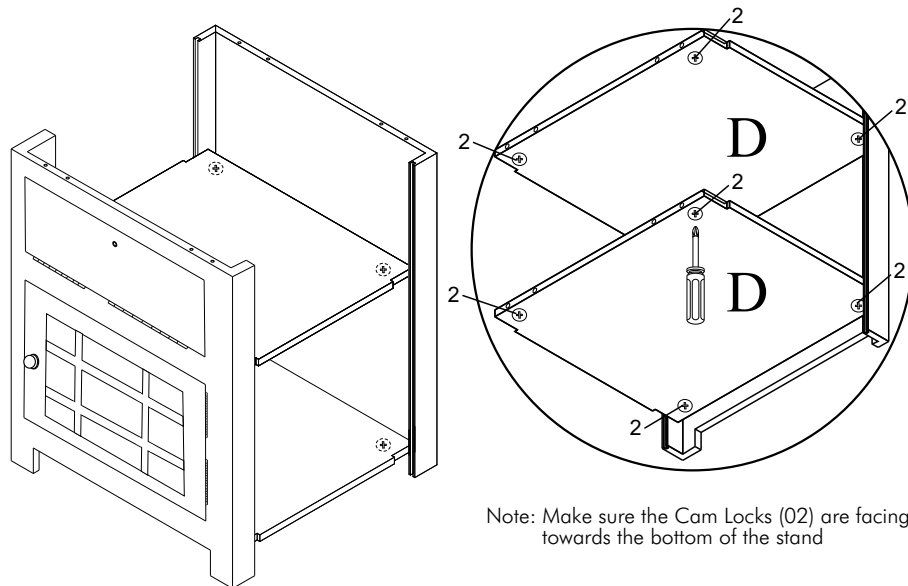

Diagram D



Note: Make sure the Cam Locks (02) are facing towards the bottom of the stand

Assembly Instruction

Diagram E

Side Panels

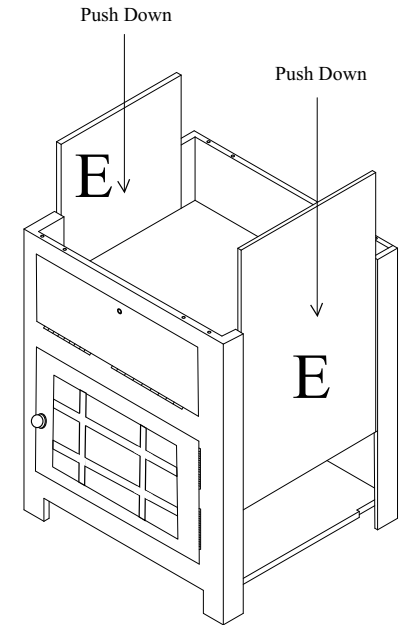

Diagram F

Top Panel

