

REVERSING THE DOOR OPENING

Your dryer is fitted with a reversible door. To change the direction of opening proceed as follows for your type of door.

Dryers fitted with hinge cover :-

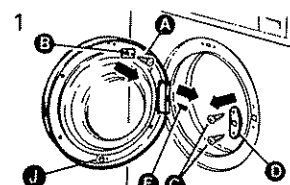

Open the door. Undo screw (A) remove switch strike (B) and replace screw. Undo screw (J) and remove buffer. Remove screws (C) and latch plate (D). Remove hinge cover screw (E). Close the door.

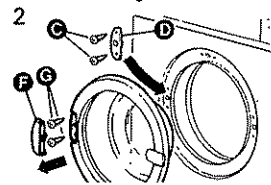

Pull the hinge cover (F) forwards to remove it. Remove two outer screws (G). Remove door. Fit latch plate (D) with screws (C)

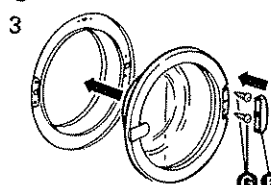

Reverse door and fit to dryer in closed position. Refit screws (G) and hinge cover (F). Open the door.

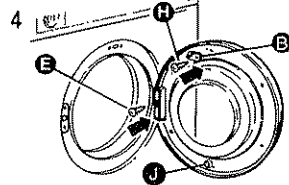

Fit screw (E) to secure hinge cover. Remove screw (H) at top of door and refit switch strike (B) as shown. Refit buffer (J).

Dryers fitted without hinge cover :-

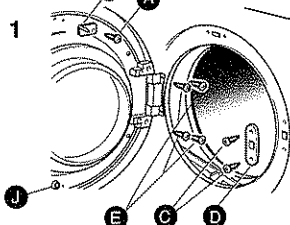

Open the door. Undo screw (A) remove switch strike (B) and replace screw. Undo screw (J) and remove buffer. Remove screws (C) and latch plate (D). Remove hinge block screw (E). Remove door from hinge blocks.

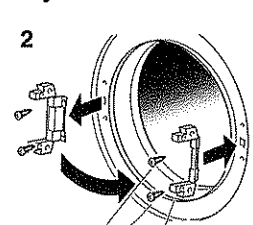

Remove hinge screws (F) and hinge (G) and refit to opposite side as shown.

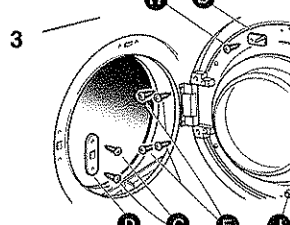

Refit latch plate (D) with screws (C). Remove screw (H) at top of door and re fit switch strike (B) as shown. Refit buffer (J). Fit door to hinge blocks and secure with screws (E)

INSTRUCTIONS FOR USE

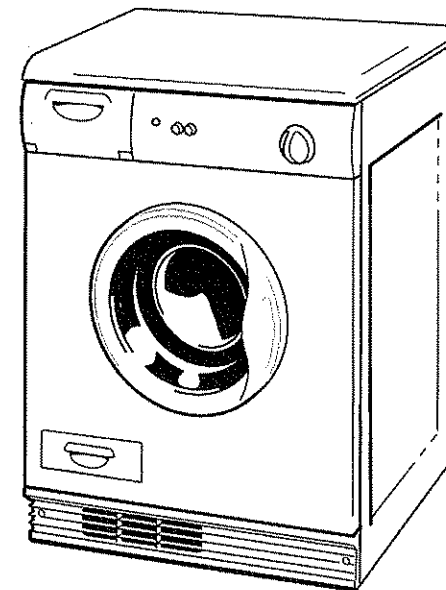

CD7N

GB

IMPORTANT:

PLEASE READ THESE INSTRUCTIONS THOROUGHLY BEFORE USING THIS APPLIANCE. KEEP THEM IN A SAFE PLACE FOR FUTURE REFERENCE.

THE CONDENSER

CLEANING THE CONDENSER

- CAUTION: For maximum efficiency, the plates are made from very thin aluminium and are easily damaged. Do not try to poke anything between the plates or use a hard object or tool for cleaning. At all times, handle the condenser carefully and avoid crushing the plates.
- Remove the condenser (see opposite).
- Flush the fluff from between the plates under running water and carefully shake off excess water.



- Whilst the condenser is removed, clean as much fluff as possible from inside the ducting by reaching a hand into the machine. In particular, keep the passage from the fan clear (on the right hand side of the condenser duct).
- After cleaning, re-install the condenser (see opposite).

RE-INSTALLING THE CONDENSER

- Carefully push the condenser back into the machine, until it is pushed fully home and a "click" is heard.
- Ensure all lint and fluff is removed from around the grille seal before closing or water may leak.
- IMPORTANT: The dryer may leak if the condenser is not correctly re-installed.

REMOVING THE CONDENSER

NOTE: The condenser will discolour through use.

The condenser and ducting should be cleaned monthly or more frequently if the dryer is in constant use. See "CLEANING THE CONDENSER" opposite.

IMPORTANT USER INFORMATION

These notes are provided in the interest of safety. You must read them before installing or using the appliance.

- This tumble dryer is intended for **NORMAL DOMESTIC USE ONLY**.
- Please note it is not recommended that the dryer is placed directly next to ovens or cookers as the performance of the dryer may be affected.
- A carpet must not obstruct the ventilation openings in the base of the dryer.
- Do not stack the tumble dryer on top of other appliances without the correct stacking kit.
- Any electrical work required to install the appliance should be carried out by a qualified person.
- It is important to clean the lint filter after each drying cycle and the condenser every three or four months or the restrictions to airflow will extend drying times and could cause the safety cut-out to trip.
- Under no circumstances should anything other than the recommended articles be placed in the tumble dryer.
- The tumble dryer should be serviced by an appointed service organisation and only genuine parts used.
- It is dangerous to alter or modify the product in any way other than fitting authorised accessories.
- We recommend that the appliance is unplugged each time after use. It should always be disconnected from the electricity supply if it is to be left unattended for long periods (i.e. weekends, holidays etc.)
- The rear of the dryer gets quite hot during use. Position the dryer so that the back is not accessible while in operation.
- The special mains cable and plug assembly must only be replaced with a genuine part from the manufacturer or his service agent.
- It is important to clean fluff from the window of the dryer and around the door seal after each drying cycle. Failure to do so could result in water leaking.
- This appliance is not intended for use by persons (including children) with reduced physical, sensory or mental capabilities, or lack of experience and knowledge, unless they have been given supervision or instruction concerning use of the appliance by a person responsible for their safety.
- Children should be supervised to ensure they do not play with the appliance.
- **DO NOT** use a two-way adaptor, or extension lead. The dryer must be connected to its own socket.
- **WARNING:** Never stop a tumble dryer before the end of a drying cycle unless all items are quickly removed and spread out so that heat is dissipated.
- **DO NOT** block the air inlets at the front and back of your dryer.
- **DO NOT** allow fluff to accumulate around the tumble dryer. Risk from fire.
- **DO NOT** exceed the recommended maximum load.
- **DO NOT** dry unwashed items in the tumble dryer.
- **DO NOT** place articles in the dryer if anything other than a water solution has been used in the cleaning process.
- **DO NOT** attempt to dry dripping wet articles.
- **DO NOT** use the tumble dryer if you suspect that it is damaged in any way. Under no circumstances should you attempt to repair the appliance yourself. Repairs carried out by inexperienced persons may cause serious injury. Consult your local appointed service engineer and insist on genuine spare parts.

THIS APPLIANCE MUST BE EARTHED



This label, positioned on the rear of your dryer, indicates the surface is hot when in operation - avoid touching.

INSTALLATION

DRAINAGE OPTIONS

Your dryer is supplied connected to a water bottle, so drained water will collect in the water bottle. If you require your dryer to be connected to a waste pipe, follow the instructions below:-

1. Pull the hose from the valve at the top of the unit.
2. Fit the hose into the waste pipe, ensuring an air gap between the end of the hose, and any water in the pipe.

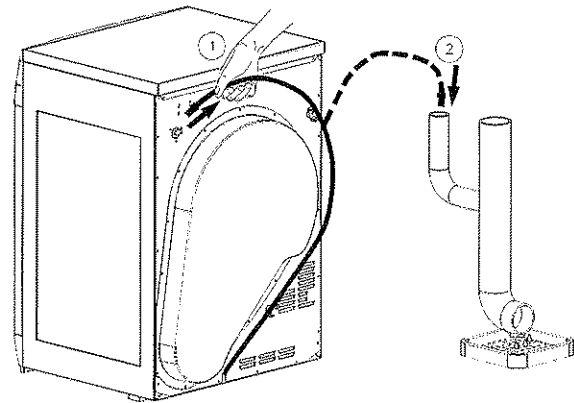

If the hose is not long enough to reach the waste pipe, a drain extension kit can be purchased from your tumble dryer supplier (part number 4213 089 8778)

The illustration shows the minimum space required by the dryer and the position of the waste-pipe within this space and behind the dryer. If a trap is fitted it must not obstruct the air inlet at the back of the dryer.

The waste pipe can be positioned on either side of the dryer.

If the waste pipe is used by both the dryer and a washing machine then its diameter must be large enough to contain both hoses - 1.5" bore (38mm) minimum.

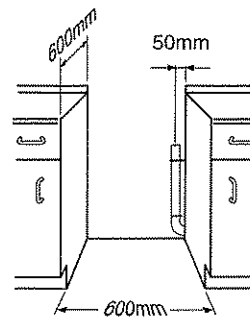

FINAL INSTALLATION

Push the filter into its operating position as shown in the diagram.

If you wish to change the side on which your door opens, see the instructions on the back page.

Remove any dust by wiping the drum and door with a damp cloth. Any initial smell from the heater should disappear after the first period of heating.

Position the tumble dryer so that the plug remains accessible after installation. Do not block the vent at the front of the dryer, as this will impair the working of the machine.

This appliance must not be installed behind a lockable door, sliding door or a door with hinges on the opposite side to that of the tumble dryer.

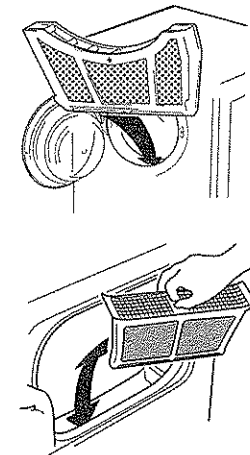

OPERATION

Open the door.

Load clothes loosely into the drum.

Load sheets first, starting with one corner.

Close the door.

Dry your hands.

Check that the timer is in the '0' position.

Plug in the machine.

Select correct heat position (see programme chart on control panel for recommendations). Press start button.

Set the timer to the required time setting (see programme chart on control panel for recommendations). Press start button.

The drum will begin rotating. Reversing drum models will stop every few minutes to rotate in the reverse direction for a short time.

Should the clothes become dry before the cycle has finished, or if an excessive programme time has been selected, the drum will continue to rotate while the thermostat will automatically switch the heater off to prevent over-drying and save energy.

If the door is opened during a cycle the dryer will stop. To restart, close the door, press start button. When drying large items such as sheets, we suggest you periodically stop the dryer to redistribute the load.

There is an automatic 12 minute cool down period at the end of every cycle, during which the heater is switched off. This helps to minimise creasing.

NEVER SWITCH THE DRYER OFF AND LEAVE A HOT LOAD IN THE DRUM.

AFTER REMOVING THE DRIED CLOTHES: ALWAYS CLEAN THE FILTER.

Failure to do so could cause the safety cut-out to operate.

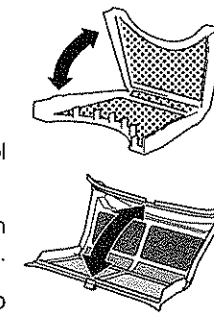

- Pull the filter upwards and away from the appliance.
- Remove any threads or fluff by hand or with a soft brush.
- Slide the filter back.
- Wash the filter occasionally in detergent solution using a soft brush to remove small particles.

ALWAYS EMPTY THE WATER BOTTLE

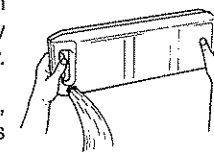

- Open the door, pull out and empty the bottle.
- Replace the bottle ensuring that it is pushed all the way in - if it is not, the dryer will not operate.
- If the dryer is connected to a drain there is no need to empty the bottle but it must be correctly fitted to the machine.
- Ensure the water bottle is emptied each time the dryer is used unless discharging into a drain.

THE CONTROLS

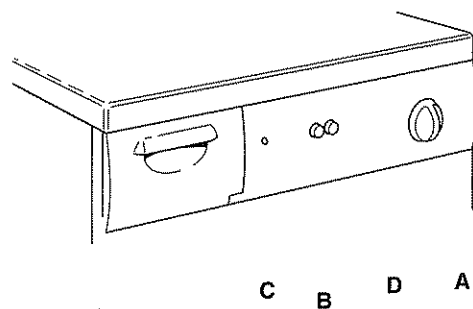

A. THE TIMER

Select the required drying time based on the recommendations on the control panel.

B. HEAT SWITCH

Select the required heat setting based on the recommendations on the control panel.

C. BOTTLE FULL NEON

This will light when the bottle needs emptying or when it is incorrectly inserted.

D. START BUTTON

PREPARATION

Check care labels inside the garments.

CARE LABELS YOU MAY FIND ON YOUR FABRICS

<input type="checkbox"/>	Suitable for tumble drying
<input checked="" type="checkbox"/>	Tumble dry using full heat
<input checked="" type="checkbox"/>	Tumble dry using half heat
<input checked="" type="checkbox"/>	Do not tumble dry

Do not tumble dry woollen or wool mixture articles unless the article is labelled to be suitable due to a possibility of shrinkage.

Roll dripping wet articles in a towel to remove excess water.

Place delicate articles e.g. tights, scarves, inside a pillowcase.

To avoid the need to iron easycare polyester/cotton items it is better to only dry small loads (i.e. half fill drum).

It is better to dry small and large articles together.

Fabric softeners, or similar products, should be used as specified by the Fabric Softener instructions.

Do not overload the dryer or dry large bulky items such as duvets or sleeping bags as it is important that the airflow through the dryer is not obstructed.

Items that have been soiled with substances such as cooking oil, acetone, alcohol, petrol, kerosene, spot removers, turpentine, waxes and wax removers should be washed in hot water with an extra amount of detergent before being dried in the tumble dryer.

Items such as foam rubber (latex foam), shower caps, waterproof textiles, rubber backed articles and clothes or pillows fitted with foam rubber pads should not be dried in the tumble dryer.

ADDITIONAL INFORMATION

ANY PROBLEMS

If the clothes are **not dry** after normal drying time:

- Check that you used the correct heat setting.
- Check that you have not set the timer within a cool down period.
- Check that the lint filter has been cleaned. A blocked filter will restrict the airflow.
- Check that the condenser unit and associated duct work are clean. If blocked these will restrict the airflow.
- Check that your dryer is heating - below the door to the left side, should feel warm to the touch after the first 10-15 minutes of its programme. Failure to heat may indicate the safety cut-out has operated. To reset, simply press the red button at the rear of the machine. If it has operated then a sharp "click" will be heard. This cut-out only operates if the airflow is severely restricted so make sure the filter is clean and that all other restrictions are removed before re-starting. If the cut-out continues to operate after checking the above points, you should contact your service agent.
- Check that the machine has the correct weight load in the drum before starting the appliance.

If your machine **does not work** check the following before calling a service engineer:

- Check that there is a supply of electricity.
- Check that the door has been properly closed and the machine is switched on.
- Check that the water bottle has been withdrawn from, and replaced into the machine.
- Check the fuse in the moulded plug.

OPTIONAL EXTRAS

Drain Hose Kit

To enable your dryer to be connected to a drain to remove the need to empty the water bottle.

The above item can be purchased as an accessory for your tumble dryer from your supplier.

TECHNICAL DATA

OVERALL DIMENSIONS:

Height: 85 cm
Width: 59.5 cm
Depth: 58 cm

MAXIMUM DRY WEIGHT LOADS:

Cotton 7kg
(for minimum creasing 2kg)
Delicates 2kg

For electrical ratings see plate on back of dryer.

For Model No. see serial plate inside door (needed when requesting service).

Room temperature range 5°C to 30°C.

Your washing machine should have a spin speed of not less than 800rpm.