



SUPER TORQUE DIGITAL SERVO INSTRUCTION MANUAL

Product no. #8126 / DS1213



Introduction

Congratulations on your purchase of ACE R/C Super Torque Digital Servo. ACE R/C super torque digital servo is a high torque product featuring with numerous enhancements that will improve your flying precisely in your helicopter and aircraft.

Equipped with all brand new super precise metal gear and advanced microprocessor to speed up the process of signal pulse. State-of-the-art middle case aluminum heat sink with cooling fans design can prevent the fading performance. Changeable single and twin ball screws for different applications.

Thus, reviewing thoroughly the user's manual prior installation is strongly recommended.

Features

- Equipped with superbly precise metal gears.
- Newly developed microprocessor will process the signal pulses more precisely and quickly.
- Extraordinary aluminum heat sink middle case with cooling fans to cool the coreless motor and prevent the fading of performance.
- 8 screws to enhance the structure solidness to deliver dependable power.
- Muscular holding power combined with fewer angular errors comparing to leading brands.
- Supplies superior torque output with low current consumption.
- Water and dust resistance.
- Single and Twin ball screws for output shaft reinforcement.

Contents

Product name	DS1213
Servo	#8126 x 1
Servo Connector	JR type
Servo Horn	Super Rigid Straight servo horn x 1 Super Rigid Round servo horn x 1
Servo Hardware	Horn Screw x 1 Link Ball Screw x 1 Mounting Screws (2.6mm) x 4 Eyelet-Brass x 4 Rubber Grommet (Damper) x 4

Specifications

Product name	DS1213
Product No.	#8126
Motor	Coreless
Gear	Metal
Case	Heat Sink
Dim. (LxWxH)mm	41.8 x 20.6 x 39.6
Weight (g/oz)	66 / 2.328
Torque (Kg-cm/oz-in)@ 4.8V	9.6 / 133
Transit Time (sec/ 60°)@ 4.8V	0.16
Voltage Range	4.8V ~ 6V

Precaution

- Due to the high current drain consumption at startup for the ACE R/C super torque digital servo. Please use high capacity NiCD batteries or NiMH batteries instead of using dry cells.
- To achieve the best performance, FM radio control system is suggested for its precised pulse signal processing.
- When using a high power consumption servo, the BEC eliminator circuit built-in battery port on most of AM receiver will limit the power consumption by drawing from itself. To by-pass the BEC circuit on the receiver, a "Y" harness is highly recommended to use for connecting the battery pack and servo instead. Otherwise a FM receiver without the BEC circuit is suggested.
- Using systems with the battery fail safe function will also cause shorter operation time due to the featuring higher cut-off voltage setting.

Service

Thunder Tiger strives to bring you the highest level of quality and service we can provide. We race and test our products around the world to bring you state-of-the-art items. Thunder Tiger guarantees that you should enjoy many hours of trouble free use from our R/C products. Thunder Tiger products have been sold worldwide through the authorized distributors that are supported directly and rapidly from Thunder Tiger. You may find that Thunder Tiger is always pursuing to explore new items creatively with highest quality. To update the latest product information and to get the best technical support, please feel free to contact your local hobby shops or Thunder Tiger authorized distributor.

Parts List

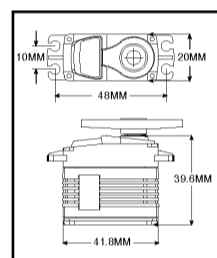

Item	8126
Name	DS1213
A	UP/LOW CASE SET
B	GEAR SET
C	CONNECTOR
D	BEARINGS
E	VARIABLE RESISTOR
F	ACCESSORY PACKAGE
MISCELLANEOUS	
12 DAMPERS (SQUARE)	AQ1422
12 EYELETS (ø3.0)	AQ1494
Optional Parts	
G	Twin Link Ball Screw x 2
	AQ1425

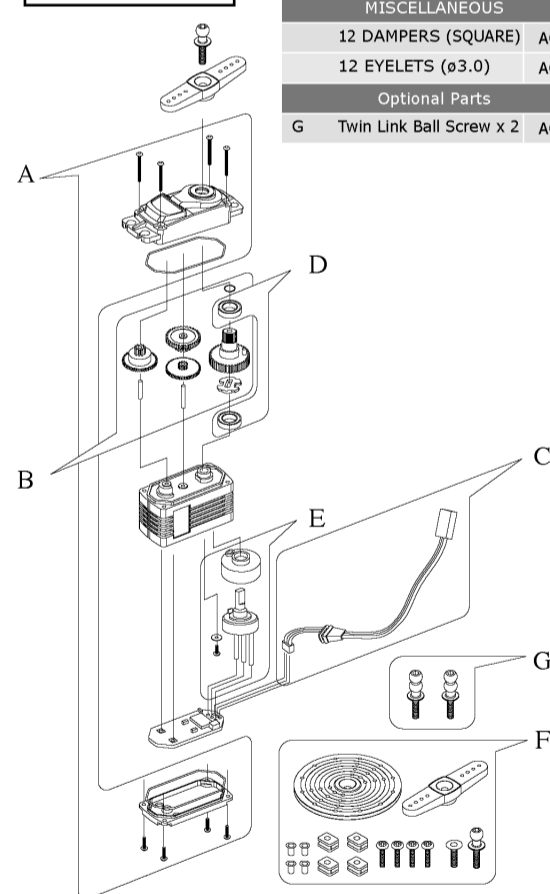

Manufactured by
THUNDER TIGER CORP.
<http://www.thundertiger.com>

JC0616