

# 数码监视器 MONITOR

**72-MC2100-001**

产品执行标准号:Q/WP1034-2005

Product Implementation Standard No.:Q/WP1034-2005

产品标准备案号:QB/44130033952-2005

Product Standardization File No.:QB/44130033952-2005

尊敬的客户:如在使用中遇到问题,请拨打TCL全国统一用户服务热线4008-123456咨询。

If you encounter any problem with your monitor, please call TCL nationwide customer service hotline 4008-123456 for assistance.



**TCL集团股份有限公司**

地址:广东省惠州市仲恺高新技术开发区十九号小区

**TCL CORPORATION**

No.19 District, Zhongkai High-tech Development Zone, Huizhou City, Guangdong Province

电话(TEL):4008-123456

传真(FAX):0752-2636307

邮编(ZIP CODE):516006

# TCL

www.tcl.com

**MC14  
MC15  
MC21**

**彩色监视器  
COLOR MONITOR**

**使用说明书  
OPERATION MANUAL**

尊敬的客户,因本机功能较多,为了充分有效地应用各项功能,使用前,请您详细阅读本机使用说明书。

This apparatus is with multi functions, so to use it properly, please read the instructions carefully before your operation.

## 目 录

02 警告注意

03 机型特点

03 技术规格

03 遥控器

04 连接示意图

05 基本操作

05 开机与关机

05 AV功能的使用

05 图像调整

05 系统设置

06 浏览设置

## 装箱单

- 主机一台
- 遥控器一个，7号电池两节
- 说明书一套(含保修单、合格证等)
- 有线遥控连接线一条

## 警告注意

### 警告

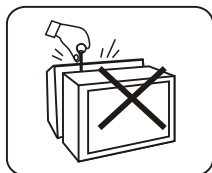

机内有高压，非专业人员切勿打开后盖，以防触电。

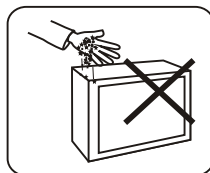

切勿将异物(如：铁屑、项链、硬币等)掉入机内，以防引起电路短路着火，损坏监视器。

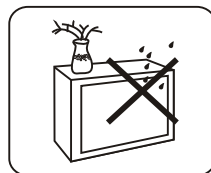

监视器不应遭受水滴或水溅。监视器上不应放置花瓶一类装满液体的物品。

### 注意

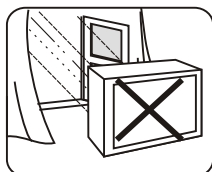

监视器严禁雨淋、受潮和严重的灰尘侵蚀，以防引起触电或电路短路着火。

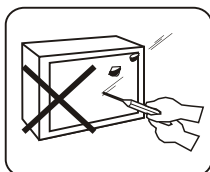

勿使监视器(尤其是荧光屏)受到硬质物撞击，搬运、装卸时应特别注意。

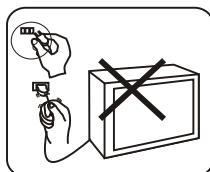

应注意保护好监视器的电源及插头，切勿因强拉重压使其损伤。

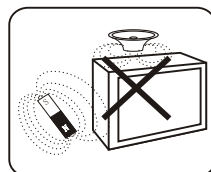

监视器应远离扬声器、电动机、变压器等磁性物品，以免引起彩色异常。

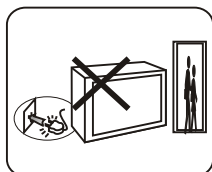

长期外出或雷电时请将电源插头拔掉。

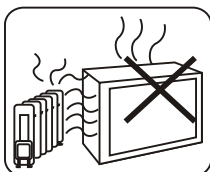
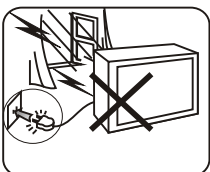

机内温度过高易引起监视器损坏，应保证监视器通风良好，切勿堵挡监视器散热孔。监视器应远离热源(如：暖气、火炉等)处，并避免阳光直射。

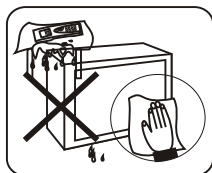
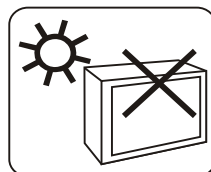

勿用酒精、氨水、稀释剂等清洗监视器表面，若确有需要，请用湿海绵或软布(可加少量中性洗涤剂)拧干后清洗，并切记在清洗前切断电源。

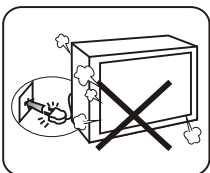

监视器使用过程中发现异常(如有异味等)或不慎将异物落入机内，应立即关闭监视器并拔出插头，尽快与维修单位联系检修。

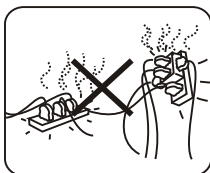

应根据监视器的电源消耗功率选择合适的电源插座，勿与其它电器共用插座。

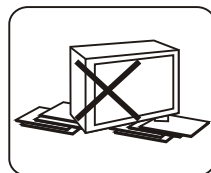

应根据监视器的重量将其放置于有足够强度的支撑台上，并要安放稳定，以免使监视器受到跌落等冲击而损坏。

机型特点

- ☐ 数码超级单芯片功能
- ☐ 图像状态变换（四种）
- ☐ NTSC梳状滤波器
- ☐ 宽电源范围
- ☐ 两路AV(BNC)输入、一路S端子输入、两路AV环通(BNC)输出
- ☐ 拉幕式护眼开机

技术规格

适合制式	AV: NTSC3.58、NTSC4.43、PAL		
AV1、AV2端子输入(BNC)	视频1.0Vp-p；音频0.5VRMS		
S端子接口	亮度信号1.0Vp-p；色度信号0.7Vp-p		
电压工作范围	165V-250V~ 50Hz		
机型	MC14	MC15	MC21
可视图像对角线尺寸	34cm	36cm	51cm
外形尺寸(宽x深x高)	390x478x325(mm)	390x478x325(mm)	504x512x420(mm)
质量	约13kg	约15kg	约30kg
整机消耗功率	50W	60W	70W

遥控器



- 注意:

按“上移/下移”键可显示当前画面的信号源，

按“增加/减少”键可直接调节音量大小。
- 遥控器电池的安裝

打开遥控器背面的电池盒盖，然后按电池盒内所标注的极性相应放入两节7号1.5V电池，最后把电池盒盖盖上。

遥控器的使用

  - 1、有线遥控：将随机所附遥控器连接线一端插入遥控器“有线遥控接口”，另一端连于主机后盖“遥控器接口”，即可操作、调整画面等。
  - 2、无线遥控：不需要连接遥控器“有线遥控接口”，只需要将遥控器对准主机前面的遥控接收窗。若主机与遥控器之间有障碍物，遥控可能会失灵。
- 注意:

  - 1.为确保持遥控器良好的操作性能，如发现操作不正常，请换电池再试。
  - 2.不要将新、旧电池或不同型号的电池混合使用。
  - 3.电池电力微弱时会发生泄漏电解液现象，这会损坏遥控器。一旦发现电力微弱，应尽快更换电池。
  - 4.若长期不使用遥控器，请把电池取出，以免电池泄漏电解液。

# 连接示意图

以MC21为例：

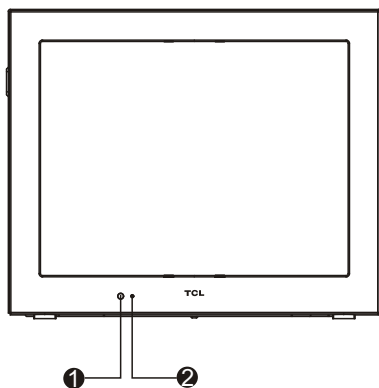

- 1. 遥控接收窗
- 2. 电源指示灯

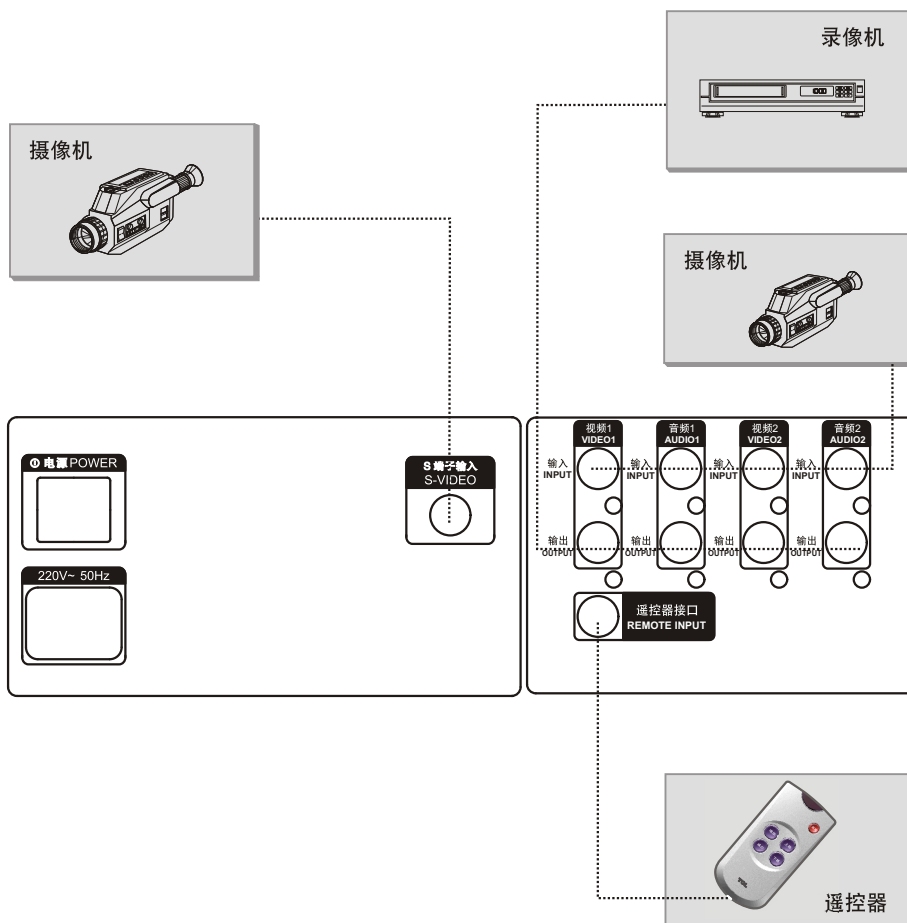
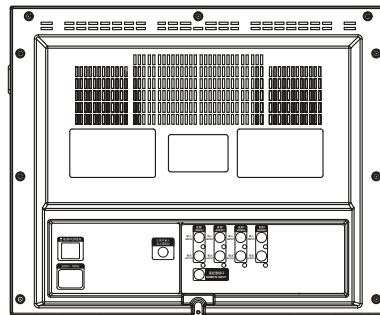

# 基本操作

首先请将电源线接好。

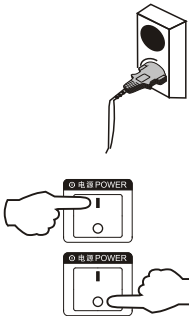

## □ 开机与关机

**开机：**按下主机后面的电源开关的“**I**”，即可进入正常工作状态。

**关机：**在开机状态下，按下主机后面的电源开关的“**O**”，即可正常关机。

## □ AV功能的使用

将视频信号接入“视频输入”端口，即可正常工作。

**注意：**

本机型设有一路SVHS（S端子）接口，如果您的设备有SVHS接口，请从S端子输入，可获得高画质效果。

S端子与视频1，请不要同时插入信号。



## □ 图像调整

按一下“菜单”键，呼出“图像”菜单，接着按“上移/下移”键选择要调整项，按“增加/减少”键，对选择项进行增、减操作。

例：调整对比度

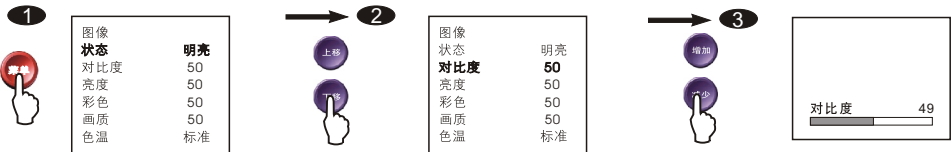

**注意：**

- (1) 色调是在NTSC制式时才出现。
- (2) 对比度是调节画面黑白层次的，适当的对比度使画面清晰明亮。
- (3) 亮度是调节画面的背景亮度，一般与对比度配合使用。
- (4) 彩色是调节色彩的鲜艳度（饱和度）的。
- (5) 画质是调节画面清晰度的。
- (6) 色温有标准、冷、暖三种模式。

## □ 系统设置

连续按两下“菜单”键，呼出“系统”菜单，接着按“上移/下移”键选择要调整项，按“增加/减少”键，对选择项进行切换操作。

例：语言切换

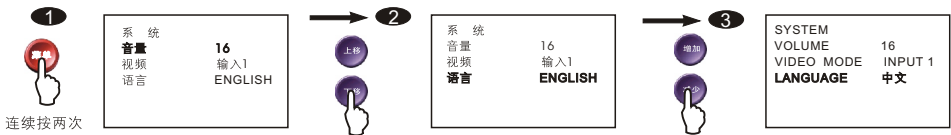

音量：按“增加/减少”键可调节音量大小。  
视频：有输入1、输入2。  
语言：有中文和英文。

## □ 浏览设置

连续按三下“菜单”键，呼出“浏览”菜单，接着按“上移/下移”键选择要调整项，按“增加/减少”键，对选择项进行调整。

例：通道选择设定

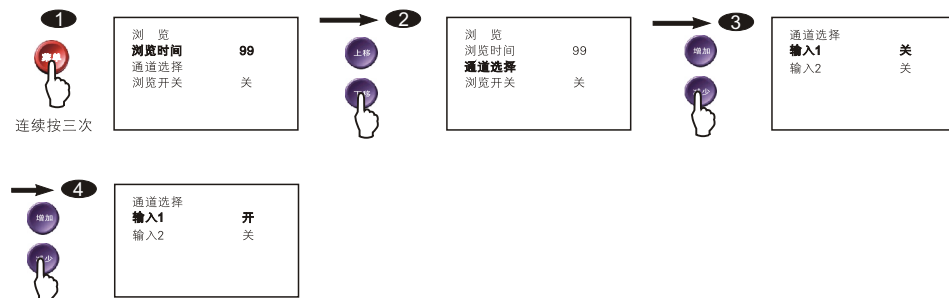

例：浏览功能设定



浏览时间：设定范围1-99秒。

通道选择：有输入1、输入2两种选择。（如果“输入1”和“输入2”都设为“开”时，浏览将会在“输入1”和“输入2”之间循环进行，如果插入S端子，系统会自动识别在“S视频”和“输入2”之间循环浏览。）

浏览开关：当此开关设定为开时，浏览功能才生效。

注：当需要停止浏览功能，直接按“菜单”键退出，此时屏幕下方会显示“浏览开关：关”，如要重启此功能需要再次进到“浏览”菜单设定。

## Contents

02	Warnings and Precautions
03	Features
03	Specifications
03	Remote Control
04	Connection Illustrations
05	Basic Operations
05	Turning on/off the Unit
05	AV Function
05	Picture Adjustments
05	System Settings
06	Browse Settings

## Packing List

- Main Unit - one set
- Remote Control Handset - one set, including two AAA batteries
- Operation Manual - one pc (including warranty card, quality certificate, etc.)
- Remote Control Cable - one pc



# Warnings and Precautions

## Warnings

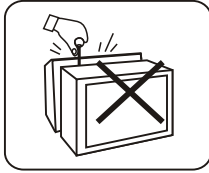

High voltage inside! To reduce the risk of electric shock, do not remove cover (or back). Refer servicing to qualified personnel.

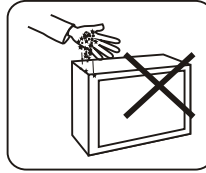

Do not push objects of any kind into the unit as this may cause fire or short circuit and damage the unit.

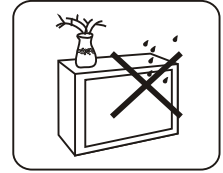

The unit shall not be exposed to dripping or splashing and no objects filled with liquids such as vases, shall be placed on the unit.

## Precautions

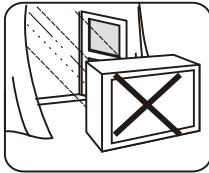

To prevent fire or shock hazard, do not expose the unit to rain, moisture or heavy dust areas.

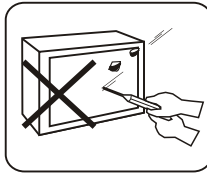

Protect the unit, especially the screen, from being attached by hard objects. Please take care during transportation and loading/unloading.

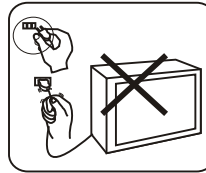

To protect the power cord, do not pull it or press it with excessive force.

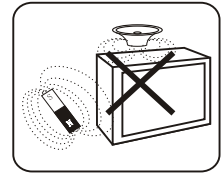

To avoid color abnormality, keep the unit away from the magnetic objects, such as the speaker, electromotor or transformer.

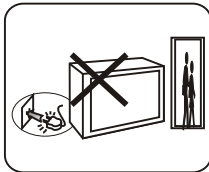

Remove the power plug when the unit will not be used for a long period of time, or when it is thunder or lightning.

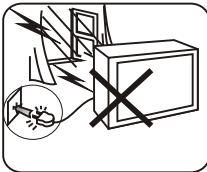

During your operation, if there is something abnormal found, such as strange smell, or if some objects fall into the unit, switch off and unplug the unit immediately and contact the service personnel as soon as possible.

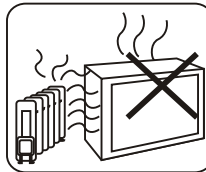

High temperature inside may cause the damage to the unit. Please keep it well ventilated and do not block the ventilation slots and openings. Keep away from heat sources such as stove and radiator and avoid direct sunshine.

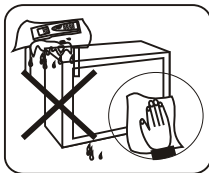
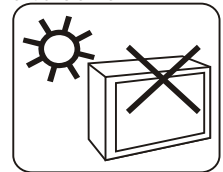

Do not use chemicals such as alcohol, ammonia or thinner for cleaning. If necessary, use a piece of wet cloth or sponge with some diluted neutral detergent, wring dry for cleaning. Be sure to cut off the power before your cleaning.

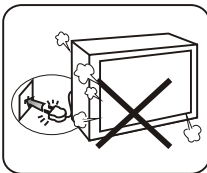

During your operation, if there is something abnormal found, such as strange smell, or if some objects fall into the unit, switch off and unplug the unit immediately and contact the service personnel as soon as possible.

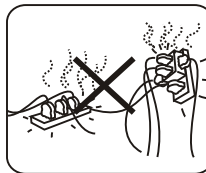

Use suitable power outlet based on power consumption of the unit. Do not share a power outlet with other electrical appliances.

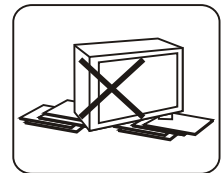

Place the unit on a platform strong enough for supporting. Keep it stable to avoid falling off and cause the damage.

## Features

- ☐ Digital Super One Chip Function
- ☐ NTSC Comb filter
- ☐ 2 AV Input (BNC), 1 S-VIDEO Input and 2 AV LOOP OUT (BNC)
- ☐ 4 Picture Modes
- ☐ Wide Voltage Range
- ☐ Curtain-up Powering on

## Specifications

Receiving System	AV: NTSC3.58, NTSC4.43, PAL		
AV1&AV2 Input (BNC)	Video: 1.0Vp-p; Audio: 0.5VRMS		
S-VIDEO Input	Y: 1.0Vp-p; C: 0.7Vp-p		
Operating Voltage	165V-250V ~ 50Hz		
Model No.	<b>MC14</b>	<b>MC15</b>	<b>MC21</b>
Visible Diagonal Size	34cm	36cm	51cm
Dimensions(mm)	390x478x325(mm)	390x478x325(mm)	504x512x420(mm)
Gross Weight	about 13kg	about 15kg	about 30kg
Power Consumption	50W	60W	70W

## Remote Control

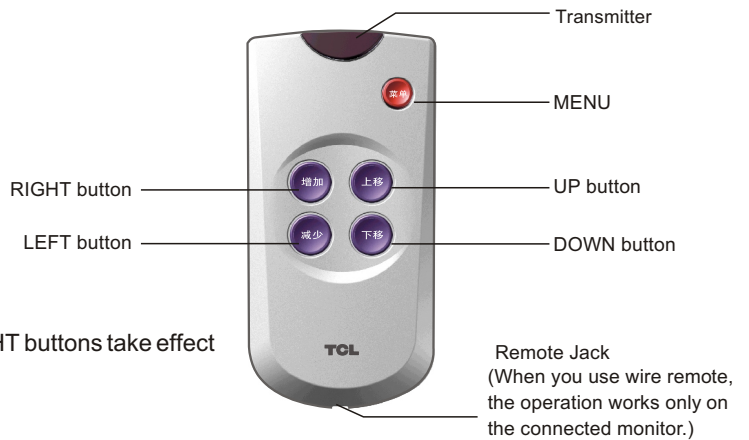

### Note:

UP/DOWN buttons and LEFT/RIGHT buttons take effect only in the MENU mode.

### Battery Installation

Remove the battery compartment lid from the back of the remote, insert the 2 x 1.5V AAA batteries, paying attention to the polarity, and then replace the cover.

### Using the Remote Control

1. Wire Remote: Connect one end of the attached remote cable to the jack on the remote and the other end to the remote jack on the rear panel, then you can use this wire remote to adjust menu controls.
2. Wireless Remote: No need to connect it with the remote jacks. Point this wireless remote directly toward the infra-red sensor on the unit. If there is an obstacle between the unit and the remote, the remote signal may not be received.



### Notes:

1. For better performance, once you find the operation is abnormal, please replace the batteries and have a try again.
2. Do not mix old and new batteries or different types.
3. When the batteries are to be exhausted, battery leakage may occur and cause the damage to the remote. When the operation is not sensitive enough, the battery may be low, so please change batteries immediately.
4. If the device is not to be used for a long period of time, remove the batteries to prevent damage or injury from possible battery leakage.

# Connection Illustrations

Take MC 21 for an example:

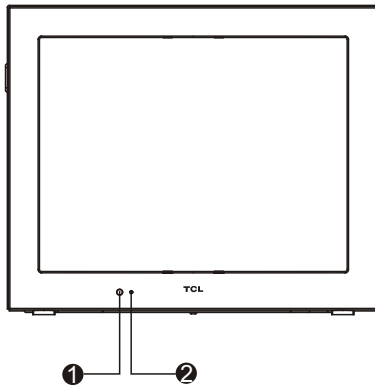

1. Sensor
2. LED indicator

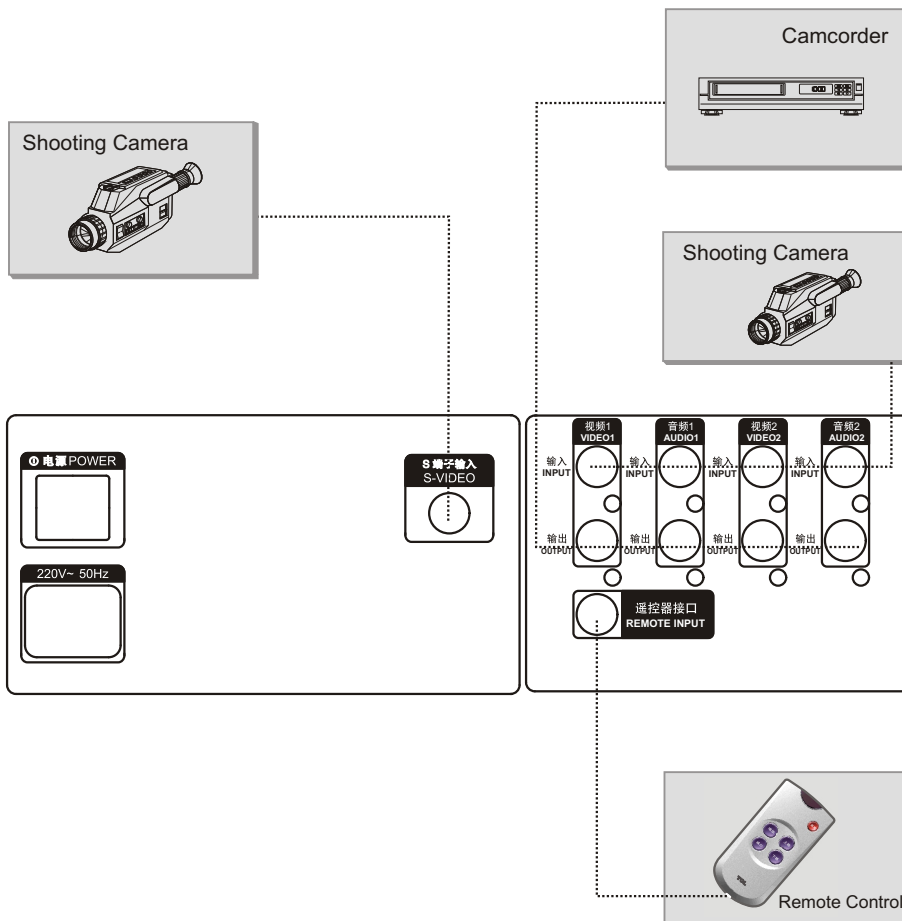
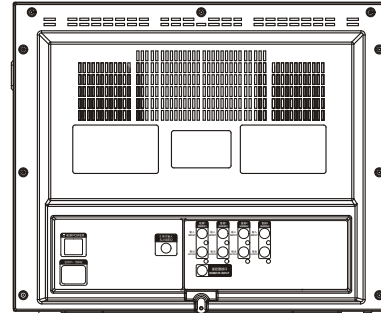

## Basic Operations

Connect the power cord first.



### □ Turning on/off the Unit

Turning on: Press the "I" on the POWER button of the rear panel to turn on the unit, then it goes to the normal working status.

Turning off: Under the working status, press the "O" on the POWER button of the rear panel to turn the unit off.

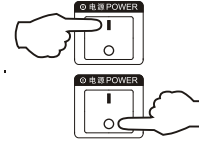

### □ AV Function

Connect the video signal source to the VIDEO input jacks, then the unit will start working.



**Note:**

There is an SVHS (S-VIDEO) input jack on the unit. If your apparatus has an SVHS jack, you can connect it to the S-VIDEO input jack to achieve the high quality pictures. Please do not use the S-VIDEO jack and VIDEO1 jack simultaneously.

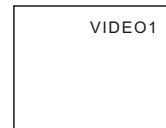

### □ Picture Adjustments

After you make the remote connects, press MENU on the remote and then PICTURE menu appears on the screen. You can select the item by using UP/DOWN buttons and adjust menu controls by using LEFT/RIGHT buttons. Take CONTRAST adjustment for an example:

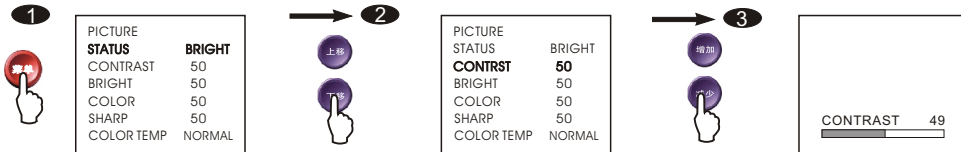

**Notes:**

- (1) TINT is available only in NTSC mode.
- (2) CONTRAST adjusts the distinction between the black and white parts of the picture.
- (3) BRIGHT is used to brighten the darkest parts of the picture. Usually it is adjusted together with CONTRAST setting.
- (4) COLOR is used to add or reduce color.
- (5) SHARP improves picture details.
- (6) COLOR TEMP (color temperature) includes 3 modes: NORMAL, COLD and WARM.

### □ System Settings

After you make the remote connects, press MENU on the remote twice and then SYSTEM menu appears on the screen. You can select the item by using UP/DOWN buttons and adjust menu controls by using LEFT/RIGHT buttons. Take LANGUAGE setting for an example:



**VOLUME:** Increase/Decrease the sound level by pressing UP/DOWN buttons.

**VIDEO MODE:** INPUT 1, INPUT 2

**LANGUAGE:** CHINESE, ENGLISH

## □ Browse Settings

Press MENU on the remote three times and then BROWSE menu appears on the screen. You can select the item by using UP/DOWN buttons and adjust menu controls by using LEFT/RIGHT buttons. Take VIDEO CHOICE setting for an example:

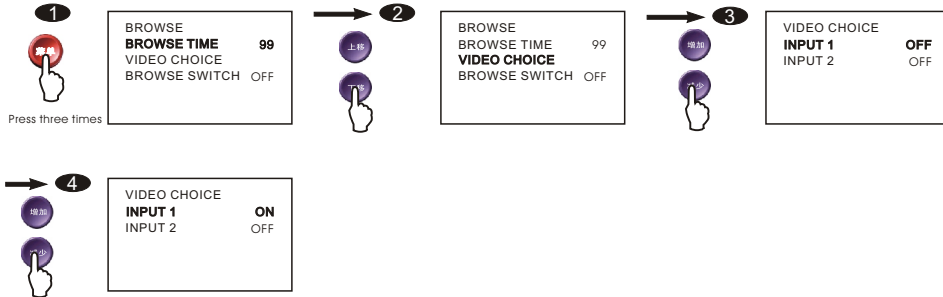

Take BROWSE SWITCH setting for an example:

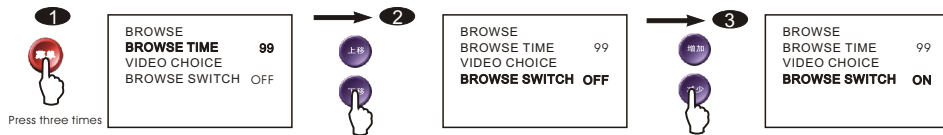

**BROWSE TIME:** The time can be adjusted from 1 to 99 seconds.

**VIDEO CHOICE:** INPUT 1, INPUT 2 (If both INPUT 1 and INPUT 2 are set to ON, you can cyclically browse these two input channels.

If S-VIDEO input jack is connected, the system will automatically select S-VIDEO and INPUT 2 as the input channels to browse.)

**BROWSE SWITCH:** The browse function will take effect only when ON is set.

**Note:**

When you want to stop the browse function, press MENU to exit directly and then "BROWSE SWITCH OFF" appears on the screen. If you want to activate this function again, enter the BROWSE menu to make menu controls.