

转轮式 全自动环保除湿机

CH150D

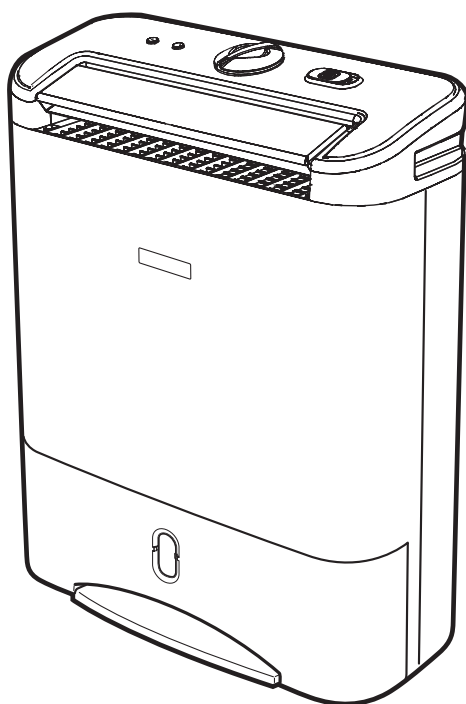

使用手册

尊敬的用户：

感谢购买本产品，请仔细阅读《使用手册》，并按照相关内容正确使用、维护机器。请保存《使用手册》，以便随时查阅。为保证您获得完善的售后服务，请及时办理保修手续并保存购机凭据。

WGI Inc U.S.A.

目 录

产品简介.....	3
使用前注意事项.....	4
机器放置.....	4
各部位名称.....	5
控制显示面板.....	6
功能设定.....	6
运转状态指示灯.....	6
运转操作.....	7
银离子空气过滤网.....	7
水箱水满指示及水箱倒水.....	8
外接水管自动排水.....	9
机器清洁及维修.....	9
电源线的维护与更换.....	9
机器不使用时.....	9
一般故障排除.....	10
规格表.....	11
产品保修卡.....	封 三

版 权 声 明

© **WGI** 公司版权所有。本公司保留为改进产品而变更设计及规格的权利，恕不另行通知。

由于产品的改进，您所购买的产品可能与使用手册中的介绍不完全一致，谨此致歉。

如有任何印刷错漏或在翻译中可能产生的误差，本公司不承担由此产生的后果。

产品简介

一、转轮除湿技术的优点

转轮除湿技术的性能在除湿技术中是最好的，因不用压缩机及制冷剂，所以没有噪音及制冷剂破坏大气臭氧层的问题，具有高效、节能、环保及低温低湿仍能强力除湿等优点，向来被应用于工业及国防项目，但造价昂贵。小型除湿转轮的研发成功及应用技术，使转轮式小型除湿机能够批量生产并具有高效、省电、低噪音、体积轻巧的显著优点，是一种高科技的环保除湿产品。

二、CH150D转轮式全自动环保除湿机的产品优势

1、科技、健康、时尚

高级塑钢机体，构成美观时尚外形。

双速运转及高效空气净化装置，带给您使用高科技健康产品的美好享受。

2、湿冷天气的强大克星：

不受环境温度变化制约，低温条件下仍保持强力除湿。使空气干爽怡人。

3、简洁方便的操作控制功能：

湿度控制旋钮：适湿、干爽、干燥、连续除湿四种湿度条件自动控制。

双功能选择键：省电(低功率/低风速)或快速(高功率/高风速)运转；

可调节广角送风导板：前方至上方随意手动调节，最大幅度可达150°。

4、带提把的前置式水箱及正面水位视窗。

5、水满防溢自动停机及警示功能。

6、连续除湿自动排水接口。

7、防倾倒自动停机保护功能。

8、机体内部温度自我安全检测及防护。

9、一体式侧面把手可轻易提起重量仅 8.8kg 的机器，方便移动。

三、纳米银离子空气过滤网可杀菌防霉，呵护人体健康

- 空气过滤网以特殊工艺涂布了纳米银离子，可将通过空气循环而吸附在滤网上的细菌杀灭，吹出干净清爽的空气。
- 纳米银离子能杀灭包括大肠杆菌、肺炎杆菌、真菌、淋球菌等数百种有害微生物，抗菌能力长期有效，且不会对人体产生不良影响。

使用前注意事项

- 1、本机不得在没有协助或监控下，给儿童或其它因身体、感官或心智能力无法安全使用的人士使用。应该监督儿童确保他们不把本机当成玩具。
- 2、本机仅适用于 **220 V AC / 50 Hz** 电源。使用场所的电源电压、电线配置及电源开关、插座均应符合用电安全国家标准。
- 3、本机仅限室内使用，适用环境温度：**1~40°C**。机器应避免阳光直接照射，远离热源和易燃易爆物，不受水或油类物质淋湿，避免在腐蚀性化学品污染及灰尘严重的环境使用，以免机器受到损坏甚至引起电击、火灾等严重事故。
- 4、如机器电源线受损或电源插座松脱，应即停机，待修复后方可使用。
电源线受到损坏，会导致机器受损及漏电、短路甚至引起火灾等严重事故，为此应避免电源线受到强力拉扯、折叠、重压或鼠咬、化学物腐蚀等损害。当电源线受损时，请即关机，将插头从插座上拔下后与供应商或服务中心联系更换新品，请不要自行拆卸更换非本机专用电源线。
- 5、机器在清洁、移动、维修或停用前应先关机后再将电源线插头拔掉。
- 6、请用手握住电源线插头插进/拔下电源插座，请不要通过拉扯电源线将插头从插座上拔下，以免电源线受损，引起漏电、短路甚至火灾等严重事故。
- 7、避免杂物，尤其是金属物进入出风口内，以免机器受到损坏甚至引起电击事故。
- 8、机器应安装空气过滤网后方能开机运转，以免内部器件污脏受损，引起故障。
- 9、机器运转时请将门窗关闭，以达到最大的除湿效果。
- 10、机器使用场所无人时请关机，以避免其它因素引起意外事故。

机器放置

- 机器应平稳放置于平坦坚固的地面，以免发生漏水、噪音等异常情况。
- 机器进、出风口近距离应无遮蔽物，以利空气流通。
- 确认水箱放置定位。水箱未装定位，水满/检查指示灯会亮起，机器不能运转。

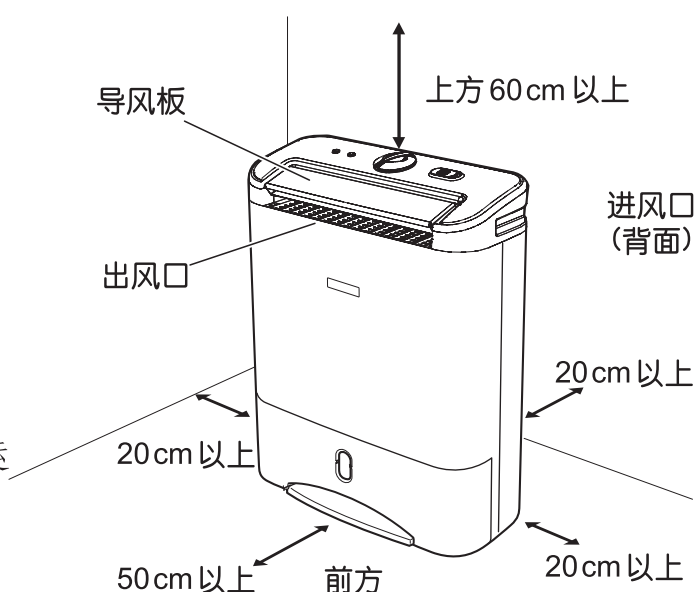

各部位名称

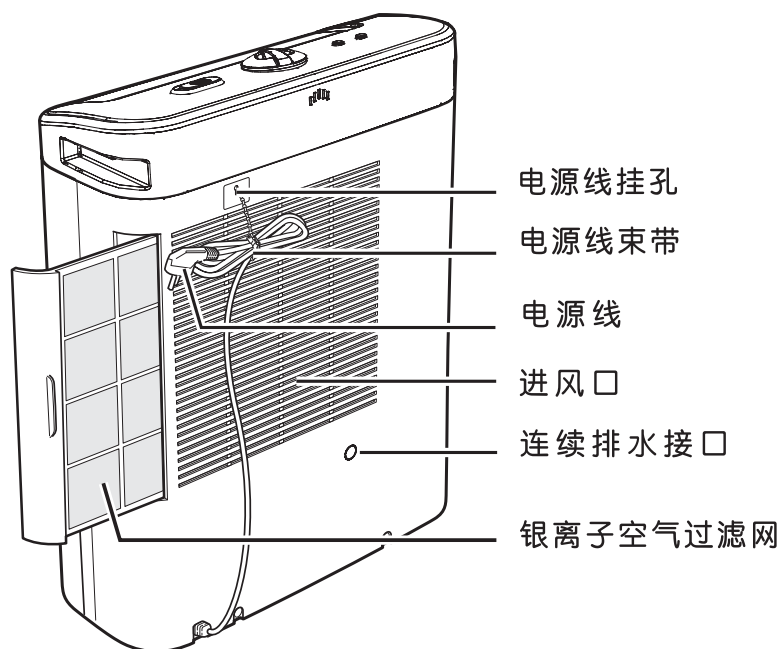
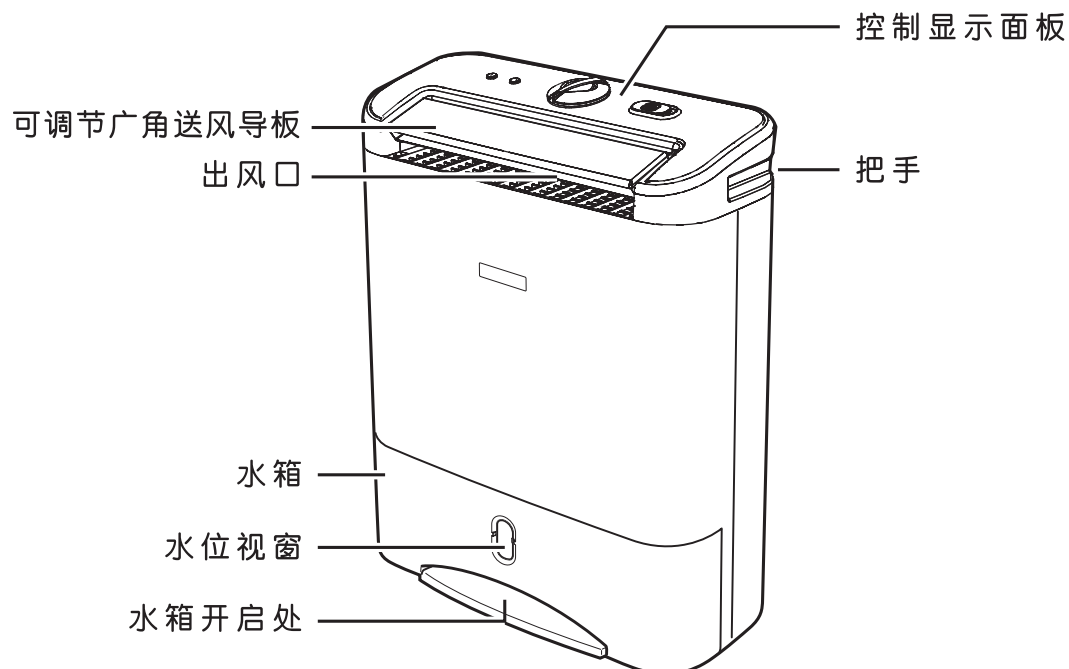

控制显示面板

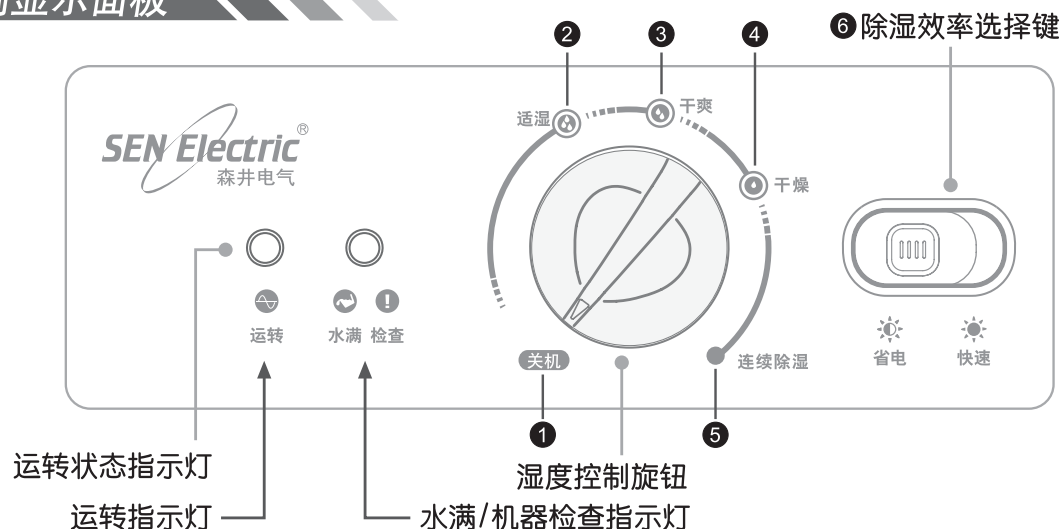

功能设定

- ① 关机：机器停止运转。
- ② 适湿：环境相对湿度60%~70%RH自动除湿/开、停机功能。
当室内环境相对湿度约高于70%RH时，机器启动运转，除湿至约低于60%RH时，机器自动停止运转。
- ③ 干爽：环境相对湿度50%~60%RH自动除湿/开、停机功能。
当室内环境相对湿度约高于60%RH时，机器启动运转，除湿至约低于50%RH时，机器自动停止运转。
- ④ 干燥：环境相对湿度35%~50%RH自动除湿/开、停机功能。
当室内环境相对湿度约高于50%RH时，机器启动运转，除湿至约低于35%RH时，机器自动停止运转。
- ⑤ 连续除湿：机器连续运转除湿，水箱水满时才停机（自动连续排水则不停机）。
- ⑥ 除湿效率选择键：省电：低功率/低风速；快速：高功率/高风速。

运转状态指示灯

- ⑦ 运转指示灯：亮起表示机器在运转中。
- ⑧ 水满/机器检查指示灯：机器倾倒、水箱满水或未放定位、浮球损坏；或因环境温度超过40°C，进、出风口被遮蔽或其它异常因素或机器发生故障时，机器会停止运转，指示灯亮起，警示应检查处理。

运转操作

- 1、请使用独立的、符合用电安全国家标准的电源插座。
 - 劣质的电源插座、多台机器或与其它电器共用一个电源转接器，以及其它不规范的电源连接方式，均容易使机器受到损坏甚至引起火灾等严重事故。
- 2、确认旋钮在“关机”位置上再将电源插头插入电源插座。
- 3、确认水箱放置在正确的位置上，水箱未装定位，水满指示灯会亮起，机器不能运转。
- 4、湿度控制旋钮在“关机”的位置上，电源未接通，将旋钮顺时针方向设置在需要的适湿、干爽、干燥或连续除湿的位置上，机器开启，控制显示面板上的运转指示灯亮起，将旋钮逆时针方向设定在关机位置，机器关闭，运转指示灯熄灭。
- 5、湿度控制旋钮在“关机”位置，机器停止运转。

银离子空气过滤网

- 本机配置纳米级银离子空气过滤网。银离子可杀灭包括大肠杆菌、真菌、淋球菌等几百种病菌，抗菌能力长期有效，且不会对人体产生不良影响。
 - 银离子空气过滤网上附着过多灰尘，会影响空气流通，使除湿和杀菌效率下降，甚至使机器受到损坏，为此请经常检查并及时清洁：
- 1、请先关机后拔下电源线插头，从进风口左侧抽出过滤网。
 - 2、用吸尘器或软毛刷把过滤网上的灰尘清除干净后，将过滤网装回原位。（如图）
 - 3、请不要用水清洗滤网，否则会将纳米银离子洗掉，使杀菌效率降低甚至消失。

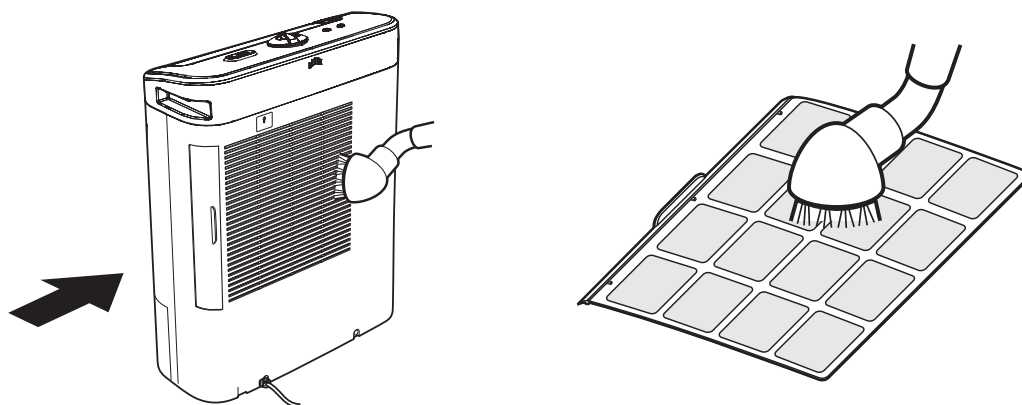

水箱水满指示及水箱倒水

- 1、水箱满水时，水满指示灯亮起并停机，提示水箱满水了。
- 2、握住水箱中间底部开启处外拉，移出水箱，再握住水箱手把提起。
- 3、倒水时掀开水箱盖，再紧握开启处，提起水箱，将水倒掉。
- 4、每次倒水后，水箱应清洗擦拭干净，以免结垢。
- 5、水箱盖及手把复位后，将水箱放回定位，水满指示灯熄灭，机器继续运转。

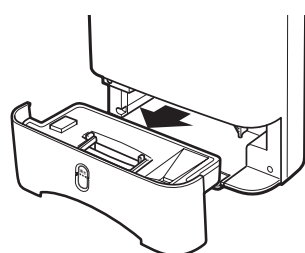

移出水箱

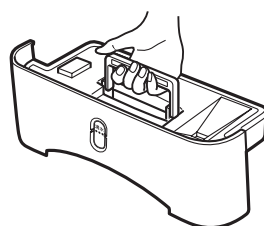

握住手把提起

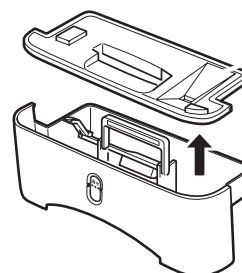

掀开水箱盖

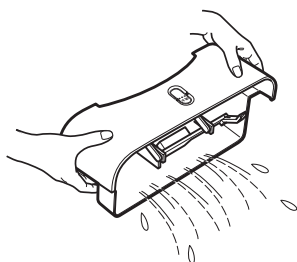

紧握开启处提起倒水

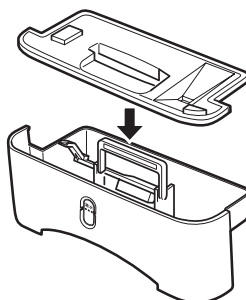

将水箱盖及手把复位

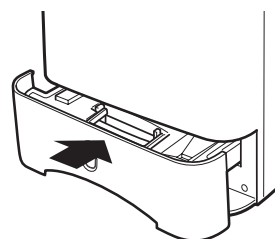

装回水箱定位

警 示:

- 刚停机时，请不要立即取出水箱，以免水滴在机体内。
- 请用清水清洗水箱，并用柔软棉布擦拭干净。请不要使用清洁剂或热水清洗。
- 请不要移动或破坏水箱浮球，否则机器将无法正常运转。
- 放回水箱前，请确定水箱盖及手把已复位固定。
- 水箱若未装置定位，水满指示灯会亮起，请重新装置定位。

外接水管自动排水

机器设定自动排水时，请使用内径12mm的塑料水管安装：

- 1、移出水箱。
- 2、用螺丝刀等工具戳开机体背面预留的水管孔，将水管从孔中穿过。
- 3、将水管内端套紧在随机附件L型转接管上。
- 4、将L型转接管套紧机器排水接口。
- 5、顺时针方向将转接管旋转到水平牢固位置，并将水管调整妥当。
- 6、将水箱放回定位，排水管的排水端应成斜度下垂且勿折曲，以利排水。

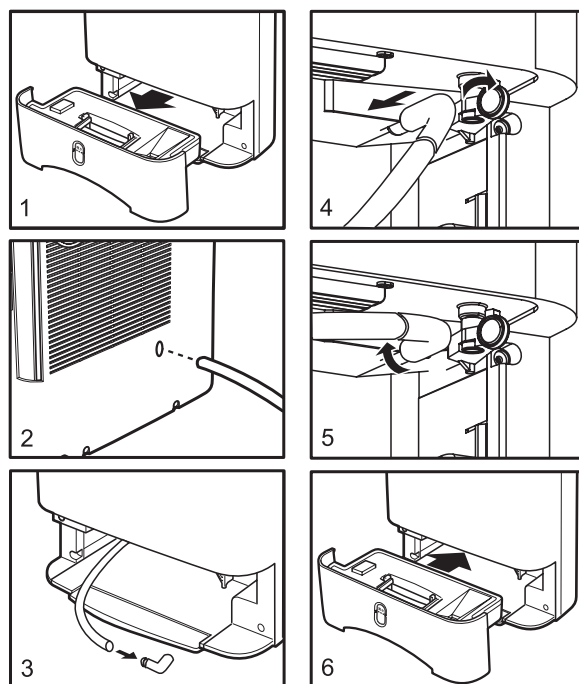

机器清洁及维修

- 1、请先关机后拔下电源线插头。
- 2、用吸尘器或柔软棉布清除进、出风口的灰尘后，再用柔性的清洁剂及柔软棉布将机体擦拭干净。
- 3、机器出现故障不能排除并确认需要维修时，请与授权维修中心(站)或供应商联系，请不要擅自拆卸机器维修。

警 示：

- 清洁时应防止水滴进机器，更不能直接用水冲洗，以免机器受到损坏。
- 请不要向机体喷洒油漆、杀虫剂或涂拭烈性化学制剂，以免引起机壳变形甚至火灾等严重事故。

电源线的维护与更换

电源线受到损坏，会导致机器受损及漏电、短路甚至引起火灾等严重事故，为此应避免电源线受到强力拉扯、折叠、重压或鼠咬、化学物腐蚀等损害。当电源线受损时，请即关机，待出风口完全停止送风后，将插头从插座上拔下后与供应商或服务中心联系更换新品，请不要自行拆卸更换非本机专用电源线。

机器不使用时

- 1、请先关机后拔下电源线插头。
- 2、将水箱内的水倒掉，并清洁干净。
- 3、清洁空气过滤网，进、出风口及机体。
- 4、盖上防尘罩，放置在阴凉、通风处。

一般故障排除

故障情况	故障原因	处理方法
机器不能运转	1、停电 2、电源不正常	恢复供电 修复电源
水满/检查灯亮	1、水箱放置未定位、水箱水满 2、机器倾倒 3、进/出风口被遮蔽 4、使用环境温度过高	定位、倒水 将机器重新放置好 清除遮蔽物使空气流通，并等候至少 30 分钟后再重新开机。 不要在温度高于 40℃ 的环境使用。移到凉爽处，并等候至少 30 分钟后再重新开机。
除湿功能欠佳	1、过滤网阻塞 2、门窗未关 3、有障碍物阻碍进/出风口	清洁过滤网 关闭门窗及通风口 清除障碍物使空气流通
地板有水	1、机器放置不平衡 2、排水管松脱或堵塞	将机器重新放置好 检查排水管与 L 型转接管

当故障不能排除并确认需要维修时，请与授权维修中心(站)或供应商联系，请不要擅自拆卸机器维修。

- 本机初次启动运转时，可能会有气味产生，这并非产品的异常，通常随着使用的过程，会逐渐减少消失。若持续有气味产生，请检查使用环境是否会发生气味的东西，如香烟、新家具、发胶、染发剂、化妆品、药品、刚施工完成不久的壁纸等，机器可能吸入此气味附着在机体内的除湿转轮上，经加热后吹出此气味。

规格表

型 号	CH150D
除 湿 量	15L/d (27°C, 60%RH)
电 源	220 V AC / 50 Hz
电 流	3.17A
功 率	高 740 W , 低 440W
适用环境温度	1~40°C
运转噪音	45~52dB
水箱容量	3.5 L
净 重	8.8 kg
外形尺寸	H552 • W416 • D186 mm

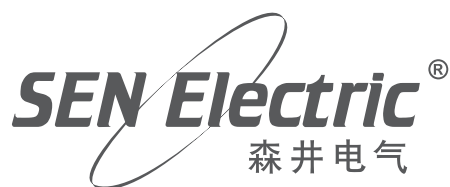

**DESICCANT
AUTO DEHUMIDIFIER**

CH150D

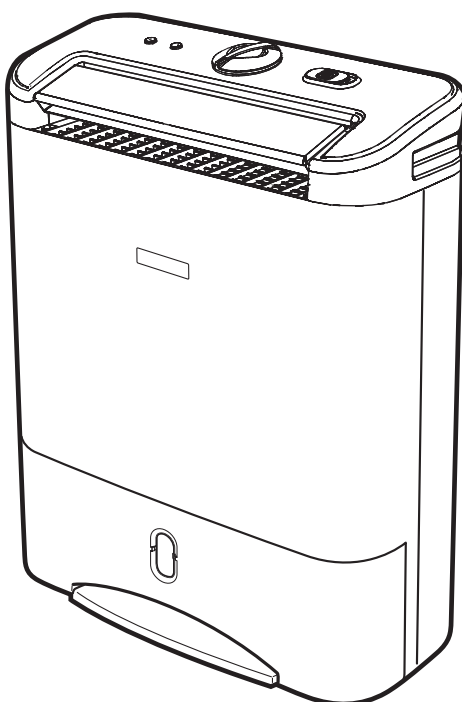

USER MANUAL

Dear customer:

Please read the manual carefully before operating. Follow the instructions to use and maintain the unit, and keep it for future reference. Please finish the service registration for obtaining well customer service afterwards.

WGI Inc U.S.A.

Contents

Introduction.....	3
Safety Notes.....	4
To Settle.....	4
The Components.....	5
Control Panel.....	6
Control Settings.....	6
Condition Indicators.....	6
To Operate.....	7
Nano-silver Filter.....	7
To Empty the Bucket when Water Full.....	8
Permanent Drain Option.....	9
To Clean the Unit.....	9
To Replace Power Cord.....	9
Before Storing.....	9
Troubleshooting.....	10
Specifications.....	11
Product Service Card.....	Back

Copyright statement

All rights reserved by **WGI** Corporation. This company retains the rights to improve the product and to change the design and/or the specifications, without further informing.

As a result of product improvement, the product that you purchase possibly incompletely consistent with the contents of the User Manual. We apologize sincerely if it happens.

If there are any printing errors, omissions or translation errors, the company doesn't undertake the consequence it produces.

Introduction

A. Advantages of desiccant rotor dehumidifier

Desiccant rotor is an excellent dehumidification method without using compressor and refrigerant so as to prevent from noise and refrigerant environmental pollution problems. It has the advantages of high performance and environmental friendliness. The unit is light-weighted for easy carry. Desiccant rotor technology gives excellent dehumidification than traditional compressor dehumidifier in lower room temperature range.

B. Features of Desiccant Auto Dehumidifier CH150D

1. High-tech and fashion

White casing gives you a confident feeling. Intelligent control functions are approached by rotary humidistat, slide switch and indication lamps. Two-speed operation and air cleaning functions let you enjoy the benefits of the product.

2. Powerful dehumidification

Even in a lower temperature, the machine keeps the same high performance. The adjustable louver at the air outlet provides warm and clean air.

3. Easy and convenient operations

Humidistat Knob: The stepless humidity settings including WET, MED, DRY and Continuous can always meet your needs.

Power Selection Switch: The slide switch let you choose Low (silent) or High speed operations.

Adjustable Louver: Let you adjust the airflow in a wide (150 degrees) range.

4. Front-accessed bucket with handle and a water level window at front.

5. Automatic stop and warning while the bucket is full.

6. Permanent drain is applicable.

7. Self-protection of automatic stop when the unit is tilted.

8. Self detection and protection when abnormal temperature occurs.

9. Weighted only 8.8 kg and easy to be carried by the handle.

C. Special air purification features

To provide you healthy air, a nano-silver filter having silver nano-particles coated on the air filter is incorporated. It acts as a bacteria killer and kills bacteria that touch the filter.

Safety Notes

1. The appliance is not to be used by children or persons with reduced physical, sensory or mental capabilities, or lack of experience and knowledge, unless they have been given supervision or instruction. Children should be supervised to ensure that they do not play with the appliance.
2. The unit runs with 220V AC/50Hz power only. The rating, wiring, circuit breaker and receptacles shall all be qualified.
3. This unit is only for indoor use and suitable for ambient temperature of 1~40°C. In order to avoid danger of electrical shock or fire, the unit must be kept away from direct sunlight, heat, explosive gas, mist, oily vapors, plenty of dust and chemical environment.
4. DO NOT operate the unit with a damaged cord or loose socket. Stop using it before calling examination and repair.
If the power cord is damaged, it may cause danger such as short circuit or fire. Prevent it to be damaged by pulled strongly, twisted, mice bite or pressed. If the power cord is damaged, power off and unplug it. Please contact your dealer. DO NOT disassemble it or use any other or unqualified power cord by yourself.
5. Turn off the machine and unplug it before cleaning, moving, maintaining or storing.
6. Never unplug the power cord by pulling the cord out of the socket. This could damage the cord and cause electrical shock or fire disaster.
7. In order to avoid damage, keep any articles away from the air inlet and air outlet.
8. In order to avoid contaminating and damaging internal parts, do not use this unit without an air filter.
9. Except for refreshing the room air, please have the doors and windows closed so as to increase the dehumidification efficiency.
10. Do not leave unit running unattended for long periods of time as a safety precaution.

To Settle

1. Please set the unit on flat ground to avoid water leakage, noise or other abnormal situation.
2. Please set the unit at safe distance away from wall, furniture or curtain for good air circulation.
3. Fit the bucket in place. The unit will not start while the bucket is not in place and the Full/Check lamp lights.

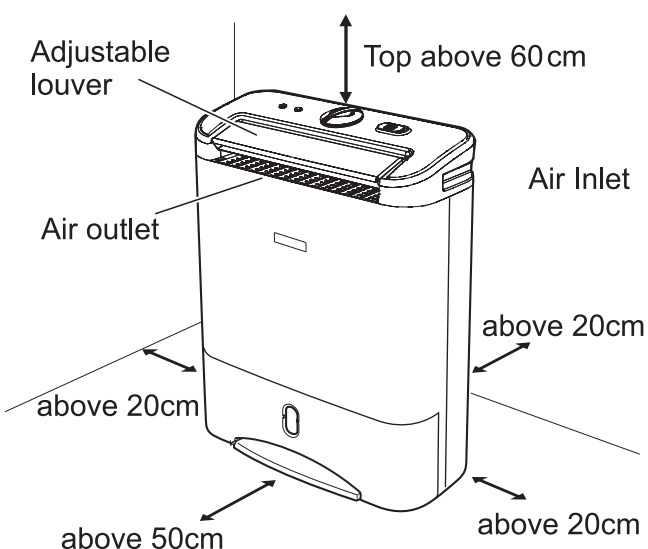

The Components

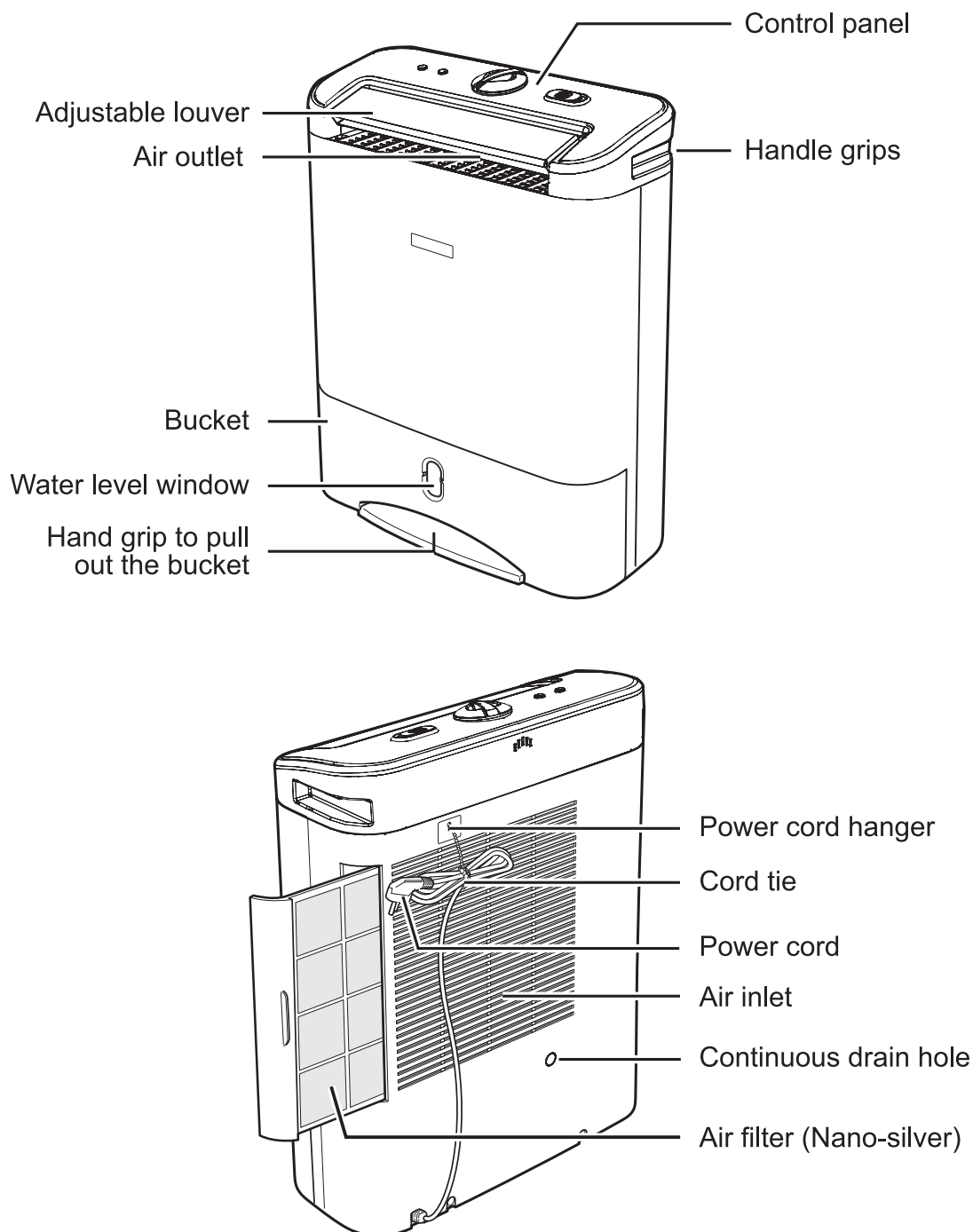

Control Panel

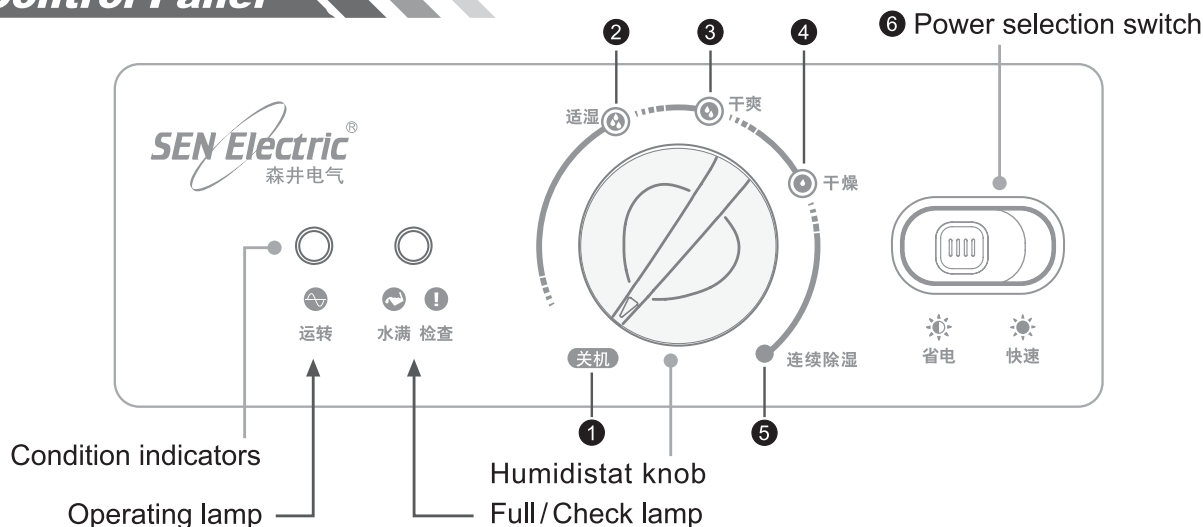

Control Settings

- ① OFF: To turn off the unit.
- ② WET: The machine automatically starts dehumidifying when the room humidity exceeds about 70%RH and stops when the room humidity is below about 60%RH.
- ③ MED: The machine automatically starts dehumidifying when the room humidity exceeds about 60% RH and stops when the room humidity is below about 50% RH.
- ④ DRY: The machine automatically starts dehumidifying when the room humidity exceeds about 50% RH and stops when the room humidity is below about 35% RH.
- ⑤ CONT.: The machine continuously dehumidifies except the bucket is full. (It will not stop if a hose drains the water out.)
- ⑥ Power Selection Switch:
HIGH (Fast): Switch the button rightward for high heating power and high fan speed.
LOW (Saving): Switch the button leftward for low heating power and low fan speed.

Condition Indicators

- ⑦ Operating Lamp: Lights up when the unit is turned on by the humidistat.
- ⑧ Full/Check Lamp: Lights up when the unit inclines, bucket full, displaced or the float damaged, the unit works at room temperature above 40°C, the air inlet or outlet being covered or other problems. The machine stops and the Full/Check lamp lights.

To Operate

1. Be aware to use a sole qualified receptacle. In order to avoid danger or fire, always use a qualified receptacle, standard connections and DO NOT share with other electrical appliances.
2. Turn the knob to "OFF" before plug the machine to power.
3. Make sure to fit the bucket in right position. When the bucket is full or not in place (or the machine overheated), the Full/Check lamp lights and the machine stops.
4. The machine is turned off when the knob is at "OFF" position. Turn the knob clockwise to turn on the unit with a suitable humidity setting. The humidistat can be set along WET (70~60%RH), MED (60~50%RH) , DRY (50~40%RH) or more humid or more dry scales to control the unit on and off automatically and keep the room humidity at a certain range. When the machine is on, the Operating Lamp lights. When the machine is off, the Operating Lamp extinguishes.
5. Turn the knob counterclockwise to "OFF" to turn off the machine.

Nano-silver Filter

- This machine applies a nano-silver air filter that can restrain germs and bacteria, and does no harms to human.
- If the filter is covered by plenty of dust, the airflow and the performance of the unit will be affected.

Please check and clean it often.

1. Turn off the unit, unplug it and remove the filter from the unit.
2. Clean the nano-silver filter only with a vacuum cleaner or soft brush. Replace the filter in position.

Prevent washing the filter. Washing may weaken the germicidal effect of the filter.

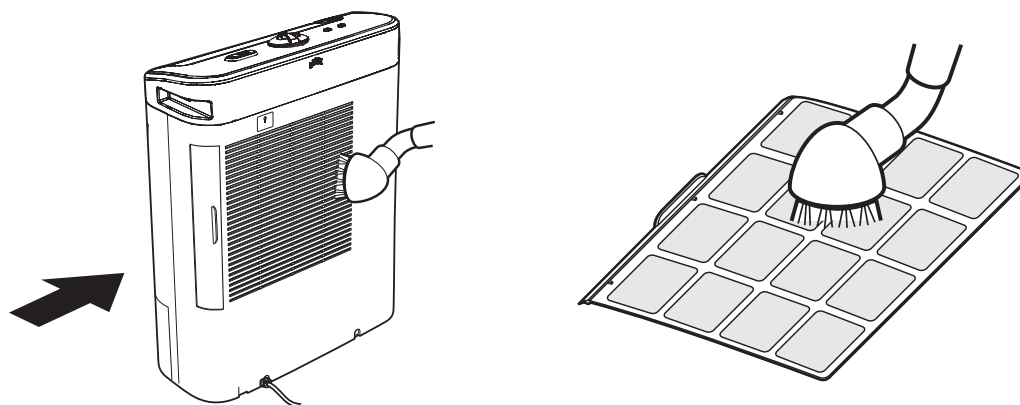

To Empty the Bucket when Water Full

1. When the bucket is full, Full/Check lamp lights. The machine stops.
2. Pull out the bucket by holding the grabbing portion. Then, carry with its handle.
3. Remove the cover first before pouring the water.
4. After pouring the water, clean the bucket and restore in place.
5. After restoring the cover and handle, replace the bucket. The Full/Check lamp will extinguish and the unit will retrieve running.

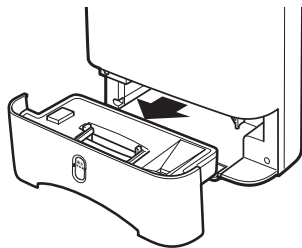

Pull out the bucket

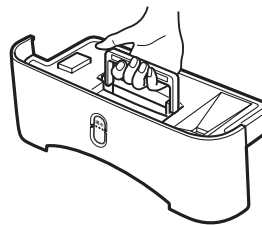

Lift by the handle

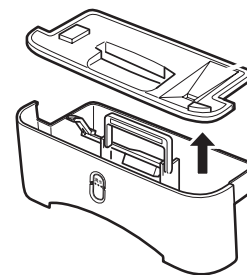

Remove the cover

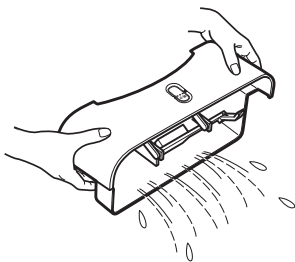

Pour the water away

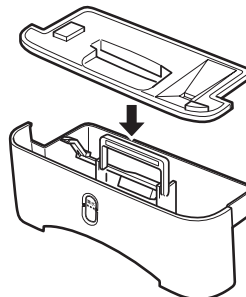

Restore the cover
and the handle

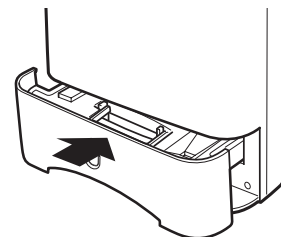

Restore the bucket

Note

1. Do not remove the bucket right after stopping the machine in order to prevent water dripping.
2. Clean the bucket with clean water. Do not use solvent, abrasive or hot water.
3. Do not remove or damage the float in the bucket, or the unit cannot work correctly.
4. The bucket cover and the handle must be well fitted in position before restoring the bucket.
5. The Full/Check lamp lights if the bucket is not well in place. Reset the bucket.

Permanent Drain Option

A hose with an inner diameter of 12mm can be connected for continuous drainage:

1. Remove the bucket;
2. Using a screwdriver, remove the 'knock-out' located on the back of the appliance and pass the hose through the hole;
3. Attach the hose firmly to the 'L' shaped drain connector;
4. Connect the 'L' shaped drain connector to the drain outlet;
5. Rotate clockwise to fix the connector into position;
6. Restore the water bucket in the correct position.

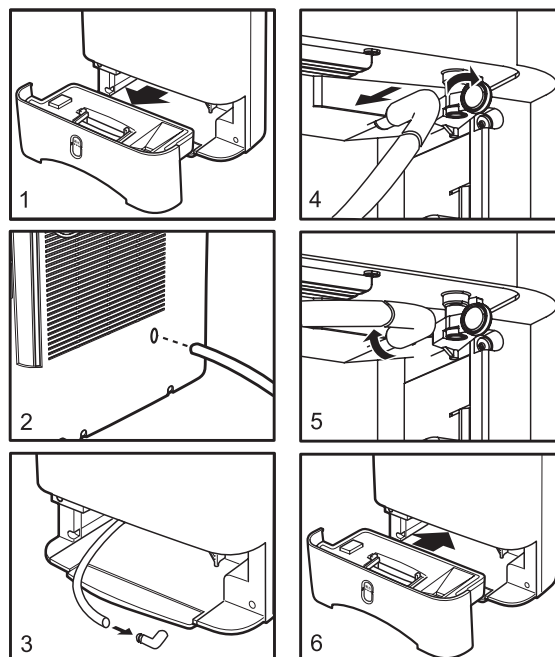

To Clean the Unit

1. Before cleaning or maintaining, turn off the unit and unplug the cord.
2. The air inlet and outlet may gather dust easily. Please clean it often with a soft cotton cloth moistured with water or soft detergent only.
3. When malfunctions occur, contact your dealer for help. DO NOT disassemble or repair it by yourself.

Warning

- In order to avoid damage, do not wash the machine with water.
- Never spray any paint, solvent or chemical to the unit. That could cause case deformation or fire.

To Replace Power Cord

If the power cord is damaged, it will cause danger of short circuit or harms. Please do not pull strongly, twist, mice bite or press the cord.

If the power cord is damaged, turn it off and unplug the machine. Please contact your dealer, do not try to repair it yourself or apply any other or unqualified power cord to the unit.

Before Storing

1. Turn off the unit and unplug the cord.
2. Clean and dry the bucket.
4. Clean the filter, the inlet, the outlet and the case.
5. Cover the unit to prevent it from gathering dust. Store it in a cool and dry place.

Troubleshooting

Problem	Possible Cause	What to Do
Dehumidifier doesn't start (no lamp)	<ol style="list-style-type: none"> 1. The unit is unplugged 2. The fuse is blown or circuit breaker is tripped 	<ol style="list-style-type: none"> 1. Make sure the plug is pushed completely into the outlet. 2. Check the house fuse / circuit breaker box and replace fuse or reset the breaker.
Full/Check lamp lights	<ol style="list-style-type: none"> 1. The tank is full or not in place 2. The unit inclines or falls down 3. The air inlet or outlet is covered 4. The ambient temperature is too high, such as over 40°C 	<ol style="list-style-type: none"> 1. Empty the tank, check the float in position, and replace the bucket. 2. Place the unit on a stable, level surface. 3. Make sure there is nothing blocking the air inlet and air outlet of the unit. Clean the filter. Wait at least 30 minutes to restart. 4. Do not use it in a small and closed place where heat accumulates. Move to a cooler place, wait at least 30 minutes to restart.
Water on floor	<ol style="list-style-type: none"> 1. The unit is not placed well 2. The drainage is clogged or loose 	<ol style="list-style-type: none"> 1. Replace the unit. 2. Check the drainage hose and its connection.

Should there still be a problem, please unplug the unit and contact us. Do not try to repair it yourself.

- When you first use the dehumidifier and periodically afterwards you might notice a smell coming from the dehumidifier. This is caused by the Zeolite desiccant material and is not a sign that the dehumidifier is faulty, nor is it harmful to humans or pets. The smell occurs because the Zeolite absorbs odors from items like cigarettes, cosmetics, hair sprays, building materials and new furniture and then when the desiccant is heated the smell is discharged into the room. This smell is normal, will not last long and is not a sign of a fault. Please ventilate the room occasionally to remove the possible odor.

Specifications

MODEL	CH150D
Dehumidification	15L/d (27°C, 60%RH)
Power Source	220 V AC / 50 Hz
Current	3.17A
Power consumption	High 740W , Low 440W
Working Environment	1~40°C
Refrigerant	45~52dB
Bucket Volume	3.5 L
Net Weight	8.8 kg
Dimensions	H552 • W416 • D186 mm

SEN 森井电气产品保修卡 A 联 No.

产品名称：_____ 型 号：_____ 制造序号：_____
销售单位：_____ 票据号码：_____ 购机日期：_____
用户名称：_____ 地 址：_____
电 话：_____ 传 真：_____ 邮 编：_____

- 此联请交供货商。

—— — — — 请沿虚线剪下 ✂ — — — — —

SEN 森井电气产品保修卡 B 联 No.

产品名称：_____ 型 号：_____ 制造序号：_____
销售单位：_____ 票据号码：_____ 购机日期：_____
用户名称：_____ 地 址：_____
电 话：_____ 传 真：_____ 邮 编：_____

产 品 保 修 服 务 须 知

- 一、请于购机后15天内办理保修。
- 二、保修期：自购机之日起（以购机票据日期为准）一年。在保修期内，因产品质量问题所致的零配件损坏或机器故障，均可免费更换或修复。
- 三、保修期内如有以下情况，均不能享受保修服务：
 - 1、用户因安装、使用、保管不当而引起的损坏或故障；
 - 2、非授权单位或用户自行拆卸、维修而造成的损坏或故障；
 - 3、因不可抗力(如水灾、火灾、雷电、地震等)而造成的损坏或故障；
 - 4、无办理保修及购机单据，购机单据与产品不符或被涂改。
- 四、保修期以外及因本“保修须知”第三条款内容所引起的零配件损坏或故障，更换或修复均需收费。
- 五、产品经维修后，如在三个月内因质量问题发生同一零配件损坏或故障时可免费更换或修复。

产品保修办理方式

尊敬的用户：

为了保证您得到优质的售后服务，请仔细阅读“保修服务须知”（使用手册封三）后，以如下方式办理产品保修手续：

- 一. 请登陆：www.CN-SEN.com，点击“服务与支持”栏目中的“保修登记”或网页左下角的“保修办理”，进入“保修登记”，请认真填写页面中表格内容后点击“提交”即可完成保修登记，我们将以电子邮件回复确认。
- 二. 请以手机短信将产品型号、制造序号、票据号码、购机日期、用户名称、地址、联系电话发送到手机：**13825120884**即可完成保修登记，我们将回复短信确认。
- 三. 在供货商送货上门或安装时填写“产品保修卡”，直接办理保修。

产品可送到维修中心或供货商处进行保修(维修)。您有任何需求请随时与我们联系，我们将竭诚为您服务。

SEN 森井电气服务中心 地址：广州市东风中路445号越秀城市广场北塔33楼
24小时服务热线：(020)83568853 传真：(020)83561700 邮编：510045
E-mail: info@cn-sen.com **Web:** www.CN-SEN.com

SEN 森井电气产品维修中心通讯录

地 址	电 话	邮 编
大连市 富国街62号1单元301室	(0411)84398513	116021
北京市 朝阳区十里堡1号院恒泰大厦A座3029B	(010)85821436	100025
上海市 徐汇区斜土路2601号嘉汇广场T2~6D	(021)64687082	200030
合肥市 绩溪路361号惠康大厦518室	(0551)3638584	230022
广州市 东风中路445号越秀城市广场北塔33楼	(020)83566471	510045
深圳市 罗湖区笋岗东路3013号长虹大厦1805室	(0755)88831871	518001
成都市 洗面桥街25号A栋B座407室	(028)85571363	610041
南宁市 星湖路27~15号	(0771)5870182	530022