



**USINES DE ROSIÈRES**

30, RUE Y. LACELLE -

Rosières

18400 - Lunery

France

## COFFEE AND CAPPUCCINO MAKER

## MACHINE À CAFÉ ET À CAPPUCCINO

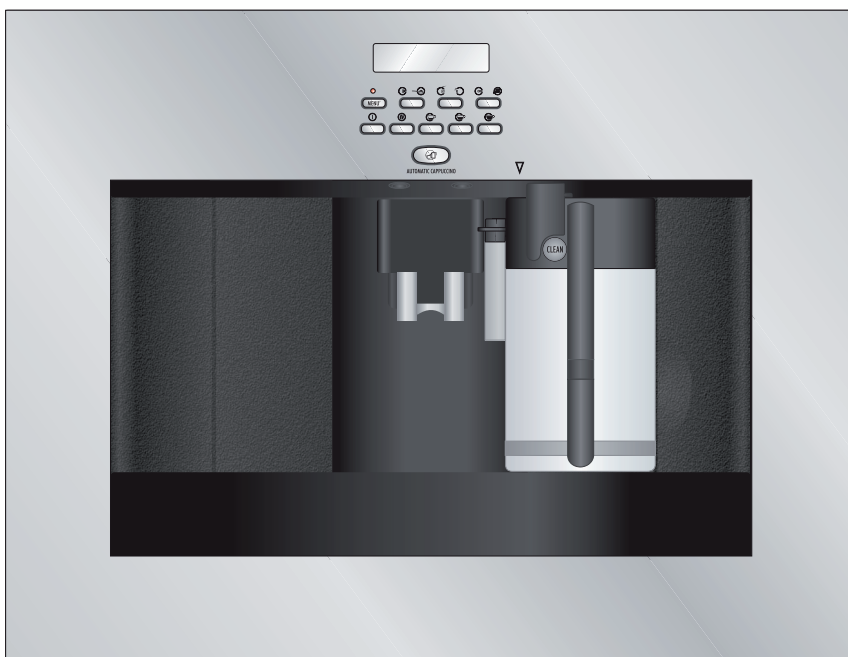

RCC46MIN

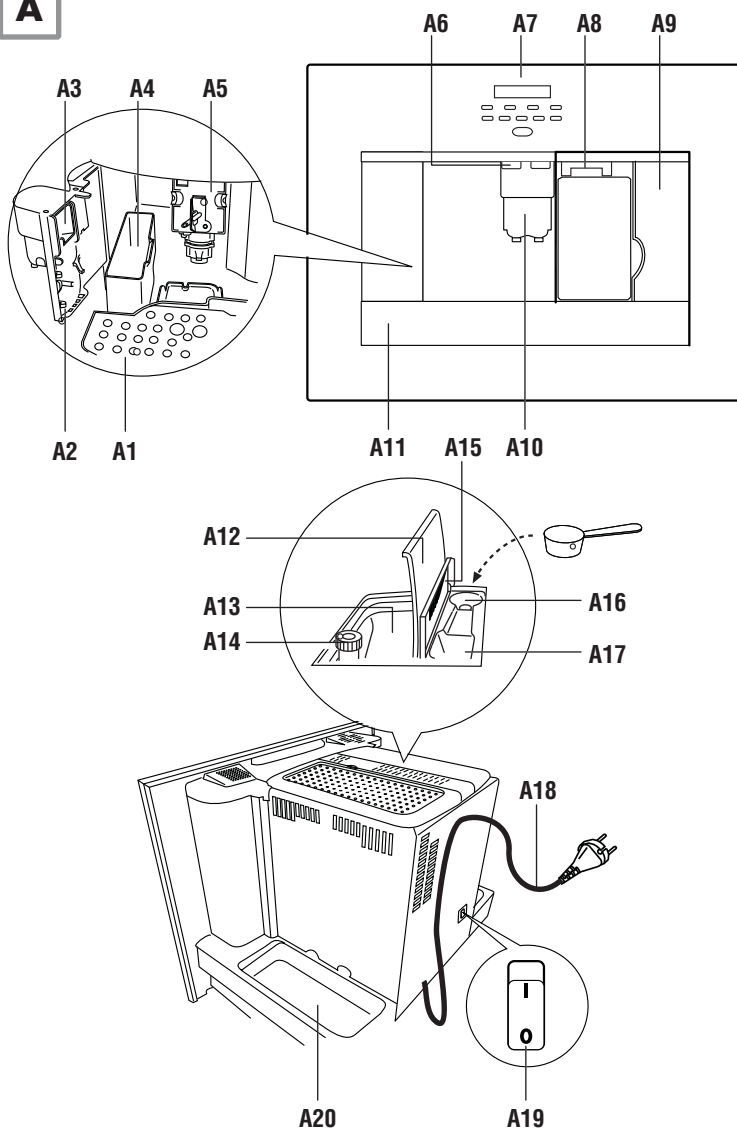
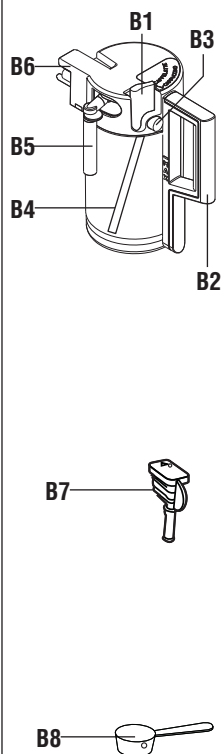
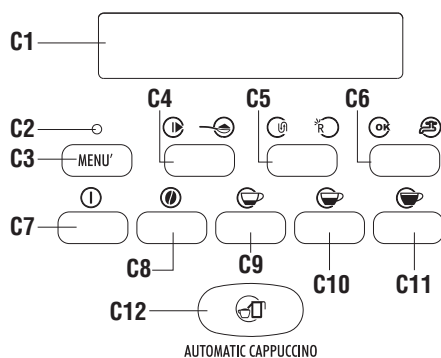

**A****B****C**

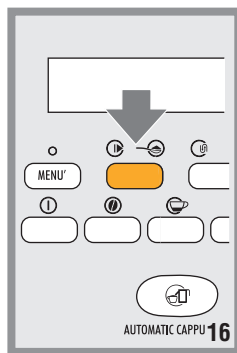
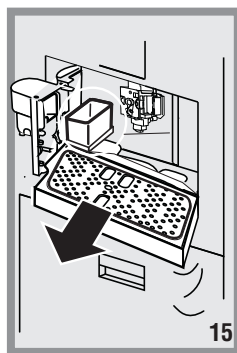
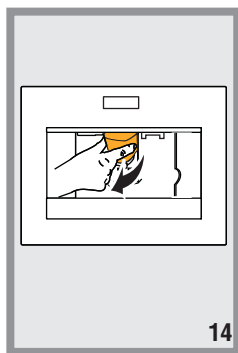
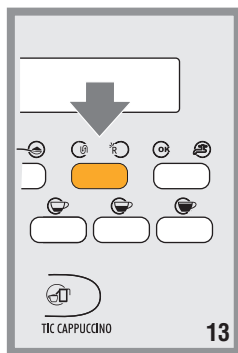
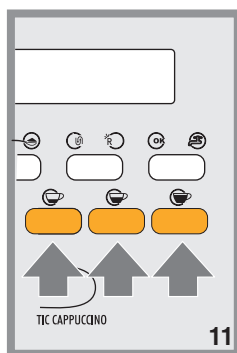
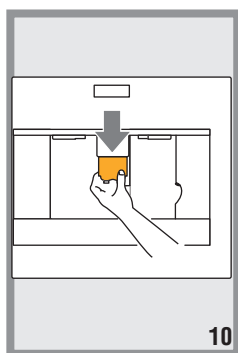
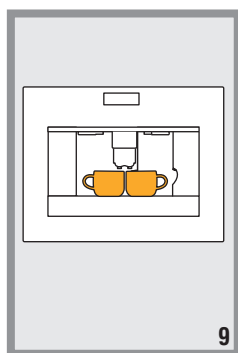
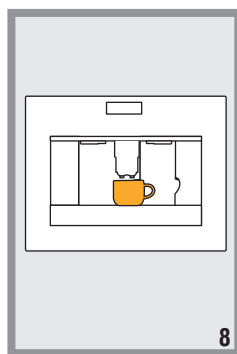
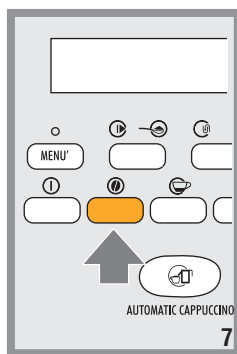
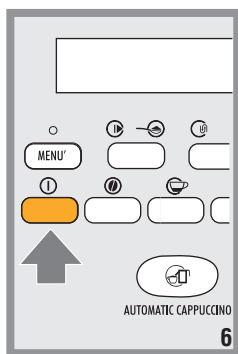
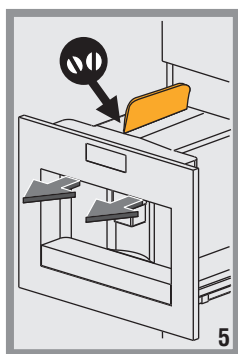
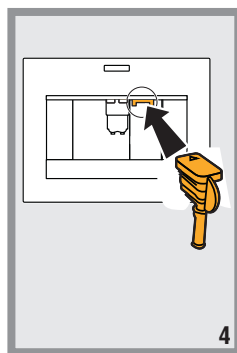
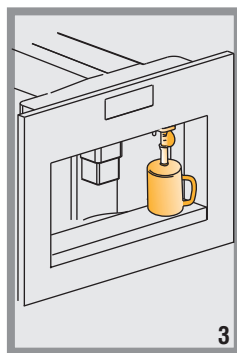
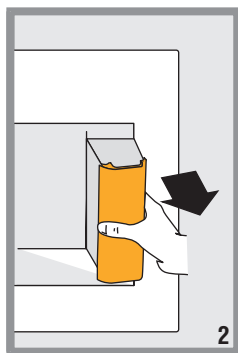
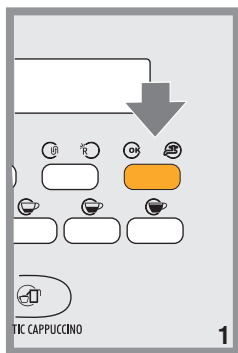

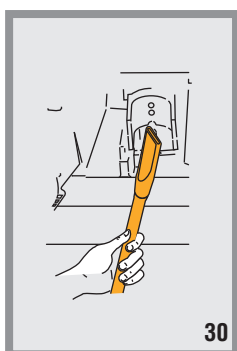
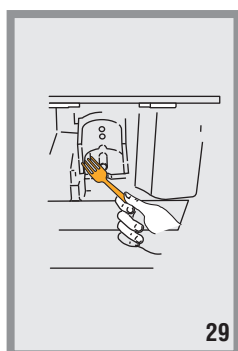
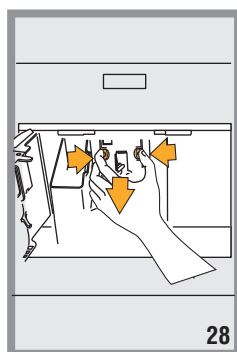
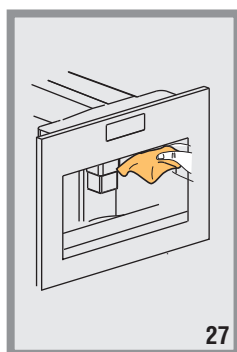
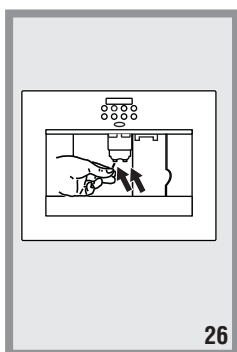
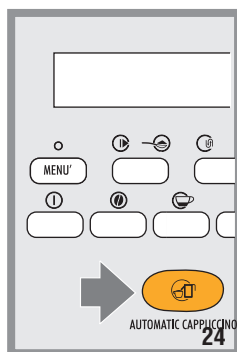
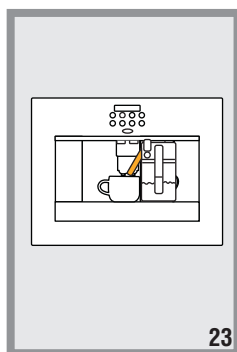
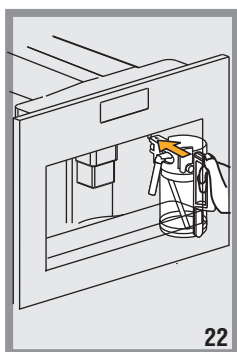
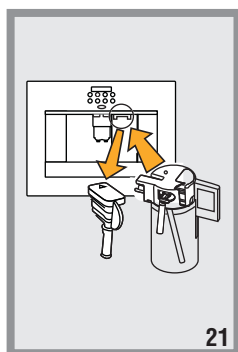
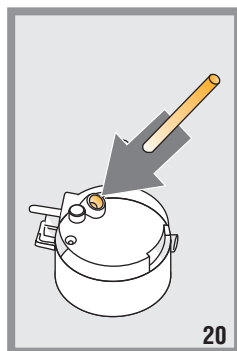
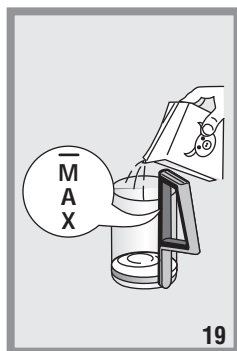
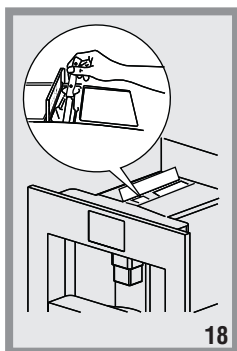
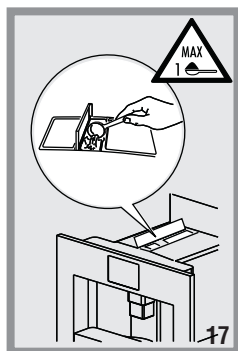

# INDEX

<b>INTRODUCTION .....</b>	<b>7</b>
Symbols used in these instructions .....	7
Letters in brackets.....	7
Troubleshooting and repairs .....	7
<b>SAFETY .....</b>	<b>7</b>
Fundamental safety warnings.....	8
Designated use .....	8
Instructions .....	8
<b>DESCRIPTION .....</b>	<b>8</b>
Description .....	8
Description of milk container and accessories .....	8
Description of control panel .....	8
<b>PRELIMINARY CHECKS.....</b>	<b>9</b>
Controls after transport .....	9
Installing the appliance .....	9
Connecting the appliance.....	9
<b>AUTOMATIC CUP TRAY LIGHTING .....</b>	<b>9</b>
<b>BUILT-IN INSTALLATION .....</b>	<b>10</b>
<b>USING THE APPLIANCE FOR THE FIRST TIME .....</b>	<b>12</b>
<b>TURNING ON AND HEATING UP .....</b>	<b>12</b>
<b>PREPARING COFFEE USING COFFEE BEANS .....</b>	<b>13</b>
<b>CHANGING THE QUANTITY OF COFFEE IN THE CUP .....</b>	<b>14</b>
<b>ADJUSTING THE COFFEE MILL .....</b>	<b>14</b>
<b>PREPARING ESPRESSO COFFEE WITH PRE-GROUND COFFEE (INSTEAD OF COFFEE BEANS) .....</b>	<b>15</b>
<b>HOT WATER DELIVERY .....</b>	<b>15</b>
<b>CHANGING THE QUANTITY OF HOT WATER.....</b>	<b>15</b>
<b>PREPARING CAPUCCINO (FROTHED MILK AND COFFEE).....</b>	<b>15</b>
<b>PREPARING FROTHED MILK (WITHOUT COFFEE) .....</b>	<b>16</b>

<b>CHANGING THE QUANTITY OF COFFEE AND MILK FOR CAPPUCCINO .....</b>	<b>17</b>
--	-----------

<b>CLEANING AND MAINTENANCE .....</b>	<b>17</b>
Cleaning the coffee maker .....	17
Cleaning the infuser .....	17
Cleaning the milk container .....	18

<b>MODIFICA E IMPOSTAZIONE DEI PARAMETRI DEL MENU' .....</b>	<b>18</b>
Setting the clock .....	18
Setting auto-start time .....	19
Descaling .....	19
Changing coffee temperature .....	20
Changing the length of time the appliance remains on.....	20
Setting water hardness .....	20
Resetting factory default values (reset) ..	20
Washing procedure .....	20

<b>CHANGING THE LANGUAGE .....</b>	<b>20</b>
------------------------------------	-----------

<b>DISPLAYED MESSAGES .....</b>	<b>21</b>
---------------------------------	-----------

<b>TROUBLESHOOTING .....</b>	<b>23</b>
------------------------------	-----------

<b>TECHNICAL SPECIFICATION .....</b>	<b>25</b>
--------------------------------------	-----------

<b>DISPOSAL .....</b>	<b>25</b>
-----------------------	-----------

## INTRODUCTION

Thank you for choosing the automatic coffee and cappuccino maker.

We hope you enjoy using your new appliance.

Take a few minutes to read these instructions.

This will avoid all risks and damage to the appliance.

### Symbols used in these instructions

Important warnings are identified by these symbols.

These warnings must absolutely be respected.

Failure to observe the instructions could result in electric shock, serious injury, burns, fire or damage to the appliance.



**Danger!**

Failure to observe the warning could result in possibly life threatening injury from electric shock.



**Important!**

Failure to observe the warning could result in injury or damage to the appliance.



**Danger of burns!**

Failure to observe the warning could result in scalds or burns.



**NB:**

This symbol identifies important advice or information for the user.

### Letters in brackets

The letters in brackets refer to the legend in the Description of the Appliance on page 3.

### Troubleshooting and repairs

In the event of problems, first try and resolve them following the information given in the sections "Displayed messages" on page 21 and "Troubleshooting" on page 23.

### Customer assistance service

If you cannot identify the cause of the operating anomaly, switch off the appliance (do not subject it to rough treatment) and contact the Assistance Service.

PRODUCT SERIAL NUMBER. Where can I find it?

It is important you to inform the Assistance Service of your product code and its serial number

(a 21 character code which begins with the number 3); this can be found on the guarantee certificate or on the data plate located on the appliance. It will help to avoid waster journeys to technicians, thereby (and most significantly) saving the corresponding callout.

## SAFETY

### Fundamental safety warnings



**Danger!** This is an electrical appliance and may therefore cause electric shock.

You should respect the following safety warnings:

- Never touch the appliance with damp hands.
- Never touch the plug with damp hands.
- Make sure the socket used is freely accessible at all times, enabling the appliance to be unplugged when necessary.
- Unplug directly from the plug only.  
Never pull the power cable as you could damage it.
- To disconnect the appliance completely you must unplug it from the mains socket.
- If the appliance is faulty, do not attempt to repair.  
Turn it off, unplug from the mains socket and contact a technical service centre.
- If the plug or power cable is damaged, it must be replaced by a technical service centre only to avoid all risk.



**Danger!** Keep all packaging (plastic bags, polystyrene foam) away from children.



**Danger!** Do not allow the appliance to be used by persons (including children) with psychological, physical or sensory impairments or with inadequate experience or knowledge, unless closely supervised and instructed by someone responsible for their safety.

Children must be supervised to ensure they do not play with the appliance.



**Important: Risk of burns!** This appliance produces hot water and steam may form while it is in operation.

Avoid contact with splashes of water or hot steam. Avoid touching hot surfaces when the appliance is in use. Use knobs and handles.



**Danger!** Do not grasp the coffee maker when it is out of the cabinet.



Do not rest recipients containing liquids or inflammable or corrosive materials on top of the appliance. Place the accessories required to prepare the coffee (the measure for example) in the special holder.

Do not rest large objects which could obstruct movement or unstable objects on the appliance.



Never make coffee, hot water or steam when the appliance is extracted. Always make sure the appliance is inactive before extracting it. Failure to observe this precaution could lead to damage to the appliance!

## Designated use

This appliance is designed and made to prepare coffee and heat drinks.

All other use is considered improper.

This appliance is not suitable for commercial use. The manufacturer is not liable for damage deriving from improper use of the appliance.

## Instructions

Read these instructions carefully before using the appliance.

- Keep these instructions  
If the appliance is passed to other persons, they must also be provided with these instructions.
- Failure to respect these instructions may result in burns or damage to the appliance.  
The manufacturer is not liable for damage deriving from failure to respect these instructions.

## DESCRIPTION

### Description

(page 3 - **A**)

- A1. Cup tray
- A2. Service door
- A3. Mobile drawer
- A4. Coffee grounds container
- A5. Infuser
- A6. Lights
- A7. Control panel
- A8. Hot water and steam nozzle
- A9. Water tank
- A10. Coffee spout (adjustable height)
- A11. Drip tray
- A12. Bean container lid
- A13. Container for coffee beans
- A14. Grinding adjustment knob
- A15. Ground coffee feed door
- A16. Compartment for measure
- A17. Ground coffee feed funnel
- A18. Power cable
- A19. ON/OFF switch
- A20. Accessories holder

### Description of milk container and accessories

(page 3 - **B**)



- B1. Milk frother pointer
- B2. Milk container handle
- B3. CLEAN button
- B4. Milk intake tube
- B5. Frothed milk spout
- B6. Milk frother
- B7. Hot water spout
- B8. Measure



### Description of control panel

(pag. 3 - **C**)

*A number of buttons on the panel have a dual function.*

*This is indicated in brackets in the description.*

- C1. Display: guides the user in using the appliance.
- C2. Menu light
- C3. Button to activate or deactivate menu parameter setting mode
- C4. Ground coffee selection button  
(When you access the MENU: press the  button to display the next menu parameter.
- C5. Rinse button  : performs a brief rinse to heat the infuser.

- (When you access the MENU: press the  button to modify menu parameters).
- C6. Hot water button.  
(When you access the MENU: press the  button to confirm menu parameters).
- C7.  button: turns the appliance on and off.
- C8. Coffee taste button
- C9. One/two cups short coffee button
- C10. One/two cups standard coffee button
- C11. One/two cups long coffee button
- C12. Cappuccino/frothed milk button

## PRELIMINARY CHECKS

### Controls after transport

After removing the packaging, make sure the product is complete and undamaged and that all accessories are present.

Do not use the appliance if it is visibly damaged. Contact the technical service centre.

### Installing the appliance



#### **Important!**

When installing the appliance, respect the following safety warnings:

- Installation must be performed by a qualified professional in compliance with legislation in force in the country of installation (see BUILT-IN INSTALLATION).
- The packing elements (plastic bags, polystyrene foam, etc.) should be kept out of reach of children as they are a safety hazard.
- Do not install the appliance in rooms where the temperature may drop to 0°C or lower (the water in the appliance could freeze and cause damage).
- You should customise the water hardness as soon as possible following the instructions in the "SETTING WATER HARDNESS" chapter.

### Connecting the appliance



#### **Danger!**

Check that the mains power supply voltage corresponds to the value indicated on the rating plate on the bottom of the appliance.

Connect the appliance to an efficiently earthed and correctly installed socket with a minimum current rating of 10A only.

If the power socket does not match the plug on the appliance, have the socket replaced with a sui-

table type by a qualified professional.

To comply with safety directives, an omnipolar switch with a minimum contact distance of 3 mm must be installed.

Do not use multiple sockets or extensions.

To learn to use the appliance correctly, the first time you use it follow the detailed instructions in the following paragraphs.

## AUTOMATIC CUP TRAY LIGHTING

The appliance automatically lights the spout and drip tray while delivering coffee, steam and hot water.

After delivery, the lights remain on and the cooling fan comes into operation to prevent condensate from forming inside the cabinet. After a few minutes, both the lights and the fan go off automatically.



**NB:** The appliance completes this cycle even if turned off by pressing the  button.

## BUILT-IN INSTALLATION

Verify the minimum measurements required for correct installation of the appliance.

The coffee maker must be installed in a column and the column must be firmly fixed to the wall with commercially available brackets.

### Important:

- Important: all installation or maintenance operations must be performed with the appliance disconnected from the mains electricity supply.
- Kitchen furniture in direct contact with the appliance must be heat resistant (65°C min).
- To guarantee correct ventilation, leave a gap at the bottom of the cabinet (see measurements in figure).

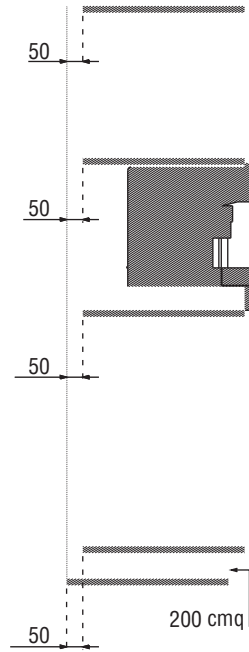
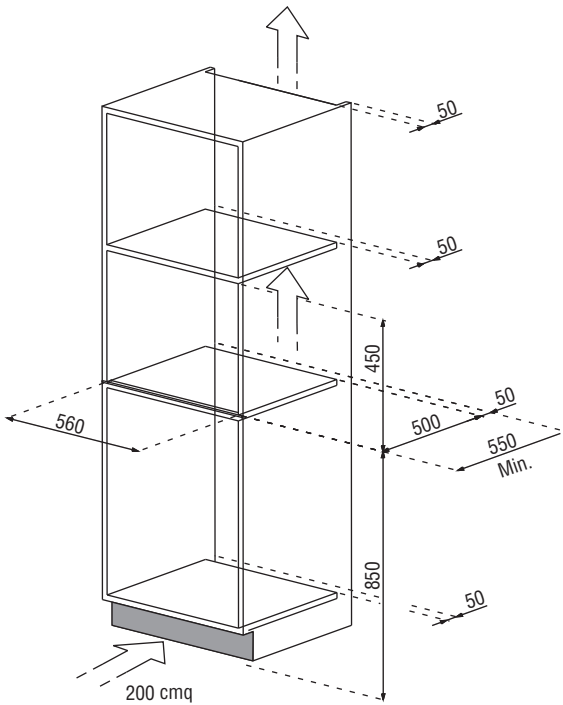
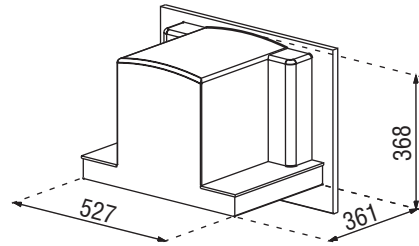
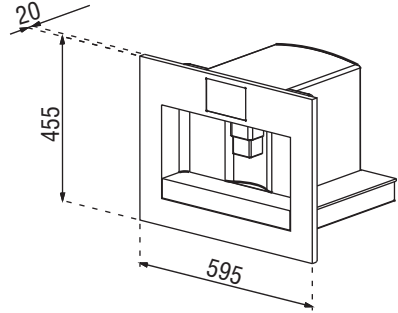

1

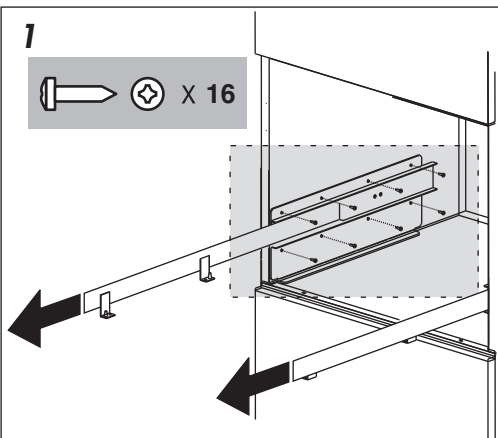
 X 16

Rest the rails on the surface of the cabinet.  
Fix with the screws, then extract them completely.

If the coffee maker is installed over a warmer drawer, use the top surface of this as a reference to position the rails.

In this case, there will be no surface to rest the rails on.

2

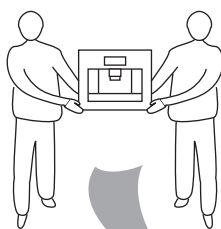
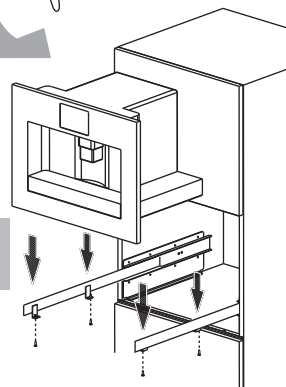
 X 4

Position the appliance on the rails, making sure the pins are correctly inserted in the housings, then fix it with the screws supplied.

3

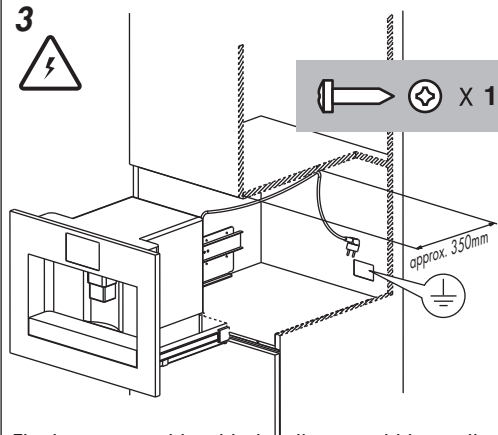
 X 1

Fix the power cable with the clip to avoid it tangling when the appliance is inserted or extracted.  
The power cable must be long enough to allow the appliance to be extracted from the cabinet to fill the coffee bean container.

**The appliance must be earthed in compliance with legislation. Electrical connections must be performed by a qualified electrician in compliance with the manufacturer's instructions and legislation in force in the country of installation.**  
The electrical socket must be accessible.

4

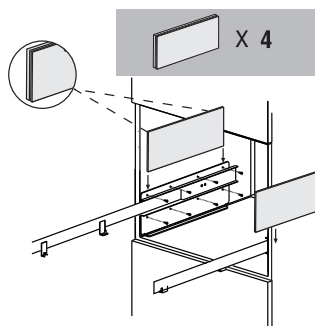

If necessary, correct alignment of the appliance by positioning the spacers supplied under or at the sides of the support.

## USING THE APPLIANCE FOR THE FIRST TIME

 **NB!** The first time the appliance is turned on and each time it is plugged in, when the ON/OFF switch (A) is pressed, the appliance will perform an AUTO-DIAGNOSIS cycle and then go off. To turn it on again, press the ① button (C7) on the control panel.

- Coffee has been used to factory test the appliance and it is therefore completely normal for there to be traces of coffee in the mill. The machine is, however, guaranteed to be new.
- You should customise water hardness as soon as possible following the instructions in the "Setting water hardness" chapter.

1. Connect the appliance to the mains supply.

You must select the required language:

2. To set English, wait for the appliance to display: "PRESS OK TO INSTALL ENGLISH". While the message is displayed, press the  button (fig. 1) for at least three seconds until you hear a BEEP (fig. 1) and "ENGLISH INSTALLED" is displayed. The appliance then displays the setting confirmed message in English.

If you set the wrong language by mistake, follow the instructions in the chapter "Changing the language" to choose the right language.

Follow the instructions indicated by the appliance:

3. After 5 seconds, the appliance displays "fill tank". To fill the water tank, remove (fig. 2), rinse and fill with fresh water without exceeding the MAX line. Replace the tank and push as far as it will go.
4. Place a cup under the hot water spout (fig. 3). (If the water spout is not inserted, the appliance displays "INSERT WATER SPOUT". Attach it as shown in figure 4, making sure the arrows on the spout and on the machine control panel are aligned.) The appliance now displays: "PRESS OK". Press the  button (fig. 1) and after a few seconds a little water comes out of the spout. (Delivery stops automatically).
5. The appliance now displays: "TURNING OFF... PLEASE WAIT" and goes off.
6. Extract the appliance by pulling it out using the handles (fig. 5). Open the lid and fill the container with coffee beans, then close the lid

and push the appliance in.

 **Important:** To prevent malfunction, never introduce pre-ground coffee, freeze dried coffee, caramelised beans or any other substance which could damage the appliance.

The coffee maker is now ready for normal use.

 **NB!** When using the appliance for the first time, you need to make 4/5 cups of coffee and 4/5 cappuccinos before the appliance starts to give satisfactory results.

## TURNING ON AND HEATING UP

Each time the appliance is turned on, it performs an automatic preheat and rinse cycle which cannot be interrupted.

The appliance is ready for use only after completion of this cycle.



**Danger of burns!** During rinsing, a little hot water is delivered from the coffee spouts. Avoid contact with splashes of water.

- To turn the appliance on, press the ① button (fig. 6). The message "Heating Up... Please Wait" is displayed.

After heating, the message "RINSING" is displayed. As well as heating the boiler, the appliance also heats the internal circuits by circulating hot water.

The appliance is at temperature when the message "READY STANDARD TASTE" is displayed.



## PREPARING COFFEE USING COFFEE BEANS

1. The appliance is preset to make coffee with a standard taste.

You can also choose coffee with an extra-mild, mild, strong or extra-strong taste.

To choose the required taste, press the  button (fig. 7). The required coffee taste is displayed.

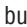
2. Place 1 cup under the spouts to make 1 coffee (fig. 8) or 2 cups for 2 coffees (fig. 9). Lower the spouts as near as possible to the cup for a creamier coffee (fig. 10).

3. Press the  button to make a short coffee (fig. 11), the  button for a standard coffee and the  button for a long coffee. To make 2 coffees, press the button twice (within 2 seconds).

To change the quantity of coffee the appliance delivers automatically into the cup, proceed as described in the following chapter.

(The appliance now grinds the beans and starts delivering the coffee into the cup.

Once the set amount of coffee has been delivered, the machine stops delivery automatically and expels the pellet of used coffee grounds into the grounds container.

4. After a few seconds, the ready message is displayed again and you can make another coffee.
5. To turn the appliance off, press the  button. Before going off, the appliance performs an automatic rinse cycle (a little hot water is delivered from the spouts and is collected in the drip tray beneath. Take care to avoid scalds).

**NOTE 1:** If the coffee is delivered a drop at a time or not at all, turn the grinding adjustment knob (fig. 12) one click clockwise (see the "Adjusting the coffee mill" chapter).



Proceed one click at a time until coffee delivery is satisfactory.



**NOTE 2:** If the coffee is delivered too fast and the cream is not satisfactory, turn the grinding adjustment knob (fig. 12) one click anticlockwise (see the "Adjusting the coffee mill" chapter).

Avoid turning the grinding adjustment knob excessively otherwise when you select 2 cups, the coffee may be delivered in drops.

**NOTE 3:** Tips for a hotter coffee:

- When you turn the appliance on, if you want to make a short coffee (less than 60 cc), rinse the cups with hot water to preheat the cups. If more than 2/3 minutes have passed since the last coffee made, before requesting another coffee, you must preheat the infuser by pressing the  button (fig. 13). Deliver the water into the underlying drip tray or alternatively use this water to fill (and then empty) the cup to be used for the coffee, so as to preheat it.
- Unless preheated, do not use excessively thick cups as they will absorb too much heat.
- Use cups that have been preheated by rinsing them with hot water or by leaving them for at least 20 minutes on the cup warmer tray on top of the appliance with the appliance on.

**NOTE 4:** While the appliance is making coffee, delivery can be interrupted at any moment by pressing the previously selected button, ,  or .

**NOTE 5:** As soon as delivery is finished, to increase the quantity of coffee in the cup, just hold down the previously selected coffee button ( ,  or  ) until the required amount is reached (this must be done within three seconds after completion of delivery).

**NOTE 6:** When the appliance displays "fill tank", fill the tank with water or the appliance will not make coffee.

(It is normal for there to be a little water left in the tank when the message is displayed).

**NOTE 7:** After about 14 single (or 7 double) coffees, the appliance displays: "EMPTY GROUNDS CONTAINER" indicating that the grounds container is full and must be emptied and cleaned.

Until the grounds container has been cleaned, the appliance continues to display the message and coffee cannot be made.

To clean, open the service door on the front of the appliance by pulling the handle (fig. 14), extract the drip tray (fig. 15), empty and clean.

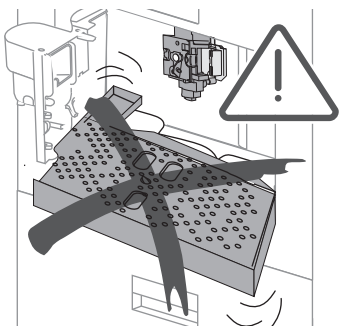

*When cleaning, **always extract the drip tray completely** to avoid it falling when the grounds container is removed.*

Empty the grounds container and clean thoroughly to remove all residues left on the bottom.



**Important:** when removing the drip tray, the grounds container **MUST** be emptied, even if it is not completely full.

If this is not done, when you make the next coffees, the grounds container may fill up more than expected and clog the machine.



**NOTE 8:** Never extract the water tank while the machine is delivering coffee.

If it is removed, it will not be possible to make the coffee and the appliance will display: "GROUND TOO FINE ADJUST MILL, INSERT WATER SPOUT AND PRESS OK".



To use the appliance again, insert the hot water spout (fig. 4) if not already in position, then press the  button and deliver water from the spout for a few seconds.

## CHANGING THE QUANTITY OF COFFEE IN THE CUP

The appliance is factory preset to automatically deliver the following quantities of coffee:

- short coffee (40 ml) when the  button is pressed;
- standard coffee (80 ml) when the  button is pressed;
- long coffee (125 ml) when the  button is pressed.

To change these quantities, proceed as follows:

- press the button corresponding to the quantity you want to change ( ,  or  ) for at least 3 seconds then release until the message "PROGRAM QUANTITY" is displayed and coffee delivery commences;
- when the coffee in the cup reaches the required level, press the same button again to memorise the new amount.

The appliance is now re-programmed with the new settings and displays: "READY".

## ADJUSTING THE COFFEE MILL

The coffee mill is preset in the factory to prepare coffee correctly and should not require regulating initially.

However, if after making the first few coffees you find that delivery is either too fast or too slow (in drops), this can be corrected by regulating the grinding adjustment knob (fig. 12).

Turn one click clockwise (one number) for more rapid coffee delivery (not in drops).

Turn one click anticlockwise for slower coffee delivery and a creamier coffee.

These adjustments will only be evident after at least 2 cups of coffee have been made.

The grinding adjustment knob must only be turned when the coffee mill is in operation.

*For slower delivery and creamier coffee, turn one click anticlockwise (finer ground coffee).*

*For faster delivery (not in drops), turn one click clockwise (coarser ground coffee).*



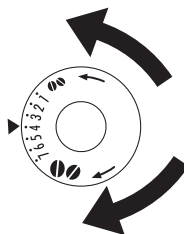

(Coffee has been used to factory test the appliance and it is therefore completely normal for there

to be traces of coffee in the mill.

It is, however, guaranteed to be new.)



## PREPARING ESPRESSO COFFEE WITH GROUND COFFEE (INSTEAD OF BEANS)

- Press the  button (fig. 16) to select the ground coffee function. This disables the coffee mill function.  
The appliance now displays the message: "READY PRE-GROUND".
- Extract the machine by pulling it outwards using the handles.
- Lift the central lid, place one measure of pre-ground coffee in the funnel (see fig. 17). Push the appliance in then proceed as described in the chapter "Preparing coffee using coffee beans".  
NB: You can make just one coffee at a time by pressing the ,  or  button once only.
- After using the machine with pre-ground coffee, to go back to making coffee using beans, deactivate the pre-ground coffee function by pressing the  button again to enable the coffee mill.

**NOTE 1:** Never introduce pre-ground coffee when the machine is off or it could spread through the inside of the appliance.



**NOTE 2:** Never add more than one level measure, otherwise either the appliance will not make the coffee and the pre-ground coffee will be dispersed inside the appliance, dirtying it, or the coffee will be delivered a drop at a time.

**NOTE 3:** Use the measure provided to add the right amount of coffee.

**NOTE 4:** Introduce only pre-ground coffee for espresso coffee machines into the funnel. Never fill with coffee beans, freeze dried coffee or other substance that could damage the appliance.

**NOTE 5:** If more than one measure of pre-ground coffee is used and the funnel clogs, push the coffee down with a knife (fig. 18) then remove and clean the infuser and machine as described in the "Cleaning the infuser" chapter.

## HOT WATER DELIVERY

- Always make sure the appliance is ready.
- Make sure the water spout is in place (fig. 4);
- Position a container under the spout (fig. 3).
- Press the  button (fig. 1).  
The message "hot water" is displayed and hot water is delivered from the water spout into the container.  
(You should not deliver hot water for more than two minutes at a time).  
To interrupt the flow, press the  button.  
Once the set quantity of hot water has been reached, delivery stops automatically.

## CHANGING THE QUANTITY OF HOT WATER

The appliance is factory preset to automatically deliver 250 ml of hot water.

To change these quantities, proceed as follows:

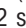
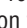
- Attach the water spout (fig. 4).
- Position a container under the spout (fig. 3).
- Press the  button for at least 2 seconds then release.  
The message "HOT WATER PROGRAM QUANTITY" is displayed and hot water is delivered from the water spout.
- When the hot water in the cup reaches the required level, press the  button to memorise the new amount.  
(You should not deliver hot water for more than two minutes at a time).

## PREPARING CAPPUCCINOS (FROTHED MILK AND COFFEE)

- Select the taste of the coffee you want to use to make the cappuccino by pressing the button .
- Remove the milk container lid.
- Fill the container with about 100 grams of milk for each cappuccino to be prepared (fig. 19). Never exceed the MAX level (corresponding to about 750 ml) marked on the jug.  
You should ideally use skimmed milk at refrigerator temperature (about 5°C).
- Make sure the intake tube is correctly inserted in the rubber washer (fig. 20) then replace the milk container lid.
- Position the milk frother pointer (B1) between the words CAPPUCCINO and CAFFELATTE



printed on the milk container lid cover.

The quantity of froth can be adjusted by moving the regulator towards the word **CAFFELATTE** for a denser froth.

Moving it towards the word **CAPPUCCINO** obtains a less dense froth.

- Remove the hot water spout (fig. 21) and attach the milk container to the nozzle, making sure the arrow on the container lid is lined up with the arrow on the control panel of the appliance (fig. 22).
- Position the milk tube as shown in fig. 23 and then place a sufficiently large cup under the coffee spout and milk spouts.
- Press the  button (fig. 24).  
The appliance displays: "CAPPUCCINO..." and after a few seconds, frothed milk is delivered from the milk spout into the cup below.

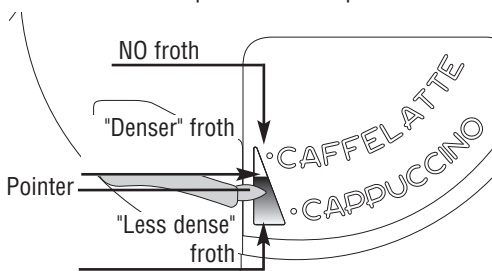

(Delivery stops automatically).

- The appliance then grinds the beans, delivers the coffee and displays the "ready" message again.
- The cappuccino is ready. Sweeten to taste and, if desired, sprinkle the froth with a little cocoa powder.

**NOTE 1:** While making cappuccino, the flow of frothed milk or coffee can be interrupted by pressing the  button.

**NOTE 2:** If the milk in the container finishes while delivering frothed milk, remove the container and add milk. Reattach and press the  button to request a cappuccino again.

**NOTE 3:** To ensure the complete cleanliness and hygiene of the milk frother, always clean the circuits in the milk container lid after making cappuccino.

- Place a recipient under the milk spout;
- Press the  button on the lid and hold down for at least 3 seconds (fig. 25).  
The appliance displays "cleaning".  
After cleaning, remove the milk container and place in the refrigerator.  
The milk should not be left out of the refrige-

rator for more than 15 minutes.

**NOTE 4:** To change the quantity of coffee or frothed milk the appliance delivers automatically into the cup, proceed as described in chapter 1 "Changing the quantity of coffee and milk for cappuccinos".



## PREPARING FROTHED MILK (WITHOUT COFFEE)

- Remove the milk container lid.
- Fill the container with the quantity of milk you want to prepare (fig. 19).
- Replace the lid on the milk container.
- Attach the milk container to the appliance (fig. 22).
- Place a sufficiently large cup under the spout (fig. 23).
- Press the  button twice (within 2 seconds).  
The appliance displays "FROTHED MILK" and after a few seconds, the frothed milk is delivered from the milk spout into the cup below.
- After delivery, clean the tubes inside the milk container by pressing the **CLEAN** button as described in the previous section (note 3).

## CHANGING THE QUANTITY OF COFFEE AND MILK FOR CAPPUCCINOS

The appliance is factory preset to automatically deliver a standard cappuccino.

To change these quantities, proceed as follows:

- Fill the container with milk up to the maximum level indicated on the container.
- Press the  button for at least 3 seconds until the appliance displays "MILK FOR CAPPUCCINO PROGRAM QUANTITY". Then release the button. The appliance starts delivering milk.
- Once the required quantity of milk has been delivered, press the  button again. Milk delivery stops and the quantity is memorised. (You should not deliver frothed milk for more than 3 minutes at a time.)
- After a few seconds, the appliance delivers coffee into the cup and displays "COFFEE FOR CAPPUCC. PROGRAM QUANTITY".
- Once the required quantity of coffee has been delivered, press the  button again. Coffee delivery stops and the quantity is memorised.

The appliance is now re-programmed with the new settings and displays: READY.

## CLEANING AND MAINTENANCE

Before performing any cleaning operations, leave the machine to cool down completely and unplug from the mains power supply.

Never immerse the coffee maker in water. It is an electrical appliance.

Do not use solvents or abrasive detergents to clean the coffee maker.

A soft damp cloth will suffice.

NEVER wash any of the components of the coffee maker in the dishwasher.

### Cleaning the coffee maker

Clean the grounds container (as described in the chapter: "Preparing coffee using coffee beans" - note 7) whenever it requires emptying.

The water tank should be cleaned regularly.

The drip tray is fitted with a level indicator (red) showing the level of water it contains.

When the indicator starts to appear (a few millimetres under the drip tray), the drip tray must be emptied and cleaned.

Check that the holes in the coffee spout are not blocked.

Unblock by scraping the remains of dry coffee accumulated with a needle (fig. 26).

Clean the nozzle regularly with a sponge as shown in fig. 27.

### Cleaning the infuser

The infuser must be cleaned regularly to avoid the build-up of coffee encrustations which could cause malfunction. Proceed as follows:

- turn the appliance off by pressing the ① button (fig. 6) (do not unplug) and wait for the display to go off;
- open the service door (fig. 14);
- remove the drip tray and the grounds container (fig. 15) and wash;
- press the two red release buttons on the infuser sideways and towards the centre (fig. 28) and pull the infuser outwards;
- **IMPORTANT: THE INFUSER CAN ONLY BE REMOVED WHEN THE APPLIANCE IS OFF. ATTEMPTING TO REMOVE THE INFUSER WITH THE APPLIANCE ON MAY CAUSE SERIOUS DAMAGE.**
- Wash the infuser under running water, without using washing up liquid.
- Never wash the infuser in the dishwasher;
- clean the inside of the appliance thoroughly. To remove coffee encrustations from the inside of the appliance, scrape with a plastic or wooden fork (fig. 29) then vacuum up the residues with a vacuum cleaner (fig. 30);
- Replace the infuser by sliding it onto the supports and pin at the bottom; then push the PUSH symbol fully in until it clicks into place.

Check that the two red buttons have snapped out, otherwise the door cannot be closed.

- replace the drip tray complete with grounds container;

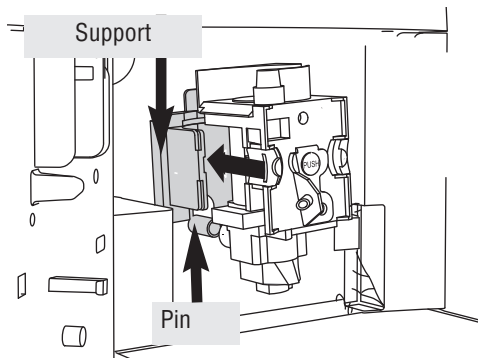

- close the service door.

**NOTE 1:** If the infuser is not inserted correctly until it clicks in place and the red buttons snap out, the service door cannot be closed.

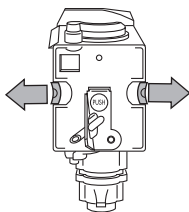

**NOTE 2:** If the infuser is difficult to insert, you must first adapt it to the right dimension by pressing it forcefully from the bottom and top as shown in the figure.

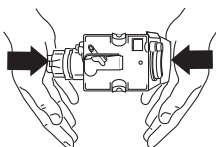

**NOTE 3:** If the infuser is still difficult to insert, leave it out of the machine, close the service door, unplug the appliance from the mains then plug in again. Wait for all the lights to go off after the self-diagnosis, then open the door and replace the infuser.

## Cleaning the milk container

**! Important!** After preparing milk, always clean the tubes inside the milk container (B). If there is still milk in the container, do not leave it out of the refrigerator for longer than strictly necessary.

Clean the container each time you prepare milk as described in the chapter "Preparing cappuccino" - note 3.

1. Turn the milk container lid clockwise then remove it.
2. Remove the milk spout and intake tube.
3. Remove the pointer by pulling it outwards.
4. Wash all the components thoroughly with hot water and mild washing-up liquid.

Make sure there are no milk residues left inside the holes

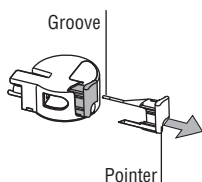
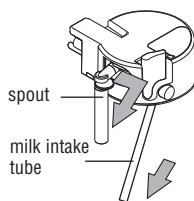

and the groove on the fine end of the pointer.

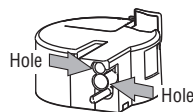

5. Check that the intake tube and spout are not clogged with milk residues.
6. Replace the pointer, milk spout and intake tube.
7. Replace the milk container lid.

## CHANGING AND SETTING MENU PARAMETERS

After pressing the ① button and waiting for the appliance to be ready, you can use the internal menu to modify the following parameters and functions:

- Clock
- Auto-start time.
- Descaling process
- Coffee temperature
- Length of time the appliance remains on
- Water hardness
- Default values
- Washing process





### Setting the clock

To set the clock, proceed as follows:

- Press the **MENU** button (the light over the button comes on) then press the ► button repeatedly until the appliance displays: "CLOCK... 00:00"
- Press the ⌚ button to set the clock. (If you hold the ⌚ button down, the time is changed rapidly).
- Press the OK button to confirm the value;
- Press the **MENU** button to exit programming mode or ► to change other parameters.

## Setting auto-start time

This function programmes the time the machine will come on automatically to be ready for use.

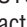
- Make sure the clock on the appliance is set as described in the previous chapter.
- Press the **MENU** button (the light over the button comes on) then press the  button repeatedly until the appliance displays: "START TIME... 00:00"
- Press the  button to set the auto-start time.  
(If you hold the  button down, the time is changed rapidly).
- Press the **OK** button to confirm the value;
- Press  once and the appliance displays the message: "AUTO-START NO".  
Press the  button to modify the function (the machine displays "AUTO-START YES").
- Press the  button to activate auto-start;



**NB:** when the machine is off and an auto-start time has been set, the  symbol appears alongside the time on the unlit display.

- Press the **MENU** button to exit programming mode or  to change other parameters.

## Descaling

Over time, constant heating up of the water used to make the coffee leads to limescale building up in the inner circuits of the appliance.

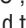
When "DESCALE" is displayed, the machine requires descaling. Proceed as follows:

- make sure the machine is ready;
- press the **MENU** button (the light over the button comes on) then press the  button repeatedly until the appliance displays "DESCALE NO";
- Press  and the appliance displays "DESCALE YES"
- Press the  button to start the descale programme;
- empty the tank of water, pour the contents of the descaler bottle into the tank respecting the instructions given on the descaler pack, then add water up to the MAX level marked on the water tank.

When descaling subsequently, use descaler of the same type and brand as supplied (available from the manufacturer's authorised technical service centres) or a descaler recommended by the service centre. Always follow the instructions on the pack.



- attach the water spout to the nozzle;
- place a container with a minimum capacity of 1.5 litres under the hot water spout (fig. 3);

- press the  button. Descaler is delivered from the hot water spout into the container below.

The appliance displays "DESCALING UNDERWAY";

- the descale programme automatically performs a series of deliveries and pauses to remove limescale deposits from inside the machine.
- After about 30 minutes, the appliance displays "RINSING FILL TANK".

The appliance must now be rinsed through to eliminate residues of descaling solution from inside the appliance. Proceed as follows:

- empty the water tank, rinse and fill with clean water.
- replace the tank;
- empty the full container and put back under the hot water spout;
- Press the  button. Hot water is delivered from the spout into the container below and the appliance displays "RINSING";
- When the water tank is empty, the appliance displays the message "RINSING COMPLETE... PRESS OK";
- Press the  button and refill the water tank with clean water.
- The descale programme is now terminated and the appliance is ready to make coffee again.

**NB:** If descaling is interrupted before completion, the machine still displays the descaling message and the process must be begun again from the beginning.





Empty the water tank, rinse with clean water and deliver a cup of hot water.



**IMPORTANT:** FAILURE TO DESCALE THE APPLIANCE REGULARLY INVALIDATES THE GUARANTEE.



## Changing coffee temperature

To change coffee temperature, proceed as follows:

- Press the **MENU** button (the light over the button comes on) then press the  button repeatedly until the appliance displays "TEMPERATURE HIGH...";
- Press the  button until the appliance displays the required coffee temperature;
- press the  button to confirm the temperature selected;
- Press the **MENU** button to exit programming mode or  to change other parameters.

## Changing the length of time the appliance remains on

The appliance is factory preset to go off automatically one hour after the last coffee has been made. To increase the number of hours the machine stays on (max. 3), proceed as follows:





- Press the **MENU** button (the light over the button comes on) then press the button repeatedly until the appliance displays "OFF AFTER 1 HOUR".
- Press the  button to change the number of hours the appliance remains on.
- Press the  button to confirm the value;
- Press the **MENU** button to exit programming mode or  to change other parameters.

## Setting water hardness

The descale message is displayed after the appliance has been operated for a factory set period of time calculated on the basis of the maximum quantity of limescale which may be contained in the water used.

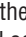

The operating period can be extended if required, making descaling less frequent by programming the machine on the basis of the real lime content in the water used.

Proceed as follows:

- remove the "Total Hardness Test" strip (attached to page 2) from its packaging then dip it fully in the water for a few seconds, Then remove and wait about 30 seconds (until it changes colour and forms red squares).
- Turn the appliance on by pressing the  button (fig. 6).
- Press the **MENU** button then press the  button repeatedly until the appliance displays "WATER HARDNESS 4";
- Press the  button repeatedly until the number coincides with the number of red squares on the test strip (for example, if there are 3 red squares on the test strip, press the button until "WATER HARDNESS 3" is displayed).
- Press the  button to confirm the value; The coffee maker is now programmed to provide the descale warning when necessary based on the actual hardness of the water.

## Resetting factory default values (reset)

If you change the original values, the factory default values can be reset as follows:

- Press the **MENU** button then press the  button repeatedly until the appliance displays: RESET TO DEFAULT NO;
- Press the  button and the appliance displays "RESET TO DEFAULT YES";
- Press the  button to reset the factory default values;
- The appliance is now reset to the factory default settings and the "READY" message is displayed.

## Washing process

This function is available to service centre personnel only. .

## CHANGING THE LANGUAGE

To change the language, press the  button for at least 5 seconds until the appliance displays the installation message in various languages.

Select the required language as described in the section "Using the appliance for the first time".

## DISPLAYED MESSAGES

DISPLAYED MESSAGE	POSSIBLE CAUSE	REMEDY
FILL TANK	<ul style="list-style-type: none"> <li>The water tank is empty or positioned incorrectly.</li> </ul>	<ul style="list-style-type: none"> <li>Fill the tank with water and/or insert it correctly, pushing it as far as it will go until it clicks into place.</li> </ul>
GROUND TOO FINE ADJUST MILL Insert water spout and press ok	<ul style="list-style-type: none"> <li>The grinding is too fine and the coffee is delivered too slowly.</li> <li>The machine is not able to make coffee.</li> </ul>	<ul style="list-style-type: none"> <li>Turn the grinding adjustment knob one click towards the 7.</li> <li>Insert the hot water spout, press the  button and deliver water from the spout for a few seconds.</li> </ul>
INSERT WATER SPOUT	<ul style="list-style-type: none"> <li>The water spout is not inserted or is inserted incorrectly.</li> </ul>	<ul style="list-style-type: none"> <li>Insert the hot water spout.</li> </ul>
EMPTY GROUNDS CONTAINER	<ul style="list-style-type: none"> <li>The grounds container (A4) is full.</li> </ul>	<ul style="list-style-type: none"> <li>Empty the grounds container and clean, then replace. Important: when removing the drip tray, the grounds container <b>MUST</b> be emptied, even if it is not completely full. If this is not done, when you make the next coffees, the grounds container may fill up more than expected and clog the machine.</li> </ul>
INSERT GROUNDS CONTAINER	<ul style="list-style-type: none"> <li>After cleaning, the grounds container has not been replaced.</li> </ul>	<ul style="list-style-type: none"> <li>Open the service door and insert the grounds container.</li> </ul>
INSERT MILK CONTAINER	<ul style="list-style-type: none"> <li>The milk container is not inserted.</li> </ul>	<ul style="list-style-type: none"> <li>Insert milk container.</li> </ul>
ADD PRE-GROUND COFFEE	<ul style="list-style-type: none"> <li>The "pre-ground coffee" function has been selected without placing any pre-ground coffee in the funnel.</li> </ul>	<ul style="list-style-type: none"> <li>Add the pre-ground coffee to the funnel or select the "coffee beans" function.</li> </ul>

DISPLAYED MESSAGE	POSSIBLE CAUSE	REMEDY
DESCALE	<ul style="list-style-type: none"> <li>This indicates the presence of limescale in the machine.</li> </ul>	<ul style="list-style-type: none"> <li>The descaling procedure described in the "Descaling" section needs to be performed as soon as possible.</li> </ul>
LESS COFFEE	<ul style="list-style-type: none"> <li>The ground coffee funnel is clogged.</li> <li>Too many coffee beans or too much pre-ground coffee has been added.</li> </ul>	<ul style="list-style-type: none"> <li>Empty the funnel with the help of a knife, as described in the section "Preparing espresso coffee with pre-ground coffee" - note 5.</li> <li>Select a milder taste or reduce the quantity of pre-ground coffee, then request coffee delivery again.</li> </ul>
FILL BEANS CONTAINER	<ul style="list-style-type: none"> <li>The coffee beans have run out.</li> </ul>	<ul style="list-style-type: none"> <li>Fill bean container</li> </ul>
INSERT INFUSER ASSEMBLY	<ul style="list-style-type: none"> <li>The infuser has not been replaced after cleaning.</li> </ul>	<ul style="list-style-type: none"> <li>Insert the infuser as described in the chapter "Cleaning the infuser".</li> </ul>
CLOSE DOOR	<ul style="list-style-type: none"> <li>The service door is open</li> </ul>	<ul style="list-style-type: none"> <li>Close the service door.</li> </ul>
GENERAL ALARM	<ul style="list-style-type: none"> <li>The inside of the appliance is very dirty</li> </ul>	<ul style="list-style-type: none"> <li>Clean the inside of the appliance thoroughly, as described in the section "Cleaning and maintenance". If the message is still displayed after cleaning, contact a service centre.</li> </ul>

## TROUBLESHOOTING

Below is a list of some of the possible malfunctions.

If the problem cannot be resolved as described, contact a technical service centre.

PROBLEM	POSSIBLE CAUSE	REMEDY
The coffee is not hot	<ul style="list-style-type: none"> <li>The cups have not been preheated.</li> <li>The infuser has cooled down because 2/3 minutes have elapsed since the last coffee was made.</li> </ul>	<ul style="list-style-type: none"> <li>Rinse cups with hot water.</li> <li>Before making coffee, heat the infuser by pressing the  button (fig. 29).).</li> </ul>
The coffee is not creamy enough	<ul style="list-style-type: none"> <li>The coffee is ground too coarsely.</li> <li>Wrong type of coffee</li> </ul>	<ul style="list-style-type: none"> <li>Turn the grinding adjustment knob one click anti-clockwise towards the 1 while the coffee mill is in operation (fig. 7).</li> <li>Use a type of coffee for espresso coffee makers.</li> </ul>
The coffee is delivered too slowly or a drop at a time.	<ul style="list-style-type: none"> <li>The coffee is ground too finely.</li> </ul>	<ul style="list-style-type: none"> <li>Turn the grinding adjustment knob one click clockwise towards the 7 while the coffee mill is in operation (fig. 7). Continue one click at a time until coffee delivery is satisfactory.</li> </ul>
The coffee is delivered too quickly.	<ul style="list-style-type: none"> <li>The coffee is ground too coarsely.</li> </ul>	<ul style="list-style-type: none"> <li>Turn the grinding adjustment knob one click anti-clockwise towards the 1 while the coffee mill is in operation (fig. 7). Avoid turning the grinding adjustment knob excessively otherwise when you select 2 cups, the coffee may be delivered a drop at a time.</li> </ul>



PROBLEM	POSSIBLE CAUSE	REMEDY
Coffee does not come out of one of the spouts.	<ul style="list-style-type: none"> <li>The spouts are blocked.</li> </ul>	<ul style="list-style-type: none"> <li>If necessary, remove coffee deposits with a toothpick (fig. 26), sponge or stiff bristled kitchen brush.</li> </ul>
The coffee does not come out of the spouts, but from around the service door (A2).	<ul style="list-style-type: none"> <li>The holes in the spouts are clogged with dry coffee dust.</li> <li>The mobile drawer (A3) inside the service door is blocked and cannot swing.</li> </ul>	<ul style="list-style-type: none"> <li>If necessary, remove coffee deposits with a toothpick, sponge or stiff bristled kitchen brush (fig. 26).</li> <li>Thoroughly clean the mobile drawer (A3), particularly near the hinges.</li> </ul>
Water comes out of the spouts instead of coffee.	<ul style="list-style-type: none"> <li>The ground coffee may be blocked in the funnel (A17).</li> </ul>	<ul style="list-style-type: none"> <li>Clean the funnel (A17) with a wooden or plastic fork, clean the inside of the appliance.</li> </ul>
The milk does not come out of the milk spout (B5).	<ul style="list-style-type: none"> <li>The intake tube is not inserted or is inserted incorrectly.</li> </ul>	<ul style="list-style-type: none"> <li>Insert the intake tube (B4) in the rubber washer in the milk container lid (fig. 16).</li> </ul>
The milk is not well frothed.	<ul style="list-style-type: none"> <li>The milk container lid is dirty.</li> </ul>	<ul style="list-style-type: none"> <li>Clean the milk container lid as described in the section "Cleaning the milk container".</li> </ul>
The milk contains bubbles or squirts out of the milk spout.	<ul style="list-style-type: none"> <li>The milk is not cold enough or is not semi-skimmed.</li> <li>The milk frother pointer is incorrectly adjusted. .</li> </ul>	<ul style="list-style-type: none"> <li>You should ideally use skimmed or semi-skimmed milk at refrigerator temperature (about 5°C). If the result is still disappointing, try another brand of milk.</li> <li>Move the pointer slightly towards the word "CAFFELATTE" (see section "Making cappuccino").</li> </ul>

## TECHNICAL SPECIFICATION

Voltage: 220-240 V~ 50/60 Hz max. 10A

Absorbed power: 1350W

Pressure: 15 bar

Water tank capacity: 1.7 litres

Size: LxHxD: 560x 450x550 mm

Weight: 26 kg

**CE** The appliance complies with the following EC directives:

- Low Voltage Directive 2006/95/EC;
- EMC Directive 89/336/EEC and subsequent amendments 92/31/EEC and 93/68/EEC.

Materials and accessories coming into contact with food conform to EEC directive 1935/2004.

## DISPOSAL



Electrical appliances must not be disposed of as household waste.

Appliances with this symbol are covered by European Directive 2002/96/EC.

All unused electric and electronic appliances must be disposed of separately from household waste by taking them to State authorised special centres.

Disposing of the unused appliance correctly avoids damage to the environment and a risk to health.

For more information on disposing of the unused appliance, contact the local administration, the waste disposal department or the shop where the appliance was bought.

## ELECTRICAL CONNECTION (UK ONLY)

- A) If your appliance comes fitted with a plug, it will incorporate a 13 Amp fuse. If it does not fit your socket, the plug should be cut off from the mains lead, and an appropriate plug fitted, as below.

**WARNING:** Very carefully dispose of the cut off plug after removing the fuse: do not insert in a 13 Amp socket elsewhere in the house as this could cause a shock hazard.

With alternative plugs not incorporating a fuse, the circuit must be protected by a 15 Amp fuse.

**WARNING - THIS APPLIANCE MUST BE EARTHED**

### IMPORTANT

The wires in the mains lead are coloured in accordance with the following code:

Green and yellow:	Earth
Blue:	Neutral
Brown:	Live



If the plug is a moulded-on type, the fuse cover must be re-fitted when changing the fuse using a 13 Amp Asta approved fuse to BS 1362. In the event of losing the fuse cover, the plug must NOT be used until a replacement fuse cover can be obtained from your nearest electrical dealer. The colour of the correct replacement fuse cover is that as marked on the base of the plug.

- B) If your appliance is not fitted with a plug, please follow the instructions provided below:

As the colours of the wires in the mains lead may not correspond with the coloured markings identifying the terminals in your plug, proceed as follows:

The green and yellow wire must be connected to the terminal in the plug marked with the letter E or the earth symbol  or coloured green or green and yellow.

The blue wire must be connected to the terminal marked with the letter N or coloured black.

The brown wire must be connected to the terminal marked with the letter L or coloured red.