

Quick start guide

快速入门指南

Quick start guide

Register your product and get support at
www.philips.com/welcome

PHILIPS



Unpack

打开包装

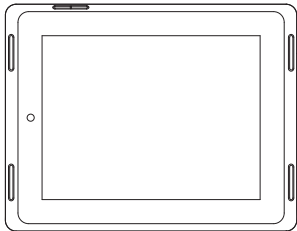

 XP (SP3) / Vista / 7



USB 



500Mb



Charge

充电

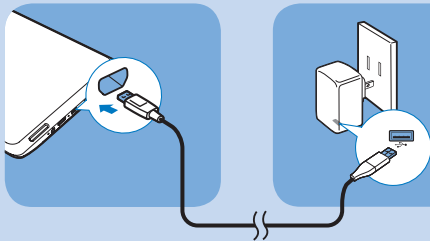

The first time you use the device, use the by-packed USB power adapter to charge the device for more than eight hours.

首次使用本机时，应使用随机所附的USB电源适配器为本机充电8小时以上。



Use

使用

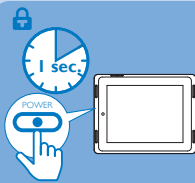
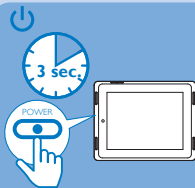
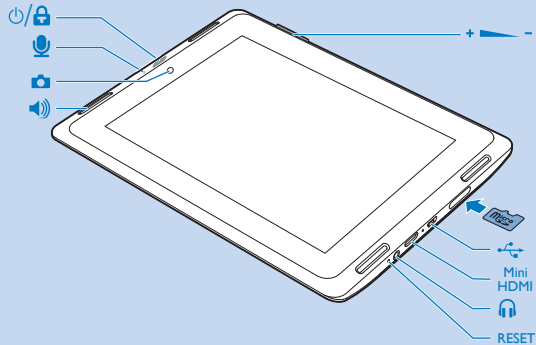





Navigate

页面导航

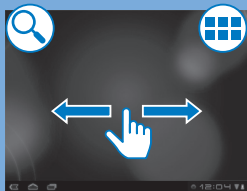
On the Home screen 在主屏幕





Swipe left/ right to select a page.
左右滑动选择页面

 Find all applications
查看所有应用

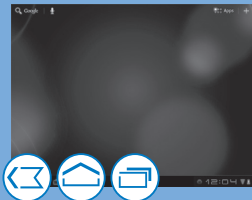
 Search in the web or the device
在网络或本机上搜索



 Go to the Home screen
进入主屏幕

 Back one level or exit
返回上层菜单或退出

 Switch to recent applications
选择最近使用过的应用程序

On the screen of running applications 在当前的应用程序屏幕

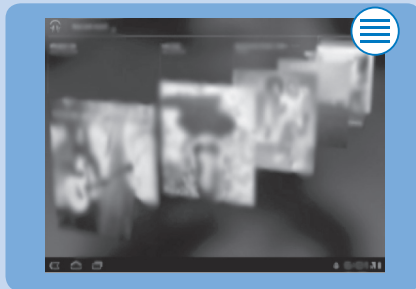

Tap a menu on the top bar to select options.
点击顶部菜单条上的菜单选择选项



Organize

页面管理

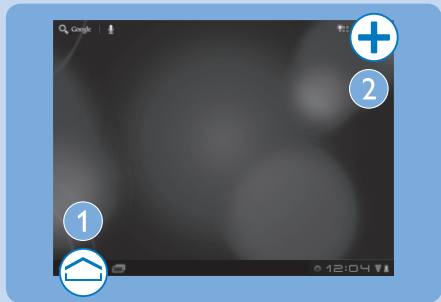

For quick access, organize icons, shortcuts, widgets, and wallpapers on the pages of Home screen.

管理主屏幕页面上的图标、捷径、工具窗口以及墙纸以方便使用。

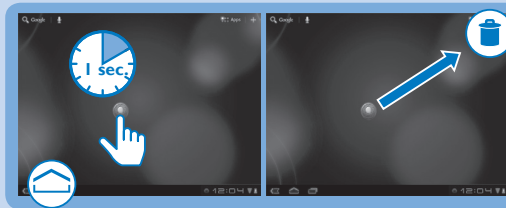
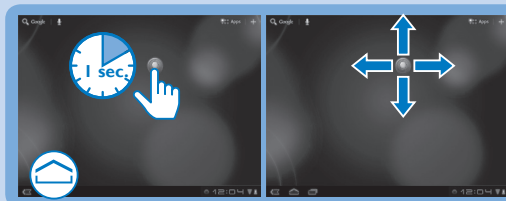



Setup

设置

To select setup options 选择设置选项

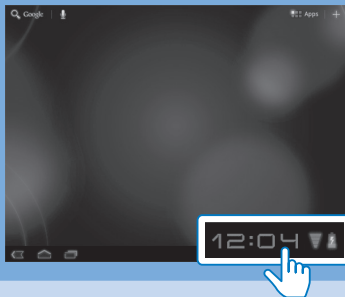

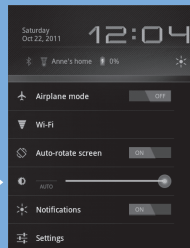
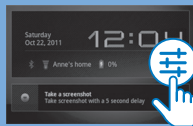

Tap on the pop-up screen to display the setup options.
点击弹出屏幕显示设置选项。

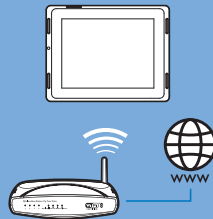
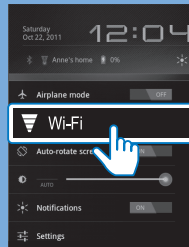

Connect to the Internet

连接互联网



Through Wi-Fi, connect the device to the Internet. On the pop-up screen for setup options, tap  to switch on Wi-Fi and connect to an available network.

经由Wi-Fi，将本机接入互联网。在弹出屏幕选择设置选项，点击  开启Wi-Fi 并接入可用的网络。

Connect to your home network

接入家庭网络

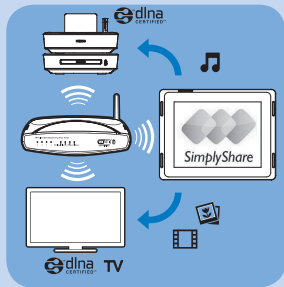

Through Wi-Fi, connect the device to the same network as your Philips connected TV or audio system.
经由 Wi-Fi, 将本机接入你的 Philips 互连电视机或音响系统所在的同一网络。

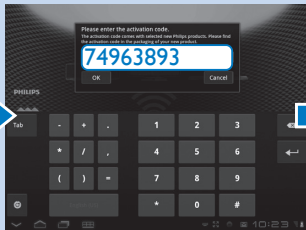

Enter the activation code 74963893 for your first-time use.

首次使用时输入激活码74963893。

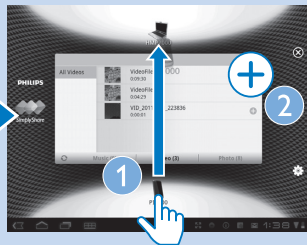

1. Select a connected device as player;
2. Tap or double tap + to add media to the shared list.

1. 选择接入网络的某个设备作为播放器
2. 点击或双击+将媒体文件加入分享列表。



HiMarket

安卓市场



Go to  to search for, download, and install applications.

进入  搜索、下载、安装应用。



Connect to an HDTV

连接高清电视

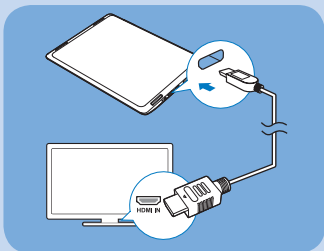

Use an HDMI cable (sold separately) to connect the device to a high-definition TV (HDTV). You can watch on the HDTV photos and videos that play on the device.

使用HDMI数据线（另售）将本机连接至高清电视。
你可在高清电视上观看本机的照片和视频播放。



Connect to your PC

连接PC电脑



Use the USB cable to connect the device to PC. You can drag and drop media files between the device and PC.



使用USB数据线将本机连接至PC电脑。你可在本机与PC电脑之间传输文件。

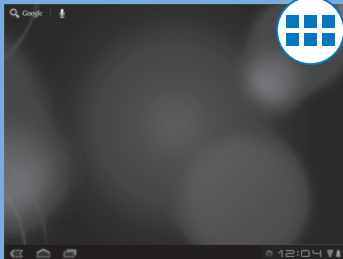

More information

更多信息



To read the User Manual, download Adobe Reader from  HiMarket, and then go to  > **User Manuals**

如需阅读用户手册，请在  安卓市场下载Adobe Reader，然后请转到  > **用户手册**



Help

帮助

Device does not respond to the pressing of keys

本机对按键操作无反应

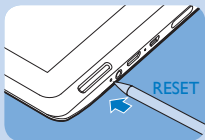

See **support information** in the user manual for more

详情请参阅用户手册中的**支持信息**



Be responsible
Respect copyrights

Specifications are subject to change without notice.

Trademarks are the property of Koninklijke Philips Electronics N.V. or their respective owners

© 2011 Koninklijke Philips Electronics N.V.

All rights reserved.

www.philips.com



Printed in China
PI7000_93_QSG_V2.0
WK1147.4