

Register your product and get support at
www.philips.com/welcome

DCD132



EN	User manual	3
KO	설명서	25
TH	คู่มือผู้ใช้	47
ZH-TW	使用手冊	67

PHILIPS

Contents

1 Important	4
Know these safety symbols	4
Hearing safety	4
Others	5
2 Congratulations	6
Feature introduction	6
What's in the box	6
Overview of the main unit	7
3 Before use	8
Place the player	8
Install/replace the battery of remote control	9
4 Connect	9
Connect speakers	9
Connect TV	10
Connect a USB storage device	10
Connect power	10
5 Get started	11
Turn on	11
Set the clock	11
Find the correct video input channel	11
Select the correct TV system	11
Select a language for on-screen display	11
6 Play	12
Basic operation	12
Play a disc	12
Play recorded files	12
Control the play	14
Search by time or title/chapter/track number	15
Adjust sound	15

7 Other features	15
Play iPhone/iPod	15
Listen to FM radio	16
Play audio from an external device	16
Listen through headphone	17
Turn on/off automatically	17
8 Setup	18
Interface for setup menu	18
Change a setting	18
System setup	18
Language setup	19
Audio setup	19
Video setup	19
9 Product information	20
Specifications	20
Supported disc formats	21
USB playability information	21
10 Troubleshooting	22
11 Notice	24
Copyright notice	24
Trademark notice	24
Compatibility notice	24

1 Important

Know these safety symbols



This 'bolt of lightning' indicates uninsulated material within your unit may cause an electrical shock. For the safety of everyone in your household, please do not remove product covering.

The 'exclamation point' calls attention to features for which you should read the enclosed literature closely to prevent operating and maintenance problems.

WARNING: To reduce the risk of fire or electric shock, this apparatus should not be exposed to rain or moisture and objects filled with liquids, such as vases, should not be placed on this apparatus.

CAUTION: To prevent electric shock, match wide blade of plug to wide slot, fully insert.

Hearing safety

Listen at a moderate volume.

- Using headphones at a high volume can impair your hearing. This product can produce sounds in decibel ranges that may cause hearing loss for a normal person, even for exposure less than a minute. The higher decibel ranges are

offered for those that may have already experienced some hearing loss.

- Sound can be deceiving. Over time your hearing 'comfort level' adapts to higher volumes of sound. So after prolonged listening, what sounds 'normal' can actually be loud and harmful to your hearing. To guard against this, set your volume to a safe level before your hearing adapts and leave it there.

To establish a safe volume level:

- Set your volume control at a low setting.
- Slowly increase the sound until you can hear it comfortably and clearly, without distortion.

Listen for reasonable periods of time:

- Prolonged exposure to sound, even at normally 'safe' levels, can also cause hearing loss.
- Be sure to use your equipment reasonably and take appropriate breaks.

Be sure to observe the following guidelines when using your headphones.

- Listen at reasonable volumes for reasonable periods of time.
- Be careful not to adjust the volume as your hearing adapts.
- Do not turn up the volume so high that you can't hear what's around you.
- You should use caution or temporarily discontinue use in potentially hazardous situations. Do not use headphones while operating a motorized vehicle, cycling, skateboarding, etc.; it may create a traffic hazard and is illegal in many areas.



Caution

- Use of controls or adjustments or performance of procedures other than herein may result in hazardous radiation exposure or other unsafe operation.

Others

Any changes or modifications made to this device that are not expressly approved by Philips Consumer Lifestyle may void the user's authority to operate the equipment.



This product complies with the radio interference requirements of the European Community.



Your product is designed and manufactured with high quality materials and components, which can be recycled and reused.



When this crossed-out wheeled bin symbol is attached to a product it means that the product is covered by the European Directive 2002/96/EC.

Please inform yourself about the local separate collection system for electrical and electronic products.

Please act according to your local rules and do not dispose of your old products with your normal household waste. Correct disposal of your old product helps to prevent potential negative consequences for the environment and human health.



Your product contains batteries covered by the European Directive 2006/66/EC, which cannot be disposed with normal household waste. Please inform yourself about the local rules on separate collection of batteries

because correct disposal helps to prevent negative consequences for the environmental and human health.

Environmental information

All unnecessary packaging has been omitted. We have tried to make the packaging easy to separate into three materials: cardboard (box), polystyrene foam (buffer) and polyethylene (bags, protective foam sheet.)

Your system consists of materials which can be recycled and reused if disassembled by a specialized company. Please observe the local regulations regarding the disposal of packaging materials, exhausted batteries and old equipment.

This apparatus includes this label:



Class II equipment symbol



This symbol indicates that the unit has a double insulation system.

2 Congratulations

Congratulations on your purchase, and welcome to Philips! To fully benefit from the support that Philips offers, register your product at www.philips.com/welcome.

If you contact Philips, you will be asked for the model and serial number of this apparatus. The model number and serial number are on the back of the main unit. Write the numbers here:

Model No. _____

Serial No. _____

Feature introduction

This player can

- play videos, audios, and display pictures from discs and USB storage devices
- play audios from iPod/iPhone

For the details of supported media, refer to "Specifications".



Region codes

You can play discs with the following region codes.

DVD region code	Countries
	Asia Pacific, Taiwan, Korea

Sound effect

This player supports the sound output by DSC (Digital Sound Effect) and DBB (Dynamic Bass Boost).

What's in the box

Check and identify the contents of your package:

- Main unit
- 2 speakers
- Remote control
- Audio and video cables (white, red and yellow connectors)
- USB cable (100 mm)
- MP3 link cable (3.5 mm plug)
- Power cord
- User manual
- Quick start guide

To fully enjoy the features, you need the following cables.

- Component video cables
- Contact local retailers to purchase these additional cables.

Overview of the main unit

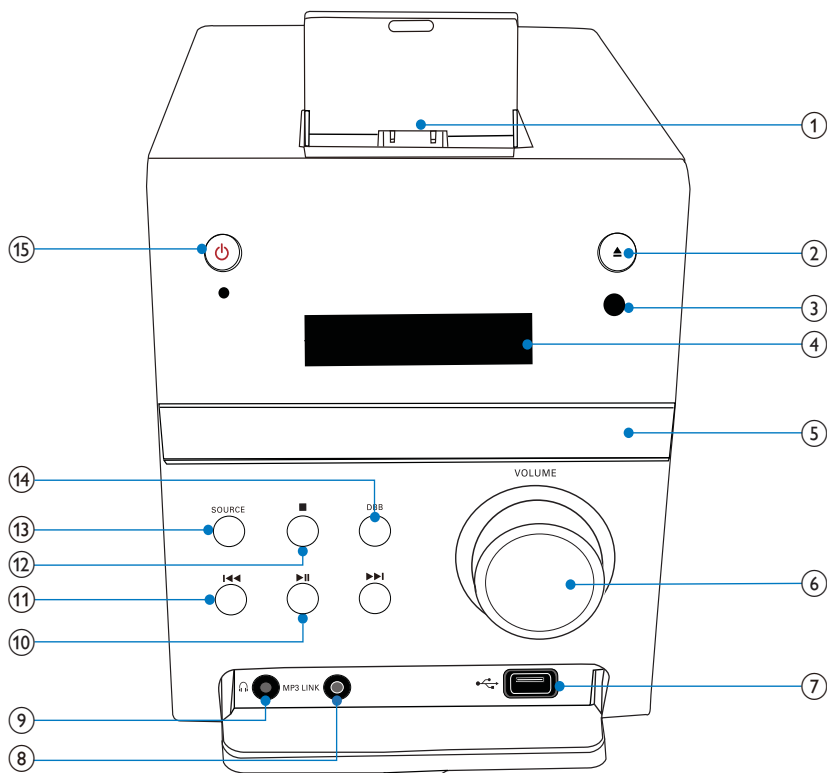

① **DOCK for iPhone/iPod** (Dock for iPhone/iPod)

② ▲
• Eject or close the disc compartment.

③ **IR sensor**

④ **VFD display**

⑤ **Disc compartment**

⑥ **VOLUME**
• Increase or decrease the volume level.

⑦
• Connect a USB storage device.

⑧ **MP3 LINK**

- Connect an MP3 link cable (3.5 mm plug).

⑨
• Socket for headphones.

⑩
• Start, pause or resume the play.

⑪
• Skip to the previous or next title, chapter, track, or file.
• Search fast backward or forward.

⑫ ■
• Stop the play.

⑬ SOURCE

- Select a media source (disc, USB storage device, iPhone/iPod, FM tuner, or external device connected through MP3 link cable).

⑭ DBB

- Enable or disable the DBB (Dynamic Bass Boost) feature.

⑮

- Turn on or off the player.
- Switch to standby mode.

3 Before use

Place the player



Note

- Place this player on a flat, hard, and stable surface.
- Never place this player in an enclosed cabinet, nor on any other electrical equipment.
- Keep this player away from direct sunlight, naked flames, or heat.
- Do not block any ventilation openings.
- Apparatus shall not be exposed to dripping or splashing.
- Do not place any sources of danger on the player (for example, liquid filled objects, lighted candles).
- Install this player near the AC outlet where the AC power plug can be easily reached.
- To avoid magnetic interference or unwanted noise, never place the main unit and speakers too close to any radiation devices.

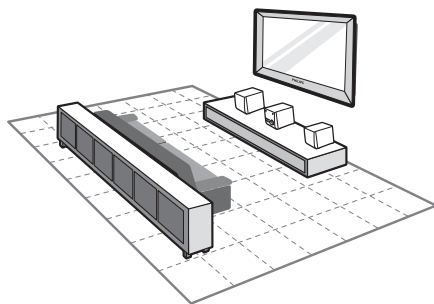

- 1 Place the player near to the TV.
- 2 Place the left and right speakers at equal distance from the TV and at an angle of approximately 45 degrees from the listening position.

Install/replace the battery of remote control



Note

- Risk of explosion! Keep batteries away from heat, sunshine or fire. Never discard batteries in fire.
- Remove the battery if the remote control is not to be used for an extended period of time.

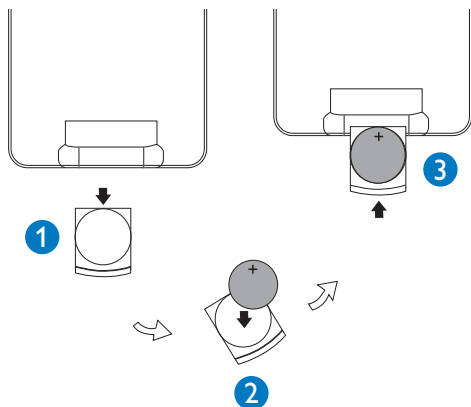

- 1 Pull out the battery tray.
- 2 Insert one lithium CR2025 battery with correct polarity (+/-) as indicated.
- 3 Push and close the battery tray.

4 Connect

Connect speakers



Note

- For the best sound quality, use the supplied speakers only.
- Connect speakers with the same or higher impedance only. Refer to "Product information" > "Specifications" for details.

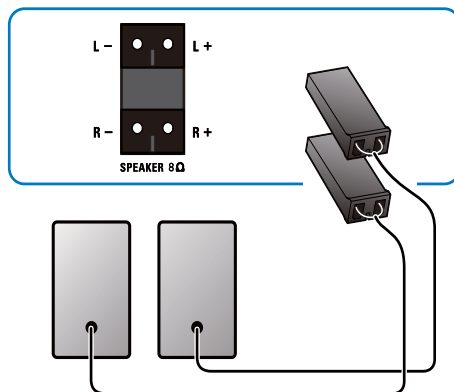

Connect TV

Connect the audio and video cables to the output sockets on the player and the corresponding input sockets on your TV. Select the best video connection that your TV supports.

Option 1: Connect through a composite video cable

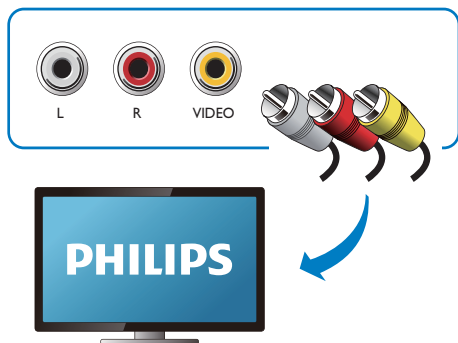

Option 2: Connect through component video cables

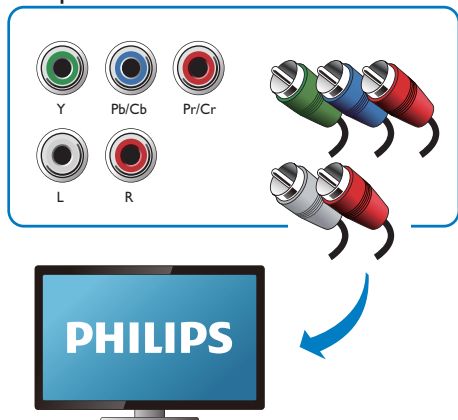

Connect a progressive scan TV through component video cables for higher quality video.

Connect a USB storage device



Note

- For the best data transmission, use the supplied USB cable only.

- 1 Connect the supplied USB cable to:
 - the  jack on the main unit.
 - the plug of your USB storage device.

Connect power



Note

- Where the MAINS plug or an appliance coupler is used as the disconnect device, the disconnect device shall remain readily operable.
- Risk of product damage! Make sure that the power supply voltage corresponds to the voltage printed on the back of the main unit.
- Before you connect the AC power cord, make sure that you have complete all other connections.
- Protect the power cord from being walked on or pinched, particularly at plugs, convenience receptacles, and the points where they exit from the apparatus.
- Unplug this apparatus during lightning storms or when unused for long periods of time.

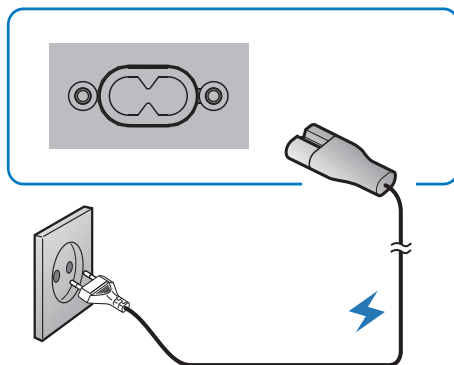

The illustration is for reference only. The power plug on the player may differ in some regions.

5 Get started

Turn on

- 1 Press **⏻**.
 ↳ The player switches to the last selected source.



Note

- If no source is played within 15 minutes, the player switches to standby mode.
- If no operation is performed within 15 minutes in standby mode, the player switches to Eco-power standby mode.
- Press **⏻** to switch the player to standby mode.

Set the clock

The player uses the 24-hour time format.

- 1 In standby mode, press and hold **DISPLAY/CLOCK** for 2 seconds.
 ↳ The hour digits blink.
- 2 Press **⏮** to set the hour.
- 3 Press **DISPLAY/CLOCK** again.
 ↳ The minute digits blink.
- 4 Press **⏮** to set the minute.
- 5 Press **DISPLAY/CLOCK** to confirm the setup.

Find the correct video input channel

- 1 Turn on the player.
- 2 Press **DISC** to select the disc source.
 - Turn on the TV and switch to the correct video-in channel.



Note

- See the user manual of your TV for how to switch between video-in channels.

Select the correct TV system

This player is compatible with both NTSC and PAL. If the picture is abnormally displayed with the default setting, select a TV system that matches your TV. (Refer to "Setup" > "System setup" > **[TV SYSTEM]** for details)

Select a language for on-screen display

English, traditional Chinese, Korean, and Thai are the default language options for this setting. (See "Setup" > "Language setup" > **[OSD LANGUAGE]** for details)

6 Play



Caution

- Risk of damage to the player! During play, never move the unit.
- Never put any object other than a disc into the disc compartment.
- Never look at the laser beam inside the player.
- Never play discs with accessories such as disc stabilizer rings or disc treatment sheets.

When [INVALID KEY] is displayed after an operation, it indicates that this operation is unavailable for the current media or at the current time.

Basic operation

The listed operations are applicable for all supported media.

Function	Action
Stop play	Press ■.
Pause or resume play	Press ► .
Skip to the previous/next title, chapter, track, or file	Press ◀◀/▶▶.

Play a disc

- 1 Press **DISC** to select the disc source.
- 2 Press ▲ to eject the disc tray.
- 3 Place a disc onto the disc tray with the printed side upward, and then press ▲.
- 4 The player starts playing automatically.
 - To start the play manually, press ►||.
 - To play a DVD that has a rating level higher than your setting, enter the 4-digit password first. (Refer to "Setup" > "System setup" > [PASSWORD] and [RATING])

Play recored files

You can play DivX/MP3/WMA/JPEG files that are copied onto a CD-R/RW, recordable DVD, or USB storage device.



Note

- You can only play DivX videos that are rented or purchased with DivX® registration code of this player. (See "Setup" > "Language setup" > [DIVX[R] VOD])
- Subtitle files with the following file extensions (.srt, .smi, .sub, .ssa, .ass) are supported but not displayed in the file list.
- The subtitle filename has to be the same as the filename of the DivX video (the file extension excluded).
- The DivX video file and the subtitle files must be saved under the same directory.

- 1 Select a source.
 - For a USB storage device, press **USB**.
 - For a disc, press **DISC**.
- 2 Insert the USB storage device or disc.
 - ➡ The player starts playing automatically.
 - ➡ The play interface is displayed.

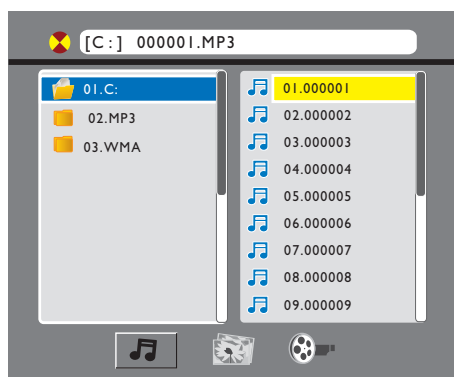

- On the top: the name of current file and the name of current folder
- On the left: the folder list
- On the right: the file list
- At the bottom: the category icons
 - 🎵 for music
 - 🖼️ for photos
 - 🎬 for videos

Access a category

- 1 Press ◀◀ (or ▶▶) repeatedly until a category icon is highlighted.
 - If there is no file under a certain category, the category icon can not be highlighted.
- 2 Press ▶▶ (or ◀◀) to highlight the selected category icon.
- 3 Press **OK** to confirm.
 - ↳ The folders that contain the files of this category are listed.

Access a folder

- 1 Press ◀◀ repeatedly until a folder name is highlighted.
- 2 Press ▲/▼ to highlight the selected folder name.
- 3 Press **OK** to confirm.
 - ↳ The files of the selected category in the folder are listed.

Play a file

- 1 Access the selected folder.
- 2 Press ▶▶ to highlight a file name.
- 3 Press ▲/▼ to highlight the selected file name.
- 4 Press **OK** to confirm.
 - ↳ The selected file starts playing.
 - ↳ The player stops playing automatically at the end of the last file of same category.

Play slideshow and music simultaneously



Note

- Make sure that the USB storage device or the disc contains both WMA/MP3 files and JPEG photos.
- See "Setup" > "System setup" for slideshow settings.

- 1 Play a WMA/MP3 file.
- 2 Access the photo category.
- 3 Access a photo folder.
- 4 Select a photo file.
- 5 Press **OK** to start the slideshow.
 - The slideshow stops after all photos are displayed for one time.
 - To stop the slideshow, press ■.















Note

- This player can only display digital camera pictures with JPEG-EXIF format, which is widely used in digital cameras. It cannot display Motion JPEG, nor pictures in formats other than JPEG. Sound clips associated with pictures cannot be displayed either.
- If the JPEG photo is not recorded with an "exif" type file, it is displayed as a "blue mountain" thumbnail picture.

Control the play

Follow the instructions to control the play.

Media	Function	Action
	Return to the disc menu	Press DISC MENU repeatedly.
	Enable/disable the PBC (playback control) feature	Press DISC MENU repeatedly. <ul style="list-style-type: none"> Enable PBC to display the PBC menu, and then use the numeric buttons to enter your choice.
	Select an audio language or audio channel	Press AUDIO repeatedly.
	Select a subtitle language	Press SUBTITLE repeatedly.
	Select a camera angle	Press ANGLE repeatedly.
	Select a play mode (repeat and random play)	Press MODE repeatedly.
	Repeat a specific section within a chapter or track	<ol style="list-style-type: none"> Press REPEAT A-B to select the start point. Press REPEAT A-B again to select the end point. <ul style="list-style-type: none"> The selected section starts play repeatedly. To resume normal play, press REPEAT A-B until [REP OFF] is displayed.
	Display the play information	Press DISPLAY .
	Zoom in or out	Press ZOOM repeatedly. <ul style="list-style-type: none"> To pan through an enlarged image, press ▲/▼/◀/▶.
	Slow down the play	Press ▼ repeatedly to select a play speed.
	Search backward or forward fast	Press and hold ◀◀/▶▶ for 2 seconds to select a speed.
	Preview photos	Press ▲/▼ to highlight a file name in the file list.
	Rotate a photo	Press ▲/▼/◀/▶ .

Search by time or title/ chapter/track number

- 1 During play, press **GOTO**.
- 2 Press **◀◀/▶▶** to highlight the title number, chapter number, track number, or time field.
- 3 Use the **numeric buttons** to enter the number or time digits.
- 4 Press **OK** to confirm.
 ↳ **[GOTO]** is displayed.
 ↳ Play starts automatically.

Adjust sound

You can adjust the volume level and select sound effects.

Function	Action
Increase/decrease the volume level	Press + VOL - ; turn VOLUME clockwise or anti-clockwise.
Select a preset sound effect (POP , ROCK , JAZZ , and CLASSIC)	Press DSC repeatedly.
Enable/disable the DBB (Dynamic Bass Boost) feature	Press DBB .
Mute/unmute the speakers	Press MUTE .

7 Other features

Play iPhone/iPod

You can enjoy audio from iPhone/iPod through this player.



Note

- The audio is only output through the supplied speakers.

Compatible iPod/iPhone models

The player supports the following iPod and iPhone models.

- iPod touch (1st, 2nd, 3rd, and 4th generation)
- iPod with video
- iPod nano (1st, 2nd, 3rd, 4th, 5th, and 6th generation)
- iPod with color display
- iPod mini
- iPhone 4
- iPhone 3GS
- iPhone 3G
- iPhone

Load the iPhone/iPod

- 1 Lift the lid of the dock.
- 2 Load the iPhone/iPod onto the dock.

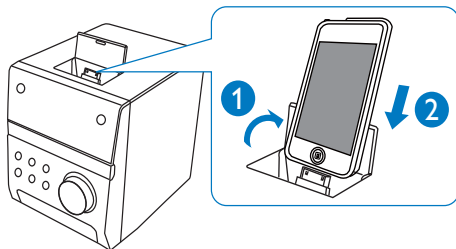

Listen to the iPhone/iPod

- 1 Load your iPhone/iPod.
 - ↳ The player switches to the **iPhone/iPod** input automatically.
- 2 Play the selected track on your iPhone/iPod.
 - To pause/resume the play, press **▶||**.
 - To stop the play, press **■**.
 - To skip to the previous/next audio track, press **◀▶**.
 - To select a track from the playlist: press **DISC MENU** to access the playlist, press **▲/▼** to select a track, and then press **OK** to confirm.

Charge the iPhone/iPod

When the player is connected to power, the docked iPhone/iPod starts charging.

Remove the iPhone/iPod

- 1 Unload the iPhone/iPod from the dock.
- 2 Flip down the lid to hide the dock.

Listen to FM radio



Note

- A maximum of 10 radio stations can be stored.
- Fully extend the FM antenna for better reception.

Program radio stations automatically

- 1 Press **TUNER**.
- 2 Press and hold **ANGLE/PROG** for 2 seconds.
 - ↳ **AUTO** blinks.
 - ↳ Available stations are programmed.
 - ↳ The first programmed radio station is broadcast automatically.

Program radio stations manually

- 1 Press **TUNER**.
- 2 Press **◀◀/▶▶** repeatedly to tune to a radio station.
- 3 Press **ANGLE/PROG**.
 - ↳ The sequence number blinks with the current frequency displayed.
- 4 Press **◀▶** to allocate a sequence number from **01** to **10** to this radio station.
- 5 Press **ANGLE/PROG** to confirm.
 - ↳ The sequence number and the current frequency are displayed.
- 6 Repeat steps 2-5 to program more stations.



Note

- To overwrite a programmed station, store another station with its sequence number.

Tune to a programmed radio station

- 1 Press **TUNER**.
- 2 Press **◀▶** (or **▲/▼**) repeatedly to select a programmed radio station.

Play audio from an external device

You can use this player to play audio from an external device.

- 1 Connect the MP3 link cable to
 - the **MP3 LINK** jack of this player
 - the audio output jack (usually headphone jack) of the external device.
- 2 Press **MP3-LINK**.
- 3 Play the external device (see the user manual of this device for details).

Listen through headphone

Plug a headphone into the  socket.

Turn on/off automatically

You can set a time for automatic power on and off.



Note

- Make sure that you have set the clock before this setup.

- 1 In standby mode, press and hold **SLEEP/TIMER**.
↳ **ON TIME** (time for auto power on) blinks.
- 2 Press **SLEEP/TIMER**.
↳ The hour digits blink.
- 3 Press **⏮️⏭️** to set the hour.
- 4 Press **SLEEP/TIMER** again.
↳ The minute digits blink.
- 5 Press **⏮️⏭️** to set the minute.
- 6 Press **SLEEP/TIMER** to confirm the time for auto power on.
↳ **ON TIME** blinks.
↳ If you want to set the power-off time, press **⏮️⏭️** to select **OFF TIME** (time for auto power off), and then repeat steps 2-6.
- 7 Press **⏮️⏭️** to select **SOURCE**.
- 8 Press **SLEEP/TIMER**.
- 9 Press **⏮️⏭️** to select a media source (**DISC**, **USB**, **DOCK** or **FM**).
• For the tuner source, you still need to press **⏮️⏭️** to select a programmed radio station.
- 10 Press **OK**.
↳ The clock time is displayed.

- 11 Press **SLEEP/TIMER** to activate the timer.
↳  is displayed.
↳ The player turns on/off at the set time.
• To deactivate the timer, press **SLEEP/TIMER** again.

Use the sleep timer

The player can also turn off automatically after a preset period (10-90 minutes with an interval of 10 minutes).

- 1 During play, press **SLEEP/TIMER** repeatedly to select a period.
↳ **SLEEP** is displayed.
- 2 To deactivate the sleep timer, press **SLEEP/TIMER** repeatedly until **SLEEP OFF** is displayed.

8 Setup

Interface for setup menu

After you press **SETUP**, the interface for setup menu is displayed as follows.

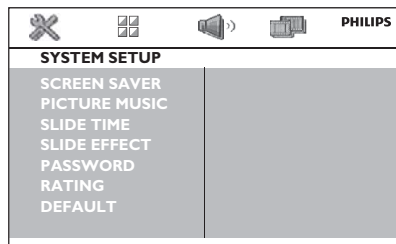

On the top: Icons for main menus

- for **[SYSTEM SETUP]** menu
- for **[LANGUAGE SETUP]** menu
- for **[AUDIO SETUP]** menu
- for **[VIDEO SETUP]** menu

In the middle: Name of the current main menu

On the left: Items under the current menu

On the right: Setting options

Change a setting

Note

- If a menu item or setting option is grayed out, it means that the setting cannot be changed at the current state.

- 1 Press **SETUP**.
 - To access another main menu, press **◀◀/▶▶** to select its icon.
- 2 Press **▲▼** to select a menu item.
- 3 Press **OK**.
 - If a dialog box is displayed, follow the instructions to operate.
- 4 Press **▲▼** to select your setting option.

- 5 Press **OK** to confirm.
 - To exit the menu, press **SETUP**.

System setup

[SCREEN SAVER]

Protect the TV screen from damage due to over exposure to static image.

- **[ON]** - Enable the screen saver.
- **[OFF]** - Disable the screen saver.

[PICTURE MUSIC]

The player can play a slideshow and music simultaneously.

- **[ON]** - Enable this feature.
- **[OFF]** - Disable this feature.

[SLIDE TIME]

Set the time interval (15 seconds, 30 seconds, or 45 seconds) between two slides.

[SLIDE EFFECT]

Select an effect for slide display.

[PASSWORD]

Set a password to restrict the play of rated discs to children. The default password is "0000". You can change the 4-digit password.

- 1 Press **SETUP**.
- 2 Select **[SYSTEM SETUP]** > **[PASSWORD]**, and then press **OK**.
- 3 Enter the current password with the numeric keys (0-9), and then press **OK**.
 - If you forget the password, enter "0000".
- 4 Enter the new password.
- 5 Press **OK** to confirm.

[RATING]

Select a rating level to restrict the play of discs that are not suitable for children. To play a disc that has the rating level higher than your setting, you must enter the 4-digit password.

These discs must be recorded with rating levels.

[DEFAULT]

Reset all settings to factory default, except for the settings of **[PASSWORD]** and **[RATING]**.

Language setup

[OSD LANGUAGE]

Select a language for on-screen-display messages.

[MENU LANG]

Select a language for disc menu.

[DIVX SUBTITLE]

Select a character set that supports the subtitle of your DivX video.

[DIVX[R] VOD]

Display the DivX® registration code (behind **[REGISTER CODE]**).



Note

- Go to www.divx.com/vod for how to register your player and rent or purchase DivX videos.
- DivX videos rented or purchased with this registration code can be played only on this player:

Video setup

[TV SYSTEM]

Select a TV system that matches your TV.

[TV TYPE]

Select a display ratio that matches your TV screen.

Audio setup

[DOWNMIX]

Compress multi-channel Dolby digital sound to 2-channel surround sound (**[LT/RT]**) or stereophonic sound (**[STEREO]**).

[NIGHT MODE]

Equalize loud sound and soft sound. Enable this feature to watch DVD movies at a low volume at night.

[DYNAMIC RANGE]

Set a dynamic range for sound output.

9 Product information

Note

- Product information is subject to change without prior notice.

Specifications

Amplifier

Rated Output Power	2 X 10 W RMS
Frequency Response	40–20000 Hz, ± 3 dB
Signal to Noise Ratio	> 65 dB
Aux Input	500 mV RMS 600 ohm

Disc

Laser Type	Semiconductor
Disc Diameter	12 cm/8 cm
Video Decoding	MPEG-1 / MPEG-2 / DivX
Video DAC	12 Bits
Signal System	PAL / NTSC
Video Format	4:3 / 16:9
Video S/N	> 48 dB
Audio DAC	24 Bits / 96 kHz
Total Harmonic Distortion	< 0.8% (1 kHz)
Frequency Response	4 Hz - 20 kHz (44.1 kHz) 4 Hz - 22 kHz (48 kHz) 4 Hz - 24 kHz (96 kHz)
S/N Ratio	> 65 dBA
Video Resolution	720 X 480 X 30; 720 X 576 X 25

Tuner (FM)

Tuning Range	87.5 - 108MHz
Tuning grid	50KHz
Sensitivity - Mono, 26dB S/N Ratio	<22 dBf
Sensitivity - Stereo, 46dB S/N Ratio	<43 dBf
Search Selectivity	>28dBf
Total Harmonic Distortion	<2%
Signal to Noise Ratio	>55dB

Speakers

Speaker Impedance	8 ohm
Speaker Driver	Full range speaker
Sensitivity	> 80 dB/m/W \pm 4dB/m/W

General information

AC power	100–240 V, 50/60 Hz
Operation Power Consumption	25 W
Eco Standby Power Consumption	< 1 W
Composite Video Output	1.0 Vp-p, 75 ohm
Headphone output	2 X 2.5 mW, 32 ohm
USB Direct	Version 2.0
Dimensions	
- Main Unit (W x H x D)	152 X 174 X 210 mm
- Speaker Box (W x H x D)	152 X 174 X 200 mm
Weight	
- With Packaging	5.0 kg
- Net Weight	3.7 kg

Supported disc formats

- Digital Video Discs (DVDs)
- Video CDs (VCDs)
- Super Video CDs (SVCDs)
- Digital Video Discs + Rewritable (DVD+RW)
- Compact Discs (CDs)
- Picture (Kodak, JPEG) files on CDR(W)
- DivX® disc on CD-R(W)
- DivX 3.11
- WMA

Supported MP3-CD formats:

- ISO 9660
- Max. title/album name: 24 characters
- Max. title number plus album: 255.
- Max. nested directory: 8 levels
- Max. album number: 130
- Max. MP3 track number: 5000
- Supported sampling frequencies for MP3 disc: 32 kHz, 44.1 kHz, 48 kHz
- Supported Bit-rates of MP3 disc are: 32, 64, 96, 128, 192, 256 (kbps)
- The following formats are not supported:
 - Files like *.VMA, *.AAC, *.DLF, *.M3U
 - *.PLS, *.WAV
 - Discs recorded in Joliet format
 - MP3 Pro and MP3 with ID3 tag

USB playability information

Compatible USB devices:

- USB flash memory (USB 2.0 or USB1.1)
- USB flash players (USB 2.0 or USB1.1)
- memory cards (requires an additional card reader to work with this apparatus)

Supported formats:

- USB or memory file format FAT12, FAT16, FAT32 (sector size: 512 bytes)
- MP3 bit rate (data rate): 32-320 Kbps and variable bit rate
- WMA v9 or earlier
- Directory nesting up to a maximum of 8 levels
- Number of albums/ folders: maximum 99
- Number of tracks/titles: maximum 999
- ID3 tag v2.0 or later
- File name in Unicode UTF8 (maximum length: 128 bytes)

Unsupported formats:

- Empty albums: An empty album is an album that does not contain MP3/WMA files.
- Unsupported file formats are skipped. For example, Word documents (.doc) or MP3 files with extension .dlf are ignored and not played.
- AAC, WAV, PCM audio files
- DRM protected WMA files (.wav, .m4a, .m4p, .mp4, .aac)
 - WMA files in Lossless format

10 Troubleshooting



Caution

- Never remove the casing of this apparatus.

To keep the warranty valid, never try to repair the system yourself.

If you encounter problems when using this apparatus, check the following points before requesting service. If the problem remains unsolved, go to the Philips web site (www.Philips.com/support). When you contact Philips, ensure that your apparatus is nearby and the model number and serial number are available.

No power

- Ensure that the AC cord of the apparatus is connected properly.
- Ensure that there is power at the AC outlet.
- As a power-saving feature, the system switches off automatically 15 minutes after track play reaches the end and no control is operated.

No disc detected

- Insert a disc.
- Check if the disc is inserted upside down.
- Wait until the moisture condensation at the lens has cleared.
- Replace or clean the disc.
- Use a finalized CD or correct format disc.

No picture

- Check the video connection.
- Turn on the TV to the correct Video-In channel.
- Progressive scan is activated but the TV does not support progressive scan.

Black and white or distorted picture

- The disc does not match the TV color system standard (PAL/NTSC).
- Sometimes a slight picture distortion may appear. This is not a malfunction.
- Clean the disc.

- A distorted picture may appear during progressive scan setup.

The aspect ratio of the TV screen cannot be changed even though you have set the TV display format.

- The aspect ratio is fixed on the loaded DVD disc.
- The aspect ratio may not be changed for some TV systems.

No sound or poor sound

- Adjust the volume.
- Disconnect the headphones.
- Check that the speakers are connected correctly.

Remote control does not work

- Before you press any function button, first select the correct source with the remote control instead of the main unit.
- Reduce the distance between the remote control and the player.
- Insert the battery with its polarities (+/- signs) aligned as indicated.
- Replace the battery.
- Aim the remote control directly at the sensor on the front of the player.

Disc does not play

- Insert a readable disc with the label side facing you.
- Check the disc type, color system and regional code. Check for any scratches or smudges on the disc.
- Press **SYSTEM MENU** to exit the system setup menu.
- Disable the password for parental control or change the rating level.
- Moisture has condensed inside the system. Remove the disc and leave the system turned on for about an hour. Disconnect and reconnect the AC power plug, and then turn on the system again.
- As a power-saving feature, the system turns off automatically 15 minutes after disc play reaches the end and no control is operated.

DivX video files cannot be played.

- Make sure that the DivX video file is complete.
- Make sure that the file extension is correct.
- Due to Digital Rights issue, the DRM-protected video files stored on a USB storage device cannot be played through an analog video connection (e.g. composite, component, and scart). Transfer the video content onto a supported disc to play these files.

Poor radio reception

- Increase the distance between the apparatus and your TV or VCR.
- Fully extend the FM antenna.
- Connect an outdoor FM antenna instead.

Audio or subtitle languages cannot be set

- The disc is not recorded with sound or subtitles in multiple languages.
- The audio or subtitle language setting is prohibited on the disc.

Cannot display some files in USB device

- The number of folders or files in the USB device has exceeded a certain limit. This phenomenon is not a malfunction.
- The formats of these files are not supported.

USB device not supported

- The USB storage device is incompatible with the player. Try another one.

Timer does not work

- Set the clock correctly.
- Switch on the timer.

Clock/timer setting erased

- Power has been interrupted or the power cord has been disconnected.
- Reset the clock/timer.

11 Notice

Copyright notice



Be responsible
Respect copyrights

This item incorporates copy protection technology that is protected by U.S. patents and other intellectual property rights of Rovi Corporation. Reverse engineering and disassembly are prohibited.

Trademark notice



Manufactured under license from Dolby Laboratories. Dolby and the double-D symbol are trademarks of Dolby Laboratories.



'DVD Video' is a trademark of DVD Format/Logo Licensing Corporation.



ABOUT DIVX VIDEO: DivX® is a digital video format created by DivX, Inc. This is an official DivX Certified® device that plays DivX video. Visit divx.com for more information and software tools to convert your files into DivX video.

ABOUT DIVX VIDEO-ON-DEMAND: This DivX Certified® device must be registered in order to play purchased DivX Video-on-Demand (VOD) movies. To obtain your registration code, locate the DivX VOD section in your device setup menu. Go to vod.divx.com for more information on how to complete your registration.

DivX®, DivX Certified® and associated logos are trademarks of DivX, Inc. and are used under license.

DivX Certified® to play DivX video, including premium content.

Compatibility notice

Made for



iPod



iPhone

"Made for iPod" and **"Made for iPhone"** mean that an electronic accessory has been designed to connect specifically to iPod or iPhone respectively, and has been certified by the developer to meet Apple performance standards. Apple is not responsible for the operation of this device or its compliance with safety and regulatory standards.

