

DEHUMIDIFIER

MODEL

MJ-EZ6CX-H

INSTRUCTION MANUAL

English



Features

- Intelligent Laundry
- Clothes Deodorant
- Bathroom Mildew Guard
- Downward Blowing Louvre

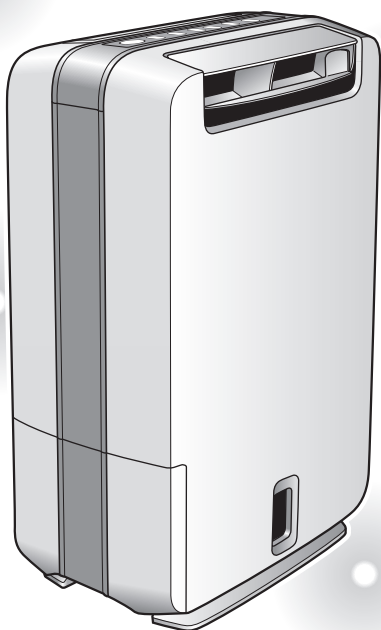

- In order to ensure correct usage, please read this instruction manual carefully and retain it for future reference.
- Before accepting the Warranty at the time of purchase, please make sure that the date of purchase, place of purchase and other items are correctly filled in the form.
- Keep the Instruction Manual and Warranty in a safe place.

Table of Contents

page

Before using the unit

- Recommended Ways of Using the Unit ... 2
- Features of this dehumidifier 3
- Precautions..... 4
- Warnings..... 6
- Names and Functions of Parts 6
- Before using your dehumidifier 8

Operating

- **Drying Laundry** (Intelligent Laundry) 10
 - Tips on Drying Laundry
- **Dehumidifying** (AUTO,HIGH,LOW) 12
- **Using Louvre** 13
- **Reducing Growth of Mildew in Bathroom** (Bathroom Mildew Guard)..... 14
- **Removing Odor from Clothes** (Clothes Deodorant)..... 15
- **Using OFF Timer** 16
- **CLEAN FILTER Lamp**..... 17
- **Draining**..... 18
- **Continuous Drainage** 19

Troubleshooting

- **Maintenance** 20
- **Replacement Parts**..... 23
- **Storage and Disposal**..... 23
- **Troubleshooting** 24
- **Specifications** back cover

Recommended Ways of Using the Unit

When you want to dry laundry

When you want to perform automatic operation

- INTELLIGENT LAUNDRY ▶ P.10

When you want to perform continuous operation

- DEHUMIDIFYING HIGH ▶ P.12

Tips on Drying Laundry
P.11



When you want to dehumidify the room

When you want to perform automatic operation

- DEHUMIDIFYING AUTO ▶ P.12

When you want to perform continuous operation

- DEHUMIDIFYING HIGH ▶ P.12

Reducing blowing sound and performing continuous operation

- DEHUMIDIFYING LOW ▶ P.12



When you are worried about mildew in the bathroom

- MODE BATHROOM MILDEW GUARD ▶ P.14

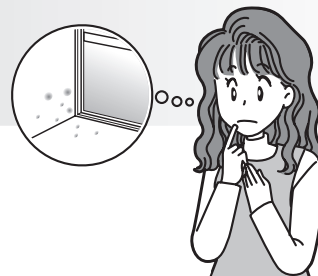

When you want to remove odor from clothes

- MODE DEO-DRY ▶ P.15



When you want to dehumidify a closet or shoebox

- DEHUMIDIFYING HIGH ▶ P.12

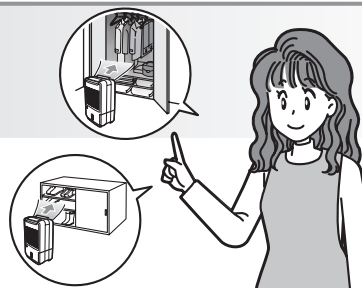

Features of this dehumidifier

● Room temperature may rise 3-6°C during operation.

The dehumidifier does not have a cooler function. Due to heat produced during operation, the room temperature may rise 3-6°. As a result, the unit may blow warm air, but this is not due to a malfunction. (During winter, the air may not feel warm as the temperature is below body temperature.)

How does dehumidification work?

- ① Air is drawn from the room, moisture is absorbed by the dehumidifier rotor, and dry air is blown out.
- ② The dehumidifier rotor is heated with a heater, and the absorbed moisture is discharged inside the heat exchanger.
- ③ The discharged moisture is cooled by the heat exchanger, causing it to transform into droplets, which is collected in the water tank.

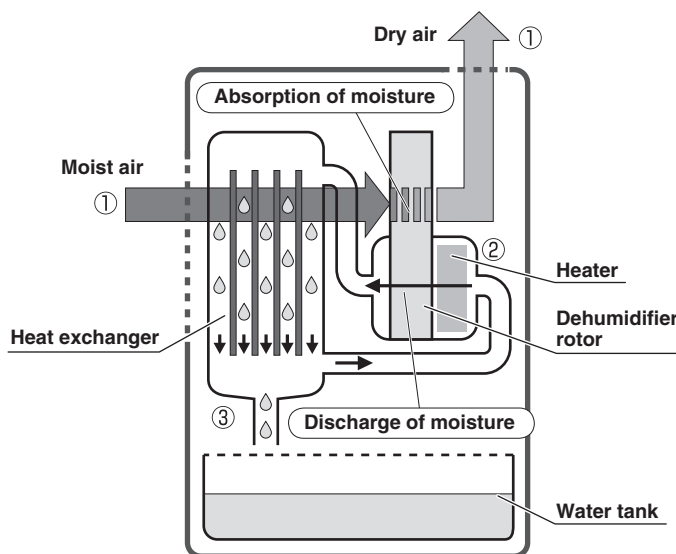

● The blown air may cause smell during operation.

- An odor may be emitted from the parts inside the dehumidifier when you first use the dehumidifier.
- Odorants that cannot be removed by the silver ion filter may be absorbed by the dehumidifier rotor inside the unit.
- Odors unique to zeolite (sour smell, burning smell, etc.) may be emitted from the dehumidifier rotor. These odors have no effect on humans and animals.
- If the room contains any of the following items, the corresponding odor will be absorbed by the dehumidifier rotor inside the dehumidifier. Also, that absorbed odor will be heated by the heater, which may result in a burning like smell or other abnormal odor.

Examples: Cigarettes, cosmetics, hair dressing products, building materials, new furniture, etc.

● The unit can operate in a room temperature range of 1-35°C.

However, if the room temperature exceeds 35°C, the unit may operate in blower mode or increase the airflow. This is because the temperature within the unit rises causing the protection mechanism to operate. In order to lower the internal temperature of the unit, use the unit with the swing stopped and louvre vertical.

- If the temperature is over 40°, the unit will operate in blower mode without dehumidifying.
- If the temperature is below 1°C, the extracted water is close to freezing disabling the dehumidification, and only the blower is operating.

● The amount of dehumidifying becomes less when the humidity becomes approximately 40% or less or the room temperature becomes approximately 35°C or more.

If the humidity becomes approximately 40% or less or the room temperature becomes approximately 35°C or more, the amount of dehumidifying becomes less because operation is performed with the power consumption of the heater reduced to a level equivalent to that of LOW mode.

Precautions

The following diagrams indicate circumstances where danger can result from mishandling the unit.



WARNING

Mishandling may result in fatal or serious injuries.

CAUTION

Mishandling may result in injuries or damage to your home or property, etc.

Meanings of the graphic symbols used in this manual and on the unit are explained below.

	Forbidden		Do not disassemble
	Keep away from fire		Do not subject to water

 Always follow the instructions

WARNING

Do not damage or modify the power cord or plug. Do not use power sockets in which the plug fits loosely.

Do not modify, bundle, twist, bend or heat the power cord. Do not place under objects or use with the end close to the plug bent.

(Keep pets from biting the cord.)

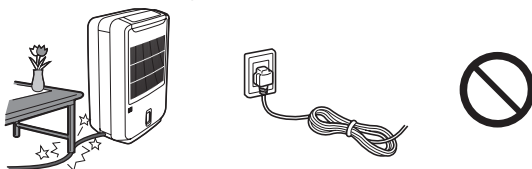

The cord may be damaged **resulting in fire, electric shock or heat generation.**

Do not plug many power cords into one power socket.

This may **result in fire, electric shock or malfunctions.**

Do not start/stop the unit by plugging/unplugging the power cord.

This may **result in fire and/or electric shock.** To prevent the temperature inside the unit from rising, the blower fan rotates for approximately 2 minutes after the power button is turned off. Remove the power plug after the blower fan has stopped.

Do not put the unit near heat-generating devices (such as stoves, fan heaters, etc.).



The plastic parts may melt and **cause fire.**

Do not put your fingers or any long object, into the air intake/outlet. Do not touch the swing louver.



The internal fan rotates at high speeds, and such actions may **result in injury or malfunctions.**

Do not attempt to repair, disassemble, or modify the unit.



This may **result in fire and/or electric shock.** Refer servicing to your dealer or Mitsubishi Electric Service Centre.

Exclusively use 220V AC power sockets for the power supply.

Failing to do so may **result in fire and/or electric shock.**

* Use an extension cord by itself.

Wipe dust off the power plug and insert the plug firmly.

If the plug is not fully inserted into the socket, dust may gather on the connectors which may **cause fire and/or electric shock.**

Should abnormal symptoms occur (a burning smell, etc.), switch off the unit and unplug it from the socket.

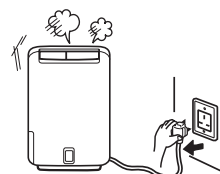

Continuing to operate the unit may **result in fire, electric shock, or malfunctions.**

Contact your dealer or Mitsubishi Electric Service Centre for consultation.

Remove water that has collected in the tank.

Accidentally drinking the water or using it for other purposes may **cause illness and/or unforeseen accidents.**



CAUTION

Do not cover an air outlet or air intake with laundry, cloth, curtain, etc.

This results in poor ventilation and may **cause heat generation/fire**.

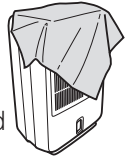

Do not put vases or any other objects filled with water on the unit.

Water may leak into the unit adversely affecting electric insulation and **cause electric shock and/or fire** by short-circuiting.



Do not use the unit in a bathroom or other location where it is likely to come into contact with water, or wash it with water.



Exposure to water may **result in fire or electric shock** caused by an electric leak.

Do not use the unit where it may be exposed to direct sunlight or other weather conditions.

(This unit is for indoor use only.)

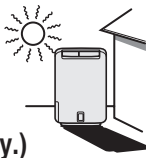

This may **cause overheating, electric shock and/or fire** caused by an electric leak.

Do not use the unit in narrow, enclosed places such as inside closets, between pieces of furniture, etc.

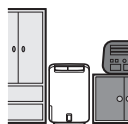

This results in poor ventilation and may **cause heat generation and/or fire**.

Do not use combustion appliances in the path of the air outlet.



This may **cause incomplete combustion** in the appliance.

Do not use the unit in places that may be subject to oil or flammable gas leakage.

Such a leak around the unit may **cause combustion and fire**.



Do not use the unit in places where chemicals are used (such as hospitals, factories, laboratories or beauty salons).

Chemicals and solvents evaporated in the air may harm the unit and cause water in the tank to leak, **resulting in damage to property**.



Do not use the unit for special purposes, such as preservation of food, art or scientific works.

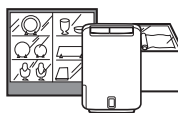

This may **negatively affect the quality** of the items stored.

Do not point airflow from the unit directly at the body for a prolonged period of time.

Be especially careful when using the unit where there is someone who is unable to adjust the humidity (infant, child, or elderly person).



If air-flow is directed at the body for long periods, it may **harm one's physical condition and lead to dehydration**.

Do not stand on, sit on or lean against the unit.

The unit may tip over **causing injury**.



Keep the supplement cartridge out reach of children.

Do not disassemble or tear the bag inside the cartridge.

Make sure children do not swallow the contents.



Do not remove the Styrofoam from the floating element.

The floating element will not be able to detect a full tank resulting in water leakage, **which may damage surrounding objects or cause electric shock and/or an electric leak**.

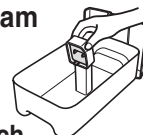

Do not drain water continuously if there is a possibility that temperature around the hose could drop to freezing point.

Water inside the hose may freeze and prevent the water in the tank from flowing out. The water may leak from the unit and **damage surrounding objects**.



Install the unit in a location where the floor is flat and stable.

If the unit falls over, the water collected in the water tank may leak **damaging surrounding objects and in turn result in fire or electric shock caused by an electrical leak**.



Before moving the unit always switch it off, unplug it and remove water from the water tank.

Moving the unit with water in its tank may cause the water to leak and **damage the surrounding objects and in turn result in electric shock and/or an electric leak**.



Grasp the plug and remove from the power socket.

When removing the plug from the power socket, do not pull on it diagonally or by the cord as this may cause the projections/wiring to be damaged **resulting in a short circuit, electric shock or fire**.



Before cleaning the unit, wait until the blower fan stops after operation has stopped, and then remove the power plug.



When the unit is on, the internal fan rotates at high speeds and may **cause injury**.

E

Before using the unit



CAUTION

Unplug the unit from the power source when not using the unit for an extended period of time.



Otherwise it may **cause fire and/or electric shock** caused by an electric leak.

When using the continuous drainage outlet, make sure to position the hose so that the water drains without obstruction.



The water in the tank may leak and **damage surrounding objects.**

When draining water continuously or left unattended for long periods, inspect the unit every two weeks.



Do not allow debris to clog the filter/hose as this may **cause overheating/leakage.**

First remove the water from the tank and then grasp the handle firmly when moving the unit.



The falling or dropping of the dehumidifier may **cause an injury, damage to the floor, or household belongings becoming wet** as a result of water spilling out of the tank.

Use the unit with caution in rooms where the walls, furniture and art work are vulnerable to dry air, as it may cause cracks and warping.



Warnings

- **Keep the unit always in an upright position.**
Inclining the unit may cause water in the tank to leak into the unit, **resulting in malfunction.** Should you incline the unit accidentally, contact the place of purchase for advice.
- **Do not carry the unit horizontally.**

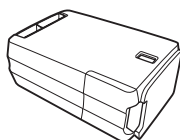

This may **result in malfunctions.**

Names and Functions

Front

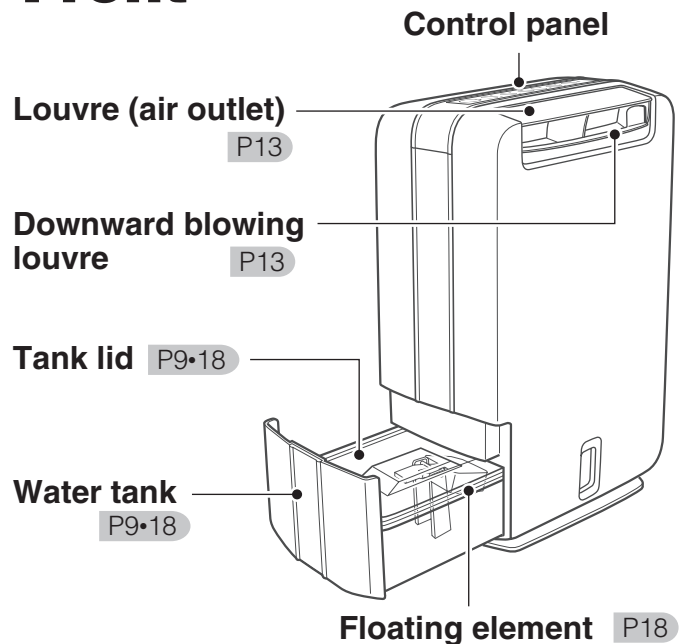

The water tank may contain water residue at time of purchase. This is from final product testing at the factory and is not due to a defect.

Back

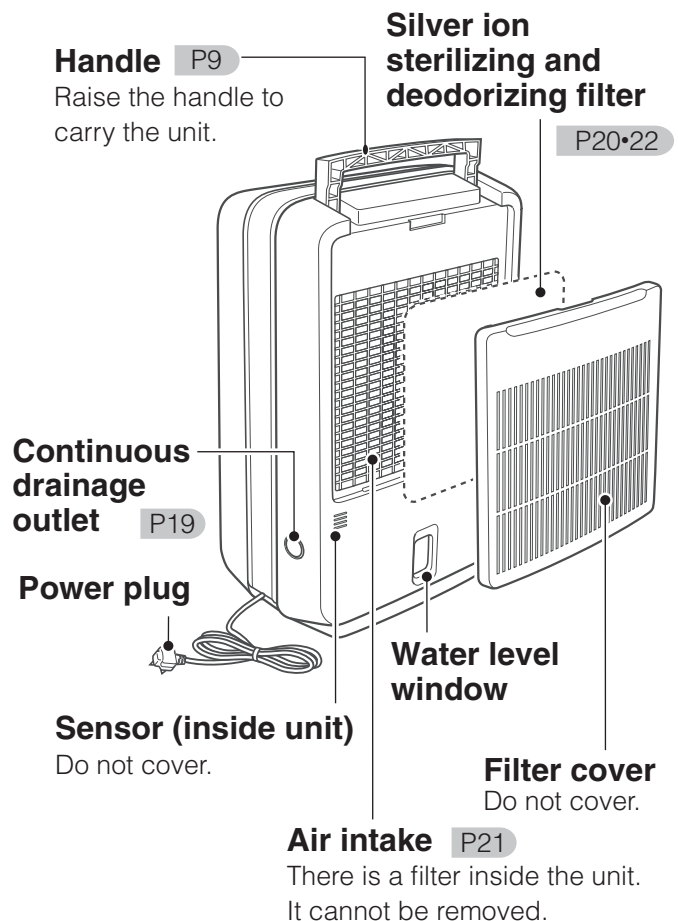

tions of Parts

Control panel

● FULL lamp

- Lights when the tank is full.
- Lights when the tank is not attached to the unit.

P18

● OFF TIMER lamps

Indicates the OFF timer remaining operation time.

● OFF TIMER switch

Sets the OFF timer operation time.

P16

● SWING LOUVRE lamps

The lamp for the swing direction of the louver lights.

● SWING LOUVRE switch

Changes the swing direction of the louver, or stops the swing operation.

P13

● POWER lamp

Lights during operation.

● POWER switch

Turns the power on/off.

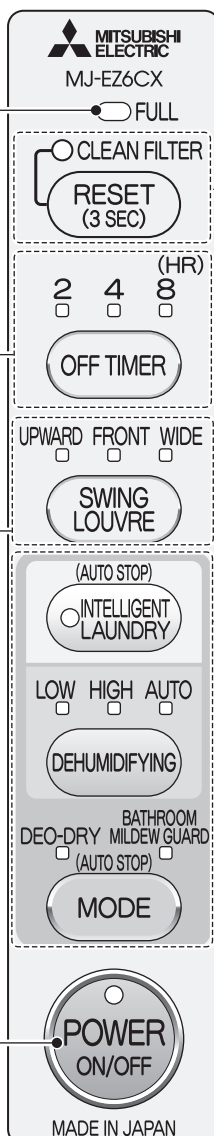

● CLEAN FILTER lamp

Flashes or lights to notify you that it is time to clean the filter.

● RESET switch

Cancels the flashing or lit state of the CLEAN FILTER lamp.

P17•21

● Operating mode lamps

The lamp of the selected operating mode lights.

● INTELLIGENT LAUNDRY switch

Switches to the Intelligent laundry operation.

● DEHUMIDIFYING switch

Switches to the dehumidifying operation.

● MODE switch

Switches between the clothes deodorant operation and bathroom mildew guard operation.

● INTELLIGENT LAUNDRY P10

● LOW

● HIGH

● AUTO

P12

● DEO-DRY

● BATHROOM MILDEW GUARD

P15

P14

You can select one of the six operating modes above.

It is not possible to use a combination of two operating modes.

Accessories

● Silver ion sterilizing and deodorizing filter

Hereafter referred to as simply "silver ion filter."

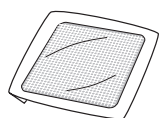

The silver ion filter and supplement cartridge are supplied with the unit at the time of purchase. Set before using the unit. P8

● Supplement cartridge



What is a silver ion sterilizing and deodorizing filter?

The silver ion sterilizing and deodorizing filter is a filter consisting of fibres containing special deodorant and silver ion anti-bacterial agent (anti-allergen, anti-virus, and sterilization).

Cigarette smoke and toxins found in smoke, such as carbon monoxide, cannot be removed with this filter.

Installing your dehumidifier

Make sure to leave some space around the unit.

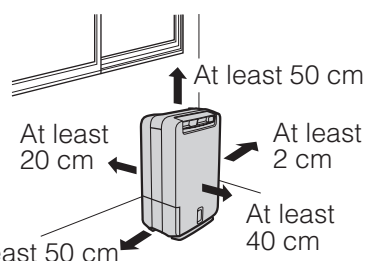

<When installing your dehumidifier near a wall>
Stop the swing operation and use the louver in the upward direction. Since the wind blown out of the unit mixes with the dust in the air, dust may stick to the wall and make it dirty if the wind is blown directly onto the wall.

<Operating noise>

Use the unit on a mat or the like. This reduces vibration and noise. It also prevents leaving depressions on carpets, etc.

Before using your dehumidifier

Set the silver ion filter

The silver ion filter is supplied with the unit at time of purchase. Please fit before using the unit.

1 Remove the silver ion filter from the polyethylene bag.

2 Remove the filter cover.

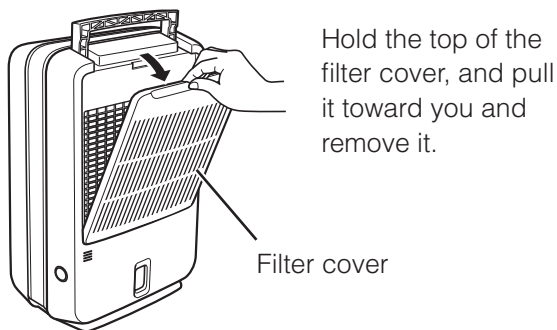

3 Set the silver ion filter into the filter cover.

Align the white net surface with the filter cover, and insert the filter inside the tabs of the filter cover.

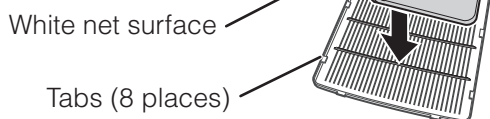

4 Set the filter cover.

- ① Insert the tabs at the bottom of the filter cover into the unit.
- ② Push in the filter cover at the top.

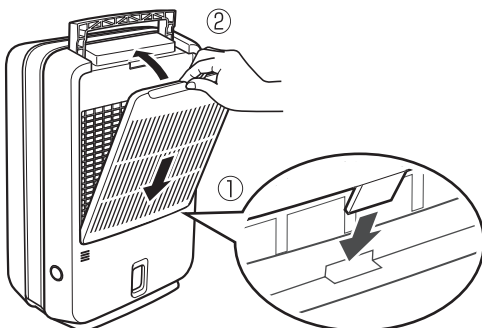

Note

- Make sure the silver ion filter is attached to the unit. If it is not, fine dust will enter inside the unit and cause a malfunction.

Setting the supplement cartridge

The unit disperses antioxidants during dehumidifier operation by setting the supplement cartridge.

1 Remove the cartridge from the bag.

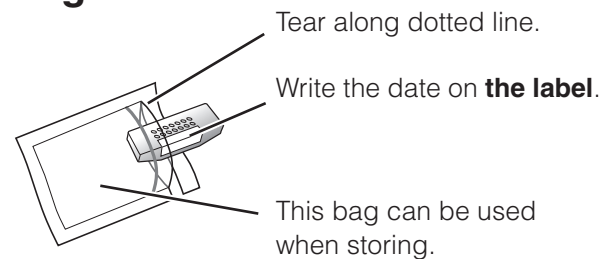

2 Install the cartridge.

- ① Raise the louvre and insert the cartridge in the indentation under the louvre.

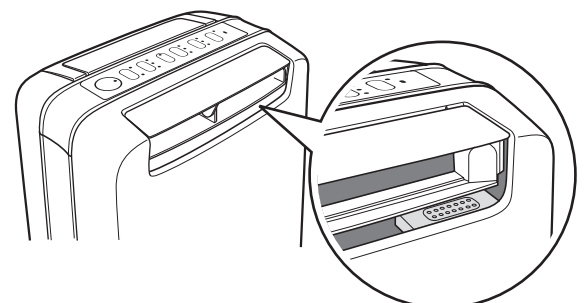
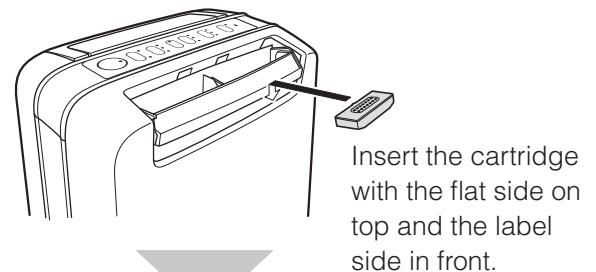

- ② Move the louvre manually and see if it does not hit the cartridge.

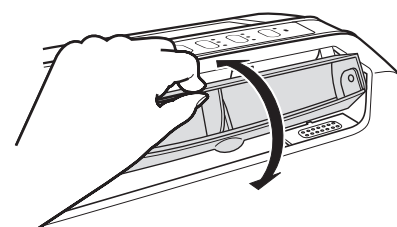

Remove the supplement cartridge.

Raise the louvre and press the right side of the supplement cartridge to remove it.

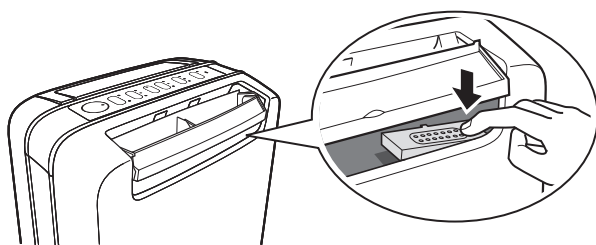

CAUTION

Keep the supplement cartridge out reach of children.
Do not disassemble or tear the bag inside the cartridge.
Make sure children do not swallow the contents.

What is supplement air?

Recognizing the antioxidant qualities of natural herbs, we put the oil extracted from rosemary, which has exceptional antioxidant qualities, into the air outlet cartridge.

The fragrance is so slight that it can be hardly noticed.

The reason washing yellows is because colourless organic material trapped within the fibers is oxidized by heat from a drier or the sun's UV rays.

By using the dehumidifier and drying your washing indoors, you can keep away the oxidizing effects of heat and UV rays, as well as benefit from rosemary's antioxidant properties, preventing your clothes from yellowing.

Furthermore, herbs are effective in removing odor.

Information

- The unit can be operated without the cartridge.
- It is possible to continue operation with a supplement cartridge for which the replacement time has elapsed in the unit, but antioxidants will no longer be dispersed.
- Use the original bag when storing the cartridge after a short use(1-2 months).

Cartridge life

Replace the cartridge after 6 months (not including the time it is stored in the bag).

Replacement of cartridge is available for purchase.

Only the cartridge is replaced. Do not throw away the case. P23

Inserting the water tank correctly

Check the water tank, and push it firmly all the way into the unit

Tank lid

Press the edge to insert it firmly into place.

Water tank

Make sure the tank is not broken or cracked.

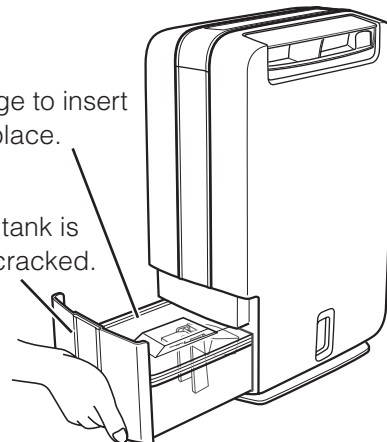

Plug the power cord into the power socket

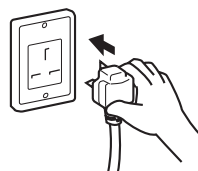

Use a 220V AC power socket only.

If the louvre is opened, it closes automatically.

Carrying the Unit

1 Empty the tank and close the louvre.

Moving the unit without emptying the tank may cause an accident due to, for example, the floor or household belongings becoming wet as a result of water spilling out of the tank.

2 Raise the handle to carry the unit.

Carry the unit slowly and gently.

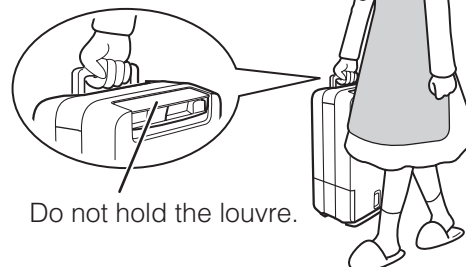

Do not hold the louvre.

Note

- **Do not attempt to carry the unit horizontally.** Tilting the unit will result in the water spilling and cause a malfunction.
- Do not let the power cord drag, as this may damage the cord.

Drying Laundry (Intelligent Laundry)

The unit performs operation automatically while monitoring the temperature and humidity in the room, thus alleviating the need for advanced settings.

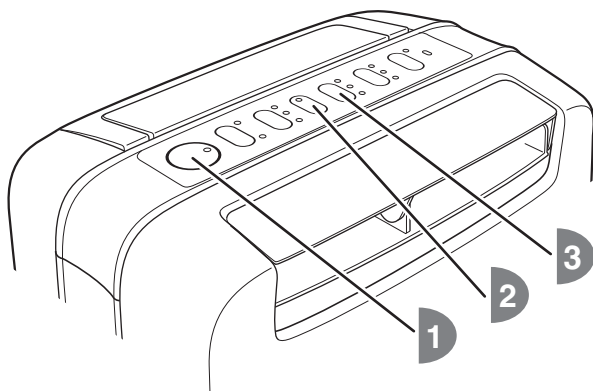

1 Press .

- The POWER lamp lights.
- The operating mode lamp lights.
- The louvre opens and airflow starts.

Information • The unit remembers the operating mode. Even if the plug is disconnected or the power turned off, the unit restarts at the previous setting. (The swing setting is not remembered)

2 Press .

- The INTELLIGENT LAUNDRY lamp lights.

3 Press to select the louvre swing direction. **P13**

<To stop operation>

Press .

- The POWER lamp turns off.
- The operating mode lamp turns off.
- Air is blown for approximately 2 minutes, and then operation stops and the louvre closes automatically.

Information • **To prevent the temperature inside the unit from rising, the blower fan rotates for approximately 2 minutes before operation stops.** Wait until the blower fan stops before unplugging the power cord.

● Intelligent Laundry

The unit controls the airflow rate while monitoring the humidity in the room, estimates when the clothes will dry, and stops operation automatically. These operations are performed for a period of time ranging from approximately 1 hour to 12 hours.

Rough Guide on Usage	Size of room	Amount of laundry
	Up to approx. 7m ²	Up to approx. 2.5kg

Keep usage within the ranges specified in "Rough Guide on Usage" to ensure efficient drying.

- Information**
- **Drain the tank before use.**
The unit may stop before the laundry dries because of a full tank.
 - **If this is used in conjunction with the OFF timer, operation may stop before the clothes are dry. **P16****
 - **When the room temperature is approximately 5°C or less, operation stops after about 1 hour because the evaporation of moisture becomes difficult and the clothes will not dry.**
In such a case, use the unit with dehumidifying set to "HIGH."

Tips on Drying Laundry

To dry laundry quickly and neatly

How to Hang Clothes

- **Fully extend the clothes to remove any wrinkles**
- **Leave space between clothes to allow air to easily pass through them (Guideline for spacing: Approximately 5 cm)**
- **Hang any difficult to dry items in positions where wind can easily come into contact with them**

Clothes placed close together will take time to dry.

<Drying takes a long time in the following cases>

- When there are a lot of clothes
- When the room temperature is low
The drying time required at a low temperature (approximately 10°C) is around 1.5 times that at a normal temperature (approximately 20°C).
- When the room is large P10

How to Blow Air at Clothes

- **Use the swing louvre to blow air onto all of the clothes P13**

Clothes placed in locations that are not exposed to the wind will take time to dry.

- **When there are a lot of clothes**

Change the hanging positions of the clothes during drying to ensure air is blown onto all of the clothes.

About the Room for Hanging Clothes

- **Hanging the clothes in a small enclosed room and dehumidifying**

It allows for very efficient dehumidifying and quick drying.

- **When the room temperature is low such as during the winter**

Drying becomes easier if you also use a heater to raise the room temperature to approximately 16°C or more.

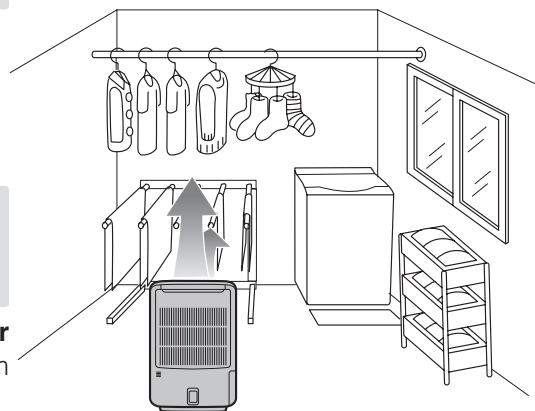
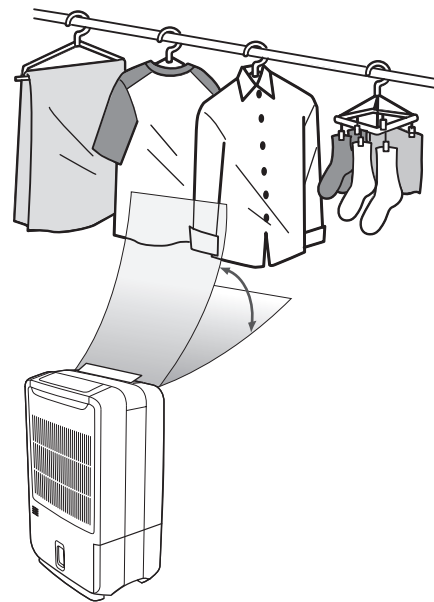

Using the unit to dry clothes hung in a room is recommended on days such as the following.

- **Cloudy and rainy days**



Drying clothes hung outside takes a while on days with high humidity because it is difficult for water to evaporate.

- **Days with a lot of pollen and dust in the air**



Hanging clothes inside enables you to prevent pollen and dirt getting on them.

- **Days you are unable to bring in the washing during daylight hours**

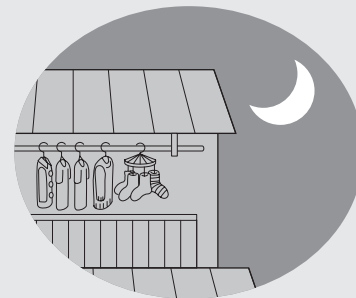

Dry clothes absorb dampness when the air cools outside after the sun sets, meaning your efforts will have gone to waste.

Dehumidifying

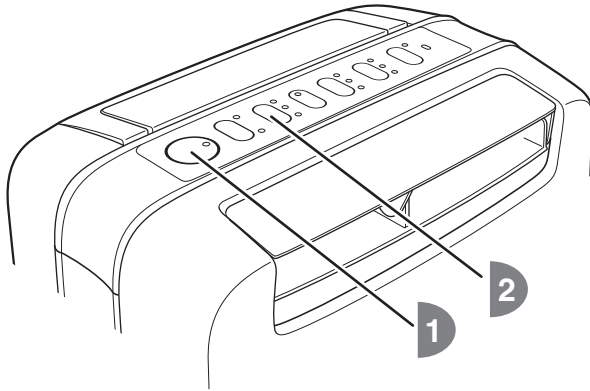

1 Press .

- The POWER lamp lights.
- The operating mode lamp lights.
- The louvre opens and airflow starts.

Information • The unit remembers the operating mode. Even if the plug is disconnected or the power turned off, the unit restarts at the previous setting. (The swing setting is not remembered)

2 Press to select the operating mode.

- Changes with every press.



■ Use the swing louvre as desired. P13

<To stop operation>

Press .

- The POWER lamp turns off.
- The operating mode lamp turns off.
- Air is blown for approximately 2 minutes, and then operation stops.

Information • **To prevent the temperature inside the unit from rising, the blower fan rotates for approximately 2 minutes before operation stops.** Wait until the blower fan stops before unplugging the power cord.

● LOW

Dehumidification is performed continuously with the airflow rate and heater in LOW level regardless of the current humidity.

● HIGH

Dehumidification is performed continuously with the airflow rate and heater in HIGH level regardless of the current humidity.

● AUTO

The unit operates intermittently controlling the airflow to remove the damp feeling in the air. When the room temperature is high, the blower operates to reduce the rise in room temperature.

- Once the set humidity level is reached the airflow and louvre operations may stop.

Rough Guide on Usage

Size of room	Up to approx. 9m ²
--------------	-------------------------------

Keep usage within the ranges specified in "Rough Guide on Usage" to ensure efficient operation.

- If the room is large, the humidity level may not fall to the set humidity level.

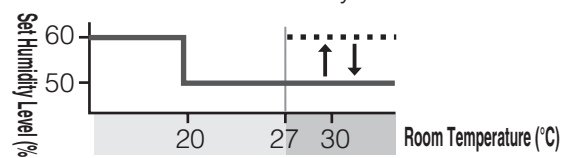

If the room temperature is below 27°C, the unit changes the set humidity level according to the room temperature, and starts dehumidifying.

If the room temperature is above 27°C, the unit dehumidifies until the humidity level reaches 50%, and then activates the blower. The dehumidifier is reactivated when the humidity level rises to 60%.

Using Louvre

The louvre can be made to swing. Use the louvre in accordance with the intended use.

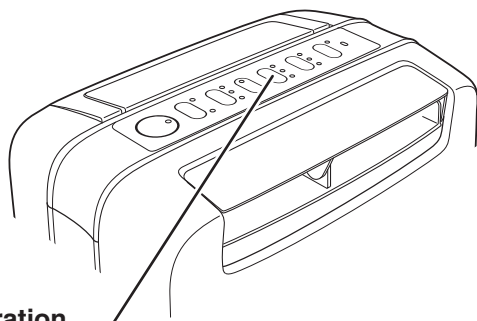

During operation,
press **SWING LOUVRE** to select the
louvre swing direction.

- Changes with each press for swing direction.

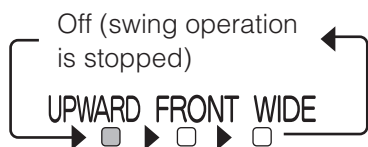

● UPWARD

For drying clothes, etc.

Swing speed is automatically controlled to send air at clothes from all angles. The blowing range is approximately 90°.

If the louvre swings at the same speed all the time, the airflow will be directed on the clothes in front of the unit for a shorter period than in the upward direction. Therefore, the louvre swings slowly for the 30° portion shown at right.

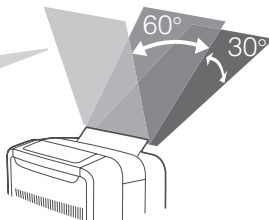

● FRONT

When you want to dehumidify the inside of closets, etc.

The louvre swings so that air is blown from the front of the unit. The blowing range is approximately 60°.

● WIDE

To cover the entire room

The louvre swings so that air is blown over a wide area. The blowing range is approximately 145°. (The moving range of the louvre is approximately 120°.)

● Stop swing operation

To stop the louvre at the desired angle

- The louvre stops in the vertical position.
- The **SWING LOUVRE** lamp turns off. Wait until the louvre stops before you adjust the angle by hand.

When you want to use the “downward blowing louvre”

Use this when you want to perform the “bathroom mildew guard” operation, dehumidify bedding, carpets, or tatami, or dry training shoes.

- Stop the swing operation, and raise the louvre.

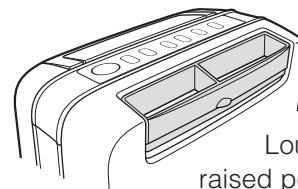
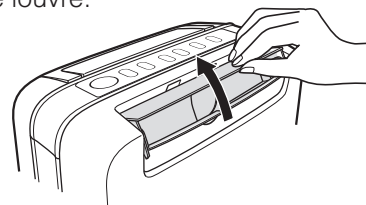

Louvre in raised position

- Hold the tab and pull up the bottom blowing louvre.

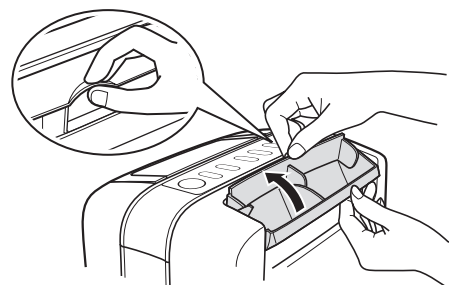

- Lower the louvre.

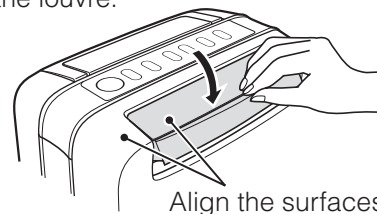

Align the surfaces

Preventing condensation on windows and dehumidifying the inside of closets or shoeboxes

Use the swing louvre to blow air at the location you want to dehumidify.

<Recommended Operating Mode>
Dehumidifying “HIGH”



Information

- The level of noise emitted from the unit varies according to the angle of the air-flow.
- The louvre sometimes stops for up to about 8 seconds to align the position, but it will start moving again afterwards.
- If the louvre is knocked out of the desired angle because the louvre is touched by a hand or object, press the SWING LOUVRE switch again to readjust the position.
- If air is blown directly onto a wall, the wall may become dirty because of dust in the air being blown onto the wall.
- When you want to dry training shoes, place them at a position that is a little higher than the floor.

Reducing Growth of Mildew in Bathroom (Bathroom Mildew Guard)

This operation is for reducing the growth of mildew by drying the inside of a bathroom to remove any humidity and droplets that remain inside after, for example, you take a bath. This operation can also be used as a measure for tackling mildew in rooms.

Installing the Dehumidifier

Install the unit in the dressing room (entrance to the bathroom).
(Do not install the unit inside the bathroom.)

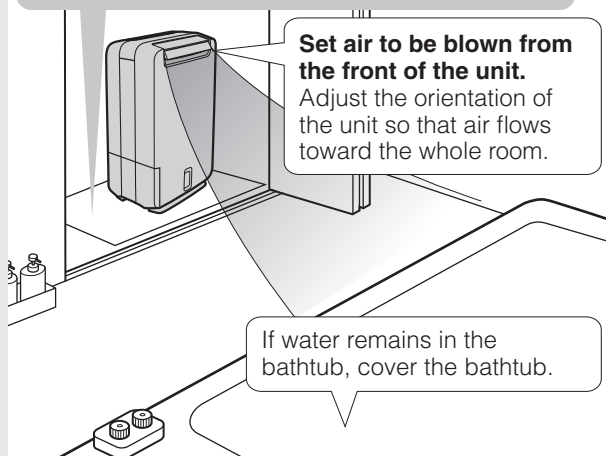

CAUTION

Do not use the unit in a bathroom or other location where it is likely to come into contact with water, or wash it with water.
The unit does not have a drip-proof or water-proof structure. Water coming into contact with the unit may result in a fire due to a short circuit, or an electric shock.

Rough Guide on Usage

Location to be dehumidified	Size
Bathroom (bathroom + dressing room)	Up to approximately 7m ² (size of bathroom + dressing room)
Room	Up to 9m ²

For more effective operation, use the unit within the above ranges.

Information

- For effective use, keep the windows and doors of the room closed and do not ventilate the room during operation.
- Operation may not be sufficiently effective if the bathroom is spacious or because of the building materials used for the floor and walls of the bathroom.
- Drops of water may remain in places where water collects easily.
- Mildew may grow depending on the room conditions and the type of mildew.
Example: Where air circulation is poor such as beneath a container or the like in the bathroom or at the back of a cupboard or behind furniture in the bathroom.
- This operation cannot dry locations where the airflow cannot reach such as inside a bathtub and beneath a container.
- This operation cannot remove existing mildew and water scale, or slime in the drain outlet.
- If this operation is used in conjunction with the off timer, operation may stop before drying is complete.

About Bathroom Mildew Guard Operation

After dehumidifying is performed until the humidity reaches 50%, operation is performed for approximately 4 hours and then stopped automatically. The operation time varies depending on the temperature and humidity, but the minimum time is approximately 4 hours (approximately 6 hours when the room temperature is 20°C or less) and the maximum time is approximately 12 hours.

How is mildew growth suppressed?

Mildew is unable to produce new spores if dried as mycelia. The Mildew Guard feature applies this principle. (However, the spores themselves are resilient to dry conditions.)

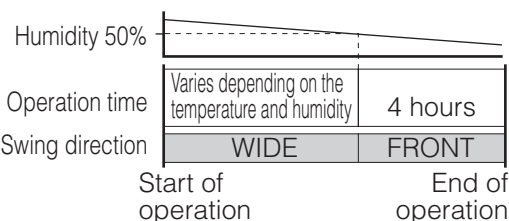

"Identification of Black Mold"
[Research paper by Dr.K.Abe of the Environmental Biology Research Center]

<Preparation> Install the dehumidifier in the dressing room

- Use the "downward blowing louvre" operation. P13

1

Press



P10

2

Press



to select
"BATHROOM MILDEW GUARD".

- Changes with every press.



- The BATHROOM MILDEW GUARD lamp lights.
- The swing louvre operation starts (blowing set to "WIDE" and "FRONT").

- Operation stops after approximately 4 to 12 hours.
The POWER lamp and BATHROOM MILDEW GUARD lamp turn off.

- The louvre operates in the "WIDE" swing direction until the humidity drops to 50% and then automatically switches to the "FRONT" swing direction. The swing direction can be changed according to preference. P13
- The airflow rate cannot be set because it is changed automatically. Do not use this operation in conjunction with other operations.

<When you want to abort the operation>

- When you want to end the operation partway through:
Press the POWER switch (OFF).
- When you want to switch to another operation:
Press any one of the "INTELLIGENT LAUNDRY", "DEHUMIDIFYING", and "MODE" switches.

Removing Odor from Clothes (Clothes Deodorant)

This unit operates for approximately 1 hour to remove odor from clothes by blowing warm air on them.

Use this operation when you want to remove odor from clothes that are not frequently washed, such as suits and sweaters.

<Use for odor from the following>
Cigarettes and grilled meat

How to Hang Clothes

Secure hangers so they will not be moved by airflow.

Space out laundry to improve airflow.

Allow pants to hang unfolded.

Fasten the buttons on suits, coats, and the like.

When odor is absorbed into the fabric, allow air to blow inside the hanging garment.

Note

- Do not use for leather and silk goods.
- Drain the water tank before operating.
- Ensure ventilation during operation.

Information

- The odor cannot be removed in the following cases.
 - When the temperature and humidity inside the room are low.
 - When there are many clothes.
- The odor will not be removed from parts not blown by the wind.
- The sharp odor such as perfumes and chemicals cannot be removed.
- The odor of oil and dirt on clothes cannot be removed.
- If the operation has little effect, try the operation again, or wash or clean the clothes.

<Preparation> Hang the hangers on which the clothes are hung, and then place the dehumidifier beneath them.

1 Press **POWER ON/OFF** P10

2 Press **MODE** to select "DEO-DRY".

- Changes with every press.

DEO-DRY BATHROOM MILDEW GUARD

- Operation stops after approximately 1 hour. The DEO-DRY lamp turns off.

The airflow rate cannot be set because it is changed automatically. Do not use this operation in conjunction with other operations.

3 Press **SWING LOUVRE** to select the louvre swing direction. P13

The odor will not be removed from parts not blown by the wind. Select a swing direction that enables a good amount of wind to blow the clothes.

<When you want to abort the operation>

■ **When you want to end the operation partway through:**

Press the POWER switch (OFF).

■ **When you want to switch to another operation:**

Press any one of the "INTELLIGENT LAUNDRY", "DEHUMIDIFYING", and "MODE" switches.

<Details on Clothes Deodorant Operation> This operation takes approximately one hour.

CLOTHES DEODORANT switch (ON)

Clothes deodorant operation (Approx. one hour.)

Dehumidifying operation (maximum airflow rate)

A strong wind is used to blow away odors.

Approx. 30 min.

Dehumidifying operation (high airflow rate)

The temperature of the wind is raised to remove odors that have penetrated deep into fabric.

Approx. 30 min.

Auto Stop

Operating

Using OFF Timer

You can select an operating time from “2”, “4”, and “8” hours.

When the set time is reached, the unit switches itself off automatically. Set the OFF timer while the unit is “ON”.

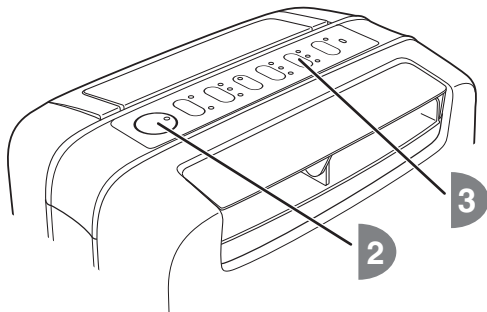

1 Removing water from the tank.

If the water tank becomes full, dehumidifying is not possible because the unit automatically shuts down. Empty the water tank before operating.

2 Press P10

Set the desired operating mode **P10-15** and louvre swing direction. **P13**

3 Press to select the operating time.

- Changes with each press.



- The lamp for the selected time lights. (Off time operation starts)
- The OFF timer lamp (remaining operation time indication) changes as time passes.
- When the set time is reached, the unit switches itself off and the louvre closes automatically. The POWER lamp turns off.

<When you want to cancel the OFF timer before the set time is reached>

■ When you want to turn the unit off

Press the POWER button. (Power off)

■ When you want to disable the OFF timer and continue operation

Press the OFF TIMER switch repeatedly until the operating time lamps go out.

Information

- If you use the “INTELLIGENT LAUNDRY” operation or “BATHROOM MILDEW GUARD” operation together with the off timer, the operation may end before drying is complete.

CLEAN FILTER Lamp

When it becomes time to clean the silver ion filter and air intake, you are notified by the flashing or lighting of the CLEAN FILTER lamp. Press the POWER switch to turn off the power, and then make sure you perform cleaning before pressing the RESET button.

CLEAN FILTER lamp flashes.

When the operation time becomes approximately 150 hours, an alarm sounds and the CLEAN FILTER lamp flashes.

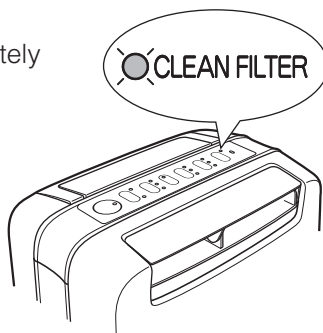

Clean the silver ion filter and air intake, and then insert the power plug and press the RESET switch until you hear a beep. **P21**

If you continue use without performing cleaning:

CLEAN FILTER lamp lights.

If you continue operation for approximately another 150 hours while the CLEAN FILTER lamp is flashing, an alarm sounds, the lamp lights, and operation stops.

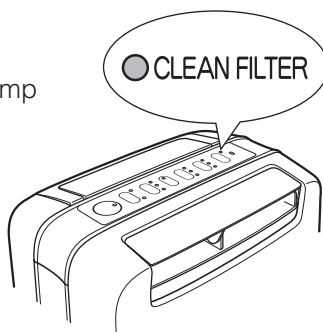

In the following cases as well, the CLEAN FILTER lamp lights and operation stops to prevent the temperature inside the unit from rising.

- The silver ion filter and air intake are clogged.
- The air outlet and filter cover are blocked by a curtain, towel, or the like.
- The room temperature is high (approximately 40°C).

Clean the silver ion filter and air intake, and then insert the power plug and press the RESET switch until you hear a beep. **P21**

Information

- Operation is not possible while the CLEAN FILTER lamp is on.
- When the CLEAN FILTER lamp is flashing or on, an alarm sounds each time you turn on the POWER switch.

Draining

The unit automatically shuts down and lights the Tank full lamp when the tank is full.
Empty the water tank.

When the water tank becomes full, the “FULL lamp” lights.

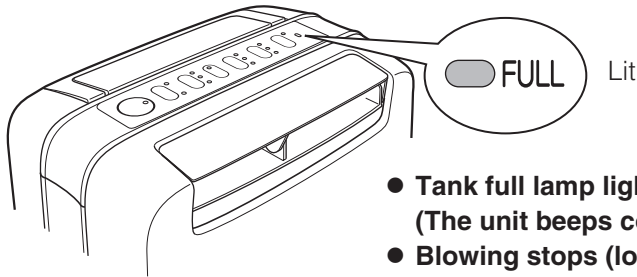

- Tank full lamp lights.
(The unit beeps continuously).
- Blowing stops (louvre stops).
- The operation indicator lamp turns off.

Information

- After removing the water and replacing the tank, the Tank full lamp will go off, and the unit will automatically return to operation mode.
- When the Tank full lamp is lit, no operation but ON/OFF is possible.

1 Remove the water tank.

Grasp handle and slide out.

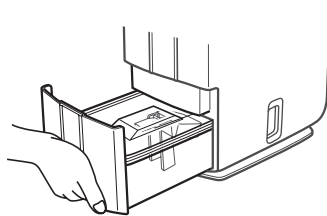

If you remove the tank, the FULL lamp lights.

<Hold the tank this way>

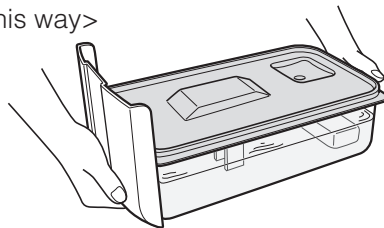

2 Remove the tank lid, and pour out the water.

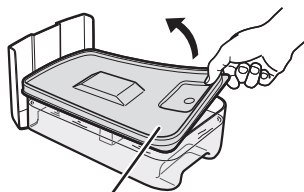

Tank lid

Floating element
Do not remove this.

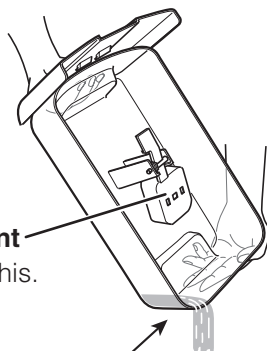

Pour the water out as shown.

3 Slide the tank lid to close the tank.

Check the tank lid, and firmly push it all the way in.

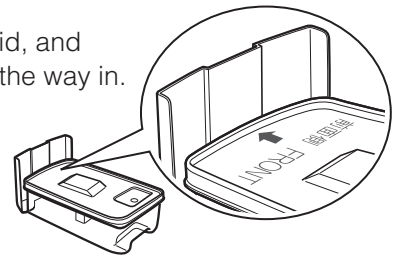

4 Check the tank, and firmly push it all the way in.

Tank lid

Press the edge to insert it firmly into place.

Water tank

Make sure the tank is not broken or cracked

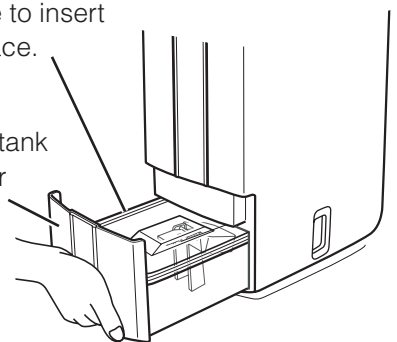

- A beep is heard and the lamp turns off.

Information

- Not attaching the tank lid properly may result in water leaking.
- If the tank lid is not inserted firmly, it may not be possible to remove the tank.
- If the tank is not installed correctly, the tank full light will come on, and the unit will not operate.

Note

Do not remove or dismantle the floating element in the tank. If it is removed, the unit cannot detect when the tank is full, and this could result in leakage.

Continuous Drainage

If a drain is available, the unit can continuously drain excess water by attaching a commercially available hose (internal diameter 15mm).

The unit can be operated for extensive periods without the need to empty the water tank.

Items to prepare

- **Commercially available hose (I.D. 15mm)**
Long enough to reach the drain
- **Nippers or the like**

How to set up the drainage hose

Correctly installed



Incorrectly installed

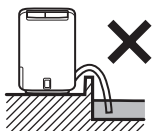

- hose immersed in water
- hose raised to a level higher than the drainage outlet
→ **The water will not drain.**

<Preparation> Turn the **POWER switch "OFF"**, and remove the power plug.

1 Remove the water tank.

Grasp handle and slide out.

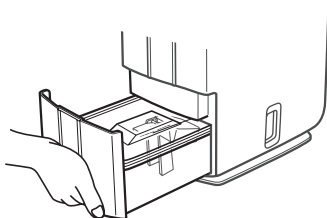

2 Open the continuous drainage outlet.

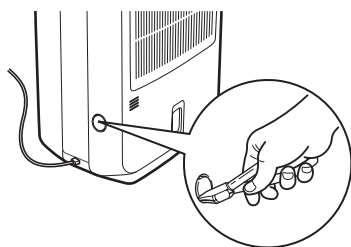

Position of drainage outlet

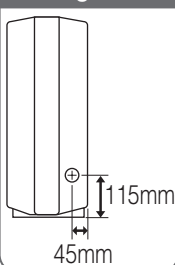

Use nippers or the like to cut the fixing ribs (three places) of the continuous drainage outlet on the back of the unit, and remove it from the outlet (while taking care not to injure yourself on a cut surface).

3 Use a finger to press the stopper of the drainage outlet.

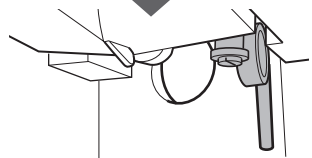
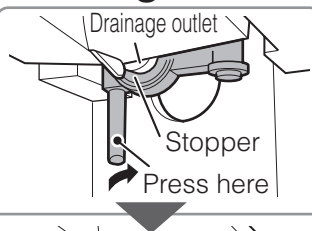
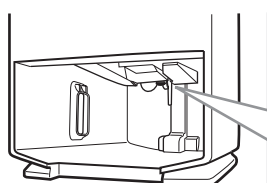

Note

- When you will perform continuous drainage, leave at least 20 cm of space from the surface with the outlet for the hose.
- Confirm that the hose does not show signs of deterioration such as bending cracks and clogging.
- Inspect the hose every 2 weeks. Insects or dirt blocking the hose may cause leakage resulting in malfunctions.



CAUTION



Do not drain water continuously if there is a possibility that temperatures around the hose could drop below freezing point.

Water inside the hose may freeze and water may leak from the unit and **damage surrounding objects.**



When draining water continuously or left unattended for long periods, inspect the unit once a fortnight.

Foreign objects, etc. could clog the hose **resulting in overheating and/or leakage.**

4

Insert the hose through the continuous drainage outlet from the back of the unit.

- ① Feed the commercially available hose (internal diameter of 15 mm) into the continuous drainage outlet while keeping the stopper pressed.

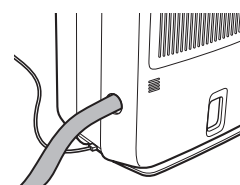
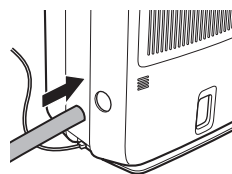

- ② Firmly push the hose through the drainage outlet of the unit.

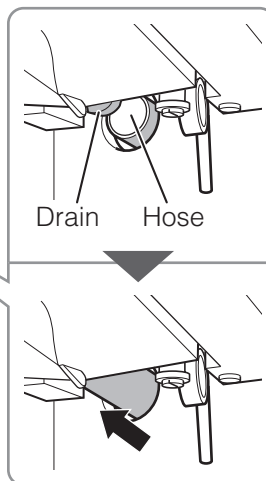
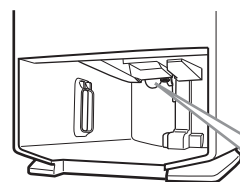

- ③ Check for water leakage.

5

Attach the tank to the unit, and place the end of the hose in the drain location.

If the tank is not reattached, the "FULL lamp" remains on and operation is not possible.

Maintenance

Do not use detergents, cleaning agents for heat exchange equipment, abrasive powders, chemically treated dusters, gasoline, benzene, thinners or other solvents, as they can damage the unit or the water tank, which may result in leakage.

Remove the power plug before you begin maintenance.

Frequency and Parts for Maintenance

When dirty

- Tank
 - Unit
- Wipe with a dry cloth P20

Once every two weeks

- Silver ion filter
 - Air intake
 - Sensor
- Clean with a vacuum cleaner P21

○ CLEAN FILTER Flashes or lights

Once every three months

- Silver ion filter
- Soak in water P22

When dirty

Water tank • Unit

Wipe with a soft cloth.

Floating element

Do not remove or dismantle.

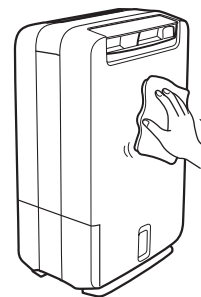
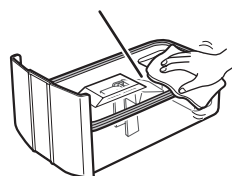

- The unit draws in dust present in the air, and this may cause the tank to **gradually become dirty**. If the dirt does not come off easily, wash with cold or warm water, then wipe with a soft, dry cloth.
- Mildew may form in the tank unless kept clean.

Once every two weeks or when the CLEAN FILTER lamp flashes or lights

Silver Ion Filter, Air Intake, and Sensor

Clogging with dust and the like reduces the effectiveness of the dehumidifying.

Clean once every two weeks

Removing and setting the filter, see **P8**

Press the **POWER** switch to turn off the power, wait until the blower fan stops rotating (approximately 2 minutes) before unplugging the power cord.

1 Remove the filter cover.

2 Remove the silver ion filter from the filter cover.

3 Clean the filter.

Remove any dust from the white net surface with the nozzle of a vacuum cleaner.

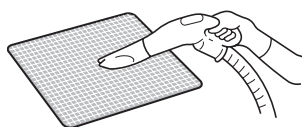

Do not use a nozzle with a brush. This may damage the filter.

<When the filter is very dirty>
Soak the filter in water. **P22**

4 Clean the air intake and sensor.

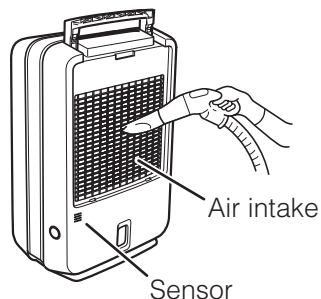

Remove any dirt with a vacuum cleaner.

Do not use a nozzle with a brush.
This may damage the filter.

5 Set the silver ion filter into the filter cover.

Make sure the silver ion filter is attached to the unit. If it is not, fine dust will enter inside the unit and cause a malfunction.

6 Set the filter cover.

Resetting the CLEAN FILTER lamp

- ① Insert the power plug in a power socket.
- ② Press the RESET switch until you hear a beep (for approximately 3 seconds).

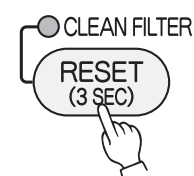

Press
until you hear a beep.

Maintenance (cont.)

Once Every Three Months

Silver Ion Filter (Soak in Water)

Soak the silver ion filter in water.

Removing and setting the filter, see P8

Press the **POWER** switch to turn off the power, wait until the blower fan stops rotating (approximately 2 minutes) before unplugging the power cord.

1 Remove the filter cover.

2 Remove the silver ion filter from the filter cover.

3 Clean the filter.

Remove any dust from the white net surface with the nozzle of a vacuum cleaner.

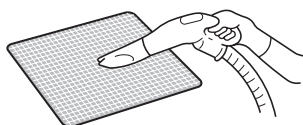

Do not use a nozzle with a brush. This may damage the filter.

4 Soak the silver ion filter in water.

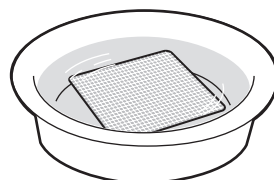

Soak in cool to lukewarm water for about 30 minutes.

Do not use detergent or hot water. Also, do not use a brush or the like to scrub the filter or rub the filter while soaking. This may damage the filter.

- Any yellow or dark stains may remain on the filter, but should not affect performance.
- The filter can be soaked for a total of eight times. After that, replace with a new filter.

5 Dry the silver ion filter well.

Dry the filter on a flat surface.

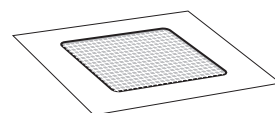

6 Set the silver ion filter into the filter cover.

7 Set the filter cover.

Replacement Parts

The silver ion filter and supplement cartridge become depleted over time.

Replace them when necessary. (The dehumidifier can still operate without replacing the supplement cartridge. Replace as desired.)

Replacing the silver ion filter

Although the silver ion filter lasts roughly 2 years, replace it when:

- You have soaked the filter 8 times.
- The silver ion filter has turned brown due to cigarette smoke or black with dust.

Filter life differs on usage and environmental conditions

Remove the filter cover from the unit, and replace the silver ion filter.

Removing and setting the filter, see **P8**
When disposing the filter, see **P23**

Replacing the supplement cartridge

Replace after 6 months.

Remove the supplement cartridge and replace it.

Removing and setting the cartridge, see **P8-9**
When disposing the unit, see **P23**

Parts sold separately

Silver ion sterilizing and deodorizing filter for replacement

- Type: MJPR-7AXFT

Replacement supplement cartridge

- Type: MJ-E100SPL
(This contains the same content as KD-E100SPL)
- Type code: 5C5 810

Please contact your nearest Mitsubishi Electric dealer for purchase.

Storage and Disposal

Storage

After switching the unit off, leave for one day until any water inside has had time to settle. Then carry out the following steps.

1 Wrap the power cord.

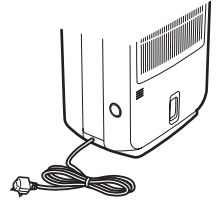

2 Remove the drainage water.

P18

3 Clean the silver ion filter.

P21

Remove any dust from the white net surface with the nozzle of a vacuum cleaner.

4 Clean the air intake.

P21

Remove any dust with the nozzle of a vacuum cleaner.

5 Store the unit.

- When you are sure that all parts of the unit are dry, cover it with a cloth to keep it from dust.
- Store the unit in an upright position in a place not exposed to direct sunlight.

When disposing the unit

Dispose according to the garbage regulations in your district.

● Silver ion filter

Material: PET

● Supplement cartridge

Material: PP

Do not disassemble. Dispose as plastic waste.



● Unit

Do not disassemble. Dispose according to the garbage regulations in your district.

E

Troubleshooting

● For the symptoms listed below, refer to the remedies listed right.

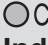
Symptom	Cause/Remedy
The room temperature rises during operation (The unit blows warm air)	<ul style="list-style-type: none"> ● The dehumidifier does not have a cooler function. Due to heat produced during operation, the room temperature may rise 3-6°C. (If operation is performed with the unit set to Dehumidifying "LOW" or "AUTO", the rising of the room temperature can be minimized compared to other operating modes.)
Water does not collect in the water tank (minimal dehumidifying results)	<ul style="list-style-type: none"> ● Is the silver ion filter clogged? → Clean it as described in "Maintenance." P21 ● Is the air intake or air outlet blocked? → Remove the item that is blocking it. P5 ● Do the temperature and humidity become low? The amount of dehumidifying becomes less as the temperature and humidity in the room drops. P3
The unit does not operate (No air comes out and the louvre does not swing) The unit stops	<ul style="list-style-type: none"> ● Check to see if the power cord is correctly plugged. → Plug the power cord properly into the power socket. P9 ● Is the air intake or air outlet blocked? → Remove the item that is blocking it. P5 ● Is operation being performed with the unit set to Dehumidifying AUTO? → The unit is switching between the dehumidifying operation, blowing operation, and stop state automatically. P12 ● Is operation being performed with the unit set to Bathroom Mildew Guard? → Operation stops automatically if the humidity falls. Operation stops after a minimum of 4 hours. P14
Stops after a short time	<ul style="list-style-type: none"> ● Is operation being performed with the unit set to "Intelligent Laundry"? → Operation stops after approximately 1 hour if the room temperature is approximately 5°C or less. This is because the evaporation of moisture from clothes becomes difficult and humidity does not change if the room temperature is low. P10 ● Is operation being performed with the unit set to DEO-DRY? → This operation is designed to end after approximately 1 hour. P15
 FULL Indicates	<ul style="list-style-type: none"> ● Check to see if the water tank is full. → Empty the water tank and return it to its original position. P18 ● Check to see if the water tank is inserted properly. → Adjust the position of the water tank. P9
 CLEAN FILTER Flashing or on	<ul style="list-style-type: none"> ● I am being notified that it is time to clean the silver ion filter, air intake, and sensor. → Clean them as described in "Maintenance," and then reset the lamp by pressing the RESET switch until you hear a beep. P17-21
 CLEAN FILTER Indicates	<ul style="list-style-type: none"> ● Has the room temperature become high (approximately 40°C or more)? → Operation sometimes stops to prevent the temperature inside the unit from rising. Reset the lamp by pressing the RESET switch until you hear a beep. P17 ● Is the air intake or air outlet blocked? → Remove the item that is blocking it, and then reset the lamp by pressing the RESET switch until you hear a beep. P5 P17-21
The unit continues to operate even though it is turned off	<ul style="list-style-type: none"> ● Even if the POWER switch is turned off, the blower fan rotates for approximately 2 minutes to prevent the temperature inside the unit from rising. Wait until the blower fan stops before removing the power plug. P10
The humidity level does not drop easily	<ul style="list-style-type: none"> ● Check to see if the room is not too large. ● Check to see if the exits to the room are open. → Refrain from opening doors/windows during operation. ● Check to see if steam producing appliances such as kerosene heaters are on in the vicinity.
The louvre does not move as set	<ul style="list-style-type: none"> ● Press the Swing louvre switch again. P13
Water leaks from the unit	<ul style="list-style-type: none"> ● Is the unit tilted or in a non-upright position? ● Did you carry the unit without emptying the water from the tank? ● Is the floating element disconnected? ● Is the tank cracked or broken? → Purchase a new tank for replacement.

Symptom		Cause/Remedy
The water tank contains liquid or white water residue		<ul style="list-style-type: none"> The residue is from final product testing at the factory. It is not a result of a malfunction.
There is black residue on the inside of the water tank and lid.		<ul style="list-style-type: none"> The residue is from debris in the air. → Clean according to the maintenance procedures. P20
The power plug and socket are unusually hot.		<ul style="list-style-type: none"> Stop using the unit, and contact the place of purchase or Mitsubishi Electric Service Center.
The unit makes noises	The operating noise is loud/reverberates	<ul style="list-style-type: none"> Check to see if the unit is on a slope or uneven surface. → Move to a sturdy even surface. P5-7 Check to see if the silver ion filter is clogged. → Clean according to the maintenance procedures. P21 Operating the unit in small rooms or in tight spaces sometimes causes the sound to reverberate. → Place a mat underneath the unit. P7
	The operating sound varies and sometimes stops.	<ul style="list-style-type: none"> This occurs because the unit checks the rotation state of the motor once every approximately 10 seconds. It is a function for safety purposes. This is not a malfunction.
	The wind sound changes in volume	<ul style="list-style-type: none"> The volume of the sound differs depending on the angle of the louvre. P13
	The unit produces frizzling and whirring sounds.	<ul style="list-style-type: none"> This is the sound of the motor inside the dehumidifier. This is not a malfunction.
The unit produces an odour		<ul style="list-style-type: none"> An odour may be emitted from the parts inside the dehumidifier when you first use the dehumidifier. Odorants that cannot be removed by the silver ion filter may be absorbed by the dehumidifier rotor inside the unit. Odors unique to zeolite (sour smell, burning smell, etc.) may be emitted from the dehumidifier rotor. These odors have no effect on humans and animals. If the room contains any of the following items, the corresponding odor will be absorbed by the dehumidifier rotor inside the dehumidifier. Also, that absorbed odor will be heated by the heater, which may result in a burning like smell or other abnormal odor. Examples: Cigarettes, cosmetics, hair dressing products, building materials, new furniture, etc.

● Error message

Digital display	Cause/Remedy
<div> <div>2</div> <div>4</div> <div>(HR) 8</div> </div> The three OFF TIMER lamps light.	<ul style="list-style-type: none"> Check to see if the power cord is plugged into the power socket properly. → Plug the power cord into the power socket properly.
The POWER lamp and the operating mode lamp of the current operating mode flash.	<ul style="list-style-type: none"> The fall detection switch is operating. Is the unit tilted or in a non-upright position? → Use the unit on a flat surface. Check that no water is leaking from the tank, and turn the POWER switch off and then back on.
One of the OFF TIMER, SWING LOUVRE, and operating mode lamps flashes.	<ul style="list-style-type: none"> Reinsert the power plug in the power socket. <If the problem persists even after reinserting the power plug> This is a malfunction Take note of error message, unplug the power cord, and contact the place of purchase.

If the symptoms persist even after following the prescribed remedies, or the error message does not disappear, unplug the power cord, and contact the place of purchase.

Specifications

Model		MJ-EZ6CX-H
Power supply		Single phase 220V 50Hz
Dehumidifying capacity		6.0 L/day
Power consumption	HIGH	545W
	LOW	280W
Operating sound	HIGH/LOW	46/37dB
	LAUNDRY	49dB
Water tank capacity		stops automatically at approx. 2.4L
Weight		7.0kg
Dimensions (H × W × D)		485mm × 190mm × 324mm

- The dehumidifying capacity is a value obtained when the dehumidifier is continuously run at a room temperature of 30°C and relative humidity of 80%. It indicates the amount of dehumidification per day (24 hours).
- Standby power approximately 1W.

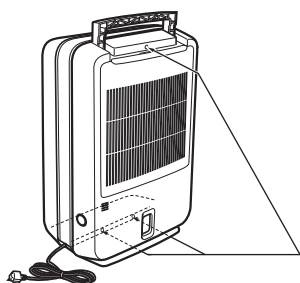

NOTE

It is impossible to remove the back panel because the three spots shown are fastened with three special screws.

- If the supply cord is damaged, it must be replaced by the manufacturer, its service agent in order to avoid a hazard. Contact the Service Center listed below for more information.

Sole Agent in Hong Kong

Mitsubishi Electric Ryoden Air-Conditioning & Visual Information Systems (Hong Kong) Limited.

Head Office: Tel.: 2510 1505 Service Center: Tel.: 2427 8484

Fill in the following for your future reference.

Place of purchase:		Telephone number:	
Authorised Service Centre:		Telephone number:	
Date of purchase:	Day	Month	Year

 **MITSUBISHI ELECTRIC CORPORATION**