

K10 General Purpose

Maximum Measuring Length (ML) 50 ft.
/ 15 m.

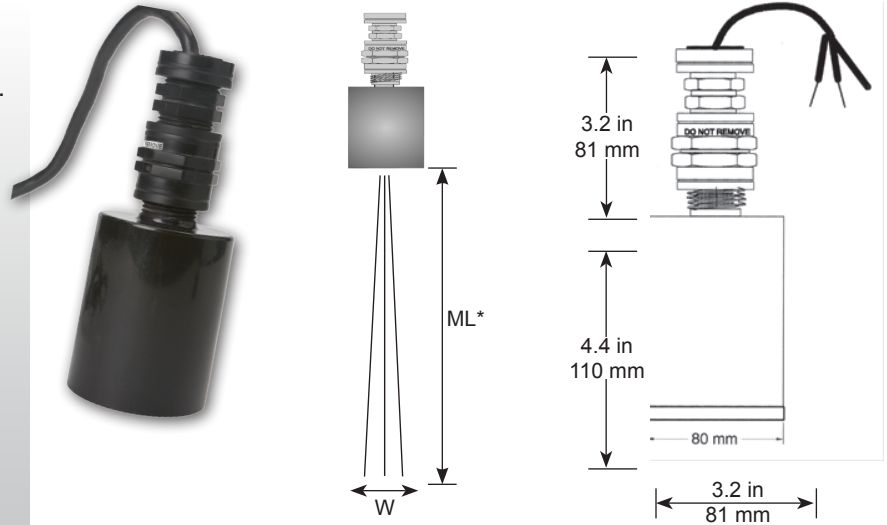

K10F Solids Applications

Maximum Measuring Length (ML) 50 ft.
/ 15 m.

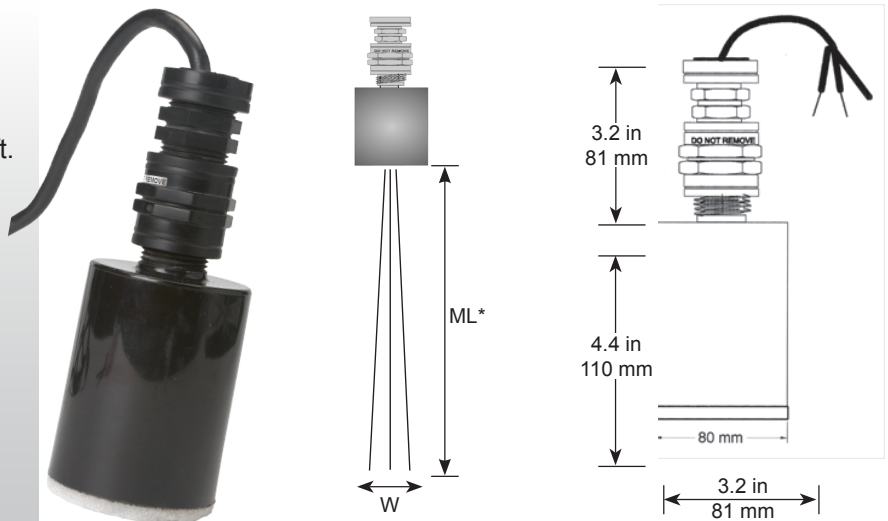

K10T3 PTFE Lined Transducer, 3 inch Flange

Maximum Measuring Length (ML) 50 ft.
/ 15 m.

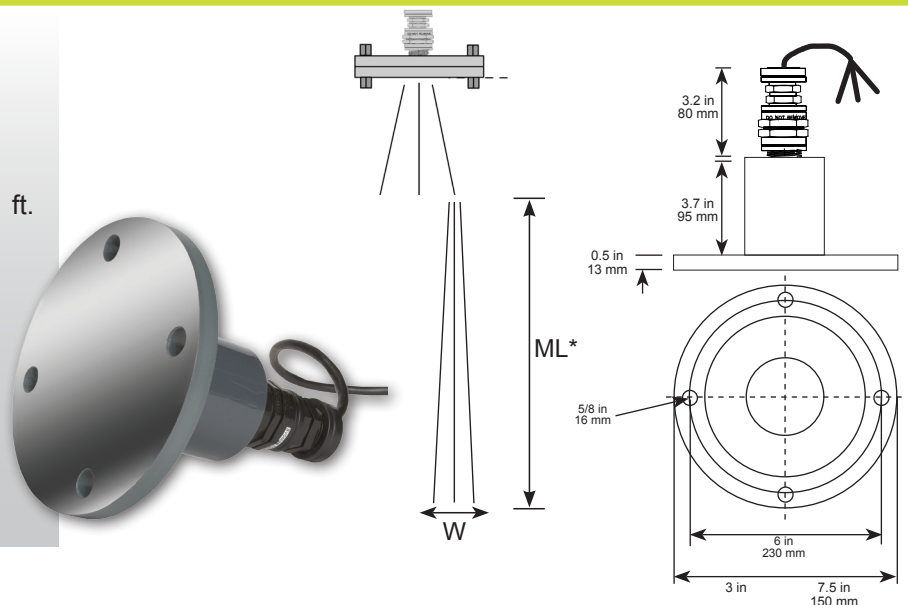

K10T4 PTFE Lined Transducer, 4 inch Flange

Maximum Measuring Length (ML) 50 ft.
/ 15 m.

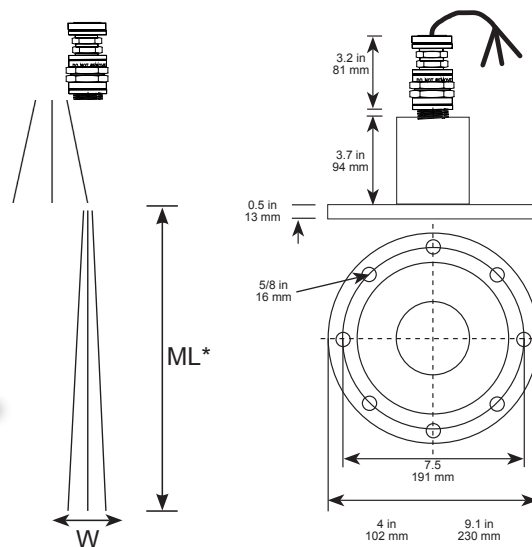
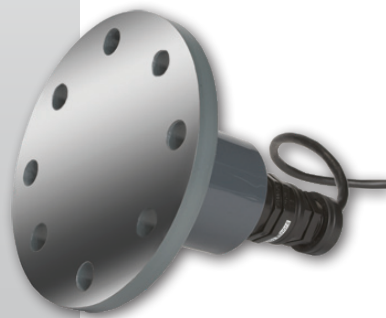

K20 Intermediate Range

Maximum Measuring Length (ML) 100 ft.
/ 30 m.

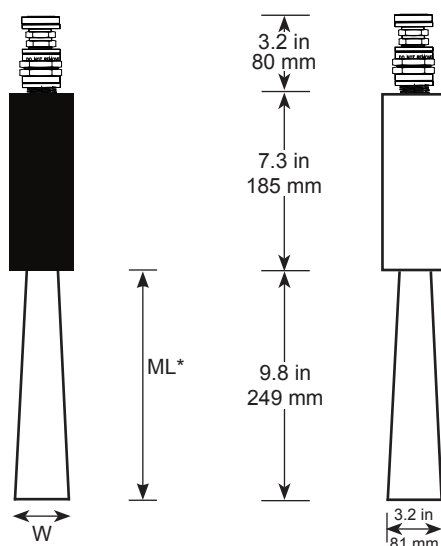

K20H Intermediate Range with Dust

Maximum Measuring Length (ML) 100 ft.
/ 30 m.

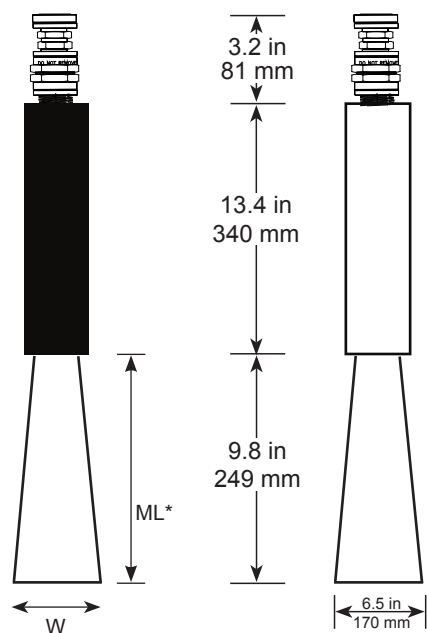

K60 Long Range

Maximum Measuring Length (ML) 196 ft.
/ 60 m.

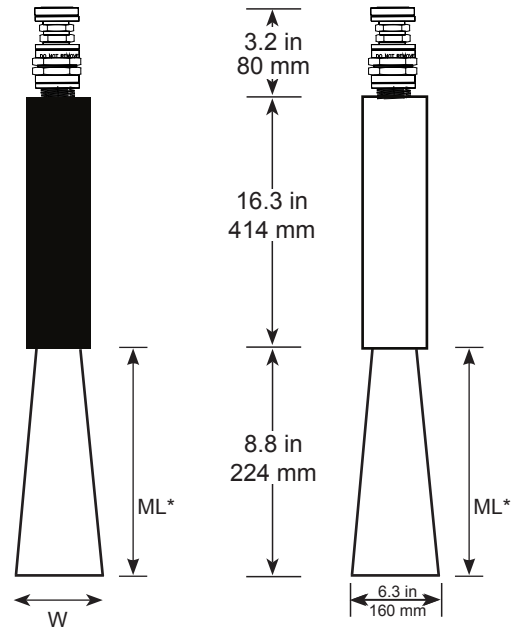

Nozzle Installation

The KSONIK Transducer must be installed at a height so that the blanking distance is not interfered with, even at the maximum fill level. A pipe nozzle can be used if you cannot obtain the blanking distance in any other way or if a nozzle is pre-existing on a tank structure. The interior of the nozzle must be smooth with no edges, welded joints or burrs on the inside of the tank side nozzle end. Best results are achieved with a 45° cut nozzle. The Transducer may not function correctly if the blanking distance is not above the maximum level measured.

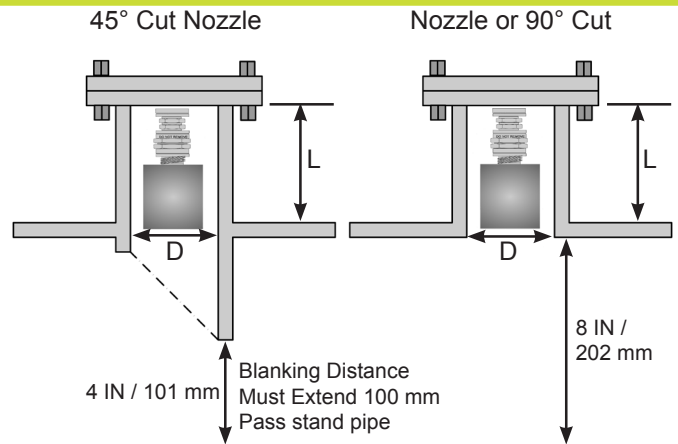

D (in. / mm)	Nozzle or 90° Cut - Maximum Length (L)		
	K10	K20	K60
3 in. / 80 mm	8 in. / 200 mm	not applicable	not applicable
4 in. / 100 mm	10 in. / 250 mm	26 in. / 650 mm	not applicable
6 in. / 150 mm	15 in. / 380 mm	60 in. / 1500 mm	not applicable
8 in. / 200 mm	15 in. / 380 mm	72 in. / 1800 mm	consult factory
10 in. / 250 mm	24 in. / 600 mm	92 in. / 2300 mm	consult factory

D (in. / mm)	45° Cut Nozzle - Maximum Length (L)		
	K10	K20	K60
3 in. / 80 mm	19 in. / 490 mm	not applicable	not applicable
4 in. / 100 mm	22 in. / 550 mm	30 in. / 750 mm	not applicable
6 in. / 150 mm	60 in. / 1500 mm	76 in. / 1900 mm	not applicable
8 in. / 200 mm	80 in. / 2000 mm	100 in. / 2500 mm	consult factory
10 in. / 250 mm	100 in. / 2500 mm	124 in. / 3100 mm	consult factory

Min. Transducer Material and Ratings

Trans	Min Bkg	Frq. KHz	Beam Angle	Facing Material	Body Material	IP Protection	Temp Range	Mounting
K10	1 ft. / 0.3 m	44	3°	Polyurethane	PVC	IP68	-4 to 176°F -20 to 80°C	1 in. MNPT
K10F	1 ft. / 0.3 m	44	3°	Polyurethane Foam	PVC	IP68	-4 to 176°F -20 to 80°C	1 in. MNPT
K10T3	1 ft. / 0.3 m	44	3°	PTFE	PVC	IP68	-4 to 176°F -20 to 80°C	in. MNPT
K10T4	1 ft. / 0.3 m	44	3°	PTFE	PVC	IP68	-4 to 176°F -20 to 80°C	4 in. MNPT
K20	3 ft. / 1 m	15.4	3°	Polyurethane Foam	PVC	IP62	-4 to 176°F -20 to 80°C	1 in. MNPT
K20H	3 ft. / 1 m	15.4	3°	Polyurethane Foam	PVC	IP62	-4 to 176°F -20 to 80°C	1 in. MNPT
K60	5 ft. / 1.5 m	12.5	3°	Polyurethane Foam	PVC	IP62	-4 to 176°F -20 to 80°C	1 in. MNPT

Transducer Description and Ranges

Trans	Description	KSONIK I		KSONIK III	
		Liquids	Solids	Liquids	Solids
K10	General Purpose	50 ft. / 15 m	16 ft. / 5 m	50 ft. / 15 m	16 ft. / 5 m
K10F	Solid Applications		50 ft. / 15 m		50 ft. / 15 m
K10T3	PTFE Lined Transducer with flange	50 ft. / 15 m		50 ft. / 15 m	
K10T4	PTFE Lined Transducer with flange	50 ft. / 15 m		50 ft. / 15 m	
K20	Medium Range			100 ft. / 30 m	100 ft. / 30 m
K20H	Medium Range with Dust			100 ft. / 30 m	100 ft. / 30 m
K60	Long Range			195 ft. / 60 m	195 ft. / 60 m

Note: For temperature compensation add "C".

AKIT - Aiming Kit (304SS)

It is recommended that an aiming kit be used when the transducer is used on a solids application. It allows positioning of the transducer to maximize the return signal.

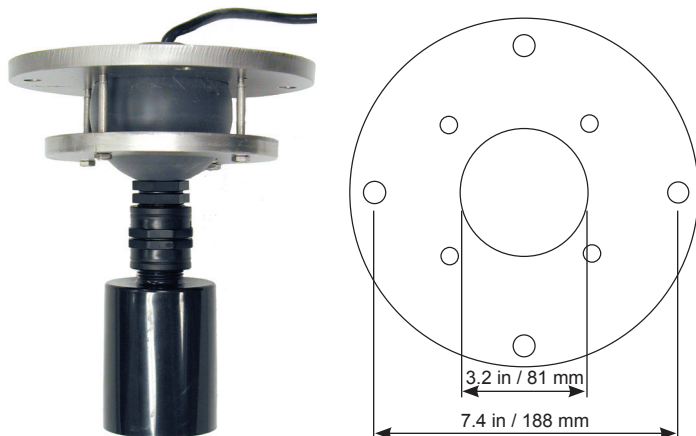

KSCOPE - KSONIK Scope Software

Multi-use Windows based software package. Allows programming and bin mapping. Can also help set up a KSONIK I or III in just a few minutes and is downloadable from the K-TEK website.

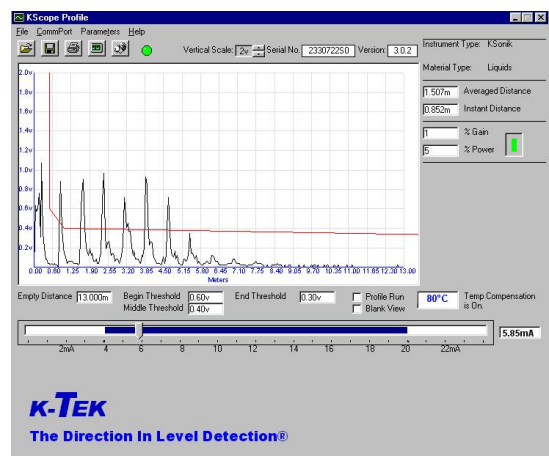

K-TEK
18321 Swamp Road
Prairieville, LA 70769 USA
Phone: +(1) 225-673-6100
Fax: +(1) 225-673-2525
Email: sales@ktekcorp.com
Website: ktekcorp.com

K-TEK
A MEMBER OF THE ABB GROUP
ACS-0003-1 Rev e (07-2010)
DCN0497

For the latest version of this data sheet,
visit ktekcorp.com or kteksolidslevel.com.

K-TEK
6100 West by Northwest #140
Houston, TX 77040 USA
Phone: +(1) 713-462-7665
Fax: +(1) 713-462-7684
Email: sales@kteksolidslevel.com
Website: kteksolidslevel.com