

HM60开合帘电机

使用说明书



深圳市汉莫电子有限公司

安装使用之前，请仔细阅读此说明书

智能家居4S服务平台<http://www.home1010.cn>

客服热线：400-666-2095 邮箱：CS@home1010.cn

注意事项

- 1、请勿在可能溅水处或靠近易燃气体或易燃物体处使用本产品，这样可能导致火灾、爆炸及触电等严重事故。
- 2、不要试图拆解、修改本产品，这样可能会导致火灾、损伤、触电或严重伤害您及您的产品。
- 3、聘请合格的安装人员进行安装调试。
- 4、在安装未完成之前，请勿接通电机电源。
- 5、在电机安装到端头上时，请检查并确定电机的锁扣是否已锁好，要确保锁扣弹入锁止孔内，否则电机将会坠落导致导致人身伤害及产品的损坏。



锁扣锁好弹入锁止孔圈



锁扣未弹入锁止孔圈

- 6、在窗帘安装好后，请勿用力拉扯帘布，不要在窗帘轨道上施加任何额外的重量；请勿攀悬帘布或在帘布上悬挂物品，这样轨道及电机可能会坠落导致人身伤害及产品的损坏。
- 7、当系统发生任何异常情况时，请立即停止操作并断开电源，然后请与我们的经销商或技术服务人员联系。

特点

- 电机内置新一代离合器，精密行星减速机构，系统运行噪音40dB。
- 全自动寻找窗帘行程停机点进行软停机，
- 具有手拉启动功能，如果不需求此功能可通过简单操作取消。
- 多种灵活控制方式，无线、有线、红外、智能弱电中控，强电控制，总线控制等。
- 采用交流电机作为动力源，使动力更加稳定可靠，水平拉力9KG，负重60KG。
- 适用于所有场合的中型直线，弧型开合帘。

技术参数

额定电压	AC220V/240V 50Hz
额定功率	90W
额定扭矩	1.0Nm
额定转速	112rpm
单开直线速度	14cm/s
绝缘等级	E级
防护等级	IP41

HM60A:	内置无线电机
HM60C:	外置电机，强电控制

负载能力

单轨单电机负载曲线

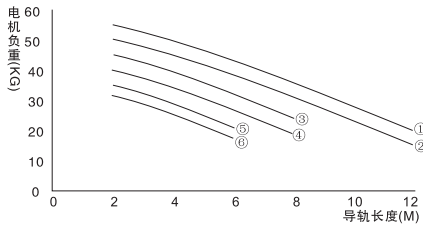

- 曲线①的导轨单开形式
- 曲线②的导轨双开形式
- 曲线③的导轨单开形式
- 曲线④的导轨双开形式
- 曲线⑤的导轨单开形式
- 曲线⑥的导轨双开形式

控制方式接线图

内置电机HM60A

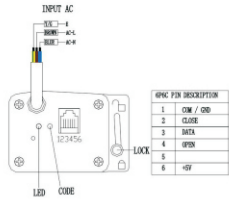

外置电机HM60A

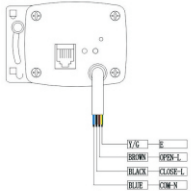

有线开关量控制方式

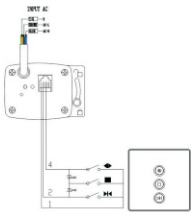

无线遥控控制方式

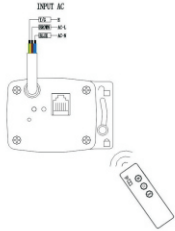

智能强电控制方式

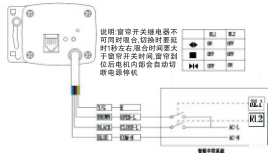

智能弱电控制方式



电机尺寸

HMH型导轨电机系统尺寸

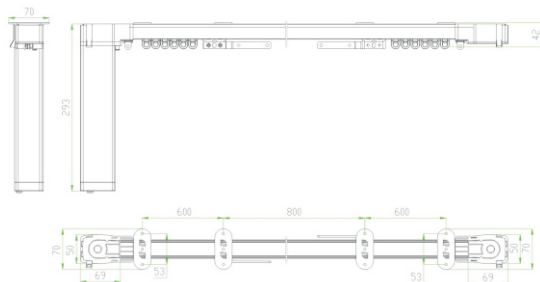

HMH型直轨安装极限尺寸

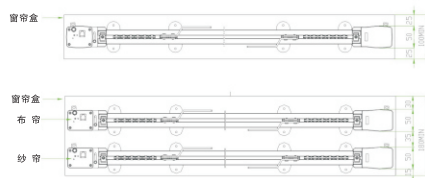

HMH-90°弯轨安装极限尺寸

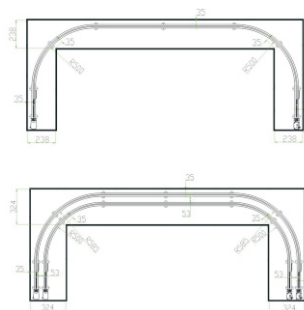

电机安装图

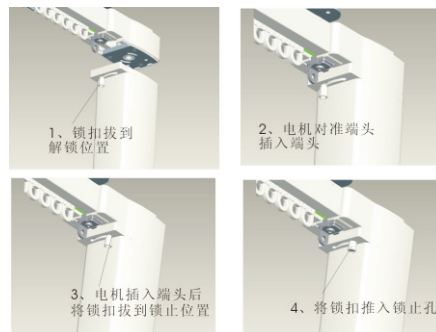

遥控器设置

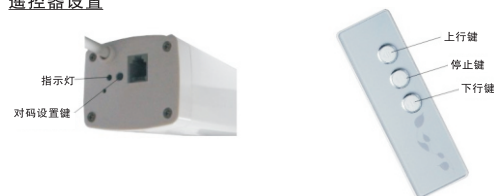

- 1、对码：按住电机对码键约5秒后，电机指示灯则变成长亮，这时选好遥控器通道按上行键，电机指示灯闪3次后熄灭表示对码成功，这时可用对了码的遥控器控制电机正转、反转、停止。注：电机可对16组遥控器的码。
 - 2、换向：按住电机对码键约5秒后，电机指示灯则变成长亮，这时按遥控器的下行键，电机指示灯闪3次后熄灭表示换向成功。
 - 3、清码：按住电机对码键约5秒后，电机指示灯则变成长亮，这时再按住电机对码键约5秒指示灯闪3次后熄灭表示清码成功。注意执行此操作后电机所有的码都会被清除。
 - 4、电机行程确定：电机上电后正常来回运行3次后即可自动确定停机电点进行检修机。
 - 5、手拉启动功能：电机装上导轨，任何时候用手都可以轻松拉动窗帘的帘头，帘头行程约为12cm，电机能自动向相应方向启动。
- 取消手拉启动功能：电机在对码状态下按手控板的停止键，电机指示灯闪3次，即可关闭启动功能。若要恢复手拉启动功能，再执行一次此操作即可恢复手拉启动功能。

导轨系统及配件

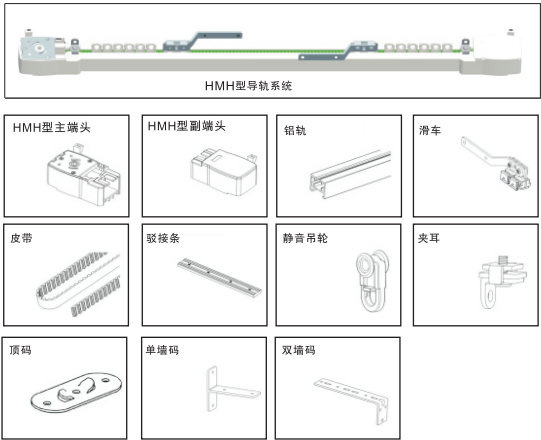

使用中常见故障解决方法

- 1、手拉启动不了
原因：电机未通电，请确认电机电源已连接好。
- 2、遥控距离近或无反应
原因：遥控器电池电量低，请更换遥控器电池。
- 3、电机中途停机
原因：布帘受阻导致负载过重，请检查布帘有无受阻。
- 4、电机运行温度过高不动作
原因：内部热保护器热保了，等温度降下后机会自动恢复正常状态。
- 5、弱电中控或有线开关量控制不了。
原因：水晶座接线不正确，请按照接线图重新检查接线是否正确。
- 6、弱电中控、遥控器按键的开关与电机实际运行方向相反。
原因：请进行换向操作即可将方向调换过来。

若上述原因仍不能排除故障，请及时联系厂家经销商。

HM60开合帘电机保修卡

产品信息

产品型号: _____ 产品名称: _____
发票号码: _____ 购买日期: _____
购买商店及地址: _____

用户信息

用户姓名: _____ 联系电话: _____
通讯地址: _____
购买凭证: ☐ 发票 ☐ 收据 ☐ 合同 ☐ 无

根据规定本公司电机保修期为三年（自开具发票之日起计算）。在保修期内，凡属于正常使用情况下由于产品本身质量问题引起的故障，本公司将负责给予免费维修。

一、在保修期内，凡属产品本身质量问题引起的故障，请用户携带已填好的保修卡用户联及购机发票在全国各地本公司授权的维修中心免费维修，保修卡应有经销商盖章、产品交接人签名后方可有效。

二、不接收由于擅自改装或加装其他功能后出现故障的机器。

三、保修卡及购机发票一经涂改，保修即时失效。保存保修卡及购机发票作为本机的保修凭证，请用户妥善保存，遗失不补。

四、以下情况不在保修服务范围内：

- 1、无保修凭证及票据的或已过保修期限的。
- 2、未按说明书的要求操作机器而引起的故障。
- 3、非本公司特约维修人员拆卸造成损坏的。**或用户保管、维修、使用不当造成损坏的。**
- 4、因不可抗力造成的故障或损坏。
- 5、未经授权而改装公司产品属侵权行为除产品失去保修资格外，本公司对该改装的产品所发生的故障或事故不承担任何责任。



客户服务热线：400-666-2095

智能家居4S服务平台：www.home1010.cn



HM60 Drapery motor system

USER MANUAL



SHENZHEN Homemode Electronics Co.,Ltd.
Before installation, please read the instruction carefully.

Notice:

- 1、Keep away from the place that has a possibility cause splash or inflammable substance/gas, too close to cause fire、explode 、electric shock or any other accident.
- 2、Don't try to make a disassembly or refit the product , it could cause fire 、damage、electric shock or any other accident may badly harm your body and your product.
- 3、Please hire a professional person to install and uninstall.
- 4、When you haven't finished your installation , don't turn on the drive power.
- 5、When you install the motor to the drive unit , please check and make sure that the latch has pushed into the locked hole, otherwise the motor will fall down to cause personal injury and product damage.



The latch has pushed into the locked hole



The latch hasn't pushed into the locked hole

- 6、After the motor has been finished installing, please don't pull the curtain with too much force, and don't put any additional weight on the rail, don't climb the curtain nor hang anything on the curtain.
- 7、Has any abnormal situation, please stop your operation and turn off the power immediately, then contact with our agent or technical service.

Characteristic:

- Built-in brand-new electromagnetic clutch, with precise planetary reduction gear, operating noise no more than 40dB.
- Automatic find the trip point for the curtain shut down softly, with pull-start function.
- A variety of flexible control mode: wireless remote control、control wiring mode、INF remote control、intelligent low-voltage、**AC control**、**bus control** .
- AC power input, operates more steady and **reliable, horizontal pull** reaches 8KG, load capacity is 50KG.
- Applies to all medium straight、curved drapery curtain.

Technology parameter:

Rated voltage

Rated power

Rated torque 1.0Nm

Rated speed

Line speed

Insulation class

Protection class

HM60A: Built-in receive motor

HM60C: No receive in drive AC control

Load capacity:

Single motor load capacity

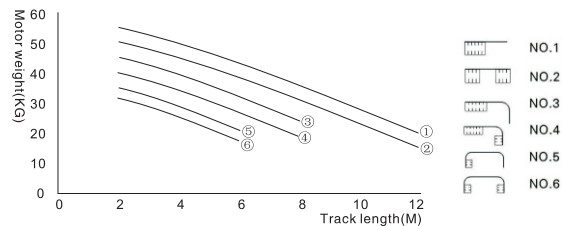
Connecting control draw

Built-in receiver

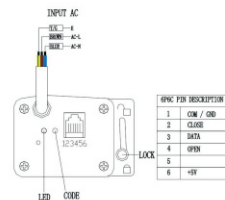

No receive in drive

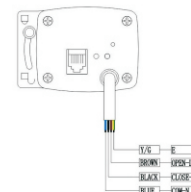

Switch control

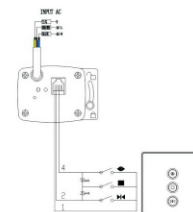

Remote control

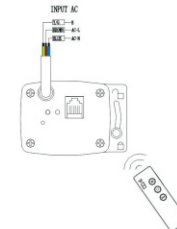

Intelligent AC control

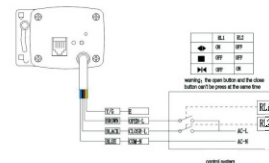

Intelligent low-voltage

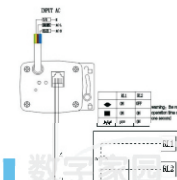

Dimension Drawing

HMH-rail system size

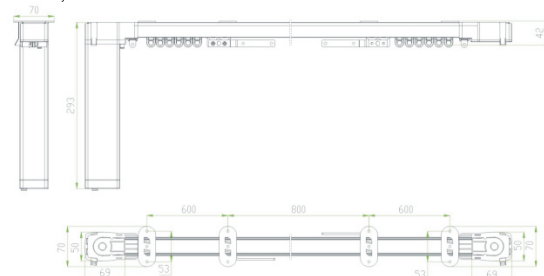

HMH-straight-rail installation limit size

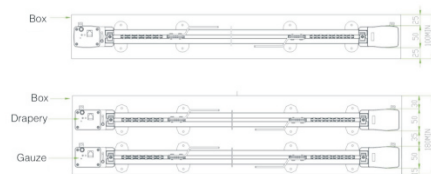

HMH-90°Bended rail installation limit size

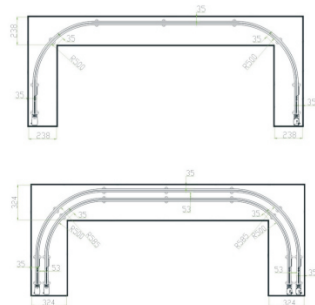

Installation drawing

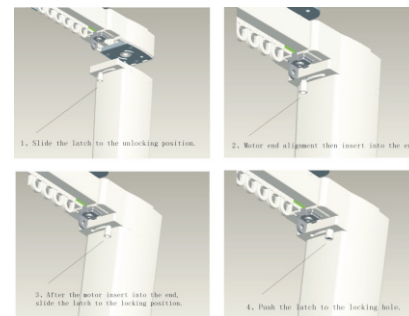

Remote control setting



Setting code:

1. Press the "code setting" button of the motor about 5 seconds, the light will shine.
2. Select the channel of transmitter, then press the open button, the light will twinkle 3 times and extinguish, it means the code setting is OK.
3. Then you can use this transmitter to control the motor.
NOTICE: One motor can only use 16 times for setting code.

Change direction:

1. Press the "code setting" button of motor about 5 seconds, the light will shine.
2. Select the channel of transmitter, then press the close button, the light will twinkle 3 times and extinguish, it means the direction change is OK.

Delete code:

1. Press the "code setting" button of the motor about 5 seconds, the light will shine.
2. Loose for 1 seconds then press the "code setting" button of the motor about 5 seconds, the light will twinkle 3 times and extinguish, it means the code delete is OK.
NOTICE: When you finish deleting code, all the code in motor has been deleted.

Motor trip determine: when the motor operation thrice in normal, can be find the stop location.

Delete the pull start code: Cancel pull-start function: Press the code setting button of the motor about 5 seconds, the light will shine. Then press the close button of the hand controller, the light will twinkle 3 times and extinguish, it means the switching over is ok. If you want to recover the pull-start function, carry out the operation once again, then it can work.

Delete the pull start code :

1. Cancel pull-start function: Press the code setting button of the motor about 5 seconds, the light will shine. Then press the stop button, the light will twinkle 3 times and extinguish, it means the switching over is OK. If you want to recover the pull-start function, carry out the operation once again, then it can work.

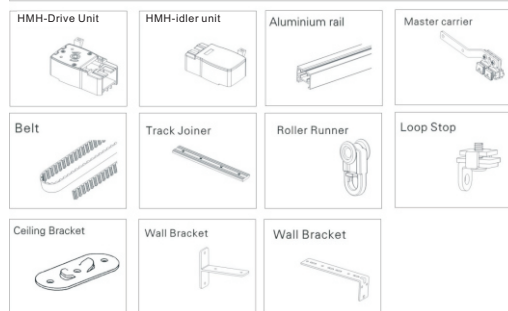
HMH-rail system and accessoriesSolution of common operate failure

1. Can't pull-start.
Reason: The motor's power is off, please make sure the power is on.
2. Remote distance is not far or no response in transmitter
Reason: Low battery, please replace the battery of transmitter.
3. The motor pause in the mid-way.
Reason: The curtain has been held back that lead the load is too heavy, please check the curtain whether has been held back.
4. The temperature of the motor is too high to work
Reason: The build-in heat protector has been protected, when the temperature falls down the motor can return normal.
5. Low voltage central control and switch control can't work.
Reason: The plug block has a wrong wiring, please check as the connecting drawing whether is correct.
6. The direction of the button in the low voltage central control and transmitter is different from the motor's actual running direction.
Reason: Please change the direction and set the right direction.

If the motor still can't work, please contact with the agent or the manufacturer.

HM60 curtain motor service card

Product information

Model: _____ Product serial: _____
 Receipt NO. _____ Purchase date: _____
 Place of purchase: _____

User information

Name of user: _____ Tel: _____
 ADD: _____
 Certificate: ☐ Bill ☐ Receipt ☐ Contract

- According to provisions guarantee company for three years (from motor invoice date). During the warranty period, all who are under normal use due to the product itself quality problem cause breakdown, our company will be responsible to repair.
1. during the warranty period of the product. If cause by itself quality problem, please carry the copy of user of the warranty card with fill-in and buyer invoice to repair center. Which authorized my our company throughout country. product warranty card should dealers stamp signature rear unauthorized modification.
 2. don't receive due to or add other function without modification after failure machine.
 3. the product is altered, and buyers invoice warranty real-time failure. Take as the product of the invoice and buyers warranty certificate, please keep users, not lost.
 4. the condition is beyond guarantee service scope:
 - . without warranty certificate and bills or guarantee deadline has passed.
 - . and fails to the requirements of the operating machine caused by fault.
 - . and the company hold down about maintenance personnel dynamic damage. Or user custody, maintenance, use undeserved cause damage.
 - . owing to force majeure cause damage or malfunction.
 5. the unauthorized infringement of modified products, product warranty loss.