

GERMAN
POOL 德國寶

超薄數碼恒溫氣體熱水器 | GPS12

Instantaneous Gas Water Heater



在使用之前請詳細閱讀「使用說明書」及「保用條例」，並妥為保存。
Please read these instructions and warranty information carefully before use and keep them handy for future reference.



使用說明書 OPERATING INSTRUCTIONS

適用於香港

根據香港法例第51章（氣體安全氣體裝置技工及氣體工程承辦商註冊）規例規定，任何人如非註冊氣體裝置技工而安裝 / 接駁或修理這件氣體爐具即屬違法。請直接或經同你的氣體供應商安排由註冊氣體工程承辦商作出安全的安裝及維修。

For Use in Hong Kong

It is an offence under the Gas Safety (Registration of Gas Installers and Gas Contractors) Regulations, Cap.51, for any person who is not a registered gas installer to install/connect this gas appliance, or to carry out repairs. Contact a registered gas contractor, directly or through your gas supplier, to arrange for safe installation and servicing.

內容 Content

請確定遵從
Please make sure to follow

- 安全操作注意事項 2
Cautions for safety operations

如何操作
How to Operate

- 各部份名稱 9
Parts identifications
- 第一次操作熱水爐 10
To operate the heater for the first time
- 使用熱水爐方法 11
Operating Instructions
- 日常檢查及保養 12
Daily inspection and maintenance

當有需要時請查看
Please read when necessary

- 修理指南 14
Trouble shooting
- 規格 17
Specifications
- 維修服務 18
Repair service

安全操作注意事項

Cautions for safety operations

請確定遵從。
Please make sure to follow.

為防止使用者或其他人受傷害及財物受到破壞，下列項目必須遵從。
The below listed items shall be strictly followed to prevent the user and other people from suffering an injury and to prevent your property from being damaged.

■ 當不遵從“注意事項”而發生意外，以下標誌表示受傷害及破壞之程度。
The below markings show the level of injury and damage caused when the cautions are not followed.

	危險 DANGER	項目有此標誌表示將會有生命危險及嚴重受傷。 This marking is labeled on those items that any death or a serious injury is approaching.
	警告 WARNING	項目有此標誌表示可能有生命危險及嚴重受傷。 This marking is labeled on those items that any death or a serious injury is expected.
	注意 CAUTIONS	項目有此標誌表示可能有受傷及財物受到破壞。 This marking is labeled on those items that any injury and material damage is expected.

■ 以下標誌會用於此使用說明書。
The below listed markings are used in the operation manual.

	此標誌表示需提高警覺。 This marking is given to those items to call your attention.
	此標誌給禁止項目使用。 This marking is given to those items banned.
	此標誌代表這些項目必須確實遵從。 This marking is given to those items to be strictly followed.

安全操作注意事項

Cautions for safety operations

請確定遵從。
Please make sure to follow.

⚠ 危險 DANGER

氣體泄漏注意事項 Cautions when gas leaks

■ 當發現氣體泄漏時，關掉主氣體閥門，打開所有窗戶及通知氣體代理商或油公司。
When the gas leakage is detected, close main gas valve, open the windows and doors and call your dealer or gas company.

 關掉主氣體閥門
Close main gas valve.

 盡量打開所有窗戶。
Open windows and doors fully.

 通知氣體代理商或油公司。
Call your dealer or gas company.

氣體泄漏可引致火警或爆炸。
Gas leakage may cause a fire or an explosion.

切勿開啓或關閉任何電掣或點火。
Do not turn on/off the electrical switches or ignite fire.



熄滅所有火源。
No fire



可能引致火警或爆炸。
A fire or an explosion may be caused.

安裝注意事項 Cautions for installations

切勿使用拆除烟道或烟道被堵塞之熱水爐。
Do not use the heater when the flue duct is removed or clogged.

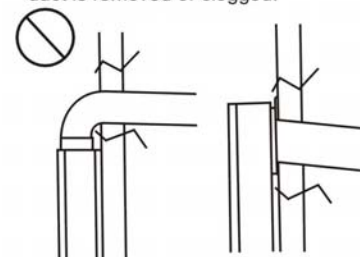

使用已拆除烟道或烟道被堵塞之熱水爐，廢氣會進入室內及熱水爐不正常燃燒而可能產生有毒一氧化碳或缺氧。
When the flue duct is removed or clogged, the exhaust air leaks into the room and the abnormal combustion of the heater may be caused. A carbon monoxide or an oxygen depletion may be caused.

切勿將熱水爐安裝於室外。
Do not install the heater outdoors.

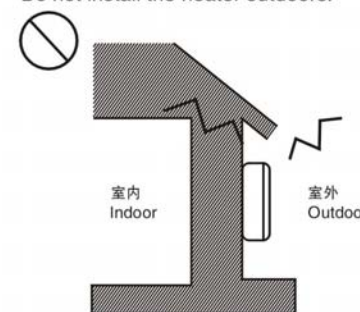

不正常燃燒可能導致生火或熱水爐被雨水破壞。
A fire may be caused by an abnormal combustion or the heater may be damaged by the rain.

警告 WARNING

■ 不正常燃燒可從氣味及聲音偵察或當火警 / 地震發生時，請確定遵照下列程序。
When an abnormal combustion, smell and sound is detected or when a fire or and earthquake takes place, make sure to follow the below procedures.

當熱水爐長期不使用，請確定關掉熱水爐之主開關及關掉主氣體閥門。
Make sure to turn off the main switch of the heater and to close the main gas valve when the heater is not used for a long time.



關掉熱水掣。
Close hot water tap.



關掉熱水爐主開關。
Turn off the main switch of the heater.



關掉氣體及供水閥門。
Close main gas valve and main water valve.

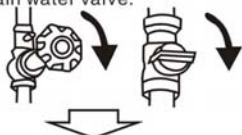

通知氣體代理商或油公司。
Call your dealer or gas company.



若不正常現象持續，可能導致生火。
If the abnormal condition is kept unchanged, a fire may be caused.



當熱水爐長期不使用，為避免熱水爐內的水結冰，建議排放熱水爐內之水。
If the heater is not used for a long time, it is suggested to drain out the water inside the heater to prevent freezing.

氣體洩漏可能引致生火。
A gas leakage may cause a fire.

切勿使用非附貼於熱水爐上所標明之氣體及電力供應。
Do not use gas and power supply other than specified in the specifications label attached on the heater.



若使用其他氣體及電力供應，可能導致生火或不正常燃燒而產生有毒一氧化碳。
If a different gas or power supply is used, a fire or a carbon monoxide toxication may be caused by an abnormal combustion or the heater.

熱水爐與易燃物品保持距離。
Keep the inflammables away from the heater.



熱水爐前面：
超過600毫米
Front: more than 600mm

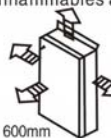

熱水爐頂：超過300毫米
Up: more than 300mm

熱水爐旁：超過45毫米
Side: more than 45mm

若熱水爐與易燃物品不能保持最低限度距離，可能會引致生火。
If the minimum distance from the inflammable is not kept, the fire may be caused.

安全操作注意事項 Cautions for safety operations

請確定遵從。
Please make sure to follow.

警告 WARNING

使用熱水注意事項 Cautions for using a hot water

■ 使用花灑沐浴前，請先用手測試熱水溫度。
Make sure to check hot water temperature by hand before taking a shower.



小心被熱水燙傷。

Caution : Prevent from getting burnt.

可能被熱水燙傷。
You may be scalded by the hot water.



■ 若使用混合式水龍頭，請先關掉熱水掣。
If a mixing tap is used, close the hot water tap first.



熱水掣關掉後，熱水管內仍存著熱水。下次使用時，熱水管內熱水可能令你燙傷。
If a water tap is closed first, hot water will remain in the water piping system. You may get burnt by the hot water remained in the piping system in your next use.

■ 若使用混合式水龍頭，切記將冷熱水選擇杆推回原來位置。

When a mixing tap is used, make sure to return the change over lever to the original position.



若冷熱水選擇杆置於半開位置時，你可能會被熱水燙傷。
You may get burnt by hot water if the lever is positioned in the half way.

■ 切勿在熱水爐附近使用易燃物品，如汽油、苯。
Do not use inflammable like gasoline and benzen near the heater.



可能引致生火。 A fire may be caused.

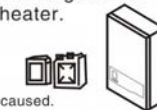

■ 當使用熱水時，除使用者外，切勿讓其他人調校熱水溫度。
When hot water is used, make sure that hot water temperature will not be changed by persons other than user.



使用熱水爐途中改變熱水溫度，有可能被熱水燙傷，若熱水爐使用途中被關掉，有可能導致受傷。

If the hot water temperature is changed in the middle of the use, you may get burnt. If the heater is turned off in the middle of the use, you may have the risk to be injured.

■ 當使用混合式水龍頭而同一個熱水系統之另一個熱水龍頭開啓時，你可能會被燙傷。

When the mixing tap is used, there may be a case that you will get burnt if the other hot water tap in the same hot water piping system is opened.



小心被熱水燙傷。

Caution : Prevent from getting burnt

熱水供應可能隨時到達，請先用手測試後才使用。
Hot water may be supplied suddenly. Make sure to wait for a while and to check hot water temperature by hand before use.

■ 切勿為熱水爐安裝檔口。
Do not install a covering around the heater.



不正常燃燒可能導致生火或產生問題。
A fire or trouble of the heater may be caused by an abnormal combustion.

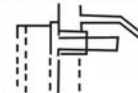

警告 WARNING

- 緊固地插入。
Plug in firmly.



熱水爐可能有問題。
The heater may be malfunctioned.

- 間中清潔電源插的塵埃。
Remove dusts on the plug occasionally.



若電源插積聚塵埃，潮濕導致絕緣降低而可能引致生火。
If any dust gathered on the plug, the electrical insulation becomes poor due to humidity and may cause a fire.

- 切勿破壞電源線及電源插。
Do not damage power cord and plug.



若使用損壞的電線及電源插，可能導致觸電，短路及生火。
If damaged cord or plug is used, electric shock, short-circuit and a fire may be caused.

- 確定電路不過載。
Make sure that wiring equipment should not be overloaded.



若過載，可能生熱而導致生火。
If overloaded, it may generate heat to cause a fire.

- 手部帶水份切勿觸摸電插頭。
Do not touch an electric plug with wet hands.



可能導致觸電。
An electrical shock may be caused.

- 當插入或拔出電源，確定拿緊電插頭。
When power supply is plugged in or out, make sure to do so by holding the plug firmly.



若拔出或拉出電源線，電源線可能脫離而導致生火或觸電。
If you plug out by pulling the power cord, power cord may be disconnected to cause a fire or an electric shock.

- 熱水爐之安裝或搬移，必須由註冊氣體技工進行。
Installation or relocation of the heater must be done by a Registered Gas Installer.



若使用不正確安裝或搬運的熱水爐，損壞的電源線及電源插，可能導致觸電，短路及生火。
If the heater is not installed properly, electric shock, short-circuit or a fire or a trouble may be caused.

安全操作注意事項 Cautions for safety operations

請確定遵從。
Please make sure to follow.

注意 CAUTIONS

- 熱水爐只供淋浴或沐浴使用，切勿作其他用途。
Do not use the heater for purposes other than supplying hot water for bath and shower.



若熱水爐作其他用途，可能產生問題或導致生火。
If the heater is used for other purpose, a fire or a trouble of the heater may be caused.

- 熱水爐操作中或剛停止操作時，切勿觸摸熱水爐煙道。
Do not touch a flue duct during operation or right after the heater is turned off.



切勿觸摸。
Do not touch.

你可能會被燙傷。
You may get burnt.

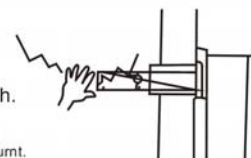

- 切勿用熱水爐攀爬或將物件放置於熱水爐上。
Do not ride on the heater or place anything on the heater.



你可能會被燙傷或受傷及熱水爐可能被破壞。
You may get burnt or injured and the heater may be damaged.



- 切勿將熱水爐安裝在車輛或船上。
Do not install the heater on a vehicle or a vessel.



熱水爐可能倒下而導致生火或令人受傷。
The heater may fall down to cause a fire or an injury.



- 檢查及維修熱水爐之前，確定切斷電源，關掉氣體及水閥門及熱水爐已冷卻。
Make sure to close main gas and water valves, to plug out the heater and to confirm the heater is cooled down before inspection and maintenance.



熱水爐可能產生問題或燒掉。
A burnt and a trouble of the heater may be caused.

- 確定熱水爐已接地。
Make sure to confirm that the heater is grounded.



若沒有安裝接地線，漏電時可能導致觸電。
If not grounded, an electric shock may be caused by an electric leakage.

- 切勿更改熱水爐。
Do not modify the heater.



切勿拆散。
Do not disassemble.

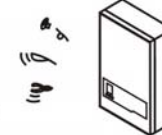

熱水爐可能產生問題。
The heater may have problems.

- 切勿使用熱水爐內之水作食水或煮食之用。
Do not drink water kept in the heater nor use it for cooking.

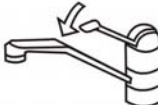
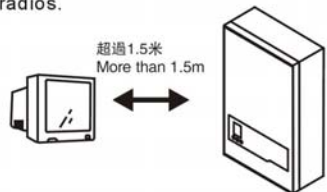

可能影響健康。
Your health may be damaged.

<p>■ 當電力發生故障時，關掉熱水掣。 Close hot water tap at the time of power failure.</p>  <p>熱水爐操作時遇電力故障，會停止燃燒及熱水會漸漸冷下來。 When the power failure takes place during operation, the combustion stops and hot water becomes cold.</p>	<p>■ 切勿使用非指定之組件及配件。 Do not use other optional components and accessories than specified.</p> <p>熱水爐可能會出現問題。 A trouble of the heater may be caused.</p>
<p>■ 遇供水停止時，關掉主開關及熱水掣。 Turn off the main switch and close the hot water tap at the time of water suspension.</p> <p>若不視察，熱水爐可能損壞。 The heater may be damaged.</p>	<p>■ 若使用混合式龍頭，間中讓水流動。 When a mixing tap is used, sometimes let water flow.</p> <p>若長期沒有開水，放出來的水可能渾濁。 There may be a case that the cloudy water comes out if the supply water does not flow for a long time.</p>
<p>■ 若夏天時來水溫度較高，增加水流量。 If the lukewarm water cannot be supplied during summer, increase the water volume.</p> <p>熱水供應時減少水流量，有時會引致熱水溫度很高。 When the hot water is supplied, there may be a case that hot water temperature becomes very hot by decreasing water volume.</p>	<p>■ 熱水爐操作時，切勿切斷電源。 Do not unplug out during operation.</p> <p>熱水爐可能損壞。 The heater may be damaged.</p>
<p>■ 使用後關掉主開關。 Turn off the main switch after use.</p> <p>若不關掉，小孩玩耍時可能開啓熱水爐。 If not turned off, the heater may operate when being played by children.</p>	<p>■ 熱水爐需安裝於遠離電視機及收音機之地方。 Install the heater away from TVs and radios.</p> <p>超過1.5米 More than 1.5m</p>  <p>電視機及收音機節目會被噪音干擾。 TV or radio program may be hampered by noises.</p>

各部份名稱 Parts identifications

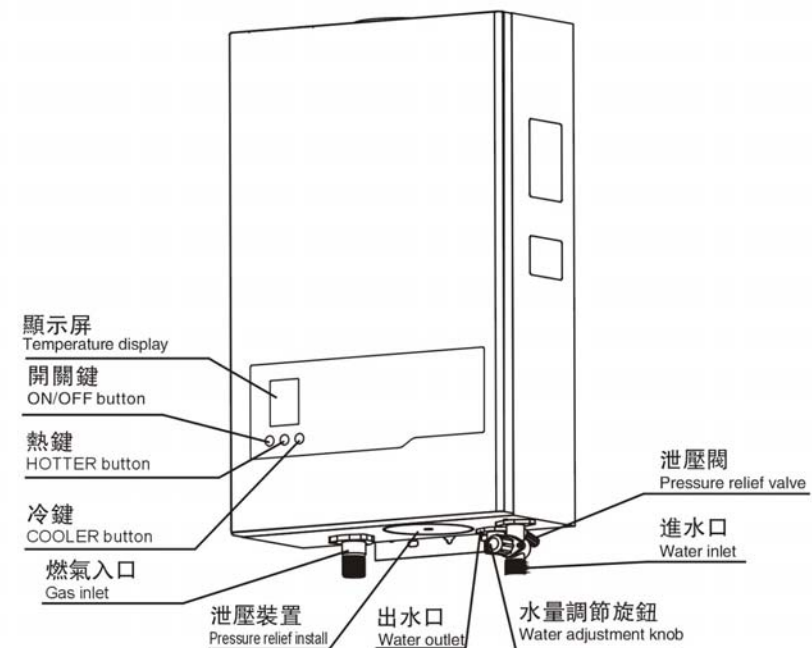

第一次使用熱水爐 To operate the heater for the first time

以下解釋推桿拉起後熱水掣便開啓。

Hot water tap is opened when the lever is up , explanation as follows.

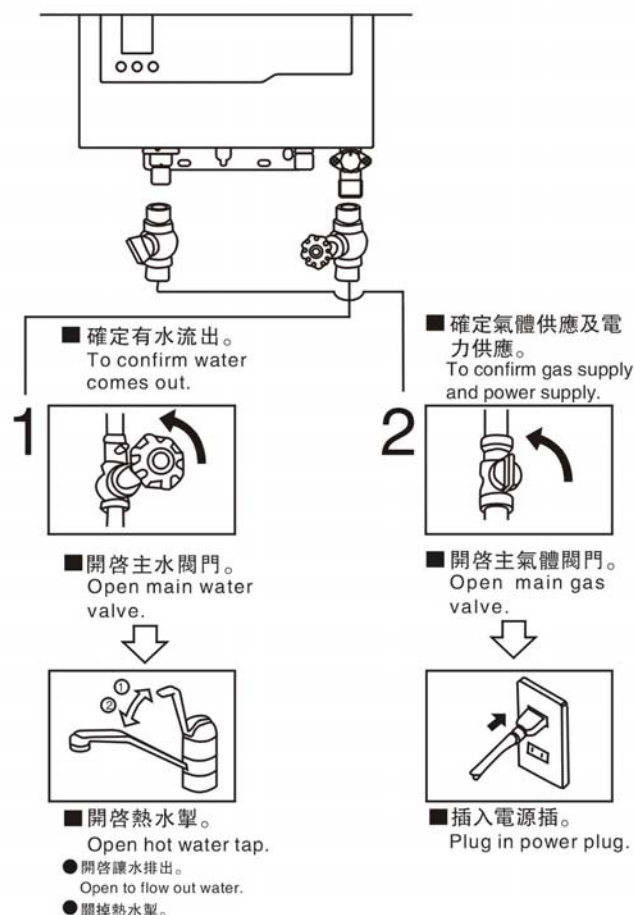

通電顯示屏中“GERMAN POOL”燈亮，開水時機器點火及風機轉動，顯示屏中的“ ”燈亮，機械正常工作。

When there is power supply, the lamp of "GERMAN POOL" at display will be on. Then turn on the water, and the heater ignition and the blower running will be started at same time, then the " " on display will be on.

使用熱水爐方法 Operating Instructions

■ 調校合適熱水溫度

Set the desired hot water temperature

設置溫度調節，按“ ”或“ ”按鍵，調整設置溫度經過幾十秒後，出水溫度逐步達到設置溫度。

Setting the water temperature by pressing " " or " " button of the control panel, the water flow out will gradually reach the temperature you desired after 10 seconds.

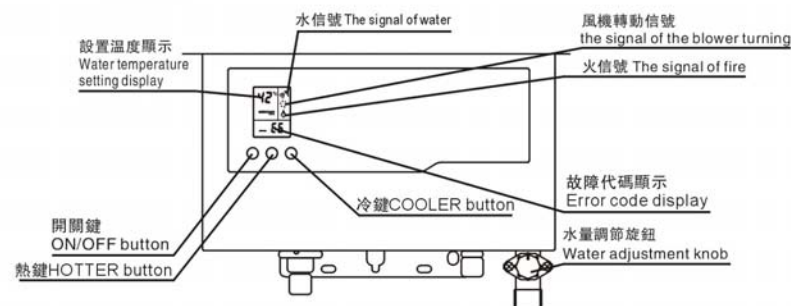

如出水溫度始終達不到設置溫度，則可適當調節“水量調節旋鈕”，以使出水溫度達到設定溫度，順時針調節水量減少，逆時針調節水量增大。

If the water temperature cannot reach your desired, adjusting the water flow out volume by tuning the " water adjustment knob ", clockwise direction will decrease water flow out and anti-clockwise direction will increase the water flow out.

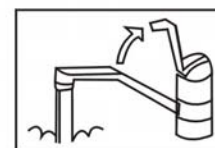

開啓熱水掣。
Open hot water tap.

(熱水器自動點火燃燒。)

Water heater will ignite automatically.

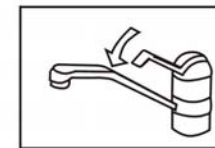

關掉熱水掣。
Close hot water tap.

(熱水器即刻自動熄火。)

Water heater will turn off the flame immediately.

日常檢查及保養 Daily inspection and maintenance

依照下列程序定期進行日常檢查及保養。
Carry out the daily inspection and maintenance regularly following the procedure described below.

保養前 Before maintenance

預備工作 Preparations

⚠ 注意 Cautions

關掉主氣體及冷熱水閥門，切斷電源供應及待熱水爐冷卻。
Close main gas and water valves, plug out power supply and wait until the heater is cooled down.

- 1 關掉主開關。
Turn off the main switch.



- 2 關掉主氣體及冷熱水閥門。
Close main gas and water valves.

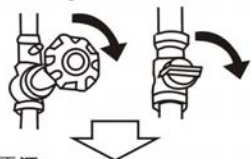

- 3 切斷電源。
Plug out power supply.



- 4 熱水爐冷卻後，進行下列步驟。
Carry out the following after the heater is cooled down.

保養 Maintenance

熱水爐 Heater

用刷掃或毛巾加廚房清潔液指抹熱水爐。
Wipe the heater with swab or towel using a kitchen cleanser.

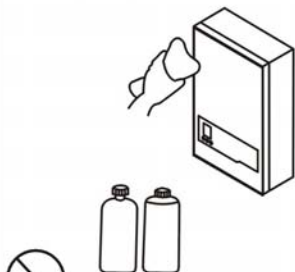

注意：切勿用苯或稀釋劑。
Note: Do not use benzen and thinner.

保養 Maintenance

濾水器 Water filter

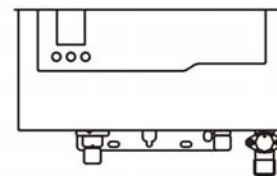

- 1 從冷水入口拆除濾水器。
Remove the filter at water inlet.



- 2 用牙刷清洗濾水器。
Clean the filter with a toothbrush.

- 3 安裝濾水器於入水口。
Mount the filter at water inlet.

檢查 Inspection

- 是否有異常之操作聲音？
Any abnormal operation sound?

- 熱水爐外表是否改變？
Any changes on the appearance of the heater?

- 熱水爐周圍是否有易燃物品？
Any inflammables around the heater?

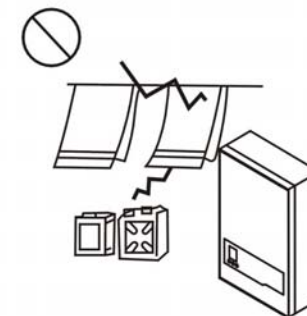

熱水爐具有兩種排氣方式，頂排式和背排式，其內部結構及使用性能相同，供客戶選用。如上圖所示。

The water heaters have two types of gas exhaust methods, top flue and back flue, the structures and operations of the heater is the same for customers choice. As shown in the above drawings.

熱水爐修理指南

Trouble shooting of the heater

若熱水爐出現問題，依照下列程序檢查熱水爐。

If there is any trouble on the heater, check the heater following the below listed procedures.

故障 Symptom	需要檢查的項目。 Items to check.
<p>停止操作 (燃燒) No operation (combustion)</p> 	<ul style="list-style-type: none"> • 電源插是否緊插? Is power plug plugged in firmly? • 主氣體閥門是否全開? Is main gas valve opened fully? • 主供水閥門是否全開? Is main water valve opened fully? • 供水是否停止? Is there a suspension of the water supply? • 是否電力供應故障? Is there a power failure? • 管道系統內是否留有空氣? Is there air left in the piping system? • 重覆燃點步驟。 Repeat ignition procedures. • 濾水器是否堵塞? (參照第12頁) Is water filter clogged?(Refer to page 12.)
<p>水溫不夠。 Water is not warm enough.</p>	<ul style="list-style-type: none"> • 主氣體閥門是否全開? Is main gas valve fully opened? • 冷熱水是否混和合適? Are hot and cold water mixed properly? • 設置溫度是否過低? Is the set temperature too low?
<p>水溫過高。 Hot water temperature is too high.</p>	<ul style="list-style-type: none"> • 主供水閥門是否全開? Is main water valve opened fully? • 濾水器是否堵塞? (參照第12頁) Is water filter clogged?(Refer to page 12.) • 設置溫度是否過高? Is the set temperature if high?

下列的徵兆並非是產品缺點。
Below listed symptoms are not defects.

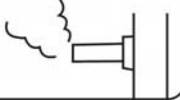
故障 Symptom	原因 Reason
<p>冬天時烟道出水蒸氣。 Steam comes out from a flue duct on a cold day.</p> 	<p>這不是不正常，只因廢氣內之水份轉為水蒸氣。 This is not abnormal. This happens when water in the exhaust air becomes vapor.</p>
<p>熱水供應停止後聽到風扇運轉聲音。 Fan rotating sound is heard after hot water supply is stopped.</p>	<p>風扇連續運轉約30秒鐘能令熱水爐迅速重新點著。 Fan continues to rotate for about 30 seconds so that the heater will be re-ignited promptly.</p>
<p>熱水掣輕微關閉時熱水會渾濁。 Hot water becomes cloudy when hot water tap is closed slightly.</p>	<p>由於空氣在水裏變為水泡。 It is only because air in the water becomes bubbles.</p>
<p>突然關閉熱水掣會產生震盪聲。 Bumpy noise is heard when hot water tap is closed suddenly.</p>	<p>突然停止供水通常會聽到這類聲音。 This sound is normally heard when water supply is stopped suddenly.</p>
<p>熱水掣輕微關閉時，燃燒停止及熱水漸漸轉冷。 When hot water tap is closed slightly, the combustion stops and hot water becomes cold.</p>	<p>當供水壓力低於熱水爐最低點火壓力，熱水爐將停止操作。 When the water pressure becomes lower than the minimum ignition water pressure, the heater will be turned off.</p>

若熱水爐出現問題，安全裝置會啟動。
Safety devices will be activated when something is wrong with the heater.

- | | |
|----------------|--|
| 1.操作時火焰熄滅----- | 熄火安全裝置
Flame failure device |
| 2.熱水爐異常高溫----- | 防止過熱裝置
Overheat prevention device |
| 3.無供水下燃燒----- | 防止空燒安全裝置
Empty combustion prevention device |
| 4.超電流量----- | 電流保險絲
Electric fuse |
| 5.不正常高水壓----- | 超壓排洩閥
Pressure relief valve |

故障代碼 Error Code

E0 溫度傳感器故障 Temperature Sensor Failure
E1 點火故障 Ignition Failure
E2 火焰故障 Flame Failure
E3 空燒過熱故障 Dry-heating Failure
E5 風機故障 Fan Failure
E6 超溫保護 Overheat Protection

若以上五個裝置之中其中有一個啟動，關掉主氣體及水閥門及通知代理商。
If one of above 1-5 devices is activated, close main gas and water valves and call the dealer.

規格 Specifications

產品 Product		氣體熱水爐 Gas water heater	
型號 Model number		GPS12-LG-U GPS12-LG-B 石油氣 LP Gas	GPS12-TG-U GPS12-TGB 煤氣 TG
系統 System	熱水供應 Hot water supply	多點式 Multi-points	
	安裝及煙道 Installation & Flue	室內/強制對衝式 Indoor/Forced balanced flue system	
點火 Ignition		電子連續點火 Electric continuous spark ignition	
水壓 Water pressure	操作水壓 Operation water pressure	0.01-0.8Mpa(0.1-8kgf/cm)	
	點火水壓 Ignition water pressure	20kPa(0.2kgf/cm ²)	
尺寸 Dimensions	熱水爐 heater	高X寬X深 /H x W x D 515mmX330mmX138mm	
重量 Weight	熱水爐 heater	12公斤 (kg)	
喉管接駁 Pipe connection	氣體 gas	半寸(1/2)噉牙 R1/2(PT1/2)	
	冷水 water	半寸(1/2)噉牙 R1/2(PT1/2)	
	熱水 hot water	半寸(1/2)噉牙 R1/2(PT1/2)	
電力供應 Power supply		AC220V (50Hz)	
電源 Electric	耗電量 Consumption	石油氣：最大火力35W LPG:35W at maximum combustion	
		煤氣：最大火力35W TG:35W at maximum combustion	
控制方式 Control method		水控後制式 Water outlet control	
安全裝置 Safety devices		熄火安全裝置，閃電保護安全裝置，過熱安全裝置，熱水高溫安全裝置 電流保險絲，壓力排放閥 Flame failure device,Lightening surge protector,Overheat prevention device, Hot water hi-limit device, Electric fuse, Pressure relief valve	
配件 Accessory		使用說明書，螺絲 Operation manual. Installation manual, Screws	
適用氣體 Gas type		石油氣 LPG	煤氣(香港) Town Gas(HK)
耗氣量 Gas Consumption	最大 Maximum	86MJ/h (24 kW)	90MJ/h (25 kW)
	最小 Minimum	29MJ/h (8 kW)	29MJ/h (8 kW)
出水量 (公升/分鐘) Hot water supply (L/min)	最多溫升25°C, +25°C	12	12
	最少溫升25°C, +25°C	4.2	4.2
	最多溫升40°C, +40°C	7.5	7.5

參數變化，以實物為準，恕不另行通知。
The change of the parameter bases on the practicality, without prior notice.

請填妥以下空格並與發票一併保存，以便維修時核對資料。用戶提供本公司之所有資料必須正確無誤，否則免費保用將會無效。
Please fill out the form below. This information and the purchase invoice will be required for any repairs. Warranty will be invalid if information provided is found to be inaccurate.

型號 Model No.: ☐ GPS12

機身號碼 Serial No.: _____

購買商號 Purchased From: _____

發票號碼 Invoice No.: _____

購買日期 Purchase Date: _____

保用條例

此保用提供德國寶產品之機件在正常使用下壹年保用(自購買日起計算)。

* 貴戶須在購機十天內，以下列其中一種方式向本公司登記資料，保用手續方正式生效：

- 1) 填妥本公司網頁內之保用登記表格
www.germanpool.com/warranty
- 2) 填妥保用登記卡，並連同購機發票之副本一併郵寄到客戶服務總部(本公司將不發還發票副本或登記卡)。

1. 未能出示購買發票正本者，將不獲免費維修服務。
2. 用戶應依照說明書的指示操作。本保用並不包括：
 - 任何附件及輔助裝置；
 - 因天然與人為意外造成的損壞(包括運輸及其它)；
 - 電源接合不當、不依說明書而錯誤或疏忽使用本機所引致之損壞。
3. 於下列情況下，用戶之保用資格將被取消：
 - 購買發票有任何非認可之刪改；
 - 產品被用作商業或工業用途；
 - 產品經非認可之技術人員改裝或加裝任何配件；
 - 機身編號被擅自塗改、破壞或刪除。
4. 如用戶自攜熱水器或部份配件到本公司維修部檢查或維修，本公司將會收取檢查或測試費用。
5. 總代理有權選擇維修或更換配件或其損壞部份。
6. 產品一經被轉讓，其保用即被視作無效。
7. 保用只在香港、九龍及新界區有效，東涌、愉景灣及離島須額外收取交通費用。

客戶服務部

德國寶(香港)有限公司
香港九龍土瓜灣馬頭角道116號
新寶工商中心高層地下2-4室
電話：+852 2333 6249
傳真：+852 2356 9798
電郵：repairs@germanpool.com

Warranty Terms & Conditions

Under normal operations, the water heater will receive a 1-year full warranty provided by German Pool (effective starting from the date of purchase).

This warranty is not valid until Customer's registration information is returned to and received by our Service Centre within 10 days of purchase via one of the following methods:

- 1) Visit our website and register online:
www.germanpool.com/warranty
- 2) Complete all fields on the attached Warranty Card and mail it back to our Customer Service Headquarters along with a photocopy of the purchase invoice (Warranty Card and invoice copy will not be returned to Customer)

1. Customer who fails to present original purchase invoice will be disqualified for free warranty.
2. Customer should always follow the operating instructions. This warranty does not apply to:
 - any accessories and auxiliary devices;
 - damages caused by accidents of any kind (including transport and others);
 - operating failures resulted by incorrect voltage, improper operations and unauthorized installations or repairs.
3. This warranty is invalid if:
 - purchase invoice is modified by unauthorized party;
 - product is used for any commercial or industrial applications;
 - product is repaired or modified by unauthorized personnel, or unauthorized parts are installed;
 - serial number is modified, damaged or removed from the product.
4. Regardless of warranty status, all walk-in requests for water heater repair or replacement service at our Customer Service Centre are subject to testing and handling charges.
5. German Pool will, in its discretion, repair or replace any defective part.
6. This warranty will be void if there is any transfer of ownership from the original purchaser.
7. Service area includes Hong Kong Island, Kowloon and New Territories. Repairs in Tung Chung, Discovery Bay or other outlying islands are subject to extra service charges.

Customer Service Centre

German Pool (Hong Kong) Limited
Room 2-4, Upper G/F, Newport Centre,
116 Ma Tau Kok Road,
Tokwawan, Kowloon, Hong Kong
Tel : +852 2333 6249
Fax : +852 2356 9798
Email : repairs@germanpool.com

此保用只適用於香港

This warranty is valid only in Hong Kong

GERMAN POOL 德國寶

图号: JSG24-SM1(DGB)

名称: 德国宝蓝屏恒温说明书

规格: 297x210mm

材料: 封底面128克铜版纸, 内容80克双胶纸

德國寶(香港)有限公司 German Pool (Hong Kong) Limited

香港九龍土瓜灣馬頭角道116號新寶工商中心高層地下2-4號室 Room 2 - 4, Upper Ground Floor, Newport Centre 116 Ma Tau Kok Road, Tokwawan, Kowloon, Hong Kong	電話 (Tel): +852 2333 6245 +852 2773 2888	傳真 (Fax): +852 2765 8215 +852 2365 6009	電郵 (E-mail): info@germanpool.com
---	---	---	-------------------------------------



© 版權所有。未獲德國寶授權，不得翻印、複製或使用本說明書作任何商業用途，違者必究。
© All rights reserved. Copying, reproducing or using the contents of this manual is not allowed without prior authorization from German Pool, violators will be prosecuted.

www.germanpool.com