



---

# Portable IC Audio Player 数码音频播放机

---

Operating Instructions.....	GB
使用说明书.....	CS

在使用产品前，请仔细阅读本使用说明书

**XDM-S500/S700**

## WARNING

**To prevent fire or shock hazard, do not expose the unit to rain or moisture.**

Do not install the appliance in a confined space, such as a bookcase or built-in cabinet.

To prevent fire, do not cover the ventilation of the apparatus with news papers, table cloths, curtains, etc. And don't place lighted candles on the apparatus.

To prevent fire or shock hazard, do not place objects filled with liquids, such as vases, on the apparatus.

### Note on installation

If you use the unit at a place subject to static or electrical noise, the track's transferring information may be corrupted. This would prevent successful transferring authorization on your computer.

## Notice for users

### On the supplied software

- Copyright laws prohibit reproducing the software or the manual accompanying it in whole or in part, or renting the software without the permission of the copyright holder.
- In no event will SONY be liable for any financial damage, or loss of profits, including claims made by third parties, arising out of the use of the software supplied with this player.
- In the event a problem occurs with this software as a result of defective manufacturing, SONY will replace it.  
However, SONY bears no other responsibility.
- The software provided with this player cannot be used with equipment other than that which is so designated.
- Please note that, due to continued efforts to improve quality, the software specifications may be changed without notice.
- Operation of this player with software other than that provided is not covered by the warranty.

Program ©2001, 2002, 2003, 2004 Sony Corporation  
Documentation ©2004 Sony Corporation

This manual explains how to operate your Portable IC Audio Player and how to use the MP3 File Manager (pre-installed software). For details on how to use the SonicStage (supplied software), refer to the SonicStage operating instructions.

OpenMG and its logo are trademarks of Sony Corporation.

SonicStage and SonicStage logo are trademarks or registered trademarks of Sony Corporation.

ATRAC, ATRAC3, ATRAC3plus and their logos are trademarks of Sony Corporation.

Microsoft, Windows and Windows Media are trademarks or registered trademarks of Microsoft Corporation in the United States and/or other countries.

All other trademarks and registered trademarks are trademarks or registered trademarks of their respective holders.

In this manual, <sup>TM</sup> and ® marks are not specified.

---

# Table of Contents

Overview .....	4
What you can do with your Portable IC Audio Player .....	4
Other features .....	5
Step 1: Checking the package contents .....	6
Step 2: Inserting the battery .....	7
Locating controls .....	8
Front side .....	8
Rear side .....	8
Display .....	9

---

## Basic Operations

Transferring audio files from the computer to your Portable IC Audio Player .....	10
Note on playing songs with a limited playing period (Timeout contents) .....	11
Note on playing songs with a limited playing count .....	11
Listening to music with your Portable IC Audio Player .....	12
What is the Group function? .....	13
On other operations .....	13

---

## Advanced Operations

Repeat mode .....	14
Selecting the repeat mode .....	14
Playing the tracks repeatedly (Track Repeat) .....	15
Playing a specified section repeatedly (A-B Repeat) .....	15
Playing specified sentences repeatedly (Sentence Repeat) .....	16
Setting the repeat counts .....	17
Changing the display mode .....	17
Selecting the group display mode .....	18
Adjusting treble and bass (Digital sound preset) .....	19
Selecting the Sound quality .....	19
Adjusting the sound quality .....	19
Locking the controls (HOLD) .....	20
Storing non-audio data .....	21

---

## Using the radio

Listening to the radio .....	22
Presetting radio stations .....	23

---

## Adjusting the settings of your Portable IC Audio Player

Adjusting the time setting of your Portable IC Audio Player to a computer's built-in clock .....	24
Adjusting the current time setting (DATE-TIME) .....	25
Limiting the volume (AVLS) .....	26
Setting the volume using the preset volume function .....	26
Setting a volume level of the preset mode .....	26
Switching to the manual mode .....	27
Turning off the beep sound (BEEP) .....	28
Changing the backlight setting .....	28
Changing the blink setting of OPERATION lamp .....	29
Turning off the power after a specified time (TIMER) .....	30

---

## Other functions

Regrouping songs (REGROUP) .....	31
Formatting the memory (FORMAT) .....	32

---

## Other Information

Precautions .....	33
Troubleshooting .....	34
To reset the player .....	34
What happened? .....	34
Messages .....	37
Specifications .....	38
Glossary .....	39
Menu list .....	40

---

## MP3 File Manager software operation

What you can do with the MP3 File Manager .....	41
Transferring MP3 audio files from the computer to your Portable IC Audio Player .....	41
Display of MP3 File Manager .....	43
Erasing audio file .....	44
Changing the order of audio files .....	44

Index .....	45
-------------	----

# Overview

## What you can do with your Portable IC Audio Player

First, you need to install the “SonicStage” software into your computer (MP3 File Manager software is pre-installed in your Portable IC Audio Player). You can easily transfer digital audio files from your computer to the built-in flash memory and carry it anywhere to enjoy.

### 1 Store digital audio files on your computer.

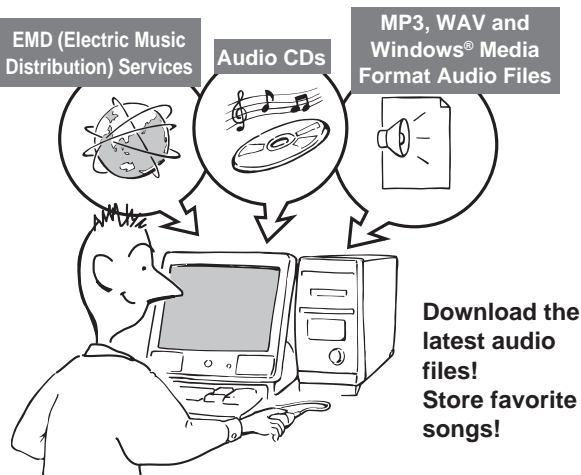

### 2 Transfer files to your Portable IC Audio Player.

When you transfer MP3 format audio files to your Portable IC Audio Player, use MP3 File Manager software (pre-installed software) to transfer and store them as MP3 format audio files.

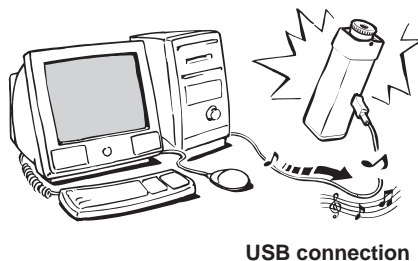

### 3 Enjoy music with your Portable IC Audio Player.

You can display the data stored in the built-in flash memory using Windows Explorer when your Portable IC Audio Player is connected to the computer. However, an MP3 format audio file cannot be played back if you drag or copy the file directly on the Windows Explorer screen. When you transfer an MP3 format audio file to your Portable IC Audio Player, be sure to use the MP3 File Manager software (see page 41).



## Other features

- Compact size, light weight, skip-proof operation, high portability.
- The pre-installed MP3 File Manager software enables you to transfer MP3 format audio files to your Portable IC Audio Player and listen to them with your Portable IC Audio Player as MP3 format files.
- Continuous playback time with a battery  
XDM-S500/XDM-S700: Approximately 100\*<sup>1</sup> hours
- Recording time\*<sup>2</sup>  
XDM-S500: 128MB built-in flash memory, more than 5 hours 50 minutes.  
XDM-S700: 256MB built-in flash memory, more than 11 hours 40 minutes.
- The supplied SonicStage software enables you to record songs from audio CDs to the hard disk of your computer using the ATRAC3plus format (high sound quality, high compression).
- Sentence Repeat: Useful function for learning a foreign language.
- High-speed data transfer using the dedicated USB cable.
- Backlight LCD screen: song titles and artist names can be displayed.
- Group function: you can select songs to be played by album.
- FM radio tuner: you can listen to FM broadcasts in addition to playing audio files.
- Timer function: you can set your Portable IC Audio Player to turn off automatically after a certain period of time.
- Storage function: you can store a variety of data as well as audio files.

\*<sup>1</sup> Differs according to the data format. In this case, the figure for the battery duration is when continuously playing ATRAC3 format audio files.

\*<sup>2</sup> Differs according to the bit rate when recording. In this case, the figure for the recordable time is when recording at 48kbps ATRAC3plus format.

### NOTES:

- The recorded music is limited to private use only. Use of the music beyond this limit requires permission of the copyright holders.
- Sony is not responsible for incomplete recording/downloading or damaged data due to problems of the Portable IC Audio Player or computer.

---

# Step 1: Checking the package contents

Please check the accessories in the package.

XDM-S500/S700:

- Portable IC Audio Player (1)
- Headphones (1)
- Carrying pouch (1)
- Neck strap (1)
- Headphones extension cord (1)
- CD-ROM (1)
- Operating instructions (1)
- SonicStage operating instructions (1)
- Card Warranty (1)

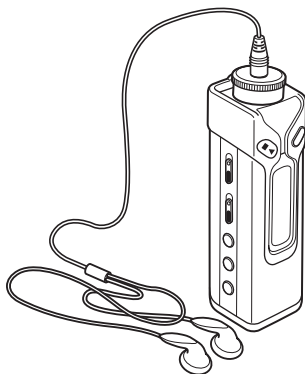

- Dedicated USB cable (1)

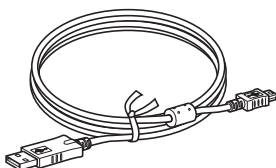

## Step 2: Inserting the battery

Insert one LR6 (size AA) alkaline battery with correct polarity. Be sure to insert it from the  side as illustrated. Push forward the battery compartment lid until it locks completely.

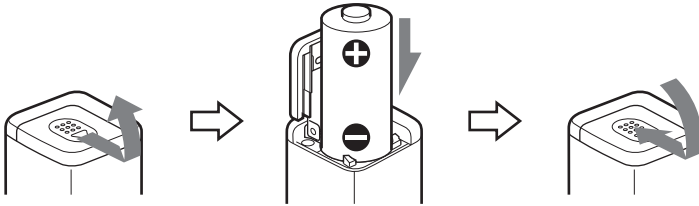

### **Battery duration\***

ATRAC3 format: Approximately 100 hours

ATRAC3plus format: Approximately 90 hours

MP3 format: Approximately 80 hours

FM radio reception: Approximately 40 hours

\* The battery life may be shorter due to operating conditions and the temperature of the location.

### **On the remaining battery indication**

The battery icon in the display changes as shown below.

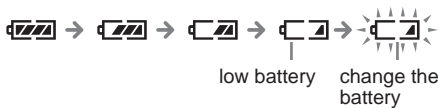

If the battery compartment lid is accidentally detached, attach it as illustrated.

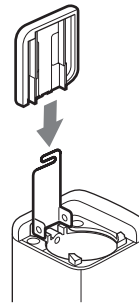

If “LOW BATT” is displayed in the display, you need to change the battery.

### **Notes**

- When the player is not turned on, even if it puts in a battery, put in a battery again after waiting for a while.
- If you do not use the battery correctly, it may become damaged from leakage and corrosion. For best results:
  - Use the alkaline battery.
  - Make sure the polarity is correct.
  - Do not charge a dry cell battery.
  - Remove the battery, if you do not intend to use the player for an extended period of time.
  - If you have battery leakage, replace with a new battery after cleaning the battery compartment.

# Locating controls

For details about each part, refer to the pages in parentheses.

## Front side

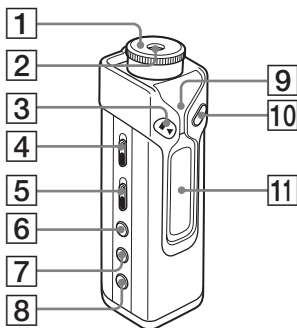

- 1** Shuttle switch (◀◀/▶▶, VOL (volume)) (pages 12 to 20, 22 to 32)
- 2** Headphone jack (page 12)
- 3** ▶■ button (pages 12, 14 to 20, 22 to 32)
- 4** HOLD (Locking controls) switch (page 20)
- 5** RADIO ON/OFF switch (pages 12 to 14, 17 to 18, 22 to 23, 30)
- 6** SOUND button (page 19)
- 7** GROUP/TUNE MODE button (pages 13, 18, 23)

## Rear side

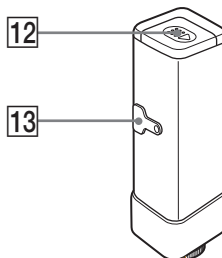

- 8** REPEAT button (pages 15 to 16)
- 9** ACCESS lamps (pages 10, 41)  
Blinks in orange.  
OPERATION lamp (pages 29)  
Blinks or lights in green.
- 10** MENU button (pages 14, 17 to 20, 22 to 32)
- 11** Display (pages 9, 13, 15, 17)  
For details on the display and icons, refer to page 9.
- 12** Battery compartment (page 7)
- 13** USB jack (pages 10, 41)



## Display

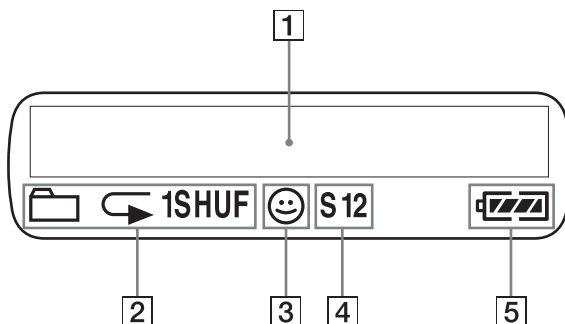

- 1** Text/graphic information display (page 15)  
Displays track number, track name, current date and time (page 17 to 25), MESSAGE (page 11, 37) and menu.  
Press the MENU button to switch the display mode. For details, refer to “Changing the display mode” on page 17.
- 2** Repeat mode indication (page 14)  
The current repeat mode is displayed.
- 3** AVLS indication (page 26)  
The indication appears while the AVLS function is activated.
- 4** Digital sound preset indication (page 19 to 20)  
The current sound setting is displayed.
- 5** Remaining battery indication (page 7)  
The remaining battery power is displayed.

# Transferring audio files from the computer to your Portable IC Audio Player

### Note

Before connecting your Portable IC Audio Player to the computer for the first time, be sure to install the “SonicStage” software from the supplied CD-ROM in your computer. Even if the SonicStage software is already installed, you need to install the SonicStage software supplied with this Portable IC Audio Player before connecting your Portable IC Audio Player to the computer (update programs may be available).

You can transfer ATRAC3, ATRAC3plus format audio files from the computer to your Portable IC Audio Player using the installed SonicStage software. Follow the procedure below.

You can also transfer MP3 format audio files, using the MP3 File Manager that is pre-installed in your Portable IC Audio Player. For details, refer to “MP3 File Manager software operation” on page 41.

- 1 Install the SonicStage software in your computer using the supplied CD-ROM.  
Follow step 1 only for the first time when you connect your Portable IC Audio Player to the computer.  
For details, refer to the SonicStage operating instructions.
- 2 Import audio files into the SonicStage software.  
For details, refer to the manual “SonicStage operating instructions.”
- 3 Connect your Portable IC Audio Player to your computer.  
Connect the small connector of the dedicated USB cable into the USB jack on the Portable IC Audio Player, then the large connector to a USB port on your computer.  
“CONNECT” appears in the display.

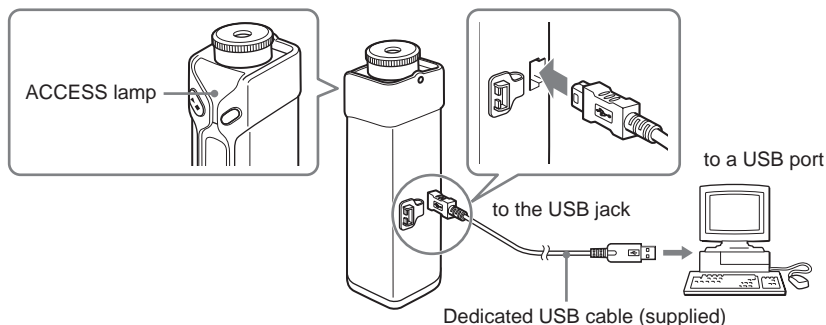

### Notes

- The orange ACCESS lamp blinks while your Portable IC Audio Player accesses the computer.
- Do not disconnect the USB cable when the orange ACCESS lamp is blinking. The data being transferred may be destroyed.
- Use of your Portable IC Audio Player with a USB hub or a USB extension cable is not guaranteed. Always connect your Portable IC Audio Player to the computer directly using the dedicated USB cable.
- Some USB devices connected to the computer may interfere with the proper operation of your Portable IC Audio Player.
- The control buttons on your Portable IC Audio Player are all disabled while it is connected to a computer.
- You can display the data stored in the built-in flash memory using Windows Explorer when your Portable IC Audio Player is connected to the computer.

---

## 4 Transfer audio files to your Portable IC Audio Player.

For information on transferring audio files to the built-in flash memory, refer to the separate manual “SonicStage operating instructions.”

---

### Tip

For information on transferring audio files back to the computer, refer to the manual “SonicStage operating instructions” or online Help for the SonicStage software.

## Note on playing songs with a limited playing period (Timeout contents)

Some songs distributed via the Internet (EMD service) have a limited playing period.

If you try to play an expired song, “EXPIRED” blinks and the next song will be played after a moment.

In addition, an expired song cannot be played using the SonicStage software, or transferred to your Portable IC Audio Player. Delete such songs as needed.

## Note on playing songs with a limited playing count

Your Portable IC Audio Player does not support contents with a limited playing count.

When you try to play a song with a limited playing count, “EXPIRED” will be displayed and the song will not be played.

# Listening to music with your Portable IC Audio Player

Please insert a battery before use (see page 7).

## Note

When using Portable IC Audio Player, be sure to disconnect it from the computer.

### 1 Connect the headphones.

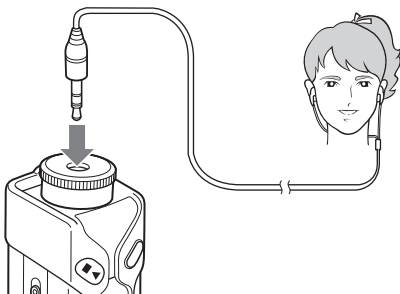

### To use the headphones extension cord

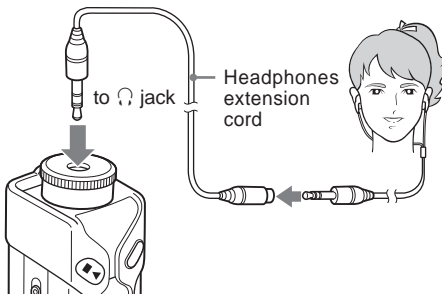

### 2 Turn off the radio.

Slide the RADIO ON/OFF switch in the direction of RADIO OFF.

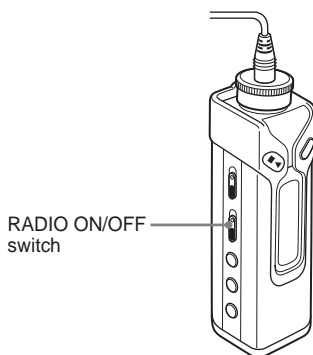

### If playback does not start

Make sure that the HOLD switch is set to off (page 20).

### To stop playback

Press the ►■ button.

### To adjust the volume

The volume can be set in the PRESET and MANUAL mode (pages 26 to 27).

### 3 Start playback.

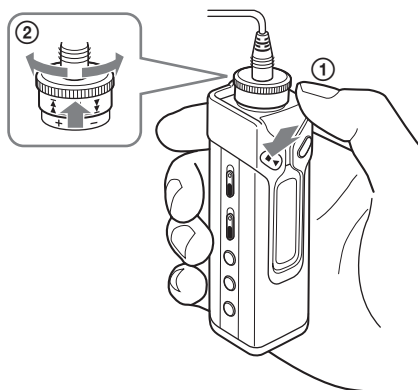

① Press the ►■ button.

② Pull and rotate the Shuttle switch to adjust the volume.

### 💡 Tip

If your Portable IC Audio Player is not operated for 5 seconds while in stop mode, the display automatically turns off.

When scrolling track titles, etc., the display turns off after scrolling is finished.

When the normal playback mode is selected, playback stops automatically after the last song is played.

# What is the Group function?

The Group function enables you to select favorite music conveniently on your Portable IC Audio Player. You can transfer audio files or play songs by album or artist using the Group function.

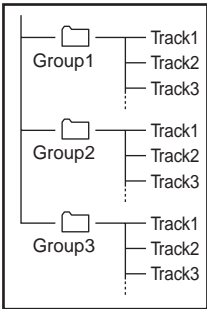

- The track number is the order of songs in each group.
- You can switch between Track Name mode and Group mode by pressing the GROUP/TUNE MODE button.
- In the Group mode, group names are displayed instead of track names. In addition, any shift operations, such as Skip or Repeat, are performed by group.

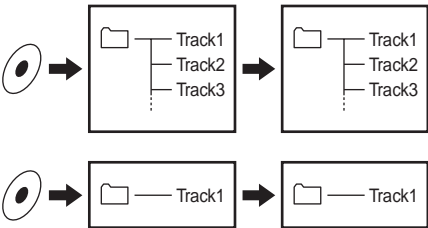

## Transferring by group

The audio files transferred to the SonicStage software are always grouped when transferred to the built-in flash memory.

### Tip

A group created by SonicStage software has priority over one created by MP3 File Manager software on your Portable IC Audio Player.

## On other operations

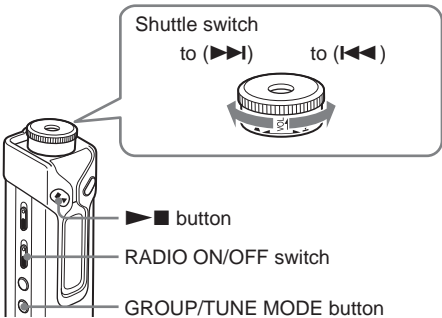

### Tip

You can switch to the Group mode by pressing the GROUP/TUNE MODE button with the RADIO ON/OFF switch set to RADIO OFF.

To	Shuttle switch operation
Skip to the beginning of the next track/ group* <sup>1</sup>	Rotate the Shuttle switch clockwise once (>>>).
Skip to the beginning of the current track/ group* <sup>1</sup>	Rotate the Shuttle switch counterclockwise once (<<<).
Fast-forward* <sup>2</sup>	Rotate the Shuttle switch clockwise (>>>) and hold it.
Fast-rewind* <sup>2</sup>	Rotate the Shuttle switch counterclockwise (<<<) and hold it.

\*<sup>1</sup> Rotating and holding of the Shuttle switch during stop mode allows you to skip to the beginning of the next (current and previous) track/group continuously.

\*<sup>2</sup> Fast-forward and fast-rewind speed become faster if the operation is continued for five seconds.

## Repeat mode

There are three types of repeat mode: Track Repeat, A-B Repeat and Sentence Repeat.

### • Track Repeat (TRK Rep)

This mode plays back tracks repeatedly in the following five ways.

Track Repeat mode	Operation
All Repeat	All tracks repeatedly
Single Repeat	Current track repeatedly
Group Repeat	Current group repeatedly
Group Shuffle Repeat	Current group repeatedly in random order
All Groups Shuffle Repeat	All groups repeatedly in random order

### • A-B Repeat (A-B Rep)

This mode plays back the specified section in a track repeatedly.

### • Sentence Repeat (SENTENCE Rep)

This mode plays back voice data within a specified section in a track repeatedly.

## Selecting the repeat mode

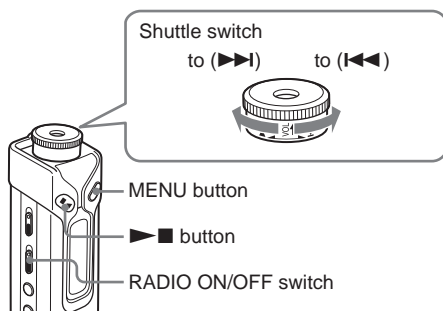

- 1 Turn off the radio.  
Slide the RADIO ON/OFF switch in the direction of RADIO OFF.

- 2 Press the MENU button in stop mode.  
The menu screen is displayed.



- 3 Rotate the Shuttle switch to select "REPEAT MODE >" and press the ▶■ button to confirm.

- 4 Rotate the Shuttle switch to select a desired repeat mode and press the ▶■ button to confirm.



You can choose one mode among "TRK Rep," "A-B Rep" and "SENTENCE Rep."

- 5 Press the MENU button.  
The display returns to the normal screen.  
You can operate each repeat mode you selected, as referred to below.
  - TRK Rep: see "Playing the tracks repeatedly (Track Repeat)."
  - A-B Rep: see "Playing a specified section repeatedly (A-B Repeat)."
  - SENTENCE Rep: see "Playing specified sentences repeatedly (Sentence Repeat)."

### To cancel the Menu mode

Select [RETURN] in the menu screen or press the MENU button.

### Notes

- The display automatically returns to the normal playback screen if you do not operate any button for 60 seconds.
- When there are no audio files in the built-in flash memory, you cannot set any repeat mode.
- When you connect the Portable IC Audio Player to your computer, the selected mode will be cancelled.
- You can select repeat mode only in stop mode.

# Playing the tracks repeatedly (Track Repeat)

The Track Repeat mode is changed by pressing the REPEAT button. You can check the current Track Repeat mode with the icon of the display.

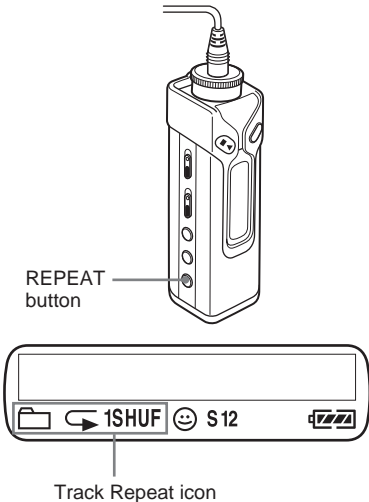

Select the Track Repeat mode (TRK Rep) first (page 14). Then, press the REPEAT button repeatedly to select the repeat mode you want.

Each press changes the Track Repeat icon as follows:

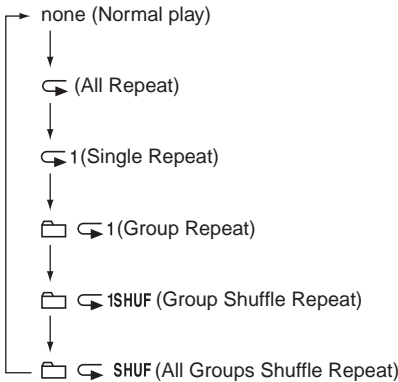

# Playing a specified section repeatedly (A-B Repeat)

While playing a track, you can set the start point (A) and end point (B) for a section you wish to play repeatedly.

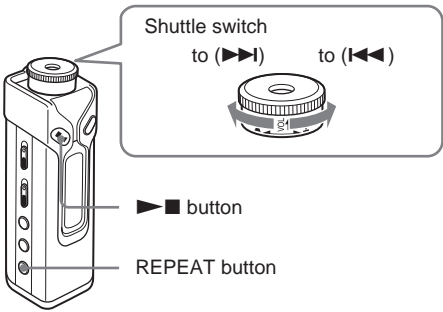

- 1 Select the A-B Repeat mode (A-B Rep) (page 14).
- 2 Press the ▶■ button to start playback.
- 3 Press the REPEAT button to set the start point (A) while playing back. "B" blinks.

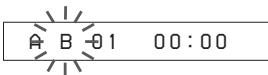

- 4 Press the REPEAT button to set the end point (B). "A B" is displayed and the specified section is played back repeatedly.



- Notes
- You cannot set A-B Repeat for a section that overlaps two or more tracks.
  - If you do not set the end point (B), the end point is automatically set at the end of the track.
  - You cannot use A-B Repeat in the Group mode or when the current time is displayed.

## Repeat mode (continued)

### 💡 Tips

- You can fast-forward or fast-rewind by rotating the Shuttle switch, after the start point (A) is set. If the track reaches the end while fast-forwarding, the end point is set as point (B) and fast-forwarding continues. A-B Repeat starts when you release the Shuttle switch. If the track reaches the beginning while fast-reversing, it jumps to the end of the track, the end point is set as point (B), and fast-reversing continues.
- You can fast-forward or fast-rewind by rotating the Shuttle switch, during A-B Repeat playback. If the track reaches the track start/end while fast-forwarding or fast-reversing, playback is stopped (enters Standby). A-B Repeat restarts when you release the Shuttle switch.

### To clear the start point (A) and end point (B)

- Press the REPEAT button during A-B Repeat playback.
- Press the MENU button during A-B Repeat playback.
- Select the Group mode by pressing the GROUP/TUNE MODE during A-B Repeat playback.
- Select the previous or next track by rotating the Shuttle switch during A-B Repeat playback.

### To cancel the A-B Repeat mode

Changing the Repeat mode in the menu screen (page 14).

## Playing specified sentences repeatedly (Sentence Repeat)

This function automatically detects only voice data from the setting point and repeats the voice data for setting counts. It is useful for learning a foreign language.

### 💡 Tip

The default repeat counts setting is twice for one sentence. But you can change the repeat counts setting. Refer to “Setting the repeat counts” on page 17.

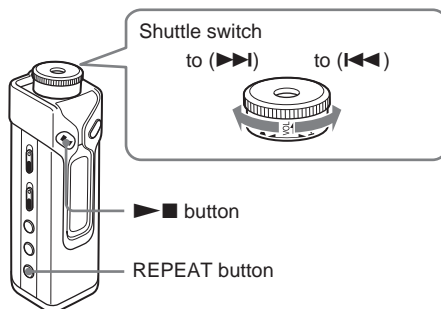

- 1 Select the Sentence Repeat mode (SENTENCE Rep) (page 14).
- 2 Press the ▶ button to start playback.
- 3 Press the REPEAT button to place the setting point during playback. The Portable IC Audio Player detects spoken sections and non-spoken sections from the set point, and Sentence Repeat starts. (The spoken section is repeated once (during detection), and the setting is counted.)

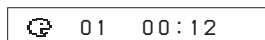

### Notes

- You cannot use Sentence Repeat in the Group mode, or when the current time is displayed.
- A spoken or non-spoken section of less than 1 second will not be detected.
- If a non-spoken section is not detected until the track end, the track end point is recognized as a non-spoken section and Sentence Repeat begins from the previous spoken section.

### To clear the setting point

- Press the REPEAT button during Sentence Repeat playback.
- Press the MENU button during Sentence Repeat playback.
- Select the Group mode by pressing the GROUP/TUNE MODE during Sentence Repeat playback.
- Select the previous or next track by rotating the Shuttle switch during Sentence Repeat playback.

### To cancel the Sentence Repeat mode

Changing the Repeat mode in the menu screen (page 14).



## Setting the repeat counts

You can set the repeat counts (1-9) of one sentence for the Sentence Repeat mode.

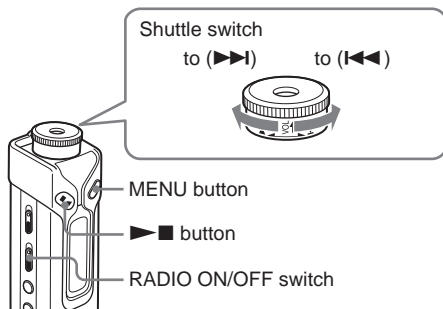

- 1 Turn off the radio.  
Slide the RADIO ON/OFF switch in the direction of RADIO OFF.

- 2 Press the MENU button.  
The menu screen is displayed.



- 3 Rotate the Shuttle switch to select "REPEAT MODE >" and press the ▶■ button to confirm.

- 4 Rotate the Shuttle switch to select "SENTENCE Rep" and press the ▶■ button to confirm.  
"COUNT:" is displayed on the screen.



- 5 Rotate the Shuttle switch to select a desired repeat counts and press the ▶■ button to confirm.

- 6 Press the MENU button.  
The display returns to the normal screen.

### To cancel the Menu mode

Select [RETURN] in the menu screen or press the MENU button.

## Changing the display mode

You can view information such as track numbers or titles in the display while music is played or stopped. Change the display mode by operating the Shuttle switch in the Menu mode.

- Lap Time: Elapsed time display mode

The following will be displayed after a music title and artist name are displayed.

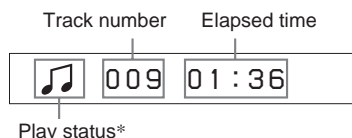

\* Play: Displays and alternately.

Stop: Displays .

Search track: Displays ▶▶ or ◀◀.

Fast-forward/Fast-rewind: Displays ▶▶ or ◀◀.

- Title: Title display mode

When the music title includes more than 12 characters, the title will be automatically scrolled.

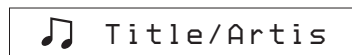

- Track info: Track information display mode

The track title, CODEC, and bit rate are displayed. When the information includes more than 12 characters, the information will be automatically scrolled.

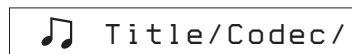

While searching, fast-forwarding, or fast-rewinding a track, the current playing position is displayed.

## Changing the display mode (continued)

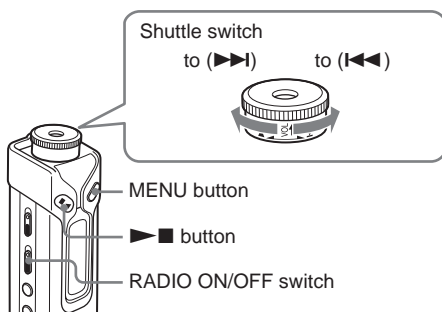

- 1 Turn off the radio.  
Slide the RADIO ON/OFF switch in the direction of RADIO OFF.

- 2 Press the MENU button.  
The menu screen is displayed.



- 3 Rotate the Shuttle switch to select "DISPLAY >" and press the ▶ button to confirm.  
The selected display mode blinks.



- 4 Rotate the Shuttle switch to select a desired display mode and press the ▶ button to confirm.  
The display switches to the selected display mode.



- 5 Press the MENU button.  
The display returns to the normal screen.

### To cancel the menu mode

Select [RETURN] in the menu screen or press the MENU button.

#### Note

The display automatically returns to the normal playback screen if you do not press any buttons for 60 seconds.

## Selecting the group display mode

For any menu mode, you can select the group display by pressing the GROUP/TUNE MODE button with the RADIO ON/OFF switch set to RADIO OFF.

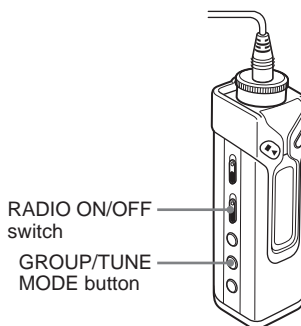

### To cancel the group mode

Press the GROUP/TUNE MODE button in the group mode screen.

#### Tip

The backlight lights in green in group mode and lights in blue when not in group mode (if backlight is set to "ON"(see page 28)).

#### Note

The display automatically returns to the normal playback screen if you do not operate any button for 30 seconds.

# Adjusting treble and bass (Digital sound preset)

You can adjust the treble and bass. You can preset two settings, which can be selected during playback.

## Selecting the Sound quality

### Default settings

Sound quality	SOUND 1 (S1)	SOUND 2 (S2)	SOUND OFF (NORMAL SOUND)
Bass	+1	+3	±0
Treble	±0	±0	±0

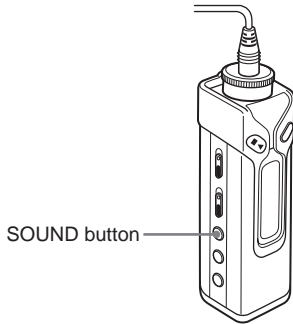

### Press the SOUND button repeatedly

The Sound quality setting change as follows:

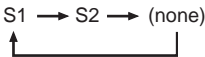

### To return to the normal Sound quality

Select "SOUND OFF."

## Adjusting the sound quality

You can adjust the sound quality of bass and treble parts.

Sound quality	Emphasis level
Bass	-4 to +3
Treble	-4 to +3

You can preset desired sound quality settings as "Sound 1" and "Sound 2." While playing music, you can assign a preset sound quality to music.

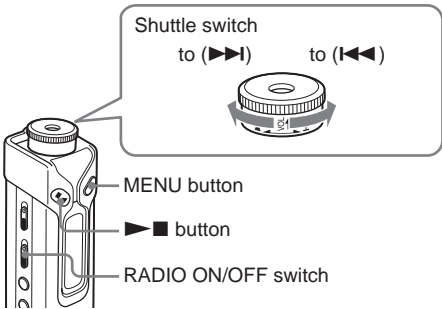

- 1 Turn off the radio.  
Slide the RADIO ON/OFF switch in the direction of RADIO OFF.
- 2 Press the MENU button.  
The menu screen is displayed.
- 3 Rotate the Shuttle switch to select "SOUND >" and press the ▶■ button to confirm.



## Adjusting treble and bass (Digital sound preset) (continued)

- 
- 4 Set the tone for “SOUND 1.”
- ① Rotate the Shuttle switch to select “SOUND 1 >” and press the ►■ button to confirm.
  - ② “BASS:+1” appears, rotate the Shuttle switch to adjust the emphasis level of bass sound and press the ►■ button to confirm.
  - ③ “TREBLE: 0” appears, rotate the Shuttle switch to adjust the emphasis level of treble sound and press the ►■ button to confirm.
- 

- 5 Press the MENU button.  
The display returns to the normal screen.
- 

### **To adjust the “SOUND 2” setting**

Select “SOUND 2” in step 4.

### **To cancel the menu mode**

Select [RETURN] in the menu screen or press the MENU button.

#### **Note**

You cannot use this function when the RADIO ON/OFF switch is set to RADIO ON.

---

## Locking the controls (HOLD)

You can protect your Portable IC Audio Player against accidental operation by using the HOLD function when carrying it.

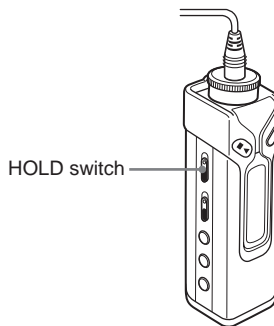

### **Slide the HOLD switch in the direction of the arrow.**

All operation buttons and switches (except the RADIO ON/OFF switch) are disabled.

If you try to operate buttons and switches while the HOLD function is on, “HOLD” blinks in the display.

### **To release the HOLD function**

Slide the HOLD switch in the opposite direction of the arrow.

#### **Note**

Only the RADIO ON/OFF switch activates when the HOLD function is on.

---

# Storing non-audio data

You can transfer data from the hard disk of your computer to the built-in flash memory using Windows Explorer.

The built-in flash memory is displayed in Windows Explorer as an external drive (for example: as the D drive).

## Notes

- You cannot operate the SonicStage software while operating the data storage function of your Portable IC Audio Player to use files stored in the built-in flash memory. The error message “Cannot access the Device/media.” will be displayed when you try to operate both of them simultaneously.
- If you store a lot of non-audio data into the built-in flash memory, the space for audio data is reduced by the same amount.

## Listening to the radio

You can listen to FM broadcasts.

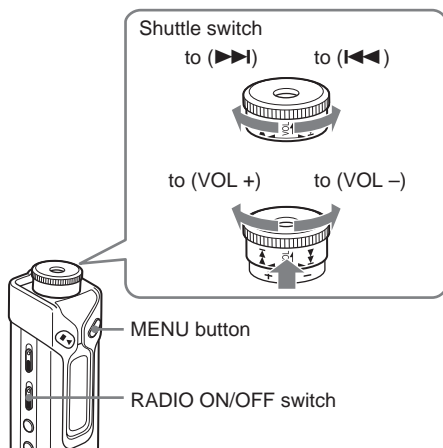

- 1 Set the RADIO ON/OFF switch to RADIO ON to turn on the radio.

FM 87.50MHz

- 2 Press the GROUP/TUNE MODE button to select the manual tuning mode (see tip below).

- 3 Rotate the Shuttle switch clockwise (▶▶) or counterclockwise (◀◀) and hold it.

The Player starts scanning the frequencies and stops when it finds a receivable station. If you rotate the Shuttle switch repeatedly, the frequency changes step by step.

### To turn off the radio

Set the RADIO ON/OFF to RADIO OFF.

### If it is hard to hear the FM broadcast

If the FM broadcast is noisy, switch to the monaural reception mode.

- 1 Slide the RADIO ON/OFF switch in the direction of RADIO ON to turn on the radio.
- 2 Press the MENU button.  
“FM SOUND” is displayed.
- 3 Press the ▶■ button.
- 4 Rotate the Shuttle switch to select “FM SOUND: MONO.”
- 5 Press the ▶■ button to confirm.

### To change the setting to “STEREO”

Select “FM SOUND: STEREO” in step 4.

### To adjust the volume

Pull and rotate the Shuttle switch.

### To improve the reception

The headphone cord functions as the FM antenna. Extend the cord to improve the reception.

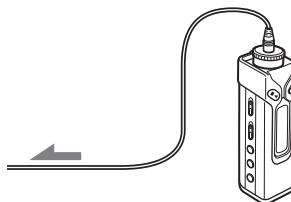

### 💡 Tip

There are two modes in tuning in the station; manual tuning mode and preset tuning mode.

In manual tuning mode, you can tune in by changing the frequency as step 3 above.

In preset tuning mode, you can tune in by changing the preset number (see page 23).

To switch between manual tuning mode and preset tuning mode, press the GROUP/TUNE MODE button. Only in preset tuning mode, the preset number appears on the right side of the display. The backlight lights in blue in manual tuning mode and lights in green in preset tuning mode (if backlight is set to “ON”(see page 28)).

# Presetting radio stations

You can preset up to 30 FM radio stations.

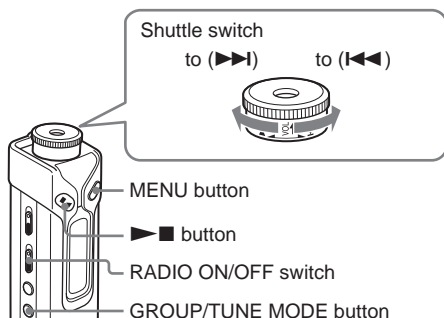

## To preset stations automatically (Auto preset)

- 1 Turn on the radio.  
Slide the RADIO ON/OFF switch in the direction of RADIO ON.
- 2 Press the MENU button.
- 3 Rotate the Shuttle switch to select "FM AUTO PRESET" and press the ▶■ button to confirm.
- 4 Rotate the Shuttle switch to select "FM RUN."
- 5 Press the ▶■ button.  
The Player starts scanning for stations from the lower frequencies.



The first received station is preset on the preset number 1, and then the player starts scanning for the next receivable station.

If you press the ▶■ button during auto presetting, the player stops scanning and exits the auto preset mode.

## To preset a station manually (Manual preset)

If there is a station that cannot be preset automatically, you can preset it manually by the following procedure.

Before starting, you must exit the preset mode (the preset numbers should not be displayed).

- 1 Tune in the station you want to preset in manual tuning mode (see tip on page 22).
- 2 Press and hold the ▶■ button for more than 2 seconds.  
The preset numbers flash in the display.
- 3 Within 30 seconds, rotate the Shuttle switch to select the preset number you want to store the station on.  
The selected preset number starts flashing.
- 4 Press the ▶■ button.

## To tune in a preset station

- 1 Turn on the radio.  
Slide the RADIO ON/OFF switch in the direction of RADIO ON.
- 2 Press the GROUP/TUNE MODE button to select the preset tuning mode (see tip on page 22).  
The preset number appears on the right side of the display.
- 3 Rotate the Shuttle switch to select the preset number of the station you want to tune in.

## Adjusting the settings of your Portable IC Audio Player

# Adjusting the time setting of your Portable IC Audio Player to a computer's built-in clock

If the function is set to "ON," the time setting of your Portable IC Audio Player is automatically adjusted to the computer's built-in clock when your Portable IC Audio Player is connected and audio file transferring is executed (the SonicStage software must be started). "ON" is selected by default.

You cannot play a song with a limited playing period without the time setting of your Portable IC Audio Player. Be sure to adjust the time setting.

To set the date and time on your Portable IC Audio Player, refer to "Adjusting the current time setting (DATE-TIME)" on page 25.

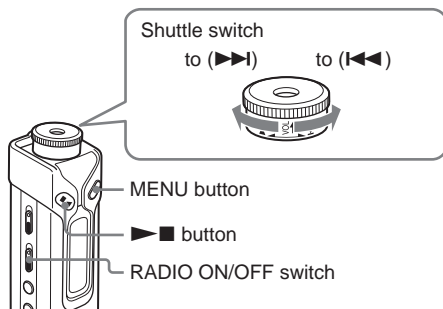

### Changing the setting to "OFF"

The time setting of your Portable IC Audio Player does not change even when your Portable IC Audio Player is connected to a computer.

- 1 Turn off the radio.  
Slide the RADIO ON/OFF switch in the direction of RADIO OFF.

- 2 Press the MENU button.  
The menu screen is displayed.



- 3 Rotate the Shuttle switch to select "PC CLK:" and press the ▶■ button to confirm.



- 4 Rotate the Shuttle switch to select "OFF" and press the ▶■ button to confirm.

- 5 Press the MENU button  
The display returns to the normal screen.

### To change the setting to "ON"

Select "ON" in step 4.

### To cancel the menu mode

Select [RETURN] in the menu screen or press the MENU button.



# Adjusting the current time setting (DATE-TIME)

You can set and display the current time.

You can also adjust the time setting of your Portable IC Audio Player to a computer's built-in clock by connecting your Portable IC Audio Player to the computer (page 24).

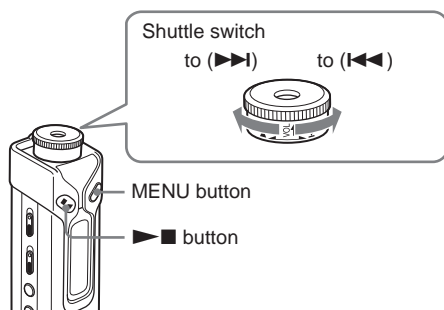

- 1 Press the MENU button.  
The menu screen is displayed.



- 2 Rotate the Shuttle switch to select "DATE-TIME" and press the ▶■ button to confirm.  
The "year" digit blinks.

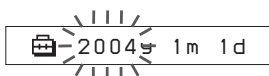

- 3 Rotate the Shuttle switch to adjust the "year" setting and press the ▶■ button to confirm.  
The "month" digit blinks.

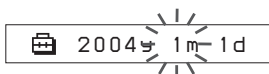

- 4 As you did in step 3, adjust the settings for "month" and "date."

After rotating the Shuttle switch to adjust the "date" setting and pressing the ▶■ button to confirm, the display switches to the time setting screen.

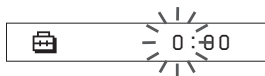

- 5 Rotate the Shuttle switch to adjust the "hour" setting and press the ▶■ button to confirm.

The "minute" digit blinks.

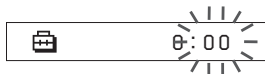

- 6 As you did in step 5, adjust the setting for "minute."

After rotating the Shuttle switch to adjust the "minute" setting and pressing the ▶■ button to confirm, the display switches to the time setting screen.



- 7 Press the MENU button.  
The display returns to the normal screen.

## To cancel the menu mode

Select [RETURN] in the menu screen or press the MENU button.

## To display the current time

Press the MENU button and hold it.

You can display the current time while pressing the button.

If you set the timer function (page 30), the preset time will be displayed before the current time.

## Notes

- If the unit is not used for a long time, your settings of the date and time may be reset.
- If the current time is not set, the display for the date and time will be "-- --."
- If PC CLK is set to "ON" (page 24), the time setting of your Portable IC Audio Player is automatically adjusted to a computer's built-in clock when your Portable IC Audio Player is connected to the computer.
- Depending on the shipping area, the time display format of the unit is set to a 12-hour display or a 24-hour display.

You cannot switch between a 12-hour display and a 24-hour display in the unit.

A 24-hour display is shown in this manual.

# Limiting the volume (AVLS)

You can set AVLS (Automatic Volume Limiter System) to limit the maximum volume to prevent auditory disturbance or distraction. With AVLS, you can listen to music at a comfortable volume level.

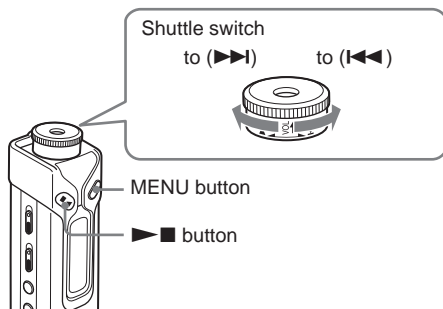

- 1 Press the MENU button.  
The menu screen is displayed.



- 2 Rotate the Shuttle switch to select "AVLS" and press the ▶■ button to confirm.  
"OFF" blinks.



- 3 Rotate the Shuttle switch to select "ON" and press the ▶■ button to confirm.  
The ☺ (AVLS) indication is displayed. The volume is kept at a moderate level.

- 4 Press the MENU button.

## To change the setting to "OFF"

Select "OFF" in step 3.

## To cancel the menu mode

Select [RETURN] in the menu screen, or press the MENU button.

# Setting the volume using the preset volume function

There are two modes to adjust the volume level.

**Manual mode:** Pull and rotate the Shuttle switch to adjust the volume level in the range of 0 to 31.

**Preset mode:** Rotate the Shuttle switch to set the volume level to any of three preset levels: LO, MID, or HI.

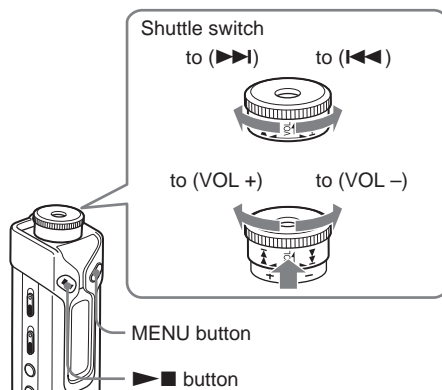

# Setting a volume level of the preset mode

- 1 Press the MENU button.  
The menu screen is displayed.



- 2 Rotate the Shuttle switch to select "VOL: MAN."

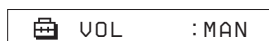

- 3 Press the ▶■ button to confirm.  
"MAN" blinks.

- 4 Rotate the Shuttle switch to select “SET >.”



- 5 Press the ► button to confirm.  
“VOL LO xx”\* blinks.  
\* “xx” stands for numeric values of the volume level.



- 6 Set volume levels of three preset levels: LO, MID, or HI.
  - ① Pull and rotate the Shuttle switch to set the volume level of the LO preset.
  - ② Return the shuttle switch to the original position and rotate the Shuttle switch to select “VOL MID xx,” and then pull and rotate the Shuttle switch to set the volume level of the MID preset.
  - ③ Return the shuttle switch to the original position and rotate the Shuttle switch to select “VOL HI xx,” and then pull and rotate the Shuttle switch to set the volume level of the HI preset.

- 7 Press the ► button to confirm.

- 8 Press the MENU button.  
The display returns to the normal screen.  
With these settings, you can adjust the volume level to any of three preset levels: LO, MID, or HI.

### To cancel the menu mode

Select [RETURN] in the menu screen or press the MENU button.

#### Note

If AVLS (page 26) is set, the actual volume may be lower than the settings.

## Switching to the manual mode

- 1 Press the MENU button.  
The menu screen is displayed.
- 2 Rotate the Shuttle switch to select “VOL: SET.”



- 3 Press the ► button to confirm.  
“SET >” blinks.

- 4 Rotate the Shuttle switch to select “MAN.”



- 5 Press the ► button to confirm.
- 6 Press the MENU button.  
The display returns to the normal screen.  
With this setting, you can adjust the volume level by rotating the Shuttle switch.

# Turning off the beep sound (BEEP)

You can turn off the beep sounds of your Portable IC Audio Player.

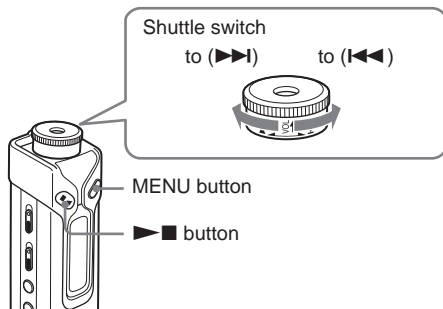

- 1 Press the MENU button.  
The menu screen is displayed.



- 2 Rotate the Shuttle switch to select "BEEP:" and press the ▶■ button to confirm.  
"ON" blinks.



- 3 Rotate the Shuttle switch to select "OFF" and press the ▶■ button to confirm.



- 4 Press the MENU button.  
The display returns to the normal screen.

## To change the setting to "ON"

Select "ON" in step 3.

## To cancel the menu mode

Select [RETURN] in the menu screen, or press the MENU button.

# Changing the backlight setting

You can select ON or OFF.

Menu	Backlight mode
OFF	Always off
ON	Turns on for three seconds after each operation (or until scrolling is complete)

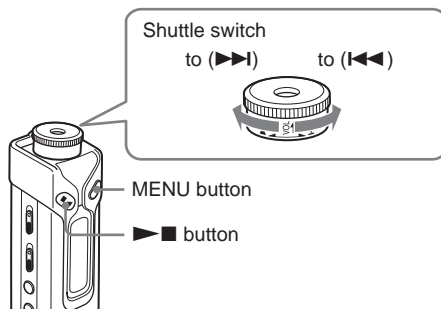

## To set "ON"

- 1 Press the MENU button.  
The menu screen is displayed.



- 2 Rotate the Shuttle switch to select "LIGHT:" and press the ▶■ button to confirm.  
"OFF" blinks.



- 3 Rotate the Shuttle switch to select "ON" and press the ▶■ button to confirm.



- 4 Press the MENU button.  
The display returns to the normal screen.

## To change the setting to "OFF"

Select "LIGHT: OFF" in step 3.

## To cancel the menu mode

Select [RETURN] in the menu screen or press the MENU button.

# Changing the blink setting of OPERATION lamp

The OPERATION lamp blinks or lights in green according to operation.

You can select from three patterns of setting, or OFF.

If you set to "OFF," the OPERATION lamp is always off.

## To cancel the menu mode

Select [RETURN] in the menu screen or press the MENU button.

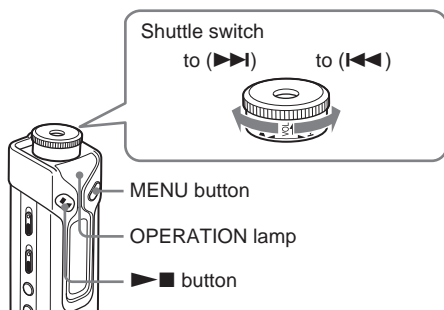

- 1 Press the MENU button.  
The menu screen is displayed.



- 2 Rotate the Shuttle switch to select "LED:" and press the ▶■ button to confirm.  
"LED:" blinks.

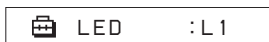

- 3 Rotate the Shuttle switch to select "LED: L1" (blinks according to operation)  
"LED: L2"(always blinks)  
"LED: L3"(always on)  
"LED: OFF"(always off)  
and press the ▶■ button to confirm.



- 4 Press the MENU button.

# Turning off the power after a specified time (TIMER)

You can set your Portable IC Audio Player to turn off automatically after a certain period of time.

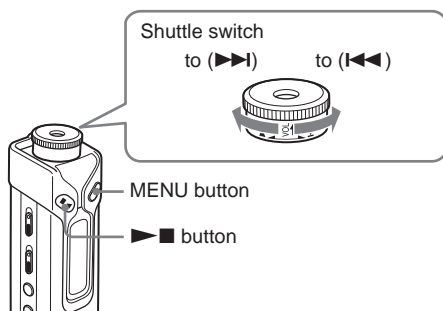

## ***To check the time length until the Player is turned off***

Press and hold the MENU button.

## ***To cancel the timer***

Carry out step 1 to 3 and select "TIMER: OFF" in step 3.

## ***To cancel the menu mode***

Select [RETURN] in the menu screen or press the MENU button.

## ***Tip***

When the timer is activated, the OPERATION lamp blinks in green even if the OPERATION lamp is set to "OFF" (see page 29).

- 1 Press the MENU button.  
The menu screen is displayed.



- 2 Rotate the Shuttle switch to select "TIMER:" and press the ▶■ button to confirm.  
"OFF" blinks.



- 3 Rotate the Shuttle switch to select "TIMER: ON" and press the ▶■ button to confirm.

- 4 Rotate the Shuttle switch to select "TIMER: 30," "60," "90," "120" or "10" and press the ▶■ button to confirm.



- 5 Press the MENU button.

# Regrouping songs (REGROUP)

The songs group function may be disabled\* when a song has been deleted from or added to the built-in flash memory by operating the computer in which the SonicStage software is not installed (page 10). In such a case, you may enable the group function by regrouping audio files. When you need to edit audio files, make sure that you connect your Portable IC Audio Player to the computer and use the SonicStage software.

\* The order of songs will not be changed even if the song group function is disabled.

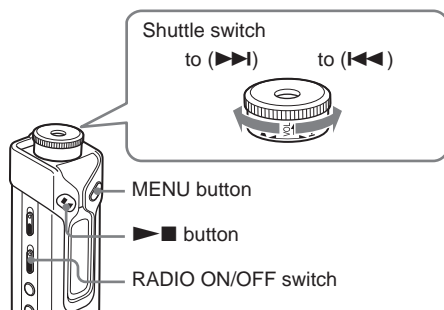

- 1 Turn off the radio.  
Slide the RADIO ON/OFF switch in the direction of RADIO OFF.

- 2 Press the MENU button.  
The menu screen is displayed.



- 3 Rotate the Shuttle switch to select "REGROUP" and press the ▶■ button to confirm.



You cannot regroup audio files while playing music.

- 4 Rotate the Shuttle switch to select "Y" and press the ▶■ button to confirm.  
"Really?" is displayed.

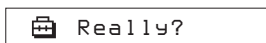

- 5 Press the ▶■ button.  
Regrouping starts and "REGROUPING" blinks. When regrouping audio files are complete, "COMPLETE" is displayed and the display returns to the indication in step 3.

- 6 Press the MENU button.  
The display returns to the normal screen.

## To cancel the menu mode

Select [RETURN] in the menu screen or press the MENU button.

### Note

You cannot regroup songs while playing music.  
("REGROUP" will not be displayed in the menu screen.)

### Tip

In some cases, you may not be able to restore the former grouping. When you need to edit audio files, connect your Portable IC Audio Player to the computer and use the SonicStage software.

# Formatting the memory (FORMAT)

You can use your Portable IC Audio Player to format the built-in flash memory. If the memory is formatted, all data previously stored in the memory will be erased. Be sure to verify the data stored in the memory prior to formatting.

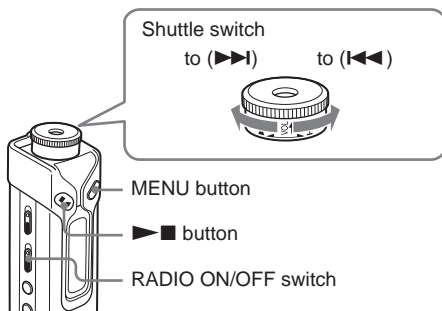

- 1 Turn off the radio.  
Slide the RADIO ON/OFF switch in the direction of RADIO OFF.

- 2 Press the MENU button.  
The menu screen is displayed.



- 3 Rotate the Shuttle switch to select "FORMAT" and press the right-pointing arrow button to confirm.



You cannot format the memory while playing music.

- 4 Rotate the Shuttle switch to select "Y" and press the right-pointing arrow button to confirm.  
"Really?" is displayed.

- 5 Press the right-pointing arrow button.  
"FORMATTING" blinks and formatting starts.

When formatting is complete, "COMPLETE" is displayed and the display returns to the indication in step 3.

- 6 Press the MENU button.  
The display returns to the normal screen.

## To cancel the menu mode

Select [RETURN] in the menu screen or press the MENU button.

## To cancel formatting

Select "N" in step 4.

## Notes

- You cannot format the memory while playing music. ("FORMAT" will not be displayed in the menu screen.)
- The MP3 File Manager software and the MP3 audio files transferred with this software are erased as a result of formatting. If the MP3 File Manager software is erased, you can restore it from the supplied CD-ROM or download it from the Aiwa customer service website. For details, refer to "MP3 File Manager software operation" on page 41.



# Precautions

## On installation

Never use your Portable IC Audio Player where it will be subjected to extremes of light, temperature, moisture or vibration.

## On the headphones

### ***Road Safety***

Do not use headphones while driving, cycling, or operating any motorized vehicle. It may create a traffic hazard and is illegal in many areas. It can also be potentially dangerous to play your Portable IC Audio Player at a high volume while walking, especially at pedestrian crossings. You should exercise extreme caution or discontinue using the player in potentially hazardous situations.

### ***Preventing hearing damage***

Avoid using the headphones at a high volume. Hearing experts advise against continuous, loud and extended play. If you experience a ringing in your ears, reduce the volume or discontinue using the player.

### ***Caring for others***

Keep the volume at a moderate level. This will allow you to hear outside sounds and to be considerate to the people around you.

### ***Warning***

If there is lightning when you are using your Portable IC Audio Player, take off the headphones immediately.

## On cleaning

- Clean your Portable IC Audio Player casing with a soft cloth slightly moistened with water or a mild detergent solution.
- Clean the headphone plug periodically.

### **Note**

Do not use any type of abrasive pad, scouring powder or solvent such as alcohol or benzene as it may mar the finish of the casing.

If you have any questions or problems concerning your Portable IC Audio Player, please consult your nearest Aiwa dealer.

# Troubleshooting

If you experience any of the following difficulties while using your Portable IC Audio Player, use this troubleshooting guide to help you to remedy the problem prior to consult an Aiwa dealer. Should any problem persist, consult your nearest Aiwa dealer. For trouble concerning operations while connected to your computer, please refer to “Troubleshooting” in the online help of the supplied software in addition.

## To reset the player

If your Portable IC Audio Player does not operate normally or if there is no sound, even after checking the troubleshooting guide below, remove the battery, then re-insert it.

### Tip

Even after resetting your Portable IC Audio Player, the preset stations will remain in the Player’s memory.

## What happened?

### On operating

Symptom	Cause/Remedy
There is no sound. Noise is generated.	<ul style="list-style-type: none"><li>• The volume level is set to zero. → Turn the volume up (page 12).</li><li>• The headphone jack is not connected properly. → Connect the headphone jack properly (page 12).</li><li>• The headphone plug is dirty. → Clean the headphone plug with a soft dry cloth.</li><li>• Songs with a limited playing period is played. → Songs with an expired playing period cannot be played.</li><li>• No audio files are stored in the memory. → If “NO DATA” is displayed, transfer audio file(s) from the computer.</li></ul>
Buttons do not work.	<ul style="list-style-type: none"><li>• The HOLD function is set to on. → Set the HOLD function to off (page 20).</li><li>• Your Portable IC Audio Player contains moisture condensation. → Keep your Portable IC Audio Player aside for a few hours.</li><li>• The remaining battery power is insufficient. → Replace the battery (page 7).</li></ul>
The volume is not loud enough.	The AVLS is enabled. → Disable the AVLS (page 26).
There is no sound from the right channel of the headphones.	<ul style="list-style-type: none"><li>• The headphone jack is not fully connected. → Connect the headphone jack fully (page 12).</li><li>• The extension headphone cord is not properly connected to the headphone jack of your Portable IC Audio Player or the headphone cord. → Connect them properly (page 12).</li></ul>
Playback has stopped suddenly.	The remaining battery power is insufficient. → Replace the battery (page 7).

## On the display window

Symptom	Cause/Remedy
The backlight is not turned on.	LIGHT is set to "OFF." → In the menu mode, set "LIGHT" to "ON" (page 28).
"□" is displayed for a title.	Characters that cannot be displayed on your Portable IC Audio Player are involved. → Use the supplied SonicStage software to rename the title with appropriate characters.

## On the connection with the computer or supplied software

Symptom	Cause/Remedy
The software cannot be installed.	An operating system not compatible with the software is used. → For details, refer to the separate manual "SonicStage operating instructions."
"CONNECT" is not displayed when connecting to the computer with the dedicated USB cable.	<ul style="list-style-type: none"><li>• Please wait for the authentication of the SonicStage software.</li><li>• Another application is running on the computer. → Wait for a while and reconnect the USB cable. If the problem persists, disconnect the USB cable, restart the computer, and then reconnect the USB cable.</li><li>• The dedicated USB cable is disconnected. → Connect the dedicated USB cable.</li><li>• A USB hub is used. → Connecting via a USB hub is not guaranteed. Connect the dedicated USB cable directly to the computer.</li></ul>
Your Portable IC Audio Player is not recognized by the computer when it is connected to the computer.	<ul style="list-style-type: none"><li>• The dedicate USB cable is disconnected. → Connect the dedicated USB cable.</li><li>• Your Portable IC Audio Player is not recognized due to the static electricity etc. → Disconnect and connect the dedicated USB cable.</li></ul>
Song cannot be transferred to your Portable IC Audio Player.	<ul style="list-style-type: none"><li>• The dedicated USB cable is not connected properly. → Connect the USB cable properly.</li><li>• The free space of the built-in flash memory to which you want to transfer audio files is insufficient. → Transfer any unnecessary songs back to your computer to increase free space.</li><li>• You have already transferred 400 songs or 400 groups to the built-in flash memory using the SonicStage software. → The maximum number of songs or groups that you can transfer to the built-in flash memory using the SonicStage software is 400.</li><li>• You have already transferred 40,000 songs or 400 groups to the built-in flash memory using the MP3 File Manager software. → The maximum number of songs and groups that you can transfer to the built-in flash memory using the MP3 File Manager software is 40,000 and 400 respectively. (The maximum number of songs contained in one group is 100.)</li><li>• Audio files with a limited playing period or playing count may not be transferred due to restrictions set by copyright holders. For details on the settings of each audio file, contact the distributor.</li></ul>

Symptom	Cause/Remedy
The number of audio files that can be transferred is limited. (Available recording time is short.)	<ul style="list-style-type: none"> <li>• The free space of the built-in flash memory to which you want to transfer audio files are insufficient.                             <ul style="list-style-type: none"> <li>→ Transfer any unnecessary audio files back to the computer to increase free space.</li> </ul> </li> <li>• Non-audio data is stored in the built-in flash memory to which you want to transfer audio files.                             <ul style="list-style-type: none"> <li>→ Move non-audio data to the computer to increase free space.</li> </ul> </li> </ul>
The operation of the Portable IC Audio Player becomes unstable while it is connected to the computer.	<p>USB hub or USB extension cable is used.</p> <p>→ Connecting via a USB hub or USB extension is not guaranteed. Connect the dedicated USB cable directly to the computer.</p>
“Failed to authenticate Device/Media” is displayed on the computer screen while connecting the Portable IC Audio Player to the computer.	<p>Your Portable IC Audio Player is not connected to the computer properly.</p> <p>→ Quit the SonicStage software and verify the connection of the dedicated USB cable. Restart the SonicStage software.</p>

## Other

Symptom	Cause/Remedy
There is no beep sound when your Portable IC Audio Player is operated.	<p>BEEP is set to “OFF.”</p> <p>→ In the menu mode, set “BEEP” to “ON” (page 28).</p>
Your Portable IC Audio Player gets warm.	Sometimes during normal conditions, the player becomes slightly warm.

# Messages

Follow the instructions below if an error message appears in the display.

Message	Meaning	Remedy
ACCESS	Accessing the built-in flash memory.	Please wait for access to complete. This message appears while transferring audio files and during initialization of the built-in flash memory.
AVLS	The volume level exceeds the rated value while the AVLS is enabled.	Turn the volume down or disable the AVLS.
CANNOT PLAY	<ul style="list-style-type: none"><li>Your Portable IC Audio Player cannot play certain files because of incompatible formats.</li><li>Transferring has been interrupted forcefully.</li></ul>	<p>If the file cannot be played, you can erase it from the built-in flash memory.</p> <p>For details, refer to “To delete abnormal data from the built-in flash memory” (page 37).</p>
CONNECT	Your Portable IC Audio Player is connected to the computer.	You can operate your Portable IC Audio Player using the SonicStage or MP3 File Manager software, but you cannot operate the controls on your Portable IC Audio Player.
ERROR	A malfunction is detected.	Please consult your nearest Aiwa dealer.
EXPIRED	<ul style="list-style-type: none"><li>The song with a playback restriction has expired.</li><li>The current time has not been set to play the song with a playback restriction.</li><li>The song is protected by the playback restriction that is not compatible with your Portable IC Audio Player.</li></ul>	<ul style="list-style-type: none"><li>If the current time has not been set yet, set the current time in the menu mode (page 25).</li><li>If song cannot be played, you can erase it from the built-in flash memory.</li></ul> <p>For details, refer to “To delete abnormal data from the built-in flash memory” (page 37).</p> <ul style="list-style-type: none"><li>Your Portable IC Audio Player does not support contents with a limited playing count. For details, refer to “Note on playing songs with a limited playing count” (page 11).</li></ul>
FILE ERROR	<ul style="list-style-type: none"><li>The file cannot be read.</li><li>The file is not normal.</li></ul>	Transfer the normal audio file back to the computer and then format your Portable IC Audio Player. (For details, refer to “To delete abnormal data from the built-in flash memory” on page 37.)
HOLD	All operation buttons are disabled since the HOLD function is set to on.	Set the HOLD function to off to operate the buttons.
LOW BATT	The battery is low.	You must change the battery (page 7).
MEMORY FULL	The memory is full or there are 400 groups.	Delete songs or groups. A group without song is also regarded as one group. To delete groups without song, use the SonicStage software.
MG ERROR	An unauthorized distribution file is detected for copyright protection.	Transfer normal audio files back to the computer and then format the built-in flash memory of your Portable IC Audio Player. (For details, refer to “To delete abnormal data from the built-in flash memory” on page 37.)
NO AUDIO	There are no audio files in the built-in flash memory.	If there are no audio files in the built-in flash memory, use the SonicStage software to transfer audio files.

## To delete abnormal data from the built-in flash memory

If “CANNOT PLAY,” “EXPIRED,” or “FILE ERROR” is displayed, there is a problem with all or part of the data stored in the built-in flash memory.

Please follow the procedures below to erase data you cannot play.

- 1 Connect your Portable IC Audio Player to the computer, and start the SonicStage software.
- 2 If you have already specified the data with problems (such as expired songs), erase the data from the Portable Player window of the SonicStage software.
- 3 If the problem persists, click the  button on the SonicStage software to transfer all data without problems while your Portable IC Audio Player is connected to the computer.
- 4 Disconnect your Portable IC Audio Player from the computer and then format the built-in flash memory using the FORMAT menu (page 32).

# Specifications

## Portable IC Audio Player

Maximum recording time (Approx.)

### XDM-S500

#### ATRAC3\*

2 hr. 00 min. (132 kbps)

2 hr. 30 min. (105 kbps)

4 hr. 10 min. (66 kbps)

#### MP3

1 hr. 00 min. (256 kbps)

2 hr. 00 min. (128 kbps)

### XDM-S700

#### ATRAC3\*

4 hr. 10 min. (132 kbps)

5 hr. 20 min. (105 kbps)

8 hr. 30 min. (66 kbps)

#### MP3

2 hr. 00 min. (256 kbps)

4 hr. 00 min. (128 kbps)

\* The values for ATRAC3, ATRAC3plus apply if the MP3 File Manager software has been erased from the built-in flash memory.

## Sampling frequency

ATRAC3, ATRAC3plus, MP3: 44.1 kHz

## Audio compression technology

Adaptive Transform Acoustic Coding3 (ATRAC3)

Adaptive Transform Acoustic Coding3plus

(ATRAC3plus)

MPEG1 Audio Layer-3 (MP3): 8 to 320 kbps, variable bit rate-compliant

## Frequency response

20 to 20,000 Hz (single signal measurement)

## FM Frequency range

87.5 – 108.0 MHz

## IF (FM)

225 kHz

## Output

Headphone: Stereo mini-jack

## Signal-to-noise ratio (S/N)

80 dB or more (excluding ATRAC3 66 kbps)

## Dynamic range

85 dB or more (excluding ATRAC3 66 kbps)

## Operating temperature

5°C to 35°C (67°F to 95°F)

## Power source

LR6 (Size AA) alkaline battery

## Battery life (continuous playback)

ATRAC3 format: Approximately 100 hours

ATRAC3plus format: Approximately 90 hours

MP3 format: Approximately 80 hours

FM radio reception: Approximately 40 hours

## Dimension

88.6 × 24.3 × 24.6 mm

(w/h/d, projecting parts not included)

## Mass

Approx. 37 g (battery not included)

## Supplied accessories

Headphones (1)

Dedicated USB cable (1)

Carrying pouch (1)

Neck strap (1)

Headphones extension cord (1)

CD-ROM (1)

Operating Instructions (1)

SonicStage operating instructions (1)

Card Warranty (1)

Design and specifications are subject to change without notice.

US and foreign patents licensed from Dolby Laboratories.

---

# Glossary

## MagicGate

Copyright protection technology that consists of authentication and encryption technology. Authentication ensures that protected content is transferred only between compliant devices and media, and that protected content is recorded and transferred in an encrypted format to prevent unauthorized copying or playback.

### Note

**MAGICGATE** is terminology denoting the copyright protection system developed by Sony. It does not guarantee conversion among other media.

## OpenMG

Copyright protection technology that securely manages music content from the EMD/Audio CD on a personal computer. Application software that is installed on the computer encrypts the digital music content when recording on the hard drive. This allows you to enjoy music content on the computer, but prevents unauthorized transmission of this content across a network (or elsewhere). This PC copyright protection complies with “MagicGate”, and allows you to transfer digital music content from a PC’s hard drive to a compliant device.

## SonicStage

Copyright protection technology that securely manages music content from the EMD/Audio CD on a personal computer. Application software that is installed on the computer encrypts the digital music content when recording on the hard drive. This allows you to enjoy music content on the computer, but prevents unauthorized transmission of this content across a network (or elsewhere). This PC copyright protection complies with “MagicGate”, and allows you to transfer digital music content from a computer’s hard disk to a compliant device.

## ATRAC3

ATRAC3, which stands for Adaptive Transform Acoustic Coding3, is audio compression technology that satisfies the demand for high sound quality and high compression rates.

The ATRAC3 compression rate is approximately 10 times higher than that of the Audio CD, resulting in an increased data capacity for the media.

## ATRAC3plus

ATRAC3plus, which stands for Adaptive Transform Acoustic Coding3plus, is audio compression technology that compresses data higher than ATRAC3. The ATRAC3plus is new audio compression technology that enables equal or higher quality sound comparing to ATRAC3.

## Bit rate

Indicates the data amount per second. The rate is reflected in bps (bit per second).

64 kbps means 64000 bits of information per second. If the bit rate is large, that means a large amount of information is used to play music. Comparing music of the same format (e.g., ATRAC3plus), 64 kbps data offers better sound quality than 48 kbps data. However, audio files in formats such as MP3 have different encoding methods, and thus sound quality cannot be determined by simply comparing the bit rate.

## MP3

MP3, which stands for MPEG-1 Audio Layer-3, is a format standard for music file compression. It was codified by the Motion Picture Experts Group, a working group of ISO (International Organization for Standardization). It compresses audio CD data to approximately one tenth its original size. Because the MP3 encoding algorithm has been made publicly available, there are various encoders and decoders that are compliant with this standard.

# Menu list

**Press the MENU button to display the menu mode and use the Shuttle switch (rotate: select/press: confirm) to change the settings of your Portable IC Audio Player.**

For details about each menu, refer to the pages in parentheses. The menu with a “>” mark will be followed by a detailed-setting screen when you press the Shuttle switch to confirm.

Display (Menu mode)	Purposes
<b>REPEAT MODE &gt;■</b>	You can select your favorite repeat mode. (page 14)
<b>DISPLAY &gt;■</b> (Display mode)	You can select your favorite display mode. (page 17)
<b>FM SOUND:□</b>	You can select the monaural reception mode during radio function.
<b>FM AUTO PRESET:□</b>	You can select the manual mode or preset mode during radio function. (page 23)
<b>VOL:■□</b> (Preset volume)	You can preset your desired volume level. (page 26)
<b>SOUND &gt;■</b> (Digital sounds preset)	You can preset your desired sound quality. (page 19)
<b>AVLS:■□</b> (Automatic Volume Limiter System)	You can set to “ON” or “OFF.” (page 26)
<b>BEEP:■□</b> (Operation sounds setting)	You can set to “ON” or “OFF.” (page 28)
<b>LIGHT:■□</b> (LCD backlight setting)	“OFF”: Always off “ON”: Turns on for three seconds after each operation (page 28)
<b>DATE-TIME■□</b> (Current time setting)	You can set and display the current time. (page 25)
<b>PC CLK:■</b> (Adjusting the time setting to a computer built-in clock)	You can adjust the time setting of your Portable IC Audio Player to a computer built-in clock. (page 24)

Display (Menu mode)	Purposes
<b>FORMAT &gt;■</b> (Formatting memory)	You can format the built-in flash memory. (page 32)
<b>REGROUP &gt;■</b> (Regrouping data)	You can restore the group function. (page 31)
<b>LED:■□</b> (OPERATION lamp setting)	You can select the blink pattern of the OPERATION lamp. (page 29)
<b>TIMER:■□</b> (Off-timer setting)	Turning off the power after a specified time. (page 30)
<b>[RETURN]■□</b>	You can switch to the normal mode by selecting [RETURN] and pressing the ►■ button.

- It is displayed when the RADIO ON/OFF switch is set to RADIO ON.
- It is displayed when the RADIO ON/OFF switch is set to RADIO OFF.



## What you can do with the MP3 File Manager

You can transfer MP3 audio files easily, using the MP3 File Manager software, to your Portable IC Audio Player in the same format (MP3), unlike the SonicStage software, which converts MP3 audio files into ATRAC3 or ATRAC3plus format.

The MP3 File Manager software is pre-installed on the Portable IC Audio Player at the factory; thereby no installation is necessary.

**However, be sure to install the SonicStage software from the supplied CD-ROM in your computer before using the MP3 File Manager software. The computer will not recognize your Portable IC Audio Player unless you install the SonicStage software (in the supplied CD-ROM) first.** If you use a computer that is not installed with the SonicStage software, you need to install the driver file for your Portable IC Audio Player from the Aiwa customer service website (<http://www.css.ap.aiwa.com/>).

### System requirements

- **OS:** Windows XP Professional  
Windows XP Home Edition  
Windows 2000 Professional  
(Simplified Chinese)
- **CPU:** Pentium II 400MHz or higher
- **RAM:** 64MB or more
- **HDD:** 5MB or more
- **Display:** High (16bit) Color or higher, 800 × 600 dots or better
- **USB port** (Supports USB (Previously called USB1.1))

## Transferring MP3 audio files from the computer to your Portable IC Audio Player

- 1 Connect your Portable IC Audio Player to your computer.

Connect the small connector of the supplied dedicated USB cable into the USB jack on the Portable IC Audio Player, then the large connector to a USB port on your computer.  
“CONNECT” appears in the display.

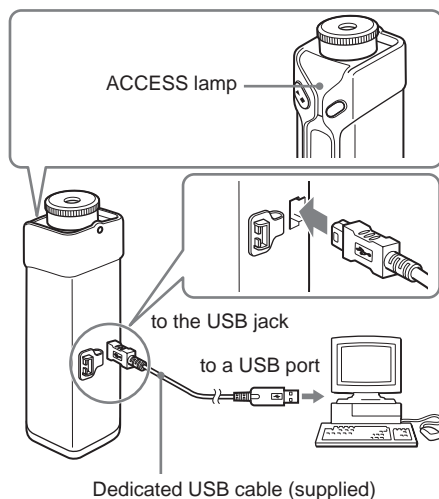

- 2 Click [My Computer]-[removable disk:]\* on your computer.

\* [MEMORY\_P-AUDIO] in the case of Windows XP Professional/  
Windows XP Home Edition

- 3 Click [Esys] folder to open it in the removable disk.

- 4 Double-click [MP3FileManager.exe] to start it.

continued

## Transferring MP3 audio files from the computer to your Portable IC Audio Player (continued)

- 5 Drag the MP3 audio files you want to transfer to your Portable IC Audio Player and drop them to the MP3 File Manager screen.
- You can also transfer MP3 format audio files to your Portable IC Audio Player by dragging a folder.

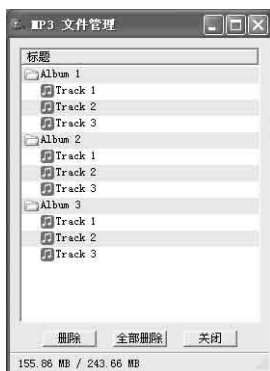

### Notes

- Do not disconnect the USB cable or remove your Portable IC Audio Player when the MP3 File Manager software is running. If you do, operation is not guaranteed.
  - The orange ACCESS lamp blinks while your Portable IC Audio Player accesses the computer.
  - Do not disconnect the USB cable or remove your Portable IC Audio Player when the orange ACCESS lamp is blinking. The data being transferred may be destroyed.
  - Install Service Pack 3 or later when you use Windows 2000.
  - With the Portable IC Audio Player, priority is given to the display of ID3 Tag information. (ID3 Tag is the format that adds music title or artist name information, etc., to an MP3 file. The Portable IC Audio Player supports version 1.0/1.1/2.2/2.3/2.4.)
  - Use of your Portable IC Audio Player with a USB hub or a USB extension cable is not guaranteed. Always connect your Portable IC Audio Player to the computer directly using the dedicated USB cable.
  - Some USB devices connected to the computer may interfere with the proper operation of your Portable IC Audio Player.
  - The control buttons on your Portable IC Audio Player are all disabled while it is connected to a computer.
- You can display the data stored in the built-in flash memory using Windows Explorer when your Portable IC Audio Player is connected to the computer.
  - MP3 audio files compliant with the MP3 File Manager software are created with a sampling frequency rate of 44.1 kHz and bit rate of 8 – 320 kbps.

**If the MP3 File Manager software is accidentally erased by formatting, etc., you can restore it from the supplied CD-ROM by following the procedure below.**

- 1 Connect your Portable IC Audio Player to your computer with the USB cable.
  - 2 Insert the supplied CD-ROM into your computer.
  - 3 Open the CD-ROM, select [MP3FileManager] folder and open it with Windows Explorer.
  - 4 Select the folder ([English], [Korean], [Simplified Chinese]) suitable for your computer's OS and open it with Windows Explorer.
  - 5 Double-click the installation file [MP3FileManager\_1.1\_Update\_ENU.exe], [MP3FileManager\_1.1\_Update\_KOR.exe], [MP3FileManager\_1.1\_Update\_CHN.exe]. Installation starts.  
Follow the instructions of the installation wizard.
- (You can also download the MP3 File Manager software from the Aiwa customer service website  
<http://www.css.ap.aiwa.com/>.)

# Display of MP3 File Manager



**1** Album list  
Double click this to show the included track list. Double click again to hide the track list.

**2** Track list

**3**  (Erase)  
Click this button to erase selected albums or tracks.

**4**  (All erase)  
Click this button to erase all the albums or tracks.

**5**  (Exit)  
Clicks this button to finish the MP3 File Manager.

**6** A selected line turns blue  
You can select several albums or tracks simultaneously using the CTRL key or Shift key.

## Note

Audio files transferred to the built-in flash memory using SonicStage software are not displayed on the MP3 File Manager screen. In addition, audio files transferred to the built-in flash memory using MP3 File Manager software are not displayed on the SonicStage software screen.

# Erasing audio file

You can erase a song stored in the built-in flash memory by track or album using MP3 File Manager.



- 1 Open the MP3 File Manager.
- 2 Select the title you want to erase.
- 3 Click the  (Erase) button in the screen.

## Tip

You can select several albums or tracks simultaneously using CTRL key or Shift key. However, albums and tracks cannot be selected simultaneously.

# Changing the order of audio files

You can move a song stored in the built-in flash memory by track or album using MP3 File Manager.



- 1 Open the MP3 File Manager.
- 2 Select the title you want to move.
- 3 Move it by drag and drop.

## A

A-B Repeat	15
ACCESS lamp	10, 29, 41
Accessories	6
ATRAC3	38
ATRAC3plus	38
Audio CDs	4
AVLS (Limiting the volume)	9, 26

## B

Backlight	28
Battery	5, 7
BEEP (Beep sound)	28
Bit rate	38

## C

CD (Audio CDs)	4
CD-ROM	6, 10
Clock	24, 25
Computer	4, 10, 40

## D

DATE-TIME	25
Display	9, 13, 15, 17, 37
Display mode	17
Download	4

## E

EMD service	4, 11
Explorer (Windows Explorer)	10, 21

## F

Fast-forward	13
Fast-rewind	13
FM	22
FORMAT	32
Formatting	32

## G

Group	13, 18
-------	--------

## H

Headphones	6, 12, 33
HOLD	20
HOLD function (Locking the controls)	20

## L

LED	29
LIGHT	28
Limiting the volume (AVLS)	26
Listening	12
Locking the controls (HOLD function)	20

## M

MENU button	14, 17-20, 22-31
Menu list	40
MP3	4, 10, 38, 39
MP3 File Manager software	41

## O

OpenMG	39
OPERATION lamp	29

## P

PC CLK	24
Play	12
Presetting stations	23

## R

Radio	22
Regroup	31
Remaining battery indication	7
Repeat	14
Repeat count	17
Reset	32
RETURN	40

## S

Sentence Repeat	16
Serial Number	6
Shuffle Repeat	14
Shuttle switch	12 to 20, 22 to 32
Skip to the beginning of a track	13
SonicStage	39
Sound preset (Digital Sound Preset)	19

## T

Time setting	24, 25
Timer	30
Title	17
Track Repeat	15
Transferring	4, 10, 41
Troubleshooting	34

## U

USB cable	6, 10, 41
-----------	-----------

## V

Volume	26
--------	----

## W

WAV format	4
Windows Explorer	10, 21, 42



## 警告

为防止火灾或电击危险，请勿将设备置于雨中或潮湿的地方。

请勿将本系统安放在书橱或壁橱等狭窄封闭处。

请勿使报纸、桌布、窗帘等物品挡住本设备的通风孔，以免造成火灾。另外，请勿将点燃的蜡烛放在本设备上。

请勿将盛满液体的物品（例如花瓶）放在本设备上，以免造成火灾或电击危险。

## 安装注意事项

如果将本装置放置在受静电或电气干扰的地方，则乐曲的传送信息可能会被破坏。这将阻止在电脑上成功传送。

# 用户注意事项

## 附赠的软件

- 版权法禁止全部或部分复制软件或手册，或未经版权所有人许可擅自租赁软件。
- SONY 在任何情形下对因使用随本播放器提供的软件所导致的财务损害、利润损失，包括第三方索赔均不承担任何责任。
- 若因软件制作缺陷导致问题出现，SONY 将予以更换。但 SONY 不承担任何其它责任。
- 随播放器提供的软件不能用于指定设备以外的装置。
- 请记住，由于我们不断提高品质，软件规格如有变更恕不另行通知。
- 使用随机提供的软件以外的其它软件操作本播放器，将不在质量担保之列。

程序 ©2001、2002、2003、2004 Sony 公司  
文件 ©2004 Sony 公司

本手册对如何操作 Portable IC Audio Player（数码声频播放器）和如何使用 MP3 文件管理器（预装软件）进行了说明。有关如何使用 SonicStage（附赠软件）的详情，请参阅 SonicStage 使用说明书。

OpenMG 及其标志是 Sony 公司的商标。

SonicStage 和 SonicStage 标志是 Sony 公司的商标或注册商标。

ATRAC、ATRAC3、ATRAC3plus 及其标志是 Sony 公司的商标。

Microsoft、Windows 和 Windows Media 是微软公司在美国和/或其它国家的商标或注册商标。

所有其它商标和注册商标均分别属于相关所有人。

在本说明书中，所有商标都未标注 ™ 和 ®。



# 目录

概述 .....	4
您可用 Portable IC Audio Player 做什么 .....	4
其它特征 .....	5
步骤 1: 检查包装内容 .....	6
步骤 2: 插入电池 .....	7
确定控制器位置 .....	8
前面 .....	8
背面 .....	8
显示屏 .....	9
<hr/>	
<b>基本操作</b>	
将音频文件从计算机传送到 Portable IC Audio Player .....	10
播放有限播放时间的歌曲 注意事项(超时内容) .....	11
播放有限播放次数的歌曲 注意事项 .....	11
用 Portable IC Audio Player 听音乐 .....	12
什么是组群功能? .....	13
关于其它操作 .....	13
<hr/>	
<b>高级操作</b>	
重复模式 .....	14
选择重复模式 .....	14
重复播放曲目(曲目重复) .....	15
重复播放某一指定部分 (A-B 重复) .....	15
重复播放指定句子 (句子重复) .....	16
设定重复次数 .....	17
更改显示模式 .....	17
选择组群显示模式 .....	18
调节高音与低音 (数字声音预置) .....	19
选择声音质量 .....	19
调节声音质量 .....	19
锁定控制器(HOLD) .....	20
储存非音频数据 .....	21
<hr/>	
<b>使用收音机</b>	
收听收音机 .....	22
预设收音机电台 .....	23

<b>调节 Portable IC Audio Player 设置</b>	
将 Portable IC Audio Player 时间设置调节至计算机内置 时钟 .....	24
调节当前时间设置 (DATE-TIME) .....	25
限制音量(AVLS) .....	26
使用预置音量功能设置音量 .....	26
设置预设模式的音量电平 .....	26
转为手动模式 .....	27
关闭操作音(BEEP) .....	28
改变背景照明设置 .....	28
改变 OPERATION 指示灯的闪烁 设置 .....	29
在一个指定的时间之后 关闭电源(TIMER) .....	30

<b>其它功能</b>	
歌曲重组(REGROUP) .....	31
格式化内存(FORMAT) .....	32

<b>其它信息</b>	
预防措施 .....	33
故障排除 .....	34
播放器复位 .....	34
发生什么故障? .....	34
信息 .....	37
规格 .....	38
术语 .....	39
菜单列表 .....	40

<b>MP3 文件管理器软件操作</b>	
MP3 文件管理器有何作用 .....	41
将 MP3 音频文件从计算机传送到 至 Portable IC Audio Player .....	41
MP3 文件管理器屏幕 .....	43
删除音频文件 .....	44
更改音频文件的排序 .....	44

<b>索引</b> .....	45
-----------------	----

# 概述

## 您可用 Portable IC Audio Player 做什么

首先，您需将“SonicStage”软件安装到您的计算机上（在 Portable IC Audio Player 中已经预装了 MP3 文件管理器软件）。您可轻松地将数码音频文件从计算机传送到内置闪存并随处携带欣赏音乐。

### 1 将数码音频文件 储存至您的计算 机上。

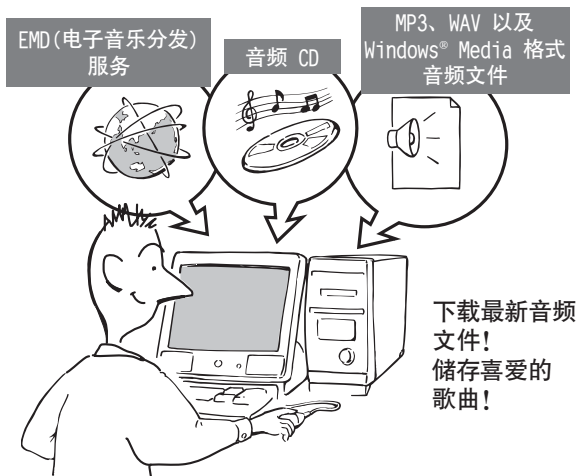

### 2 将文件传送到您的 Portable IC Audio Player。

在将 MP3 格式音频文件传送到 Portable IC Audio Player 时，请使用 MP3 文件管理器软件（预装软件）来进行传送，并将其保存为 MP3 格式音频文件。

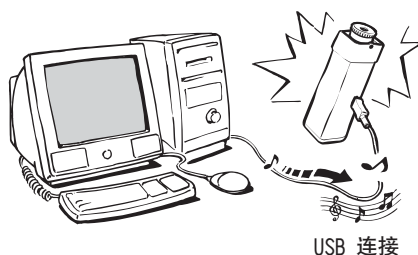

### 3 用 Portable IC Audio Player 欣赏音乐。

当您把 Portable IC Audio Player 连接到计算机时，您可以使用 Windows Explorer 显示保存在内置闪存中的数据。但是，如果在 Windows Explorer 屏幕中直接拖曳或复制 MP3 格式音频文件，则该文件将无法播放。当您把 MP3 格式音频文件传送到您的 Portable IC Audio Player 时，必须使用 MP3 文件管理器软件（参见第 41 页）。



## 其它特征

- 体积小，轻质，防跳操作，非常便于携带。
- 预装 MP3 文件管理器软件可以用来将 MP3 格式音频文件传送到 Portable IC Audio Player，并用 Portable IC Audio Player 将这些音频文件作为 MP3 格式文件收听。
- 用一节电池可持续播放  
XDM-S500/XDM-S700：约 100\*<sup>1</sup> 小时
- 录制时间\*<sup>2</sup>  
XDM-S500：128MB 内置闪存，5 小时 50 分钟以上。  
XDM-S700：256MB 内置闪存，11 小时 40 分钟以上。
- 附赠的 SonicStage 软件使您可运用 ATRAC3plus 格式（高声音品质，高压缩）将歌曲从音频 CD 录至您的计算机硬盘上。
- 句子重复：学习外语非常有用。
- 使用专用的 USB 电缆高速传送数据。
- LCD 屏幕背景：可显示歌曲标题和艺术家名字。
- 组群功能：您可通过选集选择要播放的一组歌曲。
- FM 调频收音机：除了播放音频文件之外您还可收听 FM 广播。
- 定时功能：您可设置您的 Portable IC Audio Player 在一定长的时间后自动关闭。
- 储存功能：您可储存各种数据及音频文件。

\*<sup>1</sup> 视数据格式而有差异。上述情况中，电池持续的小时数是在连续播放 ATRAC3 格式音频文件时的数值。

\*<sup>2</sup> 视录制时的比特而各不相同。此处，可录制时间是以 48 kbps ATRAC3plus 格式录制时的时间。

### 注意事项：

- 录制的音乐仅限个人使用。在此限制之外使用这些音乐需事先获得版权所有者的允许。
- 因 Portable IC Audio Player 或计算机出现问题而导致的录制/下载不全或数据损坏，Sony 不承担责任。

# 步骤 1：检查包装内容

请检查包装内的附件。

XDM-S500/S700:

- Portable IC Audio Player (1)
- 耳机 (1)

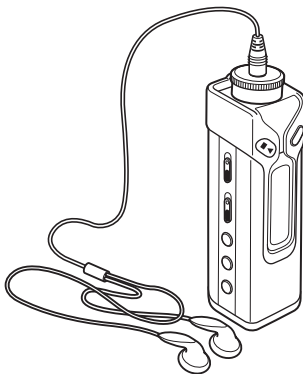

- 便携袋 (1)
- 颈带 (1)
- 耳机延长线 (1)
- CD-ROM (1)
- 使用说明书 (1)
- SonicStage 使用说明书 (1)
- 保修卡 (1)

- 专用 USB 电缆 (1)

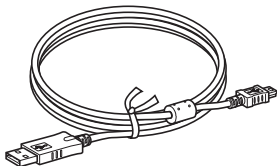

# 步骤 2：插入电池

正确插入一节 LR6（尺寸 AA）碱性电池。如图所示，务必从 ● 侧插入。把电池舱盖往前推，直至完全扣住。

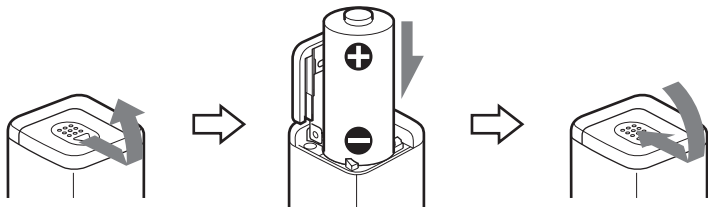

## 电池使用时间\*

ATRAC3 格式：约 100 小时

ATRAC3plus 格式：约 90 小时

MP3 格式：约 80 小时

FM 收音机接收：约 40 小时

\* 由于使用情况和环境温度，电池寿命可能会缩短。

## 关于电池剩余电量指示

显示屏上的电池图标如下改变。



如果电池舱盖意外脱落，请如图所示连接。

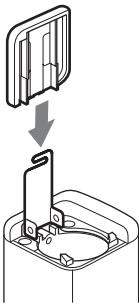

如果显示屏上出现“LOW BATT”，您需要更换电池。

## 注意事项

- 如果放入电池后播放器仍未能开机，请稍作等待后放入电池重试。
- 如果电池使用不正确，会因泄漏和腐蚀而损坏。为了达到最好效果，请：
  - 使用碱性电池。
  - 保证极性正确。
  - 不要对干电池充电。
  - 如果一段时间不使用您的播放器，请取出电池。
  - 如果电池发生泄漏，请先清洁电池舱，然后再插入新电池。

# 确定控制器位置

有关各部件的详细说明，请参阅各括号内的页码。

## 前面

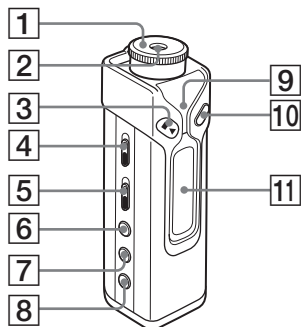

- 1** 往复开关 (◀◀/▶▶, VOL(音量))  
(第 12-20, 22-32 页)
- 2** 耳机插孔 (第 12 页)
- 3** ▶■ 按钮 (第 12, 14-20, 22-32 页)
- 4** HOLD (锁定控制) 开关 (第 20 页)
- 5** RADIO ON/OFF 开关 (第 12-14, 17-18, 22-23, 30 页)
- 6** SOUND 按钮 (第 19 页)
- 7** GROUP/TUNE MODE 按钮 (第 13, 18, 23 页)

## 背面

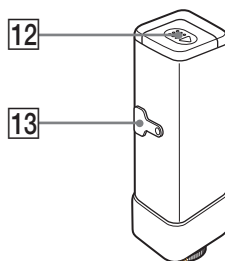

- 8** REPEAT 按钮 (第 15-16 页)
- 9** ACCESS 指示灯 (第 10、41 页)  
闪烁橘色。  
OPERATION 指示灯 (第 29 页)  
绿色闪烁或灯亮。
- 10** MENU 按钮 (第 14, 17-20, 22-32 页)
- 11** 显示屏 (第 9, 13, 15, 17 页)  
显示屏和图标的详细说明请参阅第 9 页。
- 12** 电池舱 (第 7 页)
- 13** USB 插孔 (第 10, 41 页)

## 显示屏

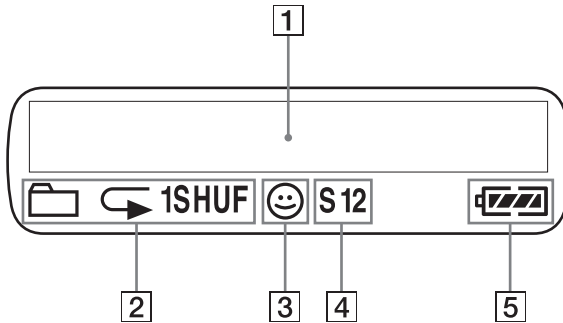

- 1** 文字/图像信息显示（第 15 页）  
显示曲目号码、曲目名称、当前日期和时间（第 17-25 页），信息（第 11, 37 页）以及菜单。  
按 MENU 按钮切换显示模式。详细信息，请参阅第 17 页“更改显示模式”。
- 2** 重复模式指示（第 14 页）  
显示当前重复模式。
- 3** AVLS 指示（第 26 页）  
当 AVLS 功能启动时，该指示亮起。
- 4** 数字声音预置显示（第 19-20 页）  
显示当前声音设置。
- 5** 剩余电量指示（第 7 页）  
显示电池的剩余电量。

# 将音频文件从计算机传送到 Portable IC Audio Player

### 注意事项

在首次将您的 Portable IC Audio Player 与计算机连接时，请确保将附赠的 CD-ROM 中的“SonicStage”软件安装到计算机。即使已经安装 SonicStage 软件，您仍需在将您的 Portable IC Audio Player 与计算机连接之前安装随本 Portable IC Audio Player 提供的 SonicStage 软件（可能有升级程序）。

使用安装好的 SonicStage 软件，您能够将 ATRAC3、ATRAC3plus 格式的音频文件从计算机传送到您的 Portable IC Audio Player。请按照以下步骤。

使用 Portable IC Audio Player 里预装的 MP3 文件管理器，您也能够传送 MP3 格式的音频文件。详细说明，请参阅第 41 页的“MP3 文件管理器软件操作”。

### 1 使用附赠的 CD-ROM 将 SonicStage 软件安装至您的计算机。

只有在首次将 Portable IC Audio Player 连接到计算机时才需要操作步骤 1。

详细说明，请参阅 SonicStage 使用说明书。

### 2 将音频文件导入 SonicStage 软件。

详细说明，请参阅“SonicStage 使用说明书”。

### 3 将您的 Portable IC Audio Player 与计算机连接。

将专用 USB 电缆上的小的连接头接入 Portable IC Audio Player 上的 USB 插孔，然后将大的连接头接到您计算机的 USB 端口。

显示屏上出现“CONNECT”。

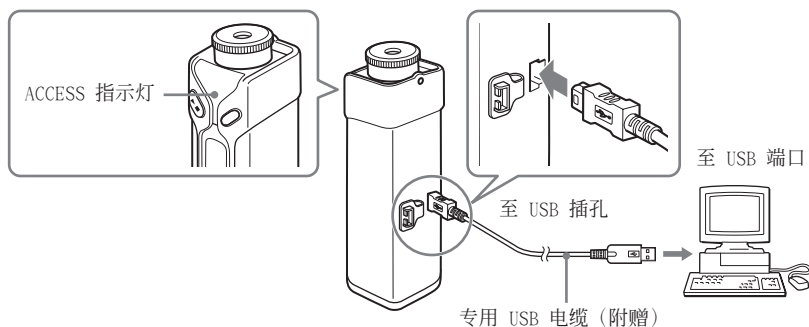

### 注意事项

- 当您的 Portable IC Audio Player 接入计算机时，ACCESS 指示灯闪烁橘色。
- 请勿在 ACCESS 指示灯闪烁橘色时将 USB 电缆断开连接，否则传送中的数据会被破坏。
- 用 USB 集线器或 USB 加长电缆使用您的 Portable IC Audio Player 不在担保之列。请仅使用专用的 USB 电缆将您的 Portable IC Audio Player 直接与计算机连接。
- 某些连接至计算机的 USB 装置可能会干扰您的 Portable IC Audio Player 的正确操作。
- 当与计算机连接时，您的 Portable IC Audio Player 上的控制按钮都将无效。
- 当 Portable IC Audio Player 与计算机连接时，您可使用 Windows Explorer 显示储存在内置闪存上的数据。



---

## 4 将音频文件传送到您的 Portable IC Audio Player。

有关将音频文件传送到内置闪存的信息，请参阅“SonicStage 使用说明书”。

---

### 提示

有关将音频文件传送回计算机的详细信息，请参阅“SonicStage 使用说明书”或 SonicStage 软件的在线帮助。

## 播放有限播放时间的歌曲注意事项(超时内容)

有些通过互联网（EMD 服务）发布的歌曲有播放时间限定。

若您试图播放过期歌曲，“EXPIRED”将闪烁，短暂停顿之后将播放下一首歌曲。

此外，过期歌曲不能用 SonicStage 软件播放或传送到您的 Portable IC Audio Player。必要时删除这些歌曲。

## 播放有限播放次数的歌曲注意事项

您的 Portable IC Audio Player 不支持有限播放次数的内容。

若您试图播放有限播放次数的歌曲时，将显示“EXPIRED”，歌曲不能被播放。

# 用 Portable IC Audio Player 听音乐

使用前请先插入电池（参阅第 7 页）。

## 注意事项

确保您在使用 Portable IC Audio Player 时已将其从计算机上断开连接。

### 1 连接耳机。

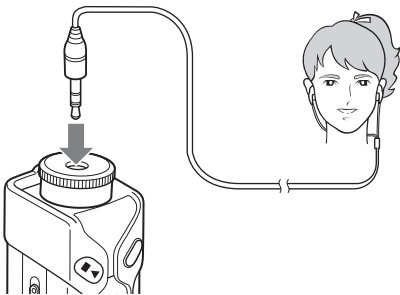

### 使用耳机延长线

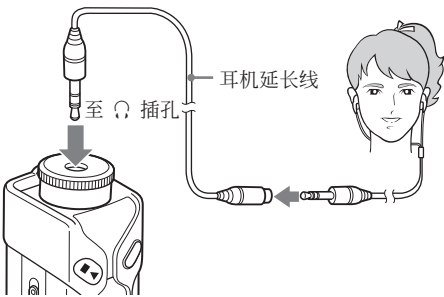

### 2 关闭收音机。

往 RADIO OFF 方向滑动 RADIO ON/OFF 开关。

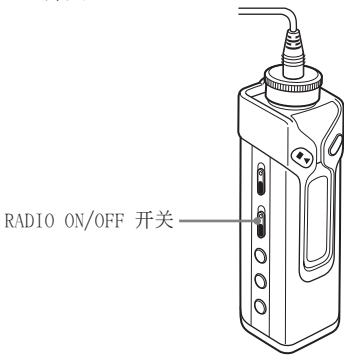

### 若播放未开始

请确认 HOLD 开关设置为关闭（第 20 页）。

### 停止播放

按 ►■ 按钮。

### 调节音量

可在 PRESET 以及 MANUAL 模式下对音量进行设置（第 26-27 页）。

### 3 开始播放。

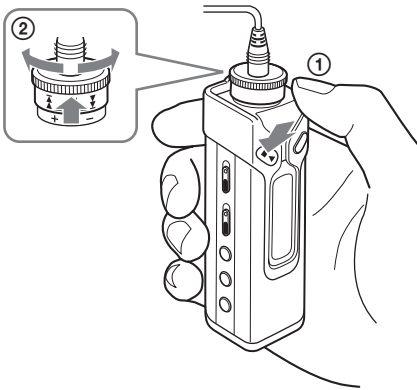

- ① 按 ►■ 按钮。
- ② 拉出并转动往复开关以调节音量。

### 提示

若在停止模式下 5 秒钟内未操作 Portable IC Audio Player，显示屏自动关闭。

当滚动显示曲目标题等时，显示屏在滚动显示结束后关闭。

当选择正常播放模式时，最后一首歌曲结束后播放自动停止。

## 什么是组群功能？

组群功能使您能方便地在 Portable IC Audio Player 上选取喜爱的歌曲。您可使用组群功能采用专辑或艺术家分类来传送音频文件或播放歌曲。

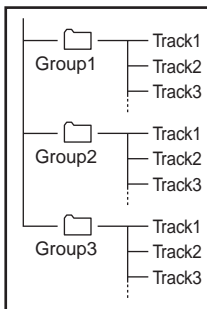

- 曲目编号是歌曲在各组群的顺序。
- 您可通过按 GROUP/TUNE MODE 按钮在曲目名称模式和组群模式之间切换。
- 在组群模式中，显示的是组群名称而非曲目名称。此外，任何切换操作，如跳跃或重复，都将按组群运行。

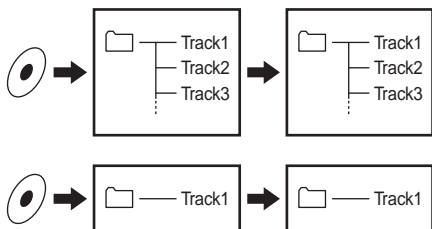

### 按组群传送

已传送到 SonicStage 软件的音频文件传送到内置闪存时总是进行分组。

### 💡 提示

在您的 Portable IC Audio Player 中，SonicStage 软件创建的组比 MP3 文件管理器软件创建的组享有优先权。

## 关于其它操作

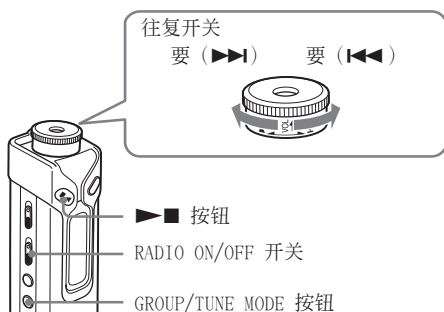

### 💡 提示

在 RADIO ON/OFF 开关设置为 RADIO OFF 时，您可通过按 GROUP/TUNE MODE 按钮切换到组群模式。

要	往复开关操作
跳到下一曲目/组群开始处* <sup>1</sup>	顺时针转动往复开关一次 (▶▶)。
跳到当前曲目/组群开始处* <sup>1</sup>	逆时针转动往复开关一次 (◀◀)。
快进 * <sup>2</sup>	顺时针转动往复开关 (▶▶) 并握住。
快退 * <sup>2</sup>	逆时针转动往复开关 (◀◀) 并握住。

\*<sup>1</sup> 在停止模式下转动并握住往复开关，可使您连续跳到下一（当前和上一）曲目/组群的开始处。

\*<sup>2</sup> 快进或快退持续 5 秒后，其速度会加快。

# 重复模式

有三种重复模式：曲目重复、A-B 重复和句子重复。

- 曲目重复 (TRK Rep)  
此模式以下列五种方式播放曲目。

曲目重复模式	操作
全部重复	重复全部曲目
单曲重复	重复当前曲目
组群重复	重复当前组群
组群随机重复	以随机顺序重复当前组群
所有组群随机重复	以随机顺序重复全部组群

- A-B 重复 (A-B Rep)  
此模式重复播放一首曲目中的某一指定部分。
- 句子重复 (SENTENCE Rep)  
此模式反复播放曲目中一个指定部分中的声音数据。

## 选择重复模式

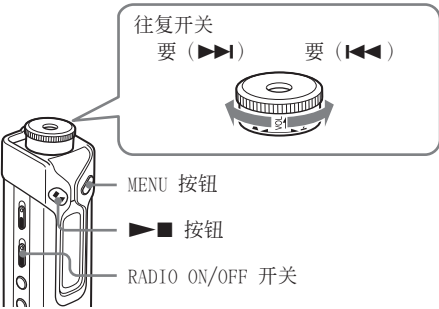

- 1 关闭收音机。  
往 RADIO OFF 方向滑动 RADIO ON/OFF 开关。

- 2 在停止模式中，按 MENU 按钮。  
显示菜单屏幕。



- 3 转动往复开关选择“REPEAT MODE >”，并按 ▶■ 按钮确认。

- 4 转动往复开关选择需要的重复模式，并按 ▶■ 按钮确认。



您可以在“TRK Rep”、“A-B Rep”和“SENTENCE Rep”中选择一种模式。

- 5 按 MENU 按钮。  
显示屏返回正常屏幕。  
参考以下内容，您可以操作每一个您选择的重复模式。
  - TRK Rep：参阅“重复播放曲目（曲目重复）”。
  - A-B Rep：参阅“重复播放某一指定部分（A-B 重复）”。
  - SENTENCE Rep：参阅“重复播放指定句子（句子重复）”。

## 取消菜单模式

选择菜单屏幕中的 [RETURN] 或按下 MENU 按钮。

### 注意事项

- 若您持续 60 秒未操作任何按钮，显示屏将自动返回到正常播放屏幕。
- 当内置闪存中没有音频文件时，您将无法设置任何重复模式。
- 当您把 Portable IC Audio Player 连接至计算机时，已选择的模式将被取消。
- 您只能在停止模式中选择重复模式。

# 重复播放曲目(曲目重复)

按 REPEAT 按钮可以改变曲目重复模式。您可以通过显示屏上的图标来查看当前曲目重复模式。

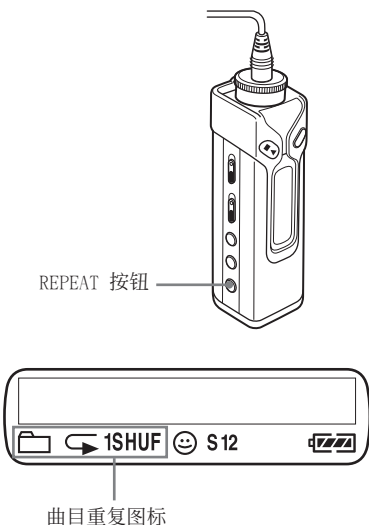

首先选择曲目重复模式(TRK Rep)(第 14 页)。  
然后, 重复按 REPEAT 按钮来选择您需要的曲目重复模式。

每按一次, 曲目重复图标如下改变:

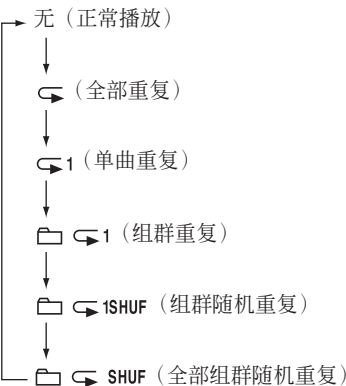

# 重复播放某一指定部分(A-B 重复)

当播放一首曲目时, 您可以通过设置开始点(A)和结束点(B)来重复播放您需要的某一部分。

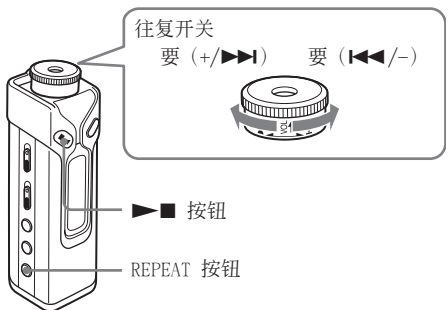

1 选择 A-B 重复模式 (A-B Rep) (第 14 页)。

2 按 ▶■ 按钮开始播放。

3 播放中按 REPEAT 按钮来设置开始点(A)。  
“B” 闪烁。

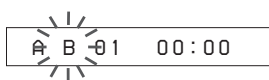

4 按 REPEAT 按钮来设置结束点(B)。  
显示屏上出现 “A B”, 指定的部分将重复播放。

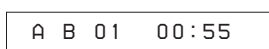

## 注意事项

- 您无法跨越两首或两首以上曲目设置 A-B 重复。
- 若您没有设置结束点 (B), 结束点将自动设置为曲目的终点。
- 处于组群模式或显示当前时间时, 您无法使用 A-B 模式。

重复模式 (续)

💡 提示

- 设置完开始点 (A) 后，您可以通过转动往复开关来快进或快退。若在快进时曲目到达终点，则终点将被设置为点 (B)，并继续快进。当松开往复开关时，A-B 重复开始。  
若在快退时曲目到达起点，则将跳回到该曲目终点，终点将被设置为点 (B)，并继续快退。
- 在 A-B 重复播放时，您可以通过转动往复开关来快进或快退。若快进或快退时，曲目到达起点/终点，则播放停止 (进入等待)。当松开往复开关时，A-B 重复将重新开始。

若要清除开始点 (A) 和结束点 (B)

- 在 A-B 重复播放过程中按 REPEAT 按钮。
- 在 A-B 重复播放过程中按 MENU 按钮。
- 在 A-B 重复播放过程中按 GROUP/TUNE MODE 按钮选择组群模式。
- 在 A-B 重复播放过程中转动往复开关选择前一曲目或下一曲目。

若要取消 A-B 重复模式

改变菜单屏幕中的重复模式 (第 14 页)。

重复播放指定句子 (句子重复)

此功能只从设置点开始自动检测声音数据，并根据设置次数重复声音数据。这对于学习外语非常有用。

💡 提示

默认的重复次数设置为一句两次。您可以改变重复次数设置。详细说明，请参阅第 17 页的“设置重复次数”。

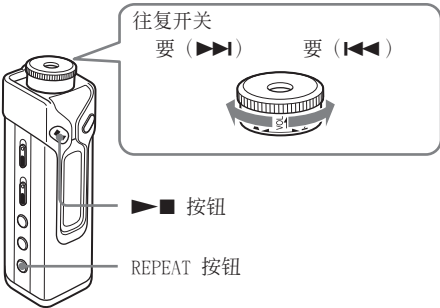

- 1 选择句子重复模式 (SENTENCE Rep) (第 14 页)。
- 2 按 ▶■ 按钮开始播放。
- 3 在播放过程中按 REPEAT 按钮放置设置点。

Portable IC Audio Player 从该设置点开始检测说话的部分和无说话的部分，并开始句子重复。(说话部分重复一次 (在检测中)，此设置被计算一次。)



注意事项

- 在组群模式中或显示当前时间时无法使用句子重复功能。
- 无法检测少于 1 秒钟的说话部分和无说话部分。
- 如果直至结束都未检测到无说话部分，则曲目的结束点将视作无说话部分，句子重复将从上一个说话部分开始。

若要清除设置点

- 在句子重复播放过程中按 REPEAT 按钮。
- 在句子重复播放过程中按 MENU 按钮。
- 在句子重复播放过程中按 GROUP/TUNE MODE 按钮选择组群模式。
- 在句子重复播放过程中转动往复开关选择前一曲目或下一曲目。

若要取消句子重复模式

改变菜单屏幕中的重复模式 (第 14 页)。

# 设定重复次数

您可以设定句子重复模式一句句子的重复次数（1-9）。

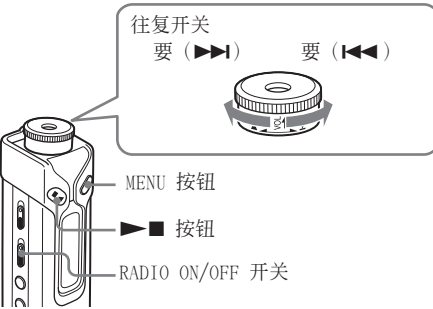

- 1 关闭收音机。  
往 RADIO OFF 方向滑动 RADIO ON/OFF 开关。
- 2 按 MENU 按钮。  
显示菜单屏幕。  

 REPEATMODE>
- 3 转动往复开关选择“REPEAT MODE >”，并按 按钮确认。
- 4 转动往复开关选择“SENTENCE Rep”，并按 按钮确认。  
“COUNT:”显示在屏幕上。  

 COUNT: 2
- 5 转动往复开关选择需要的重复次数，并按 按钮确认。
- 6 按 MENU 按钮。  
显示屏返回正常屏幕。

## 取消菜单模式

选择菜单屏幕中的 [RETURN] 或按 MENU 按钮。

# 更改显示模式

当音乐被播放或停止时，您可看到显示屏上的诸如曲目编号或标题等信息。可在菜单模式中操作往复开关来更改显示模式。

- Lap Time：已耗时间显示模式  
在一首音乐标题和艺术家名字显示之后，将出现如下显示。

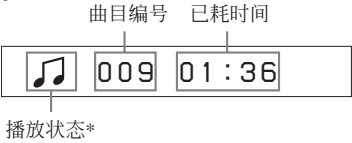

- \* 播放：交替显示 和 。
- 停止：显示 。
- 搜索曲目：显示 或 。
- 快进/快退：显示 或 。
- Title：标题显示模式  
当音乐标题包含 12 个以上字符时，标题将自动滚动显示。



- Track info：曲目信息显示模式  
将显示曲目标题、CODEC、比特率。当信息包含 12 个以上字符时将自动滚动显示。

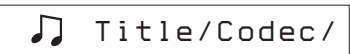

当搜索、快进、或快退曲目时，将显示当前播放位置。

高级操作

更改显示模式 (续)

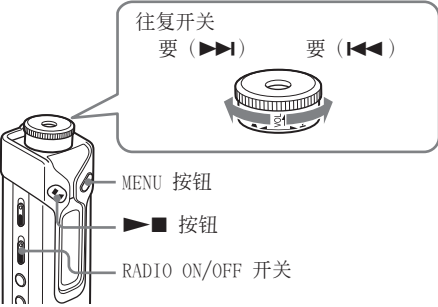

1 关闭收音机。  
往 RADIO OFF 方向滑动 RADIO ON/OFF 开关。

2 按 MENU 按钮。  
显示菜单屏幕。



3 转动往复开关选择“DISPLAY >”，  
并按 ▶■ 按钮确认。  
被选择的显示模式闪烁。



4 转动往复开关选择所需的显示模式，  
并按 ▶■ 按钮确认。  
显示切换到选中的显示模式。



5 按 MENU 按钮。  
显示屏返回正常屏幕。

取消菜单模式

选择菜单屏幕上的 [RETURN] 或按 MENU 按钮。

注意事项

若您持续 60 秒未按任何按钮，显示屏将自动返回到正常播放屏幕。

选择组群显示模式

在 RADIO ON/OFF 开关设置为 RADIO OFF 时的任何菜单模式下，您可通过按 GROUP/TUNE MODE 按钮选择组群显示。

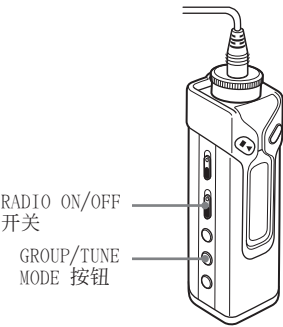

若要取消组群模式

在组群模式屏幕中按 GROUP/TUNE MODE 按钮。

提示

在组群模式时背景照明为绿色，而不在组群模式时背景照明为蓝色（如果背景照明被设置为“ON”（参见第 28 页））。

注意事项

如果持续 30 秒钟未操作任何按钮，显示屏将自动返回正常播放屏幕。



# 调节高音与低音(数字声音预置)

您可调节高音与低音。您可预置两种可在播放中选择的设置。

## 选择声音质量

### 默认设置

声音质量	SOUND 1 (S1)	SOUND 2 (S2)	SOUND OFF (普通声音)
低音	+1	+3	±0
高音	±0	±0	±0

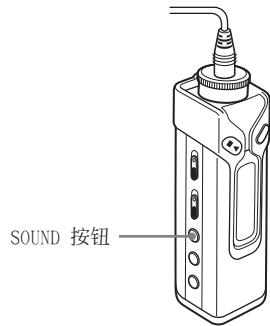

### 反复按 SOUND 按钮

声音质量设置如下改变：

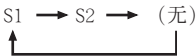

### 返回普通声音质量

选择“SOUND OFF”。

## 调节声音质量

您可调节低音和高音部分的声音质量。

声音质量	增强电平
低音	-4 至 +3
高音	-4 至 +3

您可将想要的声音质量设置预设为“Sound 1”和“Sound 2”。播放音乐时，您可指定其中一种预置声音质量。

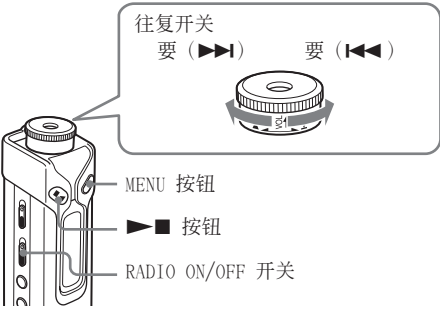

- 1 关闭收音机。  
往 RADIO OFF 方向滑动 RADIO ON/OFF 开关。





- 2 按 MENU 按钮。  
显示菜单屏幕。

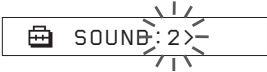

- 3 转动往复开关选择“SOUND >”，并按 ▶■ 按钮确认。

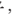
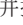

4 设定“SOUND 1”的音调。

- ① 转动往复开关选择“SOUND 1>”，并按   按钮确认。
- ② 出现“BASS:+1”，转动往复开关调节低音的增强电平，并按   按钮确认。
- ③ 出现“TREBLE:0”，转动往复开关调节高音的增强电平，并按   按钮确认。

5 按 MENU 按钮。

显示屏返回正常屏幕。

调节“SOUND 2”设置

在步骤 4 选择“SOUND 2”。

取消菜单模式

选择菜单屏幕上的 [RETURN] 或按 MENU 按钮。

注意事项

当 RADIO ON/OFF 开关设置为 RADIO ON 时，不能使用此功能。

锁定控制器(HOLD)

您可在携带 Portable IC Audio Player 时应用 HOLD 功能保护机器不被意外操作。

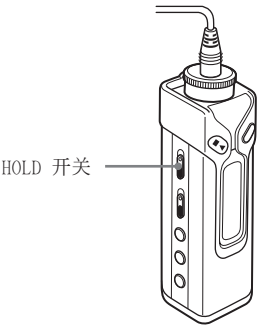

按箭头方向滑动 HOLD 开关。

除 RADIO ON/OFF 开关之外的所有操作按钮和开关都将无效。

若您在 HOLD 功能打开时试图操作按钮和开关，“HOLD”在显示屏上闪烁。

取消 HOLD 功能

按箭头相反方向滑动 HOLD 开关。

注意事项

当 HOLD 功能打开时只有 RADIO ON/OFF 开关可以操作。

# 储存非音频数据

您可应用 Windows Explorer 将计算机硬盘上的数据传送到内置闪存。

内置闪存将作为外部驱动器（如：作为 D 盘驱动器）显示在 Windows Explorer 上。

## 注意事项

- 您不能在操作 Portable IC Audio Player 的数据储存功能时，操作 SonicStage 软件来使用保存在内置闪存上的文件。当您试图同时进行上述两项操作时，将显示“Cannot access the Device/media”出错信息。
- 如果将大量的非音频数据储存在内置闪存中，则音频数据的使用空间将减少相同的容量。

## 收听收音机

您可以收听 FM 广播。

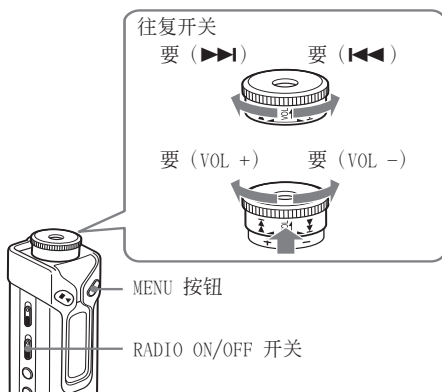

- 1 设置 RADIO ON/OFF 开关为 RADIO ON 打开收音机。

FM 87.50MHz

- 2 按 GROUP/TUNE MODE 按钮选择手动调谐模式（参见下面提示）。
- 3 顺时针（▶▶）或逆时针（◀◀）转动往复开关并握住。  
播放器开始扫描频率并在发现一个可接收的电台时停止。如果您反复转动往复开关，则频率逐步改变。

### 关闭收音机

设置 RADIO ON/OFF 开关为 RADIO OFF。

### 如果难以听清 FM 广播

如果 FM 广播有噪声，切换至单声道接收模式。

- 1 往 RADIO ON 方向滑动 RADIO ON/OFF 开关，打开收音机。
- 2 按 MENU 按钮。  
显示“FM SOUND”。
- 3 按 ▶■ 按钮。
- 4 转动往复开关选择“FM SOUND: MONO”。
- 5 按 ▶■ 按钮确认。

### 要更改设置为“STEREO”

在步骤 4 选择“FM SOUND: STEREO”。

### 调节音量

拉出并转动往复开关。

### 改善广播接收

耳机线的功能相当于 FM 天线。延长耳机线以改善接收。

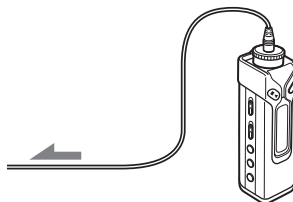

### 提示

有两种模式可以调电台：手动调谐模式和预置调谐模式。

在手动调谐模式下，您可以如上面步骤 3 次变频率进行调谐。

在预置调谐模式下，您可以通过改变预设号进行调谐（参见第 23 页）。

要在手动调谐模式和预置调谐模式间切换，请按 GROUP/TUNE MODE 按钮。只有在预置调谐模式下，预设号才会在显示屏的右边显示。手动调谐模式时背景照明为蓝色，而在预置调谐模式时背景照明为绿色（如果背景照明被设置为“ON”（参见第 28 页））。

# 预设收音机电台

您可以预设最多 30 个 FM 广播电台。

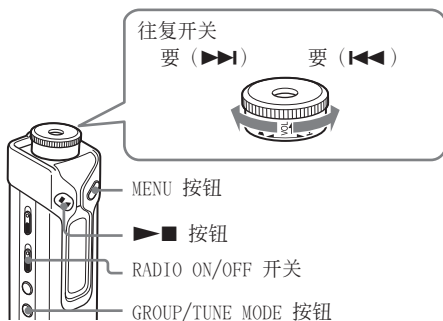

## 自动预置电台 (自动预置)

- 1 打开收音机。  
往 RADIO ON 方向滑动 RADIO ON/OFF 开关。
- 2 按 MENU 按钮。
- 3 转动往复开关选择“FM AUTO PRESET”，并按 ▶■ 按钮确认。
- 4 转动往复开关选择“FM RUN”。
- 5 按 ▶■ 按钮。  
播放器从较低的频率开始扫描电台。

FM 87.50MHz



第一个接收的电台被预设 在预设号 1 上，  
然后播放器开始扫描下一个可接收的电台。

如果您在自动预置中按 ▶■ 按钮，播放器停止扫描并退出自动预置模式。

## 手动预置电台 (手动预置)

如果有的电台不能被自动预置，您可以按照下列步骤手动预置。

在开始前，您必须退出预置模式（不应显示预置号码）。

- 1 在手动调谐模式中调谐您想要预置的电台（参见第 22 页的提示）。
- 2 按下并按住 ▶■ 按钮 2 秒以上。  
预设号在显示屏上闪烁。
- 3 在 30 秒内，转动往复开关选择您想要储存起来的电台的预设号。  
选择的预设号开始闪烁。
- 4 按 ▶■ 按钮。

## 收听预置电台

- 1 打开收音机。  
往 RADIO ON 方向滑动 RADIO ON/OFF 开关。
- 2 按 GROUP/TUNE MODE 按钮选择预置调谐模式（参见第 22 页的提示）。  
预设号出现在显示屏的右边。
- 3 转动往复开关选择您想要收听的电台的预设号。

# 将 Portable IC Audio Player 时间设置调节 至计算机内置时钟

若此功能设置为“ON”，当 Portable IC Audio Player 连接到计算机并进行音频文件传送时（必须启动 SonicStage 软件），Portable IC Audio Player 的时间设置将自动调节为计算机的内置时钟。“ON”为默认选择。

Portable IC Audio Player 不能在没有时间设置的状态下播放有限定播放时间的歌曲。请确信时间设置已调节。

要设置 Portable IC Audio Player 的日期和时间，请参阅第 25 页上的“调节当前时间设置（DATE-TIME）”。

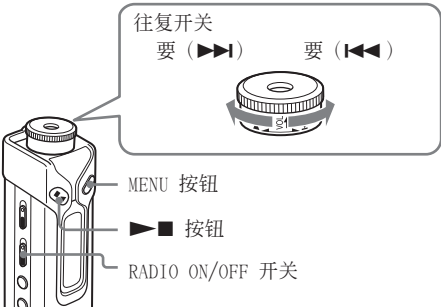

## 将设置更改为“OFF”

即使在 Portable IC Audio Player 与计算机处于连接状态时，您的 Portable IC Audio Player 上的时间设置也不会改变。

- 1 关闭收音机。  
往 RADIO OFF 方向滑动 RADIO ON/OFF 开关。

- 2 按 MENU 按钮。  
显示菜单屏幕。



- 3 转动往复开关选择“PC CLK:”，并按 ▶■ 按钮确认。



- 4 转动往复开关选择“OFF”，并按 ▶■ 按钮确认。

- 5 按 MENU 按钮。  
显示屏返回正常屏幕。

## 将设置更改为“ON”

在步骤 4 选择“ON”。

## 取消菜单模式

选择菜单屏幕上的 [RETURN] 或按 MENU 按钮。

# 调节当前时间设置 (DATE-TIME)

您可设置和显示当前时间。

您也可通过将 Portable IC Audio Player 与计算机连接，将 Portable IC Audio Player 的时间设置调节为计算机的内置时钟（第 24 页）。

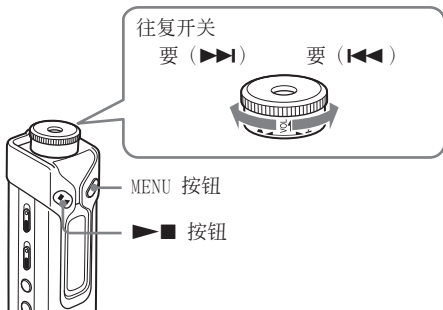

- 1 按 MENU 按钮。  
显示菜单屏幕。



- 2 转动往复开关选择“DATE-TIME”，并按 ▶■ 按钮确认。  
“年份”数字闪烁。

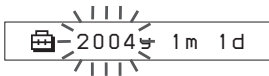

- 3 转动往复开关调节“年份”设置，并按 ▶■ 按钮确认。  
“月份”数字闪烁。

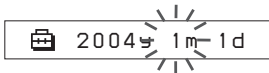

- 4 依步骤 3 相同方法调节“月份”和“日期”的设置。

在转动往复开关调节好“日期”设置并按 ▶■ 按钮确认后，显示屏转为时间设置屏幕。

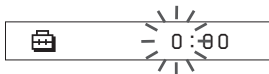

- 5 转动往复开关调节“小时”设置，并按 ▶■ 按钮确认。  
“分钟”数字闪烁。



- 6 依步骤 5 相同方法调节“分钟”设置。在转动往复开关调节好“分钟”设置并按 ▶■ 按钮确认后，显示屏转为时间设置屏幕。



- 7 按 MENU 按钮。  
显示屏返回正常屏幕。

## 取消菜单模式

选择菜单屏幕上的 [RETURN] 或按 MENU 按钮。

## 显示当前时间

按下并按住 MENU 按钮。

在按住该按钮时可显示当前时间。

您若设置了定时功能（第 30 页），预置时间将在当前时间之前显示。

## 注意事项

- 若机器长时间不用，日期和时间设置可能要复位。
- 若未设置当前时间，日期和时间显示为“---”。
- 若 PC CLK 设置为“ON”（第 24 页），则当 Portable IC Audio Player 在与计算机连接时，其时间设置自动调节为计算机的内置时钟。
- 视发运地区而定，本装置的时间显示格式设定为 12 小时制或 24 小时制。  
在本装置中不能进行 12 小时制和 24 小时制显示的切换。  
在本手册中以 24 小时显示为例。

# 限制音量 (AVLS)

您可通过设置 AVLS（自动音量限制系统）来限制最大音量，以防止听觉干扰或分心。通过 AVLS，您可在舒适的音量电平上欣赏音乐。

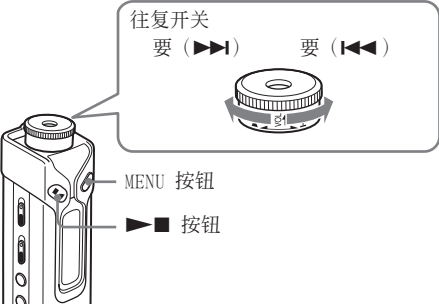

- 1 按 MENU 按钮。  
显示菜单屏幕。  

- 2 转动往复开关选择“AVLS”，并按  
▶■ 按钮确认。  
“OFF” 闪烁。  

- 3 转动往复开关选择“ON”，并按  
▶■ 按钮确认。  
将显示 😊 (AVLS) 指示。音量保持中等电平。
- 4 按 MENU 按钮。

将设置更改为“OFF”  
在步骤 3 中选择“OFF”。

取消菜单模式  
选择菜单屏幕上的 [RETURN] 或按 MENU 按钮。

# 使用预置音量功能设置音量

有两种调节音量的模式。

手动模式：拉出并转动往复开关，在 0-31 范围内调节音量电平。

预置模式：转动往复开关，将音量电平设置为以下三种预置电平的任一种：LO，MID 或 HI。

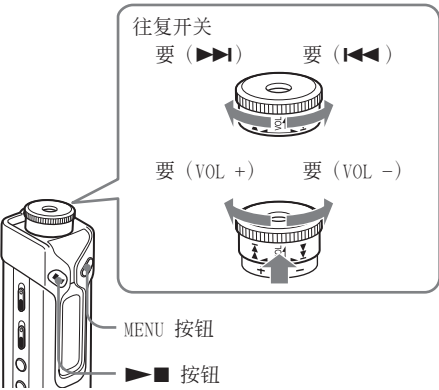

## 设置预设模式的音量电平

- 1 按 MENU 按钮。  
显示菜单屏幕。  

- 2 转动往复开关选择“VOL：MAN”。
- 3 按 ▶■ 按钮确认。  
“MAN” 闪烁。



4 转动往复开关选择“SET >”。



5 按 按钮确认。

“VOL LO xx” \* 闪烁。

\* “xx” 代表音量电平の数値。



6 三种预置电平的音量电平设置：LO，MID或 HI。

- ① 拉出并转动往复开关，设置 LO 预置音量电平。
- ② 返回往复开关到初始位置并转动往复开关选择“VOL MID xx”，然后拉出并转动往复开关，设置 MID 预置音量电平。
- ③ 返回往复开关到初始位置并转动往复开关选择“VOL HI xx”，然后拉出并转动往复开关，设置 HI 预置音量电平。

7 按 按钮确认。

8 按 MENU 按钮。

显示屏返回正常屏幕。

通过这些设置，您可调节音量电平至以下三种预置电平的任一种：LO，MID 或 HI。

## 取消菜单模式

选择菜单屏幕上的 [RETURN] 或按 MENU 按钮。

### 注意事项

若 AVLS (第 26 页) 已设置，实际音量可能低于该设置。

## 转为手动模式

1 按 MENU 按钮。  
显示屏菜单屏幕。

2 转动往复开关选择“VOL:SET”。



3 按 按钮确认。  
“SET >” 闪烁。

4 转动往复开关选择“MAN”。



5 按 按钮确认。

6 按 MENU 按钮。  
显示屏返回正常屏幕。  
通过该设置，您可转动往复开关来调节音量电平。

# 关闭操作音 (BEEP)

您可关闭 Portable IC Audio Player 的操作音。

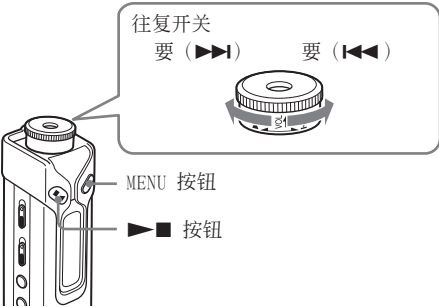

- 1 按 MENU 按钮。  
显示菜单屏幕。



- 2 转动往复开关选择“BEEP:”，并按  
▶■ 按钮确认。  
“ON”闪烁。



- 3 转动往复开关选择“OFF”，并按  
▶■ 按钮确认。



- 4 按 MENU 按钮。  
显示屏返回正常屏幕。

## 将设置改变为“ON”

在步骤 3 选择“ON”。

### 取消菜单模式

选择菜单屏幕上的 [RETURN] 或按 MENU 按钮。

# 改变背景照明设置

您可选择 ON 或 OFF。

菜单	背景照明模式
OFF	总是关闭
ON	每次操作后 开启 3 秒钟 (或直到滚动显示完成)

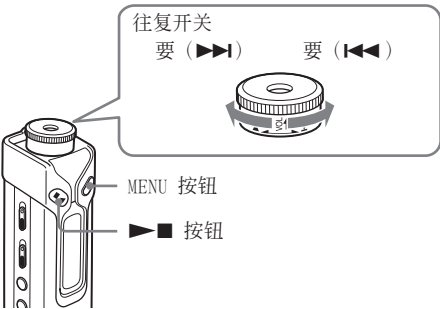

## 设置为“ON”

- 1 按 MENU 按钮。  
显示菜单屏幕。



- 2 转动往复开关选择“LIGHT:”，并按  
▶■ 按钮确认。  
“OFF”闪烁。

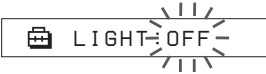

- 3 转动往复开关选择“ON”，并按  
▶■ 按钮确认。



- 4 按 MENU 按钮。  
显示屏返回正常屏幕。

## 将设置改变为“OFF”

在步骤 3 选择“LIGHT: OFF”。

### 取消菜单模式

选择菜单屏幕上的 [RETURN] 或按 MENU 按钮。

# 改变 OPERATION 指示灯的闪烁设置

根据不同的操作 OPERATION 指示灯会闪烁绿色或亮蓝灯。

您可从设置的三种方式中选择或选择 OFF。

您若设置为“OFF”，OPERATION 指示灯将始终关闭。

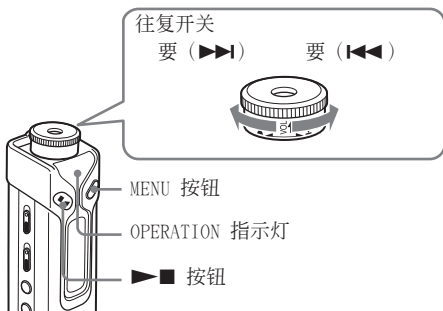

## 取消菜单模式

选择菜单屏幕上的 [RETURN] 或按 MENU 按钮。

### 1 按 MENU 按钮。

显示菜单屏幕。



### 2 转动往复开关选择“LED:”并按 ▶■ 按钮确认。

“LED:” 闪烁。



### 3 转动往复开关选择

“LED: L1” (根据操作闪烁)

“LED: L2” (始终闪烁)

“LED: L3” (始终开)

“LED: OFF” (始终关)

并按 ▶■ 按钮确认。



### 4 按 MENU 按钮。

# 在一个指定的时间之后关闭电源(TIMER)

您可设置您的 Portable IC Audio Player 在一定长的时间后自动关闭。

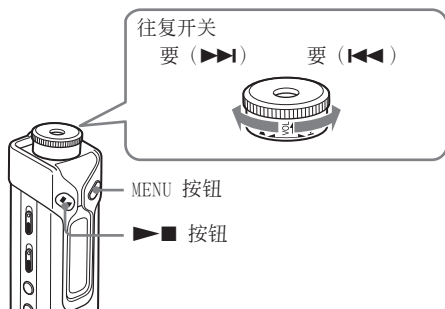

- 1 按 MENU 按钮。  
显示菜单屏幕。



- 2 转动往复开关选择“TIMER:”并按  
▶■ 按钮确认。  
“OFF” 闪烁。



- 3 转动往复开关选择“TIMER: ON”并按  
▶■ 按钮确认。

- 4 转动往复开关选择“TIMER: 30”、“60”、“90”、“120”或“10”并按  
▶■ 按钮确认。



- 5 按 MENU 按钮。

## 检查到播放器关闭还有多长时间

按下并按住 MENU 按钮。

## 取消定时

执行第 1 至第 3 步并在第 3 步中选择“TIMER: OFF”。

## 取消菜单模式

选择菜单屏幕上的 [RETURN] 或按 MENU 按钮。

## 💡 提示

定时启动后，即使 OPERATION 指示灯被设置为“OFF”，OPERATION 指示灯也会闪烁绿色（参见第 29 页）。

# 歌曲重组 (REGROUP)

若通过操作未安装 SonicStage 软件的计算机（第 10 页），将歌曲从内置闪存删除或添加到内置闪存时，则歌曲组群功能可能无法执行\*。在这种情形下，您可通过重组音频文件激活组群功能。当您需要编辑音频文件，请确信您已将 Portable IC Audio Player 连接到计算机上并使用 SonicStage 软件。

\* 即便歌曲组群功能不能执行，歌曲顺序仍不会改变。

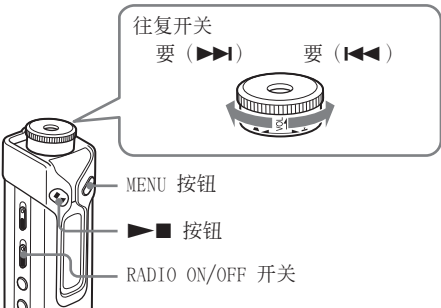

1 关闭收音机。  
往 RADIO OFF 方向滑动 RADIO ON/OFF 开关。

2 按 MENU 按钮。  
显示菜单屏幕。



3 转动往复开关选择“REGROUP”，并按  
▶■ 按钮确认。



您不能在播放音乐时重组音频文件。

4 转动往复开关选择“Y”，并按  
▶■ 按钮确认。  
将显示“Really?”。



5 按 ▶■ 按钮。  
重组开始，“REGROUPING”闪烁。当重组音频文件数据完毕，显示“COMPLETE”，显示屏返回步骤 3 中的指示。

6 按 MENU 按钮。  
显示屏返回正常屏幕。

## 取消菜单模式

选择菜单屏幕上的 [RETURN] 或按 MENU 按钮。

## 注意事项

您不能在播放音乐时重组歌曲（“REGROUP”不显示在菜单屏幕上）。

## 提示

某些情形下，您可能无法恢复先前的组群。当您  
需要编辑音频文件时，请将 Portable IC Audio  
Player 连接到计算机上并使用 SonicStage 软件。

# 格式化内存 (FORMAT)

您可使用 Portable IC Audio Player 来格式化内置闪存。  
若对内存进行格式化，则先前储存在内存中的所有数据将被删除。请确保在格式化之前核实内存中储存的数据。

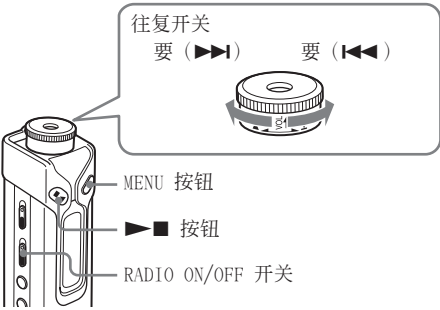

1 关闭收音机。  
往 RADIO OFF 方向滑动 RADIO ON/OFF 开关。

2 按 MENU 按钮。  
显示菜单屏幕。



3 转动往复开关选择“FORMAT”，并按  
▶■ 按钮确认。



您不能在播放音乐时格式化内存。

4 转动往复开关，选择“Y”，并按  
▶■ 按钮确认。  
将显示“Really?”。

5 按 ▶■ 按钮。

“FORMATTING”闪烁，格式化开始。  
当格式化完成，将显示“COMPLETE”，显示屏返回步骤 3 中的指示。

6 按 MENU 按钮。  
显示屏返回正常屏幕。

## 取消菜单模式

选择菜单屏幕上的 [RETURN] 或按 MENU 按钮。

## 取消格式化

在步骤 4 选择“N”。

## 注意事项

- 您不能在播放音乐时格式化内存（“FORMAT”不在菜单屏幕上显示）。
- MP3 文件管理器软件和使用该软件传送的 MP3 音频文件会因格式化而被删除。若 MP3 文件管理器软件被删除后，您可以从随机提供的 CD-ROM 恢复或从 Aiwa 客户服务网站下载该软件。详细说明，请参阅第 41 页“MP3 文件管理器软件操作”。

# 预防措施

## 安装

请勿在极端光线、温度、湿度或振动的环境下使用您的 Portable IC Audio Player。

## 耳机

### 道路安全

请勿在驾驶、骑车、或操作任何机动车辆时使用耳机。它可能会导致交通事故，并在许多地方是非法的。在行走，尤其在穿行人行横道时，高音量播放 Portable IC Audio Player 可能有潜在危险。您应该在有着潜在危害的环境下使用时特别谨慎操作或中止使用播放器。

### 预防听觉受损

避免以高音量使用耳机。听力专家建议避免持续、高音和长期播放。若您感觉有耳鸣，请降低音量或中止使用播放器。

### 顾及他人

请将音量保持在适当的电平。这将使您能听见外面的声音，也为了顾及周围的人。

### 警告

若您在使用 Portable IC Audio Player 时出现闪电，请立即关闭耳机。

## 清洁

- 请用微湿的软棉布或温和的清洁剂清洁 Portable IC Audio Player 外壳。
- 定期清洁耳机插头。

## 注意事项

请勿使用任何类型的擦洗纱布、擦洗粉或溶剂，例如酒精或苯，否则会损坏外壳表面。

如果有关于 Portable IC Audio Player 的任何问题或疑问请向最近的 Aiwa 经销商咨询。

# 故障排除

若您在使用 Portable IC Audio Player 时出现下列问题，请在向 Aiwa 经销商咨询之前，利用本故障排除指南进行问题排除。若问题仍然存在，请向最近的 Aiwa 指定代理商咨询。若您在与计算机连接时出现操作问题，请另行参阅附赠软件上在线帮助中的“故障排除”章节。

## 播放器复位

若您在检查了下列故障排除指南后，Portable IC Audio Player 仍然不能正常操作或没有声音，请取出电池，然后重新插入。

### 提示

即使在您的 Portable IC Audio Player 复位之后，预置电台将继续保存在播放器的内存中。

## 发生什么故障？

### 操作中

故障现象	原因/纠正方法
没有声音。 产生噪声。	<ul style="list-style-type: none"><li>音量电平设置为零。 → 将音量提高（第 12 页）。</li><li>未正确连接耳机插孔。 → 请正确连接耳机插孔（第 12 页）。</li><li>耳机插头不洁。 → 用软干棉布清洁耳机插头。</li><li>正播放有限定播放时间的歌曲。 → 不能播放超过播放期限的歌曲。</li><li>内存中没有音频文件。 → 如果显示“NO DATA”，请从计算机中传送出音频文件。</li></ul>
按钮无效。	<ul style="list-style-type: none"><li>HOLD 功能设置为开启。 → 将 HOLD 功能设置为关闭（第 20 页）。</li><li>您的 Portable IC Audio Player 有潮湿凝结。 → 将 Portable IC Audio Player 闲置数小时。</li><li>电池所剩电量不足。 → 更换电池（第 7 页）。</li></ul>
音量不够响。	<p>AVLS 被激活。 → 使 AVLS 失效（第 26 页）。</p>
耳机右声道没有声音。	<ul style="list-style-type: none"><li>耳机插孔未完全连接。 → 请完全连接耳机插孔（第 12 页）。</li><li>耳机延长线未正确连接到您的 Portable IC Audio Player 的耳机插孔或耳机线。 → 请正确连接（第 12 页）。</li></ul>
播放突然中断。	<p>电池剩余电量不足。 → 更换电池（第 7 页）。</p>



显示屏窗口

故障现象	原因/纠正方法
背景照明不能打开。	LIGHT 设置在“OFF”。 → 在菜单模式下，将“LIGHT”设置为“ON”（第 28 页）。
标题显示为“□”。	您的 Portable IC Audio Player 包含了无法显示的字符。 → 使用附赠的 SonicStage 软件将标题用正确的字符重新命名。

与计算机的连接或附赠的软件

故障现象	原因/纠正方法
无法安装软件。	正使用的是不与软件兼容的操作系统。 → 详细信息，请另行参阅“SonicStage 使用说明书”。
使用专用的 USB 电缆与计算机连接时，没有显示“CONNECT”。	<ul style="list-style-type: none"><li>请等待 SonicStage 软件校验。</li><li>计算机正在运行其它应用程序。 → 稍等片刻后重新连接 USB 电缆。若问题仍然存在，断开 USB 电缆，重新启动计算机，然后再连接 USB 电缆。</li><li>专用的 USB 电缆已断开连接。 → 连接专用的 USB 电缆。</li><li>使用了 USB 集线器。 → 通过 USB 集线器连接不在担保之列。请使用专用的 USB 电缆直接与计算机连接。</li></ul>
您的 Portable IC Audio Player 在与计算机连接时，不能被计算机识别。	<ul style="list-style-type: none"><li>专用 USB 电缆已断开连接。 → 连接专用的 USB 电缆。</li><li>由于静电等缘故您的 Portable IC Audio Player 不能被识别。 → 断开并连接专用的 USB 电缆。</li></ul>
歌曲不能传送到您的 Portable IC Audio Player。	<ul style="list-style-type: none"><li>专用 USB 电缆未正确连接。 → 正确连接 USB 电缆。</li><li>您用于传送音频文件的内置闪存空间不足。 → 将所有不需要的歌曲传回计算机，以增加剩余空间。</li><li>您已经使用 SonicStage 软件将 400 首歌曲或 400 个组群传送到内置闪存。 → 使用 SonicStage 软件将歌曲或组群传送到内置闪存的最大数量为 400。</li><li>您已经使用 MP3 文件管理器软件将 40,000 首歌曲或 400 个组群传送到内置闪存。 → 使用 MP3 文件管理器软件将歌曲或组群传送到内置闪存的最大数量分别为 40,000 和 400。（一个组群中所含歌曲的最大数量为 100。）</li><li>由于版权所有者的限制设定，有限定播放时间或播放次数的音频文件不能被传送。有关各音频文件设置的详细信息，请向代理商咨询。</li></ul>

其它信息

故障排除(续)

故障现象	原因/纠正方法
可以被传送的音频文件数量有限制。(可供录制的时间短。)	<ul style="list-style-type: none"><li>• 您想要传送音频文件给它的内置闪存的剩余空间不够大。 → 将所有不需要的音频文件传回计算机，以增加剩余空间。</li><li>• 非音频数据储存在您想要传入音频文件的内置闪存中。 → 将非音频数据移到计算机，以增加剩余空间。</li></ul>
Portable IC Audio Player 与计算机连接后，操作变得不稳定。	使用了 USB 集线器或 USB 延长接线。 → 使用 USB 集线器或 USB 延长接线连接不在担保之列。请使用专用的 USB 电缆直接与计算机连接。
当 Portable IC Audio Player 与计算机连接时，计算机屏幕上显示“Failed to authenticate Device/Media”。(设备/媒体校验失败。)	您的 Portable IC Audio Player 未与计算机正确连接。 → 退出 SonicStage 软件，核实专用 USB 电缆连接。重新启动 SonicStage 软件。

其它

故障现象	原因/纠正方法
您的 Portable IC Audio Player 操作时没有提示音。	BEEP 设置为“OFF”。 → 在菜单模式下，将“BEEP”设置为“ON”（第 28 页）。
Portable IC Audio Player 变热。	在正常条件下，有时候播放器会轻微变热。

信息

若显示屏上出现出错信息，按以下指令操作。

信息	含义	纠正方法
ACCESS	存取内置闪存。	请等待存取完成。此信息在传送音频文件和内置闪存初始化时显示。
AVLS	AVLS 激活时，音量电平超出了额定值。	将音量开小或关闭 AVLS。
CANNOT PLAY	<ul style="list-style-type: none"><li>• 您的 Portable IC Audio Player 由于格式不兼容，不能播放某些文件。</li><li>• 传送被强行中断。</li></ul>	若该文件不能播放，您可将其从内置闪存中删除。 详细信息，请参阅“从内置闪存中删除异常数据”（第 37 页）。
CONNECT	您的 Portable IC Audio Player 正与计算机连接。	您可使用 SonicStage 或 MP3 文件管理器软件操作您的 Portable IC Audio Player，但不能操作 Portable IC Audio Player 上的控制器。
ERROR	检测到一个故障。	请向最近的 Aiwa 代理商咨询。
EXPIRED	<ul style="list-style-type: none"><li>• 有播放限定的歌曲已经过期。</li><li>• 播放有播放限定的歌曲时，当前时间未被设置。</li><li>• 歌曲受不与您的 Portable IC Audio Player 兼容的播放限定的保护。</li></ul>	<ul style="list-style-type: none"><li>• 若未设置当前时间，请在菜单模式下设置当前时间（第 25 页）。</li><li>• 若歌曲不能播放，您可将其从内置闪存中删除。 详细信息，请参阅“从内置闪存中删除异常数据”（第 37 页）。</li><li>• 您的 Portable IC Audio Player 不支持有限定播放次数的内容。详细信息，请参阅“播放有限定播放次数的歌曲注意事项”（第 11 页）。</li></ul>
FILE ERROR	<ul style="list-style-type: none"><li>• 文件不能被读取。</li><li>• 文件不正常。</li></ul>	将正常音频文件传送回计算机，然后对您的 Portable IC Audio Player 进行格式化。（详细信息，请参阅第 37 页的“从内置闪存中删除异常数据”）。
HOLD	HOLD 功能设置为开启时，所有操作按钮不能执行。	将 HOLD 功能设置为关闭，以操作按钮。
LOW BATT	电池电量低。	您必须更换电池（第 7 页）。
MEMORY FULL	内存已满载或已存有 400 组歌曲。	删除歌曲或组群。没有歌曲的组群仍被认为是一个组群。要删除没有歌曲的组群，请使用 SonicStage 软件。
MG ERROR	为了版权保护，检测出一个未经授权的发布文件。	将正常音频文件传回计算机，然后在 Portable IC Audio Player 上将内置闪存格式化。（详细说明、请参阅第 37 页“从内置闪存中删除异常数据”。）
NO AUDIO	内置闪存中没有音频文件。	若内置闪存中没有音频文件，请使用 SonicStage 软件传送音频文件。

从内置闪存中删除异常数据

若显示“CANNOT PLAY”、“EXPIRED”或“FILE ERROR”，表明在内置闪存中储存的全部或部分数据出现了问题。

请按照下列步骤删除不能播放的数据。

- 1 将您的 Portable IC Audio Player 与计算机连接，启动 SonicStage 软件。
- 2 若您已知是哪些数据出现了问题（如过期歌曲），将该数据从 SonicStage 软件的 Portable Player 窗口删除。
- 3 若问题仍然存在，在您的 Portable IC Audio Player 与计算机连接的情况下，单击 SonicStage 软件上的  按钮，传送所有没有问题的数据。
- 4 将您的 Portable IC Audio Player 与计算机断开连接，然后使用 FORMAT 菜单将内置闪存格式化（第 32 页）。



# 规格

## 最长录制时间（约）

### XDM-S500

ATRAC3*	ATRAC3plus*
2 小时 00 分钟 (132 kbps)	1 小时 00 分钟 (256 kbps)
2 小时 30 分钟 (105 kbps)	4 小时 20 分钟 (64 kbps)
4 小时 10 分钟 (66 kbps)	5 小时 50 分钟 (48 kbps)

### MP3

1 小时 00 分钟 (256 kbps)
2 小时 00 分钟 (128 kbps)

### XDM-S700

ATRAC3*	ATRAC3plus*
4 小时 10 分钟 (132 kbps)	2 小时 00 分钟 (256 kbps)
5 小时 20 分钟 (105 kbps)	8 小时 40 分钟 (64 kbps)
8 小时 30 分钟 (66 kbps)	11 小时 40 分钟 (48 kbps)

### MP3

2 小时 00 分钟 (256 kbps)
4 小时 00 分钟 (128 kbps)

\* 若 MP3 文件管理软件从内置闪存中被删除，则应用 ATRAC3 和 ATRAC3plus 的值。

## 采样频率

ATRAC3, ATRAC3plus, MP3: 44.1 kHz

## 音频压缩技术

Adaptive Transform Acoustic Coding3 (ATRAC3)  
Adaptive Transform Acoustic Coding3plus (ATRAC3plus)  
MPEG1 Audio Layer-3 (MP3): 8-320 kbps, 符合可变比特率

## 频率响应

20 - 20,000 Hz (单一信号测量)

## FM频率范围

87.5 - 108.0 MHz

## IF (FM)

225 kHz

## 输出

耳机：立体声迷你插孔

## 信噪比 (S/N)

80 dB 或以上（不包括 ATRAC3 66 kbps）

## 动态范围

85 dB 或以上（不包括 ATRAC3 66 kbps）

## 操作温度

5°C-35°C

## 电源

LR6（尺寸 AA）碱性电池

## 电池使用时间(连续播放)

ATRAC3 格式：约 100 小时  
ATRAC3plus 格式：约 90 小时  
MP3 格式：约 80 小时  
FM 收音机接收：约 40 小时

## 尺寸

88.6 × 24.3 × 24.6 mm  
(宽/高/深，不包括突出部件)

## 重量

约 37 g (不含电池)

## 随赠的附件

耳机 (1)  
专用 USB 电缆 (1)  
便携袋 (1)  
颈带 (1)  
耳机延长线 (1)  
CD-ROM (1)  
使用说明书 (1)  
SonicStage 使用说明书 (1)  
保修卡 (1)

设计和规格随时更改，恕不另行通知。  
美国国外专利由 Do1by Laboratories 许可。

# 术语

## MagicGate

由识别和加密技术组成的版权保护技术。识别技术可确保受保护的内容仅在相关设备和媒介间传送，且确保受保护的内容通过加密格式录制和传送，以防止未经授权的复制或播放。

### 注意事项

**MAGICGATE** 是 Sony 开发的代表版权保护系统的术语。它不能保证其它媒介之间的转换。

## OpenMG

在个人计算机上安全管理音乐分发服务或音频 CD 内容的版权保护技术。通过应用安装在计算机上的 OpenMG 软件，对数码音频内容在录制到硬盘时进行加密。这样您可在计算机上欣赏音乐，同时防止该音乐通过互联网（或其它途径）进行未经授权的内容分发。这项计算机版权保护是遵照了“MagicGate”，您可将数码音频内容从个人计算机硬盘传送到符合的设备上。

## SonicStage

在个人计算机上安全管理音乐分发服务或音频 CD 内容的版权保护技术。通过应用安装在计算机上的 OpenMG 软件，对数码音频内容在录制到硬盘时进行加密。这样您可在计算机上欣赏音乐，同时防止该音乐通过互联网（或其它途径）进行未经授权的内容分发。这项计算机版权保护是遵照了“MagicGate”，您可将数码音频内容从个人计算机硬盘传送到符合的设备上。

## ATRAC3

ATRAC3 代表 Adaptive Transform Acoustic Coding3，是一种满足高声音品质和高压缩率需求的音频压缩技术。

ATRAC3 压缩率约为音频 CD 的 10 倍，增加了媒介的数据容量。

## ATRAC3plus

ATRAC3plus 代表 Adaptive Transform Acoustic Coding3plus，是比 ATRAC3 压缩数据更高的音频压缩技术。ATRAC3plus 是新的音频压缩技术，其声音质量达到并超过 ATRAC3 水平。

## Bit rate(比特率)

表示每秒数据量。比特率用 bps (bit per second) 表示。

64 kbps 意味着每秒信息量 64000 比特。若比特率较大，意味着播放音乐使用了大量信息。与相同格式的音乐相比(例如：ATRAC3plus)，64 kbps 数据比 48 kbps 数据提供更好的声音品质。但是，MP3 等格式音频文件有不同的编码方法，因此声音品质不能简单地从比较比特率进行判断。

## MP3

MP3 代表 MPEG-1 Audio Layer-3，是一种音乐文件压缩的格式标准。由 ISO (International Organization for Standardization) 的工作组 Motion Picture Experts Group 编纂。它将音频 CD 数据压缩至约原来尺寸的十分之一。因为 MP3 编码运算法则已公开使用，所以现在有许多与此标准相兼容的编码器和解码器。

# 菜单列表

按 MENU 按钮显示菜单模式，使用往复开关 (转动：选择/按：确认) 改变您的 Portable IC Audio Player 的设置。

每个菜单的详细信息，请参阅括号内的页码。有 “>” 标记的菜单在您按往复开关确认时，将附有一个详细设置屏幕。

显示 (菜单模式)	目的
REPEAT MODE >■ (重复模式)	您可选择喜爱的重复模式。 (第 14 页)
DISPLAY >■ (显示模式)	您可选择喜爱的显示模式。 (第 17 页)
FM SOUND:□	在收音机功能有效期间，您 可选择单声道接收模式。
FM AUTO PRESET:□	在收音机功能有效期间，您 可选择手动模式或预置模 式。(第 23 页)
VOL: ■□ (预置音量)	您可预置您期望的音量电 平。(第 26 页)
SOUND >■ (数字声音预置)	您可预置您期望的声音质 量。(第 19 页)
AVLS: ■□ (自动音量限制系 统)	您可设置为 “ON” 或 “OFF”。(第 26 页)
BEEP: ■□ (操作音设置)	您可设置为 “ON” 或 “OFF”。(第 28 页)
LIGHT: ■□ (LCD 背景照明 设置)	“OFF”：总是关闭。 “ON”：在每次操作后开启 3 秒钟。(第 28 页)
DATE-TIME ■□ (当前时间设置)	您可设置和显示当前时间。 (第 25 页)
PC CLK: ■ (调节时间设置为 计算机内置时钟)	您可将 Portable IC Audio Player 时间设置调节为计算 机内置时钟。(第 24 页)

显示 (菜单模式)	目的
FORMAT >■ (格式化内存)	您可以格式化内置闪存。 (第 32 页)
REGROUP >■ (数据重新分组)	您可恢复组群功能。 (第 31 页)
LED: ■□ (OPERATION 指示 灯设置)	您可选择 OPERATION 指示 灯的闪烁方式。 (第 29 页)
TIMER: ■□ (定时关闭设置)	电源在一个指定的时间之后 关闭。(第 30 页)
[RETURN] ■□	您可通过选择 [RETURN] 和按 ▶■按钮切换为普通模式。

- 当 RADIO ON/OFF 开关被设置为 RADIO ON 时显示。
- 当 RADIO ON/OFF 开关被设置为 RADIO OFF 时显示。

## MP3 文件管理器有何作用

使用 MP3 文件管理器软件可以方便地将 MP3 音频文件以相同的格式（MP3）传送到您的 Portable IC Audio Player，而 SonicStage 软件是将 MP3 音频文件转换为 ATRAC3 或 ATRAC3plus 格式。

Portable IC Audio Player 在出厂时预装了 MP3 文件管理器软件；因此不再需要安装。

但是，在使用 MP3 文件管理器软件之前，必须用附赠的 CD-ROM 在计算机上安装 SonicStage 软件。您只有先安装了 SonicStage 软件（在附赠的 CD-ROM 中），才能运行 MP3 文件管理器。如果使用的计算机没有安装 SonicStage 版软件，则您需要安装从 Aiwa 客户服务网站下载 Portable IC Audio Player 的驱动文件（<http://www.css.ap.aiwa.com/>）。

### 系统要求

- 操作系统：Windows XP Professional  
Windows XP Home Edition  
Windows 2000 Professional  
（简体中文）
- CPU：Pentium II 400 MHz 或更高
- RAM：64 MB 或更大
- HDD：5 MB 或更大
- 显示器：增强色（16 位或更高），分辨率 800 × 600 或更高
- USB 端口（支持 USB（以前称作 USB1.1））

## 将 MP3 音频文件从计算机传送至 Portable IC Audio Player

- 1 将您的 Portable IC Audio Player 与计算机连接。

将附赠的专用 USB 电缆上的小的连接头接入 Portable IC Audio Player 上的 USB 插孔，然后将大的连接头接到您计算机的 USB 端口。

显示屏上出现“CONNECT”。

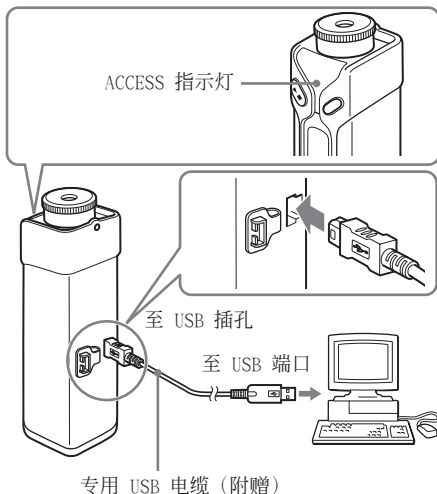

- 2 单击您计算机上的 [我的电脑]-[可移动磁盘：]\*。

\* 在 Windows XP Professional/Windows XP Home Edition 的情况中为 [MEMORY\_P-AUDIO]

- 3 单击打开可移动磁盘中的 [Esys] 文件夹。

- 4 双击运行 [MP3FileManager.exe] 。

## 将 MP3 音频文件从计算机传送至 Portable IC Audio Player(续)

- 5 将您需要传送至 Portable IC Audio Player 的 MP3 音频文件拖放至 MP3 文件管理器屏幕。
- 您也可以通过拖动文件夹将 MP3 格式音频文件传送到 Portable IC Audio Player。

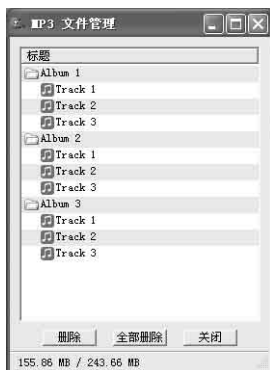

如果 MP3 文件管理器软件被格式化等意外删除，您可以按照以下步骤从随机提供的 CD-ROM 恢复该软件。

- 1 使用 USB 电缆把您的 Portable IC Audio Player 连接到您的计算机上。
- 2 把随机提供的 CD-ROM 装入您的计算机。
- 3 使用 Windows Explorer 打开 CD-ROM，选择 [MP3FileManager] 文件夹并打开。
- 4 使用 Windows Explorer 选择适合您的计算机操作系统的文件夹 ([English]、[Korean]、[Simplified Chinese]) 并打开。
- 5 双击安装文件  
[MP3FileManager\_1.1\_Update\_ENU.exe]，  
[MP3FileManager\_1.1\_Update\_KOR.exe]，  
[MP3FileManager\_1.1\_Update\_CHN]。  
开始安装。  
按照安装向导的指令操作。

(您也可以从 Aiwa 客户服务网站  
[<http://www.css.ap.aiwa.com/>] 下载  
MP3 文件管理器软件。)

### 注意事项

- MP3 文件管理器软件正在运行时请不要断开 USB 电缆，或拔去您的 Portable IC Audio Player。否则不能保证其正常工作。
- 当您的 Portable IC Audio Player 接入计算机时，ACCESS 指示灯闪烁橘色。
- 请勿在 ACCESS 指示灯闪烁橘色时将 USB 电缆断开连接或取下 Portable IC Audio Player，否则传送中的数据会被破坏。
- 使用 Windows2000 时请安装 Service Pack 3 或更高版本。
- Portable IC Audio Player 先显示 ID3 Tag 信息 (ID3 Tag 是在 MP3 文件上添加音乐标题或艺术家名等信息的格式。Portable IC Audio Player 支持的版本有 1.0/1.1/2.2/2.3/2.4.)
- 用 USB 集线器或 USB 加长电缆使用您的 Portable IC Audio Player 不在担保之列。请仅使用专用的 USB 电缆将您的 Portable IC Audio Player 直接与计算机连接。
- 某些连接至计算机的 USB 装置可能会干扰您的 Portable IC Audio Player 的正确操作。
- 当与计算机连接时，您的 Portable IC Audio Player 上的控制按钮都将无效。
- 当 Portable IC Audio Player 与计算机连接时，您可使用 Windows Explorer 显示储存在内置闪存上的数据。
- 符合 MP3 文件管理器软件的 MP3 音频文件由一个频率为 44.1 kHz 和比特率为 8-320 kbps 的采样频率创建。



# MP3 文件管理器屏幕



- 1

专辑列表  
双击此处显示包含的曲目列表。再次双击则隐藏曲目列表。
- 2

曲目列表
- 3

删除  
单击此按钮，删除选中的专辑或曲目。
- 4

全部删除  
单击此按钮删除全部专辑或曲目。
- 5

关闭  
单击此按钮，关闭 MP3 文件管理器。
- 6

选中行变蓝  
您可通过使用 CTRL 键或 SHIFT 键同时选中多张专辑或多首曲目。

## 注意事项

在 MP3 文件管理器屏幕上不显示使用 SonicStage 软件传送到内置闪存的音频文件。另外，在 SonicStage 软件屏幕上也不显示使用 MP3 文件管理器软件传送到内置闪存的音频文件。

# 删除音频文件

在 MP3 文件管理器中，您可按曲目或专辑删除储存在内置闪存中的歌曲。

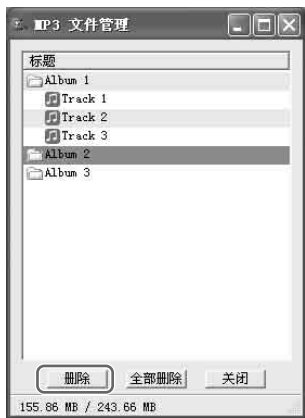

- 1 打开 MP3 文件管理器。
- 2 选中您要删除的标题。
- 3 单击屏幕上的删除按钮。

## 💡 提示

您可通过使用 CTRL 键或 SHIFT 键同时选中多张专辑或多首曲目。但是，专辑和曲目无法同时选中。

# 更改音频文件的排序

在 MP3 文件管理器中，您可按曲目或专辑移动储存在内置闪存中的歌曲。



- 1 打开 MP3 文件管理器。
- 2 选中您要移动的标题。
- 3 拖放移动。

## A

A-B 重复	15
ACCESS 指示灯	10, 29, 41
ATRAC3	38
ATRAC3plus	38
AVLS (限制音量)	9, 26

## B

BEEP (操作音)	28
背景照明	28
比特率	38
播放	12

## C

CD (音频 CD)	4
CD-ROM	6, 10
菜单列表	40
重复	14
重复次数	17
重组	31
传送	4, 10, 41

## D

DATE-TIME	25
电池	5, 7
电池剩余电量指示	7

## E

EMD 服务	4, 11
Explorer (Windows 资源管理器)	10, 21
耳机	6, 12, 33

## F

FM	22
FORMAT	32
附件	6
复位	32

## G

格式化	32
故障排除	34

## H

HOLD	20
HOLD 功能 (锁定控制器)	20

## J

计算机	4, 10, 40
-----	-----------

## K

快进	13
快退	13

## L

LED	29
LIGHT	28

## M

MENU 按钮	14, 17-20, 22-31
MP3	4, 10, 38, 39
MP3 文件管理器软件	41

## O

OpenMG	39
OPERATION 指示灯	29

P

PC CLK 22

Q

曲目重复 15

R

RETURN 40

S

收音机 22

随机重复 14

SonicStage 39

声音预置 19

（数字声音预置）

时间设置 24, 25

时钟 23

锁定控制器 20

（HOLD 功能）

T

Title 17

TIMER 30

跳到曲目开始 13

听 12

U

USB 电缆 6, 10, 41

W

WAV 格式 4

Windows Explorer 10, 21, 42

往复开关 12-20, 22-32

X

下载 4

显示模式 17

显示屏 9, 13, 15, 17, 37

限制音量（AVLS） 26

序号 6

Y

预置电台 23

音量 26

音频 CD 4

Z

组群 13, 18

句子重复 16







上海索广电子有限公司  
上海市 闵行区 剑川路930号

<http://www.aiwa.com/>

Printed in China