

Nokia 1208/1209

用戶指南

Copyright © 2008 Nokia。版權所有。

一致性聲明

諾基亞公司聲明本產品 RH-105 符合 1999/5/EC 指引的基本要求和相關規定。可在網站

http://www.nokia.com/phones/declaration_of_conformity/
找到此聲明的副本。

CE 0434

© 2008 Nokia。版權所有。

Nokia、Nokia Connecting People 及 Navi 是諾基亞公司的商標或註冊商標。Nokia tune 是諾基亞公司的聲音標誌。本文件中所提及的其他產品及公司名稱可能分別為其各自擁有者之商標或商號名稱。

未事先取得諾基亞的書面同意，嚴禁以任何形式複製、傳輸、分發或儲存本文件的部份或全部內容。

美國專利號碼 5818437，其他專利正在申請中。T9 文字輸入軟件 Copyright © 1997-2008。Tegic Communications, Inc. 版權所有。

諾基亞奉行持續研發的政策。諾基亞保留對本文所描述之任何產品進行更改及改進的權利，恕不預先通知。

在適用法律許可的最大範圍內，任何情況下對資料遺失、收益損失或因此所引致的任何特別的、意外的、連帶的或間接的損失，諾基亞恕不負責。

本文件的內容以「現有形式」提供。除所適用的法律外，諾基亞不對本文件的正確性、可靠性或其內容提供任何保證，不論是明示或暗示的，包括但不限於適銷性及針對特定目的的適用性的暗示保證。諾基亞保留隨時修訂或收回本文件的權利，恕不預先通知。如需最新產品的資料，請參閱 www.nokia.com.hk。

特定產品、產品應用程式及服務的供應情況可能根據地區的不同而有所分別。請向您的諾基亞經銷商查詢以獲取詳細資料及提供的語言選項。

本裝置可能含有受美國及其他國家出口法律及法規約束的物品、技術或軟件。禁止與法律相抵觸的改動。

目錄

安全規定	4	3. 電池資料	30
1. 快速入門	9	充電與放電	30
安裝 SIM 卡和電池	9	諾基亞電池認證指引	32
為電池充電	11	4. 原廠增強配套	35
開機和關機	12	電池	36
2. 您的手機	14	保養及維修	37
按鍵及插孔	14	附加安全資料	39
主要功能	15	索引	46
撥打電話及接聽來電	16		
喇叭	16		
輸入法	17		
中文輸入	17		
開啓或關閉智慧英文 輸入法	22		
使用傳統英文輸入法	23		
使用智慧英文輸入法	23		
輸入文字的秘訣	25		
訊息	26		
通訊錄	27		
電筒	28		
多本通訊錄	28		

安全規定

請閱讀下列簡易的使用準則。違反這些準則可能會引致危險或觸犯法律。閱讀完整的用戶指南以獲取詳情。



安全規定

當禁止使用無線電話，或可能因此造成干擾或危險時，請勿開機。



行車安全第一

請遵守當地所有法律。駕車時請保持雙手活動自如，以便控制車輛。行車安全是駕駛車輛時優先考慮的因素。



干擾

所有無線裝置都可能受到干擾，影響效能。



在醫院內請關機

請遵守所有限制。位處醫療儀器附近時請關機。

安全規定



在飛機上請關機

請遵守所有限制。無線裝置會對飛機飛行造成干擾。



加油時請關機

請勿在加油站使用手機。請勿在燃料或化學品附近使用手機。



進行爆破時請關機

請遵守所有限制。進行爆破作業時請勿使用手機。



正確使用

請以產品說明書中所述的姿勢使用手機。如非必要，請勿觸摸天線區域。



合格的服務

僅容許合格的服務人員安裝或維修本產品。



增強配套及電池

請僅使用經認可的增強配套及電池。請勿連接不兼容的產品。



防水性

本裝置並不防水。請保持乾燥。



備份資料

請記住為儲存於您裝置內的重要資料備份或保留書面記錄。



連接其他裝置

在連接任何其他裝置時，請先閱讀其用戶指南，獲取詳細的安全指引。請勿連接不兼容的產品。



緊急電話

請確保裝置已經開啓且處於服務區域內。視情況按結束鍵數次以清除螢幕並返回至待機模式。輸入緊急電話號碼，然後按通話鍵。告知您所在的位置。當接到掛掉電話的指示後才可結束通話。

■ 關於本裝置

本指南中描述的無線裝置已獲許用於 GSM 900 和 GSM 1800 網絡。請與服務供應商聯絡，獲取有關網絡的詳情。

當使用本裝置的功能時，請遵守所有法律並尊重他人的隱私和合法權利 (包括版權)。



警告：要使用本裝置內的任何一項功能 (鬧鐘功能除外)，裝置必須開啓。在使用無線裝置可能導致干擾或危險的情況下，請勿開機。

■ 網絡服務

要使用手機，必須享有無線服務供應商提供的服務。部份功能要求特殊網絡功能。並非所有網絡均支援這些功能；某些網絡可能要求您在使用網絡服務前先向服務供應商作特殊申請。您的服務供應商會為您提供指引，並說明要收取的費用。一些網絡可能有限制，影響您使用網絡服務。例如，有些網絡可能無法支援所有受語言影響的字符和服務。

服務供應商可能會要求您關閉或停用裝置的某些功能。這樣，這些功能將不會顯示於您裝置的功能表中。本裝置可能已經過特殊配置，例如：功能表名稱、功能表次序及圖標的更改。請與服務供應商聯絡以獲取詳情。

■ 諾基亞網上支援

如要獲取本指南的最新版本、下載內容、服務及有關您諾基亞產品的其他資料，請瀏覽

www.nokia.com.hk/support 或您本地的 Nokia 網站。

如果您仍需要協助，請瀏覽

www.nokia.com.hk/contactus 中的內容。

要查看最近的諾基亞維修中心位置以獲得維修服務，請瀏覽 www.nokia.com.hk/carecenter。

1. 快速入門

■ 安裝 SIM 卡和電池

移除電池前務必關閉裝置並斷開與充電器的連接。

請將所有 SIM 卡置於兒童無法觸及的地方。

如要獲取有關 SIM 卡服務的供應情況及更多資料，請向您的 SIM 卡經銷商查詢。SIM 卡經銷商亦可能是服務供應商、網絡商或其他經銷商。

此手機適用的電池為：BL-5CA。

1. 滑動後殼以將其卸下 (1)。提起電池，然後將其卸下 (2)。
2. 小心地從手機的指夾處提起 SIM 卡夾 (3)。將 SIM 卡插入卡夾，並使卡的斜角端處於右上角且金色接觸區域朝下 (4)。關閉 SIM 卡夾，然後輕按直至鎖定到位 (5)。

3. 裝回電池和手機後殼(6、7)。

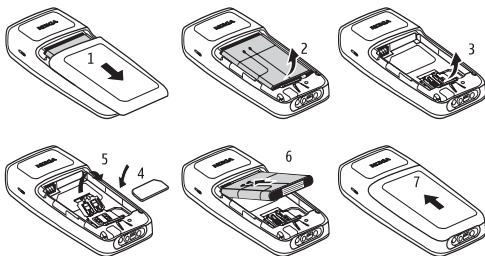

注意：移除外殼前，請關閉裝置，並取下充電器或其他任何裝置。更換外殼時請勿接觸任何電子元件。存放及使用手機時必須安裝好外殼。

■ 為電池充電



警告：僅使用經諾基亞認可、適用於本特定型號的電池、充電器及增強配套。使用其他未經許可的增強配套，可能會令手機的保養失效，甚至造成危險。

使用充電器為本裝置充電之前，請先檢查充電器的型號。本裝置適合使用 AC-3 充電器¹。

如要獲取經認可增強配套的供應情況，請向您的經銷商查詢。切斷任何增強配套的電源時，請握住插頭拔出，不要拉電線。

1. 將充電器連接至電源插座。
2. 將充電器連接至手機。電池指示條開始捲動。當電池充滿電後，指示條將停止捲動。

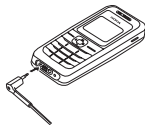

1. 充電器的具體型號因插頭類型的不同而不同。例如：對於 AC-3，充電器的具體型號可以是 AC-3C、AC-3U、AC-3X 等。



秘訣：要節省電量，請在電池完全充電後拔下充電器。

如果電池完全沒電，可能要等幾分鐘後，螢幕上才會出現充電指示符號，手機才能撥打電話。

■ 開機和關機

按住結束鍵。

請僅以正常操作姿勢使用手機。

本裝置配備內置天線。

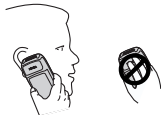

注意：跟任何無線電傳輸裝置一樣，當天線正在使用時，避免無必要地接觸天線。例如，應避免在通話過程中碰觸流動天線。觸碰正在發射/接收訊號的天線會影響無線電通訊的品質，可能會導致手機作業時的功率超過所需的正常水平，還會縮短電池的壽命。

快速入門



注意：不要觸碰此插孔，其
僅供授權的維修人員使用。

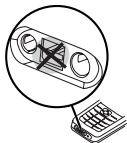

2. 您的手機

■ 按鍵及插孔

- 網絡名稱或系統標誌 (1)
- 網絡訊號強度 (2)
- 電池電量 (3)
- 聽筒 (4)
- 喇叭 (5)
- 電筒 (6)
- 選擇鍵的功能 (7)
- 選擇鍵 (8)
- Navi™ 鍵 (9) ,
以下簡稱為瀏覽鍵
- 通話鍵 (10)

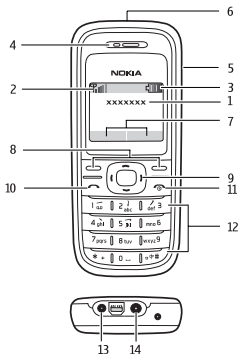

您的手機

- 結束鍵/電源鍵 (11)
- 鍵盤 (12)
- 充電器插孔 (13)
- 耳機插孔 (14)

■ 主要功能

選擇功能表可存取以下功能：

訊息 — 建立、傳送、開啓及管理訊息

通訊錄 — 將姓名和電話號碼儲存至 SIM 卡和手機記憶體中

通話記錄 — 存取未接來電、已接來電和已撥電話的電話號碼

設定 — 設定手機的各種功能

鬧鐘 — 為鬧鐘設定響鬧時間

備忘錄 — 管理備忘錄

遊戲 — 設定遊戲效果或玩手機中安裝了的遊戲

附加功能 — 可存取計算機、換算器、倒數計時器、日曆、計時錶、鈴聲編輯器、示範、農曆及電筒

SIM卡服務 — 使用其他服務 (如果您的 SIM 卡支援)

■ 撥打電話及接聽來電

要撥打電話，輸入電話號碼 (如有必要，輸入國家和地區代碼)。按通話鍵以撥打該號碼。通話期間，向右捲動可提高聽筒或耳機的音量，或者向左捲動可降低音量。

要接聽來電，按通話鍵。要拒絕接聽來電，按結束鍵。

■ 喇叭

如果適用，您可以選擇喇叭或手機以在通話期間使用手機的喇叭或聽筒。



警告：當喇叭在使用時，請勿把裝置靠近您的耳朵，因為音量可能非常響亮。

■ 輸入法

手機中可用的輸入法是根據手機銷售市場預先設置的。

中文輸入

將手機語言設為繁體中文後，您可以使用筆劃輸入法輸入繁體中文字元。將手機語言設為簡體中文後，您可以使用拼音輸入法或筆劃輸入法輸入簡體中文字元。

輸入法指示符號

輸入法指示符號顯示於螢幕的左上角處：輸入法名稱和螢幕上相應的指示符號顯示如下：

拼音	pinyin
筆劃	一丨丿フ
大寫字母	ABC Abc

小寫字母	abc
數字輸入	123

請注意，並非在任何情況下均可使用所有輸入法。請查看指示符號，確定正在使用的是哪一種輸入法。

在輸入法之間互相切換

您可以透過以下方式在可用輸入法之間進行切換：

- 重複按 **#**，直到您想要的輸入法的指示符號顯示於螢幕的左上角處。
- 在您編寫訊息時，選擇**操作**，然後從選項清單中選擇想要的輸入法。

筆劃輸入法

組成中文字元的筆劃可分為五種：橫、豎、撇、點和折。每種筆劃分別對應從 1 至 5 的數字鍵。

按鍵	1	2	3	4	5
基本筆劃	一	丨	丿	丶	㇏

您的手機

使用筆劃輸入法

1. 輸入筆劃：根據標準的筆劃次序，按數字鍵輸入筆劃。



如果您不確定該使用哪一種筆劃或其屬於哪一種類，按 6 來代替該筆劃，然後繼續輸入其他筆劃。輸入區域中會顯示問號來代表該筆劃。

2. 於候選清單中捲動以選擇所需中文字元，然後選擇確認。

您可以鍵入的筆劃數目不受限制。輸入的筆劃越多，候選清單就會越短。

拼音輸入法

拼音符號印在數字鍵上。不用考慮符號在數字鍵上的位置，您僅需按鍵一次，手機將會對拼音符號進行邏輯組合。

1. 為要輸入的每個拼音符號，按一次數字鍵 (使用「v」輸入「ü」)。

按 1 一次輸入第一聲，兩次輸入第二聲，依此類推。按 1 五次輸入輕聲。

2. 如有必要，按 * 獲取下一個可能的拼音組合。
3. 捲動候選清單以突出顯示想要的中文字元，然後選擇**確認**以選定該字元。

智慧字符輸入法

手機會預想可與輸入的上一個中文字元組成適當短語的下一個中文字元。從候選字元和預想字元中選擇您想要的一個字元。要在不需要預想時結束預想，選擇返回，或立即開始輸入下一個字元。

開啟或關閉智慧英文輸入法

輸入文字時，選擇**操作 > 預想字典**。

- 要開啟智慧文字輸入法，從字典選項清單中選擇一種語言。僅清單中所列的語言可以使用智慧文字輸入法。
- 要返回至傳統文字輸入法，選擇**關閉預想字典**。

使用傳統英文輸入法

重複按數字鍵 (1 至 9) 直到出現想要的字元。

並非按某數字鍵可輸入的所有字元均印於該數字鍵上。可用字元視乎您所選擇的手機語言而定。

- 如果要輸入的下一個字母與上一個字母位於同一按鍵上，請向左或向右捲動，然後輸入新的字母。
- 按數字鍵 1 可存取最常用的標點符號和特殊字元。

如要獲取有關輸入文字的更多說明，請參閱「[輸入文字的秘訣](#)」，刊於第 25 頁。

使用智慧英文輸入法

要輸入任何字母，您只需按相應鍵一次。智慧英文輸入法基於內置字典，您也可以向該字典加入新單詞。

1. 使用數字鍵 2 至 9 開始輸入單詞。輸入一個字母只需按相應數字鍵一次。單詞會隨每次按鍵而變化。



例如：選擇英文詞典之後，要輸入 **Nokia**，按 6、6、5、4、2。

有關輸入文字的更多說明，請參閱「輸入文字的秘訣」，刊於第 25 頁。

2. 當您完成輸入且單詞正確時，透過按 0 加入一個空格或按任意瀏覽鍵進行確認。

如果該單詞不正確，

重複按 * 或按操作，然後選擇其他對應項。當您想要的單詞出現時，請確認。

如果在該單詞之後顯示？，表示字典中沒有您要輸入的單詞。要將該單詞加至詞典，選擇拼寫，輸入該單詞 (使用傳統英文輸入法)，然後按確認。當詞典變滿時，新單詞會取代最早加入的單詞。

您的手機

3. 開始輸入下一個單詞。

輸入複合詞彙

輸入該詞彙的前半部分，然後向右捲動進行確認。輸入該詞彙的後半部分，然後確認。

輸入文字的秘訣

以下功能亦可用於輸入文字：

- 使用瀏覽鍵移動遊標。
- 要在未顯示輸入符號時插入數字，按住想要的數字鍵。
- 要在未顯示候選或預想清單的情況下插入空格，按 0。
- 要在未顯示任何輸入符號的情況下刪除游標左側的字元，選擇清除。按住右選擇鍵 (清除) 可刪除所有字元。
- 要在數字和其他輸入法之間切換，按住 #。

- 使用傳統英文輸入法或中文輸入法時，按 * 可開啓特殊字元清單。使用智慧英文輸入法時，按住 * 可開啓特殊字元清單。

捲動至想要的字元，然後選擇**確定**。

■ 訊息

只有網絡商或服務供應商支援訊息服務，您才能使用該服務。

本裝置支援傳送大小超過單個訊息字符限制的文字訊息。較長的訊息會以兩個或兩個以上的連續訊息傳送。服務供應商可能會收取相應的費用。使用重音符號或其他標記的字符，以及某些語言選項 (例如中文) 中的字符會佔用較多空間，從而限制在單個訊息內可以傳送的字符數。

1. 選擇**功能表 > 訊息 > 寫訊息**。
2. 編寫訊息。

您的手機

3. 要傳送訊息，選擇**操作 > 發送**，輸入收訊人的電話號碼，然後選擇**確認**。



注意：裝置可能會指示訊息已傳送至已編入本裝置內的訊息中心號碼。但是，可能不會顯示訊息接收者是否收到了訊息。如要獲取有關訊息服務的更多詳細資料，請與服務供應商聯絡。

要刪除所有已讀訊息或一個資料夾中的所有訊息，選擇**功能表 > 訊息 > 刪除訊息 > 全部已讀訊息**或所需的資料夾。

■ 通訊錄

您可以將姓名及電話號碼儲存至手機記憶體及 SIM 卡記憶體中。內部通訊錄最多可以儲存 200 個姓名。



注意：本手機與姓名顯示相關的功能是基於對通訊錄儲存的電話號碼最相近的匹配，但只支援最後七位號碼的匹配。

要尋找聯絡人，請在待機模式中向下捲動，然後輸入姓名的前幾個字母。捲動至您要找的姓名。

您還可以選擇**功能表 > 通訊錄**並從以下選項中選擇：

新增姓名 — 將姓名和電話號碼儲存至通訊錄中

複製 — 將姓名和電話號碼從內部通訊錄一次性全部複製到或逐個複製到 SIM 通訊錄中，反之亦可。

■ 電筒

要開啓或關閉電筒，選擇**功能表 > 附加功能 > 電筒 > 開或關**。

■ 多本通訊錄

您的手機最多可支援五本獨立的通訊錄，以供多個用戶使用。啓動多本通訊錄後，僅可顯示當前使用的通訊錄中的聯絡人。

要啓動多本通訊錄功能，選擇**功能表 > 通訊錄 > 設定 > 多本通訊錄 > 通訊錄樣式 > 多個通訊錄**。要啓動

您的手機

其中一本通訊錄，選擇**功能表 > 通訊錄 > 設定 > 多本通訊錄 > 當前通訊錄**，然後選擇所需通訊錄或選擇共用內容。

同一個聯絡人可以屬於一本或多本通訊錄。共用內容中的聯絡人可以顯示在所有通訊錄中。要將某個聯絡人指定給一本或多本通訊錄，選擇**功能表 > 通訊錄 > 設定 > 多本通訊錄 > 管理聯絡人**。捲動至想要的聯絡人，然後選擇該聯絡人。標記您想要儲存該聯絡人的通訊錄，然後選擇**完成 > 確認**。

要重新命名通訊錄，選擇**功能表 > 通訊錄 > 設定 > 多本通訊錄 > 重新命名通訊錄**及所需通訊錄。

3. 電池資料

■ 充電與放電

本裝置由充電電池供電。電池可以充電、放電數百次，但最終亦會失效。當通話與待機時間明顯短於正常時間的時候，請更換電池。請僅使用諾基亞認可的電池，並僅使用諾基亞認可、指定用於本裝置的充電器為電池充電。

如果替換的電池是第一次使用或如果電池長時間沒有使用，在開始為電池充電時，您可能需要將電池連接至充電器然後斷開，之後再連接。

不使用充電器時將其從電源插座及裝置中拔出。不要將完全充電的電池連接至充電器，因為過分充電可能會縮短其壽命。如果已完全充電的電池擱置不用，其本身便會不斷放電。

如果電池已完全沒電，可能要過幾分鐘充電指示符號才會出現在螢幕上或才能撥打電話。

電池資料

請勿將電池用作其他用途。請勿使用損壞的充電器或電池。

請勿使電池短路。當金屬物品(如硬幣、萬字夾或筆)直接接觸電池的正極(+)及負極(-)時，可能會發生意外短路。(它們看上去像電池上的小金屬條)。例如當您將備用電池放在口袋或背包中時，就有可能發生這種情況。電極的短路將會造成電池或觸及物品的毀損。

將電池置於極熱或極冷的地方(例如，夏季和冬季時將電池放在封閉的車內)，會降低電池容量，縮短電池壽命。請盡量把電池保持在 15 °C 至 25 °C (59 °F 及 77 °F) 之間。如果裝上過熱或過冷之電池，即使電池電量充足，裝置亦可能暫時無法操作。電池的效能在冰點以下將大打折扣。

切勿將電池丟入火中，因其可能發生爆炸。電池受損壞時亦可能發生爆炸。請依當地的法例規定處理電池。請盡量回收以循環再用。請勿將電池當成家庭廢棄物丟棄。

請勿拆開或拆毀電池。在電池滲漏的情況下，盡量避免讓滲出的液體接觸皮膚或眼睛。如果上述滲漏情況發生，請立即用清水沖洗皮膚或眼睛，或尋求醫療協助。

■ 諾基亞電池認證指引

爲了您的安全，請堅持使用諾基亞原廠電池。要證實您購買的是一枚諾基亞的原廠電池，應向一間獲授權的諾基亞經銷商購買，及使用以下的步驟檢查全息影像標籤：

成功完成以下步驟並不能完全保證電池的可靠性。如果您有任何理由相信您的電池不是可靠的諾基亞原廠電池，便應該停止使用，然後將其帶往最近的諾基亞授權服務點或經銷商尋求協助。如果不能確認可靠性，請將電池送回至您購買的地方。

授權全息影像

1. 當您查看標籤上的全息影像，您應該從一個角度看到諾基亞的牽手符號，及從另一個角度看到諾基亞的原廠增強配套標誌。
2. 當您從左、右、下和上角度注視全息影像時，應該可以在每邊分別看到 1、2、3、4 點。



如果您的電池不是可靠的電池怎麼辦？

如果您不能透過您諾基亞電池標籤上的全息影像確認是否為可靠的諾基亞電池，請不要使用此電池。將其帶往最近的諾基亞授權服務點或經銷商尋求協助。使用未經製造商許可的電池可能造成危險，並可能導致操作失效和對您的裝置及其增強配套造成損壞。這樣亦會令裝置的所有許可和保養失效。

要尋找更多有關原廠諾基亞電池的資料，請瀏覽 www.nokia.com/battery。

4. 原廠增強配套

您的手機有更多齊備的增強配套可供選擇。請選擇符合您個人通訊需要的增強配套。

有關與本型號手機相兼容的原廠增強配套的資料，請瀏覽 www.nokia.com.hk。

如要獲取有關增強配套的供應情況，請向您當地的經銷商查詢。

有關附件及增強配套的幾條實用準則。

- 把所有配件及增強配套置於兒童不能觸及的地方。
- 切斷任何附件或增強配套的電源時，請握住插頭拔出，不要拉電線。
- 請定期檢查汽車中的增強配套是否安裝妥當並且操作正常。
- 僅容許合格的人員安裝複雜的車用增強配套。

只可使用手機生產商認可的電池、充電器及增強配套。使用其他類型產品可能令適用於電話的任何保證或擔保失效，並可能發生危險。

■ 電池

N1208/1209

類型	種類	通話時間*	待機時間*
BL-5CA	鋰電池	長達 3.5 小時	長達 350 小時

* 僅在某些最優化的網絡條件或環境中使用才能達到這些電池的通話及待機時間。電池實際的通話及待機時間可能視乎 SIM 卡、使用的功能、電池的使用時間及條件、電池所處的溫度、不同的網絡條件及更多其他因素而定，因此通話及待機時間可能明顯少於此處規定的時間。此外，使用鈴聲、免提、在數字模式下使用及使用其他消耗電量的功能及裝置用於通話的總時間均會影響待機時間。同樣地，裝置開啓的總時間及處於待機模式下的總時間亦會影響通話時間。

保養及維修

本裝置是採用優良技術設計的產品，務請小心使用。以下建議有助維護您裝置的保養。

- 請保持手機乾燥。雨水、濕氣與各種液體或水份可能含有腐蝕電路的礦物質。如果您的裝置被弄濕，請取出電池，等到裝置完全乾燥後再重新裝入電池。
- 請勿將裝置存放在佈滿灰塵、髒亂的地方或在此類地方使用裝置。活動式的零件和電子元件可能較容易損壞。
- 請勿將裝置存放在高溫之處。高溫可能會縮短電子裝置的壽命、損壞電池，並使某些塑膠零件變形或溶化。
- 請勿將裝置存放在低溫之處。當裝置升溫至其正常的溫度時，其內部可能會產生濕氣，損壞電路板。
- 請勿嘗試違反本指南的說明自行拆卸裝置。

- 請勿扔擲、敲擊或搖晃裝置。粗暴的使用方式可能會破壞內部的電路板及精密構造。
- 請勿使用刺激性的化學製品、清潔溶劑或腐蝕性的清潔劑來清潔裝置。
- 請勿為裝置塗上顏料。塗料可能會妨礙裝置的活動式零件，影響正常使用。
- 僅使用隨裝置提供或經許可的天線。未經授權的天線、改裝或其他附件可能會破壞裝置，並可能違反無線裝置管制法。
- 請在室內使用充電器。
- 經常為您希望保留的數據 (例如通訊錄及日曆備註) 建立備份。
- 要經常重設裝置以獲取最佳性能，關閉裝置並除下電池。

這些建議同樣適用於本裝置、電池、充電器或其他任何增強配套。若任何裝置不能正常工作，請到就近的授權服務處進行維修。

附加安全資料

■ 兒童

本裝置及其增強配套可能包括細小配件。請將配件置於兒童無法觸及的地方。

■ 操作環境

請謹記，於任何場所均須遵守所有強制性的特殊規定，且在任何禁止使用手機或可能造成干擾或危險的場所，亦請務必關機。請僅以正常操作姿勢使用手機。當您以對著耳朵的正常姿勢使用裝置或當其置於距離您身體的至少 2.2 厘米 (7/8 英吋) 處時，此裝置符合 RF 暴露指引。請勿隨身攜帶含金屬材料的便攜套、皮帶扣或機架，並應將裝置放在距離身體體如上所述的位置處。

要傳輸數據檔案或訊息，本裝置需要與網絡建立良好連接。在一些情況下，數據檔案或訊息可能會被延遲直至這些連接可以使用。請確保遵守上述間距說明，直到傳輸順利完成。

裝置某些部分具有磁性。裝置可能會吸引金屬物件。請勿將信用卡或其他磁性儲存媒體放在裝置附近，該媒體內儲存的資料可能因此被清除。

■ 醫療設備

任何無線傳輸裝置的操作，包括無線電話，都可能會干擾防護不足的醫療設備之功能。請詢問醫生或醫療設備的製造商，確認這些設備是否可充分阻擋外部 RF 能量，或您的其他問題。請在醫療診所等區域張貼的相關法規指示下關閉裝置。醫院或醫療診所可能正在使用容易受外部 RF 能量影響的設備。

植入式醫療設備

醫療設備的製造商建議在無線裝置及植入式醫療設備(如心律調校器或植入式心律去顫器)之間保持最少 15.3 厘米 (6 英吋) 的距離，以免對醫療設備產生干擾。配戴此類設備的人應該遵守以下規定：

- 當無線裝置開啓時，裝置與醫療設備之間的距離經常保持在 15.3 厘米 (6 英吋) 以上。
- 不要將無線裝置放在胸前的口袋。

附加安全資料

- 以沒有使用心律調校器那一邊的耳朵接聽電話，將干擾的可能性減至最低。
- 如果有任何理由懷疑產生干擾，請立即關閉裝置。
- 閱讀及遵循植入式醫療設備製造商的指引。

如果您對將無線裝置及植入式醫療設備一起使用有任何疑問，請向您的醫師查詢。

助聽器

有些數碼無線裝置可能會干擾助聽器。如果產生干擾，請向您的服務供應商查詢。

■ 汽車

無線電頻率(RF)信號可能會影響汽車上未適當安裝或未妥善隔絕的電子系統(如電子燃油噴注系統、電子防滑(防鎖)剎車系統、電子速控系統及安全氣袋系統)。如要獲取更多資料，請向您汽車的製造商或代表或已添加至您汽車的裝置製造商或其代表查詢。

應僅由合格的專業人員維修裝置，或是在汽車中裝設裝置。錯誤的安裝或維修可能會產生危險，而且可能

使任何適用於該裝置的保養失效。請定期檢查汽車內所有的無線裝置設備是否安裝妥當並且操作正常。請勿將易燃液體、氣體或易爆物與裝置及其組件或增強配套置於同一汽車置物箱中。對於配備安全氣袋的汽車，請謹記會有一股巨大的力量充滿安全氣袋。請勿將物件 (包括固定及可攜式的無線設備) 放置在安全氣袋之上或安全氣袋可伸展到的地方。若車內的無線設備安裝不當，安全氣囊充氣脹大時可能會引致嚴重傷亡。

飛行中禁止使用本裝置。登機前請將關閉裝置。在飛機上使用無線電子裝置可能會危及飛機的操作安全、干擾無線通訊網絡，而且可能是違法的。

■ 可能發生爆炸的場所

請在任何可能發生爆炸的場所關閉裝置，並遵守所有的告示及指示。

可能發生爆炸的場所包括那些您通常會被告知要關閉交通工具引擎的地方。在這類地方產生的火花可能會造成爆炸或失火，導致身體受傷甚至死亡。在油站請關機，例如，在靠近油泵的服務站。遵守在加油站 (燃料存放及銷售區域)、化工廠或進行爆破工程的地

附加安全資料

方使用無線電裝備的限制。這類可能發生爆炸的地方通常 (但不一定) 會有清楚的標示。這些地方包括船的船身、化學品輸送或貯存的設施、使用液化石油燃料 (例如丙烷或丁烷) 的交通工具、空氣中含有化學物或微粒 (例如顆粒、塵埃或金屬粉末) 的地方。

■ 緊急電話



重要資料：本裝置正如其他無線電話一樣，利用電波信號、無線網絡、有線網絡及用戶可編制的功能操作。因此，無法保證這些功能在任何情況下都能使用。因此您不應僅依賴任何無線電話機進行重要通訊 (例如，緊急醫療事件)。

要撥打緊急電話：

1. 如果裝置沒有開機，請先開機。檢查收訊強度是否足夠。
有些網絡可能需將有效的 SIM 卡正確地插入裝置中。
2. 視情況按結束鍵所需次數以清除螢幕，使裝置作好通話準備。

3. 輸入您目前所在地的官方緊急號碼。各地區的緊急號碼可能有所不同。
4. 按通話鍵。

如果某些功能正在使用，則可能要先關閉這些功能才可撥打緊急電話。請參閱本指南或向您的服務供應商查詢以獲取更多資料。

當撥打緊急電話時，盡可能提供準確的必要信息。您的無線電話可能是發生意外情況時唯一的通訊途徑。當接到掛掉電話的指示後才可結束通話。

■ 許可證明 (SAR)

本流動裝置符合有關暴露於無線電波的國際準則。

本流動電話是一部無線電收發器。其設計不會超出由國際指引建議的無線電波暴露限制。這些指引是經由獨立的科學組織 (ICNIRP) 制定的，包括一個安全空間，以確保所有人的安全，不論其年齡和健康。

流動裝置的暴露指引運用了一組名為特別吸收率的測量數據，即 SAR。ICNIRP 指引中所述的 SAR 限制為平均每 10 克人體組織 2.0 瓦特/千克 (W/kg)。SAR 測試是以標準操作手機姿勢在所有測試頻帶中所檢定的

附加安全資料

最高功率之下進行的。裝置的實際 SAR 會遠遠低於其最大值，因為裝置的設計僅為使用達到接通網絡所需的功率。該數值由多項因素決定，例如：您與網絡基站之間的距離。在耳朵旁使用本裝置進行測試時，ICNIRP 準則規定的最高 SAR 值為 1.01 W/kg。

使用裝置配件及增強配套可能會導致不同的 SAR 值。SAR 值可能視乎國際報告、測試需求和網絡帶寬而有所不同。附加的 SAR 資料可能在 www.nokia.com 上的產品資料中提供。

索引

四畫

中文輸入 17

五畫

主要功能 15

充電與放電 30

可能發生爆炸的場所 42

六畫

在輸入法之間互相切換 ... 18

多本通訊錄 28

安全規定 4

安裝 SIM 卡和電池 9

七畫

助聽器 41

快速入門 9

汽車 41

八畫

使用智慧英文輸入法 23

使用傳統英文輸入法 23

兒童 39

附加安全資料 39

九畫

保養及維修 37

按鍵及插孔 14

拼音輸入法 21

為電池充電 11

十畫

原廠增強配套 35

訊息 26

十一畫

您的手機 14

許可證明 (SAR) 44

通訊錄 27

十二畫

喇叭 16

智慧字符輸入法 22

植入式醫療設備 40

筆劃輸入法 19

索引

開啓或關閉智慧英文 輸入法	22
開機和關機	12

十三畫

電池資料	30
類型	36
電筒	28
電量	36

十四畫

緊急電話	43
網絡服務	7

十五畫

撥打電話及接聽來電	16
-----------------	----

十六畫

操作環境	39
諾基亞網上支援	8
輸入文字的秘訣	25
輸入法	17
輸入法指示符號	17
輸入複合詞彙	25

十八畫

醫療設備	40
------------	----

十九畫

關於本裝置	7
-------------	---

Nokia 1208/1209

User's Guide

Copyright © 2008 Nokia. All rights reserved.

DECLARATION OF CONFORMITY

Hereby, NOKIA CORPORATION declares that this RH-105 product is in compliance with the essential requirements and other relevant provisions of Directive 1999/5/EC. A copy of the Declaration of Conformity can be found at http://www.nokia.com/phones/declaration_of_conformity/.

CE 0434

© 2008 Nokia. All rights reserved.

Nokia, Nokia Connecting People, and Navi are trademarks or registered trademarks of Nokia Corporation. Nokia tune is a sound mark of Nokia Corporation. Other product and company names mentioned herein may be trademarks or tradenames of their respective owners.

Reproduction, transfer, distribution, or storage of part or all of the contents in this document in any form without the prior written permission of Nokia is prohibited.

US Patent No 5818437 and other pending patents. T9 text input software Copyright (C) 1997-2008. Tegic Communications, Inc. All rights reserved.

Nokia operates a policy of ongoing development. Nokia reserves the right to make changes and improvements to any of the products described in this document without prior notice.

TO THE MAXIMUM EXTENT PERMITTED BY APPLICABLE LAW, UNDER NO CIRCUMSTANCES SHALL NOKIA OR ANY OF ITS LICENSORS BE RESPONSIBLE FOR ANY LOSS OF DATA OR INCOME OR ANY SPECIAL, INCIDENTAL, CONSEQUENTIAL OR INDIRECT DAMAGES HOWSOEVER CAUSED.

THE CONTENTS OF THIS DOCUMENT ARE PROVIDED "AS IS". EXCEPT AS REQUIRED BY APPLICABLE LAW, NO WARRANTIES OF ANY KIND, EITHER EXPRESS OR IMPLIED, INCLUDING, BUT NOT LIMITED TO, THE IMPLIED WARRANTIES OF MERCHANTABILITY AND FITNESS FOR A PARTICULAR PURPOSE, ARE MADE IN RELATION TO THE ACCURACY, RELIABILITY OR CONTENTS OF THIS DOCUMENT. NOKIA RESERVES THE RIGHT TO REVISE THIS DOCUMENT OR WITHDRAW IT AT ANY TIME WITHOUT PRIOR NOTICE. FOR THE MOST CURRENT PRODUCT INFORMATION, PLEASE REFER TO WWW.NOKIA.COM.HK.

The availability of particular products and applications and services for these products may vary by region. Please check with your Nokia dealer for details, and availability of language options.

This device may contain commodities, technology or software subject to export laws and regulations from the US and other countries. Diversion contrary to law is prohibited.

Contents

For your safety	4	3.Battery	
1.Get started.....	9	information	22
Install the SIM card and		Charging and discharging ...	22
battery.....	9	Nokia battery authentication	
Charge the battery.....	11	guidelines.....	24
Switch on and off	12	4.Genuine	
2.Your phone	14	Enhancements.....	27
Keys and parts.....	14	BATTERY	28
Main features.....	15	Care and	
Make and answer a call	16	maintenance.....	30
Loudspeaker	16	Additional safety	
Write text.....	17	information	32
Message.....	18	Index	39
Contacts.....	19		
Flashlight.....	20		
Multi-phonebook	20		

For your safety

Read these simple guidelines. Not following them may be dangerous or illegal. Read the complete user guide for further information.



SWITCH ON SAFELY

Do not switch the device on when wireless phone use is prohibited or when it may cause interference or danger.



ROAD SAFETY COMES FIRST

Obey all local laws. Always keep your hands free to operate the vehicle while driving. Your first consideration while driving should be road safety.



INTERFERENCE

All wireless devices may be susceptible to interference, which could affect performance.



SWITCH OFF IN HOSPITALS

Follow any restrictions. Switch the device off near medical equipment.

For your safety



SWITCH OFF IN AIRCRAFT

Follow any restrictions. Wireless devices can cause interference in aircraft.



SWITCH OFF WHEN REFUELING

Do not use the device at a refueling point. Do not use near fuel or chemicals.



SWITCH OFF NEAR BLASTING

Follow any restrictions. Do not use the device where blasting is in progress.



USE SENSIBLY

Use only in the positions as explained in the product documentation. Do not touch the antenna areas unnecessarily.



QUALIFIED SERVICE

Only qualified personnel may install or repair this product.



ENHANCEMENTS AND BATTERIES

Use only approved enhancements and batteries. Do not connect incompatible products.



WATER-RESISTANCE

Your device is not water-resistant. Keep it dry.



BACK-UP COPIES

Remember to make back-up copies or keep a written record of all important information stored in your device.



CONNECTING TO OTHER DEVICES

When connecting to any other device, read its user guide for detailed safety instructions. Do not connect incompatible products.



EMERGENCY CALLS

Ensure the phone function of the device is switched on and in service. Press the end key as many times as needed to clear the display and return to the standby mode. Enter the emergency number, then press the call key. Give your location. Do not end the call until given permission to do so.

■ About your device

The wireless device described in this guide is approved for use on the GSM 900 and GSM 1800 networks. Contact your service provider for more information about networks.

When using the features in this device, obey all laws and respect local customs, privacy and legitimate rights of others, including copyrights.



Warning: To use any features in this device, other than the alarm clock, the device must be switched on. Do not switch the device on when wireless device use may cause interference or danger.

■ Network services

To use the phone you must have service from a wireless service provider. Many of the features require special network features. These features are not available on all networks; other networks may require that you make specific arrangements with your service provider before you can use the network services. Your service provider can give you instructions and explain what charges will apply. Some networks may have limitations that affect how you can use network services. For instance, some networks may not support all language-dependent characters and services.

Your service provider may have requested that certain features be disabled or not activated in your device. If so, these features will not appear on your device menu. Your device may also have a special configuration such as changes in menu names, menu order, and icons. Contact your service provider for more information.

■ Nokia Support and Contact Information

For the latest version of this guide, downloads, services and additional information related to your Nokia product, please visit www.nokia.com.hk/support or your local Nokia web site.

Should you still require assistance, please refer to www.nokia.com.hk/contactus.

To check for the nearest Nokia care center location for maintenance services, you may like to visit www.nokia.com.hk/carecenter.

1. Get started

■ Install the SIM card and battery

Always switch the device off and disconnect the charger before removing the battery.

Keep all SIM cards out of the reach of small children.

For availability and information on using SIM card services, contact your SIM card vendor. This may be the service provider, network operator, or other vendor.

This phone is intended for use with the BL-5CA battery.

1. Slide the back cover to remove it (1). Lift the battery, and remove it (2).
2. Carefully lift the SIM card holder from the finger grip of the phone (3). Insert the SIM card into the holder, so that the beveled corner is on the upper right side and the gold-colored contact area is facing downward (4). Close the SIM card holder, and press it to lock it into place (5).

3. Replace the battery and back cover (6, 7).

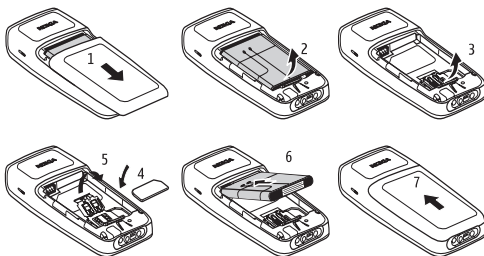

Note: Always switch off the power and disconnect the charger and any other device before removing the covers. Avoid touching electronic components while changing the covers. Always store and use the device with the covers attached.

■ Charge the battery



Warning: Use only batteries, chargers, and enhancements approved by Nokia for use with this particular model. The use of any other types may invalidate any approval or warranty, and may be dangerous.

Check the model number of any charger before use with this device. This device is intended for use when supplied with power from an AC-3 charger¹.

For availability of approved enhancements, please check with your dealer. When you disconnect the power cord of any enhancement, grasp and pull the plug, not the cord.

1. Connect the charger to a wall outlet.
2. Connect the charger to the phone.
The battery indicator bar starts scrolling. When the battery is fully charged, the bar stops scrolling.

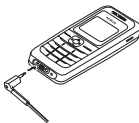

1. The exact model number of charger may vary depending on the type of plug. For example, the model numbers for AC-3 charger can be AC-3C, AC-3U, AC-3X, etc.



Tip: To save energy, unplug the charger when the battery is fully charged.

If the battery is completely discharged, it may take a few minutes before the charging indicator appears on the display or before any calls can be made.

■ Switch on and off

Press and hold the end key.

Use the phone only in its normal operating position.

Your device has an internal antenna.

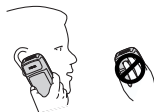

Note: As with any radio transmitting device, avoid touching an antenna unnecessarily when the antenna is in use. For example, avoid touching the cellular antenna during a phone call. Contact with a transmitting or receiving antenna affects the quality of the radio communication, may cause the device to operate at a higher power level than otherwise needed, and may reduce the battery life.

Get started



Note: Do not touch this connector as it is intended for use by authorized service personnel only.

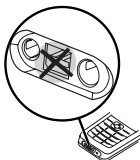

2. Your phone

■ Keys and parts

- Network name or operator logo (1)
- Network signal strength (2)
- Battery charge level (3)
- Earpiece (4)
- Loudspeaker (5)
- Flashlight (6)
- Selection key functions (7)
- Selection keys (8)
- Navi™ key (9), hereinafter scroll key
- Call key (10)
- End key/power key (11)

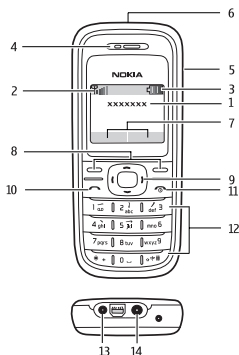

Your phone

- Keypad (12)
- Charger connector (13)
- Headset connector (14)

■ Main features

Select **Menu** to access the following features:

Messages—to create, send, open, and manage messages

Contacts—to save names and phone numbers in the SIM card and phone memory

Call register—to access phone numbers of missed, received, and dialed calls

Settings—to set up various features of your phone

Alarm clock—to set the time for the alarm

Reminders—to manage reminders

Games—to set up game effects or play the games installed in your phone

Extras—to access *Calculator*, *Converter*, *Countd. tim.*, *Calendar*, *Stopwatch*, *Composer*, *Demo*, *Chinese Lunar Calendar* and *Flashlight*

SIM services—to use additional services, if supported by your SIM card

■ Make and answer a call

To make a call, enter the phone number, including the country code and area code if necessary. Press the call key to call the number. Scroll right to increase or left to decrease the volume of the earpiece or headset during the phone call.

To answer an incoming call, press the call key. To reject the call without answering, press the end key.



■ Loudspeaker

If available, you may select **Loudsp.** or **Hands.** to use the loudspeaker or the earpiece of the phone during a call.



Warning: Do not hold the device near your ear when the loudspeaker is in use, because the volume may be extremely loud.

■ Write text

You can enter text using traditional text input  or predictive text input . To use traditional text input, press the key repeatedly until the letter appears. To turn on predictive text input when writing, select **Options** > *Dictionary* and the desired language; to turn it off, select **Options** > *Dictionary* > *Dictionary off*.

When using predictive text input, press each key once for a single letter. If the displayed word is the one you want, press **O**, and start writing the next word. To change the word, press ***** repeatedly until the word you want appears. If **?** is displayed after the word, the word is not in the dictionary. To add the word to the dictionary, select **Spell**, enter the word (using traditional text input), and select **OK**.

Tips for writing text: to add a space, press **O**. To quickly change the text input method, press **#** repeatedly, and

check the indicator at the top of the display. To add a number, press and hold the desired number key. To get a list of special characters when using traditional text input, press *; when using predictive text input, press and hold *. To undo the clearing of the message in editing window, select **Options** > *Undo clear*.

■ Message

The message services can only be used if they are supported by your network or service provider.

Your device supports the sending of text messages beyond the character limit for a single message. Longer messages are sent as a series of two or more messages. Your service provider may charge accordingly. Characters that use accents or other marks, and characters from some language options like Chinese, take up more space limiting the number of characters that can be sent in a single message.

1. Select **Menu** > *Messages* > *Create message*.
2. Write the message.

Your phone

3. To send the message, select **Options** > *Send*, enter the recipient's phone number, and select **OK**.



Note: Your device may indicate that your message was sent to the message center number programmed into your device. Your device may not indicate whether the message is received at the intended destination. For more details about messaging services, contact your service provider.

To delete all read messages or all the messages in a folder, select **Menu** > *Messages* > *Delete messages* > *All read* or the desired folder.

■ Contacts

You can save names and phone numbers in the phone memory and in the SIM card memory. The internal phone book can store up to 200 names.

To search for a contact, scroll down in the standby mode, and enter the first letters of the name. Scroll to the name that you want.

You can also select **Menu** > *Contacts* and from the following options:

Add contact—to save names and phone numbers in the phone book

Copy—to copy names and phone numbers all at once or one by one from the internal phone book to the SIM phone book, or vice versa

■ Flashlight

To turn the flashlight on or off, select **Menu** > *Extras* > *Flashlight* > *On or Off*.

■ Multi-phonebook

Your phone supports up to five separate phonebooks for multiple users. When the multi-phonebook is activated, only the contacts in the active phonebook are visible.

To activate the multi-phonebook, select **Menu** > *Contacts* > *Settings* > *Multi-Phonebook* > *Phonebook style* > *Multi-Phonebk..* To activate a phonebook, select

Your phone

Menu > *Contacts* > *Settings* > *Multi-Phonebook* > *Current phonebook* and the desired phonebook or *Shared cont.*.

A contact can belong to one or several phonebooks. The contacts in *Shared cont.* are accessible from all phonebooks. To assign a contact to one or several phonebooks, select **Menu** > *Contacts* > *Settings* > *Multi-Phonebook* > *Manage contacts*. Scroll to the desired contact, and select it. Mark the phonebooks in which you want to save the contact, and select **Done** > **Yes**.

To rename the phonebooks, select **Menu** > *Contacts* > *Settings* > *Multi-Phonebook* > *Rename phonebooks* and the desired phonebook.

3. Battery information

■ Charging and discharging

Your device is powered by a rechargeable battery. The battery can be charged and discharged hundreds of times, but it will eventually wear out. When the talk and standby times are noticeably shorter than normal, replace the battery. Use only Nokia approved batteries, and recharge your battery only with Nokia approved chargers designated for this device.

If a replacement battery is being used for the first time or if the battery has not been used for a prolonged period, it may be necessary to connect the charger, then disconnect and reconnect it to begin charging the battery.

Unplug the charger from the electrical plug and the device when not in use. Do not leave a fully charged battery connected to a charger, since overcharging may shorten its lifetime. If left unused, a fully charged battery will lose its charge over time.

B a t t e r y i n f o r m a t i o n

If the battery is completely discharged, it may take several minutes before the charging indicator appears on the display or before any calls can be made.

Use the battery only for its intended purpose. Never use any charger or battery that is damaged.

Do not short-circuit the battery. Accidental short-circuiting can occur when a metallic object such as a coin, clip, or pen causes direct connection of the positive (+) and negative (-) terminals of the battery. (These look like metal strips on the battery.) This might happen, for example, when you carry a spare battery in your pocket or purse. Short-circuiting the terminals may damage the battery or the connecting object.

Leaving the battery in hot or cold places, such as in a closed car in summer or winter conditions, will reduce the capacity and lifetime of the battery. Always try to keep the battery between 15°C and 25°C (59°F and 77°F). A device with a hot or cold battery may not work temporarily, even when the battery is fully charged. Battery performance is particularly limited in temperatures well below freezing.

Do not dispose of batteries in a fire as they may explode. Batteries may also explode if damaged. Dispose of batteries according to local regulations. Please recycle when possible. Do not dispose as household waste.

Do not dismantle or shred cells or batteries. In the event of a battery leak, do not allow the liquid to come in contact with the skin or eyes. In the event of such a leak, flush your skin or eyes immediately with water, or seek medical help.

■ **Nokia battery authentication guidelines**

Always use original Nokia batteries for your safety. To check that you are getting an original Nokia battery, purchase it from an authorised Nokia dealer, and inspect the hologram label using the following steps:

Successful completion of the steps is not a total assurance of the authenticity of the battery. If you have any reason to believe that your battery is not an authentic, original Nokia battery, you should refrain from using it, and take it to the nearest authorised Nokia service point or dealer for

Battery information

assistance. If authenticity cannot be verified, return the battery to the place of purchase.

Authenticate hologram

1. When you look at the hologram on the label, you should see the Nokia connecting hands symbol from one angle and the Nokia Original Enhancements logo when looking from another angle.
2. When you angle the hologram left, right, down and up, you should see 1, 2, 3 and 4 dots on each side respectively.



What if your battery is not authentic?

If you cannot confirm that your Nokia battery with the hologram on the label is an authentic Nokia battery, please do not use the battery. Take it to the nearest authorised Nokia service point or dealer for assistance. The use of a battery that is not approved by the manufacturer may be dangerous and may result in poor performance and damage to your device and its enhancements. It may also invalidate any approval or warranty applying to the device.

To find out more about original Nokia batteries, visit www.nokia.com/battery.

4. Genuine Enhancements

A new extensive range of enhancements is available for your phone. Select the enhancements which accommodate your specific communication needs.



For more information on the enhancements compatible with this device, please visit <http://www.nokia.com.hk>.

For availability of the enhancements, please check with your local dealer. A few practical rules for enhancements operation:

- Keep the enhancements out of small children's reach.
- When you disconnect the power cord of any accessory, grasp and pull the plug, not the cord.
- Check regularly that all mobile phone equipment in a vehicle is dismounted and operating properly.
- Installation of any complex car enhancements must be made by qualified personnel only.

Use only batteries, chargers and enhancements approved by the phone manufacturer. The use of any other types may invalidate any approval or warranty applying to the phone, and may be dangerous.

■ BATTERY

N1208/1209

Type	Tech	Talktime *	Standby Time *
BL-5CA	Li-Ion	up to 3.5 hours	up to 350hours

#These battery talk and standby times can only be reached in certain optimized network conditions or surroundings. The actual battery talk and standby times may differ depending on SIM card, features used, battery age and condition, temperatures to which battery is exposed, different network conditions, and many other factors, so that the talk and standby times may be significantly shorter than given here. In addition, ringing tones, handsfree, use in digital mode, and other functions consume the power, and

Genuine Enhancements

the amount of time a device is used for calls will affect its standby time. Likewise, the amount of time that the device is turned on and in the standby mode will affect its talk time.

Care and maintenance

Your device is a product of superior design and craftsmanship and should be treated with care. The following suggestions will help you protect your warranty coverage.

- Keep the device dry. Precipitation, humidity, and all types of liquids or moisture can contain minerals that will corrode electronic circuits. If your device does get wet, remove the battery, and allow the device to dry completely before replacing it.
- Do not use or store the device in dusty, dirty areas. Its moving parts and electronic components can be damaged.
- Do not store the device in hot areas. High temperatures can shorten the life of electronic devices, damage batteries, and warp or melt certain plastics.
- Do not store the device in cold areas. When the device returns to its normal temperature, moisture can form inside the device and damage electronic circuit boards.
- Do not attempt to open the device other than as instructed in this guide.

Care and maintenance

- Do not drop, knock, or shake the device. Rough handling can break internal circuit boards and fine mechanics.
- Do not use harsh chemicals, cleaning solvents, or strong detergents to clean the device.
- Do not paint the device. Paint can clog the moving parts and prevent proper operation.
- Use only the supplied or an approved replacement antenna. Unauthorized antennas, modifications, or attachments could damage the device and may violate regulations governing radio devices.
- Use chargers indoors.
- Always create a backup of data you want to keep, such as contacts and calendar notes.
- To reset the device from time to time for optimum performance, power off the device and remove the battery.

These suggestions apply equally to your device, battery, charger, or any enhancement. If any device is not working properly, take it to the nearest authorized service facility for service.

Additional safety information

■ Small children

Your device and its enhancements may contain small parts. Keep them out of the reach of small children.

■ Operating environment

Remember to follow any special regulations in force in any area, and always switch off your device when its use is prohibited or when it may cause interference or danger. Use the device only in its normal operating positions. This device meets RF exposure guidelines when used either in the normal use position against the ear or when positioned at least 2.2 centimeters (7/8 inches) from the body. When a carry case, belt clip, or holder is used for body-worn operation, it should not contain metal and should position the device the above-stated distance from your body.

To transmit data files or messages, this device requires a quality connection to the network. In some cases, transmission of data files or messages may be delayed until such a connection is available. Ensure the above separation distance instructions are followed until the transmission is completed.

A d d i t i o n a l s a f e t y i n f o r m a t i o n

Parts of the device are magnetic. Metallic materials may be attracted to the device. Do not place credit cards or other magnetic storage media near the device, because information stored on them may be erased.

■ Medical devices

Operation of any radio transmitting equipment, including wireless phones, may interfere with the functionality of inadequately protected medical devices. Consult a physician or the manufacturer of the medical device to determine if they are adequately shielded from external RF energy or if you have any questions. Switch off your device in health care facilities when any regulations posted in these areas instruct you to do so. Hospitals or health care facilities may be using equipment that could be sensitive to external RF energy.

Implanted medical devices

Manufacturers of medical devices recommend that a minimum separation of 15.3 centimeters (6 inches) should be maintained between a wireless device and an implanted medical device, such as a pacemaker or implanted cardioverter defibrillator, to avoid potential interference with the medical device. Persons who have such devices should:

A d d i t i o n a l s a f e t y i n f o r m a t i o n

- Always keep the wireless device more than 15.3 centimeters (6 inches) from the medical device when the wireless device is turned on.
- Not carry the wireless device in a breast pocket.
- Hold the wireless device to the ear opposite the medical device to minimize the potential for interference.
- Turn the wireless device off immediately if there is any reason to suspect that interference is taking place.
- Read and follow the directions from the manufacturer of their implanted medical device.

If you have any questions about using your wireless device with an implanted medical device, consult your health care provider.

Hearing aids

Some digital wireless devices may interfere with some hearing aids. If interference occurs, consult your service provider.

■ Vehicles

RF signals may affect improperly installed or inadequately shielded electronic systems in motor vehicles such as electronic fuel injection systems, electronic antiskid (antilock) braking systems, electronic speed control systems, and air bag systems. For more information,

A d d i t i o n a l s a f e t y i n f o r m a t i o n

check with the manufacturer, or its representative, of your vehicle or any equipment that has been added.

Only qualified personnel should service the device or install the device in a vehicle. Faulty installation or service may be dangerous and may invalidate any warranty that may apply to the device. Check regularly that all wireless device equipment in your vehicle is mounted and operating properly. Do not store or carry flammable liquids, gases, or explosive materials in the same compartment as the device, its parts, or enhancements. For vehicles equipped with an air bag, remember that air bags inflate with great force. Do not place objects, including installed or portable wireless equipment in the area over the air bag or in the air bag deployment area. If in-vehicle wireless equipment is improperly installed and the air bag inflates, serious injury could result.

Using your device while flying in aircraft is prohibited. Switch off your device before boarding an aircraft. The use of wireless teledevices in an aircraft may be dangerous to the operation of the aircraft, disrupt the wireless telephone network, and may be illegal.

■ Potentially explosive environments

Switch off your device when in any area with a potentially explosive atmosphere, and obey all signs and instructions. Potentially explosive atmospheres include areas where you would normally be

Additional safety information

advised to turn off your vehicle engine. Sparks in such areas could cause an explosion or fire resulting in bodily injury or even death. Switch off the device at refueling points such as near gas pumps at service stations. Observe restrictions on the use of radio equipment in fuel depots, storage, and distribution areas; chemical plants; or where blasting operations are in progress. Areas with a potentially explosive atmosphere are often, but not always, clearly marked. They include below deck on boats, chemical transfer or storage facilities, vehicles using liquefied petroleum gas (such as propane or butane), and areas where the air contains chemicals or particles such as grain, dust, or metal powders.

■ Emergency calls



Important: Wireless phones, including this device, operate using radio signals, wireless networks, landline networks, and user-programmed functions. Because of this, connections in all conditions cannot be guaranteed. You should never rely solely on any wireless device for essential communications like medical emergencies.

To make an emergency call:

1. If the device is not on, switch it on. Check for adequate signal strength.

A d d i t i o n a l s a f e t y i n f o r m a t i o n

Some networks may require that a valid SIM card is properly inserted in the device.

2. Press the end key as many times as needed to clear the display and ready the device for calls.
3. Enter the official emergency number for your present location. Emergency numbers vary by location.
4. Press the call key.

If certain features are in use, you may first need to turn those features off before you can make an emergency call. Consult this guide or your service provider for more information.

When making an emergency call, give all the necessary information as accurately as possible. Your wireless device may be the only means of communication at the scene of an accident. Do not end the call until given permission to do so.

■ Certification information (SAR)

This mobile device meets guidelines for exposure to radio waves.

Your mobile device is a radio transmitter and receiver. It is designed not to exceed the limits for exposure to radio waves recommended by international guidelines. These guidelines were developed by the independent scientific organization ICNIRP and include safety

Additional safety information

margins designed to assure the protection of all persons, regardless of age and health.

The exposure guidelines for mobile devices employ a unit of measurement known as the Specific Absorption Rate or SAR. The SAR limit stated in the ICNIRP guidelines is 2.0 watts/kilogram (W/kg) averaged over 10 grams of tissue. Tests for SAR are conducted using standard operating positions with the device transmitting at its highest certified power level in all tested frequency bands. The actual SAR level of an operating device can be below the maximum value because the device is designed to use only the power required to reach the network. That amount changes depending on a number of factors such as how close you are to a network base station. The highest SAR value under the ICNIRP guidelines for use of the device at the ear is 1.01 W/kg.

Use of device accessories and enhancements may result in different SAR values. SAR values may vary depending on national reporting and testing requirements and the network band. Additional SAR information may be provided under product information at www.nokia.com.

Index

A

Additional safety
information 32

B

BATTERY 28
Battery information 22

C

Care and maintenance 30
Charge the battery 11
Charging and discharging
22
Contacts 19

F

Flashlight 20

G

Get started 9

I

Install the SIM card and
battery 9

K

Keys and parts 14

L

Loudspeaker 16

M

Main features 15
Make and answer a call 16
Message 18
Multi-phonebook 20

N

Nokia battery
authentication guidelines
24
Nokia original
enhancements 27

S

Switch on and off 12

W

Write text 17

Y

Your phone 14