

AT-10 ES EB

1:10 ELECTRIC POWERED 2WD TRUCK & BUGGY

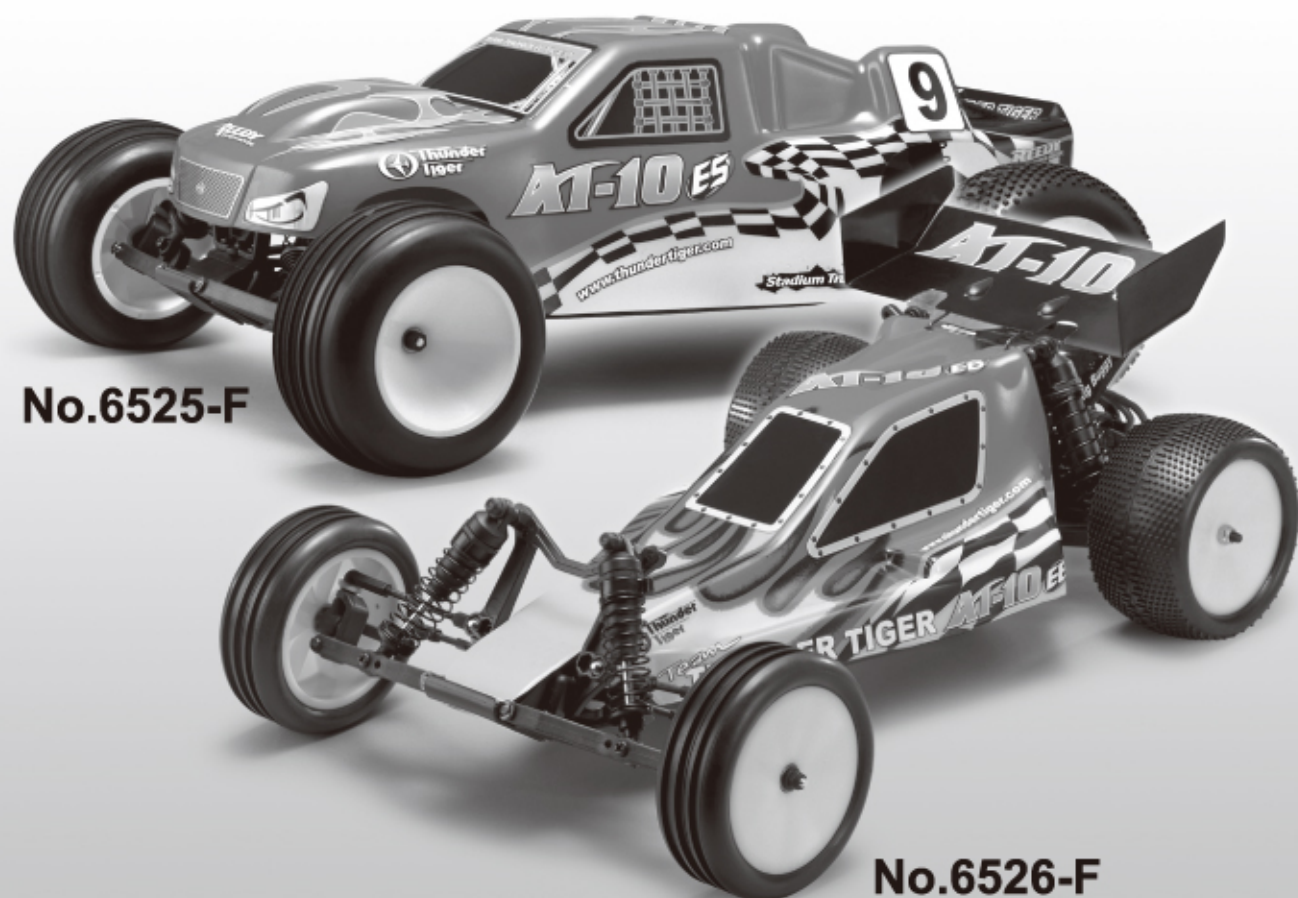

No.6525-F

No.6526-F



Please read all instructions thoroughly before operation.

The contents are subject to change without prior notice due to product improvements and specification changes.

INSTRUCTION MANUAL

WARRANTY

Thunder Tiger Corporation guarantees this model kit to be free from defects in both material and workmanship. The total monetary value under warranty will in no case exceed the cost of the original kit purchased. This warranty does not cover any components damaged by use or modification. Part or parts missing from this kit must be reported within 60 days of purchase. No part or parts will be sent under warranty without proof of purchase. To receive part or parts under warranty, the service center must receive a proof of purchase and/or the defective part or parts. Should you find a defective or missing part, contact the authorized Thunder Tiger Service/Distributor nearest you. Under no circumstances can a dealer or distributor accept return of a kit if assembly has started.

INTRODUCTION

Thank you for purchasing the Thunder Tiger AT-10 stadium truck / buggy. Thunder Tiger strives to bring you the highest level of quality and service we can provide. We race and test our products around the world to bring you state-of-the-art items.

This instruction manual contains the steps you will use to prepare and use your new vehicle. Please read all instructions and familiarize yourself with the systems and controls of this product before operating. You should enjoy many hours of trouble free use from this advanced R/C product. We offer on-line help 24-7 on our www.acehobby.com or www.thundertiger.com web site and our product specialists are ready to take your call if you have any technical questions. Have fun and enjoy the exciting world of R/C.

PRECAUTION

Thanks you for purchasing a Thunder Tiger product. **Please read all instructions thoroughly before operation.**

1. This product is not a toy. It is a high performance model product. It is important to familiarize yourself with the model, its manual, and its construction before assembly or operation. Children's operating under the supervision of the adults is necessary.
2. Do not operate model products in rain, on public roads, near crowds, near airport, or near areas with restricted radio operation.
3. This product, its parts, and its construction tools can be harmful to your health. Always exercise extreme caution when assembling and/or operating this product. Do not touch any part of model that rotates.
4. Check your radio frequency with the proper operating frequency of the area or country. Always check if there are any modelers operating on the same frequency as you are. Also, check your radio for proper operation before operating a model.
5. Use an adequate charger for the batteries and follow the instruction correctly.
6. Right after use, do not touch equipment on the model because they may generate high temperatures!
7. Do not stall the motor. The ESC may fail if power is applied to the motor when car cannot move freely.
8. Improper operations may cause personal and/or property damage. Thunder Tiger and its distributor have no control over damage resulting from shipping, improper building materials, construction, or improper usage.
9. By the act of assembling or operating this product, the user accepts all resulting liability. If the buyer is not prepared to accept this liability, then he/she return this product in new, unassembled, and unused condition to the place of purchase.

ITEMS REQUIRED FOR OPERATION

For Car



④ Ni-MH Battery Pack

2974 IB Ni-MH Batter Pack, 7.2V/IB3000
 2975 IB Ni-MH Batter Pack, 7.2V/IB3600
 2976 IB Ni-MH Batter Pack, 7.2V/IB3800
 2977 IB Ni-MH Batter Pack, 7.2V/IB4200

For Transmitter



④ Alkaline Batteries(8), AA-size



④ Power Charger (AC/DC Charger)

2605AC 110V/7.2-8.4V
 2606AC 230V/7.2-8.4V (2P)
 2607AC 230V/7.2-8.4V (3P)



④ Nose Plier, Philips Screwdriver, Allen Wrench

ITEMS INCLUDED



④ 2-Channel Surface or Pistol Radio with Standard Servo.



④ Electric Speed Control 8050 ACE R/C VELOCITY RS



④ Motor SUPER 17

TOOLS INCLUDED



④ Hex Wrench Set



④ 4-Way Wrench

1 INSTALLING STEERING SERVO LINKAGE (Skip if already assembled)

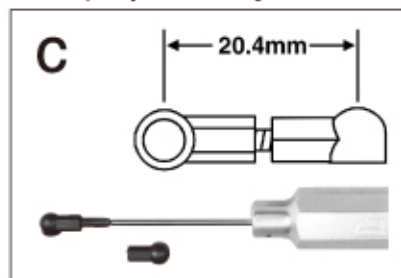
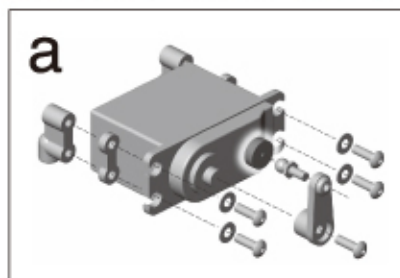

- a.** Find the appropriate servo horn for your servo. Remove the servo horn from your servo and replace with the stock horn, then fasten with the stock mounting screw. Install the ball end into the servo horn. Add the dust cover. Attach the mounts with the screws and washers. Add the spacers if you have an Airtronics servo.
- b.** Mount the servo with two screws.
- c.** Assemble the servo link, matching the length to the true scale drawing.
- d.** Use needle-nose pliers to attach link to ball ends.

2 INSTALLING THE RADIO GEAR (Skip if already assembled)

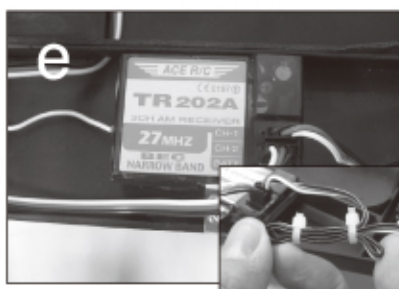
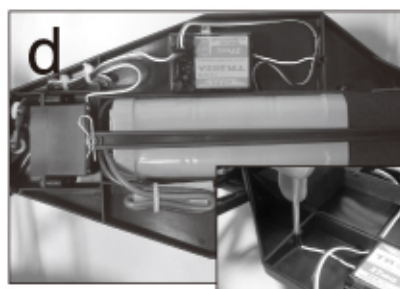
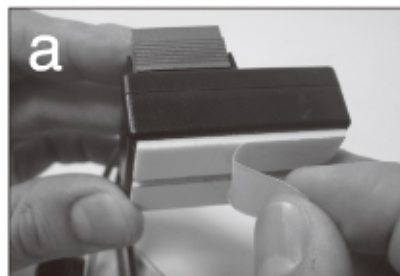

- a.** Attach speed control to chassis with a piece of double side tape.
- b.** Run the wire of the speed control through the battery slot area.
- c.** Cut a piece of double side tape, remove the paper from one side, and attach it to the bottom of your receiver.
- d.** Slip the receiver wire through the built-in chassis antenna mount. Remove the paper from the other side and attach to the chassis as shown.
- e.** Plug the small BEC plug into the receiver's on/off switch. Follow the instructions that accompany your radio receiver system. Use a small zip tie to organize the excess wiring.

3 PREPARING THE RADIO



- Install the antenna into transmitter.
- Check the frequency printed on the transmitter crystal.
- Check the frequency printed on the receiver crystal, and make sure it matches with the transmitter crystal. Make sure no one will operate on the same frequency when you are. When there is a radio glitch, it will most likely be caused by improper crystal, damaged crystal, or people operating on the same frequency.

4 INSTALLING THE BATTERY PACK (Battery products are not included in kit)



- Install 8 AA-size alkaline batteries into transmitter.
- Install the power pack (Flat type battery pack shown in the picture) and connect to the ESC.
- Caution:** Check all the wiring and connections before you connect the speed control to a drive battery. Incorrect polarity will wreck your speed control.

5 RADIO OPERATION



- When turning radio on, first turn on the transmitter.
- Then, turn on the receiver. When turning off, first turn the receiver off, then the transmitter off.
- To reverse the functions of servos, use the small, white servo reverse switches located on side of the pistol transmitter (or the inset servo reverse switches located at the bottom of the stick transmitter). To trim the servos on pistol transmitter, use the trim switches on side of the steering wheel (the ST trims steering, and the TH trims throttle/brake). On a stick transmitter, the trim levers are located accordingly around the sticks.
- Do not run flat the battery of your transmitter in case of losing control of the car.
- For more details, please check the transmitter instruction manual.

6 OPERATING RADIO STEERING FUNCTION

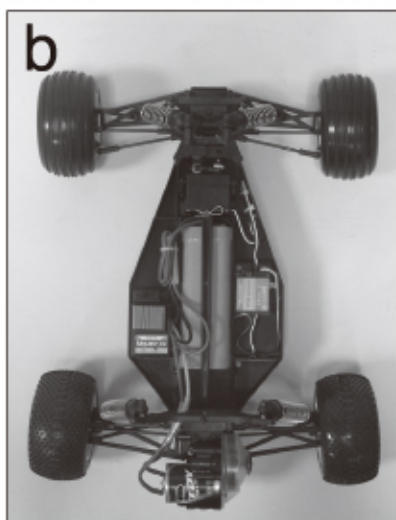

- Check the radio steering functions. With the radio transmitter and receiver on, turn the steering wheel/stick to the left. The front tires/wheels should turn left accordingly. If not, flip the steering servo reverse switch.
- Return the steering wheel/stick to neutral. The front tires/wheels should point straight forward. If not, use the steering trim lever to correct it.
- Turn the steering wheel/stick to the right. The front tires/wheels should turn right accordingly.

7 ADJUSTING ELECTRIC SPEED CONTROL (ESC)

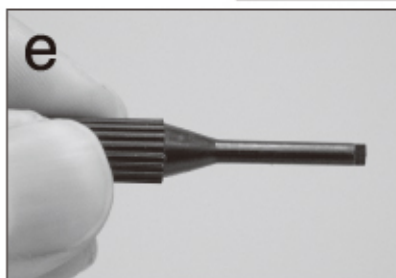

- Make sure the motor is disconnected or ensure some other way that the wheels are free to rotate.
- Turn the transmitter on.
- Connect your battery pack.
- Turn the power (ESC) switch on.
- Find the supplied tuning wand in the package or a small screwdriver.
- Hold the set-up button pressed in for at least 3 seconds using the plastic tuning wand supplied.

7 ADJUSTING ELECTRIC SPEED CONTROL (ESC)

(Picture shows the Ace R/C "Veloci-RS" electric speed control pre-installing on AT-10 Ready-To-Run version). Before operating your model, you have to set to either NEUTRAL, HIGH SPEED and BRAKE position of the electric speed control prior running the motor.

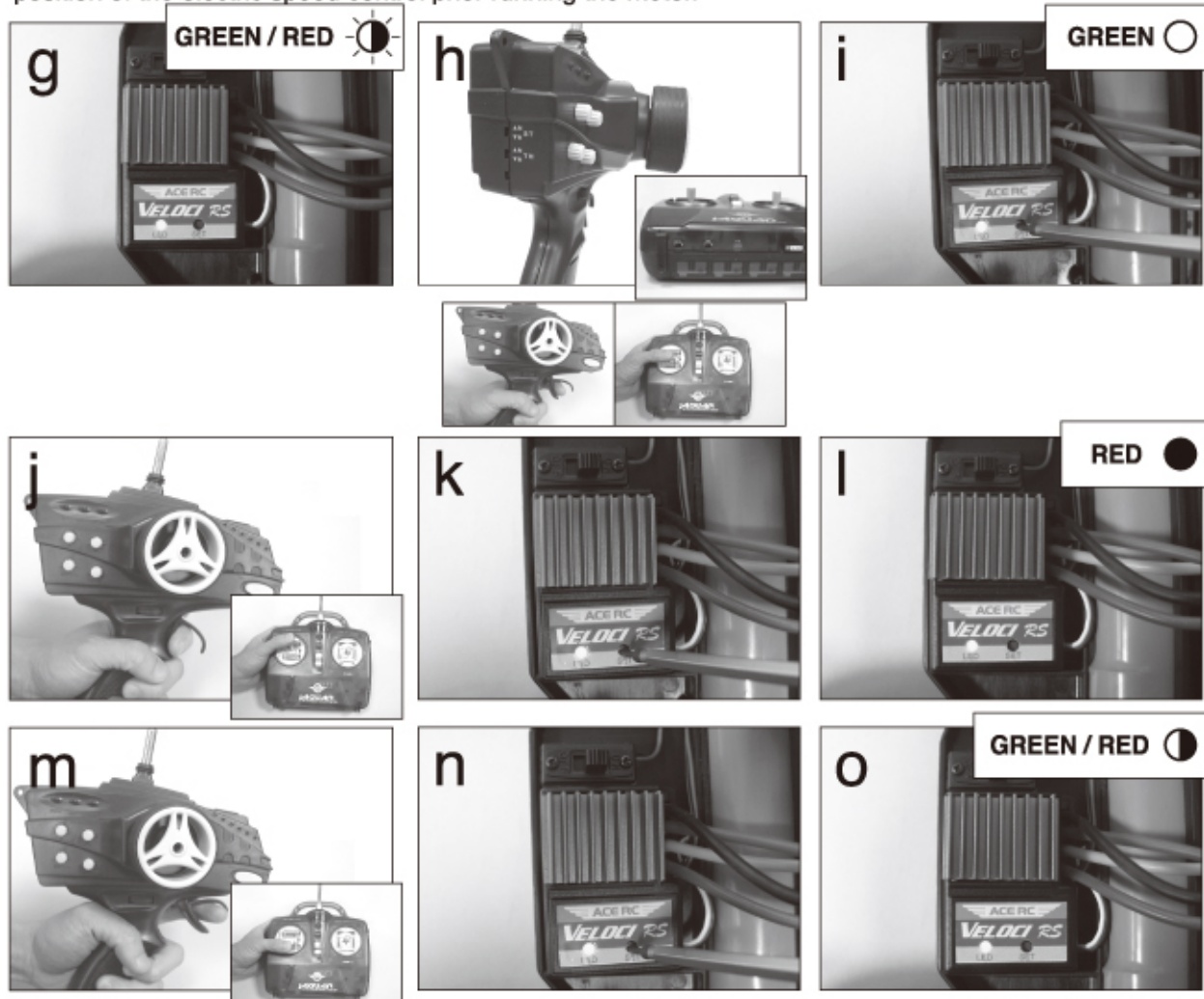

- g.** The set-up LED now flashes RED/GREEN to indicate that the ESC is in the set-up mode.
- h.** Leave the throttle stick at the neutral position and the throttle trim knob/lever in the middle
- i.** Press the set-up button, the neutral setting is now stored, and the set-up LED lightens GREEN.
- j.** Move the transmitter stick to full-throttle
- k.** Press the set-up button with the stick still in this position
- l.** The full-throttle setting is now stored, and the set-up LED lightens RED.
- m.** Move the transmitter stick to full brake
- n.** Press the set-up button with the stick still in this position.
- o.** The brake setting is now stored, and the set-up LED flashes 3 times simultaneously and then goes RED/GREEN light still.

CONGRATULATIONS!

Your electric speed control is now completely set-up and ready to run.

- Remember this! The transmitter is always the **FIRST TO BE TURNED ON** and **THE LAST TURNED OFF**.
- If you make a mistake during the set-up procedure, don't worry: disconnect the battery for about 10 seconds and start again from the first step.
- Refer to the instruction manual for more information on setting the electric speed control.

8 VELOCI SPECIAL FEATURE

The VELOCI digital speed controls feature a new overheat protection function. This function protects the VELOCI against overheating during operation. If the speed controls temperature exceeds safe levels, the motor function will be temporarily switched off. However, full steering function is still maintained during this period. When the overheat protection mode is activated, the setup LED will flash GREEN and RED simultaneously. Simply wait a few minutes to allow the speed control to cool down to normal operating temperatures and full function will be restored.

Overheating may be caused by the following:

- Driving in reverse in excess of 8 seconds.
- The motor used has less than factory limit of turns.
- Gear mesh is too tight or other drivetrain problems.
- Inappropriate gear ratios.
- Repeatedly going from full reverse to full forward instantaneously.
- Using full brakes too often.
- Not enough ventilation to the speed control.

9 BATTERY CHARGING (Battery products and charger are not included in kit)

- Make sure that the battery pack is completely discharged prior to charging. Discharging the battery pack by running the electric motor until it slows down or using a discharger (Not included).
- For best results, let the battery pack cool before charging. Heat may prevent the battery pack from charging to full capacity and also decreases the performance of the battery.
- Once the battery ready to be charged, first plug the AC quick charger into the outlet of AC power source, and then connect the battery input/output harness to the charger.
- Continued to monitor the battery as it is being charged. As soon as the battery is fully charged, disconnect the battery from the charger plug (Over-charging or charging incorrectly using inadequate chargers may cause the battery pack to become dangerously hot).

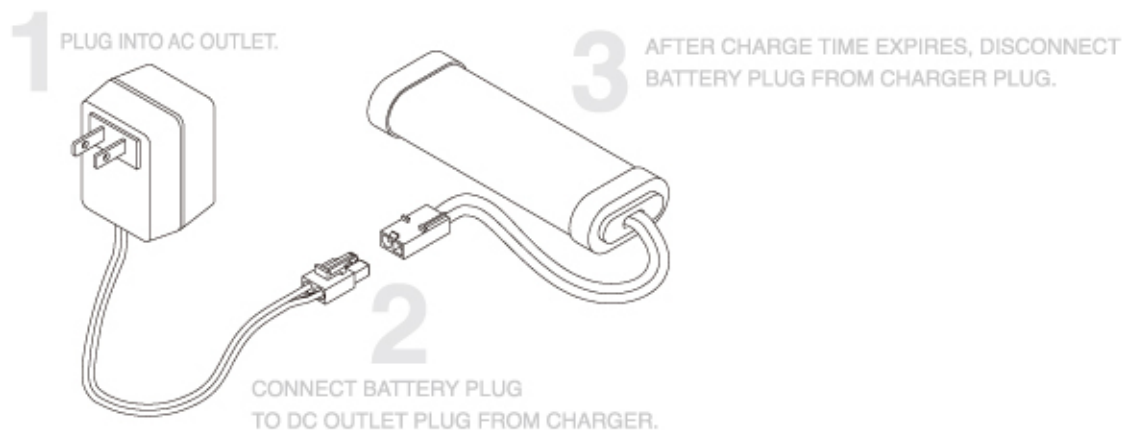

10 MAINTENANCE AFTER RUNNING

- Always turn off the radio system and disconnect the battery pack when the car is not in use.
- Remove the sand, mud, dirt, and any other elements completely from the car before you store it.
- Never use chemicals or any solvents to clean the chassis as it may cause damage to the electronics components and plastic parts as well. Use compressed air, soft paintbrush, or toothbrush to clean dust and dirt.