



X46-5000 / X55-5000 Series  
LED Backlight TV

X46-5000 / X55-5000系列  
LED背光源彩色电视

Quick Start Guide

快速使用指南



P/N: 4J.V2401.001

1

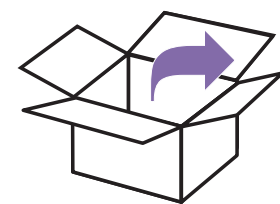

## Accessories 配件

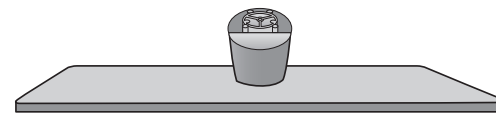
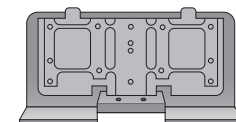
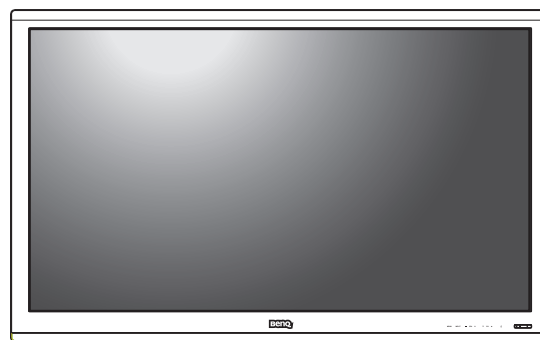

(You can remove the protection film  
on the base according to your needs.)

(您可以根据您的需求，  
决定是否移除底座的保护膜。)

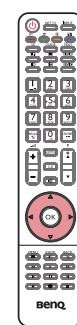

(The remote control may vary by sales region.)

(遥控器可能会依销售地区而有所不同。)

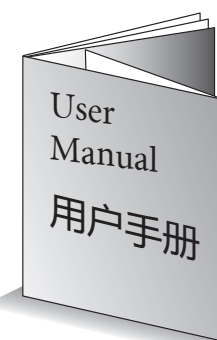
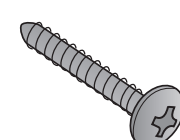
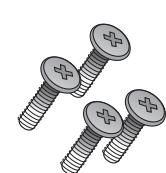
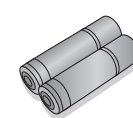

(The Warranty Card is  
available in China only.)

2

## Installation 安装

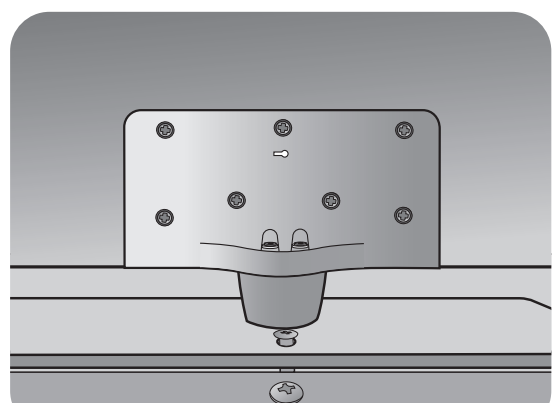
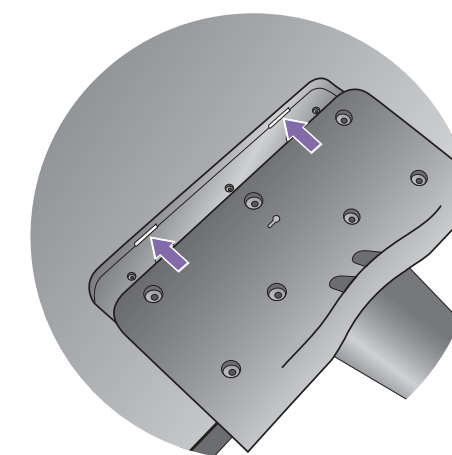
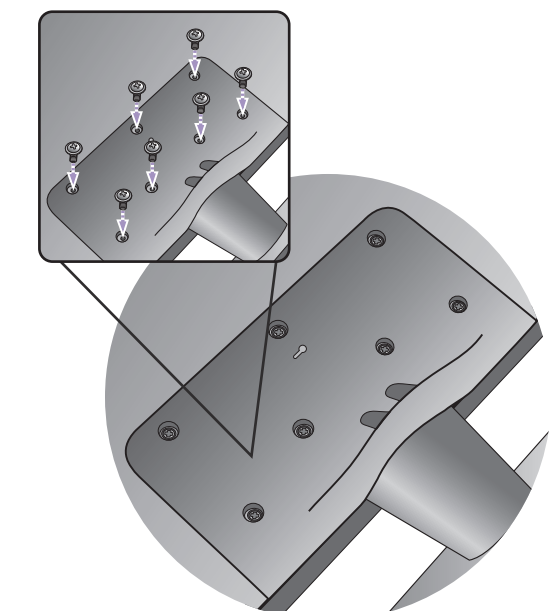
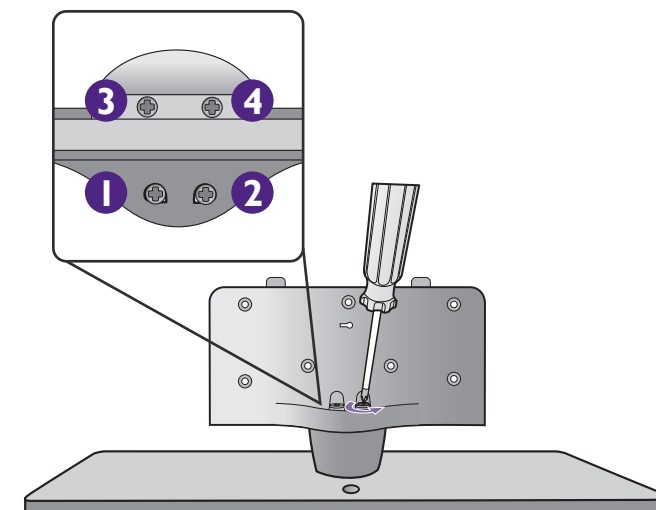
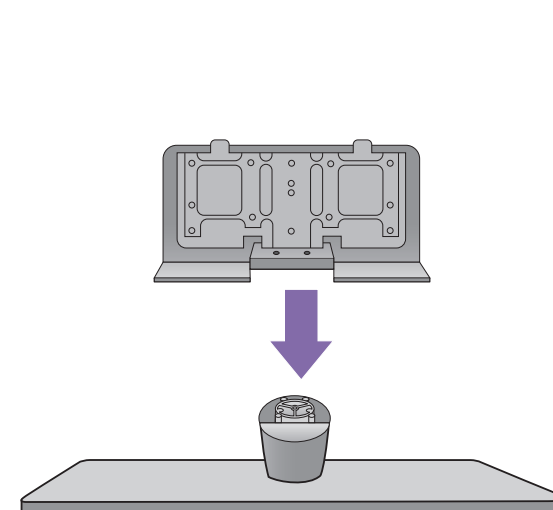

(If the environment permits, it is recommended  
using the accompanying long screw to fix the TV  
and its standing surface (wood preferred) together  
to avoid possible risk of dropping the TV due to  
earthquakes or other accidents.)

(如果环境允许，建议使用随附的长螺丝将电视  
及其站立的面（最好是木质）固定在一起，  
以避免因地震或其他意外事故可能摔落电视  
的风险。)

3

## Connection - I 连接 - I

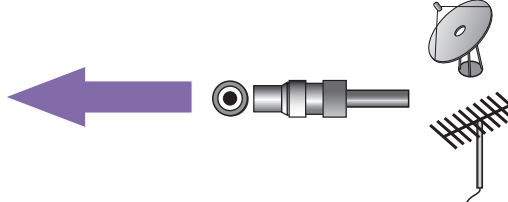
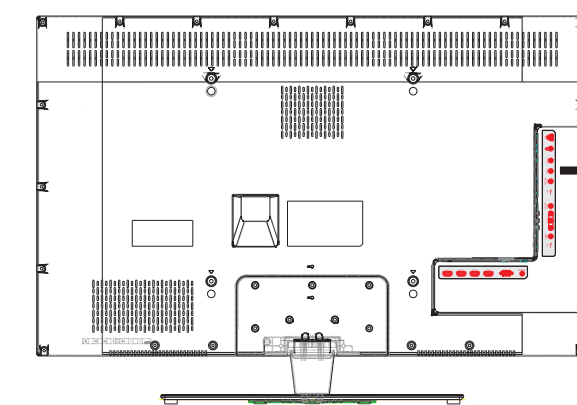

X46-5000

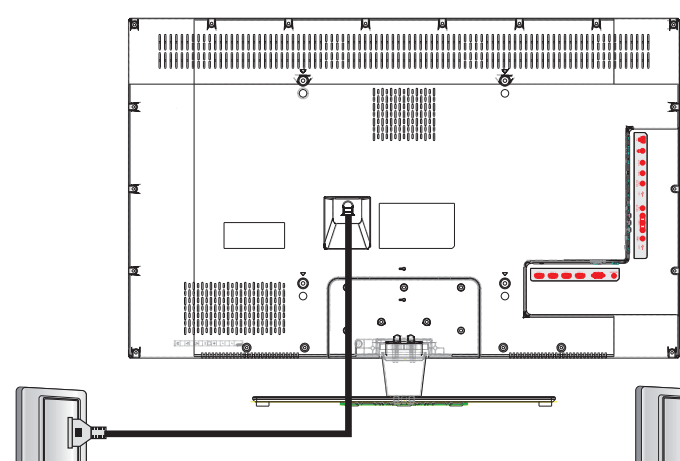

X55-5000

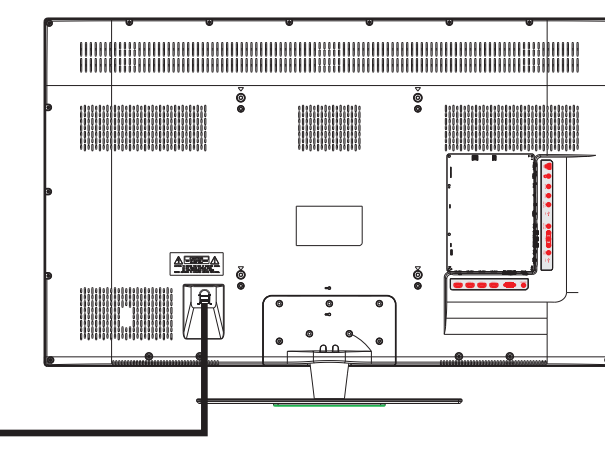

Power cord may vary  
by sales region, and thus  
could be different from  
the illustration. So, please  
see the accessories for  
actual contents.

电源线可能会因  
销售地区的不同  
而和附图有所差异，  
请以实际的附件为准。

## 4 Connection -2 连接 - 2

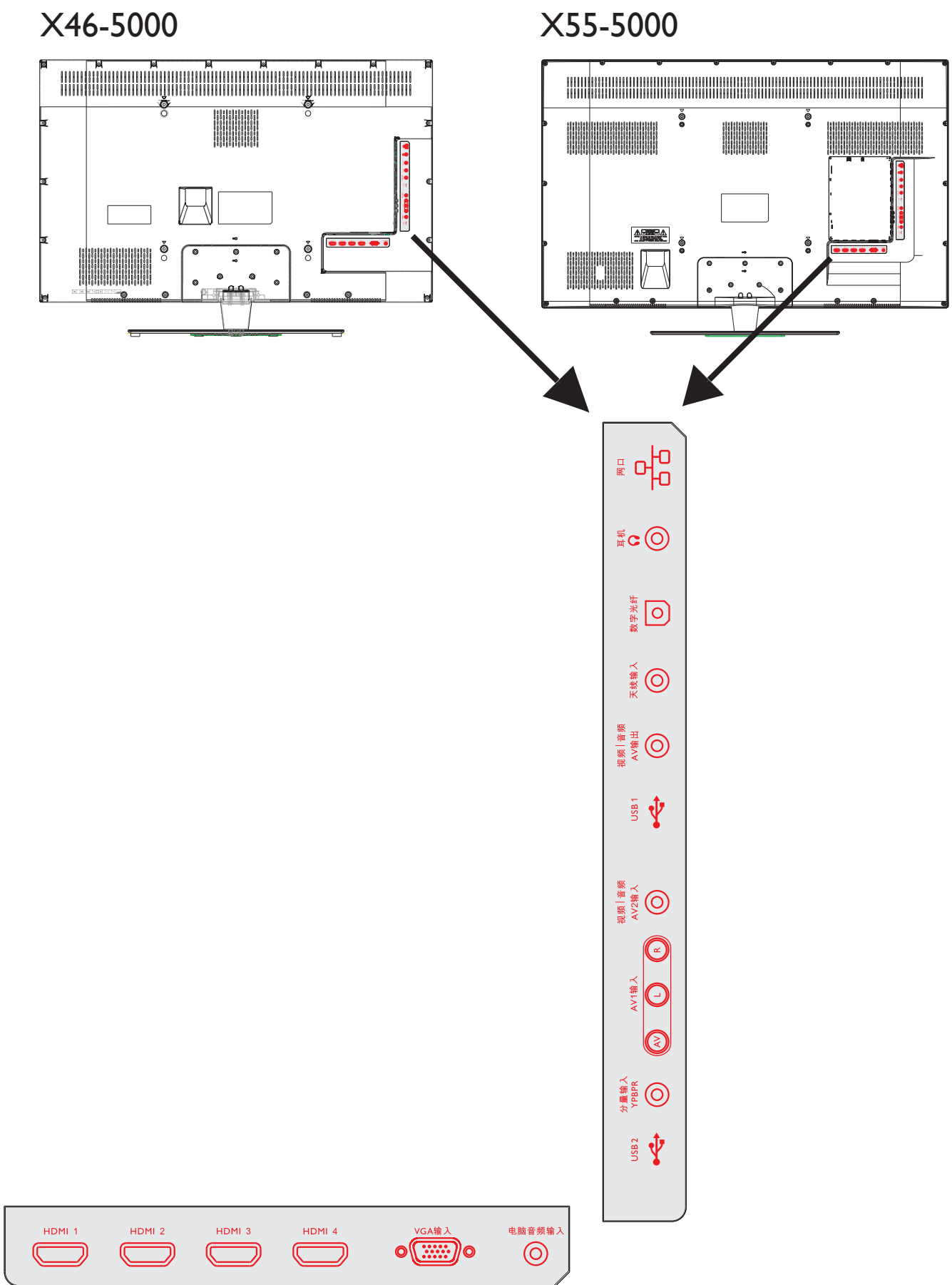

## 5 Control panel 控制面板

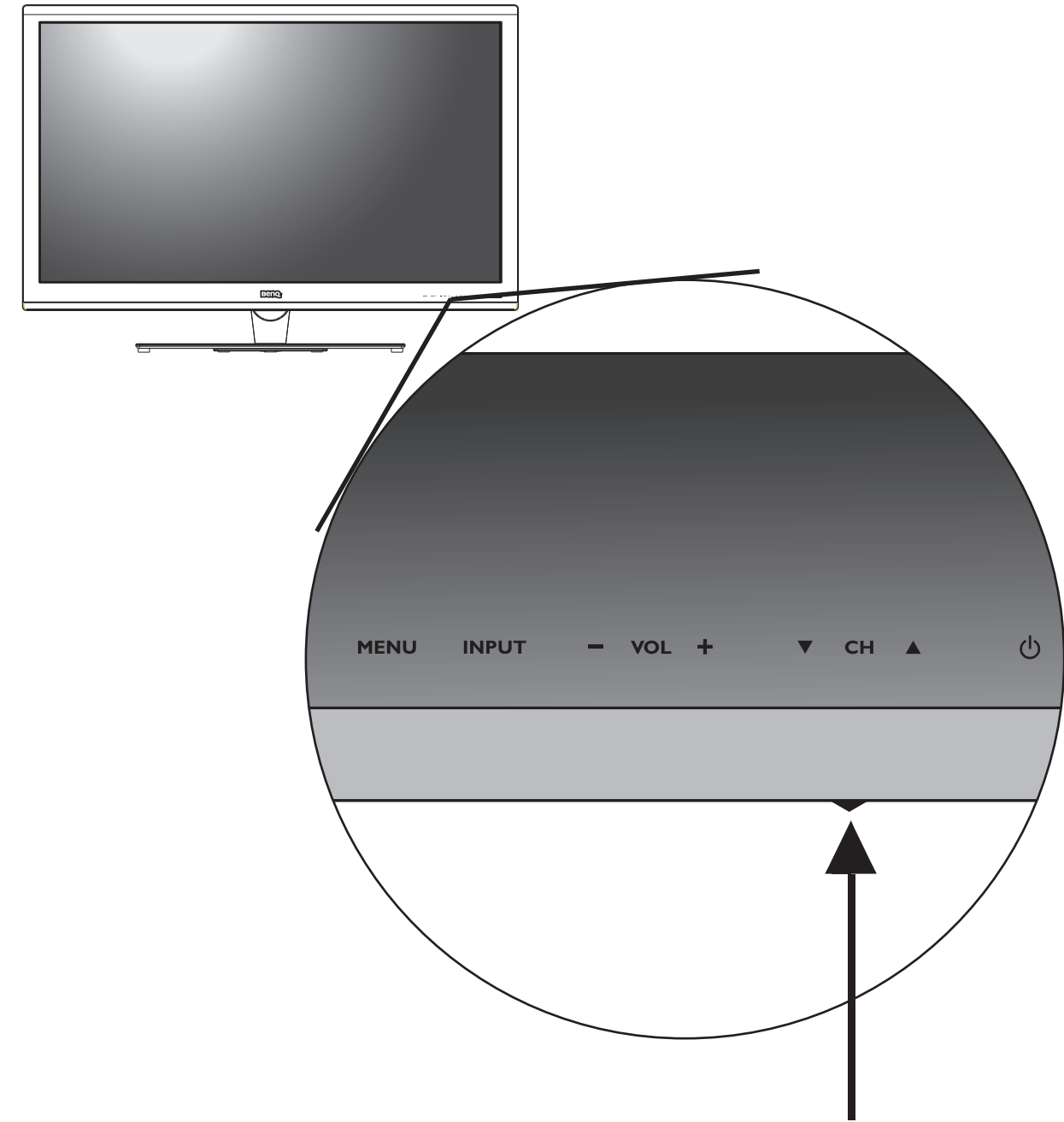

Please turn on the hard switch (as shown by the arrow) under the screen for successful power connection.

位于屏幕下方有一个硬开关 (如箭头所示), 请务必开启, 才能成功接通电源。

## 6 Power 电源

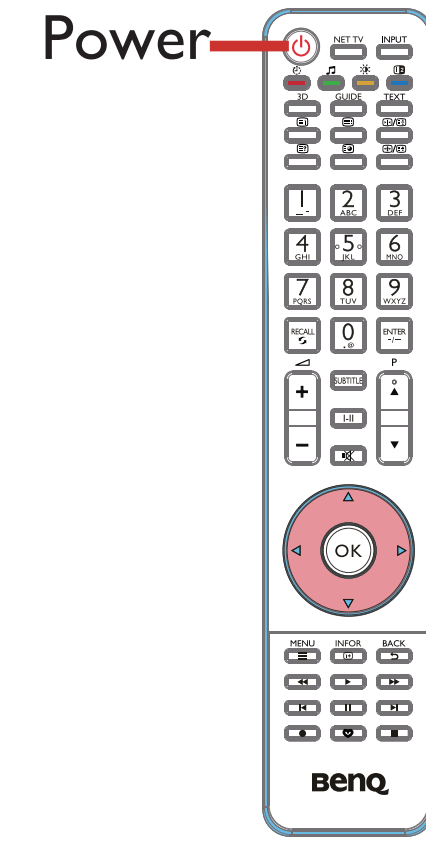

or

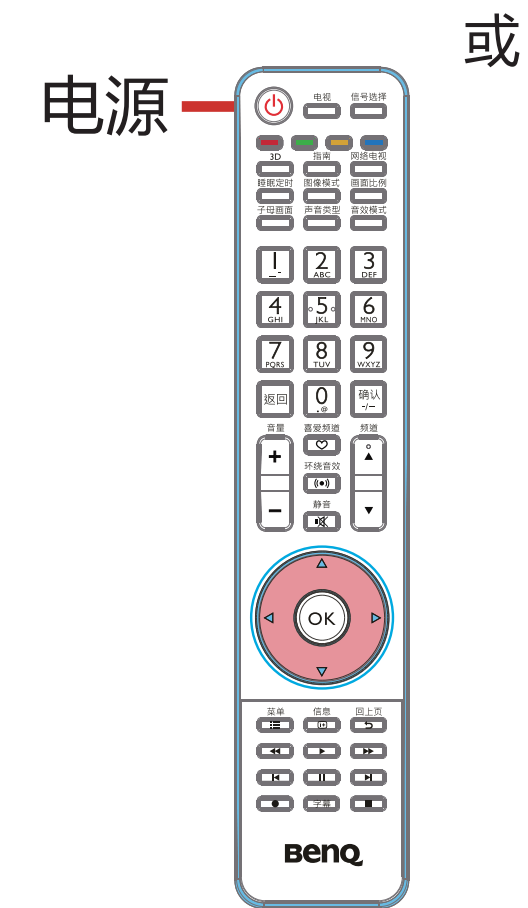

或

## 7

Turn on TV & see user manual for details.

打开电视并参照用户手册以获得进一步信息。

