

FAS - 100 Front Access Skimmer Owner's Manual

IMPORTANT SAFETY INSTRUCTIONS *READ AND FOLLOW ALL INSTRUCTIONS* SAVE THESE INSTRUCTIONS

Table of Contents

Section I. General Safety Procedures.	2
Section II. Installation Procedures.	2
Section III. Replacement Parts.	3

⚠ WARNING

IMPROPER INSTALLATION OR USE OF THIS PRODUCT MAY PRESENT A RISK OF HAIR OR BODY ENTRAPMENT AND DROWNING. Install this equipment in accordance with the instructions provided. Use only with the components and mounting hardware provided. FAILURE TO FOLLOW THESE INSTRUCTIONS AND/OR USE WITH COMPONENTS NOT PROVIDED BY PENTAIR POOL PRODUCTS AND INTENDED TO BE USED WITH THIS PRODUCT MAY RESULT IN IMPROPER POSITIONING OR FUNCTIONING OF DRAIN COVER AND MAY CAUSE SEVERE PERSONAL INJURY OR DEATH.

⚠ WARNING

Before installing this product, read and follow all warning notices and instructions accompanying this product. Failure to follow safety warnings and instructions can result in severe injury, death, or property damage. Call 1-800-831-7133 for additional free copies of these instructions.

Important Notice



Attention Installer.

This manual contains important information about the installation, operation and safe use of this product. This information should be given to the owner/operator of this equipment.

Pentair Pool Products

1620 Hawkins Ave., Sanford, NC 27330 • (919) 774-4151
10951 West Los Angeles Ave., Moorpark, CA 93021 • (805) 523-2400



Section I. General Safety Procedures

- A. The suction outlet to a swimming pool pump pulls a high vacuum. If pump is used with only one suction pipe, anyone blocking pump suction with hair or body will be trapped and held against the suction fitting. Disembowelment or drowning can result. To prevent entrapment, install at least two suction (outlet) fittings in pool. Separate these outlets by either of the following procedures.
1. Locate the outlets at least three (3) feet apart.
 2. Locate the outlets in two different planes, (for example, on two separate vertical side walls). Use multiple suction sources to reduce risk of entrapment. Failure to maintain fittings and covers can lead to severe injury or death. Use of fittings when covers are broken, loose or missing can lead to severe injury or death.
 - a. Consult your local building dept. for codes or ordinances that may apply.

Section II. Installation Procedures

- A. Punch or drill screw holes and punch or cut-out square in steel, aluminum or fiberglass panel section, as per the dimensions shown in Figure 1.
- B. Place the face of the skimmer opening up against the rear of the panel with the rear sealing gasket between the panel and the skimmer. Align the two retainer screw holes (diametrically opposite each other at the center of each side) of the rear gasket and the skimmer with those that were drilled or punched in the wall panel. Insert the two Fillister head retainer screws through the front of the pool wall through the rear gasket into the skimmer and tighten.

NOTE

The difference between the front and rear sealing gasket is the size of the retainer screw holes. The rear gasket has *smaller* holes through which go the retainer screws; the front gasket has *larger* holes to go over the heads of the retainer screws on the liner side of the panel.

- C. Install vinyl liner in the pool. Align front sealing gasket so the heads of the Fillister retainer screws are recessed in the two larger holes centered on each side of the front gasket. Align face plate and fasten tightly through the front gasket, the liner, the panel, and the rear gasket into the skimmer body with the ten flat Phillips Head screws provided. Be sure that the countersinks on the back of the face plate (each side) line up with the Fillister Heads of the retaining screws. You should pierce the liner through the face plate holes, one at a time, and insert and tighten each screw as its hole is pierced. Each screw should be inserted and tightened through (in proper order): the face plate, front sealing gasket, the liner, the panel, the rear sealing gasket, and into the skimmer throat facing.
- D. As a final step, cut out vinyl liner along inside edges of the face plate.

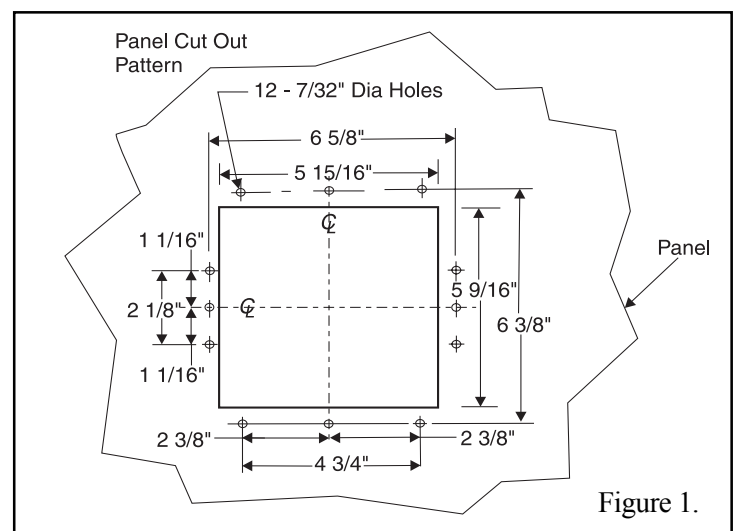
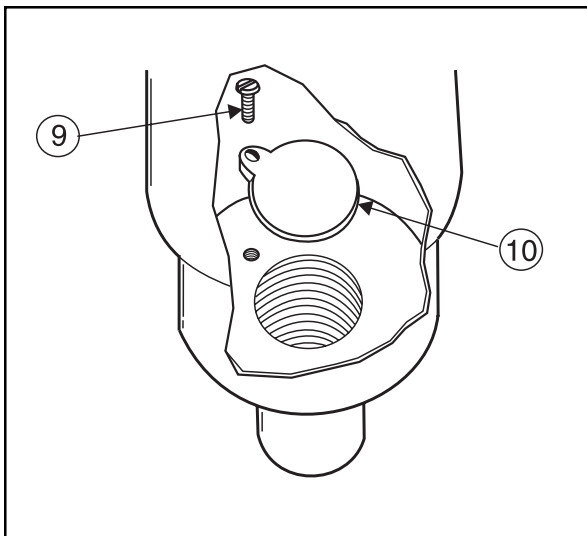
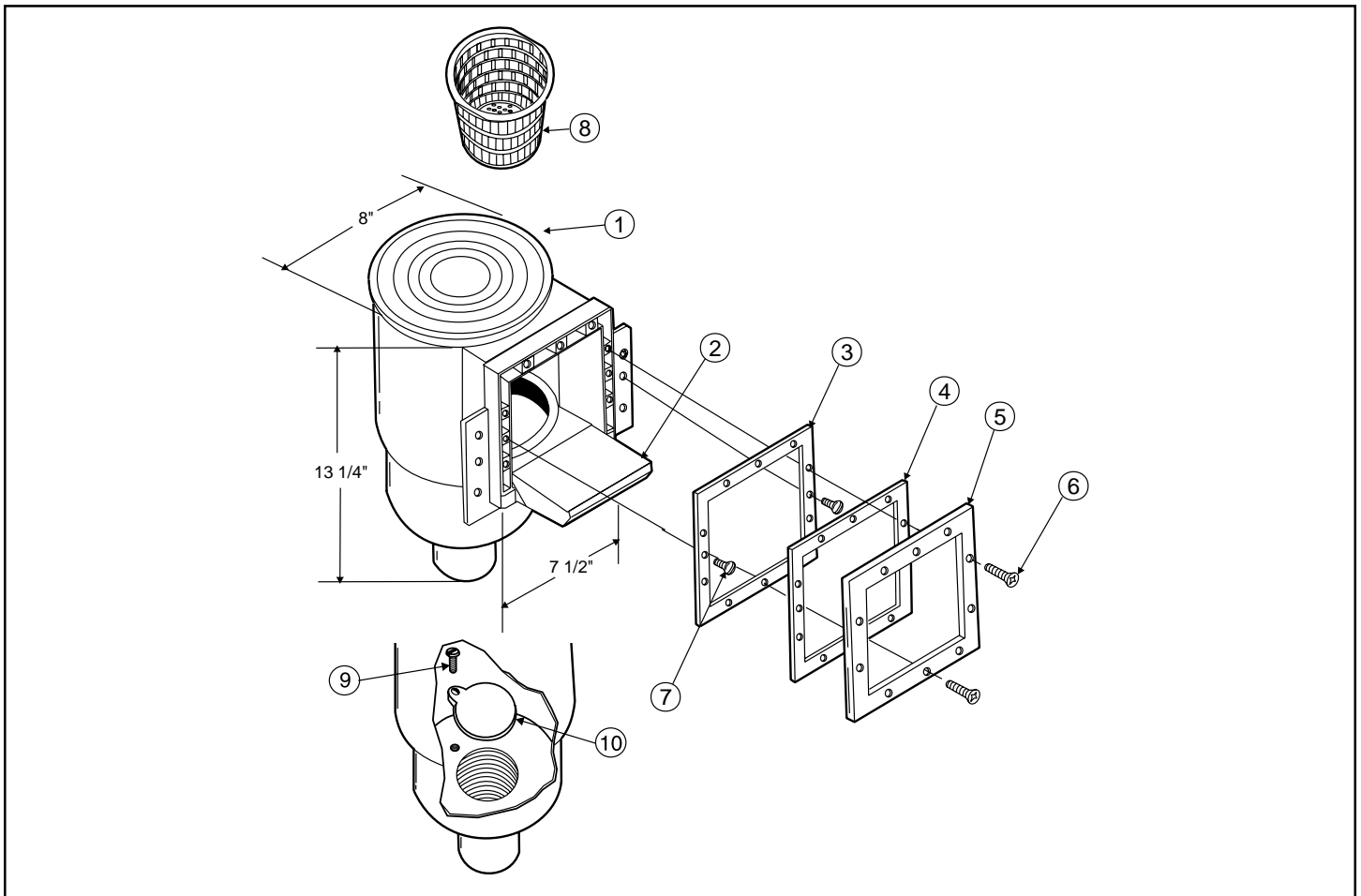

Figure 1.

Section III. Replacement Parts



Item	Part Number	Description
1	85004700	Cyclac Lid (for optional top access)
2	85003200	Flap Weir
3	85003300	Sealing Gasket - rear
4	85003400	Sealing Gasket - front
5	85004000	Cyclac Sealing Frame
6	98202900	13-16 x 1" S/S Hi-lo Flathead Phillips Sealing Screw, 10 req'd
6	98207200	13-16 x 1-1/4" Hi-lo, XL Sealing Screw, 10 req'd
7	98203000	13-16 x 3/4" S/S Hi-lo Panhead slotted Retainer Screw, 2 req'd
8	85003900	Strainer Basket
9	98204400	10-24 x 1/2" S/S Panhead Screw
10	85009600	Trimmer plate

SAVE THESE INSTRUCTIONS!

SAVE THESE INSTRUCTIONS!

Pentair Pool Products

1620 Hawkins Ave., Sanford, NC 27330 • (919) 774-4151
10951 West Los Angeles Ave., Moorpark, CA 93021 • (805) 523-2400

