

## Owner's Manual Compact Stereo System

Model No. SC-HC57

ENGLISH

ESPAÑOL



Thank you for purchasing this product.

For optimum performance and safety, please read these instructions carefully.

Please keep this manual for future reference.

If you have any questions, contact:

U.S.A. and Puerto Rico: 1-800-211-PANA (7262)

Canada: 1-800-561-5505

### **Included Installation Instructions (⇒ 2, 6)**

**The installation should never be done by any other than a qualified installation specialist.**

Before commencing work, carefully read these installation instructions and the operating instructions to ensure that installation is performed correctly.

(Please keep these instructions. You may need them when maintaining or moving this unit.)

La referencia rápida en español se puede encontrar en la página 20-21.

# IMPORTANT SAFETY INSTRUCTIONS

Read these operating instructions carefully before using the unit. Follow the safety instructions on the unit and the applicable safety instructions listed below. Keep these operating instructions handy for future reference.

- 1 Read these instructions.
- 2 Keep these instructions.
- 3 Heed all warnings.
- 4 Follow all instructions.
- 5 Do not use this apparatus near water.
- 6 Clean only with dry cloth.
- 7 Do not block any ventilation openings. Install in accordance with the manufacturer's instructions.
- 8 Do not install near any heat sources such as radiators, heat registers, stoves, or other apparatus (including amplifiers) that produce heat.
- 9 Do not defeat the safety purpose of the polarized or grounding-type plug. A polarized plug has two blades with one wider than the other. A grounding-type plug has two blades and a third grounding prong. The wide blade or the third prong are provided for your safety. If the provided plug does not fit into your outlet, consult an electrician for replacement of the obsolete outlet.
- 10 Protect the power cord from being walked on or pinched particularly at plugs, convenience receptacles, and the point where they exit from the apparatus.
- 11 Only use attachments/accessories specified by the manufacturer.
- 12 Use only with the cart, stand, tripod, bracket, or table specified by the manufacturer, or sold with the apparatus. When a cart is used, use caution when moving the cart/apparatus combination to avoid injury from tip-over.
- 13 Unplug this apparatus during lightning storms or when unused for long periods of time.
- 14 Refer all servicing to qualified service personnel. Servicing is required when the apparatus has been damaged in any way, such as power-supply cord or plug is damaged, liquid has been spilled or objects have fallen into the apparatus, the apparatus has been exposed to rain or moisture, does not operate normally, or has been dropped.



## WARNING

### Unit

- To reduce the risk of fire, electric shock or product damage,
  - Do not expose this unit to rain, moisture, dripping or splashing.
  - Do not place objects filled with liquids, such as vases, on this unit.
  - Use only the recommended accessories.
  - Do not remove covers.
  - Do not repair this unit by yourself. Refer servicing to qualified service personnel.

### Power cord

- Install this unit so that the power cord can be unplugged from the socket outlet immediately if any problem occurs.

### Button-type battery (Lithium battery)

- Risk of fire, explosion and burns. Do not disassemble, heat above 60 °C (140 °F) or incinerate.

If any electrolyte should come into contact with your hands or clothes, wash it off thoroughly with water.

If any electrolyte should come into contact with your eyes, never rub the eyes. Rinse eyes thoroughly with water, and then consult a doctor.

### <For USA-California only>

This product contains a CR Coin Cell Lithium Battery which contains Perchlorate Material – special handling may apply.

See [www.dtsc.ca.gov/hazardouswaste/perchlorate](http://www.dtsc.ca.gov/hazardouswaste/perchlorate).

## CAUTION

### Unit

- This unit utilizes a laser. Use of controls or adjustments or performance of procedures other than those specified herein may result in hazardous radiation exposure.
- Do not place sources of naked flames, such as lighted candles, on this unit.

### Placement

- To reduce the risk of fire, electric shock or product damage,
  - Do not install or place this unit in a bookcase, built-in cabinet or in another confined space. Ensure this unit is well ventilated.
  - Do not obstruct this unit's ventilation openings with newspapers, tablecloths, curtains, and similar items.

### Button-type battery (Lithium battery)

- Danger of explosion if battery is incorrectly replaced. Replace only with the type recommended by the manufacturer.
- When disposing the batteries, please contact your local authorities or dealer and ask for the correct method of disposal.
- Keep out of reach of children.
- Insert with poles aligned.
- Mishandling of batteries can cause electrolyte leakage and may cause a fire.
  - Remove batteries if you do not intend to use the remote control for a long period of time. Store in a cool, dark place.
  - Do not heat or expose to flame.
  - Do not leave the battery(ies) in a car exposed to direct sunlight for a long period of time with doors and windows closed.
  - Do not touch the terminals (+ and –) with metal objects.
  - Do not recharge, disassemble, remodel, heat or throw into fire.

## THE FOLLOWING APPLIES ONLY IN THE U.S.A.

### FCC Note:

This equipment has been tested and found to comply with the limits for a Class B digital device, pursuant to Part 15 of the FCC Rules.

These limits are designed to provide reasonable protection against harmful interference in a residential installation. This equipment generates, uses and can radiate radio frequency energy and, if not installed and used in accordance with the instructions, may cause harmful interference to radio communications. However, there is no guarantee that interference will not occur in a particular installation. If this equipment does cause harmful interference to radio or television reception, which can be determined by turning the equipment off and on, the user is encouraged to try to correct the interference by one or more of the following measures:

- Reorient or relocate the receiving antenna.
- Increase the separation between the equipment and receiver.
- Connect the equipment into an outlet on a circuit different from that to which the receiver is connected.
- Consult the dealer or an experienced radio/TV technician for help.

Any unauthorized changes or modifications to this equipment would void the user's authority to operate this device.

This device complies with Part 15 of the FCC Rules.

Operation is subject to the following two conditions:

- (1) This device may not cause harmful interference, and
- (2) this device must accept any interference received, including interference that may cause undesired operation.

Responsible Party:

Panasonic Corporation of North America  
One Panasonic Way  
Secaucus, NJ 07094

Support Contact:

Panasonic Consumer Marketing Company of  
North America  
Telephone No.: 1-800-211-PANA (7262)



## CAUTION

**RISK OF ELECTRIC SHOCK  
DO NOT OPEN**



CAUTION: TO REDUCE THE RISK OF ELECTRIC SHOCK, DO NOT REMOVE SCREWS. NO USER-SERVICEABLE PARTS INSIDE. REFER SERVICING TO QUALIFIED SERVICE PERSONNEL



The lightning flash with arrowhead symbol, within an equilateral triangle, is intended to alert the user to the presence of uninsulated "dangerous voltage" within the product's enclosure that may be of sufficient magnitude to constitute a risk of electric shock to persons.



The exclamation point within an equilateral triangle is intended to alert the user to the presence of important operating and maintenance (servicing) instructions in the literature accompanying the appliance.

## Accessories

Check the supplied accessories before using this unit.

- ☐ **1 Remote control (with a battery)**  
(N2QAYC000056)

☐ **1 AC power supply cord**  
(K2CB2YY00059)

☐ **1 FM indoor antenna**  
(RSAX0002)



### Wall mounting accessories

- ☐ **1 Safety holder**  
(RGQ0660-K)

☐ **2 Wall mount brackets**  
(RMQX1082-K)

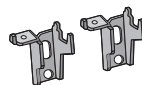

- ☐ **1 Screw**  
(XTB3+8JFJK)

### (ONLY FOR CANADA)

The enclosed Canadian French label sheet corresponds to the English display on the top of the unit.



- Do not use AC power supply cord with other equipment.
- Product numbers provided in this Owner's Manual are correct as of December 2011. These may be subject to change.

## THE FOLLOWING APPLIES IN THE U.S.A. AND CANADA

This device complies with Part 15 of FCC Rules and RSS-Gen of IC Rules.

Operation is subject to the following two conditions:

- (1) This device may not cause interference, and
- (2) this device must accept any interference, including interference that may cause undesired operation of this device.

This transmitter must not be co-located or operated in conjunction with any other antenna or transmitter.

This equipment complies with FCC/IC radiation exposure limits set forth for an uncontrolled environment and meets the FCC radio frequency (RF) Exposure Guidelines in Supplement C to OET65 and RSS-102 of the IC radio frequency (RF) Exposure rules. This equipment has very low levels of RF energy that is deemed to comply without maximum permissive exposure evaluation (MPE). But it is desirable that it should be installed and operated keeping the radiator at least 20 cm (7 7/8") or more away from person's body (excluding extremities: hands, wrists, feet and ankles).

## THE FOLLOWING APPLIES ONLY IN CANADA.

This device complies with RSS-210 of the IC Rules.

Operation is subject to the following two conditions:

- (1) This device may not cause harmful interference,
- (2) This device must accept any interference received, including interference that may cause undesired operation of the device.

Product Identification Marking is located on the bottom of the unit.

## Table of contents

IMPORTANT SAFETY INSTRUCTIONS .....	2
Accessories.....	3
Playable media.....	4
Control reference guide .....	5
Attaching the unit to a wall (optional).....	6
Connections .....	8
Inserting or removing media .....	8
AirPlay .....	9
Playback operations.....	11
Listening to the radio .....	12
Internet Radio.....	13
Sound adjustment .....	13
Clock and Timer .....	13
Others .....	14
Troubleshooting.....	16
Specifications .....	18
Unit and media care.....	19
Licenses .....	19

## Spanish Quick Reference / Referencia rápida en español

Conexiones .....	20
Insertar o sacar los medios .....	20
Las operaciones de reproducción de CD, iPod/iPhone .....	20
Radio.....	21
Reloj y temporizador .....	21

Limited Warranty (ONLY FOR U.S.A. AND PUERTO RICO).....	22
Limited Warranty (ONLY FOR CANADA) .....	23

Operations in these instructions are described using the remote control, but you can do the operations with the main unit if the operations are the same.

## Playable media

### Compatible iPod/iPhone for docking

#### iPod touch

1st, 2nd, 3rd, and 4th generation

#### iPod nano

2nd, 3rd, 4th, 5th, and 6th generation

#### iPod classic

#### iPhone 4S / iPhone 4 / iPhone 3GS / iPhone 3G / iPhone

(as of December 2011)



- Compatibility depends on the software version. Update your iPod/iPhone to the latest software before using it with this unit.
- Depending on the model, it may be necessary to remove the iPod/iPhone and select the album, artist, etc. on the iPod/iPhone.
- Be sure to use a dock adapter that is compatible with your iPod/iPhone. To purchase a dock adapter, consult your iPod/iPhone dealer. If a dock adapter is not available, insert and remove the iPod/iPhone with care.
- Please be aware that Panasonic accepts no responsibility for the loss of data and/or information.

### Charging the iPod/iPhone

The iPod/iPhone will start being charged once connected to this unit.

- In standby mode, "IPOD CHARGING" is shown on the main unit's display.
- Check the iPod/iPhone to see if the battery is fully charged. (Once fully recharged, additional recharging will not occur.)

### Compatible CD

- A disc with the CD Logo.



- This unit can play back discs that conform to the CD-DA format.
- The unit may not be able to play some discs due to the condition of the recording.
- This unit cannot play back MP3 files.

### Note about using a DualDisc

- The digital audio content side of a DualDisc does not meet the technical specifications of the Compact Disc Digital Audio (CD-DA) format so play may not be possible.
- Do not use a DualDisc in this unit as it may not be possible to insert it correctly and it may get scratched or scraped.

# Control reference guide

## Remote control

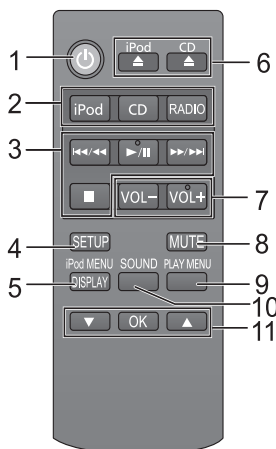

- 1 Turn this unit on or off
- 2 Select the audio source
- 3 Basic playback control buttons
- 4 Enter setup menu
- 5 Enter the iPod/iPhone menu / Change displayed information
- 6 Open/close the sliding door
- 7 Adjust the volume
- 8 Mute the sound  
Mutes the sound. Press again to cancel. "MUTE" is also canceled when the volume is adjusted or the unit is turned off.
- 9 Enter playback menu
- 10 Enter sound menu
- 11 Selection/OK

Keep the button-type battery out of reach of children to prevent swallowing.

### Preparation

Remove the insulation sheet **A** before using.



### To replace a button-type battery

- 1 While pressing the stopper **B**, pull out the battery holder.
- 2 Set the button-type battery with its (+) mark facing upward and then put the battery holder back in place.

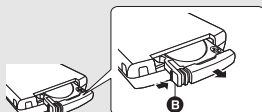

Battery type: CR2025 (Lithium battery)

- The battery should normally last about 1 year, however this depends on how frequently the unit is used.

## Main unit

### Top view

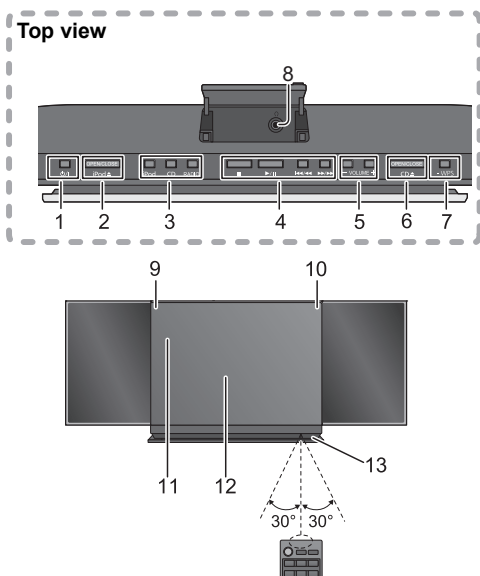

- 1 Standby/on switch [⏻/⏻]  
Press to switch the unit from on to standby mode or vice versa.  
In standby mode, the unit is still consuming a small amount of power.
- 2 Open/close the sliding door (for iPod/iPhone)
- 3 Select the audio source
- 4 Basic playback control buttons
- 5 Adjust the volume (0(min) to 50(max))
- 6 Open/close the sliding door (for discs)
- 7 WPS pairing button (⇨ 9)
- 8 Headphone jack  
Plug type:  $\varnothing 3.5$  mm ( $1/8$ ") stereo  
Recommended plug type: Straight Plug
  - To prevent hearing damage, avoid listening for prolonged periods of time.  
Excessive sound pressure from earphones and headphones can cause hearing loss.
- 9 Standby indicator
- 10 Wi-Fi® status indicator
- 11 Display
- 12 Sliding door
- 13 Remote control signal sensor  
Distance:  
Within approx. 7 m (23 ft) directly in front.
  - To avoid interference, please do not put any objects in front of signal sensor.

# Attaching the unit to a wall (optional)

## Installation accessories

### ■ Supplied accessories

- 1 Safety holder
- 1 Screw
- 2 Wall mount brackets

### ■ Commercially available accessories (not supplied)

- 4 Wall mount bracket fixing screws
- 1 Safety holder fixing screw
- 1 Fall prevention cord
- 1 Screw eye

- Keep the safety holder out of reach of children to prevent swallowing.
- Keep the screws out of reach of children to prevent swallowing.
- Keep the wall mount brackets out of reach of children to prevent swallowing.



Use screws with a nominal diameter of  $\varnothing 4$  mm ( $5/32$ " ), which are suitable to the material of the wall (e.g., wood, steel, concrete, etc.)

## Safety precautions

**Professional installation is required.**  
The installation should never be done by any other than a qualified installation specialist. **PANASONIC DISCLAIMS ANY PROPERTY DAMAGE AND/OR SERIOUS INJURY, INCLUDING DEATH RESULTING FROM IMPROPER INSTALLATION OR INCORRECT HANDLING.**

- Be sure to install this unit as indicated within this Owner's Manual.

## Wall mount instructions

Before installation, turn the unit off and disconnect the AC power supply cord from the AC outlet.

### 1 Detach the stand from the unit.

- ↳ Unscrew the fixing screw (2 pieces) at the bottom of the unit.
- ↳ Gently pull the stand off the unit as illustrated.
- Keep the removed screws and stand in a safe place.

Bottom of main unit

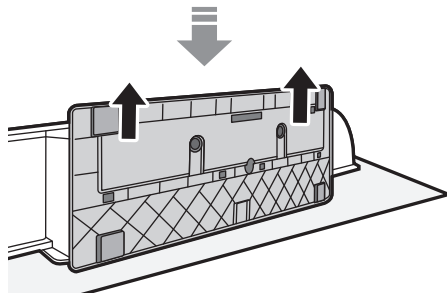
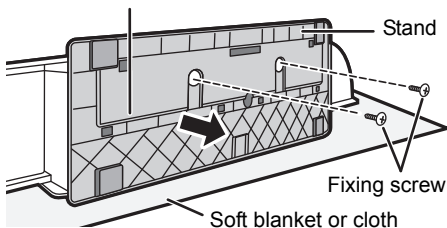

### 2 Measure and mark the position of the wall mount brackets (Both sides).

↳ Use figures below to identify the screwing positions.

Before deciding the location to place the unit, be sure to check that the Wi-Fi signal strength is sufficient. (⇒ 9, 15)

### The position to attach the wall mount brackets

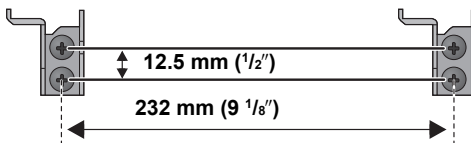

### Space required

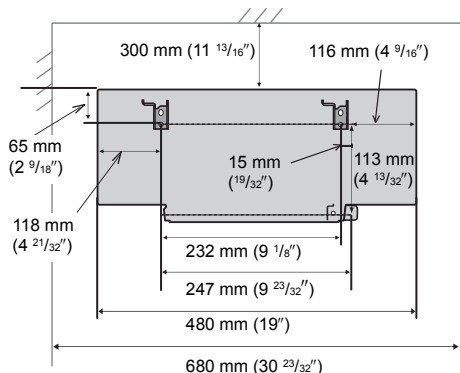

### 3 Attach the wall mount bracket to the wall with 2 screws (not supplied). (Both sides)

- Use a spirit level to ensure both wall mount brackets are level.
- Make sure that the screw used and the wall are strong enough to support the weight of at least 33 kg (72.8 lbs).

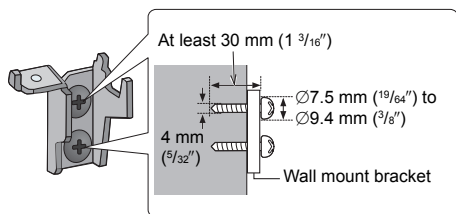

### 4 Fix the safety holder onto the unit with the screw (supplied).

↳ Screw tightening torque: 50 N•cm (0.4 lbf•ft) to 70 N•cm (0.5 lbf•ft).

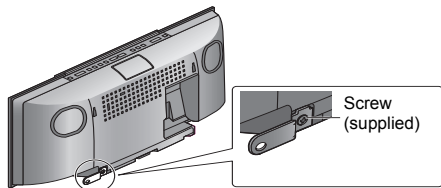

### 5 Attach the fall prevention cord (not supplied) to this unit.

- Use a cord that is capable of supporting over 33 kg (72.8 lbs) (with a diameter of about 1.5 mm (1/16")).

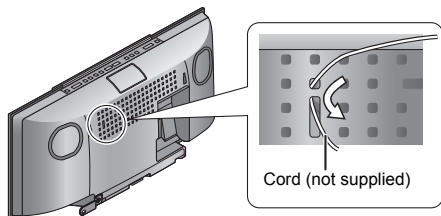

### 6 Hook the unit securely onto the wall mount brackets with both hands.

- Connect the FM antenna and the AC power supply cord to the unit before hanging the unit onto the wall. (⇒ 8)
- After hanging the unit, release your hand carefully to confirm the unit sits securely on the wall.

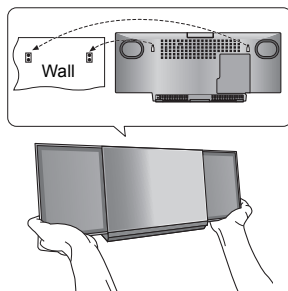

### 7 Drive the safety holder fixing screw (not supplied) to secure the safety holder onto the wall.

- Make sure that the screw used and the wall are strong enough to support the weight of at least 33 kg (72.8 lbs).
- Refer to step 3 for requirements before screwing.

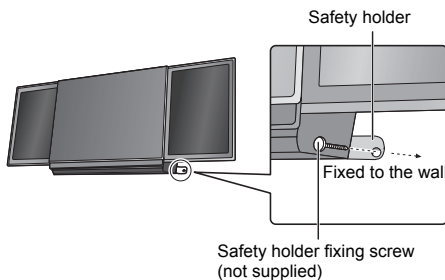

### 8 Attach the fall prevention cord (not supplied) to the wall.

- Make sure that the screw used and the wall are strong enough to support the weight of at least 33 kg (72.8 lbs).
- Make sure that the slack of the cord is minimal.

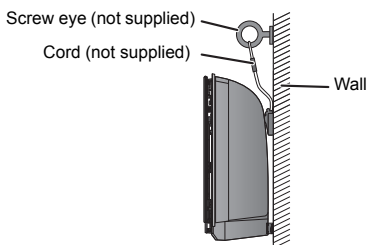

## Connections

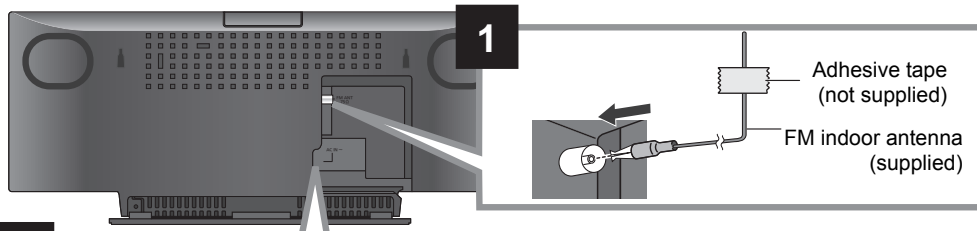

### 2 Connect the AC power supply cord after all other connections are complete.

This unit consumes a small amount of AC power (⇒ 18) even when turned off.

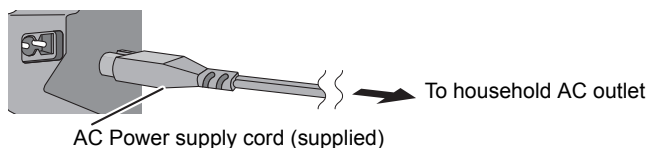

- These speakers do not have magnetic shielding. Do not place them near a television, personal computer or other devices easily influenced by magnetism.
- Tape the antenna to a wall or column in a position with the least amount of interference. (Use an FM outdoor antenna if radio reception is poor.)

## Inserting or removing media

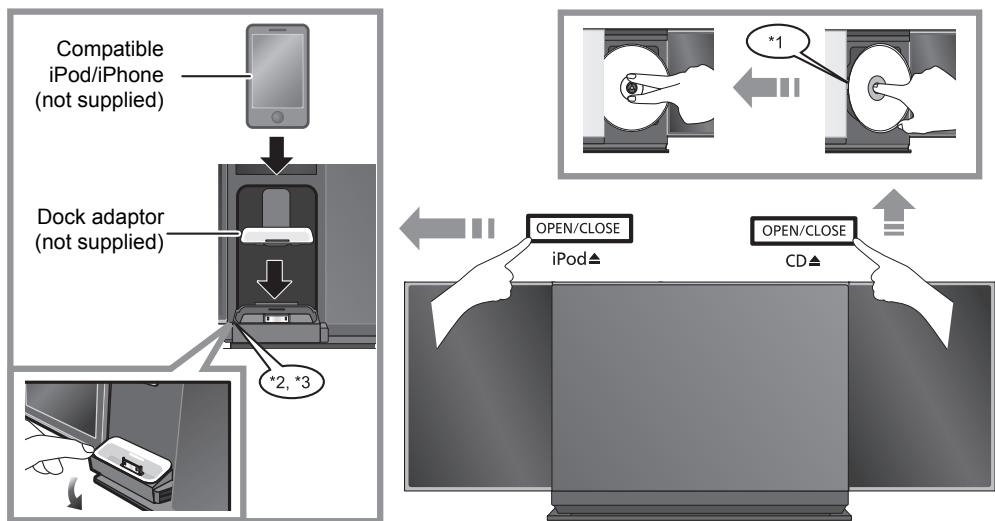

- \*1: Make sure to tilt the disc so as not to touch the sliding door.
- \*2: Do not push or pull the dock manually.
- \*3: When inserting or removing the iPod/iPhone, tilt the dock slightly by holding the corner of the dock.
- Make sure that the unit does not fall when inserting or removing media.
- Be sure to remove the iPod/iPhone from its case.
- When moving this unit, be sure to remove all media and turn this unit to standby mode.



## AirPlay

With this feature you can wirelessly stream music to this unit's speakers.

### Compatible devices (as of December 2011)

AirPlay works with;

- iOS 4.2 or later (iPod touch (2nd, 3rd, and 4th generation), iPhone 4S, iPhone 4, iPhone 3GS, iPad 2, iPad)
- iTunes 10.2 or later (Mac / PC)

## Network settings

To use the AirPlay function, this unit must join the same wireless network as the compatible device.

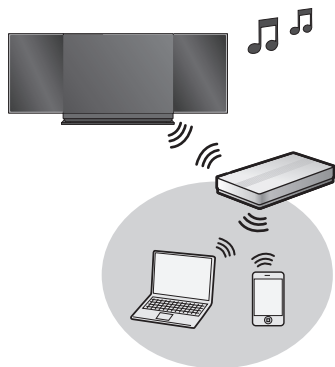

### Preparation

With this unit there are 2 methods to setup the wireless connection. Determine which type of wireless network router you are using and follow the method that matches your device.

- Refer to the operating instructions of the wireless network router for details.

If you do not know which type of wireless network router you are using, use "Method 2".

- Turn the unit on.



- When performing the network settings, place this unit close to the wireless router.
- Simultaneous use with other 2.4 GHz devices, such as microwaves, cordless telephones, etc., may result in connection interruptions.
- Immediately after this unit is turned on, the network setup may take longer to start.
- This unit cannot join a wireless network using WEP security settings with "Method 1". Use "Method 2" to join the wireless network.
- To cancel this setting in the middle, press [⏻] to turn off the unit.
- For up to date compatibility information on your Wireless router refer to <http://panasonic.jp/support/global/cs/> (This site is in English only.)

## Method 1

If your wireless network router supports WPS\*1.

### Using the WPS Push Button Configuration (PBC)

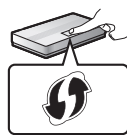

WPS Push Button Configuration (PBC) compatible wireless router may have this mark.

- 1 Press and hold [– WPS] on the unit.
  - ↳ "CONNECT" flashes on the display. (Wi-Fi status indicator blinks blue.)
  - Complete step 2 within 2 mins.
- 2 Press the WPS button on the wireless router.
  - ↳ When a link is established "LINKING" is indicated on this unit's display.
  - ↳ When the configuration is finished "SUCCESS" is indicated on this unit's display. (Wi-Fi status indicator lights blue.)
- 3 Press [OK] on the remote control to complete the setting.



- This unit can also be set using the WPS PIN code. Replace step 2 of "Method 1" with the following steps. (Before starting, refer to the wireless network router's operating instructions for details on how to enter the PIN code.)
  - 1 While "CONNECT" is flashing press and hold [– WPS] again to display the 8 digit PIN code. (Wi-Fi status indicator blinks purple.)
  - 2 Enter the PIN code into the wireless router.
- To edit this system's name it is necessary to use "Method 2".
- "FAIL" may be displayed if the connection was not made within the set time limit. Try the setting again. If "FAIL" is still displayed, try "Method 2".

## Method 2

If your wireless network router does not support WPS\*1.

With this method, you will access this unit's wireless network settings from the Internet browser of your compatible device.

- The illustrations and explanations are based on an iPhone. However, the word "iPhone" can be replaced with your compatible device.

### Preparation

- Check your **home wireless network name** (Network name (SSID)) and **password** for this network. This can often be found on the wireless router itself.
- Turn on your iPhone.

(Continues to next page)

\*1: WPS stands for "Wi-Fi Protected Setup™".

- 1 Press [SETUP] on the remote control repeatedly to select "NET SETUP" and then press [OK].

↳ "SETTING" is indicated on the display. (Wi-Fi status indicator blinks purple.)

- 2 Connect your iPhone to this unit's wireless network called "Setup \_ \_ \_ \_ \_" \*1, 2.

- Once "Setup \_ \_ \_ \_ \_" is selected, the iPhone is connected with this unit.



- 3 Start Safari on your iPhone and type "http://192.168.1.12/" into the URL address field and display the page.



↳ This unit's setup window is displayed.

- 4 Select "Search wireless network".

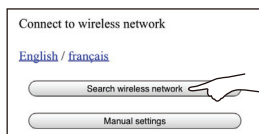

- 5 Select and input the details.

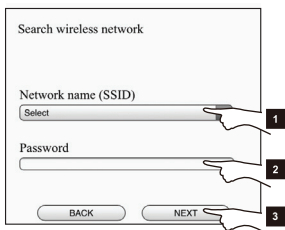

- 1 Select your **home wireless network name**. \*3
- 2 Type the **password**.
- 3 Select "NEXT".

- 6 Perform the "Additional settings". (⇒ right)  
If they do not apply, continue to the next step.

- 7 Select "JOIN" to apply the settings.

- ↳ In the pop-up screen select "OK" to continue.
  - Select "CANCEL" to return to the setup window.
- ↳ The wireless status indicator lights blue.
  - You can now close the Safari browser.
- ↳ When the configuration is finished "SUCCESS" is indicated on this unit's display.

If "FAIL" is displayed press [OK]. Then check the wireless network password and other settings and start again from step 1.

- 8 Press [OK] on the remote control to complete the settings.

- 9 Connect your iPhone back to your home wireless network.

### Alternative settings

#### Instead of steps 4 and 5:

Select "Manual settings".

- 1 Type your **home wireless network name** into the "Network name (SSID)" field.
- 2 Select the **encryption method** from the "Security system" drop down list.
- 3 Type the **password** into the "Password" field and then select "NEXT".

### Additional settings

#### In step 6:

If your home wireless network has been setup to use specific IP Addresses, Subnet Mask, Default Gateway, Primary DNS, etc. Select "Advanced network settings".

↳ Input the required addresses into each field and select "OK".

- To change the settings back to DHCP, select "ON" from the "DHCP" drop down list.

If you want to change the name of this unit that is displayed as the AirPlay speakers. Select "Edit STEREO SYSTEM name".

↳ Only ASCII characters can be used.

↳ Type a new name into the "STEREO SYSTEM name" field and select "OK".



- Enable Java and Cookies in your browser settings.
- To cancel this setting in the middle, press [⏏] to turn off the unit.

\*1: " \_ " stands for a digit that is unique to each set.

\*2: Make sure that DHCP is enabled for the network setting on the iPhone.

\*3: If you have set your wireless network to be invisible, select "BACK" and refer to "Alternative settings". (⇒ above)

## Using AirPlay with this unit's speakers

When this unit is on the same network as the compatible device, you can select this unit as the speakers.

### Preparation

- Connect this unit to the same network as the compatible device. (⇒ 9)
- Turn on the compatible device.

**1** Start iTunes on your Mac/PC or the Music App on your iOS device.

- If the Music App on your iOS device is used, select the file that is to be played.

**2** Select this unit from the AirPlay  icon at the bottom right-hand corner of the display.

- ↳ Check the volume settings before starting the playback. (When AirPlay is used for the first time, the volume may be output at the maximum setting.)

- If you have not changed the name, this unit will be displayed as "Panasonic HC57 \_ \_ \_ \_ \_" \*1, 2.

e.g., iPhone iOS 5.0

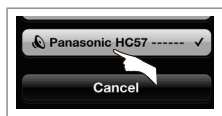

e.g., iTunes 10.5  
(Bottom right)

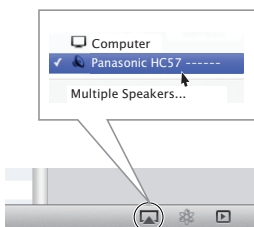

**3** Start play.



- This unit can be set to turn on automatically when this unit is selected as the output speakers. (⇒ 15)
- Playback of other audio sources will stop and AirPlay output will have priority.
- Volume changes on the iOS device or iTunes will be applied to this unit. (Refer to the iTunes Help for the required settings in iTunes.)
- With some iOS and iTunes versions, it may not be possible to restart the AirPlay playback if the selector is changed (e.g., "CD") or the unit is turned off, during the AirPlay playback. In this case, select a different device from the AirPlay icon of the Music App or iTunes and then re-select this unit as the output speakers.
- AirPlay will not work when playing back videos on iTunes.

## Playback operations

The following marks indicate the availability of the feature.

**CD**: CD audio in CD-DA format

**iPod**: Compatible iPod/iPhone (⇒ 4)

**AirPlay**: When connected to an AirPlay compatible device. (⇒ left)

### Preparation

- Turn the unit on.
- Insert the media (⇒ 8) or connect the AirPlay compatible device (⇒ 9).
- Press [CD] or [iPod] to select the audio source.

### Basic play (CD, iPod, AirPlay)

<b>Play</b> (CD, iPod only)	Press [▶/  ].
<b>Stop</b>	Press [■].
<b>Pause</b>	Press [▶/  ]. Press again to restart play. • <b>AirPlay</b> : If play does not restart, wait approx. 10 sec. and try again.
<b>Skip</b>	Press [◀/▶] or [▶▶/◀◀] to skip track.
<b>Search</b> (CD, iPod only)	During playback Press and hold [◀/▶] or [▶▶/◀◀]. • <b>iPod</b> : Backwards search is only within the current track.
<b>Volume</b>	Press [VOL -] or [VOL +] to adjust the volume.
<b>Mute</b>	Press [MUTE] to mute the sound.

### ■ **CD** To view the track number and remaining time

Press [DISPLAY] repeatedly during play or pause.

### ■ **iPod** To navigate through the iPod/iPhone menu

- Open the Music App to use this feature with iPod touch/iPhone models.
- [▲, ▼]: To navigate menu items.
- [OK]: To go to the next menu.
- [iPod MENU]: To return to the previous menu.



- To view the operation, open the sliding door.
- The operation may vary among iPod/iPhone models.

(Continues to next page)

\*1: " \_ " stands for a digit that is unique to each set.

\*2: The name that is displayed for this unit can be changed from the "Edit STEREO SYSTEM name" settings in "Method 2". (⇒ 9)

## Random/shuffle play

(**CD**, **AirPlay**\*<sup>1,2</sup>)

Select the playback mode.

- This mode can be combined with the repeat play feature.

### ■ When “CD” is selected

- 1 Press [PLAY MENU] repeatedly to select “RANDOM” and then press [OK].
- 2 Press [▲, ▼] to select “ON” and press [OK].
  - “RND” is displayed.

- 3 Press [▶/||] to start play.

### ■ When “AIRPLAY” is selected

- 1 Press [PLAY MENU] repeatedly to select “SHUFFLE” and then press [OK].
- 2 Press [▲, ▼] to turn shuffle on and press [OK].
  - **AirPlay**: Refer to the connected device to verify the selected setting.



- **CD**: During random play, you cannot skip to the previous track.
- **CD**: The current play mode is cleared when you open the sliding door for discs.
- **CD**: “RND” will not be displayed when “1-TRACK” (⇒ below) is selected.

## Repeat play (**CD**, **AirPlay**\*<sup>1,2</sup>)

- 1 Press [PLAY MENU] repeatedly to select “REPEAT” and then press [OK].
- 2 Press [▲, ▼] to select the following mode and press [OK].
  - **AirPlay**: Refer to the connected device to verify the selected setting.

<b>OFF</b>	Select to cancel repeat playback.
<b>1-TRACK</b> ( <b>CD</b> : “1, ♪, ↻” is displayed.)	The selected track is repeated, (Skip to the desired track (⇒ 11))
<b>ALL</b> ( <b>CD</b> : “↻” is displayed.)	All tracks are repeated.



- **CD**: Repeat play is canceled when you open the sliding door for discs.

\*1: **AirPlay**: Perform the settings during playback.

\*2: **AirPlay**: The applied settings will remain until it is changed on the connected device.

## Listening to the radio

You can preset up to 30 channels.

### Preparation

Make sure that the FM antenna is connected. (⇒ 8)



A station previously stored is overwritten when another station is stored in the same channel preset.

### Presetting stations automatically

- 1 Press [RADIO] to select “FM”.
- 2 Press [PLAY MENU] repeatedly to select “A.PRESET” and then press [OK].
- 3 Press [▲, ▼] to select “LOWEST” or “CURRENT” and then press [OK].

#### LOWEST:

To begin auto preset with the lowest frequency (FM 87.9 or FM 87.5).

#### CURRENT:

To begin auto preset with the current frequency.\*

\* To change the frequency, refer to “Manual tuning and presetting”.

The tuner starts to preset all the stations it can receive into the channels in ascending order.

### Listening to a preset channel

#### Preparation

- 1 Press [RADIO] to select “FM”.
- 2 Press [PLAY MENU] repeatedly to select “TUNEMODE” and then press [OK].
- 3 Press [▲, ▼] to select “PRESET” and then press [OK].

- 1 Press [RADIO] to select “FM”.
- 2 Press [◀◀/◀◀] or [▶▶/▶▶] to select the channel.

### ■ Manual tuning and presetting

Select a radio broadcast.

- 1 Press [RADIO] to select “FM”.
- 2 Press [PLAY MENU] repeatedly to select “TUNEMODE” and then press [OK].
- 3 Press [▲, ▼] to select “MANUAL” and then press [OK].
- 4 Press [◀◀/◀◀] or [▶▶/▶▶] to tune to the required station.
  - To start automatic tuning, press and hold [◀◀/◀◀], [▶▶/▶▶] until the frequency starts scrolling. Tuning stops when a station is found.

To preset the channel

- 5 While listening to the radio broadcast  
Press [OK].
- 6 Press [▲, ▼] to select the channel and then  
press [OK].

### ■ To improve FM sound quality

- 1 While receiving FM broadcasts, press  
[PLAY MENU] repeatedly to select "FM MODE"  
and then press [OK].
  - 2 Press [▲, ▼] to select "MONO" and then press  
[OK].
- This setting can be preset and memorized. To do  
so, continue to step 5 of "Manual tuning and  
presetting".



- Select "STEREO" in step 2 to return to stereo broadcasts.
- "MONO" is canceled if the frequency is changed.
- If "MONO" is selected, regardless of the type of signal this  
unit is receiving, "FM MONO" is displayed when [DISPLAY] is  
pressed. (⇒ below)

### ■ To display the current signal status

Press [DISPLAY].

"FM ST": The FM signal is in stereo.

"FM": The FM signal is in monaural.

- "FM" is also displayed even if this unit is not  
tuned to a station.



- "STEREO" is displayed when this unit tunes to a stereo  
broadcast.

## Internet Radio

This unit can output Internet radio if "vTuner for  
Panasonic" is installed on your iPhone/iPod touch.

### Preparation

- Install "vTuner for Panasonic" to your iPhone/  
iPod touch.
- Install iOS 5.0 or later.

- 1 Insert the iPhone/iPod touch to this unit.
- 2 Press [iPod] repeatedly to select "VTUNER".  
↳ "vTuner for Panasonic" starts.



- Visit the below website for the following information about  
"vTuner for Panasonic":  
<http://radio.vtuner.com/panasonic/en/>  
(Compatible iPhone/iPod touch models and software  
versions, purchasing, installation and operation details.)
- A pop-up screen may appear on your iPhone/iPod touch.  
Follow the indicated instructions.

## Sound adjustment

The following sound effects can be added to the  
audio output.

- 1 Press [SOUND] repeatedly to select the effect  
and then press [OK].
- 2 Press [▲, ▼] to select the setting and then  
press [OK].

Direct-Vocal Surround (D.SURROUND)	"LEVEL 1", "LEVEL 2" or "OFF". • The factory preset is "OFF".
Preset EQ (PRESET EQ)	"HEAVY" (heavy), "SOFT" (soft), "CLEAR" (clear), "VOCAL" (vocal) or "FLAT" (flat/off). • The factory preset is "HEAVY".
Bass (BASS) or Treble (TREBLE)	Adjust the level (−4 to +4).
Dynamic Bass (D.BASS)	"ON D.BASS" or "OFF D.BASS". • The factory preset is "ON D.BASS".

- You may experience a reduction in sound quality when these  
effects are used with some sources. If this occurs, turn the  
sound effects off.

## Clock and Timer

### Setting the clock

This is a 12-hour clock.

- 1 Press [SETUP] repeatedly to select "CLOCK"  
and then press [OK].
- 2 Press [▲, ▼] to set the time and then press  
[OK].



- To display the clock, press [SETUP] repeatedly to select  
"CLOCK" and then press [OK] once. The time is displayed for  
10 seconds.  
(During standby, press [iPod MENU, DISPLAY] once.)
- The clock is reset when there is a power failure or when the  
AC power supply cord is removed.
- Reset the clock regularly to maintain accuracy.

Play timer

## Preparation

Set the clock ( $\Rightarrow$  13).

### ■ Setting the timer

## 1 Setting the timer

- 

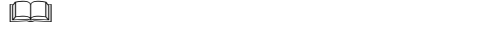

- Turn the timer on

**1** Select the course `cs1` and set the desired

1. Select the music source<sup>1</sup> and set the desired

- 3** Press [**▲** **▼**] to select “SET” and then press

- “⊙” is displayed.

- 4** Press  to turn the unit off.

- 



- This unit can be used as normal after the timer is set,

- Turn the unit to standby mode before the timer start time

- To turn the timer off, select "OFF" in step 3.

- The unit will turn on at the preset time, with the volume

- [illegible]

Sleep timer

**1** Press [SETUP] repeatedly to select “SLEEP”

- Press [SETUP] repeatedly to select SLEEP

- “SLEEP 30”  $\Leftrightarrow$  “SLEEP 60”  $\Leftrightarrow$  “SLEEP 90”  $\Leftrightarrow$  “SLEEP 120”

- The remaining time is indicated on the unit's display except

- when other operations are performed.

## Others

Automatic standby

**To cancel this function**

**1** Press [SETUP] repeatedly to select

- Press [SETUP] repeatedly to select  
"AUTO OFF" "1" "5013"

- 



- To turn automatic standby on, select "ON" in step 2.
- This setting cannot be selected when "FM" is the source.

Display brightness

**1** Press [SETUP] repeatedly to select “DIMMER”

- Press [SETUP] repeatedly to select DIMMER and then press [OK].

- Press **[F2]** to select **ON** and then press **[OK]**

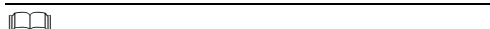

Glenn Feldman, *University of California, Berkeley*

## Changing the main unit and remote control code

**1** D [CP]1: "CP"

- 1 Press [CD] to select "CD".

- 2** Press and hold [CD] on the main unit and [▲]

- 3** Press and hold [OK] and [▲] on the remote



To change the mode back to “REMOTE 1”, repeat the steps

## Software update

Occasionally, Panasonic may release updated software for this unit that may add or improve the way a feature operates. These updates are available free of charge.

### Preparation

Connect this unit to the wireless network. (⇒ 9)

- Make sure that the wireless network is connected to the Internet.

- 1 Press [SETUP] repeatedly to select "SW UPDATE" and then press [OK].
  - 2 Press [▲, ▼] to select "UPDATE? Y" and then press [OK] to start the update.
    - ↳ After the update has finished, "SUCCESS" is displayed.
  - 3 Disconnect the AC power supply cord and reconnect it after 3 minutes.
- **DO NOT DISCONNECT the AC power supply cord while one of the following messages is displayed.**
    - "LINKING", "UPDATING" or "□□□%" ("□" stands for a number.)



- If you do not want to update the unit, select "UPDATE? N" and then press [OK] in step 2.
- If there are no updates, "NO NEED" is displayed after step 2.
- During the update process, no other operations can be performed.
- **Downloading will require several minutes. It may take longer or may not work properly depending on the connection environment.**

### Checking the software version

- 1 Press [SETUP] repeatedly to select "SW VER." and then press [OK].
  - ↳ The version of the installed software is displayed.
- 2 Press [OK] to exit.

## Wi-Fi signal strength

To check the Wi-Fi signal strength where the unit is located.

### Preparation

Connect this unit to the wireless network. (⇒ 9)

- 1 Press [SETUP] repeatedly to select "SIG.LEVEL" and then press [OK].
  - The unit's display shows "LEVEL □". ("□" stands for a number.)
- 2 Press [OK] to exit this display mode.



- It is recommended to have a signal strength of "3". Change the position or angle of your wireless network router or the unit if the indication is "2" or "1" and see if the connection improves.
- If "LEVEL 0" is displayed, this unit cannot establish a link with the wireless network router. (⇒ 17)
- This function does not work when AirPlay is used.

## Network standby

This unit can turn on automatically from standby mode when this unit is selected as the AirPlay speakers.

### Preparation

Connect this unit to the wireless network. (⇒ 9)

- 1 Press [SETUP] repeatedly to select "NET STNBY" and then press [OK].
- 2 Press [▲, ▼] to select "ON" and then press [OK].



- To cancel this function, select "OFF" in step 2.
- The factory preset is "OFF". If this function is set to "ON" the standby power consumption will increase.

## IP/MAC Address

To check the unit's IP/MAC address.

- 1 Press [CD] to select "CD".
- 2 Press and hold [– WPS] on the unit and [▼] on the remote control until the unit's display shows the IP address.
  - ↳ The IP address is partially displayed.
  - To display the MAC address on the unit, repeat the steps above by replacing [▼] with [▲].
- 3 Press [▲, ▼] on the remote control to show the rest of the IP address.



- Be sure to remove the disc from the disc tray when checking the address.
- The "–" displayed on the top or bottom left of the display indicate the first and last units respectively.

## Troubleshooting

Before requesting service, make the following checks. If you are in doubt about some of the check points, or if the solutions indicated in the following guide do not solve the problem, refer to "Customer Services Directory (United States and Puerto Rico)" on page 22 if you reside in the U.S.A. or Puerto Rico, or refer to "Limited Warranty (ONLY FOR CANADA)" on page 23 if you reside in Canada.

### To return all settings to the factory preset

When the following situations occur, reset the memory:

- There is no response when buttons are pressed.
  - You want to clear and reset the memory contents.
- ① Disconnect the AC power supply cord. (Wait for at least 3 minutes before proceeding to step ②.)
  - ② While pressing and holding down [⏻/⏻] on the main unit, reconnect the AC power supply cord.
    - "-----" appears on the display.
  - ③ Release [⏻/⏻].



All the settings are returned to the factory preset. You will need to reset the memory items.

### Do you have the latest software installed?

- Occasionally, Panasonic may release updated software for this unit that may add or improve the way a feature operates. (⇒ 15)

## Common problems

### Humming heard during play.

- An AC power supply cord or fluorescent light is near the cords. Keep other appliances and cords away from this unit's cables.

## Disc operations

### Incorrect display or play will not start.

- Make sure that the disc is compatible with this unit. (⇒ 4)
- There is moisture on the lens. Wait for about an hour and then try again.

## Radio

### A beat sound or noise is heard while receiving radio broadcast.

- Confirm the FM antenna is properly connected. (⇒ 8)
- Adjust the position of the antenna.
- Try to keep a certain amount of distance between the antenna and AC power supply cord.
- Try to use outdoor antenna if there are buildings or mountains nearby.
- Switch the television or other audio player off or separate it from the unit.
- Keep this unit away from mobile phones if the interference is apparent.

### Stations cannot be selected.

Change the FM frequency step.

- ① Press [RADIO] to select "FM".
- ② Press and hold [RADIO] on the main unit.

After a few seconds the display changes to show the current lowest frequency. Continue to hold the button down. The lowest frequency changes and the step is changed.

## iPod/iPhone operations

### Cannot charge or operate.

- Check that the iPod/iPhone is connected firmly. (⇒ 8)
- The battery of the iPod/iPhone is depleted. Charge the iPod/iPhone, and then operate again.
- When unexpected operation occurs while using the iPod/iPhone, connect the iPod/iPhone again or try to restart the iPod/iPhone.

## AirPlay operations

### Cannot connect to the network

- Confirm the network connection and settings. (⇒ 9)
- Your wireless network might be set to be invisible. In this case select "Manual settings" in "Method 2". (⇒ 9)
- This unit cannot join a wireless network using WEP security settings with the WPS methods ("Method 1"). Use "Method 2" to join the wireless network. (⇒ 9)
- Make sure that the multicast function on the wireless network router is set to on (enabled).

### Cannot connect to the unit



- Make sure that this unit is on the same wireless network as the device you are trying to use. (⇒ 9)
- If "NET STNBY" is set to "OFF", the AirPlay compatible device cannot be connected when this unit is off.
- Turn off the Wi-Fi setting on the AirPlay compatible device, set "NET STNBY" to "OFF" (⇒ 15) and then turn this unit off and on. Reconnect the compatible device to the Wi-Fi network and then select this unit as the AirPlay speakers again.

### My wireless network router is WPS PBC compatible, but the pairing does not work.

- If the network is set to be invisible, the push button configuration does not work. In this case, either make the wireless network visible while you set up the network for this unit or use "Method 2". (⇒ 9)

### Playback does not start

#### The sound is interrupted

- Simultaneous use with other 2.4 GHz devices, such as microwaves, cordless telephones, etc., may result in connection interruptions.  
Increase the distance between this unit and these devices.
- Do not place this unit inside a metal cabinet, for it might block the Wi-Fi signal.
- Place this unit closer to the wireless network router.
- If several wireless devices are simultaneously using the same wireless network as this unit, try turning off the other devices or reducing their wireless network usage.
- If the playback stops, check the playback status on the iOS device or iTunes.
- If play does not start (even though the Wi-Fi status indicator lights blue and the AirPlay  icon is displayed), restart the wireless network router, turn the Wi-Fi connection on the iOS device or Mac/PC off and on, and then make sure that your home wireless network is selected.
- If the AirPlay  icon is not displayed even if Wi-Fi status indicator lights blue, try restarting the wireless network router.



- With some iOS and iTunes versions, it may not be possible to restart the AirPlay playback if the selector is changed (e.g., "CD") or the unit is turned off, during the AirPlay playback.  
In this case, select a different device from the AirPlay icon of the Music App or iTunes and then re-select this unit as the output speakers. (⇒ 11)

## Remote control

### The remote control doesn't work properly.

- The remote control and this unit are using a different code.  
(⇒ right, "REMOTE □")

## Messages

### The following messages or service numbers may appear on the unit's display.

#### "--:--"

- You plugged the AC power supply cord in for the first time or there was a power failure recently. Set the time (⇒ 13).

#### "ADJUST CLOCK"

- Clock is not set. Adjust the clock accordingly.

#### "ADJUST TIMER"

- Play timer is not set. Adjust the play timer accordingly.

#### "AUTO OFF"

- The unit has been left unused for about 30 minutes and will shut down in a minute. Press any button to cancel it.

#### "CANNOT DISPLAY"

- The Wi-Fi signal strength cannot be displayed if "AIRPLAY" is the selected source. Stop the AirPlay playback, select a different source (e.g., "CD") and try again. (⇒ 15)

#### "CANNOT SET"

- Select an audio source other than "AIRPLAY" or "VTUNER".

#### "CHECKING CONNECTION"

- The unit is checking the connected iPod/iPhone. If this display keeps appearing, make sure that iPod/iPhone is inserted correctly and try again (⇒ 8).

#### "DIMMER"

- Appears 10 seconds after the volume is turned to "0".

#### "DL ERROR"

- The software download has failed. Press any button to exit. Please try again later.
- The server cannot be found. Press any button to exit. Make sure that the wireless network is connected to the Internet.

#### "ERROR"

- Incorrect operation is performed. Read the instructions and try again.

#### "F61"

- There is a power supply problem. Consult the dealer.

#### "FAIL"

- Updating or setting has failed. Read the instructions and try again.

#### "ILLEGAL OPEN"

- Sliding door is not in correct position. Turn the unit off and on again. If this display appears again, consult the dealer.

#### "IPOD OVER CURRENT ERROR"

- The iPod/iPhone is drawing too much power. Remove the iPod/iPhone and turn the unit off and on again.

#### "LEVEL 0"

- There is no link between this unit and the wireless network router.  
Try the following operations:
  - Check that the wireless network router is turned on.
  - Turn this unit off and on again.
  - Reset the wireless network settings. (⇒ 9)
 If the problem persists, consult your dealer.

#### "NOCONNECT"

- This unit cannot connect to the network.  
Check the network connection. (⇒ 9)

#### "NODEVICE"

- The iPod/iPhone device is not inserted correctly. Read the instructions and try again (⇒ 8).

#### "NO DISC"

- Insert the disc to be played (⇒ 8).

#### "NO PLAY"

- A CD that is not in CD-DA format is inserted. It cannot be played.

#### "NOT SUPPORTED"

- You have inserted an iPod/iPhone that cannot be played (⇒ 4). Insert correctly and try again if iPod/iPhone is compatible.
- If the iPod/iPhone is compatible, turn it on before inserting it to this unit.

#### "READING"

- The unit is checking the CD information. After this display has disappeared, start operating.

#### "START ERROR"

- Check the iPhone/iPod touch.  
Visit the below website for more information:  
<http://radio.vtuner.com/panasonic/en/>

#### "REMOTE □" ("□" stands for a number.)

- The remote control and this unit are using different codes. Change the code on the remote control.
  - When "REMOTE 1" is displayed, press and hold [OK] and [▼] for more than 4 seconds.
  - When "REMOTE 2" is displayed, press and hold [OK] and [▲] for more than 4 seconds.

# Specifications

## ■ GENERAL

Power consumption	25 W
Power consumption in standby mode	Approx. 0.1 W
Power consumption in standby mode (When "NET STNBY" is "ON")	Approx. 5.6 W
Power supply	AC 120 V, 60 Hz

### Dimensions (W×H×D)

480 mm×197 mm×84 mm (19"×7 3/4"×3 1/2")  
(Depth without stand: 75 mm (3"))

### Mass (Weight)

Approx. 2.6 kg (5.7 lbs)

### Operating temperature range

0 °C to +40 °C (+32 °F to +104 °F)

### Operating humidity range

35 % to 80 % RH (no condensation)

## ■ AMPLIFIER SECTION

### Output power:

#### RMS Output Power Stereo mode

##### Front Ch (both ch driven)

20 W per channel (6 Ω), 1 kHz, 10 % THD

##### Total RMS Stereo mode power

40 W

#### FTC Output Power Stereo mode

##### Front Ch (both ch driven)

15 W per channel (6 Ω),

20 Hz to 20 kHz, 1 % THD

##### Total FTC Stereo mode power

30 W

## ■ TUNER SECTION

### Preset Memory

FM 30 stations

### Frequency Modulation (FM)

#### Frequency range

87.9 MHz to 107.9 MHz (200 kHz step)

87.5 MHz to 108.0 MHz (100 kHz step)

#### Antenna terminals

75 Ω (unbalanced)

## ■ DISC SECTION

### Disc played [8 cm (3") or 12 cm (5")]

CD, CD-R/RW (CD-DA)

### Pick up

#### Wavelength

790 nm (CD)

#### Laser power

For U.S.A. CLASS I  
For Canada CLASS 1

### Audio output (Disc)

#### Number of channels

2 ch (FL, FR)

## ■ SPEAKER SYSTEM SECTION

### Type

1 way, 1 speaker system (Passive Radiator)

### Speaker unit(s)

#### Full range

6.5 cm (2 1/2") Cone type×1 per channel

#### Passive Radiator

8 cm (3 1/8")×2 per channel

#### Impedance

6 Ω

## ■ Wi-Fi / AirPlay SECTION

### Wi-Fi

#### WLAN Standards

IEEE802.11b/g

#### Frequency range

2.4 GHz band

#### Security

WEP, WPA™, WPA2™

#### WPS version

Version 2.0 (WEP not support)

## ■ TERMINAL SECTION

### iPod Connector

DC OUT 5 V 1.0 A MAX

### Phone jack

#### Terminal

Stereo, Ø3.5 mm (1/8") jack



- Specifications are subject to change without notice. Mass and dimensions are approximate.
- Total harmonic distortion is measured by a digital spectrum analyzer.

## Unit and media care

Pull out the AC power plug from the outlet before maintenance.

### ■ Clean this unit with a soft, dry cloth

- When dirt is heavy, wring a cloth moistened in water tightly to wipe the dirt, and then wipe it with a dry cloth.
- When cleaning the speaker covers, use a fine cloth. Do not use tissues or other materials (towels, etc.) that can fall apart. Small grains may get stuck inside the speaker cover.
- Never use alcohol, paint thinner or benzene to clean this unit.
- Before using chemically treated cloth, carefully read the instructions that came with the cloth.

### ■ Maintenance of the lens

- Clean the lens regularly to prevent malfunctions. Use a blower to remove dust and a cotton swab if it is extremely dirty.
- You cannot use a CD type lens cleaner.
- Do not leave the sliding door open for prolonged periods of time. This will cause the lens to get dirty.
- Be careful not to touch the lens with your fingers.

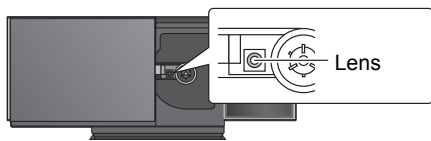

### ■ Clean discs

**DO**



**DO NOT**



Wipe with a damp cloth and then wipe dry.

### ■ Disc handling precautions

- Handle discs by the edges to avoid inadvertent scratches or fingerprints on the disc.
- Do not attach labels or stickers to discs.
- Do not use record cleaning sprays, benzene, thinner, static electricity prevention liquids or any other solvent.
- Do not use the following discs:
  - Discs with exposed adhesive from removed stickers or labels (rented discs etc.).
  - Discs that are badly warped or cracked.
  - Irregularly shaped discs, such as heart shapes.

### ■ To dispose or transfer this unit

The unit may keep the user settings information in the unit. If you discard this unit either by disposal or transfer, then follow the procedure to return all the settings to the factory presets to delete the user settings. (⇒ 16, "To return all settings to the factory preset")

- The operation history may be recorded in the memory of this unit.

## Licenses



"Made for iPod", and "Made for iPhone" mean that an electronic accessory has been designed to connect specifically to iPod, or iPhone, respectively, and has been certified by the developer to meet Apple performance standards.

Apple is not responsible for the operation of this device or its compliance with safety and regulatory standards. Please note that the use of this accessory with iPod, or iPhone may affect wireless performance.

AirPlay, the AirPlay logo, iPhone, iPod, iPod classic, iPod nano, and iPod touch are trademarks of Apple Inc., registered in the U.S. and other countries. iPad is a trademark of Apple Inc.



The Wi-Fi CERTIFIED Logo is a certification mark of the Wi-Fi Alliance.

The Wi-Fi Protected Setup Mark is a mark of the Wi-Fi Alliance.

"Wi-Fi", "Wi-Fi Protected Setup", "WPA" and "WPA2" are marks or registered marks of the Wi-Fi Alliance.

## Spanish Quick Reference / Referencia rápida en español

### Conexiones

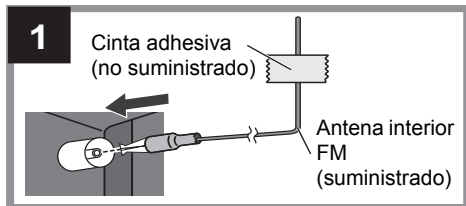

**2** Conecte el cable de alimentación AC después de que todas las demás conexiones estén completas.

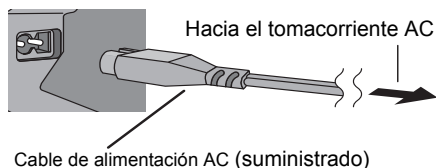

- Consumo de energía en Standby (modo de espera): Aprox. 0,1 W

### Insertar o sacar los medios

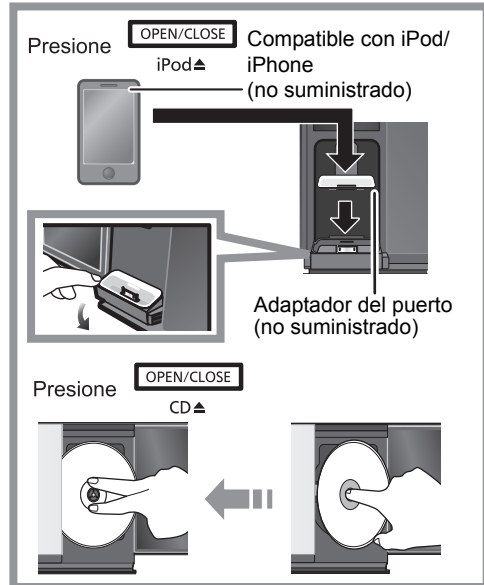

## Las operaciones de reproducción de CD, iPod/iPhone

### Preparación

- Encienda la unidad.
- Inserte el medio. (⇒ arriba)
- Presione [CD] o [iPod] para seleccionar la fuente de audio.

### Reproducción básica

<b>Reproducir</b>	Presione [▶/  ].
<b>Detención</b>	Presione [■].
<b>Pausa</b>	Presione [▶/  ]. Presione nuevamente para reiniciar la reproducción.
<b>Saltear</b>	Presione [◀◀/◀◀] o [▶▶/▶▶] para saltar una pista.
<b>Búsqueda</b>	Durante la reproducción Mantenga presionado [◀◀/◀◀] o [▶▶/▶▶].
<b>Volumen</b>	Presione [VOL -] o [VOL +] para ajustar el volumen.
<b>Mute</b>	Presione [MUTE] para silenciar el sonido.

### ■ iPod Para navegar por el menú de iPod/iPhone

- Abra Music App para usar esta función con los modelos iPod touch/iPhone.
- [▲, ▼]: Para navegar entre los elementos del menú.
- [OK]: Para ir al menú siguiente.
- [iPod MENU]: Para volver al menú anterior.



El funcionamiento puede variar entre los modelos de iPod/iPhone.



# Limited Warranty (ONLY FOR U.S.A. AND PUERTO RICO)

Panasonic Consumer Marketing Company of North America,  
Division of Panasonic Corporation of North America  
One Panasonic Way, Secaucus, New Jersey 07094

## Panasonic Home Audio Products Limited Warranty

### Limited Warranty Coverage (For USA and Puerto Rico Only)

If your product does not work properly because of a defect in materials or workmanship, Panasonic Consumer Marketing Company of North America (referred to as "the warrantor") will, for the length of the period indicated on the chart below, which starts with the date of original purchase ("warranty period"), at its option either (a) repair your product with new or refurbished parts, (b) replace it with a new or a refurbished equivalent value product, or (c) refund your purchase price. The decision to repair, replace or refund will be made by the warrantor.

Product or Part Name	Parts	Labor
Audio Products (except items below)	1 year	1 year
DVD Home Theater System	1 year	1 year
Home Theater Audio System	1 year	1 year
SD Memory Cards, Rechargeable Battery Packs (defective exchange)	90 days	Not Applicable

During the "Labor" warranty period there will be no charge for labor. During the "Parts" warranty period, there will be no charge for parts. This Limited Warranty excludes both parts and labor for non-rechargeable batteries, antennas, and cosmetic parts (cabinet). This warranty only applies to products purchased and serviced in the United States or Puerto Rico. This warranty is extended only to the original purchaser of a new product which was not sold "as is".

### Carry-In or Mail-In Service

To find a service center please visit <http://www.panasonic.com/help> or call 1-800-211-PANA (7262).

When shipping the unit, carefully pack, include all supplied accessories listed in the Owner's Manual, and send it prepaid, adequately insured and packed well in a carton box. When shipping Lithium Ion batteries please visit our Web Site at [www.panasonic.com/BatteryHandling](http://www.panasonic.com/BatteryHandling) as Panasonic is committed to providing the most up to date information. Include a letter detailing the complaint, a return address and provide a daytime phone number where you can be reached. A valid registered receipt is required under the Limited Warranty.

**IF REPAIR IS NEEDED DURING THE WARRANTY PERIOD, THE PURCHASER WILL BE REQUIRED TO FURNISH A SALES RECEIPT/ PROOF OF PURCHASE INDICATING DATE OF PURCHASE, AMOUNT PAID AND PLACE OF PURCHASE. CUSTOMER WILL BE CHARGED FOR THE REPAIR OF ANY UNIT RECEIVED WITHOUT SUCH PROOF OF PURCHASE.**

### Limited Warranty Limits and Exclusions

This warranty ONLY COVERS failures due to defects in materials or workmanship, and DOES NOT COVER normal wear and tear or cosmetic damage. The warranty ALSO DOES NOT COVER damages which occurred in shipment, or failures which are caused by products not supplied by the warrantor, or failures which result from accidents, misuse, abuse, neglect, mishandling, misapplication, alteration, faulty installation, set-up adjustments, misadjustment of consumer controls, improper maintenance, power line surge, lightning damage, modification, introduction

of sand, humidity or liquids, commercial use such as hotel, office, restaurant, or other business or rental use of the product, or service by anyone other than a Factory Service Center or other Authorized Servicer, or damage that is attributable to acts of God.

**THERE ARE NO EXPRESS WARRANTIES EXCEPT AS LISTED UNDER "LIMITED WARRANTY COVERAGE". THE WARRANTOR IS NOT LIABLE FOR INCIDENTAL OR CONSEQUENTIAL DAMAGES RESULTING FROM THE USE OF THIS PRODUCT, OR ARISING OUT OF ANY BREACH OF THIS WARRANTY.** (As examples, this excludes damages for lost time, travel to and from the servicer, loss of or damage to media or images, data or other memory or recorded content. The items listed are not exclusive, but for illustration only.) **ALL EXPRESS AND IMPLIED WARRANTIES, INCLUDING THE WARRANTY OF MERCHANTABILITY, ARE LIMITED TO THE PERIOD OF THE LIMITED WARRANTY.**

Some states do not allow the exclusion or limitation of incidental or consequential damages, or limitations on how long an implied warranty lasts, so the exclusions may not apply to you. This warranty gives you specific legal rights and you may also have other rights which vary from state to state. If a problem with this product develops during or after the warranty period, you may contact your dealer or Service Center. If the problem is not handled to your satisfaction, then write to the warrantor's Consumer Affairs Department at the addresses listed for the warrantor.

**PARTS AND SERVICE, WHICH ARE NOT COVERED BY THIS LIMITED WARRANTY, ARE YOUR RESPONSIBILITY.**

### Customer Services Directory (United States and Puerto Rico)

**Obtain Product Information and Operating Assistance; locate your nearest Dealer or Service Center; purchase Parts and Accessories; or make Customer Service and Literature requests by visiting our Web Site at:**

<http://www.panasonic.com/help>

**or, contact us via the web at:**

<http://www.panasonic.com/contactinfo>

You may also contact us directly at:

1-800-211-PANA (7262)

Monday-Friday 9am-9pm,

Saturday-Sunday 10am-7pm EST

**For hearing or speech impaired TTY users, TTY: 1-877-833-8855**

### Accessory Purchases (United States and Puerto Rico)

Purchase Parts, Accessories and Instruction Books online for all Panasonic Products by visiting our Web Site at:

<http://www.pstc.panasonic.com>

Or, send your request by E-mail to:

[npcparts@us.panasonic.com](mailto:npcparts@us.panasonic.com)

You may also contact us directly at:

1-800-332-5368 (Phone) 1-800-237-9080 (Fax Only)

(Monday-Friday 9am-9pm EST)

Panasonic National Parts Center

20421 84th Ave. S., Kent, WA 98032

(We accept Visa, MasterCard, Discover Card, American Express)

**For hearing or speech impaired TTY users, TTY: 1-866-605-1277**

**As of January 2012**

The model number and serial number of this product can be found on either the back or the bottom of the unit. Please note them in the space provided below and keep for future reference.

MODEL NUMBER SC-HC57  
SERIAL NUMBER \_\_\_\_\_

### User memo:

DATE OF PURCHASE \_\_\_\_\_  
DEALER NAME \_\_\_\_\_  
DEALER ADDRESS \_\_\_\_\_  
TELEPHONE NUMBER \_\_\_\_\_

## Limited Warranty (ONLY FOR CANADA)

**Panasonic Canada Inc.**

5770 Ambler Drive, Mississauga, Ontario L4W 2T3

## PANASONIC PRODUCT - LIMITED WARRANTY EXCHANGE PROGRAM

Panasonic Canada Inc. warrants this product to be free from defects in material and workmanship under normal use and for a period as stated below from the date of original purchase agrees to, at its option either (a) repair your product with new or refurbished parts, (b) replace it with a new or a refurbished equivalent value product, or (c) refund your purchase price. The decision to repair, replace or refund will be made by Panasonic Canada Inc.

Panasonic Portable / Clock Radio (without Tape, CD, MD)	One (1) year
Panasonic Audio Product	One (1) year
Panasonic DVD Product	One (1) year
Accessories including rechargeable batteries	Ninety (90) days

This warranty is given only to the original purchaser, or the person for whom it was purchased as a gift, of a Panasonic brand product mentioned above sold by an authorized Panasonic dealer in Canada and purchased and used in Canada, which product was not sold "as is", and which product was delivered to you in new condition in the original packaging.

IN ORDER TO BE ELIGIBLE TO RECEIVE WARRANTY SERVICE HEREUNDER, A PURCHASE RECEIPT OR OTHER PROOF OF DATE OF ORIGINAL PURCHASE, SHOWING AMOUNT PAID AND PLACE OF PURCHASE IS REQUIRED

## **LIMITATIONS AND EXCLUSIONS**

This warranty **ONLY COVERS** failures due to defects in materials or workmanship, and **DOES NOT COVER** normal wear and tear or cosmetic damage. The warranty **ALSO DOES NOT COVER** damages which occurred in shipment, or failures which are caused by products not supplied by Panasonic Canada Inc., or failures which result from accidents, misuse, abuse, neglect, mishandling, misapplication, alteration, faulty installation, set-up adjustments, misadjustment of consumer controls, improper maintenance, power line surge, lightning damage, modification, introduction of sand, humidity or liquids, commercial use such as hotel, office, restaurant, or other business or rental use of the product, or service by anyone other than an Authorized Servicer, or damage that is attributable to acts of God.

Dry cell batteries are also excluded from coverage under this warranty.

THIS EXPRESS, LIMITED WARRANTY IS IN LIEU OF ALL OTHER WARRANTIES, EXPRESS OR IMPLIED, INCLUDING ANY IMPLIED WARRANTIES OF MERCHANTABILITY AND FITNESS FOR A PARTICULAR PURPOSE. IN NO EVENT WILL PANASONIC CANADA INC. BE LIABLE FOR ANY SPECIAL, INDIRECT OR CONSEQUENTIAL DAMAGES RESULTING FROM THE USE OF THIS PRODUCT OR ARISING OUT OF ANY BREACH OF ANY EXPRESS OR IMPLIED WARRANTY. (As examples, this warranty excludes damages for lost time, travel to and from the Authorized Servicer, loss of or damage to media or images, data or other memory or recorded content. This list of items is not exhaustive, but for illustration only.)

In certain instances, some jurisdictions do not allow the exclusion or limitation of incidental or consequential damages, or the exclusion of implied warranties, so the above limitations and exclusions may not be applicable. This warranty gives you specific legal rights and you may have other rights which vary depending on your province or territory.

## CONTACT INFORMATION

For product information and operation assistance, please contact:

Our Customer Care Centre: Telephone #: 1-800-561-5505  
Fax #: (905) 238-2360  
Email link: "Support → contact us → email" on [www.panasonic.ca](http://www.panasonic.ca)

For defective product exchange within the warranty period, please contact the original dealer or our Customer Care Centre.

<b>CAUTION -</b>	VISIBLE AND INVISIBLE LASER RADIATION WHEN OPEN - AND INTERLOCKS DEFEATED -> DO NOT STARE INTO BEAM. FOR 21 CFR 136.05 (1 - a)
<b>CAUTION -</b>	CLASS 1M VISIBLE AND INVISIBLE LASER RADIATION WHEN OPEN AND INTERLOCKS DEFEATED. DO NOT VIEW DIRECTLY WITH OPTICAL INSTRUMENTS. EC00025-1 v42/Class 1M
<b>ATTENTION -</b>	RAYONNEMENT LASER VISIBLE ET INVISIBLE. CLASSE 1M, EN CAS D'OUVERTURE ET LORSQUE LA SECURITE EST NEUTRALISEE, NE PAS REGARDER DIRECTEMENT A L'AEDE D'INSTRUMENTS D'OPTIQUE.
<b>WARNING -</b>	KLASSE 1M SYNLIG OCH OSYNLIG LASERSTRÅLNING NÄR DENNA DEL ÄR ÖPPNAD OCH SPÄRRAR ÄR URKOPPLAD. BETRÄKTA EJ STRÅLEN DIREKT GENOM OPTISKA INSTRUMENT.
<b>FORSIGTIG -</b>	SYNLIG OG USYNLIG LASERSTRÅLING KLASSE 1M. NÅR LAGET ER ÅBENT OG SIKKERHEDS ÅBRYDERE ER UDE AF FUNKTION, UNDGÅ AT SE UDGE PÅ MED OPTISKE INSTRUMENTER.
<b>VARO!</b>	AVATTAESSA JA SUOJALUKITUS OHITETTAESSA OLET ALTTIINA LUOKAN 1M NÄKYVÄÄ JA NÄKYMÄTÖNÄ LASERSÄTEILYÄ, ÄLÄ KATSO OPTISELLÄ LAITTEELLA SUORAAN SÄTEESEEN.
<b>VORSICHT -</b>	SICHTBARE LASERSTRÄHLUNG KLASSE 1M. WENN ABSCHEIDUNG GEÖFFNET UND SICHERHEITSVORRICHTUNGEN ÜBERBRÜCKT, NICHT DIREKT MIT OPTISCHEN INSTRUMENTEN BETRACHTEN.
<b>PRECAUCION -</b>	RADIACION LASER VISIBLE E INVISIBLE CLASE 1M. AL ESTAR ABIERTO Y CON LOS INTERRUPTORES DE BLOQUEO DESHABILITADOS, NO MIRE DIRECTAMENTE CON INSTRUMENTOS OPTICOS.
<b>注意 -</b>	ET 开时及脱光敏时有可能见及不可见激光辐射。避免光束照射。RQJXST004

(Inside of product)

## -If you see this symbol-

### Information on Disposal in other Countries outside the European Union



This symbol is only valid in the European Union.  
If you wish to discard this product, please contact your local authorities or dealer and ask for the correct method of disposal.



As an ENERGY STAR® Partner,\* Panasonic has determined that this product meets the ENERGY STAR® guidelines for energy efficiency.

\*For Canada only: The word "Participant" is used in place of the word "Partner".

Panasonic Consumer Marketing  
Company of North America,  
Division of Panasonic Corporation of  
North America  
One Panasonic Way, Secaucus,  
New Jersey 07094  
<http://www.panasonic.com>

Panasonic Canada Inc.  
5770 Ambler Drive  
Mississauga, Ontario  
L4W 2T3  
[www.panasonic.ca](http://www.panasonic.ca)



## Listening Caution



Selecting fine audio equipment such as the unit you've just purchased is only the start of your musical enjoyment. Now it's time to consider how you can maximize the fun and excitement your equipment offers. This manufacturer and the Electronic Industries Association's Consumer Electronics Group want you to get the most out of your equipment by playing it at a safe level. One that lets the sound come through loud and clear without annoying blaring or distortion—and, most importantly, without affecting your sensitive hearing.

We recommend that you avoid prolonged exposure to excessive noise.

Sound can be deceiving. Over time your hearing "comfort level" adapts to higher volumes of sound. So what sounds "normal" can actually be loud and harmful to your hearing.

Guard against this by setting your equipment at a safe level BEFORE your hearing adapts.

To establish a safe level:

- Start your volume control at a low setting.
- Slowly increase the sound until you can hear it comfortably and clearly, and without distortion.

Once you have established a comfortable sound level:

- Leave it there.

Taking a minute to do this now will help to prevent hearing damage or loss in the future. After all, we want you listening for a lifetime.