

Panasonic®

Owner's Manual

Compact Stereo System



Model No. **SC-HC05**

Supplied Accessories

Check and identify the supplied accessories.

Use numbers indicated in parentheses when asking for replacement parts. (Product numbers correct as of January 2011. This may be subject to change.)

To order accessories, refer to "Accessory Purchases (United States and Puerto Rico)" on the next page.

☐ 1 x AC power supply cord

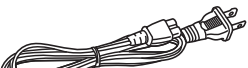

(K2CB2CB00021)

☐ 1 x Remote control

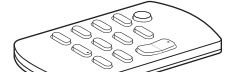

(RAK-SC989ZM)

☐ 1 x Lithium Button-Type battery

(Battery is already installed in the remote control.)



As an ENERGY STAR® Partner, Panasonic has determined that this product meets the ENERGY STAR® guidelines for energy efficiency.

Panasonic Consumer Electronics Company,
Division of Panasonic Corporation of North America

One Panasonic Way, Secaucus,
New Jersey 07094.
<http://www.panasonic.com>

© Panasonic Corporation 2011
Printed in China

P En Sp

RQTX1316-2P
L0111HH2031

IMPORTANT SAFETY INSTRUCTIONS

Read these operating instructions carefully before using the unit. Follow the safety instructions on the unit and the applicable safety instructions listed below. Keep these operating instructions handy for future reference.

- 1) Read these instructions.
- 2) Keep these instructions.
- 3) Heed all warnings.
- 4) Follow all instructions.
- 5) Do not use this apparatus near water.
- 6) Clean only with dry cloth.
- 7) Do not block any ventilation openings. Install in accordance with the manufacturer's instructions.
- 8) Do not install near any heat sources such as radiators, heat registers, stoves, or other apparatus (including amplifiers) that produce heat.
- 9) Do not defeat the safety purpose of the polarized or grounding-type plug. A polarized plug has two blades with one wider than the other. A grounding-type plug has two blades and a third grounding prong. The wide blade or the third prong are provided for your safety. If the provided plug does not fit into your outlet, consult an electrician for replacement of the obsolete outlet.
- 10) Protect the power cord from being walked on or pinched particularly at plugs, convenience receptacles, and the point where they exit from the apparatus.
- 11) Only use attachments/accessories specified by the manufacturer.
- 12) Use only with the cart, stand, tripod, bracket, or table specified by the manufacturer, or sold with the apparatus. When a cart is used, use caution when moving the cart/apparatus combination to avoid injury from tip-over.
- 13) Unplug this apparatus during lightning storms or when unused for long periods of time.
- 14) Refer all servicing to qualified service personnel. Servicing is required when the apparatus has been damaged in any way, such as power-supply cord or plug is damaged, liquid has been spilled or objects have fallen into the apparatus, the apparatus has been exposed to rain or moisture, does not operate normally, or has been dropped.



CAUTION: TO REDUCE THE RISK OF ELECTRIC SHOCK, DO NOT REMOVE SCREWS, NO USER-SERVICEABLE PARTS INSIDE. REFER SERVICING TO QUALIFIED SERVICE PERSONNEL.



The lightning flash with arrowhead symbol, within an equilateral triangle, is intended to alert the user to the presence of uninsulated "dangerous voltage" within the product's enclosure that may be of sufficient magnitude to constitute a risk of electric shock to persons.



The exclamation point within an equilateral triangle is intended to alert the user to the presence of important operating and maintenance (servicing) instructions in the literature accompanying the appliance.

The model number and serial number of this product can be found on either the back or the bottom of the unit. Please note them in the space provided below and keep for future reference.

MODEL NUMBER SC-HC05

SERIAL NUMBER

User memo:

DATE OF PURCHASE

DEALER NAME

DEALER ADDRESS

TELEPHONE NUMBER

Product identification marking is located on the bottom of unit.

The unit should be installed near an accessible AC power outlet, with the power cord connected directly to it.

To completely disconnect power from the unit, unplug the power cord from the AC power outlet.

FCC Note:

This equipment has been tested and found to comply with the limits for a Class B digital device, pursuant to Part 15 of the FCC Rules.

These limits are designed to provide reasonable protection against harmful interference in a residential installation. This equipment generates, uses and can radiate radio frequency energy and, if not installed and used in accordance with the instructions, may cause harmful interference to radio communications. However, there is no guarantee that interference will not occur in a particular installation. If this equipment does cause harmful interference to radio or television reception, which can be determined by turning the equipment off and on, the user is encouraged to try to correct the interference by one or more of the following measures:

- Reorient or relocate the receiving antenna.
- Increase the separation between the equipment and receiver.
- Connect the equipment into an outlet on a circuit different from that to which the receiver is connected.
- Consult the dealer or an experienced radio/TV technician for help.

FCC caution: To maintain compliance with FCC regulations, shielded interface cables must be used with this equipment. Operation with non-approved equipment or unshielded cables may result in interference to radio and TV reception. Any changes or modifications not approved by the party responsible for compliance could void the user's authority to operate this equipment.

This device complies with Part 15 of the FCC Rules.

Operation is subject to the following two conditions:

- (1) This device may not cause harmful interference, and
- (2) this device must accept any interference received, including interference that may cause undesired operation.

Responsible Party:

Panasonic Corporation of North America
One Panasonic Way
Secaucus, NJ 07094

Support Contact:
Panasonic Consumer Electronics Company
Telephone No.: 1-800-211-PANA (7262)



WARNING:

To satisfy FCC RF exposure requirements for mobile transmitting devices, a separation of 20 cm or more should be maintained between the antenna of this device and persons during device operation. To ensure compliance, operations at closer than this distance are not recommended. The antenna used for this transmitter must not be co-located in conjunction with any other antenna or transmitter.

CAUTION!

DO NOT INSTALL OR PLACE THIS UNIT IN A BOOKCASE, BUILT-IN CABINET OR IN ANOTHER CONFINED SPACE. ENSURE THE UNIT IS WELL VENTILATED. TO PREVENT RISK OF ELECTRIC SHOCK OR FIRE HAZARD DUE TO OVERHEATING, ENSURE THAT CURTAINS AND ANY OTHER MATERIALS DO NOT OBSTRUCT THE VENTILATION VENTS.

WARNING:

TO REDUCE THE RISK OF FIRE, ELECTRIC SHOCK OR PRODUCT DAMAGE,
• DO NOT EXPOSE THIS APPARATUS TO RAIN, MOISTURE, DRIPPING OR SPLASHING AND THAT NO OBJECTS FILLED WITH LIQUIDS, SUCH AS VASES, SHALL BE PLACED ON THE APPARATUS.
• USE ONLY THE RECOMMENDED ACCESSORIES.
• DO NOT REMOVE THE COVER (OR BACK); THERE ARE NO USER SERVICEABLE PARTS INSIDE. REFER SERVICING TO QUALIFIED SERVICE PERSONNEL.

CAUTION!

Danger of explosion if battery is incorrectly replaced. Replace only with the same or equivalent type recommended by the manufacturer. Dispose of used batteries according to the manufacturer's instructions.

WARNING

Risk of fire, explosion and burns. Do not disassemble, heat above 60°C (140°F) or incinerate.

WARNING

Keep the Button-Type battery out of reach of children to prevent swallowing.

– If you see this symbol –

Information on Disposal in other Countries outside the European Union



This symbol is only valid in the European Union. If you wish to discard this product, please contact your local authorities or dealer and ask for the correct method of disposal.

< For USA-California only >

This product contains a CR Coin Cell Lithium Battery which contains Perchlorate Material - special handling may apply. See www.dtsc.ca.gov/hazardouswaste/perchlorate.

The Bluetooth® word mark and logos are owned by the Bluetooth SIG, Inc. and any use of such marks by Panasonic Corporation is under license. Other trademarks and trade names are those of their respective owners.

Product service

1. **Damage requiring service** — The unit should be serviced by qualified service personnel if:
(a) The AC power supply cord or the plug has been damaged; or
(b) Objects or liquids have gotten into the unit; or
(c) The unit has been exposed to rain; or
(d) The unit does not operate normally or exhibits a marked change in performance; or
(e) The unit has been dropped or the cabinet damaged.

2. **Servicing** — Do not attempt to service the unit beyond that described in these operating instructions. Refer all other servicing to authorized servicing personnel.

3. **Replacement parts** — When parts need replacing ensure the service uses parts specified by the manufacturer or parts that have the same characteristics as the original parts. Unauthorized substitutes may result in fire, electric shock, or other hazards.

4. **Safety check** — After repairs or service, ask the servicer to perform safety checks to confirm that the unit is in proper working condition.

Product information

For product information or assistance with product operation: Refer to "Customer Services Directory (United States and Puerto Rico)".

Specifications

Amplifier section

RMS output power stereo mode

Front Ch (both ch driven) 20 W per channel (6 Ω), 1 kHz, 10% THD

40 W

FTC output power stereo mode

Front Ch (both ch driven) 15 W per channel (6 Ω), 20 Hz to 20 kHz, 10% THD

Total FTC stereo mode power 30 W

Terminal section

AUX (rear)

Terminal Stereo, 3.5 mm (1/8") jack

Speaker section

Type 2 way, 2 speaker system (passive radiator)

Speaker unit(s)

Woofer 6.5 cm (2 1/2") cone type x 1/ch

Tweeter 1.5 cm (5/16") piezo type x 1/ch

Passive radiators 8 cm (3 1/8") x 2/ch

Impedance 6 Ω

Bluetooth® section

Bluetooth® system specification

Ver. 2.1 + EDR

Wireless equipment classification Class 2 (2.5 mW)

Support profiles A2DP, AVRCP

Frequency band

2402 MHz to 2480 MHz (Adaptive Frequency Hopping)

Driving distance 10 m (33 ft) line of sight

(iPhone 4, at height 1 m (3.3 ft), in MODE 1)

General

Power supply AC 120 V, 60 Hz

Power consumption 16 W

Dimensions (W x H x D) 370 mm x 176 mm x 85 mm

(14 1/2" x 7" x 3 1/2")

[D = 121 mm (4 3/4") dock open]

[D = 59 mm (2 1/2") without stand]

Mass (Weight) 1.8 kg (9 lb.)

Operating temperature range 0°C to +40°C

(+32°F to +104°F)

Operating humidity range

35% to 80% RH (no condensation)

Power consumption in standby mode

0.1 W (approximate)

Note:

1. Specifications are subject to change without notice. Mass and dimensions are approximate.
2. Total harmonic distortion is measured by the digital spectrum analyzer.

Getting started

Remote control

Before using

Remove the insulation sheet before you use the remote control for the first time.

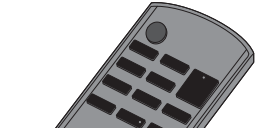

Insulation sheet

Replacing the battery

Replace the remote control battery when it stops operating or when the range is decreased. Replace with a new battery (CR2025) only.

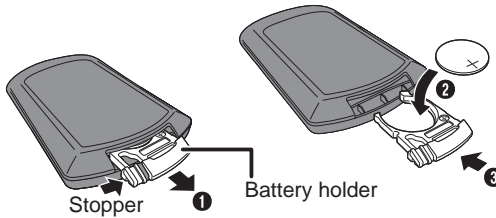

1 While pressing the stopper, pull out the battery holder.

2 Insert a new battery with the (+) side facing up.

3 Push the battery holder back fully.

CAUTION!

- Insert with poles aligned.
- Do not touch the terminals (+ and –) with metal objects.
- Do not recharge, disassemble, remodel, heat or throw into fire.
- Keep out of reach of children.
- Do not heat or expose to flame.
- Do not leave the battery(ies) in an automobile exposed to direct sunlight for a long period of time with doors and windows closed.
- Remove the battery if you do not use the remote control for a long period of time. Keep in a cool, dark area.

If any electrolyte should come into contact with your hands or clothes, wash it off thoroughly with water.

If any electrolyte should come into contact with your eyes, never rub the eyes. Rinse eyes thoroughly with water, and then consult a doctor.

Connect the AC power supply cord

Rear view

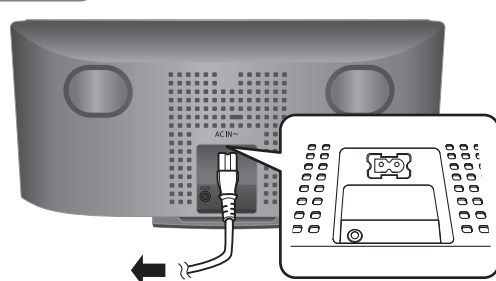

To household AC outlet

- Use the included AC power supply cord with this system only.
- Do not use an AC power supply cord from other equipment.

Conserving power

The system consumes approximately 0.1 W when it is in standby mode. Disconnect the power supply if you do not use the system. Some settings will be lost after you disconnect the system. You have to set them again.

Speakers

- Do not remove the speaker nets.
- These speakers do not have magnetic shielding. Do not put them near TVs, PCs or other devices easily influenced by magnetism.
- When you play at high levels for a long period, it can cause damage to the system and decrease the life of the system.
- Decrease the volume when you play distorted sound to prevent damage.

Overview of controls

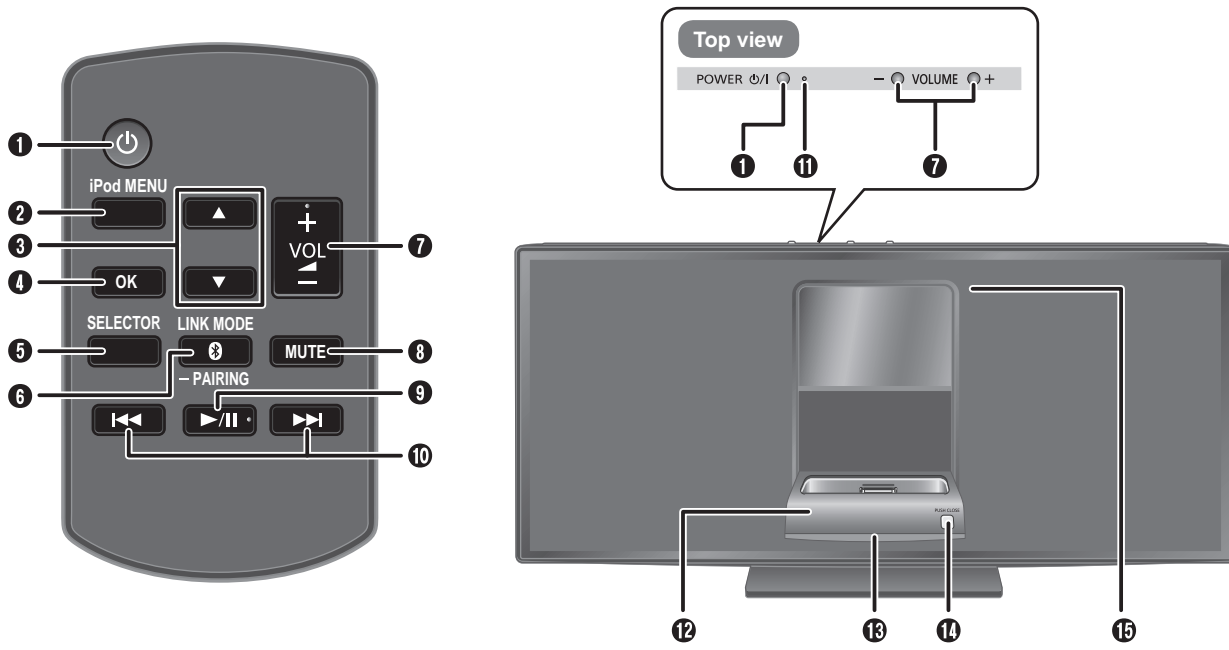

- 1 Standby/on switch [⏻], [ON/OFF POWER]
Press to switch the unit from on to standby mode or vice versa. In standby mode, the unit is still consuming a small amount of power.

2 View the iPod or iPhone menu

3 Select an item

- 4 Confirm a selection
Set or cancel the auto off function

- 5 Select iPod, Internet radio, Bluetooth® or AUX mode
Bluetooth® is the default mode except when an iPod or iPhone is connected.

- 6 Start Bluetooth® pairing mode
Select Bluetooth® link mode
Adjust the audio input level in AUX mode

- 7 Adjust the volume of the system
The setting returns to the default when you disconnect the AC power supply cord.

- 8 Mute the sound of the system
In iPod mode : The light blue and green status indicators blink alternately.
In Bluetooth® mode : The light blue and blue status indicators blink alternately.
In AUX mode : The light blue status indicator blinks continuously.

This function does not work when the system is pairing or waiting to connect with a Bluetooth® device. Press the button again to cancel. Mute is also canceled when you adjust the volume or when you switch off the system.

9 Start or pause playback

10 Skip or search track

- 11 Power indicator
On : The system is on
Off : The system is in standby mode

12 iPod or iPhone dock

- 13 Status indicator
Green : iPod mode
Blue : Bluetooth® mode
Light blue : Set or cancel the auto off function
Mute function is on : AUX mode
The green status indicator blinks each time a remote control button is pressed.

- 14 [PUSH CLOSE]
Press while closing the dock.

- 15 Remote control sensor
Point the remote control at the remote control sensor, away from obstacles, at a maximum range of 7 m (23 ft) directly in front of the main unit.

Using an iPod or iPhone

Connecting an iPod or iPhone

Preparation

Update your iPod or iPhone with the latest software. Make sure to remove the iPod or iPhone from its case.

- 1 Push [▲, iPod] to open the dock.

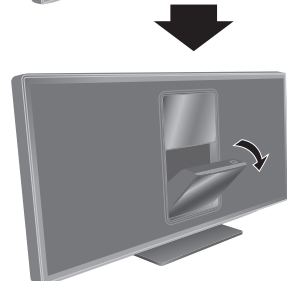

- 2 Insert a compatible dock adapter.

- 3 Connect the iPod or iPhone.

The status indicator changes to green.

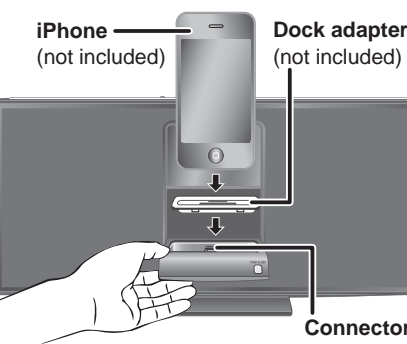

Hold the dock when connecting or disconnecting the iPod or iPhone.

To close the dock

- 1 Disconnect the iPod or iPhone.

- 2 Press [PUSH CLOSE] while closing the dock.

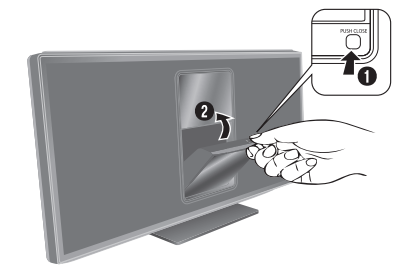

Note:

- Make sure to align your iPod or iPhone with the connector when inserting.
- Make sure to press [PUSH CLOSE] while closing the dock to prevent damage.
- When an iPod or iPhone is connected, press [SELECTOR] to switch between modes (Internet radio, Bluetooth®, AUX or iPod).
- The system automatically switches on when you connect an iPod or iPhone that is in playback mode (except for some models).
- To purchase a dock adapter, consult your local iPod or iPhone dealer.

Basic playback

- 1 Connect the iPod or iPhone.

- 2 Press [▶/⏮] to start playback.

Pause playback	Press [▶/⏮]. Press again to continue playback.
Skip track	Press [◀◀] or [▶▶].
Search track	Press and hold [◀◀] or [▶▶].
View the iPod or iPhone menu	Press [iPod MENU].
Select an item	Press [▲] or [▼] and then press [OK].

Note:

- Depending on the model, it may be necessary to remove the iPod or iPhone and select the album, artist, etc. on the iPod or iPhone.
- Operation results may vary depending on the iPod or iPhone models.
- Read the User Guide of the iPod or iPhone for operating instructions.

Compatible iPod and iPhone

(as of January 2011)

- iPod touch 4th generation (8GB, 32GB, 64GB)
- iPod nano 6th generation (8GB, 16GB)
- iPod touch 3rd generation (32GB, 64GB)
- iPod nano 5th generation (video camera) (8GB, 16GB)
- iPod touch 2nd generation (8GB, 16GB, 32GB)
- iPod classic [120GB, 160GB (2009)]
- iPod nano 4th generation (video) (8GB, 16GB)
- iPod classic (160GB) (2007)
- iPod touch 1st generation (8GB, 16GB, 32GB)
- iPod nano 3rd generation (video) (4GB, 8GB)
- iPod classic (80GB)
- iPod nano 2nd generation (aluminum) (2GB, 4GB, 8GB)
- iPod 5th generation (video) (60GB, 80GB)
- iPod 5th generation (video) (30GB)
- iPod nano 1st generation (1GB, 2GB, 4GB)
- iPhone 4 (16GB, 32GB)
- iPhone 3GS (8GB, 16GB, 32GB)
- iPhone 3G (8GB, 16GB)
- iPhone (4GB, 8GB, 16GB)

Compatibility depends on the software version of your iPod or iPhone.

Note:

- The display on the iPod can show differently because of the compatibility of the iPod models.
- All phone features can only be controlled by the touch screen of the iPhone.
- The system does not show incoming calls or the phone status.
- Playback will stop when there is an incoming call. Disconnect the iPhone to answer the call.
- A call is not canceled when you connect or disconnect the iPhone from the system.
- There is no Apple Inc. specification that will guarantee the above iPhone response. iPhone responses can be different on newer models or with newer software.

Charging an iPod or iPhone

An iPod or iPhone is charged automatically when connected to the system (even when the system is in standby mode).

- See the iPod or iPhone display for its battery charging status.
- The system automatically switches on when you connect an iPod or iPhone that is in playback mode (except for some models).
- To purchase a dock adapter, consult your local iPod or iPhone dealer.

Preparation

Install "vTuner for Panasonic" on your iPod touch or iPhone. Connect your iPod touch or iPhone to the Internet. Go to the Home screen of the iPod touch or iPhone.

Note:
For compatible iPod touch and iPhone models and instructions on how to use the "vTuner for Panasonic" application, refer to:
<http://radio.vtuner.com/panasonic/en/>

- 1 Connect the iPod touch or iPhone.

- 2 Press [SELECTOR] to start the application.

Listening to the Internet radio

You can listen to a radio station on the Internet if you install the "vTuner for Panasonic" application on your iPod touch or iPhone. Download this application from the App Store.

Note:
For compatible iPod touch and iPhone models and instructions on how to use the "vTuner for Panasonic" application, refer to:
<http://radio.vtuner.com/panasonic/en/>

Using the auto off function

The system automatically switches off if there is no audio input and you do not use it for approximately 30 minutes.

Using Bluetooth®

You can connect and play an audio device wirelessly through Bluetooth®.

Panasonic bears no responsibility for data and/or information that can possibly be compromised during a wireless transmission.

Preparation

Switch on the Bluetooth® feature of the device and put the device near the system. Read the operating instructions of the device for details.

The blue status indicator can indicate different Bluetooth® conditions:

Blinks quickly	The system is ready for pairing.
Blinks slowly	The system is waiting to connect.
Lighted	A Bluetooth® device is connected.

Pairing and connecting a device

1 Press [SELECTOR] to select Bluetooth® mode.
Status indicator: Blue

2 Access the Bluetooth® menu of the device and search for "SC-HC05".

3 Pair or connect the device to "SC-HC05".

If prompted for a passkey, input "0000".

The device connects with this system automatically after pairing is complete.

Note:

- A device must be paired to connect.
- This system can only connect to one device at a time.
- A device stays connected even if the system is switched to iPod or AUX mode.

Pairing with additional devices

1 Press [SELECTOR] to select Bluetooth® mode.

2 Press and hold [⓪, --PAIRING].

3 Access the Bluetooth® menu of the device and search for "SC-HC05".

4 Pair or connect the device to "SC-HC05".

You can pair up to 6 devices with this system. If a 7th device is paired, the device with the oldest connection history will be replaced.

You only have to do pairing once, unless:

- The pairing of the device has been replaced.
- The memory of this system has been reset.
- The pairing of "SC-HC05" has been deleted from the device.

Disconnecting a device

A device is disconnected when you:

- Switch off the system or the device.
- Move the device out of the maximum range.
- Stop or disable the Bluetooth® transmission of the device.

Basic playback

1 Press [SELECTOR] to select Bluetooth® mode.

2 Connect the device.

3 Press [▶/||] to start playback.

Pause playback	Press [▶/].
	Press again to continue playback.
Skip track	Press [◀◀] or [▶▶].

Troubleshooting guide

Before requesting service, make the following checks. If you are in doubt about some of the check points, or if the solutions indicated do not solve the problem, refer to "Customer Services Directory (United States and Puerto Rico)".

Common problems

Power indicator blinks and then the system automatically switches off.

- An error has occurred. Disconnect the AC power supply cord. Wait for a few seconds, connect the AC power supply cord and then switch on the system again. If the problem continues, contact an authorized service center.

No sound.

- Examine the connections.
- Increase the volume of the system.
- Examine the volume of the iPod, iPhone, Bluetooth® device or portable audio equipment.
- Make sure that the iPod, iPhone, Bluetooth® device or portable audio equipment is actually playing something.

Sound is distorted.

- Lower the volume of the system.
- Noise can occur if you play a lower quality audio content.
- Make sure that the equalizer function of the iPod, iPhone, Bluetooth® device or portable audio equipment is switched off.
- Move mobile telephones away from the main unit if the interference is apparent.

A "humming" sound can be heard during playback.

- An AC power supply cord or fluorescent light is near the cable. Keep other appliances and cords away from the cable of this system.

No response when remote control buttons are pressed.

- Remove the insulation sheet before you use the remote control for the first time.
- Examine that the battery is installed correctly.
- The battery is weak. Replace it with a new one.

Other Panasonic equipment responds to the remote control of this system.

This system responds to the remote control of other Panasonic equipment.

- Change the remote control code of the other Panasonic equipment.

iPod or iPhone

iPod or iPhone does not switch on.

- Make sure that the iPod or iPhone battery is not depleted. Charge the iPod or iPhone.
- Switch off the system and then switch it on again.

Note:

- When playing iPod or iPhone by Bluetooth® with the main unit, intermittent sound may be experienced if you leave the iPod or iPhone Bluetooth® menu screen active or when making Bluetooth® registration and connection. If this occurs, please exit the iPod or iPhone Bluetooth® menu screen.
- If playback does not start, stop or disable the Bluetooth® transmission of the device and then connect the device again.
- If you connect an iPod or iPhone to the dock when it is playing via Bluetooth®, the system switches to iPod mode and playback is paused. Press [▶/||] to continue playback.

Link mode

You can select different modes to suit the type of connection.

1 Stop or disable the Bluetooth® transmission of the device.

2 Press [⓪, LINK MODE].
MODE 1 ↔ MODE 2 (default)

MODE 1 → MODE 2: The light blue status indicator blinks 4 times.

MODE 2 → MODE 1: The light blue status indicator blinks 2 times.

MODE 1	For stable communication.
MODE 2	For good audio quality. Communication can disconnect easily. Select "MODE 1" if this occurs.

About Bluetooth®

Frequency band

- This system uses the 2.4 GHz frequency band.

Certification

- This system conforms to frequency restrictions and has received certification based on frequency laws. Thus, a wireless permit is not necessary.
- The actions below are punishable by law:
 - Taking apart or modifying the main unit.
 - Removing specification indications from the bottom of this main unit.

Restrictions of use

- Wireless transmission and/or usage with all Bluetooth® equipped devices is not guaranteed.
- All devices must conform to standards set by Bluetooth SIG, Inc.
- Depending on the specifications and settings of a device, it can fail to connect or some operations can be different.
- This system supports Bluetooth® security features. But depending on the operating environment and/or settings, this security is possibly not sufficient. Transmit data wirelessly to this system with caution.
- This system cannot transmit data to a Bluetooth® device.

Range of use

- Use this device at a maximum range of 10 m (33 ft).
- The range can decrease depending on the environment, obstacles or interference.

Interference from other devices

- Other devices can use the same frequency as this system and cause the system to operate incorrectly or sound distortion.
- To prevent interference from other devices:
 - Keep the system away from other devices that emit radio frequency interference.
 - Do not use this system and a wireless LAN device at the same time. Switch off any wireless LAN device.

Intended usage

- This system is for normal, general use only.
- Do not use this system near an equipment or in an environment that is sensitive to radio frequency interference (example: airports, hospitals, laboratories, etc.).

iPod or iPhone does not respond.

- Make sure that the system is in iPod mode.
- The iPod or iPhone is not connected correctly. Remove the iPod or iPhone and connect it again.

iPod or iPhone does not charge.

- Examine the connections.

Bluetooth®

Pairing cannot be done.

- The device is out of the 10 m (33 ft) communication range. Move the device nearer to the system.

The device cannot be connected.

- The pairing of the device was unsuccessful. Read the instructions and try again.
- The pairing of the device has been replaced. Do pairing again.
- Make sure that the system is not connected to a different device.

The device is connected but audio cannot be heard through the system.

- For some built-in Bluetooth® devices, you have to set the audio output to "SC-HC05" manually. Read the operating instructions of the device for details.

Sound from the device is broken.

- The device is out of the 10 m (33 ft) communication range. Move the device nearer to the system.
- Remove any obstacle between the system and the device.
- Switch off any wireless LAN device.
- Select "MODE 1" for stable communication.

Memory reset (Initialization)

When the following situations occur, refer to the instructions below to reset the memory:

- There is no response when buttons are pressed.
- You want to clear and reset the memory contents.

To reset the memory

1 Disconnect the AC power supply cord.

2 While you press and hold [⓪, POWER] on the main unit, connect the AC power supply cord again. Wait until the power indicator lights up.

3 Release [⓪, POWER].

All the settings are set back to the factory preset. The system is in standby mode. Switch on the system to set the memory items again.

Using the auxiliary input

You can connect a portable audio equipment and listen to the audio through this system.

Preparation

Switch off the equalizer (if any) of the portable audio equipment to prevent sound distortion. Decrease the volume of the system and the portable audio equipment before you connect or disconnect the portable audio equipment.

1 Connect the portable audio equipment.

Plug type: Ø 3.5 mm (1/8") stereo

2 Press [SELECTOR] to select AUX mode.

Status indicator: Off

3 Play the portable audio equipment.

Note:

- Read the operating instructions of the portable audio equipment for details.
- Components and cables are sold separately.

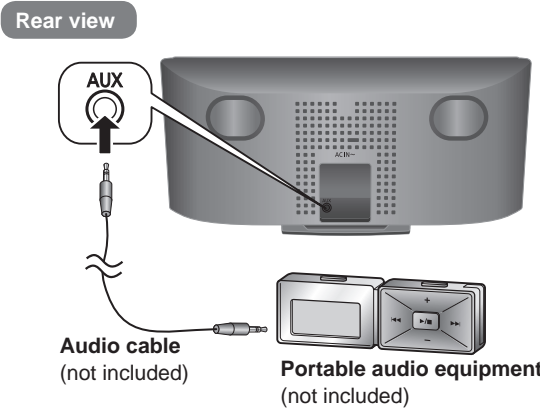

To adjust the audio input level

Press [⓪, LINK MODE/-PAIRING].
NORMAL ↔ HIGH (default)

Note:

- Select "NORMAL" if the sound is distorted during "HIGH" input level.
- The setting returns to the default when you disconnect the AC power supply cord.

Limited Warranty

Panasonic Consumer Electronics Company,
Division of Panasonic Corporation of North America
One Panasonic Way, Secaucus, New Jersey 07094

Panasonic Home Audio Products Limited Warranty

Limited Warranty Coverage (For USA and Puerto Rico Only)

If your product does not work properly because of a defect in materials or workmanship, Panasonic Consumer Electronics Company (referred to as "the warrantor") will, for the length of the period indicated on the chart below, which starts with the date of original purchase ("warranty period"), at its option either (a) repair your product with new or refurbished parts, (b) replace it with a new or a refurbished equivalent value product, or (c) refund your purchase price. The decision to repair, replace or refund will be made by the warrantor.

Product or Part Name	Parts	Labor
Audio Products (except items below)	1 year	1 year
DVD Home Theater System	1 year	1 year
Home Theater Audio System	1 year	1 year
USB Reader-writer, PC Card Adapters (defective exchange)	1 year	Not Applicable
Accessories: Headphones, cartridges, Microphones, Adapters	90 days	90 days
Rechargeable Batteries, DVD-RAM Disc (defective exchange)	10 days	Not Applicable
SD Memory Cards, Rechargeable Battery Packs (defective exchange)	90 days	Not Applicable

During the "Labor" warranty period there will be no charge for labor. During the "Parts" warranty period, there will be no charge for parts. This Limited Warranty excludes both parts and labor for non-rechargeable batteries, antennas, and cosmetic parts (cabinet). This warranty only applies to products purchased and serviced in the United States or Puerto Rico. This warranty is extended only to the original purchaser of a new product which was not sold "as is".

Carry-In or Mail-In Service

To find a service center please visit <http://www.panasonic.com/help> or call 1-800-211-PANA (7262).

When shipping the unit, carefully pack, include all accessories, and send it prepaid, adequately insured and preferably in the original carton. When shipping Lithium Ion batteries please visit our Web Site at www.panasonic.com/BatteryHandling as Panasonic is committed to providing the most up to date information. Include a letter detailing the complaint, a return address and provide a daytime phone number where you can be reached. A valid registered receipt is required under the Limited Warranty.

IF REPAIR IS NEEDED DURING THE WARRANTY PERIOD, THE PURCHASER WILL BE REQUIRED TO FURNISH A SALES RECEIPT/PROOF OF PURCHASE INDICATING DATE OF PURCHASE, AMOUNT PAID AND PLACE OF PURCHASE. CUSTOMER WILL BE CHARGED FOR THE REPAIR OF ANY UNIT RECEIVED WITHOUT SUCH PROOF OF PURCHASE.

Limited Warranty Limits And Exclusions

This warranty ONLY COVERS failures due to defects in materials or workmanship, and DOES NOT COVER normal wear and tear or cosmetic damage. The warranty ALSO DOES NOT COVER damages which occurred in shipment, or failures which are caused by products not supplied by the warrantor, or failures which result from accidents, misuse, abuse, neglect, mishandling, misapplication, alteration, faulty installation, set-up adjustments, misadjustment of consumer controls, improper maintenance, power line surge, lightning damage, modification, introduction of sand, humidity or liquids, commercial use such as hotel, office, restaurant, or other business or rental use of the product, or service by anyone other than a Factory Service Center or other Authorized Service, or damage that is attributable to acts of God.

THERE ARE NO EXPRESS WARRANTIES EXCEPT AS LISTED UNDER "LIMITED WARRANTY COVERAGE". THE WARRANTOR IS NOT LIABLE FOR INCIDENTAL OR CONSEQUENTIAL DAMAGES RESULTING FROM THE USE OF THIS PRODUCT, OR ARISING OUT OF ANY BREACH OF THIS WARRANTY. (As examples, this excludes damages for lost time, travel to and from the service, loss of or damage to media or images, data or other memory or recorded content. The items listed are not exclusive, but for illustration only.)
ALL EXPRESS AND IMPLIED WARRANTIES, INCLUDING THE WARRANTY OF MERCHANTABILITY, ARE LIMITED TO THE PERIOD OF THE LIMITED WARRANTY.

Some states do not allow the exclusion or limitation of incidental or consequential damages, or limitations on how long an implied warranty lasts, so the exclusions may not apply to you.

This warranty gives you specific legal rights and you may also have other rights which vary from state to state. If a problem with this product develops during or after the warranty period, you may contact your dealer or Service Center. If the problem is not handled to your satisfaction, then write to the warrantor's Consumer Affairs Department at the addresses listed for the warrantor.

PARTS AND SERVICE, WHICH ARE NOT COVERED BY THIS LIMITED WARRANTY, ARE YOUR RESPONSIBILITY.

Customer Services Directory (United States and Puerto Rico)

Obtain Product Information and Operating Assistance; locate your nearest Dealer or Service Center; purchase Parts and Accessories; or make Customer Service and Literature requests by visiting our Web Site at:

<http://www.panasonic.com/help>

or, contact us via the web at:

<http://www.panasonic.com/contactinfo>

You may also contact us directly at:

1-800-211-PANA (7262)

Monday-Friday 9am-9pm, Saturday-Sunday 10am-7pm EST

For hearing or speech impaired TTY users, TTY: 1-877-833-8855

Accessory Purchases (United States and Puerto Rico)

Purchase Parts, Accessories and Instruction Books online for all Panasonic Products by visiting our Web Site at:

<http://www.pstc.panasonic.com>

Or, send your request by E-mail to:

npcparts@us.panasonic.com

You may also contact us directly at:

1-800-332-5368 (Phone) 1-800-237-9080 (Fax Only)

(Monday-Friday 9am-9pm EST)

Panasonic Service and Technology Company

20421 84th Avenue South, Kent, WA 98032

(We accept Visa, MasterCard, Discover Card, American Express, and Personal Checks)

For hearing or speech impaired TTY users, TTY: 1-866-605-1277

As of December 2010

ESPAÑOL

Visión general de los controles

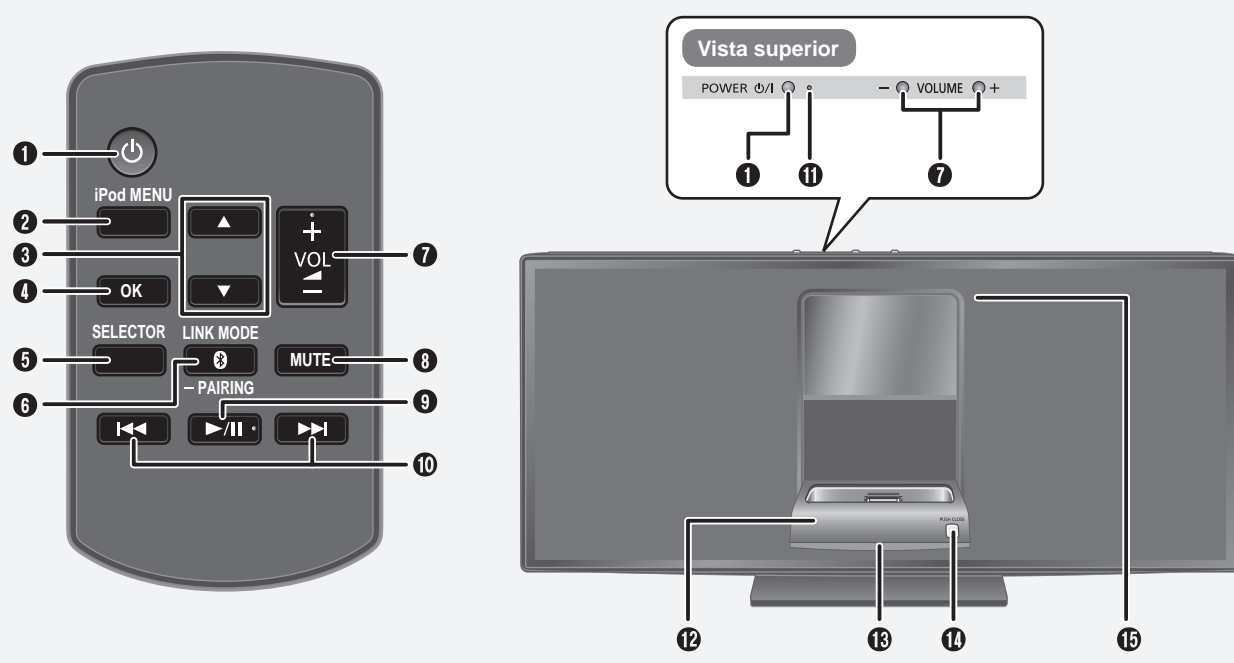

1 Interruptor de alimentación en espera/conectada [⓪],

[⓪, POWER] Pulse este interruptor para cambiar del modo de alimentación conectada al modo de alimentación en espera o viceversa. En el modo de alimentación en espera, la unidad consume una pequeña cantidad de corriente.

2 Vea el menú del iPod o iPhone

3 Seleccione un elemento

4 Confirmar selección Configure o cancele la función de apagado automático

5 Seleccione el modo iPod, radio de Internet, Bluetooth® o AUX El modo predeterminado, excepto cuando hay un iPod o iPhone conectado.

6 Inicie el modo de pareo por Bluetooth® Elija el modo de vínculo por Bluetooth® Ajuste el nivel de entrada de audio en el modo AUX

7 Ajuste el volumen del sistema La configuración se restaurará a los valores predeterminados cuando desconecte el cable de alimentación de CA.

8 Desactive el sonido del sistema

En modo iPod : Los indicadores de estado azul claro y verde parpadean alternativamente.

En modo Bluetooth® : Los indicadores de estado azul claro y azul parpadean alternativamente.

En modo AUX : El indicador de estado azul claro parpadea continuamente. Esta función no está activa cuando el sistema está en modo de pareo o esperando conectar con un dispositivo Bluetooth®. Pulse el botón nuevamente para cancelar. El silenciado del sonido también se cancela cuando usted ajusta el volumen o cuando apaga el sistema.

Cómo usar un iPod o iPhone

Cómo conectar un iPod o iPhone

Preparación Actualice su iPod o iPhone con el software más reciente. Asegúrese de sacar el iPod o el iPhone de su estuche.

1 Pulse [▲, iPod] para abrir la base de acoplamiento.

2 Introduzca un adaptador para base de acoplamiento compatible.

3 Conectar el iPod o iPhone.

El indicador de estado cambia a verde.

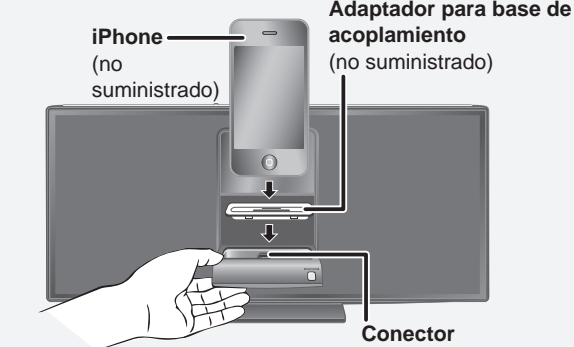

Sujete la base de acoplamiento al conectar o desconectar el iPod o el iPhone.

Para cerrar la base de acoplamiento

1 Desconectar el iPod o iPhone.

2 Pulse [PUSH CLOSE] mientras cierra la base de acoplamiento.

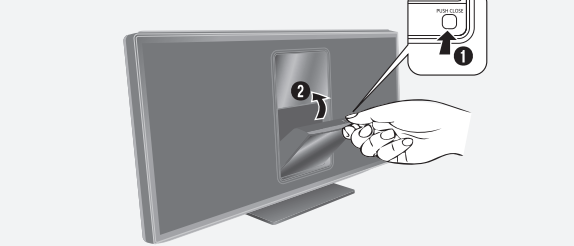

Note:

- Asegúrese de alinear su iPod o iPhone con el conector cuando realice la inserción.
- Asegúrese de pulsar [PUSH CLOSE] mientras cierra la base de acoplamiento para evitar daños.
- Cuando se conecta un iPod o iPhone, pulse [SELECTOR] para conmutar entre modos (radio Internet, Bluetooth®, AUX o iPod).
- El sistema se activa automáticamente cuando conecta un iPod o iPhone que está en modo de reproducción (excepto en algunos modelos).
- Para comprar un adaptador para base de acoplamiento, consulte a su distribuidor local de iPod o iPhone.

Escuchar la radio de Internet

Puede escuchar una estación de radio en Internet si instala la aplicación "vTuner for Panasonic" en su iPod touch o iPhone. Descargue esta aplicación de App Store.

Note:

Para obtener modelos compatibles para iPod touch e iPhone e instrucciones sobre cómo utilizar la aplicación "vTuner for Panasonic", refiérase a: <http://radio.vtuner.com/panasonic/en/>

Preparación

Instale "vTuner for Panasonic" en su iPod touch o iPhone. Conecte su iPod touch o iPhone al Internet. Vaya a la Pantalla de inicio en su iPod touch o iPhone.

1 Conectar el iPod touch o iPhone.

2 Pulse [SELECTOR] para iniciar la aplicación.

Uso de Bluetooth®

Puede conectar y reproducir un dispositivo de audio de manera inalámbrica a través de Bluetooth®.

Panasonic no se responsabiliza por datos y/o información que podrían correr algún riesgo durante la transmisión inalámbrica.

Preparación

Encienda la opción de Bluetooth® en el dispositivo y ponga el dispositivo cerca del sistema. Lea las instrucciones de operación del dispositivo para obtener más detalles.

El indicador de estado azul puede indicar distintas condiciones de Bluetooth®:

Parpadea rápidamente	El sistema está listo para el pareo.
Parpadea lentamente	El sistema está esperando conexión.
Encendido	Un dispositivo Bluetooth® está conectado.

Pareo y conexión de un dispositivo

1 Pulse [SELECTOR] para seleccionar el modo Bluetooth®.
Indicador de estado: Azul

2 Acceda al menú Bluetooth® del dispositivo y busque "SC-HC05".

3 Paree o conecte el dispositivo a "SC-HC05".

Si le pide clave de acceso, ingrese "0000". El dispositivo se conecta con el sistema automáticamente, después que se hubiera completado el pareo.

Note:

- Para conectarse, un dispositivo debe estar pareado.
- El sistema sólo puede conectarse a un dispositivo a la vez.
- El dispositivo permanece conectado incluso si el sistema se cambia a modo iPod o AUX.

Pareo con dispositivos adicionales

1 Pulse [SELECTOR] para seleccionar el modo Bluetooth®.

2 Pulse y mantenga pulsado [⓪, --PAIRING].

3 Acceda al menú Bluetooth® del dispositivo y busque "SC-HC05".

4 Paree o conecte el dispositivo a "SC-HC05".

Puede parear hasta 6 dispositivos con este sistema. Si se para un 7mo dispositivo, el dispositivo con el historial de conexión más antiguo será reemplazado.