

Panasonic®

Operating Instructions CD Stereo System

Model No. **SC-EN38**

Dear customer

Thank you for purchasing this product.
Before connecting, operating or adjusting this product, please read the instructions completely.
Please keep this manual for future reference.

If you have any questions contact

In the U.S.A.: 1-800-211-PANA (7262)

In Canada: 1-800-561-5505

Table of contents

Supplied accessories	cover
IMPORTANT SAFETY INSTRUCTIONS	2
The remote control	3
Control guide	3
Attach the stand to the unit	4
Placement of speakers	4
Connections	4
Disc operations	5
Radio operations	6
External unit	7
Timer	8
Sound adjustment	9
Specifications	9
Product Service	9
Troubleshooting guide	10
Maintenance	10
Limited Warranty (ONLY FOR U.S.A.)	11
Limited Warranty (ONLY FOR CANADA)	back cover
Listening caution	back cover

These instructions are applicable to the following systems.

System	SC-EN38
Main unit	SA-EN38
Speakers	SB-EN38

Supplied accessories



Please check and identify the supplied accessories.

Use numbers indicated in parentheses when asking for replacement parts.

(Product numbers correct as of November 2007.)

These may be subject to change.)

Only for the U.S.A.: To order accessories, refer to "Accessory Purchases" on page 11.

Only for Canada: To order accessories, call the dealer from whom you have made your purchase.

☐ 1 Remote control



(N2QAYB000247)

☐ 1 Support stand



(RYQX0512-H)

☐ 1 FM/AM antenna



(N1DADYY00003)

☐ 2 Batteries



☐ 1 AC power supply cord

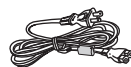

(RFAX0023)

Note

- The included AC power supply cord is for use with this unit only. Do not use it with other equipment.
- Do not use an AC power supply cord from other equipment.

The included Canadian French language sheet corresponds to this unit's English displays.

COMPACT
disc
DIGITAL AUDIO

= IMPORTANT SAFETY INSTRUCTIONS

Read these operating instructions carefully before using the unit. Follow the safety instructions on the unit and the applicable safety instructions listed below. Keep these operating instructions handy for future reference.

- 1) Read these instructions.
- 2) Keep these instructions.
- 3) Heed all warnings.
- 4) Follow all instructions.
- 5) Do not use this apparatus near water.
- 6) Clean only with dry cloth.
- 7) Do not block any ventilation openings. Install in accordance with the manufacturer's instructions.
- 8) Do not install near any heat sources such as radiators, heat registers, stoves, or other apparatus (including amplifiers) that produce heat.
- 9) Do not defeat the safety purpose of the polarized or grounding-type plug. A polarized plug has two blades with one wider than the other. A grounding-type plug has two blades and a third grounding prong. The wide blade or the third prong are provided for your safety. If the provided plug does not fit into your outlet, consult an electrician for replacement of the obsolete outlet.
- 10) Protect the power cord from being walked on or pinched particularly at plugs, convenience receptacles, and the point where they exit from the apparatus.
- 11) Only use attachments/accessories specified by the manufacturer.
- 12) Use only with the cart, stand, tripod, bracket, or table specified by the manufacturer, or sold with the apparatus. When a cart is used, use caution when moving the cart/apparatus combination to avoid injury from tip-over.
- 13) Unplug this apparatus during lightning storms or when unused for long periods of time.
- 14) Refer all servicing to qualified service personnel. Servicing is required when the apparatus has been damaged in any way, such as power-supply cord or plug is damaged, liquid has been spilled or objects have fallen into the apparatus, the apparatus has been exposed to rain or moisture, does not operate normally, or has been dropped.





CAUTION

**RISK OF ELECTRIC SHOCK
DO NOT OPEN**

CAUTION: TO REDUCE THE RISK OF ELECTRIC SHOCK, DO NOT REMOVE SCREWS. NO USER-SERVICEABLE PARTS INSIDE. REFER SERVICING TO QUALIFIED SERVICE PERSONNEL.

WARNING:

TO REDUCE THE RISK OF FIRE, ELECTRIC SHOCK OR PRODUCT DAMAGE,

- DO NOT EXPOSE THIS APPARATUS TO RAIN, MOISTURE, DRIPPING OR SPLASHING AND THAT NO OBJECTS FILLED WITH LIQUIDS, SUCH AS VASES, SHALL BE PLACED ON THE APPARATUS.
- USE ONLY THE RECOMMENDED ACCESSORIES.
- DO NOT REMOVE THE COVER (OR BACK); THERE ARE NO USER SERVICEABLE PARTS INSIDE. REFER SERVICING TO QUALIFIED SERVICE PERSONNEL.

CAUTION!

DO NOT INSTALL OR PLACE THIS UNIT IN A BOOKCASE, BUILT-IN CABINET OR IN ANOTHER CONFINED SPACE. ENSURE THE UNIT IS WELL VENTILATED. TO PREVENT RISK OF ELECTRIC SHOCK OR FIRE HAZARD DUE TO OVERHEATING, ENSURE THAT CURTAINS AND ANY OTHER MATERIALS DO NOT OBSTRUCT THE VENTILATION VENTS.

CAUTION!

THIS PRODUCT UTILIZES A LASER. USE OF CONTROLS OR ADJUSTMENTS OR PERFORMANCE OF PROCEDURES OTHER THAN THOSE SPECIFIED HEREIN MAY RESULT IN HAZARDOUS RADIATION EXPOSURE. DO NOT OPEN COVERS AND DO NOT REPAIR YOURSELF. REFER SERVICING TO QUALIFIED PERSONNEL.

 The lightning flash with arrowhead symbol, within an equilateral triangle, is intended to alert the user to the presence of uninsulated "dangerous voltage" within the product's enclosure that may be of sufficient magnitude to constitute a risk of electric shock to persons.

 The exclamation point within an equilateral triangle is intended to alert the user to the presence of important operating and maintenance (servicing) instructions in the literature accompanying the appliance.

CAUTION	CLASS 1M INVISIBLE LASER RADIATION WHEN OPEN AND INTERLOCKS DEFEATED. DO NOT VIEW DIRECTLY WITH OPTICAL INSTRUMENTS. IEC60825-1 +A2 Class 1M
WARNING	KLASS 1M OSYNLIG LASERSTRÅLNING NÄR DENNA DEL ÄR ÖPPNAD OCH SPÄRREN ÄR URKOPPLAD. BETRÄKTA EJ STRÅLEN DIREKT GENOM OPTISKT INSTRUMENT.
FORSIGTIG	OSYNLIG LASERSTRÅLNING KLASSE 1M. NÄR LÄGGET ER ÅBENT OG SIKKERHEDSÅBRYDERE ER UDE AF FUNKTION. UNDGA AT SE LIGE PÅ MED OPTISKE INSTRUMENTER.
VARO	AVATTAESSA JA SUOJALUKITUS OHITETTAESSA OLET ALLTIN LUOKAN 1M NÄKYMÄTÖNÄ LASERSÄTELYÄ. ÄLÄ KATSO OPTISELLA LAITTEELLA SUORAAN SÄTEESEEN.
VORSICHT	UNSICHTBARE LASERSTRAHLUNG KLASSE 1M. WENN ABDECKUNG GEÖFFNET UND SICHERHEITSPERRIEGELUNGEN ÜBERBRÜCKT NICHT DIREKT MIT OPTISCHEN INSTRUMENTEN BETRACHTEN.
ATTENTION	RAYONNEMENT LASER INVISIBLE, CLASSE 1M, EN CAS D'OUVERTURE ET LORSQUE LA SÉCURITÉ EST NEUTRALISÉE. NE PAS REGARDER DIRECTEMENT À L'AIDE D'INSTRUMENTS D'OPTIQUE. RCLVS0033

ONLY FOR CANADA

(Inside of product)

-If you see this symbol-

Information on Disposal in other Countries outside the European Union



This symbol is only valid in the European Union. If you wish to discard this product, please contact your local authorities or dealer and ask for the correct method of disposal.

The socket outlet shall be installed near the equipment and easily accessible. The mains plug of the power supply cord shall remain readily operable. To completely disconnect this apparatus from the AC Mains, disconnect the power supply cord plug from AC receptacle.

This product may receive radio interference caused by mobile telephones during use. If such interference is apparent, please increase separation between the product and the mobile telephone.

The remote control

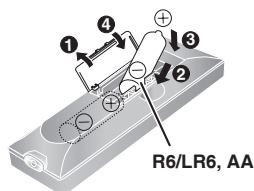

Batteries

- Insert so the poles (+ and -) match those in the remote control.
- Do not use rechargeable type batteries.
- Do not heat or expose to flame.



Remote control signal sensor

Use

- Aim at the sensor, avoiding obstacles, at a maximum range of 7 m (23 feet) directly in front of the unit.
- Operation can be affected by strong light sources, such as direct sunlight, and the glass doors on cabinets.

CAUTION

Danger of explosion if battery is incorrectly replaced. Replace only with the same or equivalent type recommended by the manufacturer. Dispose of used batteries according to the manufacturer's instructions.

Control guide

- [SLEEP]** Sleep timer setting (8)
- Standby/on switch** [⏻], [⏻/1, POWER] (5, 8)
Press to switch the unit from on to standby mode or vice versa.
In standby mode, the unit is still consuming a small amount of power.
- [CLOCK/TIMER]** (8)
Clock and Timer setting
- [PGM, -AUTO PRESET]** (5, 6)
CD/MP3 Program, Tuner Preset (Manual)
[Long press] Tuner Preset (Auto)
- [CLEAR]** (5)
CD/MP3: Delete all programs
- [DEL]** Delete last programmed track (5)
- [FM/AM]** (6)
Selector switch to Tuner for FM and AM
- [iPod ▶/II]** (7)
Selector switch to iPod®
Direct iPod Play/iPod Pause
- [VOL-], [+VOL], [VOLUME -, +]** (5, 7, 8)
To adjust the volume
- [◀, ▶, ALBUM]** (5)
MP3: Previous/Next Album
- [ENTER]** (5)
MP3: Confirm track selection during Program Mode
- [PRESET EQ]** Preset EQ mode selector (9)
- [REMASTER]** Remaster on/off (9)
- [D.BASS]** D.BASS on/off (9)

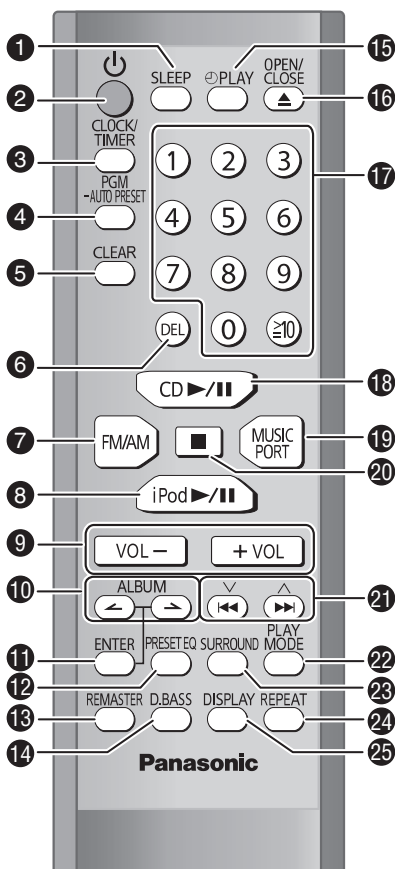

- Play timer on/off [⏻ PLAY] (15)
- [▲, OPEN/CLOSE] (16)
Open and Close CD lid
- Numbered buttons [1-9, 0, ≥10] (17)
To select a 2-digit number
e.g. 16: [≥10] → [1] → [6]
To select a 3-digit number
e.g. 226: [≥10] → [≥10] → [2] → [2] → [6]
- [CD ▶/II] (18)
Selector switch to CD
Direct CD Play/CD Pause
- [MUSIC PORT] (19)
Selector switch to MUSIC PORT
Play portable audio equipment
- Stop button [■] (20)
- Navigation buttons: [◀◀, ▶▶], [◀, ▶], [◀/II], [▶/II] (21)
CD: Skip/Search
MP3: Track Skip
Tuner: Tune up/down
[Long press] Auto tuning
- Play mode button [PLAY MODE] (22)
- Surround mode on/off [SURROUND] (23)
- Repeat on/off [REPEAT] (24)
- [DISPLAY] (25)
CD: CD Display (Elapsed play time/
Remaining play time)
MP3: MP3 Display (Elapsed time/Album
name/Track name/ID3 (Album)/ID3 (Track)/
ID3 (Artist))

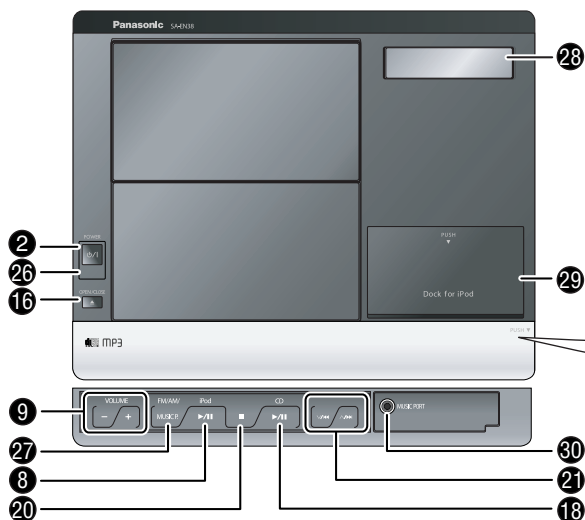

Push to open the lid.

- Remote control signal sensor (26)
- [FM/AM/MUSIC P.] (27)
FM/AM/MUSIC PORT select button
- Display (28)
- Built-in iPod Dock (29)
- Music port jack (30)

Attach the stand to the unit

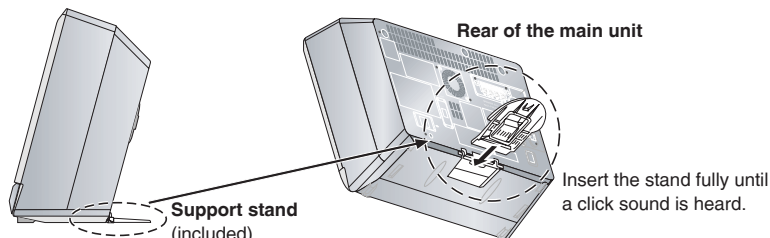

Ensure the stand is securely attached to the main unit for stabilization.

Note

- The supplied stand is specially designed for use with this unit.
- Only use as indicated in this setup.

Placement of speakers



Speakers are designed identically so that no left or right channel orientation is necessary.

Note

- Keep your speakers at least 10 mm (13/32") away from the system for proper ventilation.
- These speakers do not have magnetic shielding. Do not place them near televisions, personal computers or other devices easily influenced by magnetism.
- You cannot take the front net off the speakers.

Caution

- Use the speakers only with the recommended system. Failure to do so may lead to damage to the amplifier and/or speakers, and may result in the risk of fire. Consult a qualified service person if damage has occurred or if you experience a sudden change in performance.
- Do not attach these speakers to walls or ceilings.

Connections

1 Speakers

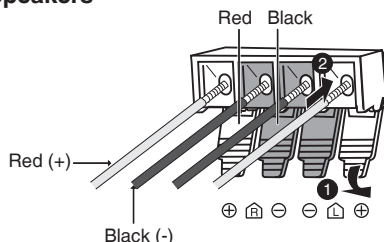

Headphones (not included)

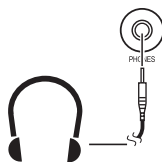

Reduce the volume level and connect the headphones.
Plug type: 3.5 mm (1/8") stereo

Note

To prevent hearing damage, avoid listening for prolonged periods of time.

2 FM/AM antenna

Stand the antenna up on its base.

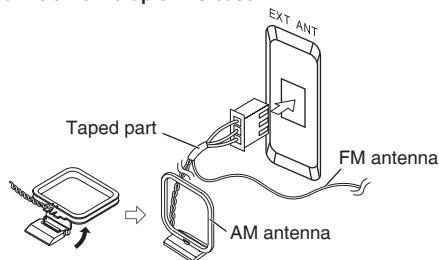

Unplug the antenna connector by holding the taped part.

3 AC power supply cord

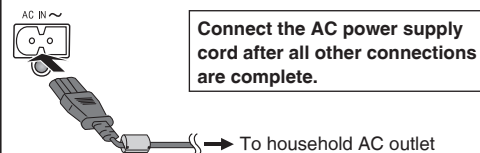

Conserving power

The unit consumes 2.6 W even it is turned off with [⏻/I, POWER]. To save power when the unit is not to be used for a long time, unplug it from the household AC outlet.

Remember to reset the radio stations and any other memory items before using the unit again.

Note

If the unit is left unplugged for longer than approximately two weeks, all settings will revert to the factory settings.

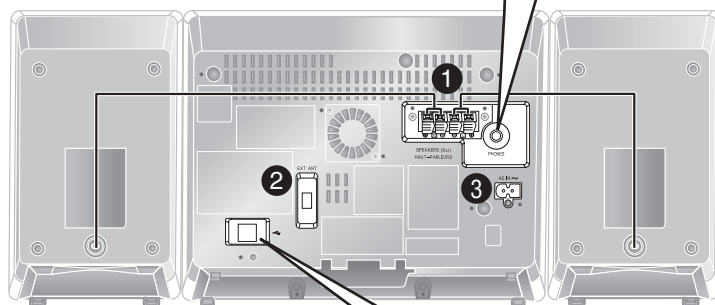

PC Sync

Connect your PC to the PC Sync port.

➔ Refer to page 7 for further information.

iPod connection

Insert your iPod into the Built-in iPod Dock.

➔ Refer to page 7 for further information.

Portable audio equipment (Cords and equipment not included)



Start playback from the portable audio source.

Note

- Adjust the volume and sound quality of this unit and the other equipment.
- For details, refer to the instruction manual of the other equipment.

Disc operations

Basic play

- 1 Press [⏻/I, POWER] to turn the unit on.
- 2 Press [⏻, OPEN/CLOSE] to open the CD lid and then set the CD in place.
Press [⏻, OPEN/CLOSE] again to close the lid.
Keep fingers away from the CD lid when it is closing to avoid possible minor injury.

Label must face outward.
Press until you hear it click into place.

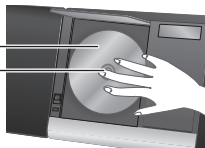

- 3 Press [CD ▶/II] to start play.
- 4 Adjust the volume.

Note

- Be sure to press the [⏻, OPEN/CLOSE] button to open and close the CD lid.
- Damage may occur if the lid is forced closed.
- During standby, if the CD is ready in the unit, the unit comes on and play begins. (One touch play)

Stop	Press [■].
Pause	Press [CD ▶/II]. Press again to resume play.
Skip/Search	Press [◀◀, ∨] or [▶▶, ∧] to skip. Press and hold [◀◀, ∨] or [▶▶, ∧] to search. Note <ul style="list-style-type: none"> • You can search during play or while paused. • You cannot search through MP3 files. • You can only search within the current track during program play, one track repeat, and random play.
Skip album MP3	Press [◀ or →, ALBUM] in the play mode. Press [◀ or →, ALBUM] once and then the numbered buttons in the stop mode.
Direct access play (Play starts with the track you select.)	CD Press the numbered buttons to select the desired track. MP3 <ol style="list-style-type: none"> 1 Press [◀ or →, ALBUM] to select the album. 2 Press [▶▶, ∧] once and then press the numbered buttons to select the desired track.

Repeat play

REPEAT

You can repeat program play or other selected play mode.

Press [REPEAT] before or during play.

"REPEAT ON" and "↺" are displayed.

To cancel

Press [REPEAT] again.

"REPEAT OFF" is displayed and "↺" is cleared.

Display function

DISPLAY

This function allows you to display the information of the current track.

Press [DISPLAY] repeatedly during play or pause.

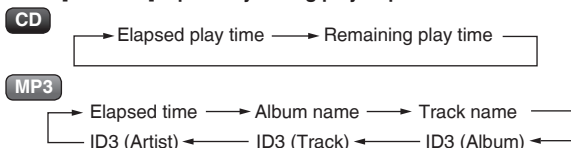

Note

- Maximum number of displayable characters: approximately 30.
- This unit supports ver. 1.0 & 1.1 ID3 tags. Text data that is not supported will not be displayed.
- ID3 is a tag embedded in MP3 tracks to provide information about the track.

Program play

PGM
- AUTO PRESET

The function allows you to program up to 24 tracks.

CD

- 1 Press [PGM, -AUTO PRESET] while stopped.
- 2 Press the numbered buttons to select tracks. (Maximum 24 tracks)
Repeat this step to program other tracks.
- 3 Press [CD ▶/II] to start play.

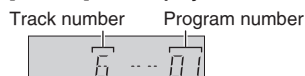

MP3

- 1 Press [PGM, -AUTO PRESET] while stopped.
- 2 Press [◀ or →, ALBUM] to select your desired album.
- 3 Press [▶▶, ∧] once and then press the numbered buttons to select tracks. (Maximum 24 tracks)
- 4 Press [ENTER].
Repeat step 2 to 4 to program other tracks.
- 5 Press [CD ▶/II] to start play.

Album number Track number



■ Confirm a programmed track	Press [◀◀, ∨] or [▶▶, ∧] when "PGM" is displayed in the stop mode. To check while programming, press [PGM, -AUTO PRESET] twice after "PGM" appears, then press [◀◀, ∨] or [▶▶, ∧].
■ Delete the last track	Press [DEL] in the stop mode.
■ Delete all programs	Press [CLEAR] in the stop mode. "CLR ALL" is displayed.
■ Cancel program mode	Press [PGM, -AUTO PRESET] in the stop mode to clear "PGM" indicator from the display.

Note

Program contents are stored in the unit's memory even after changing to a different function or turning the unit off. All program contents are erased by pressing [CLEAR] or by opening the CD lid.

Play Mode function

PLAY
MODE

Press [PLAY MODE] to select the desired mode.

Mode	To play
1-TRACK 1TR	one selected track on the disc. Press the numbered buttons to select the track.
1-ALBUM 1ALBUM	one selected album on the disc. Press [◀ or →, ALBUM] to select the album.
RANDOM RND	a disc randomly.
1-ALBUM RANDOM 1ALBUM RND	all tracks in one selected album randomly. Press [◀ or →, ALBUM] to select the album.

Note

During random play, you cannot skip to previous track.

Disc operation (continued)

Note on CD-R and CD-RW

This unit can play CD-R and CD-RW recorded with CD-DA or MP3. Use an audio recording disc for CD-DA and finalize* it when you finish recording. The unit may not be able to play some discs due to the condition of the recording.

* A process performed after recording that enables CD-R/CD-RW players to play audio CD-R and CD-RW.

Caution

Choose discs with this mark:

Do not:

- use irregularly shaped CDs.
- attach extra labels and stickers.
- use CDs with labels and stickers that are coming off or with adhesive exuding from under labels and stickers.
- attach scratch-proof covers or any other kind of accessory.
- write anything on the CD.
- clean CDs with liquids (Wipe with a soft, dry cloth.).



Note about using a DualDiscs

- The digital audio content side of a DualDiscs does not meet the technical specifications of the Compact Disc Digital Audio (CD-DA) format, so play may not be possible.
- Do not use a DualDiscs in this unit as it may not be possible to insert it correctly and it may get scratched or scraped.

MP3

The unit can play MP3, a method of compressing audio without overly hurting audio quality.

When creating MP3 files to play on this unit

- Maximum number of tracks and albums: 999 tracks and 256 albums.
- Compatible compression rate: Between 64 kbps and 320 kbps (stereo). 128 kbps (stereo) is recommended.
- Disc formats: ISO9660 level 1 and level 2 (except for extended formats).
- The time for reading TOC depends on the number of the tracks, the folders or folder structures.

Limitations on MP3

- This unit is compatible with multi-session but if there are a lot of sessions it takes more time for play to start. Keep the number of sessions to a minimum to avoid this.
- This unit cannot play files recorded using packet write.
- If the disc includes both MP3 and normal audio data (CD-DA), the unit plays the type recorded in the inner part of the disc. If the disc includes both MP3 and other types of audio data (e.g. WMA or WAV), the unit plays only the MP3.
- Depending on how you create MP3 files, they may not play in the order you numbered them or may not play at all.

Radio operations

Allocation settings

Each country allocates broadcast bands according to their particular system.

You can change the FM steps. The step is factory-set to 0.2 MHz, but you can change it to receive broadcasts allocated 0.1 MHz steps.

Any FM/AM frequencies preset in channels will be changed by this procedure.

Preset them again.

① Select the FM band with [FM/AM/MUSIC P.] on the unit.

② Press and hold [FM/AM/MUSIC P.] on the unit.



After a few seconds the display changes to show the current minimum frequency. Continue to hold the button down. The minimum frequency changes and the step is changed.

To return to the original step, repeat the above steps.

Note

The preset memory will be initialized when you change your frequency step.

Manual tuning

- ① Press [FM/AM] to select "FM" or "AM".
- ② Press [PLAY MODE] to select "MANUAL".
- ③ Press [◀, ∨] or [▶, ∧] to select the frequency of the required station.

To tune automatically

- ① Press [FM/AM] to select "FM" or "AM".
- ② Press [PLAY MODE] to select "MANUAL".
- ③ Press and hold [◀, ∨] or [▶, ∧] until the frequency starts changing rapidly.

- Auto tuning stops when it finds a station.
- To cancel auto tuning, press [◀, ∨] or [▶, ∧] once again.

Note

Auto tuning may not function when there is excessive interference.

To improve reception

FM

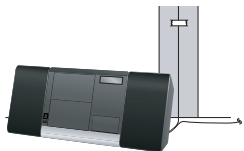

Receive the radio stations after connecting the antenna. Then attach the antenna cord to a wall or pillar where there is good reception.

AM



Change the direction and location of the antenna.

To improve FM sound quality

Press and hold [PLAY MODE] to display "MONO".



To cancel

Press and hold [PLAY MODE] again until "MONO" disappears.

- "MONO" is also canceled if the frequency is changed.
- Turn off "MONO" for normal listening.

Memory preset

You can preset up to 30 FM channels and up to 15 AM channels.

Preparation: Press [FM/AM] to select "FM" or "AM".

Automatic presetting

Press and hold [PGM, -AUTO PRESET] to start presetting.

Manual presetting

- ① Press [PLAY MODE] to select "MANUAL".
- ② Press [◀, ∨] or [▶, ∧] to tune to the required station.
- ③ Press [PGM, -AUTO PRESET].
- ④ Press the numbered buttons to select a channel.

The station occupying a channel is erased if another station is preset in that channel.

- ⑤ Repeat steps 2 to 4 to preset more stations.

Selecting a preset station

Press the numbered buttons to select the channel.

For channels 10 to 30 press [≥10], then the two digits.

OR

- ① Press [PLAY MODE] to select "PRESET".
- ② Press [◀, ∨] or [▶, ∧] to select the channel.

External unit

Enjoying audio from iPod

■ Inserting the iPod

- ① Push to open the Built-in iPod Dock and then press down until a click sound is heard.
- ② Insert the suitable dock adapter for your iPod.
- ③ Insert your iPod into the dock.
 - Hold the dock when connecting/disconnecting the iPod.
 - Recharging starts when the iPod is inserted.

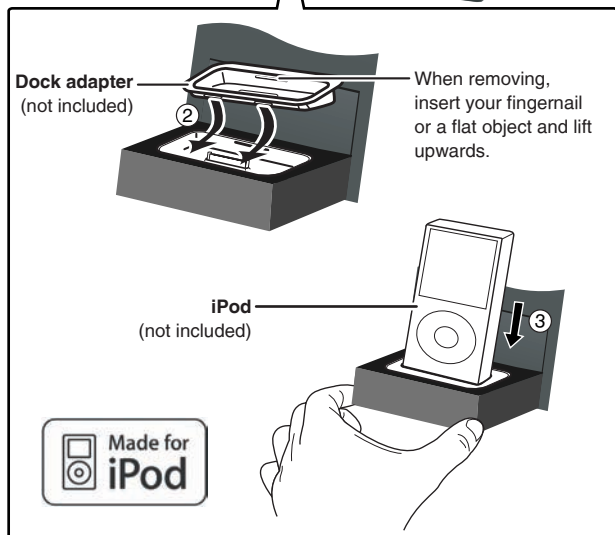
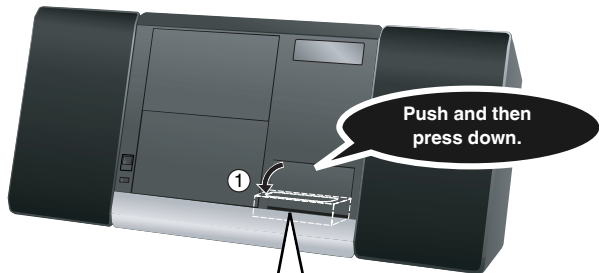

Note

It is recommended to use the dock adapter from Apple.

■ Playing the iPod

Preparation:

- Reduce the volume of the main unit.
- Confirm the iPod connection. (➡ above)
- Confirm the USB cable is removed. (➡ PC Sync, right)

- ① Press [iPod ▶/||] to play the iPod.
- ② Adjust the volume of the main unit.

	Remote control	Main unit
To pause track	iPod ▶/	iPod ▶/
To skip a track (During play/pause)	⏮ ⏭	⏮ ⏭
To search the current track (During play/pause)	press and hold ⏮ ⏭	press and hold ⏮ ⏭

Note

When you select another source or turn the main unit off, the iPod turns off.

■ Charging the iPod

- iPod will start recharging regardless of whether this unit is in On or Standby condition.
- "IPOD *" will be shown on the main unit's display during iPod charging in main unit standby mode.
- Check iPod to see if the battery is fully recharged.
- If you are not using iPod for an extended period of time after recharging has completed, disconnect it from main unit, as the battery will be depleted naturally. (Once fully recharged, additional recharging will not occur.)

■ Compatible iPod

Name	Memory size
iPod touch	8GB, 16GB
iPod nano 3rd generation (video)	4GB, 8GB
iPod classic	80GB, 160GB
iPod nano 2nd generation (aluminum)	2GB, 4GB, 8GB
iPod 5th generation (video)	60GB, 80GB
iPod 5th generation (video)	30GB
iPod nano 1st generation	1GB, 2GB, 4GB
iPod 4th generation (color display)	40GB, 60GB
iPod 4th generation (color display)	20GB, 30GB
iPod 4th generation	40GB
iPod 4th generation	20GB
iPod mini	4GB, 6GB

- Compatibility depends on the software version of your iPod.

■ PC Sync

Enables data synchronization between PC and iPod without unplugging iPod from the set.

Preparation:

Confirm the iPod is well inserted into the dock. (➡ left)

- ① **Connect your PC to the main unit through USB cable.** (PC will automatically detect iPod.)
To transfer songs to iPod, refer to iPod instruction manual.
- ② **Before disconnecting the USB cable, make sure the procedure of safe eject of hardware from PC is done.**

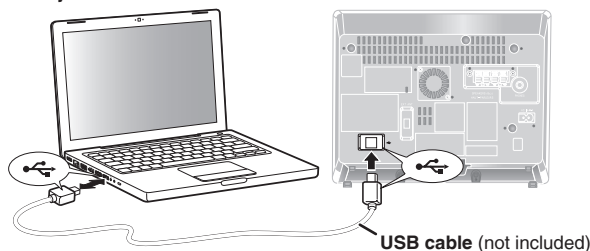

Note

PC Sync will function only when the main unit is in Standby or On condition.

Recording and operating problems may occur on some computer systems.

Please note that Panasonic and Panasonic dealers cannot be held liable for any lost audio data or other direct or indirect damage except in cases of intentional or gross negligence.

iPod is a trademark of Apple Inc., registered in the U.S. and other countries.

External unit (continued)

Changing the main unit and remote control mode

The remote control and main unit are factory-set to "REMOTE 1" mode. If your remote control affects other equipment during operation, you can switch to operate in "REMOTE 2" mode.



To switch to "REMOTE 2" mode

- ① Press [FM/AM/MUSIC P.] to select "AM".
- ② (While pressing [FM/AM/MUSIC P.] on the main unit)
Press and hold [2] until "REMOTE 2" appears on the main unit display.
- ③ Press and hold [ENTER] and [2] for at least 2 seconds.
The main unit and remote control are now set to operate in "REMOTE 2" mode.

To return to "REMOTE 1" mode

Perform steps 1 to 3 but use [1] instead of [2] for steps 2 and 3. ("REMOTE 1" appears on the main unit during step 2.)

The remote control cannot work with the main unit if their modes are different.

"REMOTE 1" or "REMOTE 2" appears on the main unit when you operate the remote control.*

- * If "REMOTE 1" appears (The main unit is in "REMOTE 1" mode.)
Press and hold [ENTER] and [1] on the remote control for at least 2 seconds.
- If "REMOTE 2" appears (The main unit is in "REMOTE 2" mode.)
Press and hold [ENTER] and [2] on the remote control for at least 2 seconds.

Timer

Setting the time



This is a 12-hour clock.

- ① Press [CLOCK/TIMER] to set the clock.
- ② Press [◀, ∨] or [▶, ^] to select the time within 5 seconds.
(Press and hold to change the time faster.)
- ③ Press [CLOCK/TIMER] again.

■ To display the clock when the unit is on Press [CLOCK/TIMER]

Note

- The clock is accurate to within ±60 seconds a month. Readjust if necessary.
- Set again after disconnecting the AC power supply cord or power failure.

Sleep timer



The SLEEP timer can turn the unit off after a set time.

Press [SLEEP] to turn the SLEEP function on/off.

- Each time you press the button:

30MIN → 60MIN → 90MIN → 120MIN
↑ OFF (Canceled) ↓

■ To check the remaining time Press [SLEEP] once

Note

The play timer and sleep timer can be used together. The sleep timer always has priority. Be sure not to overlap timer settings.

Play timer



You can set the timer to come on at a certain time to wake you up.

Preparation:

- Turn the unit on and set the clock.
- Prepare the music source (disc, radio, iPod or music port) and set the volume.

- ① Press [CLOCK/TIMER] repeatedly to select play timer.

→ CLOCK → PLAY → Original display

- ② "ON TIME" is displayed. Within 5 seconds, press [◀, ∨] or [▶, ^] to set the starting time.

AM 7:30

- ③ Press [CLOCK/TIMER] to confirm.

- ④ "OFF TIME" is displayed. Repeat steps 2 and 3 to set the finishing time.

AM 8:00

To activate the timer

- ⑤ Press [PLAY] to turn on the timer.
- ⑥ Press [⏻] to turn off the unit.



To	Action
Change the settings	Repeat steps 1 to 4 and 6.
Change the source or volume	<ol style="list-style-type: none"> ① Press [PLAY] to clear PLAY indicator from the display. ② Make changes to the source or volume. ③ Perform steps 5 and 6.
Check the settings (when the unit is on or in standby mode)	Press [CLOCK/TIMER] repeatedly to select PLAY.
Cancel	Press [PLAY] to clear the timer indicator from the display.

Note

- The timer will start at the preset time, with the volume increasing gradually to the preset level.
- The timer comes on at the set time every day if the timer is on.
- The unit must be in the standby mode for the timer to function.
- If you turn the unit off and on again while the timer is functioning, the finish time setting will not be activated.
- When MUSIC PORT or iPod is selected as the source when the timer comes on, the system turns on and engages MUSIC PORT or iPod as the source. If you wish to playback from the portable audio equipment, activate the equipment's play mode and increase the volume. (See the portable audio equipment's instruction manual.)

Sound adjustment

Sound quality

PRESET EQ

You can choose one of four types of sound quality.

Press [PRESET EQ] to select the sound quality.

- Each time you press the button:

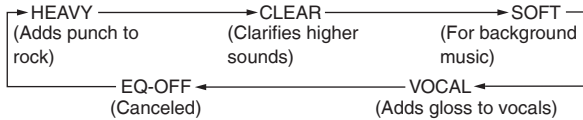

Live Virtualizer

You can create a three-dimensional sound field when listening to stereo sound.

Press [SURROUND] to turn the Live Virtualizer on/off.

Note

The actual effect depends on the source played.

Enhancing the bass

D.BASS

Enables you to enjoy the powerful bass effect.

Press [D.BASS] to turn the D.BASS function on/off.

Note

The actual effect depends on the disc.

Re-master - Enjoying more natural sound

REMASTER

MP3

Digital remaster is effective on CD (MP3)

Analog remaster is effective on iPod and Music Port

This feature reproduces the frequencies lost during recording to give you a sound closer to the original.

Press [REMASTER] during play to select "RE-MASTER ON".

- Each time you press the button:

RE-MASTER ON ↔ RE-MASTER OFF

Specifications

■ AMPLIFIER SECTION

FTC OUTPUT POWER both channel

driven simultaneously

10 % total harmonic distortion (THD)

1 kHz 2.8 W per channel (6 Ω)

RMS OUTPUT POWER both channel

driven simultaneously

10 % total harmonic distortion (THD)

1 kHz 3 W per channel (6 Ω)

Input Music Port

Sensitivity 100 mV, 15 kΩ

Terminal Stereo, 3.5 mm (1/8") jack

Output Headphone

Terminal Stereo, 3.5 mm (1/8") jack
(16 Ω to 32 Ω)

■ TUNER SECTION

Frequency range

FM 87.9 MHz to 107.9 MHz (200 kHz)
87.5 MHz to 108.0 MHz (100 kHz)

AM 520 kHz to 1710 kHz (10 kHz)

■ CD SECTION

Disc played [8 cm (3") or 12 cm (5")]

(1) CD-Audio (CD-DA)

(2) CD-R/RW (CD-DA, MP3)

(3) MP3

Sampling frequency

CD 44.1 kHz

MP3 32 kHz, 44.1 kHz, 48 kHz

Bit rate

MP3 32 kbps to 384 kbps

Decoding 16/20/24 bit linear

Pick up

Wavelength 785 nm

Laser power CLASS 1

Audio output (Disc)

Number of channels 2 channel

Audio performance

Frequency response (CD-Audio)

20 Hz to 20 kHz

Wow and flutter Below measurement limit

Digital filter 8

D/A converter MASH (1 bit DAC)

■ SPEAKER SECTION

Type 1 way, 1 speaker system (Bass reflex)

Speaker unit(s)

Full range 7 cm (2 3/4") cone type

Impedance 6 Ω

Input power (IEC) 3 W (Max)

Dimensions (W x H x D)

120 mm x 202.8 mm x 133.5 mm

(4 3/4" x 7 15/16" x 5 1/4")

■ GENERAL

Power supply

AC 120 V, 60 Hz

Power consumption

30 W

Dimensions (W x H x D)

252.5 mm x 202.8 mm x 133.5 mm

(9 15/16" x 7 15/16" x 5 1/4")

Mass

With speakers Approx. 3.2 kg (7.1 lbs)

Without speakers Approx. 1.9 kg (4.2 lbs)

Operating temperature range

0 °C to +40 °C (+32 °F to +104 °F)

Operating humidity range

35 % to 80 % RH (no condensation)

Power consumption in standby mode:

2.6 W (approx.)

Notes:

- Specifications are subject to change without notice.
- Total harmonic distortion is measured by the digital spectrum analyzer.

Product Service

- 1. Damage requiring service**—The unit should be serviced by qualified service personnel if:
 - (a) The AC power supply cord or AC adaptor has been damaged; or
 - (b) Objects or liquids have gotten into the unit; or
 - (c) The unit has been exposed to rain; or
 - (d) The unit does not operate normally or exhibits a marked change in performance; or
 - (e) The unit has been dropped or the cabinet damaged.
- 2. Servicing**—Do not attempt to service the unit beyond that described in these operating instructions. Refer all other servicing to authorized servicing personnel.
- 3. Replacement parts**—When parts need replacing ensure the servicer uses parts specified by the manufacturer or parts that have the same characteristics as the original parts. Unauthorized substitutes may result in fire, electric shock, or other hazards.
- 4. Safety check**—After repairs or service, ask the servicer to perform safety checks to confirm that the unit is in proper working condition.

The servicer will require all components to service your system. Therefore, should service ever be necessary, be sure to bring the entire system.

Product information

For product information or assistance with product operation:

In the U.S.A., refer to "Customer Services Directory" on page 11.

In Canada, contact the Panasonic Canada Inc. Customer Care Centre at 1-800-561-5505, or visit the website (www.panasonic.ca), or an authorized Servicentre closest to you.

The model number and serial number of this product can be found on either the back or the bottom of the unit.

Please note them in the space provided below and keep for future reference.

MODEL NUMBER _____

SERIAL NUMBER _____

User memo:

DATE OF PURCHASE _____

DEALER NAME _____

DEALER ADDRESS _____

TELEPHONE NUMBER _____

Troubleshooting guide

Before requesting service, make the following checks. If you are in doubt about any of the check points, or if the solutions indicated in the chart do not solve the problem, refer to "Customer Services Directory" on page 11 if you reside in the U.S.A, or refer to "Product information" on page 9 if you reside in Canada.

No play.	<ul style="list-style-type: none"> The disc isn't correctly set. The disc is scratched or dirty. (Tracks skipped.) There is moisture on the lens. Wait for about an hour and then try again.
MP3 cannot be read.	<ul style="list-style-type: none"> You may not be able to play MP3 if you have copied a multi-session disc that has no data between sessions. When creating a multi session disc, it is necessary to close the session. The amount of data on the disc is too small. Set the amount of data to greater than approximately 5 MB.
Sound is unfixed, reversed or comes from one speaker only.	<ul style="list-style-type: none"> Check the speaker connections. (⇒ page 4)
No sound or there is a lot of noise.	<ul style="list-style-type: none"> Noise may occur when playing MP3 if recording quality is poor. Keep this unit away from mobile telephones if the interference is apparent. Turn the volume up. Switch the unit off, determine and correct the cause, then switch the unit on. Causes include shorting of the positive and negative speaker wires, straining of the speakers through excessive volume or power, and using the unit in a hot environment.
Humming heard during play.	<ul style="list-style-type: none"> An AC power supply cord or fluorescent light is near the cords. Keep other appliances and cords away from this unit's cables.
A beat sound or noise is heard while receiving a radio broadcast.	<ul style="list-style-type: none"> Switch the TV or other audio player off or separate it from the unit. Switch off the portable audio player connected to "MUSIC PORT".
A low hum or noise is heard during AM broadcasts.	<ul style="list-style-type: none"> Keep the antenna away from other cables and cords. Keep the AM antenna away from the unit.
The picture on the television near the set disappears or stripes appear on the screen.	<ul style="list-style-type: none"> The location and orientation of the antenna are incorrect. The television antenna wire is too close to the unit. Separate the antenna wire of the television from the unit.
Remote control doesn't work.	<ul style="list-style-type: none"> Check that the batteries are inserted correctly. (⇒ page 3) Replace the batteries if they are worn.

Display

--:--	<ul style="list-style-type: none"> You plugged the AC power supply cord in for the first time and there was a power failure recently. Set the time. (⇒ page 8)
PGM FULL	<ul style="list-style-type: none"> The number of programmed tracks is limited to 24. No further tracks can be programmed.
NO PLAY	<ul style="list-style-type: none"> A CD-ROM disc that is not CD-DA or MP3 format is inserted. It cannot be played.
ERROR	<ul style="list-style-type: none"> Incorrect operation performed. Read the instructions and try again.
F76	<ul style="list-style-type: none"> There is a power supply problem. Consult the dealer.

iPod

iPod does not turn on.	<ul style="list-style-type: none"> Verify that the iPod battery is not depleted before connecting it to the unit. Before inserting your iPod into the dock, turn off both the unit and iPod. Power on the unit and select the appropriate source. Make sure PC is not connected to the main unit and activate PC Sync.
No sound is coming from the speakers.	<ul style="list-style-type: none"> The iPod is not correctly inserted into the dock. Turn off the iPod, remove it from the dock connector. Reinsert it and turn it on again. Make sure that iPod is actually playing something. Adjust the volume.
Music is distorted or the sound level is too low.	<ul style="list-style-type: none"> Make sure the equalizer function of your iPod is turned off.
Cannot control the iPod from the CD Stereo System.	<ul style="list-style-type: none"> Make sure the iPod is inserted properly into the dock. Check the iPod connection and make sure that iPod is selected as the source of music. (⇒ page 7)
iPod does not charge.	<ul style="list-style-type: none"> Check all connections. (⇒ page 4)
Unable to use PC Sync.	<ul style="list-style-type: none"> Turn the unit on. Check PC and iPod connections. (⇒ page 7)

Maintenance

■ If the surfaces are dirty

To clean this unit, wipe with a soft, dry cloth.

- Never use alcohol, paint thinner or benzine to clean this unit.
- Before using chemically treated cloth, read the instructions that came with the cloth carefully.

■ Care of the CD lens

- Clean the lens regularly to prevent malfunctions. Use a blower to remove dust and a cotton swab if it is extremely dirty. Recommended product: Lens cleaner kit (part no. SZZP1038C).
- Do not use the lens cleaner of the CD type.

Limited Warranty (ONLY FOR U.S.A.)

Panasonic Consumer Electronics Company,
Division of Panasonic Corporation of North America
One Panasonic Way Secaucus, New Jersey 07094

Panasonic Puerto Rico, Inc.
Ave. 65 de Infantería, Km. 9.5
San Gabriel Industrial Park, Carolina, Puerto Rico 00985

Panasonic Audio Products Limited Warranty

Limited Warranty Coverage

If your product does not work properly because of a defect in materials or workmanship, Panasonic Consumer Electronics Company or Panasonic Puerto Rico, Inc. (collectively referred to as "the warrantor") will, for the length of the period indicated on the chart below, which starts with the date of original purchase ("warranty period"), at its option either (a) repair your product with new or refurbished parts, or (b) replace it with a new or a refurbished product. The decision to repair or replace will be made by the warrantor.

Product or Part Name	Parts	Labor
Audio Products (except items listed below)	One (1) year	One (1) year
USB Reader-Writer, Personal Computer Card Adapters (in exchange for defective item)	One (1) year	Not Applicable
Accessories: Headphones, Cartridges, Microphones, Adapters	Ninety (90) days	Ninety (90) days
Rechargeable Batteries, DVD-R/-RAM Discs (in exchange for defective item)	Ten (10) days	Not Applicable
SD Memory Cards, Rechargeable Battery Packs (in exchange for defective item)	Ninety (90) days	Not Applicable

During the "Labor" warranty period there will be no charge for labor. During the "Parts" warranty period, there will be no charge for parts. You must carry-in or mail-in your product during the warranty period. If non-rechargeable batteries are included, they are not warranted. This warranty only applies to products purchased and serviced in the United States or Puerto Rico. This warranty is extended only to the original purchaser of a new product which was not sold "as is". A purchase receipt or other proof of the original purchase date is required for warranty service.

Carry-In or Mail-In Service

For Carry-In or Mail-In Service in the United States call 1-800-211-PANA (1-800-211-7262) or visit Panasonic web site: <http://www.panasonic.com> For assistance in Puerto Rico call Panasonic Puerto Rico, Inc. (787)-750-4300 or fax (787)-768-2910.

Limited Warranty Limits And Exclusions

This warranty ONLY COVERS failures due to defects in materials or workmanship, and DOES NOT COVER normal wear and tear or cosmetic damage. The warranty ALSO DOES NOT COVER damages which occurred in shipment, or failures which are caused by products not supplied by the warrantor, or failures which result from accidents, misuse, abuse, neglect, mishandling, misapplication, alteration, faulty installation, set-up adjustments, misadjustment of consumer controls, improper maintenance, power line surge, lightning damage, modification, or commercial use (such as in a hotel, office, restaurant, or other business), rental use of the product, service by anyone other than a Factory Servicenter or other Authorized Servicer, or damage that is attributable to acts of God.

THERE ARE NO EXPRESS WARRANTIES EXCEPT AS LISTED UNDER "LIMITED WARRANTY COVERAGE". THE WARRANTOR IS NOT LIABLE FOR INCIDENTAL OR CONSEQUENTIAL DAMAGES RESULTING FROM THE USE OF THIS PRODUCT, OR ARISING OUT OF ANY BREACH OF THIS WARRANTY. (As examples, this excludes damages for lost time, travel to and from the servicer, loss of media or images, data or other memory content. The items listed are not exclusive, but are for illustration only.) **ALL EXPRESS AND IMPLIED WARRANTIES, INCLUDING THE WARRANTY OF MERCHANTABILITY, ARE LIMITED TO THE PERIOD OF THE LIMITED WARRANTY.**

Some states do not allow the exclusion or limitation of incidental or consequential damages, or limitations on how long an implied warranty lasts, so the exclusions may not apply to you. This warranty gives you specific legal rights and you may also have other rights which vary from state to state. If a problem with this product develops during or after the warranty period, you may contact your dealer or Servicenter. If the problem is not handled to your satisfaction, then write to the warrantor's Consumer Affairs Department at the addresses listed for the warrantor.

PARTS AND SERVICE WHICH ARE NOT COVERED BY THIS LIMITED WARRANTY ARE YOUR RESPONSIBILITY.

Customer Services Directory

Obtain Product Information and Operating Assistance; locate your nearest Dealer or Servicenter; purchase Parts and Accessories; or make Customer Service and Literature requests by visiting our Web Site at:

<http://www.panasonic.com/consumersupport>

or, contact us via the web at: <http://www.panasonic.com/contactinfo>

You may also contact us directly at: 1-800-211-PANA (7262), Monday-Friday 9 am-9 pm; Saturday-Sunday 10 am-7 pm, EST.

For hearing or speech impaired TTY users, TTY: 1-877-833-8855

Accessory Purchases

Purchase Parts, Accessories and Instruction Books online for all Panasonic Products by visiting our Web Site at:

<http://www.pstc.panasonic.com>

or, send your request by E-mail to: npcparts@us.panasonic.com

You may also contact us directly at: 1-800-332-5368 (Phone) 1-800-237-9080 (Fax Only)

(Monday - Friday 9 am to 9 pm, EST.) Panasonic Service and Technology Company

20421 84th Avenue South, Kent, WA 98032 (We Accept Visa, MasterCard, Discover Card, American Express, and Personal Checks)

For hearing or speech impaired TTY users, TTY: 1-866-605-1277

Service in Puerto Rico

Panasonic Puerto Rico, Inc.
Ave. 65 de Infantería, Km. 9.5, San Gabriel Industrial Park, Carolina, Puerto Rico 00985
Phone (787)750-4300, Fax (787)768-2910

Limited Warranty (ONLY FOR CANADA)

Panasonic Canada Inc.
5770 Ambler Drive, Mississauga, Ontario L4W 2T3
PANASONIC PRODUCT – LIMITED WARRANTY
EXCHANGE PROGRAM

Panasonic Canada Inc. warrants this product to be free from defects in material and workmanship and agrees to replace the product for a period as stated below from the date of original purchase.

Panasonic Portable / Clock Radio (without Tape, CD, MD)	One (1) year
Panasonic Audio Product	One (1) year
Panasonic DVD Product	One (1) year
Accessories including rechargeable batteries	Ninety (90) days

LIMITATIONS AND EXCLUSIONS

This warranty does not apply to products purchased outside Canada or to any product which has been improperly installed, subjected to usage for which the product was not designed, misused or abused, damaged during shipping, or which has been altered or repaired in any way that affects the reliability or detracts from the performance, nor does it cover any product which is used commercially. Dry cell batteries are also excluded from coverage under this warranty.

This warranty is extended to the original end user purchaser only. A purchase receipt or other proof of date of original purchase is required before warranty service is performed.

THIS EXPRESS, LIMITED WARRANTY IS IN LIEU OF ALL OTHER WARRANTIES, EXPRESS OR IMPLIED, INCLUDING ANY IMPLIED WARRANTIES OF MERCHANTABILITY AND FITNESS FOR A PARTICULAR PURPOSE.

IN NO EVENT WILL PANASONIC CANADA INC. BE LIABLE FOR ANY SPECIAL, INDIRECT OR CONSEQUENTIAL DAMAGES.

In certain instances, some jurisdictions do not allow the exclusion or limitation of incidental or consequential damages, or the exclusion of implied warranties, so the above limitations and exclusions may not be applicable.

CONTACT INFORMATION

For product information and operation assistance, please contact:

Our Customer Care Centre:	Telephone #:	(905) 624-5505
	1-800 #:	1-800-561-5505
	Fax #:	(905) 238-2360
	Email link:	"customer support" on www.panasonic.ca

For defective product exchange within the warranty period, please contact the original dealer or our Customer Care Centre.

Listening caution



Selecting fine audio equipment such as the unit you've just purchased is only the start of your musical enjoyment. Now it's time to consider how you can maximize the fun and excitement your equipment offers. This manufacturer and the Electronic Industries Association's Consumer Electronics Group want you to get the most out of your equipment by playing it at a safe level. One that lets the sound come through loud and clear without annoying blaring or distortion-and, most importantly, without affecting your sensitive hearing.

We recommend that you avoid prolonged exposure to excessive noise. Sound can be deceiving. Over time your hearing "comfort level" adapts to higher volumes of sound. So what sounds "normal" can actually be loud and harmful to your hearing.

Guard against this by setting your equipment at a safe level BEFORE your hearing adapts.

To establish a safe level:

- Start your volume control at a low setting.
- Slowly increase the sound until you can hear it comfortably and clearly, and without distortion.

Once you have established a comfortable sound level:

- Set the dial and leave it there.

Taking a minute to do this now will help to prevent hearing damage or loss in the future. After all, we want you listening for a lifetime.

THE FOLLOWING APPLIES ONLY IN THE U.S.A.

FCC Note:

This equipment has been tested and found to comply with the limits for a Class B digital device, pursuant to Part 15 of the FCC Rules.

These limits are designed to provide reasonable protection against harmful interference in a residential installation. This equipment generates, uses and can radiate radio frequency energy and, if not installed and used in accordance with the instructions, may cause harmful interference to radio communications. However, there is no guarantee that interference will not occur in a particular installation. If this equipment does cause harmful interference to radio or television reception, which can be determined by turning the equipment off and on, the user is encouraged to try to correct the interference by one or more of the following measures:

- Reorient or relocate the receiving antenna.
- Increase the separation between the equipment and receiver.
- Connect the equipment into an outlet on a circuit different from that to which the receiver is connected.
- Consult the dealer or an experienced radio/TV technician for help.

Any unauthorized changes or modifications to this equipment would void the user's authority to operate this device.

This device complies with Part 15 of the FCC Rules. Operation is subject to the following two conditions: (1) This device may not cause harmful interference, and (2) this device must accept any interference received, including interference that may cause undesired operation.

Declaration of Conformity

Trade Name: Panasonic

Model No.: SC-EN38

Responsible Party:

Panasonic Corporation of North America

One Panasonic Way

Secaucus, NJ 07094

Support contact:

Panasonic Consumer Electronics Company

Telephone No.: 1-800-211-7262

Panasonic Consumer Electronics Company, Division of Panasonic Corporation of North America

One Panasonic Way Secaucus,
New Jersey 07094

<http://www.panasonic.com>

©2008 Matsushita Electric Industrial Co., Ltd.

Printed in Malaysia

Panasonic Puerto Rico, Inc.

Ave. 65 de Infantería, Km. 9.5
San Gabriel Industrial Park, Carolina,
Puerto Rico 00985

Panasonic Canada, Inc.

5770 Ambler Drive
Mississauga, Ontario
L4W 2T3

www.panasonic.ca



RQTV0288-2P

H1207FL2038