

Quick Start Guide FE-220/X-785

Start Here

For more information, please refer to the Basic & Advanced Manuals or visit: www.olympusamerica.com/support

OLYMPUS IMAGING AMERICA INC.

© 2007 OLYMPUS IMAGING CORP.
Printed in China

VH933601

1 Gather these items (box contents)

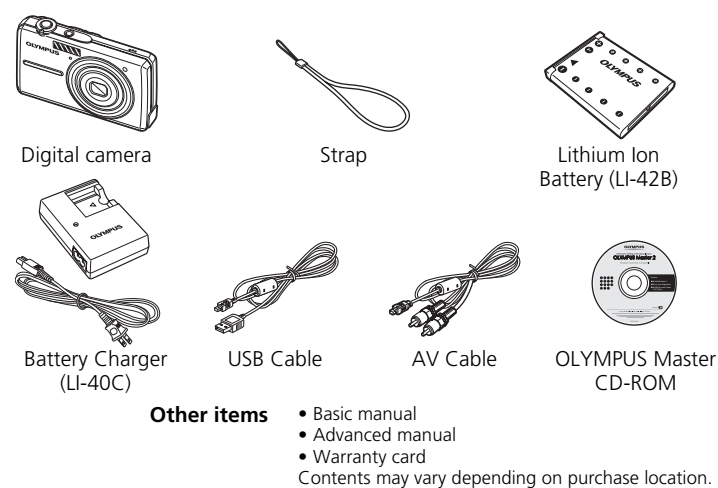

Attach the strap

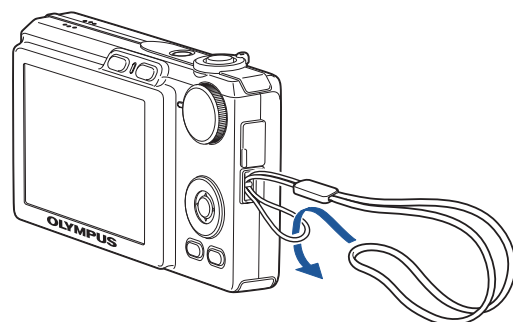

- Pull the strap tight so that it does not come loose.

2 Prepare the battery

a. Charge the battery

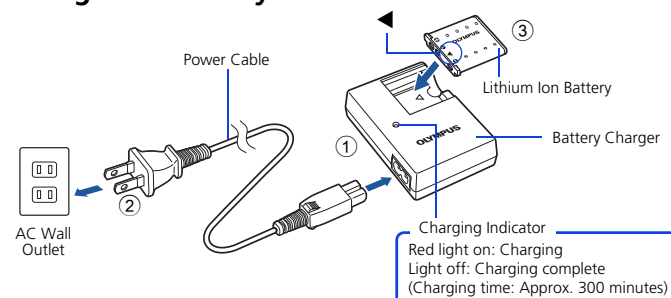

- Battery comes partially charged.

b. Insert the battery in the camera

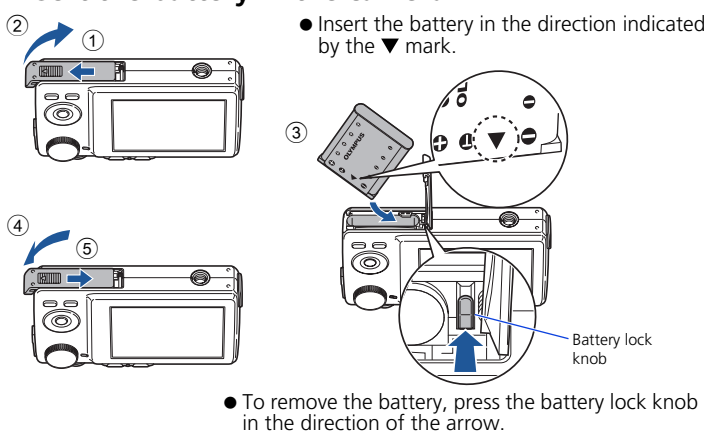

- This camera does not require an optional xD-Picture Card™ (hereinafter referred to as "the card") to take pictures. For details on inserting an optional Card, please refer to Advanced Manual.

3 Turn the camera on

This section explains how to turn on the camera in shooting mode.

a. Set the mode dial to **AUTO**

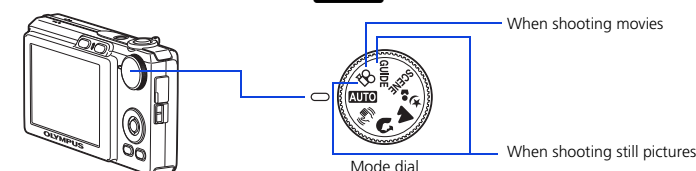

Still picture shooting modes

AUTO	The camera determines the optimum settings and shoots the picture.
	This function reduces the blur caused by a moving subject or camera movement when taking pictures.
	Suitable for taking pictures of people.
	Suitable for taking pictures of landscapes.
	Suitable for taking pictures of people at night.
SCENE	You can select a scene mode from among 10 set for various shooting conditions.
GUIDE	This function allows you to take the best picture by following the shooting guide displayed on the screen.

b. Press the **POWER** button

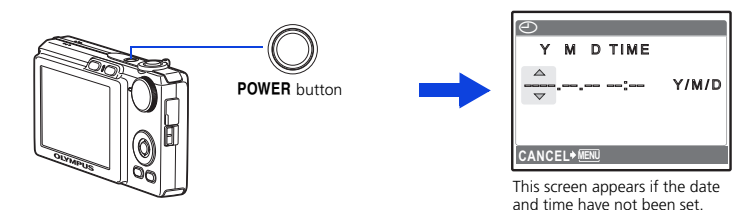

- To turn off the camera, press the **POWER** button again.

Hint

The directions of the arrow pad (▲▼◀▶) are indicated with ▲▼◀▶ in this manual.

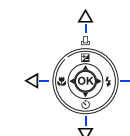

4 Set date and time

About the date and time setting screen

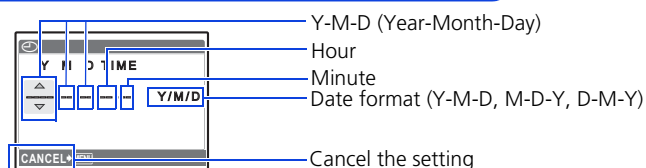

- a. Press the button and button to select [Y].
- The first two digits of the year are fixed.

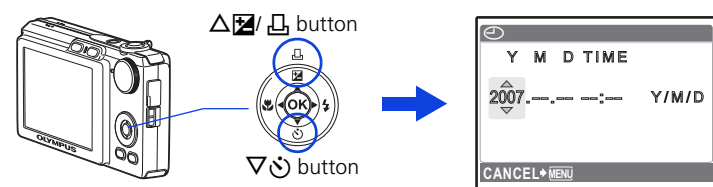

- b. Press the button.

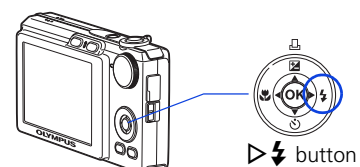

- c. Press the button and the button to select [M].

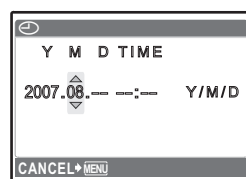

- d. Press the button.

- e. Press the button and the button to select [D].

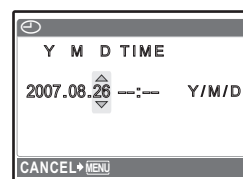

- f. Press the button.
- g. Press the button and the button to select "hour" and "minute".

- The time is displayed in the 24-hour format.

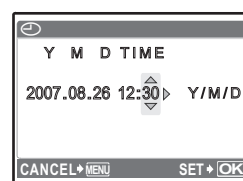

- h. Press the button.
- i. Press the button and the button to select [Y/M/D].

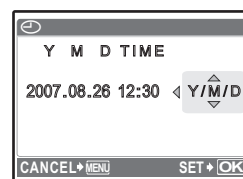

- j. After all items have been set, press the button.

- For a more accurate setting, you can press the button when the time signal hits 00 seconds.

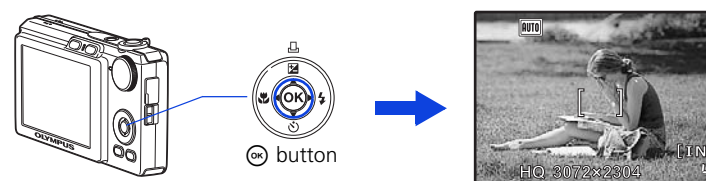

5 Take a picture

a. Hold the camera

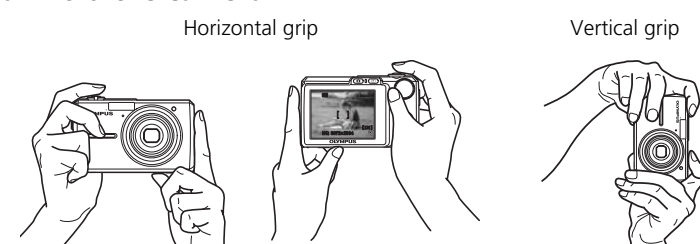

b. Focus

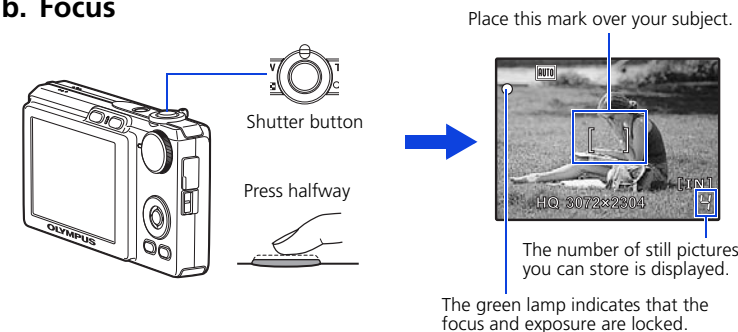

c. Shoot

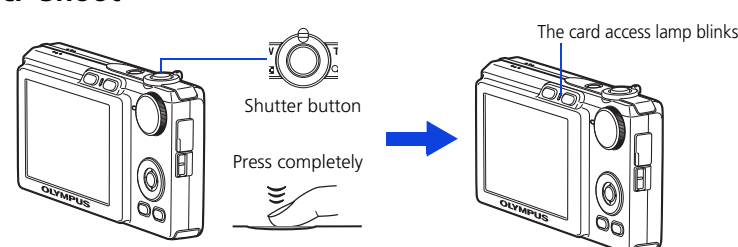

6 Review your pictures

a. Press the button.

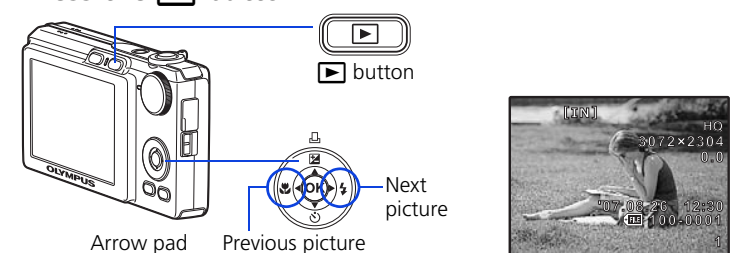

Erase pictures

- a. Press the button and the button, to display the picture you want to erase.
- b. Press the button.

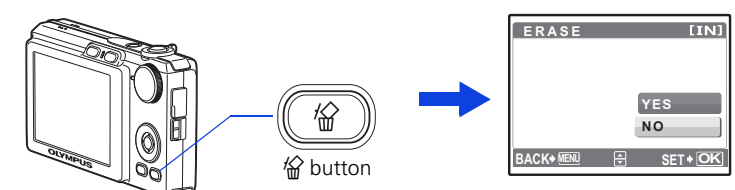

- c. Press the button to select [YES] and press the button.

