

# Quick Start Guide

## FE-230/X-790 FE-240/X-795

# Start Here

For more information, please refer to the Basic & Advanced Manuals or visit: [www.olympusamerica.com/support](http://www.olympusamerica.com/support)

OLYMPUS IMAGING AMERICA INC.

© 2007 OLYMPUS IMAGING CORP.  
Printed in Japan

1AG6P1P3339--

VK557201

## 1 Gather these items (box contents)

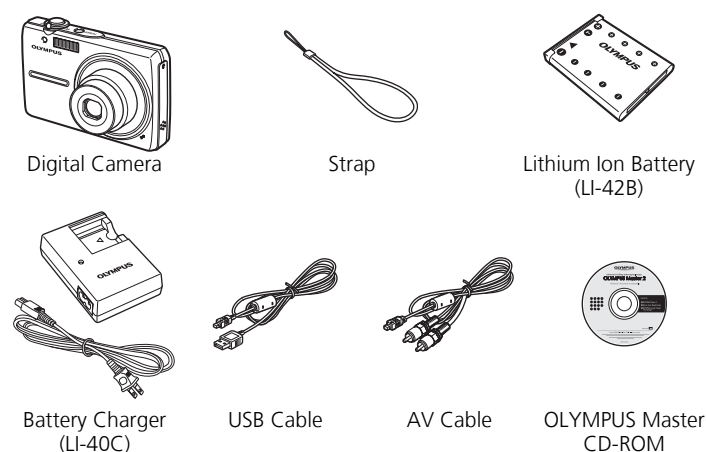

Items not shown: Advanced Manual (CD-ROM), Basic Manual, and the Warranty Card. Contents may vary depending on purchase location.

### Attach the strap

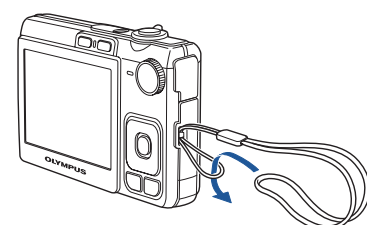

- Pull the strap tight so that it does not come loose.

## 2 Prepare the battery

### a. Charge the battery.

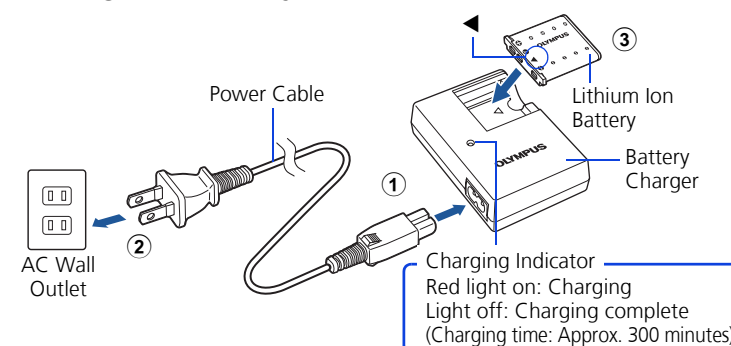

- Battery comes partially charged.

### b. Insert the battery into the camera.

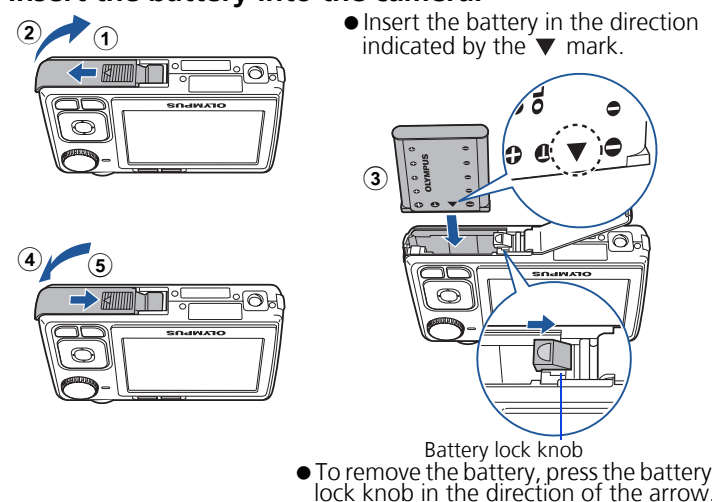

## 3 Turn the camera on

This explains how to turn on the camera in shooting mode.

### a. Set the mode dial to **AUTO**.

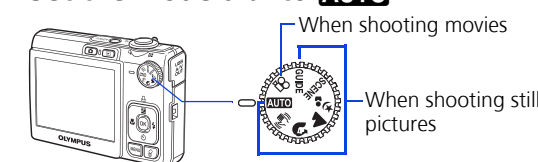

### Still picture shooting modes

|              |   |
|--------------|---|
| <b>AUTO</b>  | For normal shooting.  |
|              | This function reduces the blur incurred by a moving subject, or camera shake when taking pictures.                                    |
|              | Suitable for taking pictures of people.   |
|              | Suitable for taking pictures of a landscape.  |
|              | Suitable for taking pictures of people at night.  |
| <b>SCENE</b> | Select from 10 available scene modes (FE-240/X-795) or 13 available scene modes (FE-230/X-790), according to the shooting conditions. |
| <b>GUIDE</b> | Use the shooting guide displayed on the screen to shoot pictures according to the situation.  |

### b. Press the **POWER** button.

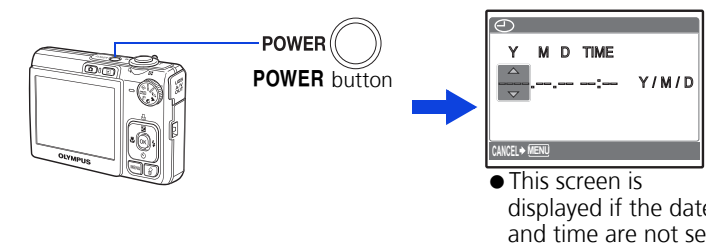

- To turn off the camera, press the **POWER** button once again.

### Hint

The directions of the arrow pad is indicated with in the supplied instruction manual.

## 4 Set the date and time

### About the date and time setting screen

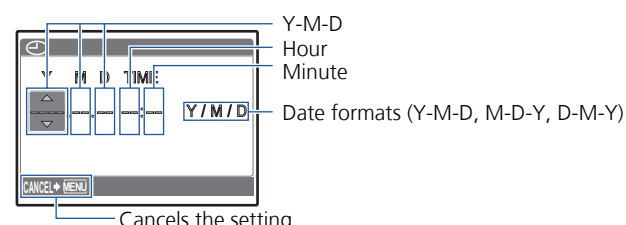

### a. Press the and buttons to select [Y].

- The first two digits of the year are fixed.

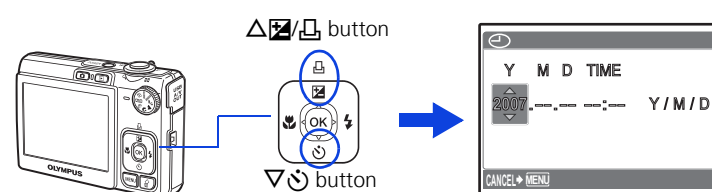

### b. Press the button.

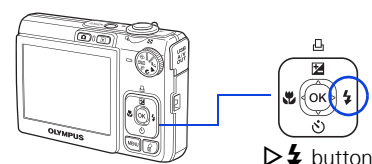

### c. Press the and buttons to select [M].

### d. Press the button.

### e. Press the and buttons to select [D].

### f. Press the button.

### g. Press the and buttons to select the hours and minutes.

- The time is displayed in the 24-hour format.

### h. Press the button.

### i. Press the and buttons to select [Y/M/D].

### j. After all settings have been set, press .

- For a more accurate setting, press when the time signal hits 00 seconds.

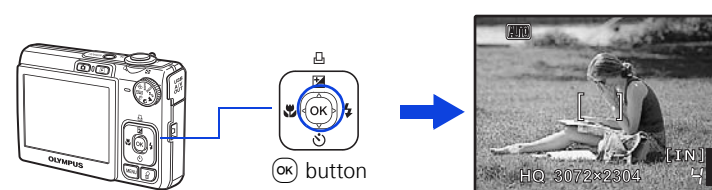

## 5 Take a picture

### a. Hold the camera.



### b. Focus.

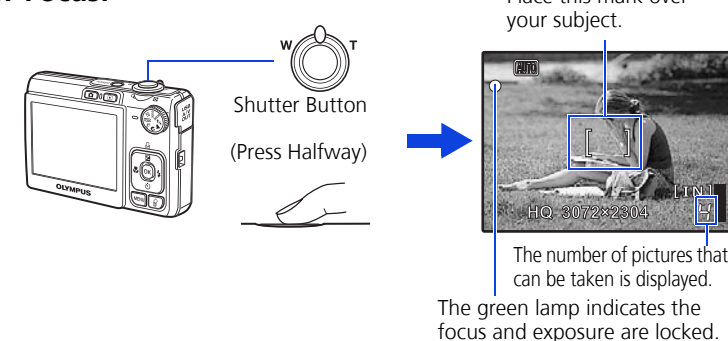

### c. Shoot.

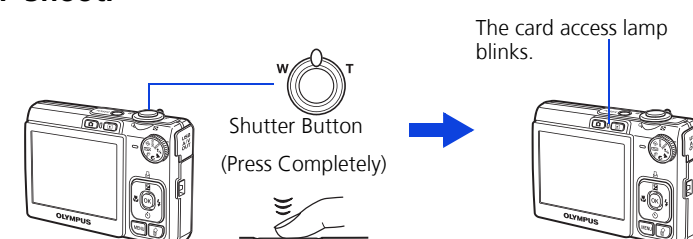

## 6 Review your pictures

### a. Press the button.

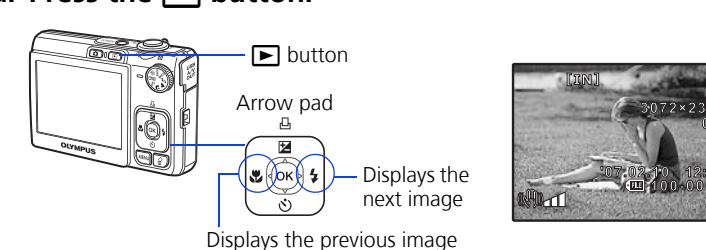

### Erase pictures

### a. Press the and buttons to display the picture you want to erase.

### b. Press the .

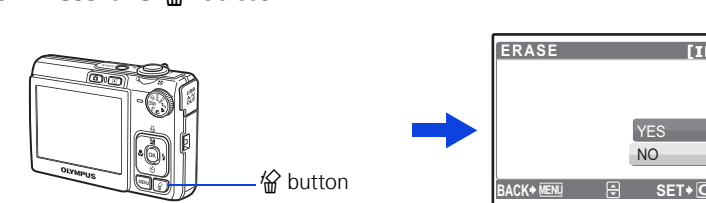

### c. Press the button, select [YES], and press .

