

## Instruction Manual

### HI 98509-1 Thermometer

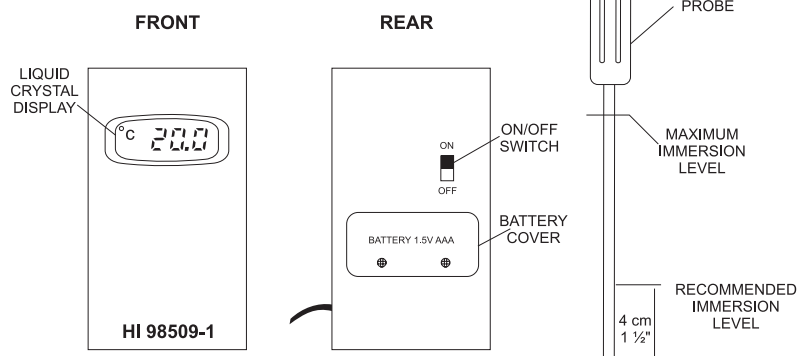

#### **SPECIFICATIONS**

**Range** -50.0 to 150.0°C

**Resolution** 0.1°C

**Accuracy** ±1°C  
(@20°C/68°F)

**Typical EMC Deviation**  
±1°C

**Probe** Stainless steel,  
160 x Ø 3mm  
(6.3 x Ø 0.12")  
with 1 m (3.3') cable

**Environment** 0 to 50°C (32 to 122°F);  
95% RH max.

**Battery Type** 1x1.5V AAA alkaline

**Battery Life** approx. 3 years  
of continuous use

**Dimensions** 106 x 58 x 19 mm  
(4.2 x 2.2 x 0.7")

**Weight** 80 g (2.8 oz.)

 **HANNA**  
instruments  
[www.hannainst.com](http://www.hannainst.com)

### **OPERATION**

- Turn the meter ON by sliding the switch on the back side.
- Dip the probe into the sample to be measured. An immersion level of 4 cm (1 ½") is recommended.
- Do NOT immerse the probe handle.
- Do NOT wrench the probe or put heavy objects on the cable. If the cable is damaged, the meter needs to be replaced.
- Wait for a few seconds for the display to stabilize and switch the meter OFF when not in use.
- Variations in readings or fading display can indicate a weak battery.



### **BATTERY REPLACEMENT**

When the thermometer can not be switched on or the display fades, remove the two screws, open the battery cover and replace the 1.5V AAA battery, while paying attention to its polarity. Reattach the cover by tightening the two screws.

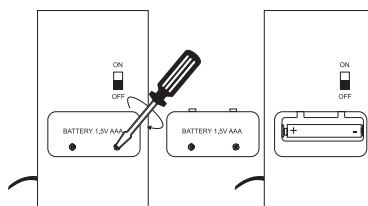

Battery should only be replaced in a safe area using the battery type specified in this instruction sheet.

### **WARRANTY**

This meter is warranted for one year against defects in workmanship and materials when used for its intended purpose and maintained according to instructions.

This warranty is limited to repair or replacement free of charge. Damages due to accident, misuse, tampering or lack of prescribed maintenance are not covered.

If service is required, contact the dealer from whom you purchased the instrument. If under warranty, report the model number, date of purchase, serial number and the nature of the failure. If the repair is not covered by the warranty, you will be notified of the charges incurred.

If the instrument is to be returned to Hanna Instruments, first obtain a Returned Goods Authorization Number from the Customer Service department and then send it with shipment costs prepaid.

When shipping any instrument, make sure it is properly packaged for complete protection.

#### **Recommendations for Users**

Before using this product, make sure that it is entirely suitable for the environment in which it is used. Operation of this instrument in residential areas could cause unacceptable interferences to radio and TV equipment. Any variation introduced by the user to the supplied equipment may degrade the instrument's EMC performance. To avoid electrical shock, do not use these instruments when voltages at the measurement surface exceed 24 VAC or 60 VDC. To avoid damages or burns, do not perform any measurement in microwave ovens.