

morphyrichards

Café Rico 10 cup filter coffee maker

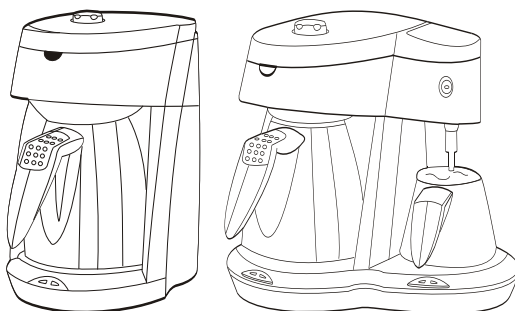

Please read and keep these instructions



getting the best from
your new coffee maker...

2year
guarantee
2 años de garantía / 2 ans de garantie

www.morphyrichards.co.uk
www.morphyrichardsindia.com



Important safety instructions

The use of any electrical appliance requires the following common sense safety rules.

Primarily there is danger of injury or death and secondly the danger of damage to the appliance. These are indicated in the text by the following two conventions:

WARNING: Danger to the person!

IMPORTANT: Damage to the appliance! In addition we offer the following safety advice.

Location

- Ensure the coffee maker is used on a firm, flat surface.
- Do not use the coffee maker outdoors or in a bathroom.
- Do not place the coffee maker on a highly polished wooden surface as damage may occur to the surface.
- Do not place the coffee maker on or near hot surfaces such as a hot plate or radiant rings or near a naked flame.
- **IMPORTANT:** Do not place the coffee maker onto a metal tray or metal surface whilst in use.

Personal safety

- **WARNING: Do not touch hot surfaces. Always use handles or knobs.**
- **WARNING: Do not operate any appliance with a damaged cord or plug or after the appliance malfunctions or has been damaged in any manner.**
- Ensure the lid of the jug is securely in place before pouring.

- Take care to pour hot coffee slowly and carefully without tipping the jug too fast.
- Do not touch metal parts until the appliance has cooled.
- Milk should not be reheated, only heat it when required.

Children

- Children do not understand the dangers associated with operating electrical appliances. Never allow children to use this appliance.

Treating scalds

- Run cold water over the affected area immediately. Do not stop to remove clothing, get medical help quickly.

Product safety

- **WARNING: Do not immerse the coffee maker itself in water and always ensure the electrical connections are kept dry.**
- Never use warm or hot water to fill the water reservoir.
- Do not use jugs in a microwave.
- Do not overfill the water reservoir.
- Do not fill above the capacity of the water level gauge marked on the jug.
- Do not fill milk jug above the MAX mark.
- When heating milk, use the stainless steel jug provided (certain models only).

Other safety considerations

- Disconnect the coffee maker from the mains supply when filling, cleaning or not in use.
- Keep the outside of the coffee maker area clean and dry at all times.
- The use of attachments or tools not recommended or sold by Morphy Richards

may cause fire, electric shock or injury.

- Do not use abrasive cleaners on the outside of the coffee maker, they may scratch the surface. Clean only with a soft damp cloth.
- Do not use the coffee maker for anything other than its intended purpose.
- Do not adjust strength control whilst the appliance is brewing.
- Do not place the jug on the hot plate unless the lid is in position.

Electrical requirements

Check that the voltage on the rating plate of your appliance corresponds with your house electricity supply which must be A.C. (alternating current).

If the socket outlets in your home are not suitable for the plug supplied with this appliance the plug should be removed and the appropriate one fitted.

WARNING : The plug removed from the mains lead, if severed, must be destroyed as a plug with a bared flexible cord is hazardous if engaged into a live socket outlet.

WARNING: This appliance must be earthed.

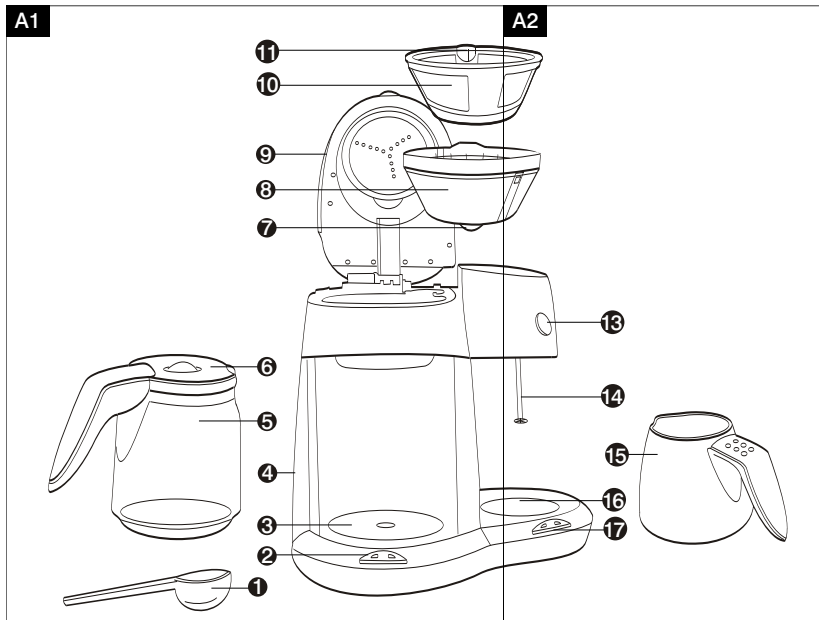

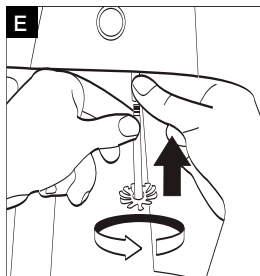
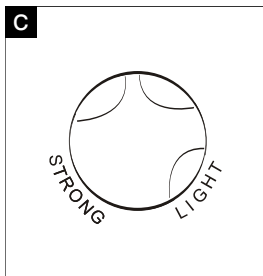
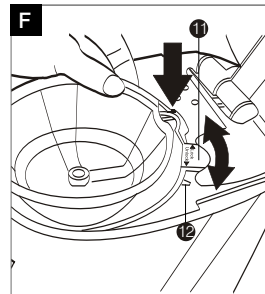
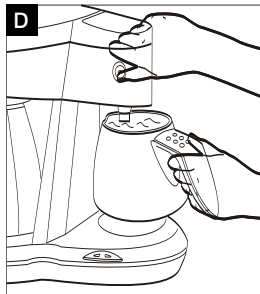
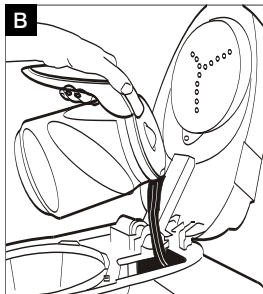

Features

Both models **A1** 47001 and 47002

- ① Measuring spoon
- ② Coffee on/off switch with power on and coffee ready indicator lights
- ③ Coffee jug hot plate
- ④ Water level indicator
- ⑤ Coffee jug with water level indicator
- ⑥ Jug lid
- ⑦ Non-drip valve
- ⑧ Removable filter holder with locking tab
- ⑨ Hinged reservoir lid with strength indicator
- ⑩ Removable permanent mesh filter

⑪ Filter locating tab

⑫ Rib

Model with frother only **A2** 47002

⑬ Milk frother button

⑭ Frother blade

⑮ Milk frother jug

⑯ Milk jug hot plate

⑰ Frother hotplate on/off switch with power on indicator

Before first use

- Remove all the packaging and retain for future reference.
- It is important to run water through your coffee maker in order to rinse the

machine. You can also run water through to warm your coffee machine.

Making coffee

1. Lift up the hinged reservoir lid ④
2. Fill the water reservoir with the required amount of water using the water level indicator ④ as a guide ③. Both the jug ⑤ and the water level indicator are marked in cups. Do not exceed the maximum level on the water gauge.
3. Spoon the required amount of ground filter coffee into the mesh filter ⑩ spreading it evenly. We suggest one level measuring spoon ① for every cup. Ensure the filter is sitting properly in the filter holder ⑨.
4. Close the reservoir lid.
5. Select the strength of coffee required using the strength selector on the reservoir lid ③.
6. Slide the jug into the coffee maker ensuring it sits correctly on the hot plate. ③ The jug lid ⑥ must be in place, otherwise the non-drip valve ⑦ will not open causing the filter to flood.
7. Plug the coffee maker in at the wall socket and switch the coffee on/off switch ② to on. The orange light will glow to show coffee maker is working.
8. Hot water will start to flow through the coffee grounds and into the jug as coffee.
9. When the coffee has been made, the green ready light will glow. Serve as required. The non-drip valve will prevent any remaining coffee dripping onto the hot plate. Ensure that the jug is replaced on the hot plate after serving. While the coffee maker is switched on the hot plate will keep the coffee warm.
10. Switch off the coffee maker when the jug is empty or the coffee is no longer required.

WARNING: The coffee maker and hot plate are hot and remain hot for some time after switching off.

11. Allow the appliance to cool.
 12. Remove the permanent mesh filter and empty the used coffee grounds. Wash the filter immediately and dry thoroughly.
- The mesh will become discoloured after a while due to the staining effect of coffee.
 - It is normal for the green ready light to go out and come back on intermittently due to the thermostat cycling on and off.

Refilling

1. Switch off the coffee maker and allow 3 minutes to cool before refilling with cold water.

Frothing milk *Model 47002 only*

It is advised to start heating your milk ready for frothing when you start making coffee.

1. Fill the stainless steel milk jug ⑮ with the required amount of milk. Do not exceed the maximum level.
2. Place the jug on the hot plate and push the frother hot plate ⑮ on/off switch ⑰ to the 'on' position.
3. Once the coffee has brewed, the milk is ready to froth. Lift the milk jug up to the milk frother blade ⑱. Raise the milk jug ensuring that the frother blade is just under the surface of the milk - this will give the maximum froth. Push and release the milk frother button. Raise the milk jug ensuring that the frother blade is just under the surface of the milk - this will give the maximum froth. Push and release the milk frother button ⑱.

WARNING: Take care as the milk will be hot.

When the milk is frothy, which normally takes around 30 seconds, press the milk frother button once more to stop the frother.



4. Pour the coffee into cups and gently pour or preferably spoon the milk onto the coffee, then sprinkle a little chocolate powder. Turn off the milk frother hot plate.

WARNING: The stainless steel jug and the hotplate will remain hot for sometime after switching off.

There may be some splash back of milk on the underside of the frothing unit. Switch the appliance off then simply wipe this area clean with a damp cloth.

The milk frother blade can be removed for easy cleaning by unscrewing the blade and washing carefully in hot soapy water. It is recommended that you remove the blade immediately after use, as dried milk can be difficult to remove. To replace insert the stem of the milk frother blade into the mounting hole on the appliance and screw into place .

Locating the filter

1. To remove the filter, slide the locking tab  on the filter holder to the unlock position and lift both the holder and mesh filter out to clean. (see cleaning)
2. To refit, place the filter holder into the top of the coffee maker, making sure the tab lines up with the rib  then slide the locking tab to the lock position. Then place the permanent mesh filter inside the filter holder by lining up the locating tab with the groove in the filter holder as shown.

Descaling

It is important to descale as the performance of your coffee maker may be

impaired by limescale and other impurities in the water supply.

If you live in a hard water area, we recommend that your coffee maker is descaled at regular intervals, e.g. every 2-3 months. In areas of moderately hard water you should descale every 6 months. If the water filters through more slowly than usual, it is a sign that descaling is necessary.

We recommend you use proprietary liquid descaler which is especially made for coffee makers and plastic kettles. Follow the instructions on the bottle or sachet, and then operate the coffee maker with just water 3 times before making coffee.

Do not use kettle descaler unless the packet specifically states it is suitable for coffee makers.

- The permanent mesh filter should not be used during descaling.

Cleaning

Unplug the coffee maker and allow to cool.

Do not immerse the coffee maker in liquid.

Rinse the water reservoir occasionally with cold water. Do not use a cloth as any residue or lint may be left behind to clog the coffee maker.

Remove the permanent filter, discard used coffee and wash. Extended soaking helps to remove coffee stains from the mesh.

Wash the jug, jug lid, filter holder, (and stainless steel milk jug and milk frother blade on model 47002) in warm soapy water. Rinse and dry all parts thoroughly and refit.

Wipe all external surfaces including the warming plate with a damp cloth and dry thoroughly.

- Care must be taken to ensure that nondrip valve situated on the bottom of the filter holder is not damaged during cleaning.
- Never use harsh or abrasive cleaners.
- No parts are suitable for cleaning in a dishwasher.

Technical Data

Power Supply	: 230V, 50Hz
Wattage	: 1400W

Morphy Richards products are intended for household use only

Morphy Richards has a policy of continuous improvement in product quality and design. The Company, therefore, reserves the right to change the specification of its models at any time.

Products & parts are indicative only, the actual product may differ.

morphy richards

Morphy Richards Ltd, Mexborough,
South Yorkshire, England, S64 8AJ