

## Your washing machine

**Congratulations** – You have opted for a modern, high-quality domestic appliance manufactured by Bosch. The washing machine is distinguished by its economical energy consumption.

Each appliance which leaves our factory is inspected thoroughly to ensure that it functions properly and is in perfect condition.

### Environmental disposal

Dispose of packaging in an environmentally friendly manner.

This appliance has been identified in accordance with the European Directive 2002/96/EG on Waste Electrical and Electronic Equipment (WEEE).

The Directive specifies the framework for an EU-wide valid return and recycling of waste appliances.

## Contents

	Page
■ Intended use	1
■ Setting programmes	2
■ After washing	4
■ Individual settings	5
■ Important information	6
■ Overview of programmes	7
■ Care	8
■ Information on the display panel	8
■ Maintenance	9
■ What to do if ...	10
■ Safety instructions	11
■ Consumption values	11

### Intended use

- for use in the household only,
- for the washing of machine-washable textiles in a detergent solution,
- to be operated with cold drinking water and commercially available detergents and care products which are suitable for use in washing machines.

- ⚠ Do not leave children unattended near the washing machine!
- Keep pets away from the washing machine!

### Programmes

For detailed overview of programmes see *Page 7*.

Temperature and spin speed can be selected individually.

👕 Cottons	hard-wearing textiles
👕 Cottons Stains Plus	
👕 Cottons Stains	
👕 Sensitive	
👕 Easy-Care	easy-care textiles
👕 Silk	delicate washable textiles
👕 Wool	hand/machine-washable textiles
👕 Drain	the rinsing water if occurs
👕 Spin	washing washed by hand
👕 Gentle Spin	washing washed by hand at reduced spin speed
Rinse/Freshen Up *	with subsequent spin cycle; for hand-washed items, starching or "freshen up" items, see <i>Page 6</i> .
👕 Sports Wash	textiles made of microfibres
→ Super Quick	short programme
👕 Mixed Load	different types of washing
👕 Dark Wash	dark textiles

## Preparation

⚠ Correct installation according to separate installation instructions.

### Checking the machine

- Never switch on a damaged machine!
- Inform your customer service!

### Turn on the tap

### Insert mains plug

- ⚠ With dry hands only!
- Take hold of the plug only!

## Before washing for the first time, wash once without any washing. See page 6

### Sorting and inserting the washing

Follow manufacturer's care information! According to the information on the care labels. According to type; colour; soiling and temperature.

Follow important instructions! See page 6!

### Add detergent and care product

Meter accordingly: Washing amount, soiling, water hardness (ask your water supply company) and manufacturer's instructions. Pour liquid detergent into the appropriate dispenser and place in the drum.

- I Prewash: Detergent, starch
- ☞ Care product: Fabric softener
- II Main wash: Detergent, water softener, bleach, stain remover
- III Dilute viscous fabric softener and fabric conditioner with water. Prevents blockage of the overflow.
- Do not use detergent for programme option **Rinse/Freshen Up** \*/

### Set and adjust programme

For additional functions and option buttons see *individual settings, page 5*.

ⓘ All buttons are sensitive, they only need to be touched gently!

Programme selector for switching the machine on and off and for selecting the programme. Can be rotated in either direction.

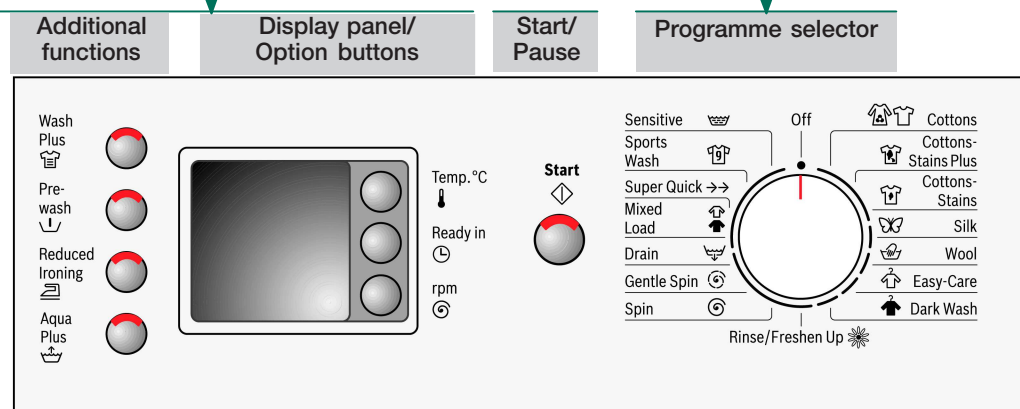

* – 90	Temp °C	Select the temperature (* = cold)
1 – 19h	Ready in	Programme ends in ...
– 1000*	rpm	Select the spin speed (* depending on model) or (without final spin)
Status displays		Programme progress displays: Washing, Rinse, Spin, End

## Wash

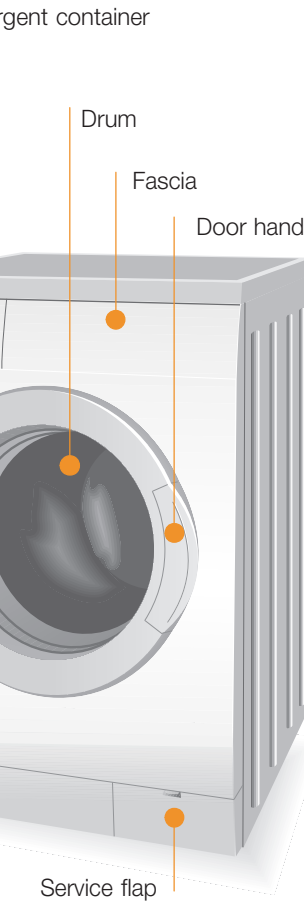

### Removing washing

Possible approx. 2 minutes after the programme ends!

Open washing machine door and remove washing. If (without final spin) active: Set programme selector to **Drain** or select spin speed. Select **Start**. Remove any foreign objects – risk of rusting.

### Turn off the tap

Not required for Aqua-Stop models.

### Switch off

Set programme selector to **Off**.

### End of programme when ...

... **Start** flashes and -0- is indicated on the display panel.

### Change programme ...

If you have mistakenly selected a wrong programme:

- Reselect programme.
- Select **Start**.

### ... or terminate

Programmes with high temperature, first:

- Cool washing: Select **Rinse/Freshen Up**.
- Washing machine door remains locked.
- Select **Off**.
- Select **Spin** or **Drain**.
- Select **Start**.

## Individual settings

### Option buttons

You can change the spin speed and temperature beforehand and while the selected programme is running. Effects dependent on the programme progress.

#### Temp. °C

You can change the indicated washing temperature. The maximum washing temperature which can be selected depends on the set programme.

#### Ready in

The respective programme duration is displayed by selecting the programme. The programme start can be delayed before the programme begins. The **Ready in**-time can be set in hour-steps up to maximum 19h. Keep pressing the **Ready in** button until the required number of hours is indicated (h=hour). Select **Start**.

#### rpm

You can change the indicated spin speed. The maximum spin speed which can be selected depends on the set programme.

### Additional functions

Wash Plus	see also programme overview
Wash Plus	Extension of the washing time for a more intensive washing of highly soiled washing or 7 kg of cottons and coloureds.
Prewash	For heavily soiled, hard-wearing washing, e.g. made of cotton or linen. Prewash at 30 °C.
Reduced Ironing	Special spin sequence with subsequent fluffing. Gentle final spin – residual moisture in the washing increased slightly.
Aqua Plus	Increased water level and additional rinse cycle, extended washing time. For areas with very soft water or for further improvement of the rinsing result.

### Start

For starting or interrupting the programme.

### Signal

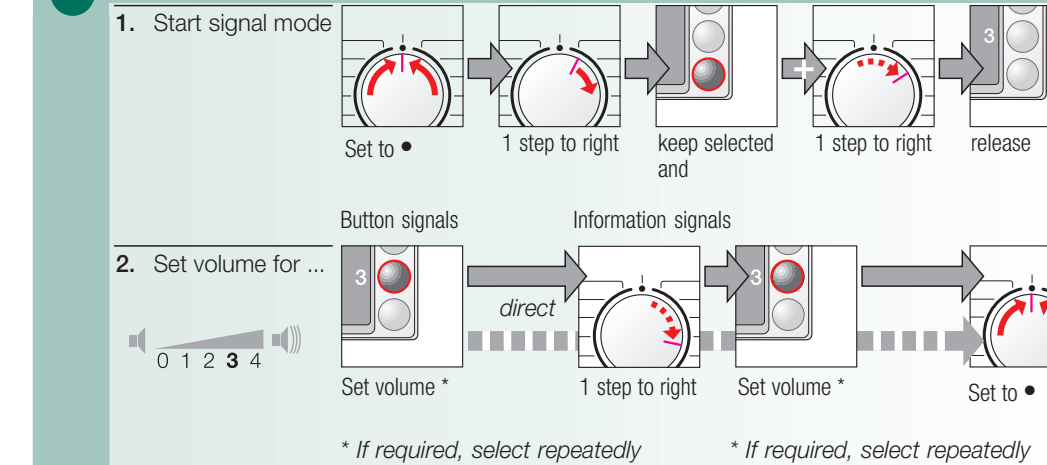

## Important information

### Protecting the washing and the machine

- Empty pockets.
- Remove metal parts (paper clips, etc.).
- Wash delicates in the net/bag (tights, curtains, underwired bras).
- Close zips, button up covers.
- Brush sand out of pockets and collars.
- Remove curtain fittings or include in the net/bag.

### Before washing for the first time

Do not put any washing in the washing machine! Turn on the tap, fill the appliance with approx. 1 litre of water and then pour ½ measuring cup of detergent into dispenser II. Set programme selector to **Easy-Care 60 °C** and select **Start**. At the end of the programme set the programme selector to **Off**.

### Washing with different degrees of soiling

Light	Wash new items separately. Do not prewash.
Heavy	If required, pretreat stains. Select <b>Wash Plus</b> additional function. Load less washing. Prewash.

### Filling weight

Do not exceed maximum load:

- Cottons and coloureds 7 kg
- Easy-Care 3 kg
- Delicates, silk and woollens 2 kg

### Soaking

Load washing of the same colour. Pour soaking agent/detergent into dispenser II according to the manufacturer's instructions. Set programme selector to **Cottons 30 °C** and select **Start**. After approx. 10 minutes select **Start**. After the required soaking time reselect **Start** if the programme is to be continued or change the programme.

### Starching

Washing should not be treated with fabric softener. Dissolve an amount of starch for approx. 15 litres of water according to the manufacturer's instructions. Set programme selector to **Rinse/Freshen Up**, set spin speed and select **Start**. As soon as water runs in: Pour the starch solution into dispenser I.

### Dyeing/Bleaching

Do not dye/bleach washing in the washing machine.

### Freshen up

Use programme **Freshen Up/Rinse**. For items, that have been tucked away or stored for a period of time, to remove creases caused by folding and storage and to eliminate odours. Use fabric conditioner for "fresh" smell.

### Protection of the environment/conservation tips

- Utilise the maximum amount of washing for the particular programme.
- Wash normally soiled washing without prewash.
- Instead of **Cottons 90 °C** select **Cottons-Stains 60 °C** programme. Comparable cleaning result with significantly lower energy consumption.
- Meter detergent according to the manufacturer's instructions and water hardness.
- If the washing is then dried in the tumble dryer, select spin speed according to the instructions of the dryer manufacturer.



Programmes	°C	max.	Type of washing	Additional functions; information
<div>  Cottons                 </div>	* -90 °C			Wash Plus,  Prewash,  Reduced Ironing,  Aqua Plus
<div>  Cottons–Stains                 </div>		7 kg*	Hard-wearing textiles, heat-resistant textiles made of cotton or linen	Wash Plus,  Prewash,  Reduced Ironing,  Aqua Plus; for particularly sensitive skin, prolonged washing at selected temperature, higher water level, additional rinse cycle
<div>  Cottons–Stains                 </div>				
<div>  Sensitive                 </div>				
<div>  Easy-Care                 </div>	* -60 °C		Easy-care textiles made of cotton, linen, synthetic fibres or blended fabrics	Wash Plus,  Prewash,  Reduced Ironing,  Aqua Plus
<div>  Mix Load                 </div>	* -40 °C	3 kg	Textiles made of cotton and easy-care textiles	Wash Plus,  Prewash,  Reduced Ironing,  Aqua Plus; Different types of washing can be washed together
<div>  Dark Wash                 </div>	* -40 °C		Dark textiles made of cotton and dark easy-care textiles	Wash Plus,  Prewash,  Reduced Ironing,  Aqua Plus; reduced rinse and final spin cycle
<div>  Silk                 </div>	* -30 °C		For delicate, washable textiles, e.g. made of silk, satin, synthetic fibres or blended fabrics (e.g. curtains)	Wash Plus,  Prewash,  Reduced Ironing,  Aqua Plus; no spin cycle between the rinse cycles
<div>  Wool                 </div>	* -40 °C	2 kg	Hand or machine-washable wool or rich-wool textiles	also suitable for hand-washable silk; reduced rinse and final spin cycle
<div>  Sports Wash                 </div>	* -40 °C		Textiles made of microfibres	Wash Plus,  Prewash,  Reduced Ironing,  Aqua Plus
<div>  Super Quick                 </div>	* -40 °C		Easy-care textiles made of cotton, linen, synthetic fibres or blended fabrics	Short programme approx. 15 minutes suitable for refreshing
Additional programmes				Rinse/Freshen Up  Spin <sup>®</sup> , Drain <sup>®</sup> , Gentle Spin <sup>®</sup>
<div>  The programmes are time-controlled for lightly soiled textiles. If textiles are heavily soiled, reduce the load or select additional functions, e.g.  Wash Plus. Programmes without prewash – pour detergent into dispenser <b>II</b>, programmes with prewash – divide detergent between dispensers <b>I</b> and <b>II</b>.                 </div>				
<div>                     * Select the  Wash Plus additional function if washing 7 kg of cottons and coloureds.                 </div>				
<div>                     For further information and a selection of our products go to our web site: <a href="http://www.bosch-hausgeraete.de">http://www.bosch-hausgeraete.de</a> or contact our customer service centres                 </div>				
<div>                     WAE20460ME 0206en 9000 171 077                 </div>				
<div>                     Robert Bosch Hausgeräte GmbH                 </div>				

## Care

### Machine housing, control panel

- Wipe with a soft, damp cloth.
- Do not use abrasive detergents.
- Immediately remove washing and cleaning agent residue.
- Do not clean the appliance with a water jet.

### Clean the detergent drawer ...

... if it contains detergent or fabric softener residue.

1. Pull out, depress insert, completely remove.
2. Open the cover.
3. Clean with water and dry.
4. Close and lock the cover (place cylinder on guide pin).
5. Insert detergent drawer.

### Drum

Leave washing machine door open so that the drum can dry out.  
Rust stains – use chlorine-free cleaning agent, not steel wool.

### Descaling

Descal according to the instructions of the descaling agent-manufacturer, not required for correct detergent dosage.

## Information on the display panel

F:16	Close the washing machine door properly; washing may be caught.
F:17	Turn on the tap, supply hose kinked/jammed; clean filter (page 9), water pressure too low.
F:18	Clean detergent-solution pump (page 9), outlet pipe/drainage hose blocked.
F:23	Water in the base pan, appliance leaking. Call customer service!

## Maintenance

### Detergent-solution pump

Set programme selector to **Off**, pull out the mains plug.

1. Open and remove service flap.

2. For models with drainage hose:  
Take drainage hose out of the holder and pull out of the housing. Remove sealing cap, allow detergent solution to flow out.  
Press on sealing cap and insert drainage hose into the holder.

- 2\* For models without drainage hose:  
Carefully unscrew pump cover until the detergent solution begins to run out.  
When the service flap is half full, screw back the pump cover and empty the service flap.  
Repeat steps until all the detergent solution has run out.

3. Carefully unscrew the pump cover (residual water).

4. Clean the interior, pump cover thread and pump housing (fan impeller in the detergent-solution pump must rotate).

5. Reinsert and screw on pump cover.

6. Insert and close service flap.

### Filters in the water supply

**Risk of electric shock!** Do not immerse Aqua-Stop safety device in water (contains electric valve).

Release water pressure in the supply hose:

1. Turn off the tap!
2. Select any programme (except **Spin<sup>®</sup>/Drain<sup>®</sup>**).
3. Press **Start** . Leave programme for approx. 40 seconds.
4. Set programme selector to **Off**.
5. Remove hose from tap.
6. Clean filter with small brush.
7. Depending on the model, remove hose from the rear of the appliance and clean the filter.

8. Connect the hose and check for leaks.

## What to do if ...

- Water is running out.
  - Correctly attach/replace drainage hose.
  - Tighten screw-fitting on the supply hose.
- Water not flowing in.  
Detergent not washed in.
  - **Start** not selected?
  - Tap not open?
  - Filter blocked? Clean filter (page 9).
  - Supply hose kinked or jammed?
  - Safety function active. wait 2 minutes.
  - (without final spin) selected?
  - **Start** selected?
  - Door closed?
- Washing machine door cannot be opened.
  - **Start** selected?
  - Door closed?
- Programme does not start.
  - Clean detergent-solution pump (page 9).
  - Clean outlet pipe and/or drainage hose.
- Detergent solution is not drained.
  - Distribute small and large items of washing in the drum.
- Washing not spun correctly.
  - Not a fault – unbalanced load detection system adjusts imbalance.
- Spin cycle actuated several times.
  - Not a fault – water below the visible area.
- Water not visible in the drum.
  - Not a fault – effect of the care product not impaired.
- Residual water in the dispenser for care product.
  - Run **Cottons 90 °C** programme without washing. Use standard detergent.
- Odour formation in the washing machine.
  - Too much detergent used?
  - Mix 1 tablespoon of fabric conditioner with ½ litre of water and pour into dispenser **II** in the detergent drawer.
  - Reduce detergent dosage for the next wash cycle.
- Foam is coming out of the detergent drawer.
  - Appliance feet fixed? Secure appliance feet (*Installation instructions*).
  - Transportation safety devices removed? Remove transportation safety devices (*Installation instructions*).
- Vibrations during spin cycle.
  - **Reduced Ironing** selected (page 5)?
- Spin result not satisfactory.
  - Power failure?
  - Fuse tripped? Switch on/replace fuse.
  - If the fault occurs repeatedly, call customer service.
- Display panel/indicator lights do not function while the appliance is running.
  - Not a fault – unbalanced load detection system adjusts imbalance by repeatedly distributing the washing.
- Programme progress longer than usual.
  - Occasionally phosphate-free detergents contain water-insoluble residue.
  - Select **Rinse/Freshen Up** or brush the laundry after washing.
- Detergent residue on the washing.
  - Select **Rinse/Freshen Up** or brush the laundry after washing.
- If a fault cannot be rectified or a repair is required:
  - Set programme selector to **Off** and pull out the mains plug.
  - Turn off the tap and call customer service (*Installation instructions*).

## Safety instructions

- Read and follow the operating and installation instructions and all other information enclosed with the washing machine.
- Retain documents for subsequent use.
- Risk of electric shock**
  - Never pull out the mains plug by tugging the power cord!
  - Never insert/pull out the mains plug with damp hands.
- Risk of injury**
  - Washing machine door may become very hot.
  - Caution when draining hot detergent solution.
  - Do not climb on the washing machine.
  - Do not lean on the open washing machine door.
  - Keep detergents and care products out of the reach of children.
- Risk of poisoning**  
**Risk of suffocation**
  - Keep packaging, plastic film and packaging parts out of the reach of children.
- Danger to life**
  - On redundant appliances:
    - Pull out the mains plug.
    - Sever the power cord and discard together with the plug.
  - Destroy the lock on the washing machine door. This will prevent children from locking themselves in and suffocating.
- Risk of explosion**
  - Caused by detergents containing solvents, e.g. stain remover/items of washing pretreated with solvent naphtha may result in an explosion after being loaded into the washing machine. Beforehand thoroughly rinse items of washing by hand.

## Consumption values

Programme	Additional function	Load	Current *	Water *	Programme duration *
Cottons 40 °C	Wash Plus	7 kg	0.75 kWh	63 l	2:13 h
Cottons 60 °C	–	7 kg	1.25 kWh	57 l	1:30 h
Cottons–Stains 60 °C	Wash Plus	7 kg	1.19 kWh	49 l	2:36 h
Cottons 90 °C	Wash Plus	7 kg	2.25 kWh	70 l	1:52 h
Easy-Care 40 °C	Wash Plus	3 kg	0.56 kWh	50 l	1:24 h
Easy-Care 40 °C (also suitable as <b>Short programme</b> )	–	3 kg	0.54 kWh	40 l	0:55 h
Mix Load	–	3 kg	0.59 kWh	37 l	0:50 h
Silk 30 °C	–	2 kg	0.23 kWh	34 l	0:32 h
Wool 30 °C	–	2 kg	0.14 kWh	31 l	0:40 h

\* The values deviate from the indicated values depending on water pressure, water hardness, water inlet temperature, room temperature, type and amount of washing and degree of soiling, utilised detergent, fluctuations in the mains voltage and selected additional functions.



Read these instructions before switching on the washing machine!  
Also follow the separate Installation instructions.  
Follow the safety instructions on page 11!



# Your washing machine

**Congratulations** – You have opted for a modern, high-quality domestic appliance manufactured by Bosch. The washing machine is distinguished by its economical energy consumption.

Each appliance which leaves our factory is inspected thoroughly to ensure that it functions properly and is in perfect condition.



## Environmental disposal

Dispose of packaging in an environmentally friendly manner.

This appliance has been identified in accordance with the European Directive 2002/96/EG on Waste Electrical and Electronic Equipment (WEEE).

The Directive specifies the framework for an EU-wide valid return and recycling of waste appliances.

## Contents

Page

Intended use	1
Setting programmes	2
After washing	4
Individual settings	5
Important information	6
Overview of programmes	7
Care	8
Information on the display panel	8
Maintenance	9
What to do if ...	10
Safety instructions	11
Consumption values	11

## Intended use

- for use in the household only,
- for the washing of machine-washable textiles in a detergent solution,
- to be operated with cold drinking water and commercially available detergents and care products which are suitable for use in washing machines.



- Do not leave children unattended near the washing machine!
- Keep pets away from the washing machine!

## Programmes

For detailed overview of programmes see Page 7.

Temperature and spin speed can be selected individually.

Cottons	} hard-wearing textiles
Cottons Stains Plus	
Cottons Stains	
Sensitive	
Easy-Care	easy-care textiles
Silk	delicate washable textiles
Wool	hand/machine-washable textiles
Drain	the rinsing water if  occurs
Spin	washing washed by hand
Gentle Spin	washing washed by hand at reduced spin speed
Rinse/Freshen Up	... with subsequent spin cycle; for hand-washed items, starching or "freshen up" items, see Page 6.
Sports Wash	textiles made of microfibres
Super Quick	short programme
Mixed Load	different types of washing
Dark Wash	dark textiles

## Preparation



Correct installation according to separate installation instructions.



## Checking the machine

- Never switch on a damaged machine!
- Inform your customer service!



## Turn on the tap



## Insert mains plug



With dry hands only!  
Take hold of the plug only!



Additional functions

Display panel/  
Option buttons

Start/  
Pause

Program

Wash Plus

Pre-wash

Reduced Ironing

Aqua Plus

Temp. °C

Ready in

rpm

Start

Sensitive

Sports Wash

Super Quick

Mixed Load

Drain

Gentle Spin

Spin

– 90	Temp °C	Select the temperature
1 – 19h	Ready in	Programme ends in ...
– 1000*	rpm	Select the spin speed ( (without final spin))
Status displays		Programme progress
–0–		Washing, Rinse, Spin, ...

*Before washing for the first time,  
wash once without any washing. See page 6*

## Sorting and inserting the washing

Follow manufacturer's care information!

According to the information on the care labels.

According to type; colour; soiling and temperature.

*Follow important instructions! See page 6!*

Insert large and small items of washing! Do not jam items of washing between the washing machine door and rubber seal.

## Add detergent and care product

Meter accordingly:

Washing amount, soiling, water hardness (ask your water supply company) and manufacturer's instructions. Pour liquid detergent into the appropriate dispenser and place in the drum.

Prewash: Detergent, starch

Care product: Fabric softener

Main wash: Detergent, water softener, bleach, stain remover

Dilute viscous fabric softener and fabric conditioner with water.

Prevents blockage of the overflow.

Do not use detergent for programme option **Rinse/Freshen Up** ✱/

## Set and adjust programme

*For additional functions and option buttons see individual settings, page 5.*



*All buttons are sensitive, they only need to be touched gently!*

*Programme selector for switching the machine on and off and for selecting the programme. Can be rotated in either direction.*

**Select Start** ◊

Programme selector

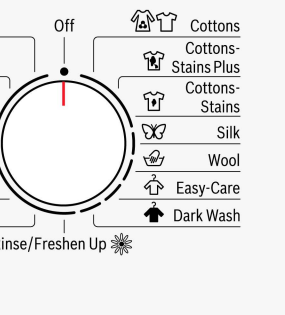

(✱ = cold)

\* depending on model) or

displays:

End

# Wash



1

2

Wash

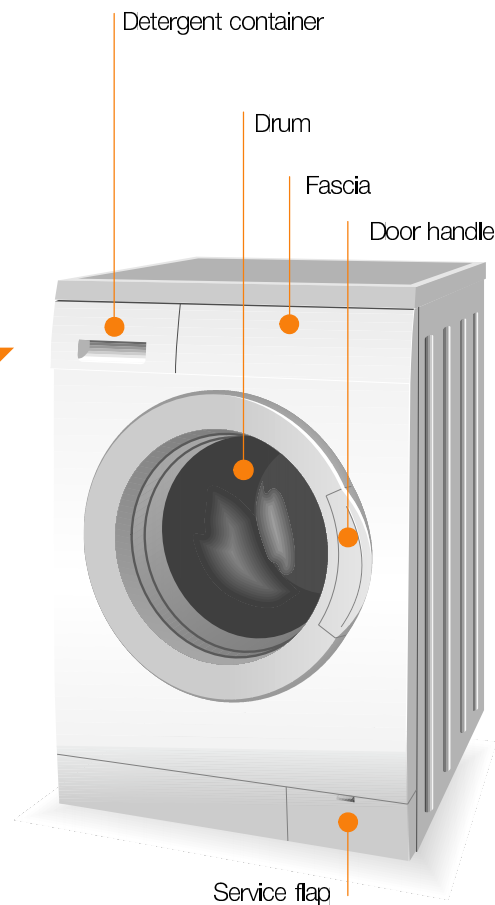

3

## Removing washing

*Possible approx. 2 minutes after the programme ends!*

Open washing machine door and remove washing.

If ◊ (without final spin) active: Set programme selector to ◊ **Drain** or select spin speed.

Select **Start** ◊.

Remove any foreign objects – risk of rusting.

## Turn off the tap

*Not required for Aqua-Stop models.*

## Switch off

Set programme selector to **Off**.

## End of programme when ...

... **Start** ◊ flashes and -0- is indicated on the display panel.

## Change programme ...

If you have mistakenly selected a wrong programme:

- Reselect programme.
- Select **Start** ◊.

## ... or terminate

Programmes with high temperature, first:

- Cool washing: Select **Rinse/Freshen Up** ✱  
Washing machine door remains locked.
- Select **Off**.
- Select ◊ **Spin** or ◊ **Drain**.
- Select **Start** ◊.

# Individual settings

## Option buttons

You can change the spin speed and temperature beforehand and while the selected programme is running. Effects dependent on the programme progress.

### Temp. °C

You can change the indicated washing temperature. The maximum washing temperature which can be selected depends on the set programme.

### Ready in ☺

The respective programme duration is displayed by selecting the programme. The programme start can be delayed before the programme begins. The **Ready in** ☺-time can be set in hour-steps up to maximum 19h. Keep pressing the **Ready in** ☺ button until the required number of hours is indicated (h=hour). Select **Start** ◀.

### rpm ⚙

You can change the indicated spin speed. The maximum spin speed which can be selected depends on the set programme.

## Additional functions

see also programme overview

Wash Plus	Extension of the washing time for a more intensive washing of highly soiled washing or 7 kg of cottons and coloureds.
Prewash	For heavily soiled, hard-wearing washing, e.g. made of cotton or linen. Prewash at 30 °C.
Reduced Ironing	Special spin sequence with subsequent fluffing. Gentle final spin – residual moisture in the washing increased slightly.
Aqua Plus	Increased water level and additional rinse cycle, extended washing time. For areas with very soft water or for further improvement of the rinsing result.

## Start ▶

For starting or interrupting the programme.

## Signal

### 1. Start signal mode

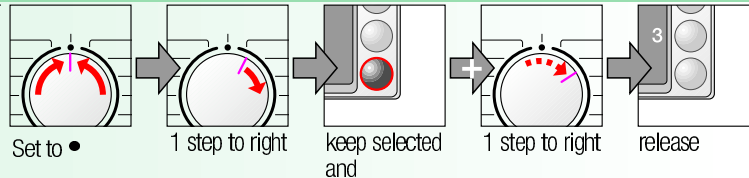

### 2. Set volume for ...

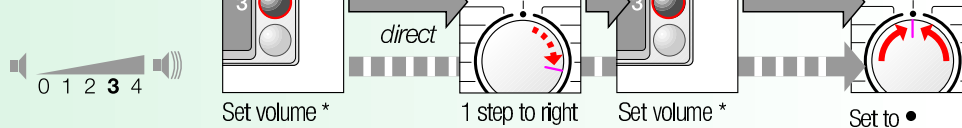

\* If required, select repeatedly

\* If required, select repeatedly



# Important information



## Protecting the washing and the machine

- Empty pockets.
- Remove metal parts (paper clips, etc.).
- Wash delicates in the net/bag (tights, curtains, underwired bras).
- Close zips, button up covers.
- Brush sand out of pockets and collars.
- Remove curtain fittings or include in the net/bag.



## Before washing for the first time

Do not put any washing in the washing machine! Turn on the tap, fill the appliance with approx. 1 litre of water and then pour ½ measuring cup of detergent into dispenser II. Set programme selector to **Easy-Care 60 °C** and select **Start** ▶. At the end of the programme set the programme selector to **Off**.



## Washing with different degrees of soiling

Light	Wash new items separately. Do not prewash.
Heavy	If required, pretreat stains. Select <b>Wash Plus</b> additional function. Load less washing. Prewash.



## Filling weight

Do not exceed maximum load:

- Cottons and coloureds 7 kg
- Easy-Care 3 kg
- Delicates, silk and woollens 2 kg



## Soaking Load washing of the same colour

Pour soaking agent/detergent into dispenser II according to the manufacturer's instructions. Set programme selector to **Cottons 30 °C** and select **Start** ▶. After approx. 10 minutes select **Start** ▶. After the required soaking time reselect **Start** ▶ if the programme is to be continued or change the programme.



## Starching Washing should not be treated with fabric softener

Dissolve an amount of starch for approx. 15 litres of water according to the manufacturer's instructions.

Set programme selector to **Rinse/Freshen Up** \*, set spin speed and select **Start** ▶. As soon as water runs in: Pour the starch solution into dispenser I.



## Dyeing/Bleaching

Do not dye/bleach washing in the washing machine.



## Freshen up Use programme \*Freshen Up/Rinse

For items, that have been tucked away or stored for a period of time, to remove creases caused by folding and storage and to eliminate odours. Use fabric conditioner for "fresh" smell.



## Protection of the environment/conservation tips

- Utilise the maximum amount of washing for the particular programme.
- Wash normally soiled washing without prewash.
- Instead of **Cottons 90 °C** select **Cottons–Stains 60 °C** programme. Comparable cleaning result with significantly lower energy consumption.
- Meter detergent according to the manufacturer's instructions and water hardness.
- If the washing is then dried in the tumble dryer, select spin speed according to the instructions of the dryer manufacturer.



Programmes	°C max.	Type of washing	Additional functions; information
Cottons	*-90 °C		
Cottons-Stains Plus			Wash Plus,  Prewash,  Reduced Ironing,  Aqua Plus
Cottons-Stains	*-60 °C	7 kg*	Hard-wearing textiles, heat-resistant textiles made of cotton or linen
Sensitive			Wash Plus,  Prewash,  Reduced Ironing,  Aqua Plus; for particularly sensitive skin, prolonged washing at selected temperature, higher water level, additional rinse cycle
Easy-Care	*-60 °C		Wash Plus,  Prewash,  Reduced Ironing,  Aqua Plus
Mix Load	*-40 °C	3 kg	Wash Plus,  Prewash,  Reduced Ironing,  Aqua Plus; Different types of washing can be washed together
Dark Wash	*-40 °C		Wash Plus,  Prewash,  Reduced Ironing,  Aqua Plus; reduced rinse and final spin cycle
Silk	*-30 °C		Wash Plus,  Prewash,  Reduced Ironing,  Aqua Plus; no spin cycle between the rinse cycles
Wool	*-40 °C	2 kg	also suitable for hand-washable silk; reduced rinse and final spin cycle
Sports Wash	*-40 °C		Wash Plus,  Prewash,  Reduced Ironing,  Aqua Plus
Super Quick	*-40 °C		Short programme approx. 15 minutes suitable for refreshing

## Rinse/Freshen Up Spin, Drain Gentle Spin

The programmes are time-controlled for lightly soiled textiles. If textiles are heavily soiled, reduce the load or select additional functions, e.g. Wash Plus. Programmes without prewash – pour detergent into dispenser **II**, programmes with prewash – divide detergent between dispensers **I** and **II**.

\* Select the Wash Plus additional function if washing 7 kg of cottons and coloureds.

For further information and a selection of our products go to our web site: <http://www.bosch-hausgeraete.de> or contact our customer service centres

Robert Bosch Hausgeräte GmbH

WAE20460ME  
0206en  
9000 171 077

## Care



- Risk of electric shock!  
Pull out the mains plug!
- Risk of explosion! No solvents!



### Machine housing, control panel

- Wipe with a soft, damp cloth.
- Do not use abrasive detergents.
- Immediately remove washing and cleaning agent residue.
- Do not clean the appliance with a water jet.



### Clean the detergent drawer ...

... if it contains detergent or fabric softener residue.

1. Pull out, depress insert, completely remove.
2. Open the cover.
3. Clean with water and dry.
4. Close and lock the cover (place cylinder on guide pin).
5. Insert detergent drawer.

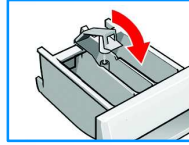
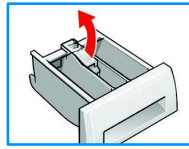
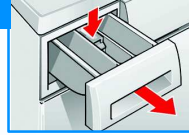

Leave detergent drawer open so that residual water can evaporate.



### Drum

Leave washing machine door open so that the drum can dry out.  
Rust stains – use chlorine-free cleaning agent, not steel wool.



### Descaling No washing in the machine!

Descale according to the instructions of the descaling agent-manufacturer, not required for correct detergent dosage.

## Information on the display panel depending on model

F:16	Close the washing machine door properly; washing may be caught.
F:17	Turn on the tap, supply hose kinked/jammed; clean filter (page 9), water pressure too low.
F:18	Clean detergent-solution pump (page 9), outlet pipe/drainage hose blocked.
F:23	Water in the base pan, appliance leaking. Call customer service!



- Risk of scalding!  
Allow detergent solution to cool down!
- Turn off the tap!

## Detergent-solution pump

Set programme selector to **Off**, pull out the mains plug.

1. Open and remove service flap.
2. For models with drainage hose:  
Take drainage hose out of the holder and pull out of the housing. Remove sealing cap, allow detergent solution to flow out.  
Press on sealing cap and insert drainage hose into the holder.
- 2\* For models without drainage hose:  
Carefully unscrew pump cover until the detergent solution begins to run out.  
When the service flap is half full, screw back the pump cover and empty the service flap.  
Repeat steps until all the detergent solution has run out.
3. Carefully unscrew the pump cover (residual water).
4. Clean the interior, pump cover thread and pump housing (fan impeller in the detergent-solution pump must rotate).
5. Reinsert and screw on pump cover.
6. Insert and close service flap.

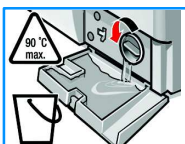
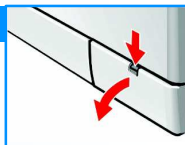

To prevent unused detergent from flowing into the outlet during the next wash:  
Pour 1 litre of water into dispenser II and select the **Drain** programme.

## Filters in the water supply



**Risk of electric shock!** Do not immerse Aqua-Stop safety device in water (contains electric valve).

Release water pressure in the supply hose:

1. Turn off the tap!
2. Select any programme (except **Spin** or **Drain**).
3. Press **Start**. Leave programme for approx. 40 seconds.
4. Set programme selector to **Off**.
5. Remove hose from tap.
6. Clean filter with small brush.
7. Depending on the model, remove hose from the rear of the appliance and clean the filter.
8. Connect the hose and check for leaks.

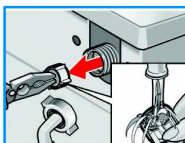

- Water is running out.
  - Correctly attach/replace drainage hose.
  - Tighten screw-fitting on the supply hose.
- Water not flowing in.  
Detergent not washed in.
  - **Start** not selected?
  - Tap not open?
  - Filter blocked? Clean filter (page 9).
  - Supply hose kinked or jammed?
- Washing machine door cannot be opened.
  - Safety function active. wait 2 minutes.
  - (without final spin) selected?
- Programme does not start.
  - **Start** selected?
  - Door closed?
- Detergent solution is not drained.
  - Clean detergent-solution pump (page 9).
  - Clean outlet pipe and/or drainage hose.
- Washing not spun correctly.
  - Distribute small and large items of washing in the drum.
- Spin cycle actuated several times.
  - Not a fault – unbalanced load detection system adjusts imbalance.
- Water not visible in the drum.
  - Not a fault – water below the visible area.
- Residual water in the dispenser for care product.
  - Not a fault – effect of the care product not impaired.
- Odour formation in the washing machine.
  - Run **Cottons 90 °C** programme without washing. Use standard detergent.
- Foam is coming out of the detergent drawer.
  - Too much detergent used?  
Mix 1 tablespoon of fabric conditioner with ½ litre of water and pour into dispenser II in the detergent drawer.
  - Reduce detergent dosage for the next wash cycle.
- Vibrations during spin cycle.
  - Appliance feet fixed?  
Secure appliance feet (Installation instructions).
  - Transportation safety devices removed?  
Remove transportation safety devices (Installation instructions).
- Spin result not satisfactory.
  - **Reduced Ironing** selected (page 5)?
- Display panel/indicator lights do not function while the appliance is running.
  - Power failure?
  - Fuse tripped? Switch on/replace fuse.
  - If the fault occurs repeatedly, call customer service.
- Programme progress longer than usual.
  - Not a fault – unbalanced load detection system adjusts imbalance by repeatedly distributing the washing.
- Detergent residue on the washing.
  - Occasionally phosphate-free detergents contain water-insoluble residue.
  - Select **Rinse/Freshen Up** or brush the laundry after washing.
- If a fault cannot be rectified or a repair is required:
  - Set programme selector to **Off** and pull out the mains plug.
  - Turn off the tap and call customer service (Installation instructions).





# Safety instructions

- Read and follow the operating and installation instructions and all other information enclosed with the washing machine.
- Retain documents for subsequent use.

## Risk of electric shock

- Never pull out the mains plug by tugging the power cord!
- Never insert/pull out the mains plug with damp hands.

## Risk of injury

- Washing machine door may become very hot.
- Caution when draining hot detergent solution.
- Do not climb on the washing machine.
- Do not lean on the open washing machine door.

## Risk of poisoning

## Risk of suffocation

- Keep detergents and care products out of the reach of children.
- Keep packaging, plastic film and packaging parts out of the reach of children.

## Danger to life

On redundant appliances:

- Pull out the mains plug.
- Sever the power cord and discard together with the plug.
- Destroy the lock on the washing machine door. This will prevent children from locking themselves in and suffocating.

## Risk of explosion

- Caused by detergents containing solvents, e.g. stain remover/items of washing pretreated with solvent naphtha may result in an explosion after being loaded into the washing machine. Beforehand thoroughly rinse items of washing by hand.

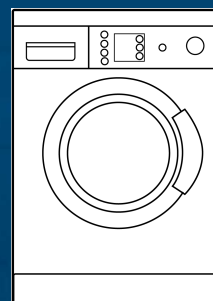

Washing machine

en

Operating instructions



**BOSCH**



Read these instructions before switching on the washing machine!  
Also follow the separate Installation instructions.  
Follow the safety instructions on page 11!

## Consumption values

Programme	Additional function	Load	Current *	Water *	Programme duration *
Cottons 40 °C	Wash Plus	7 kg	0.75 kWh	63 l	2:13 h
Cottons 60 °C	–	7 kg	1.25 kWh	57 l	1:30 h
Cottons–Stains 60 °C	Wash Plus	7 kg	1.19 kWh	49 l	2:36 h
Cottons 90 °C	Wash Plus	7 kg	2.25 kWh	70 l	1:52 h
Easy-Care 40 °C	Wash Plus	3 kg	0.56 kWh	50 l	1:24 h
Easy-Care 40 °C (also suitable as <b>Short programme</b> )	–	3 kg	0.54 kWh	40 l	0:55 h
Mix Load	–	3 kg	0.59 kWh	37 l	0:50 h
Silk 30 °C	–	2 kg	0.23 kWh	34 l	0:32 h
Wool 30 °C	–	2 kg	0.14 kWh	31 l	0:40 h

\* The values deviate from the indicated values depending on water pressure, water hardness, water inlet temperature, room temperature, type and amount of washing and degree of soiling, utilised detergent, fluctuations in the mains voltage and selected additional functions.