

## Washing machine

en Operating and installation instructions



# BOSCH

	p.		p.
General safety guidelines and warnings	3	Detergents and additives	8
Removal and disposal of packaging	3	First washing cycle	9
Environmental protection / Saving energy	4	Preparing the laundry for washing	9
Installing the appliance	4	Loading the laundry	10
Removing the transport security devices	4	Washing the laundry	10
Fixing the appliance	5	End of the wash programme/Removing the laundry	11
Connecting to the water supply	5		
Water drainage	6	Cleaning / Maintenance / Frost protection	12
Connecting to the electricity supply	6	Technical data	13
Getting to know your new appliance	7	Minor faults with simple solutions	14
Programme selector	8	After Sales Service	15
Function selection and start buttons	8	Consumption figures	15

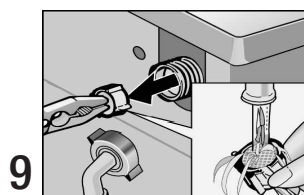
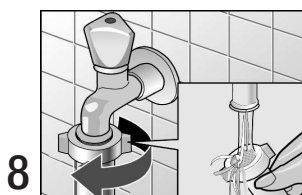
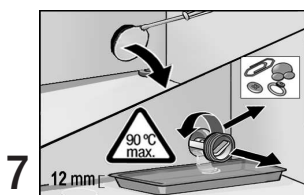
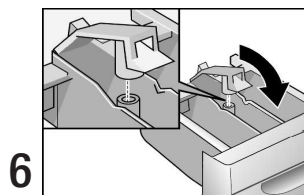
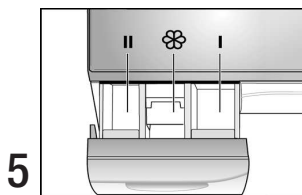
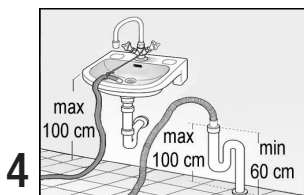
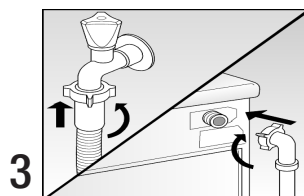
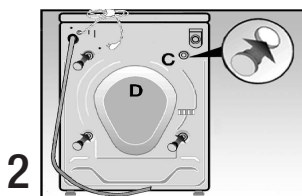
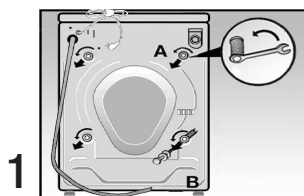

## General safety guidelines and warnings

This appliance complies with current safety standards in the sector.

### Points to bear in mind before operating the appliance:

- ! Read these instructions carefully before operating the appliance. They contain important information and advice relating to the installation, use and safety of the appliance.
- ! Keep the instructions for using the appliance for future reference and/or any possible future owner.
- ! Set up the appliance according to the assembly instructions. Remove the transport securing devices and keep them.
- ! Do not connect any appliance with visible signs of damage or flaws to the mains. If in doubt, you should contact the After Sales Service or the distributor where the appliance was acquired.
- ! If the power cable is damaged, it should be replaced with a special one supplied by the Manufacturer's Official Service.

### Points to bear in mind when washing clothes:

- ! The appliance should only be used with cold water from the public water supply.
- ! The appliance should only be used for washing clothes suited to household washing machines.
- ! Do not leave the machine unguarded if children are present.
- ! Keep pets away from the machine.
- ! Take care when the hot water is being emptied.

### Points to note for the protection of the appliance:

- ! Do not get on top of the appliance.
- ! Do not use the door as a support or stand on it either.

### Points to note when transporting the machine:

- ! Fix the transport securing devices in their positions.
- ! Empty any water remaining inside the appliance.
- ! Pay careful attention during transportation of the appliance! Do not use the parts or controls on the front to hold or lift the appliance!

## Removal and disposal of packaging

### Removal and disposal of your new appliance's packaging material

All the materials used are environmentally friendly and can be recycled or reused.

### Disposal of an old appliance

Worn-out appliances contain valuable materials that can be recovered, if the appliance is taken to an official recyclable waste recovery centre. Actively contribute to the protection of the environment by ensuring that your old appliance is disposed of in a way that respects the environment.



This appliance is labelled in accordance with European Directive 2002/96/EC concerning used electrical and electronic appliances (waste electrical and electronic equipment - WEEE). The guideline determines the framework for the return and recycling of used appliances as applicable throughout the EU.

## Environmental protection / Saving energy

- The most economic and least aggressive use from an environmental point of view is always to load the maximum amount of laundry pos-

sible into the machine according to the selected programme.

## Installing the appliance

- ! When installing the appliance and connecting it to the water supply and mains, the guidelines and warnings indicated as well as the general observations, regulations and stipulations of the local water and electricity supply companies should be closely observed.
- ! Be careful when lifting the appliance! **Danger of injury!**
- ! Do not lift the appliance by its protruding parts or controls!
- ! If in doubt, you should ask a specialist technician to connect the appliance to the water supply and electric mains.

### Positioning

In order to guarantee the safe and secure positioning of the appliance during the spin, the surface or location where the appliance is to be installed should be flat and firm. Soft floor linings, such as fitted carpets or other materials with a foam rubber face, are not suitable locations for the machine.

- ! If necessary, fix the appliance to the floor using attachment lugs (obtained from the After Sales Service) secured to the feet of the machine (particularly when setting up a combined column of washing and drying).
- ! In the event of setting up the appliance on a stand or raised base, it will be necessary to secure the feet of the appliance with the lugs in order to avoid the uncontrolled movement of the machine during the spin cycle.

The attachment lugs can be acquired as well as a spare set from the distributor.

### Protective cover

If it is necessary to remove the protective cover in order to install the appliance under the work surface, a technician should put in a cover plate to avoid dirt, water, etc. from entering the appliance and therefore extend its working life. This piece may be obtained from After Sales Service.

## Removing the transport security devices (pic. 1, 2)

- ! Before initial use of the machine, it is essential to remove the transport securing devices, which are in the rear part of the machine, with a suitable spanner.
- ! **Warning!** Danger of injury if spanner slips!
- Loosen and remove the 4 attachment screws «**A**».
- Remove the four spacers «**B**» which have fallen on the floor. Gently tilt the appliance forward.

- Assemble the protective covers «**C**» which are inside the bag with the documentation.
- ! Keep the transport securing devices in case you need to move the appliance in future.

The appliance should only be moved with the transport securing devices in place. To fit them, remove the back panel «**D**» from the machine and carry out the operations given above in reverse order.

## Fixing the appliance

---

! The appliance must be firmly fixed and settled on its four feet, not rocking.

If necessary, level and stabilise the appliance using the adjustable feet.

○ Loosen the locknuts of the feet.

○ Correct the height of the feet.

○ Securely tighten the locknuts so that the adjustments made to the feet cannot be altered accidentally.

## Connecting to the water supply (pic. 3)

---

The water inlet requires a cold water inlet pipe of the type commonly used in homes (included; two pipes in case of models featured for hot water), with a minimum pressure of 1 bar.

If pressure is higher than 10 bar, a pressure-reducing valve must be inserted between the appliance and the water supply.

! The appliance should be connected to the water supply using new feed pipes. The old feed pipes should not be reused.

! Do not connect the appliance to a mixer tap without the pressure of a boiler! If in doubt, you should get a specialist technician to assemble and connect the appliance to the water inlet and outlet supplies.

! **Warning!** The connections or couplings between the appliance and the water supply withstand the maximum pressure. Check that the circuit is watertight by turning the tap on fully!

! Remove the filter at the end of the solenoid valve in order to clean it (see «Cleaning / Maintenance / Frost protection»). The other filter, attached to the tap, should be cleaned in the pipe itself (it is not detachable).

! In order to prevent damage caused by water leaks or flooding, the tap should always be turned off after the appliance has completed its work cycles and during lengthy periods of inactivity.

! Only tighten the plastic locknuts of the pipe's connections by hand.

## Water drainage (pic. 4)

---

- ! When setting up and connecting the appliance to the water outlet supply, make sure the pipe is not bent or twisted. Do not pull the pipe!
- ! If draining through a sink, make sure the discharge pipe cannot be moved from its location. Also check the rapid discharge of water through the draining of the sink. Make sure the plug is not blocking the sink. **Danger of flooding!**

## Connecting to the electricity supply

---

- ! The appliance must only be connected to an alternating current power supply via a socket that has been properly installed and earthed.
- ! The voltage which is given on the specifications plate must coincide with the mains voltage where the appliance is connected.
- ! The connection values and the fuses or trip switch that is required are given on the specifications plate.
- ! Make sure that the socket and the plug connected to the appliance are compatible and that the plug is properly earthed.
- ! Do not use multiple plugs, cables or connections or extension cables.
- ! In the event of using a current-operated circuit breaker, only one with the symbol  can be used. Only this type of protection switch will assure the observance of current regulations on the matter.
- ! Only remove the power plug from the mains by holding the plug itself.
- ! Do not insert or remove the power plug with wet hands.

# Getting to know your new appliance

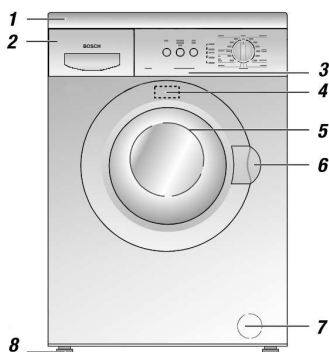



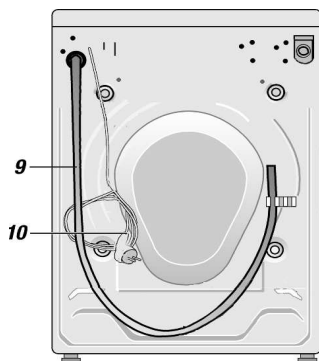

1. Protective plate (cover)
2. Drawer for detergent and additives
3. Control panel
4. Rating plate
5. Door
6. Lever for opening the door
7. Drainage pump
8. Adjustable front feet to level the appliance



9. Water outlet pipe
10. Plug
11.  – «Start» button
12. Function selection buttons (depending on model):
  - «Spin speed reduction 

1200 ↓	600 ↓
600 ↓	400 ↓, ...»

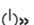
»
  - «Rinse Hold »
  - «Rinse Plus »
  - «Quick Wash »
  - «Less Ironing »
  - «Prewash »
  - «Pause »

13. Washing machine status indicator lights
14. Programme selector

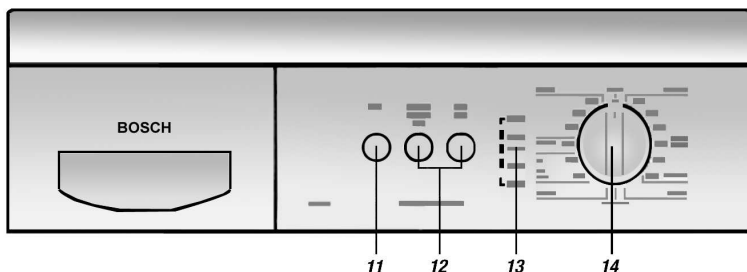

## Programme selector

Selecting programmes using the **programme selector**. For this, the control knob needs to be turned and the mark positioned on the programme selected.

### Wash programmes (depending on model):

«Cottons + Linens  »

**Heavily soiled whites, 90 °C:** fast cotton or linen (intensive wash).

**Intensive Stains  **, 60 °C: energy saving programme. A longer wash cycle reduces energy consumption.

**Whites and colours, fast materials and colours, 60 °C, with Prewash **: heavily soiled clothing.

**Mixed, 30 °C:** cotton garments and delicate fabrics; different types of clothing may be washed together.

**Colours, 30, 40, 60 °C:** fast materials.

«Easy-Care »

**Delicates, 30, 40, 60 °C (synthetic):** cotton, synthetic or mixed materials.

«Delicates »

**Very delicate clothing, 30 °C:** cotton, synthetic or mixed materials, curtains. Does not spin between the rinse cycles.



«Woollens  »



**Wool, cold, 30 °C:** wool or wool mix machine washable materials.

### Additional programmes

**Rinse **: rinse cycle with low-energy spin. Can also be used for delicate items.

**Spin **: extra spin cycle; washing or rinsing water is pumped out before spinning the laundry.

**Drain **: empty the water used for rinsing after selecting a wash programme with the option «Rinse Hold ».

! The maximum speed of the spin is limited electronically in the programmes «Easy-Care », «Delicates » and «Woollens ».

## Function selection and start buttons

**Rinse Hold:** clothing remains immersed in the last rinse water.

**Spin speed reduction:** spin at a reduced speed (spin speed values depending on model).

**Rinse Plus:** an extra rinse cycle is carried out.

**Quick Wash:** the washing cycle is shorter.

**Less Ironing:** laundry comes loose in the drum to avoid creasing.

**Prewash:** a prewash cycle is carried out.

**Pause:** the programme is interrupted.

**Start **: The selected programme is activated. The «ready-wash» indicator comes on.

! For security reasons, the machine does not start until the door is closed properly.

## Detergents and additives

All standard use detergents for automatic washing machines can be used.

! Do not use detergents with solvents in the washing machine! **Danger of explosion!**

! Do not use additives, cleaning sprays or stain removers in the vicinity of the appliance, as they may damage it.

! Keep detergents and additives in a safe place, away from children.

### Amount of detergent

Only using the correct measure of detergent will guarantee good wash results. Note the manufacturer's recommendations.



## First washing cycle

Carry out the first washing cycle without any laundry in the machine to remove residual water left inside the drum as a result of testing of the machine at the factory.

- Pour approximately 2 litres of water and half a measuring glass of normal detergent into the compartment II of the detergent drawer.

- Set the programme selector to «**Cottons + Linens 90°C**». The «**ready-wash**» indicator light flashes.
- Press the «**Start** » button. The «**ready-wash**» indicator comes on.
- When the «**spin-end**» light flashes, turn the programme selector control to «**Off**».

## Preparing the laundry for washing

### Sorting the laundry

- Sort the laundry according to the symbols on the labels.
- ! Wool or wool composite knitwear must include the indication «Will not shrink» or «Machine washable».

Items labelled with the following symbol should not be washed in the machine: 

- Sort laundry by colours. Wash whites and colours separately, otherwise white garments may change colour.
- ! New colour garments should be washed separately. **Risk of colour running.**
- Sort the laundry according to the maximum permitted load for the machine. Do not overload the machine, as this greatly reduces its performance and the result of the wash.

Maximum load allowable for washing:

**Cottons + Linens**  

**5.00 kg**

**Easy-Care** 

**2.50 kg**

**Delicates**  **Woollens**  

**2.00 kg**

### Practical guidelines

- ! Remove foreign bodies and metal objects (safety pins, clips, ...) from clothing.
- ! Remove bits of sand by brushing clothing.
- ! Do up all zips and buttons of cushion covers.
- Wash very delicate laundry (tights, curtains...) and very small items (socks, handkerchiefs...) in a net or cushion cover.
- Turn trousers and knitwear inside out (shirts, sweatshirts...).
- Make sure that bras with items inserted (hoops, etc.) are suitable for washing in the washing machine.
- ! Put bras with inserted items into a cushion cover, since these items may fall through the drum if they come loose and damage the washing machine.

### Removing stains

When stains appear, they should be treated or removed immediately with soap and water. Do not rub vigorously on the clothing. Stains that are very stubborn or dry sometimes only vanish after several washes.

## Loading the laundry (pic. 5)

---

### Open the door

- Pull the lever.

### Put the laundry in the washing machine

- ! Garments previously treated with detergents containing solvents, such as stain removers etc., should be dried outside before being washed. **Danger of explosion!**
- ! Before adding the laundry to the washing machine, make sure there are no foreign bodies or animals enclosed in the drum.
- Add the outspread and unfolded laundry, mixing large and small items.

### Close the door

- ! Make sure there are no items left trapped between the door and the rubber seal.
- Close the door by pressing it against the frame of the appliance, until you can hear the door closing shut.

### Pour detergent

- Pour detergent without exceeding the maximum filling level mark.
- Compartment **I**: Detergent for pre-washing.
- Compartment **II**: Detergent for main wash, limescale remover, stain removing salt...
- Compartment : Additives for the last rinse, for example softeners.
- Turn on the tap.

## Washing the laundry

---

### Starting a programme

- Turn the programme selector to the required wash programme. The «**ready-wash**» indicator light flashes.
- Press one or more function selection buttons (optional). The relevant status indicator light comes on.
- Press the «**Start** » button. The «**ready-wash**» indicator comes on. The wash programme starts.

### Modifying a selected programme

- Set the programme selector to the desired programme. The «**ready-wash**» indicator light flashes.
- Press the «**Start** » button. The «**ready-wash**» indicator light comes on. The selected programme starts.

### Interrupting a wash programme

- Set the programme selector to «**Drain**» or «**Spin**». The «**ready-wash**» indicator light flashes.
- Press the «**Start** » button. The «**spin-end**» indicator light comes on permanently.

## End of the wash programme/Removing the laundry

---

The «**spin–end**» indicator light flashes.

- Turn the programme selector to «**Off**».

If «**Rinse Hold** » has been selected:

- Select an additional programme («**Drain**» or «**Spin**») to empty the water.
- Press the «**Start** » button.
- After the additional programme has finished, turn the programme selector to «**Off**».

### Taking the laundry out of the machine

- Turn off the tap.
- Open the door.

! The door of the washing machine cannot be opened during the wash cycle. To open it, wait until the indicator light «**spin–end**» flashes or turn the programme selector to «**Off**» and wait at least 2 minutes.

- Take the laundry out of the machine.

! Remove foreign bodies and metallic objects (clips, coins...) which might have accumulated inside the drum or on the rubber seal. **Risk of rusting!**

Leave the door open so that air can circulate inside and dry the appliance.

## Cleaning / Maintenance / Frost protection (pic. 6, 7, 8, 9)

- ! **Before performing any type of maintenance work on the appliance, it must be disconnected from the mains and the tap turned off.**

### External cleaning of the appliance

- ! Do not use solvents! These products can damage parts of the appliance, form toxic vapours, harm your health and cause explosions.
- ! Do not clean the appliance by directing a jet of water at it.

Only clean the outside of the appliance and the controls with warm, soapy water or a standard cleaning product. Do not use abrasive or aggressive products. Dry with a soft cloth.

### Cleaning the detergent drawer

- Remove the drawer completely from the appliance keeping the mobile part pressed downwards.
- Clean all the parts and elements under running water.
- Put the drawer back into the appliance.

### Descaling the appliance

- ! Descaling agents contain acids which may attack the components of the appliance or cause discolouration in the laundry. Strictly observe the manufacturer's instructions.

### Cleaning the drum

The rust stains caused by metallic objects must be cleaned with detergents which do not contain chlorine (note the description of the components appearing on the container!). Never use steel wool!

### Cleaning the drainage pump

Cleaning is necessary:

- If the pump is blocked by foreign material (buttons, fasteners, clips...) or if dirty water is not drained.
- After washing fluffy items.

Before cleaning the pump, all water must be removed from inside the appliance. If the pump is obstructed as much as 20 litres of water may remain.

#### Procedure

- Turn the programme selector to «**Off**».
- Remove the filter cover from the front of the washing machine by inserting a screwdriver in the upper slot.
- **Risk of burning!** Allow the used water to cool down.
- Place a shallow container under the drainage pump cover (outlet filter). Loosen the cover without removing it completely to allow the water to empty gradually. When the container is full, close the drainage pump cover. Repeat the operation until all the water has been emptied. Use a suitable cloth to remove any remaining water which may spill on the floor.
- Loosen the drainage pump cover completely.
- Remove any foreign material or fluff which may have collected there. Wipe the inside of the pump. The blades must move freely.
- Coil and fit the drainage pump cover in place. Ensure that it is correctly closed.
- Fit the filter cover in place.
- Pour 2 litres of water into the detergent drawer and start the «**Drain**» additional programme. This will prevent the detergent from being flushed out before being used in the next wash.

### Cleaning the filters in the water inlet

The filters in the water inlet must be cleaned when, with the tap turned on, no water or only a very small amount enters the appliance.

The filters are located in the hose connection which joins the water inlet pipe to the mains tap, as well as in the connection of the solenoid valve at the rear of the appliance.

#### Procedure

- Firstly empty the water pressure from the inlet pipe:
  1. Turn off the tap.
  2. Set the programme selector to any wash programme (except **Spin/Drain**).
  3. Press the **«Start»** button. Let it run for at least 1 minute.
  4. Turn the programme selector to **«Off»**.
- Unscrew the inlet pipe from the tap. Rinse the filter under running water.
- Screw the pipe to the tap again.
- Remove the water inlet pipe from its connection at the back of the machine.
- Remove the filter by using some flat-nose pliers; clean it and put it back in its position.
- Attach the pipe to its coupling.
- Turn on the tap and check that there are no water leaks.
- Turn off the tap.

### Frost protection

#### Drain the water from the pump:

See «Cleaning the drainage pump».

#### Drain the water from the inlet pipe:



- Turn off the tap.
- Disconnect the inlet pipe from the tap. Put the end of the pipe in a receptacle.
- Select any wash programme (except **Spin/Drain**), during 40 seconds. The water in the pipe is drained.
- Reattach the pipe to the closed tap.

## Technical data

Width	59.5 cm	Drum capacity	according to specifications plate 1–10 bar
Height	85.0 cm	Mains voltage	
Depth	56.0 cm	Fuse	
Weight	approx. 70 kg	Water supply pressure	

## Minor faults with simple solutions

! Repairs necessary in the electrical appliances will only be able to be performed by electricians or specialist technicians. Repairs carried out incorrectly may be highly dangerous or seriously harm the user.

Malfunction	Possible cause / Remedy
<b>The function indicator does not come on</b> <b>Electrical power failure</b>	The machine's plug is not connected or not properly connected to the socket. The fuse has blown. Electrical power failure. In the event of a power failure or appliance malfunction, emergency draining is possible, so that the laundry can be removed from the machine; see «Cleaning the drainage pump»
<b>The wash cycle does not start</b>	The « <b>Start</b> 
<b>Water is not visible in the drum</b>	The door is not properly closed (« <b>ready-wash</b> » and « <b>rinse</b> » indicators flash). This is not a malfunction. There is water in the appliance but it is beneath the visible area. The electronic control reduces consumption maintaining all the features.
<b>Washing result is unsatisfactory</b>	Abnormally high degree of soiling. Insufficient detergent. Measure out the detergent in line with the manufacturer's instructions. Select the most suitable wash programme for the laundry.
<b>Foam comes out of the detergent drawer</b>	Too much detergent has been used. Disconnect the appliance for 5 - 10 minutes. To prevent the build-up of foam, put a dessert-spoon of softener mixed with half a litre of water in the detergent drawer. Reduce the amount of detergent used in your next wash.
<b>Foam is visible after the final rinse</b>	Some detergents produce a large quantity of foam although this has no effect on the rinsing result.
<b>Strange motor noises</b>	This is not a malfunction. During the heating stage, the motor produces noises characteristic of starting.
<b>Pump noises</b>	This is not a malfunction. These noises are characteristic of the machine starting and the pump discharging.
<b>The machine vibrates when washing or spinning</b>	The transport securing devices have not been removed. Note the installation instructions. The adjustable feet on the machine were not fixed during installation. Place the machine and fix the feet according to the installation instructions.
<b>The appliance does not spin or does not empty the water used</b>	The outlet pump is blocked, see «Cleaning the drainage pump»; the outlet pipe is bent or blocked (« <b>rinse</b> » and « <b>spin-end</b> » indicators flash in both cases).
<b>The door will not open</b>	The safety feature is activated. The option « <b>Rinse Hold</b> 
<b>Water does not enter the washing machine</b>	The tap is turned off. The water inlet filters are dirty (« <b>ready-wash</b> » and « <b>spin-end</b> » indicators flash); see «Cleaning the filters in the water inlet».
<b>All indicators flash</b>	Security protection activated. Close the inlet tap and contact the After Sales Service.

## After Sales Service

- Before calling the After Sales Service Department, make sure you are not able to solve the problem yourself (see «Minor faults with simple solutions»).
- In this way, you will avoid unnecessary costs, since the warranty does not cover cases where there is in fact no fault, or when the After Sales Service Department is called out to only provide instructions.
- ! If, in spite of these indications, a malfunction occurs, disconnect the appliance, pull the plug out of the socket and turn off the tap, before contacting the After Sales Service.

The address and telephone number of your nearest After Sales Service is in the attached directory.















Do not forget to indicate the product number (**E-Nr**) and serial number (**FD**), which are on the specifications plate, situated on the inside of the door frame.

Note the numbers of your machine here:

<b>E-Nr.</b> _____	<b>FD</b> _____
Product nr.	Serial nr.

Help prevent our technicians being called out on pointless journeys by providing the correct product and serial numbers, and by giving as precise an explanation as possible of the problem. This will save you unnecessary expense.

## Consumption figures

Programme	Size of load	Consumption **		
		Energy	Water	Duration
Cottons + Linens   40 °C	5.00 kg*	0.55 Kwh	54 l	110 min
Cottons + Linens   60 °C	5.00 kg	0.80 Kwh	54 l	115 min
Cottons + Linens   60 °C Intensive Stains  	5.00 kg*	0.95 Kwh	49 l	140 min
Cottons + Linens   90 °C	5.00 kg	1.90 Kwh	61 l	110 min
Easy-Care  40 °C	2.50 kg*	0.45 Kwh	50 l	75 min
Delicates  30 °C	2.00 kg	0.30 Kwh	55 l	50 min
Woollens   30 °C	2.00 kg*	0.20 Kwh	35 l	55 min

\* Test programmes in accordance with EN 60456 and IEC 456.

\*\* The consumption figures given are an approximate guide and may differ from the actual values depending on the pressure, hardness and temperature of the water, room temperature, the type and amount of laundry, the detergent used, fluctuations in electrical voltage and the additional functions selected .

Robert Bosch Hausgeräte GmbH  
Carl-Wery Str. 34  
81739 München / Deutschland

WAA20160GB / ...  
8607 en  
9000069375