

# Color Video Camera

## 彩色摄像机

### Operating Instructions

Before operating the unit, please read this manual thoroughly and retain it for future reference.

### 使用手册

使用本机前，请仔细阅读本使用手册并妥善保管以备日后参考。

## DynaView+

### SSC-DC693P/DC698P

### SSC-DC673P/DC678P

© 2008 Sony Corporation Printed in China

http://www.sony.net/

### WARNING

To reduce a risk of fire or electric shock, do not expose this product to rain or moisture.

To avoid electrical shock, do not open the cabinet. Refer servicing to qualified personnel only.

The apparatus shall not be exposed to dripping or splashing and no objects filled with liquid, such as vases, shall be placed on the apparatus.

**WARNING (SSC-DC678P/SSC-DC698P only)**  
The mains plug must be used to disconnect mains power. Please ensure that the socket outlet is installed near the equipment and shall be easily accessible.

### ATTENTION

The electromagnetic fields at specific frequencies may influence the picture of this unit.

### CAUTION

This installation should be made by a qualified service person and should conform to all local codes.

### CAUTION

The nameplate is located on the bottom.

### 警告

为减少火灾或电击危险，请勿让本产品受到雨淋或受潮。

为了避免触电，切勿打开机壳。只能请专业维修人员进行维修。

设备不要受到滴水或水溅，不要将盛满液体的花瓶等物品放在设备上。  
**警告（仅限 SSC-DC698P/DC678P）**  
必须使用电源插头断开电源连接。请确保电源插座安装在设备旁，并便于插拔。

**声明**  
此为 A 级产品，在生活环境中，该产品可能会造成无线电干扰。在这种情况下，可能需要用户对其干扰采取切实可行的措施。一旦发生干扰，请联络附近的授权 Sony 维修机构。本设备不应在住宅区使用。

### 注意

特定频率的电磁场可能会干扰本装置的图像。

### 小心

此项安装应由专业服务人员进行，并遵照所有本地法规。

### 小心

标牌在底部。

### English

### Features

The SSC-DC693P/DC698P and SSC-DC673P/DC678P color video camera is equipped with a 1/3 inch image sensor DynaView™ technology and also has the following features:

- Wide dynamic range using DynaView™ technology
- Day/Night function allowing color/monochrome mode switching (SSC-DC693P/DC698P)
- Automatic white balance tracking and adjustment (ATW/ATW-PRO)
- DC controlled auto-iris lens capability
- Backlight compensation through center measurement
- Line lock function for synchronizing through AC power source (SSC-DC698P/DC678P: 50 Hz)

\* DynaView™ is a registered trademark of Sony Corporation.

### Notes on Use

#### Power supply

- The SSC-DC693P/DC673P operates on either AC 24 V or DC 12 V power. The SSC-DC693P/DC673P automatically detects the power. –When connecting the transformer, be sure to connect each lead to the appropriate terminal. Wrong connection may cause malfunction and/or damage to the video camera. –Ground the unit or an irregular voltage may be generated in the AC power cord and may cause malfunction and/or damage to the video camera.
- The SSC-DC698P/DC678P must always be operated with an AC 220 - 240 V (50 Hz) power supply.

#### Handling

Be careful not to spill water or other liquids on the unit, or allow combustible or metallic objects to fall inside the body. If used with a foreign object inside, the camera is liable to fail, or be a cause of fire or electric shock.

#### Operation and storage locations

Avoid aiming the camera at very bright objects such as the sun or electric lights for an extended period. Avoid operating or storing the unit in the following locations.

- Extremely hot or cold places (operating temperature –10 °C to + 50 °C (14 °F to 122 °F))
- Damp or dusty places
- Where it is exposed to rain
- Where it is subject to strong vibration
- Close to generators of powerful electromagnetic radiation such as radio or TV transmitters.
- Where it is subject to fluorescent light reflections
- Where it is subject to unstable (flickering, etc.) lighting conditions.

#### Care of the unit

- Remove dust or dirt on the surface of the lens or Image Sensor with a blower.
- Use a dry, soft cloth to clean the body. If it is very dirty, use a cloth dampened with a small quantity of neutral detergent, then wipe dry.
- Avoid using volatile solvents such as thinners, alcohol, benzene, and insecticides. They may damage the surface finish and/or impair the operation of the camera.

#### Other

- When the BLC menu is set to an option other than OFF, “hunting” may occur, that is, the image may get darker and lighter as the camera “hunts” for the optimum exposure level. If hunting occurs, set the BLC menu to OFF.
- The focus may be less sharp under near infrared light than under visible light.
- The best camera performance may not be obtained under near infrared light due to the lens coating.

In the event of any problems with the operation of the camera, contact your Sony dealer.

### Location and Function of Part

#### Top/Front/Right Side

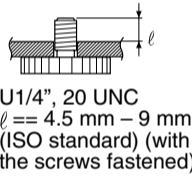
- 1 Lens mount**  
Use to mount an appropriate CS-mount lens.
- 2 Focal length adjustment screw**  
Use this screw to adjust the focal length (the distance between the lens mounting plane and the image plane).
- 3 Lens connector (4-pin socket)**  
Supplies power and control signals to an auto-iris lens (not supplied).
- 4 Tripod screws**  
The screw holes for attaching the tripod are located on both the top and bottom of the camera. Use a 1/4" UNC-20 screw to attach a tripod to the camera. The tripod must be set up on a flat surface and tightened firmly by hand.
- 5 MENU/ENTER button**  
Use for menu operation. Press this button to display the menu or confirm the settings.  
*For details of the use, see the supplied "Menu Operations" manual.*
- 6 ↑/↓/←/→ buttons**  
Use these buttons for menu operation. The ↑ and ↓ buttons move the cursor upward and downward. The ← and → buttons change the setting.  
*For details of the use, see the supplied "Menu Operations" manual.*

### CAUTION

Use the mounting screw whose length is 4.5 mm – 9 mm only. Use of other screws may cause improper mounting and damage parts inside the camera.

### Rear

- 7 Fall-prevention wire rope mounting screw hole**  
When installing the camera to a ceiling or wall, secure the supplied fall-prevention wire rope to this hole using the supplied screw.
- 8 Ground terminal (screw type)**  
If there are noises in the connections, connect this terminal to the ground.
- 9 DC 12 V/AC 24 V (power input) terminal (DC 12 V ±10% /AC 24 V ±10%) (SSC-DC693P/DC673P)**  
**Power inlet (AC 220 - 240 V, 50 Hz) (SSC-DC698P/DC678P)**
- 10 VIDEO OUT (composite video signal output) connector (BNC type)**
- 11 RS-485 TERM SSC-DC693P/DC698P**  
Use this selector to set the camera with RS-485 terminal ON or OFF.
- 12 I/O port (SSC-DC693P/DC698P)**

Signal	Description
RS-485 +	for future system expansion using an RS-485 connection
RS-485 –	for future system expansion using an RS-485 connection
Alarm In	When Alarm IN port connects the external signal equipment, the alarm is triggered by external signal. When trigger on, alarm indicator is shown on the screen and Alarm OUT terminal outputs a 5V signal.*
GND	connect with ground
Alarm Out	When Alarm IN is triggered, Alarm OUT terminal outputs a 5V signal. 5V is output between this terminal and COM when the color mode is selected; 0V is output when the B&W mode is selected.*
COM	common to pins

\* For details of the use, see the supplied “Menu Operations” manual.

(continued on the reverse side)

### 中文

### 特点

- SSC-DC693P/DC698P 与 SSC-DC673P/DC678P 彩色摄像机配备有 1/3 英寸传感器 DynaView™ 技术并具有以下特点：
- 采用 DynaView™ 技术的宽动态范围
  - 切换彩色／黑白模式的白天／夜间功能（SSC-DC693P/DC698P）
  - 自动白平衡寻迹和调节（ATW/ATW-PRO）
  - 与直流控制信号控制型自动光圈镜头兼容
  - 中央测光的逆光补偿
  - 交流电源同步的线路锁定功能（50 Hz）SSC-DC698P/DC678P

\* DynaView™ 是 Sony 公司的注册商标。

### 使用须知

#### 电源

- SSC-DC693P/DC673P 必须使用 24 V 交流电源或 12 V 直流电源。SSC-DC693P/DC673P 可自动检测电源。
  - 连接变压器时，请务必将各导线连接至适当的端子。错误的连接将导致摄像机发生故障和（或）损坏。
  - 请将装置接地，否则交流电源线可能会产生不规则的电压，从而可能会导致摄像机发生故障和（或）损坏。
- SSC-DC698P/DC678P 必须使用 220–240 V(50 Hz) 交流电源。

#### 操作

请小心不要溅水或溅洒其他液体在本机上，或使易燃物或金属物掉入机内。若在异物进入机内的状态下使用本机，摄像机可能会发生故障或因此发生火灾或触电。

#### 操作与存放场所

请避免长时间将摄像机对准强光物体（如阳光、照明光）。请避免在以下场所使用或存放本机。

- 极热或极冷（操作温度为 –10℃～+50℃）的地方
- 潮湿或多尘处
- 遭到雨淋的地方
- 有剧烈振动的地方
- 靠近强电磁辐射发射机（如无线电或电视信号发射机）的地方
- 易受到荧光灯照射的地方
- 照明条件不稳定（闪烁等）的地方

#### 保养

- 用气刷清除镜头或图像传感器表面的灰尘或污垢。
- 使用干燥、柔软的布擦拭机体。如果是顽垢，可先用布蘸少许中性洗涤剂擦拭，然后用布擦干。
- 避免使用诸如稀释剂、酒精、苯和杀虫剂之类的挥发性溶剂进行清洁。否则会破坏摄像机的表面涂层和（或）削弱其操作性能。

#### 其他

- 当 BLC 菜单处于“OFF”以外的其他位置时，可能出现“猎振”。这是因为摄像机“猎振”以设定最佳曝光等级而可能使图像变得忽明忽暗。遇此情况时，请将 BLC 菜单设定于“OFF”位置。
- 在近处的红外线条件下，聚焦可能不如在可见光条件下清晰。
- 因镜头涂层的原因，在近处的红外线条件下摄像机可能无法发挥其最佳性能。

有关在摄像机使用过程中出现的任何问题，请与您的 Sony 维修代理联系。

### 部件的位置和功能

#### 顶部／前面／右侧

##### 1 镜头接口

用于安装适当的 CS 型接口镜头。

##### 2 焦距调节螺丝

使用此螺丝调节焦距（透镜平面与成像面之间的距离）。

##### 3 镜头插口（4 针插座）

为自动光圈镜头（未附带）提供电源和控制信号。

##### 4 三脚架螺丝孔

摄像机的顶部和底部都有用于安装三脚架的螺丝孔。使用 1/4" UNC-20 螺丝将三脚架安装到摄像机上。三脚架必须放置在平坦的表面上，并用手拧紧。

##### 5 MENU/ENTER 键

用于菜单操作。按此键显示菜单或确认设定。

有关使用的详细说明，请参阅附带的“菜单操作”手册。

##### 6 ↑/↓/←/→ 键

使用这些键进行菜单操作。↑ 和 ↓ 键用于将光标上移和下移；← 和 → 键用于改变设定。

有关使用的详细说明，请参阅附带的“菜单操作”手册。

### 小心

只能使用长度为 4.5 mm – 9 mm 的安装螺丝。使用其它螺丝可能会造成不当安装，并可能损坏摄像机内部零件。

### 后面

##### 7 防掉落钢绳安装螺丝孔

当将摄像机安装到天花板或墙上时，请使用附带的螺丝将防掉落钢绳固定到此孔中。

##### 8 接地端子（螺丝型）

若在连接中有噪音，请将此端子接地。

##### 9 直流 12 V/交流 24 V（电源输入）端子（直流 12 V ±10%/交流 24 V ±10%）（SSC-DC693P/DC673P）

电源插座（交流 220–240 V，50 Hz）（SSC-DC698P/DC678P）

##### 10 VIDEO OUT（复合视频信号输出）连接器（BNC 型）

##### 11 RS-485 终端（SSC-DC693P/DC698P）

使用此开关设定使用 RS-485 终端电阻或不使用。

##### 12 I/O 接口（SSC-DC693P/698P）

信 号	说 明
RS-485+	用于将来采用 RS-485 连接方式进行系统扩展
RS-485—	用于将来采用 RS-485 连接方式进行系统扩展
Alarm In	当 Alarm IN 端口连接外部信号设备时，警报由外部信号触发。当触发开启时，屏幕上显示警报指示，且 Alarm OUT 终端输出 5V 信号。*
GND	接地
Alarm Out	当触发 Alarm IN 时，Alarm OUT 终端将输出 5V 信号。当选择彩色模式时，在此终端和 COM 之间输出 5V；当选择黑白模式时，输出 0V。*
COM	共用引脚

\* 有关使用的详细说明，请参见附带的“菜单操作”手册。

（接背面）

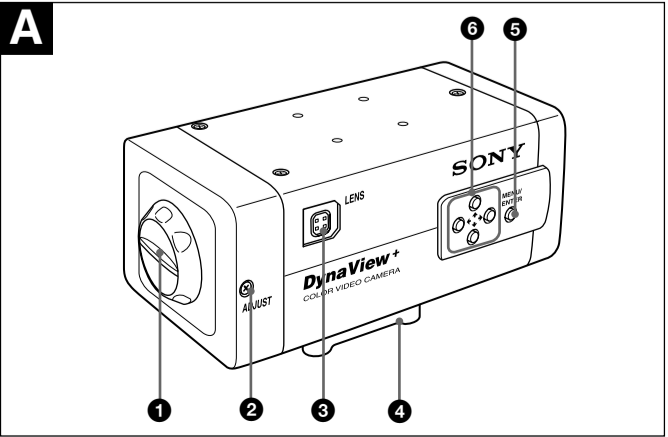

B

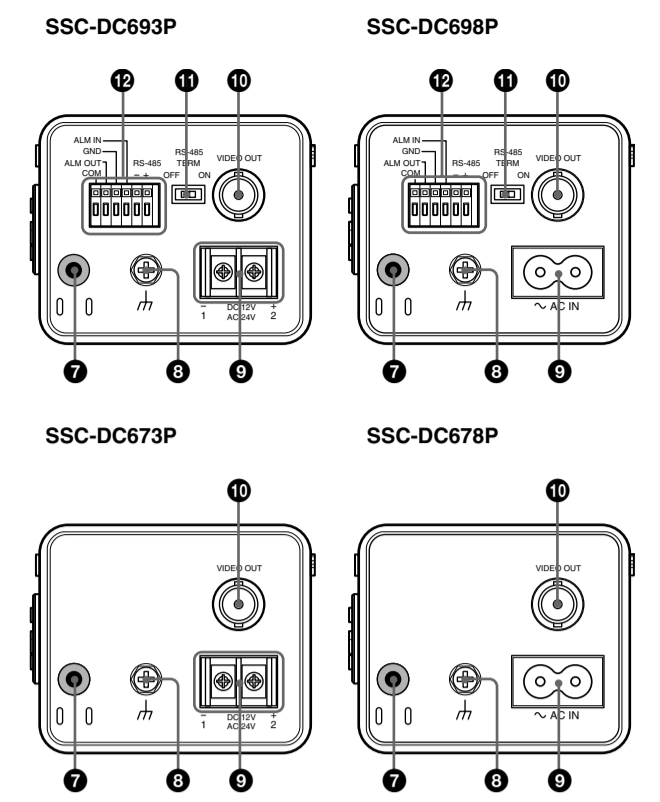

C

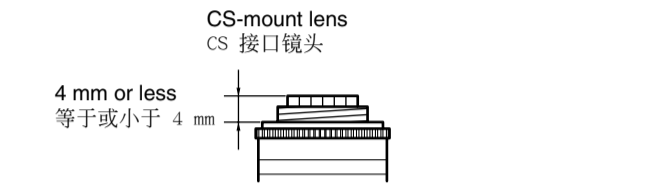

D

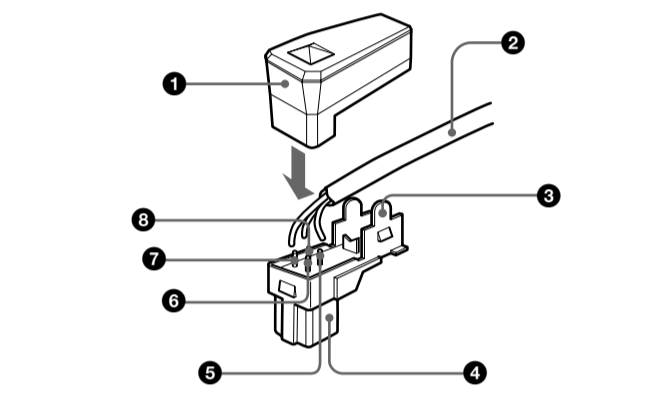

E

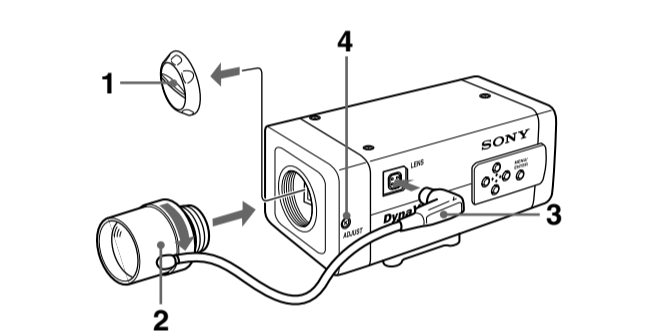

F

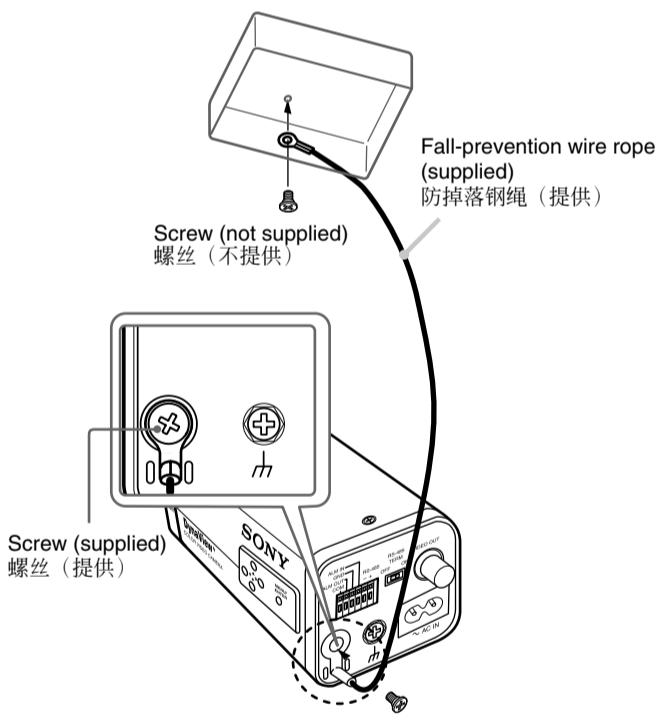

G

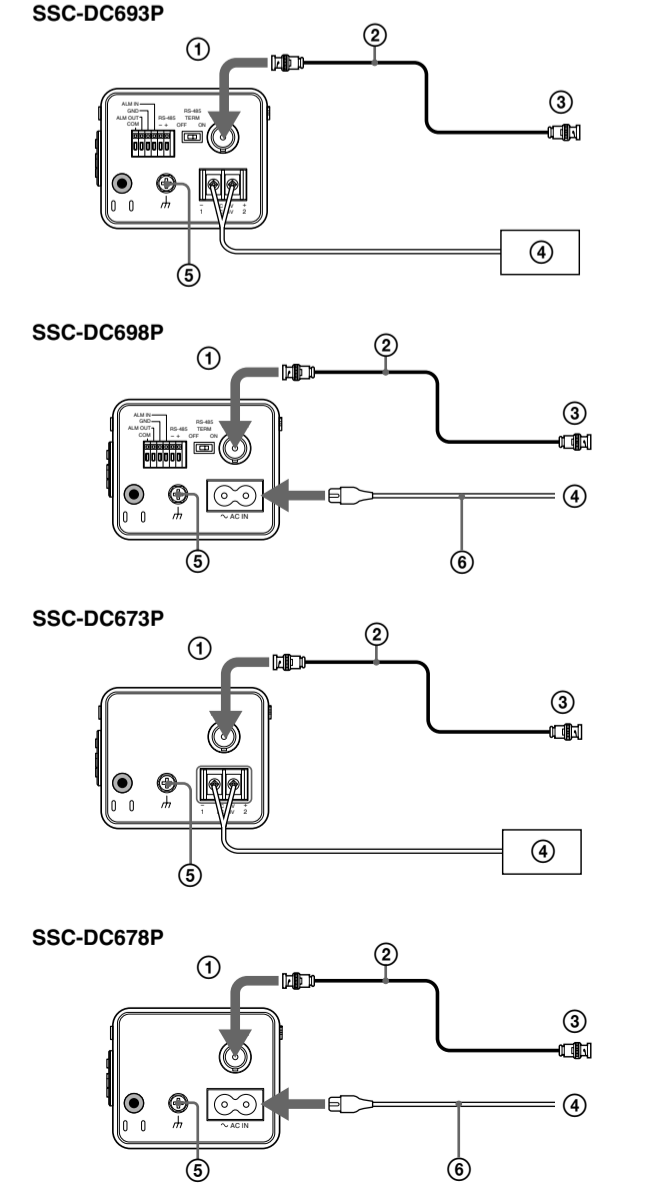

Installation

Suitable lens C

The lens must be a CS-mount type of less than 1 kg. The protrusion behind the mounting surface must be 4 mm or less.

Changing the plug on an auto-iris lens cable D

To connect an auto-iris lens, first replace the plug on the lens cable with a plug that fits the LENS connector (not supplied).

- 1 Detach the old plug from the lens cable.
- 2 Solder the wires of the lens cable to the pins of the plug. (For cable pin assignment, refer to the instruction manual for the lens.)

1	Cover		
2	Lens cable		
3	Rib (If the cable is thick, cut this off.)		
4	Plug (not supplied)		
5	Pin 4	DC control	Drive - (Ground)
6	Pin 2	DC control	Control +
7	Pin 1	DC control	Control -
8	Pin 3	DC control	Drive +

Fitting the lens E

- 1 Unscrew the lens mount cap.
- 2 Screw in the lens, and turn it until it is secured.
- 3 Insert the lens plug into the LENS connector. When fitting a manual-iris lens, omit step 3.
- 4 Adjust the focal length by turning the adjustment screw.

**CAUTION**  
Keep the lens mount cap on the camera when not attaching a lens.

Installing the camera

**ATTENTION**  
If installing the camera on the ceiling, be sure it is secure. If not securely installed, the camera may fall and injury may occur.  
If the camera is installed on the ceiling using equipment such as a bracket, housing and motored swivel base (pan/tilt), do the following:  
• Use tripod screws and securely tighten them with a driver. Order the tripod screws (Sony Part No. 3-174-693-02) from your nearest Sony dealer.  
• Install the tripod adapter on a flat surface.

Attaching the fall-prevention wire rope F

When you install the camera on a ceiling or a high position, be sure to attach the supplied fall-prevention wire rope to prevent the camera from falling. Attach the fall-prevention wire rope to the screw hole on the rear of the camera, as in the illustration.

**Note**  
Take care not to short-circuit the power terminal or the cable with the wire rope when you attach it.

- 1 Secure the wire rope to the junction box on the ceiling. Use a screw to match the screw hole of your junction box (not supplied).
- 2 Secure the wire rope to the wire rope mounting screw hole on the rear of the camera using the supplied screw.

**CAUTION**  
Use the supplied screws for installation. If not, the wire rope may not function properly.

Connecting the Camera G

**Using an internal synchronization signal**  
① Connect to the VIDEO OUT connector.  
② 75-ohm coaxial cable  
③ Connect to the VIDEO IN connector on a video monitor, etc.  
④ To power supply (DC 12 V or AC 24 V) (SSC-DC693P/DC673P) / to a wall outlet (AC 220 ~ 240 V) (SSC-DC698P/DC678P)  
⑤ GND (ground) terminal  
⑥ Power cable (SSC-DC698P/DC678P)  
Connect the power cable after connecting the auto-iris lens, video output, and external synchronization input connector.

**Using an external synchronization signal**  
When using an external (L.L) synchronization signal, see the supplied "Menu Operations" manual.

Phase Adjustment

If the picture may roll vertically, adjust the vertical phase using V PHASE in the OTHERS-SYNC-LL menu.  
For operating the menu, see the supplied "Menu Operations" manual.

Image Sensor Characteristics

The following conditions may be observed when using this camera. They are not due to any fault within the camera.

**Patterned noise:** This is a fixed pattern that may appear over the entire monitor screen when the camera is operated at high temperatures.  
**Jagged picture:** When viewing stripes, straight lines, or similar patterns, the image on the screen may appear jagged.

Specifications

Image device	1/3 inch image sensor DynaView™ technology
Effective picture elements	720 (horizontal) × 540 (vertical)
Lens mount	CS-mount
Signal system	PAL color system
Synchronization system	Internal/line lock
Horizontal resolution	520 TV lines (Typical) * 540 TV lines (Equivalent) **
Minimum illumination	SSC-DC673P/DC678P: 1.4 lux F1.2 (50 IRE with AGC set to HIGH, color) 0.7 lux F1.2 (30 IRE with AGC set to HIGH, color) 0.2 lux F1.2 (30 IRE with AGC set to HIGH, color, slow shutter × 2) SSC-DC693P/DC698P: 2.1 lux F1.2 (50 IRE with AGC set to HIGH, color) 0.9 lux F1.2 (30 IRE with AGC set to HIGH, color) 0.4 lux F1.2 (30 IRE with AGC set to HIGH, color, slow shutter × 2) 0.05 lux F1.2 (50 IRE with AGC set to HIGH, B&W) 0.02 lux F1.2 (30 IRE with AGC set to HIGH, B&W) 0.01 lux F1.2 (30 IRE with AGC set to HIGH, B&W, slow shutter × 2)
Video output	1 Vp-p, 75 ohms, negative sync
Video S/N	>50 dB (with AGC set to OFF)
Dynamic range	LOW/MID/HIGH
SLOW SHUTTER	OFF/×2/×4/×8/×16/×32
White balance	ATW-PRO/ATW/MANUAL
Automatic gain control	LOW/MID/HIGH/MANUAL
Power requirements	SSC-DC673P/SSC-DC693P: AC 24 V (50 Hz) / DC 12 V SSC-DC678P/SSC-DC698P: AC 220 ~ 240 V (50 Hz) SSC-DC673P: 5.0 W      SSC-DC693P: 8.0 W SSC-DC678P: 5.0 W      SSC-DC698P: 8.0 W
Operating temperature	–10 °C to +50 °C (14 °F to 122 °F)
Operating humidity	20 to 80%
Storage temperature	–20 °C to +60 °C (–4 °F to 140 °F)
Storage humidity	20 to 95%
Mass	Approx 420g
Dimensions	56 × 68.8 × 131 mm (w/h/d)
Supplied accessories	Lens mount cap (1) Power cable (1) (SSC-DC678P/SSC-DC698P only) Menu operations (1) Operating Instructions (1) Fall-prevention wire rope (1) Screw M4 (1)

Design and specifications are subject to change without notice.  
\* Sony standard measurement  
\*\* Progressive imager equivalent 540H.TVL (i.L) cameras

**Note**  
Always verify that the unit is operating properly before use. SONY WILL NOT BE LIABLE FOR DAMAGES OF ANY KIND INCLUDING, BUT NOT LIMITED TO, COMPENSATION OR REIMBURSEMENT ON ACCOUNT OF THE LOSS OF PRESENT OR PROSPECTIVE PROFITS DUE TO FAILURE OF THIS UNIT, EITHER DURING THE WARRANTY PERIOD OR AFTER EXPIRATION OF THE WARRANTY, OR FOR ANY OTHER REASON WHATSOEVER.

**Regular parts replacement**  
Some of the parts that make up this product (electrolytic condenser, for example) need replacing regularly depending on their life expectancies. The lives of parts differ according to the environment or condition in which this product is used and the length of time it is used, so we recommend regular checks.  
Consult the dealer from whom you bought it for details.

安装

合适的镜头 C

镜头必须是重量低于 1 kg 的 CS 接口型。接口面后方的突起部分必须等于或小于 4 mm。

改变自动光圈镜头电缆上的插头 D

要连接自动光圈镜头时，先用符合 LENS 插座的插头（未附带）更换镜头电缆上的插头。

- 1 从镜头电缆上拆下旧插头。
- 2 将镜头电缆的金属线焊接在插头引脚上（有关电缆针配置的说明，请参阅镜头的使用说明书）。

1	镜头盖		
2	镜头电缆		
3	肋条（若电缆较薄，请将它切除）		
4	插头（未附带）		
5	针 4	直流控制	驱动－（接地）
6	针 2	直流控制	控制＋
7	针 1	直流控制	控制－
8	针 3	直流控制	驱动＋

安装镜头 E

- 1 卸下镜头接口盖。
- 2 旋进镜头并拧紧，直至牢固。
- 3 将镜头插头插入 LENS 插座。安装手动光圈镜头时可省略步骤 3。
- 4 转动调节螺丝调节焦距。

**警告**  
不安装镜头时，请勿从摄像机上取下镜头接口盖。

安装摄像机

**小心**  
若将摄像机安装在天花板上，务请悬挂牢实，否则摄像机可能会落下造成伤害。若用悬架、机架和联动旋转底座（盘/架）等装置将摄像机安装在天花板上，请进行以下操作：  
• 使用三脚架螺丝并用起子拧紧它们。请向附近的 Sony 经销店订购三脚架螺丝（Sony 零部件号：3-174-693-02）。  
• 请在平坦处安装三脚架连接器。

安装防掉落钢绳 F

如果将摄像机安装到天花板或较高的位置，则必须连接防掉的防掉落钢绳，以防止摄像机掉落。  
如图所示，将防掉落钢绳连接至摄像机背后的螺丝孔。

**注**  
连接钢绳时请小心，切勿将电源端子或电缆与钢绳短路。

- 1 将钢绳固定到天花板上的接线盒内。请使用符合接线盒（不附带）螺丝孔的螺丝。
- 2 使用附带的螺丝将钢绳固定到摄像机背面的钢绳安装螺丝孔中。

**小心**  
请使用附带的螺丝进行安装。否则，钢绳可能无法正确起作用。

连接摄像机 G

**使用内部同步信号**  
① 连接至 VIDEO OUT 插座。  
② 75 Ω 同轴电缆  
③ 连接至视频监视器等上的 VIDEO IN 插座。  
④ 至电源（直流 12 V 或交流 24 V）（SSC-DC693P/DC673P）／至墙上电源插座（交流 220~240 V）（SSC-DC698P/DC678P）  
⑤ GND（接地）端子  
⑥ 电源线（SSC-DC698P/DC678P）  
在连接自动光圈镜头、视频输出和外部同步输入插座后连接电源线。

**使用外部同步信号**  
使用外部（L.L）同步信号时，请参阅附带的“菜单操作”手册。

相位调节

若图像垂直滚动，则请用 OTHERS-SYNC-LL 菜单中的 V PHASE 调节垂直相位。  
有关操作菜单的说明，请参阅附带的“菜单操作”手册。

图像传感器特性

使用本摄像机时可能会出现下列情况，这不属于本机的故障。

**固定图像杂波：**当摄像机在高温环境中操作时，整个监视器屏幕上会出现固定图案杂波。  
**锯齿状图像：**在摄制带状物体、直线或类似图案时，屏幕上的图像可能会呈锯齿状。

规格

成像器件	1/3 英寸传感器 DynaView™ 技术
有效像素	720（水平）× 540（垂直）
镜头安装	CS 型接口
信号制式	PAL 彩色制式
同步系统	内部/线路锁定
水平分辨率	520 电视线（标准）** 540 电视线（加强） SSC-DC673P/DC678P: 1.4 lux, F1.2 (50 IRE, 在 AGC 设定为 HIGH 时, 彩色) 0.7 lux , F1.2 (30 IRE, 在 AGC 设定为 HIGH 时, 彩色) 0.2 lux , F1.2 (30 IRE, 在 AGC 设定为 HIGH 时, 彩色, slow shutter × 2) SSC-DC693P/DC698P: 2.1 lux , F1.2 (50 IRE, 在 AGC 设定为 HIGH 时, 彩色) 0.9 lux , F1.2 (30 IRE, 在 AGC 设定为 HIGH 时, 彩色) 0.4 lux , F1.2 (30 IRE, 在 AGC 设定为 HIGH 时, 彩色, slow shutter × 2) 0.05 lux , F1.2 (50 IRE, 在 AGC 设定为 HIGH 时, 黑白) 0.02 lux , F1.2 (30 IRE, 在 AGC 设定为 HIGH 时, 黑白) 0.01 lux , F1.2 (30 IRE, 在 AGC 设定为 HIGH 时, 黑白, slow shutter × 2)
最低照度	1 Vp-p, 75 Ω, 负同步 >50 dB (AGC 设定于 OFF 时) LOW/MID/HIGH OFF/×2/×4/×8/×16/×32 ATW-PRO/ATW/MANUAL LOW/MID/HIGH/MANUAL SSC-DC673P/SSC-DC693P: 24 V 交流电源 (50 Hz) / 12 V 直流电源 SSC-DC678P/SSC-DC698P: 220~240 V 交流电源 (50 Hz) SSC-DC673P: 5.0 W      SSC-DC693P: 8.0 W SSC-DC678P: 5.0 W      SSC-DC698P: 8.0 W –10°C 至 +50°C 20 至 80% –20°C 至 +60°C 20 至 95% 约 420 g 56 × 68.8 × 131 mm 镜头接口盖 (1) 电源线 (1)（仅限于 SSC-DC678P/SSC-DC698P） 菜单操作 (1) 使用手册 (1) 防掉落钢绳 (1) M4 螺丝 (1)
视频输出	1 Vp-p, 75 Ω, 负同步
视频 S/N	>50 dB (AGC 设定于 OFF 时)
动态范围	LOW/MID/HIGH
慢速快门	OFF/×2/×4/×8/×16/×32
白平衡	ATW-PRO/ATW/MANUAL
自动增益控制	LOW/MID/HIGH/MANUAL
电源要求	SSC-DC673P/SSC-DC693P: 24 V 交流电源 (50 Hz) / 12 V 直流电源 SSC-DC678P/SSC-DC698P: 220~240 V 交流电源 (50 Hz) SSC-DC673P: 5.0 W      SSC-DC693P: 8.0 W SSC-DC678P: 5.0 W      SSC-DC698P: 8.0 W –10°C 至 +50°C 20 至 80% –20°C 至 +60°C 20 至 95% 约 420 g 56 × 68.8 × 131 mm 镜头接口盖 (1) 电源线 (1)（仅限于 SSC-DC678P/SSC-DC698P） 菜单操作 (1) 使用手册 (1) 防掉落钢绳 (1) M4 螺丝 (1)
功率消耗	SSC-DC673P: 5.0 W      SSC-DC693P: 8.0 W SSC-DC678P: 5.0 W      SSC-DC698P: 8.0 W
操作温度	–10°C 至 +50°C
操作湿度	20 至 80%
储藏温度	–20°C 至 +60°C
储藏湿度	20 至 95%
质量	约 420 g
体积（宽/高/深）	56 × 68.8 × 131 mm
附件	镜头接口盖 (1) 电源线 (1)（仅限于 SSC-DC678P/SSC-DC698P） 菜单操作 (1) 使用手册 (1) 防掉落钢绳 (1) M4 螺丝 (1)

设计和规格若有变更，恕不另行通知。

\* Sony 标准法  
\*\* 加强型传感器，相当于 540 线隔行相机

**注**  
在使用前请始终确认本机运行正常。无论保修期内外或基于任何理由，SONY 对任何损坏（包括但不限于）概不负责。由于本机故障造成的现有损失或预期利润损失，不进行退货或赔偿。

定期零件更换

本产品中采用的部分零件（例如电解质电容器）需要根据其平均寿命定期进行更换。  
零件的寿命随本产品的使用环境或条件以及使用时间而异，建议您定期进行检查。  
详细信息请向您购买本产品的经销商咨询。

产品中有毒有害物质或元素的名称及含量

使用环境条件：参考使用手册中的操作条件

部件名称	有毒有害物质或元素					
	铅 (Pb)	汞 (Hg)	镉 (Cd)	六价铬 (Cr (VI))	多溴联苯 (PBB)	多溴二苯醚 (PBDE)
实装基板	×	○	○	○	○	○
外壳	×	○	○	○	○	○
光学组件	×	○	○	○	○	○
附属品	×	○	○	○	○	○

○：表示该有毒有害物质在该部件所有均质材料中的含量均在 SJ/T11363-2006 标准规定的限量要求以下。  
×：表示该有毒有害物质至少在该部件的某一均质材料中的含量超出 SJ/T11363-2006 标准规定的限量要求。

制 造 商：索尼（中国）有限公司  
地 址：北京市朝阳区东三环北路霞光里18号佳程大厦A座25层  
产 地：江苏省  
企业标准编号：Q/CYSNC008