

SHARP®

ELECTRONIC CALCULATOR

电子计算器

ELSI MATE

EL-244T

OPERATION MANUAL

操作手册

SHARP CORPORATION

PRINTED IN CHINA / 中国印刷
09BT(TINSZ1470EHZZ)
0GS9216170////

ENGLISH

BEFORE USE

- Do not press too hard against the LCD panel because it contains glass.
- Never dispose of the battery in a fire.
- Keep battery out of reach of children.
- Please press ^{ON} **[C/C]** if you see no indication.
- This product, including accessories, may change due to upgrading without prior notice.
- Since this product is not waterproof, do not use it or store it where fluids, for example water, can splash onto it. Raindrops, water spray, juice, coffee, steam, perspiration, etc. will also cause malfunction.

SPECIFICATIONS

Type:	Electronic calculator
Operating capacity:	8 digits
Power supply:	Built-in solar cell and lithium battery (3V ... (DC) CR2016 × 1)
Automatic Power-off:	Approx. 7 min.
Operating temperature:	0°C - 40°C (32°F-104°F)
Dimensions:	60 mm (W) × 105 mm (D) × 8.4 mm (H) 2-3/8" (W) × 4-1/8" (D) × 11/32" (H)
Weight:	Approx. 42 g (0.09 lb.) (battery included)
Accessories:	Lithium battery (installed), Operation manual

SHARP will not be liable nor responsible for any incidental or consequential economic or property damage caused by misuse and/or malfunctions of this product and its peripherals, unless such liability is acknowledged by law.

中文

使用之前

- LCD 面板内含玻璃，所以请不要用力挤压 LCD。
- 请绝对不要将电池投入火中。
- 请将电池放置在小孩所能接触范围之外。
- 如果没有任何显示，请按 ^{ON} **[C/C]**。
- 本产品及其附件会因升级而变化，恕不提前通知。
- 因为产品不防水，请不要在液体（如水）能溅到的地方使用或保存。雨滴、喷水、果汁、咖啡、蒸汽、汗水等也会造成产品故障。

规格

类型:	电子计算器
计算能力:	8 位数字
电源:	内置太阳能电池和锂电池 (3V ... (DC) CR2016 × 1)
自动关机:	约 7 分钟
工作温度:	0°C - 40°C (32°F-104°F)
尺寸:	60 mm (W) × 105 mm (D) × 8.4 mm (H) 2-3/8" (W) × 4-1/8" (D) × 11/32" (H)
重量:	约 42 g (0.09 lb.) (包括电池)
附件:	锂电池 (已安装), 操作手册

夏普对本产品和其外设因误用和（或）故障而导致的附带或间接经济或财产损坏不承担义务或责任，除非法律规定有此义务。

BATTERY REPLACEMENT

电池更换

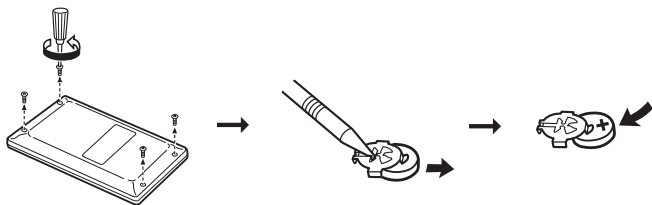

For USA only:

This product contains a CR Coin Lithium Battery which contains Perchlorate Material – special handling may apply, California residents, See www.dtsc.ca.gov/hazardouswaste/perchlorate/

OPERATIONS

操作

1. Press **[C-CE]** twice to clear any residual values and calculation instructions in the calculator.
2. Before starting memory calculations, press **[R-CM]** twice to clear the memory contents.
3. For expressing calculation examples, only the symbols that are required for explanation are mentioned.
4. Example procedures are listed in following manner unless otherwise specified.

(1) Example	(2) Key operations	(3) Display
1. 按 [C-CE] 两次清除计算器内任何数值和计算指令。		
2. 如果开始记忆计算，请按 [R-CM] 两次清除内存信息。		
3. <u>对于表达式计算示例，只有对需要解释的符号才会说明。</u>		
4. 示例步骤按如下方式列举，除非另有说明。		
(1) 示例	(2) 关键运算	(3) 显示

◆ HOW TO PERFORM BASIC CALCULATIONS

如何执行基本计算

- When [=], [%], [M+], or [M-] is pressed, the “=” symbol appears on the display. (This symbol is not shown in the calculation examples.)
- 当按下 [=], [%], [M+], 或 [M-] 时, “=” 符号会显示在显示屏上。(该符号不出现在计算示例中。)

(1)	(2)	(3)
	[C-CE] [C-CE]	0.
$(-24+2) \div 4 = -5.5$	$-24 [+] 2 \div 4 [=]$	-5.5
$34+57=91$	$34 [+] 57 [=]$	91.
$45+57=102$	$45 [=]$	102.
$38-26=12$	$38 [-] 26 [=]$	12.
$35-26=9$	$35 [=]$	9.
$68 \times 25 = 1700$	$68 [X] 25 [=]$	1'700.
$68 \times 40 = 2720$	$40 [=]$	2'720.
$35 \div 14 = 2.5$	$35 [\div] 14 [=]$	2.5
$98 \div 14 = 7$	$98 [=]$	7.
$200 \times 10\% = 20$	$200 [X] 10 [%]$	20.
$(9 \div 36) \times 100 = 25$	$9 [\div] 36 [%]$	25.
$200 + (200 \times 10\%) = 220$	$200 [+] 10 [%]$	220.
$4^5 = (4^3)^2 = 4096$	$4 [X] [=] [=] [X] [=]$	4'096.
$1/8 = 0.125$	$8 [\div] [=]$	0.125
$25 \times 5 = 125$ $-) 84 \div 3 = 28$ $+) 68 + 17 = 85$ 182	[R-CM] [R-CM] $25 [X] 5 [M+]$ $84 [\div] 3 [M-]$ $68 [+] 17 [M+]$ [R-CM] [R-CM]	M 125. M 28. M 85. M 182. 182.
$2+3 \rightarrow 2+4=6$	$2 [+] 3 [C-CE] 4 [=]$	6.
$5 \times 2 \rightarrow 5 \div 2 = 2.5$	$5 [X] [\div] 2 [=]$	2.5
$98765432 \div 0.444$ $\times 555$ $= 1234.5678 \times 10^8$	$98765432 [\div] 0.444 [X]$ [C-CE] $555 [=]$ $(1234.5678 \times 10^8 = 123456780000)$	E 2.2244466 1'234.5678

◆ CALCULATING TAX / 计算税率

- To perform a tax calculation, first it is absolutely necessary to set and check the tax rate. (The initial tax rate is 0.)
A tax rate can be set (or changed) with a number containing up to four digits. (Decimal point is not regarded as a digit.)
The set tax rate is retained until it is changed. However, the set tax rate may be changed or lost if the battery is consumed largely.
- 要执行税率计算, 首先当然需要设置和检查税率。(初始税率设置为 0)。
税率可以使用最多 4 位数字设置 (或更改)。(小数点不作为数字。)
设置的税率会一直保留到下次更改。但是, 如果电池基本耗尽, 设置税率也会更改或丢失。

- (1) • Confirming the tax rate. (0%)
• 确认税率。(0%)

(2)	(3)
[C-CE] [C-CE] RATE RECALL [TAX]	[RATE TAX] <div>0.</div>

- (1) • Set a 5% tax rate. Calculate the tax on \$800 and calculate the total including tax.
- 设置 5% 税率。对 \$800 计算税率，计算连税值。

(2)	(3)
<input type="button" value="C-CE"/> <input type="button" value="C-CE"/>	0.
RATE SET <input type="button" value="+TAX"/> 5	<input type="button" value="RATE"/> TAX = 5.
<input type="button" value="C-CE"/> <input type="button" value="C-CE"/> 800	800.
<input type="button" value="+TAX"/>	*TAX 840.
<input type="button" value="+TAX"/>	TAX 40.
<input type="button" value="+TAX"/>	

- (1) • Perform two calculations using \$84 and \$52.5, both of which already include tax. (tax rate: 5%) Calculate the tax on the total and the total without tax.
- 对 \$84 和 \$52.5 执行计算，两者均已含税。（税率：5%）计算税费总额和去税总额。

(2)	(3)
<input type="button" value="C-CE"/> <input type="button" value="C-CE"/> 84 <input type="button" value="+"/> 52.5 <input type="button" value="="/>	= 136.5
<input type="button" value="-TAX"/>	-TAX 130.
<input type="button" value="-TAX"/>	TAX 6.5
<input type="button" value="-TAX"/>	

产品中有毒有害物质或元素的名称及含量

部件名称	有毒有害物质或元素					
	铅 (Pb)	汞 (Hg)	镉 (Cd)	六价铬 (Cr(VI))	多溴联苯 (PBB)	多溴二苯醚 (PBDE)
印刷电路板	○	○	○	○	○	○
显示器	○	○	○	○	○	○
箱体、底盘	○	○	○	○	○	○
电源	○	○	○	○	○	○
键盘	○	○	○	○	○	○
配件(电缆等)	○	○	○	○	○	○
<p>○：表示该有毒有害物质在该部件所有均质材料中的含量均在SJ/T 11363-2006标准规定的限量要求以下。</p> <p>×：表示该有毒有害物质至少在该部件的某一均质材料中的含量超出SJ/T 11363-2006标准规定的限量要求。</p>						