

IMPORTANT SAFETY INSTRUCTIONS READ AND FOLLOW ALL INSTRUCTIONS SAVE THESE INSTRUCTIONS

⚠ WARNING

IMPROPER INSTALLATION OR USE OF THIS PRODUCT MAY PRESENT A RISK OF HAIR OR BODY ENTRAPMENT AND DROWNING. Install this equipment in accordance with the instructions provided. Use only with the components and mounting hardware provided. FAILURE TO FOLLOW THESE INSTRUCTIONS AND/OR USE WITH COMPONENTS NOT PROVIDED BY PENTAIR POOL PRODUCTS AND INTENDED TO BE USED WITH THIS PRODUCT MAY RESULT IN IMPROPER POSITIONING OR FUNCTIONING OF DRAIN COVER AND MAY CAUSE SEVERE PERSONAL INJURY OR DEATH.

HOW DOES YOUR MAIN DRAIN WORK

The Geyser Drain simultaneously supplies filtered water to the pool and returns unfiltered pool water from the pool to the filter. If installed correctly in accordance with these provided instructions, Geyser Drain will minimize the body entrapment potential, improve chemical agitation, and improve heating and filtration process.

INSTALLATION

Installation must comply with the latest applicable local codes and standards. Refer to National Spa and Pool Institute standards ANSI/NSPI 1 through 6, Uniform Swimming Pool Spa and Hot Tub Code™ and the US Consumer Product Safety Commission Guidelines for Entrapment Hazards Pub No. 363-009801.

NOTE

The Geyser Drain creates a radial flow pattern on the pool surface directly above it, as shown in Figure 2. Locate your skimmer and returns to optimize the skimming effect.

⚠ WARNING

This Geyser Drain must be installed and plumbed as instructed. Connecting both lines as suction (outlet) or reversing the inlet and outlet can result in hair or body entrapment, which can cause severe personal injury or death. If in doubt about installation of your system, call Pentair Pool Products at (800) 831-7133.

PLUMBING

The inlet port (side port) must be connected to the filter line supplying filtered water to the swimming pool. The outlet port (bottom port) must be connected to the pump suction returning unfiltered pool water to the filter; see Figure 1 for installation layout.

⚠ WARNING

Maximum suction flow rate, water removed from Main Drain shall NOT exceed **85 GPM**. Size your suction lines (skimmers, drains) and returns so that water removed from the Main Drain through the outlet port (bottom port) is equal or less than water supplied through the inlet port (side port). Do NOT add a valve to inlet line of the Main Drain. Failure to do so can result in hair or body entrapment, which can cause severe personal injury or death. If in doubt about installation of your system, call Pentair Pool Products at (800) 831-7133.

⚠ WARNING

Never use a pool or spa that has a missing or broken drain cover. Using a pool or spa with a missing or broken drain cover can result in hair or body entrapment, which can cause severe bodily injury or death.

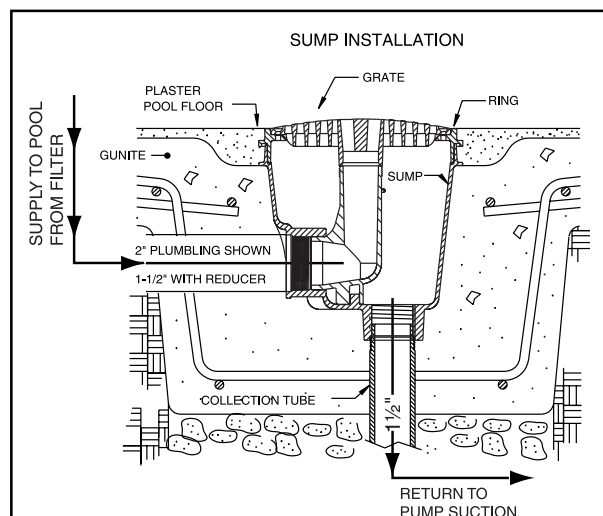

Figure 1.

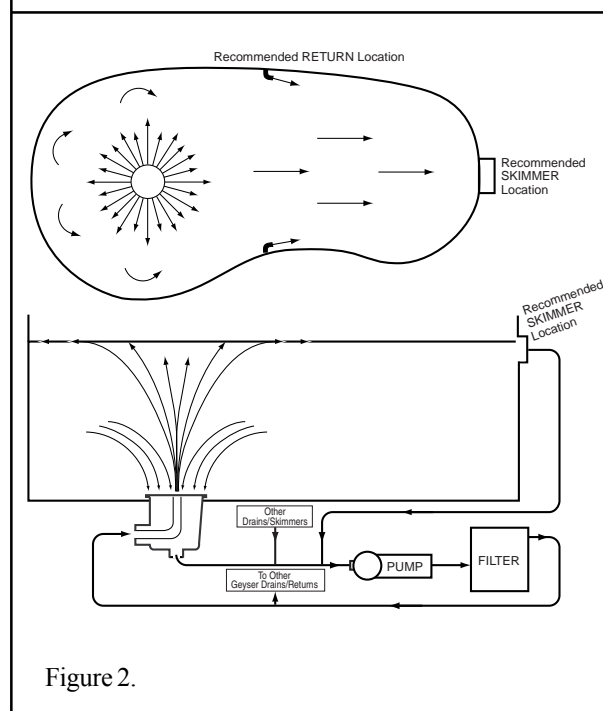
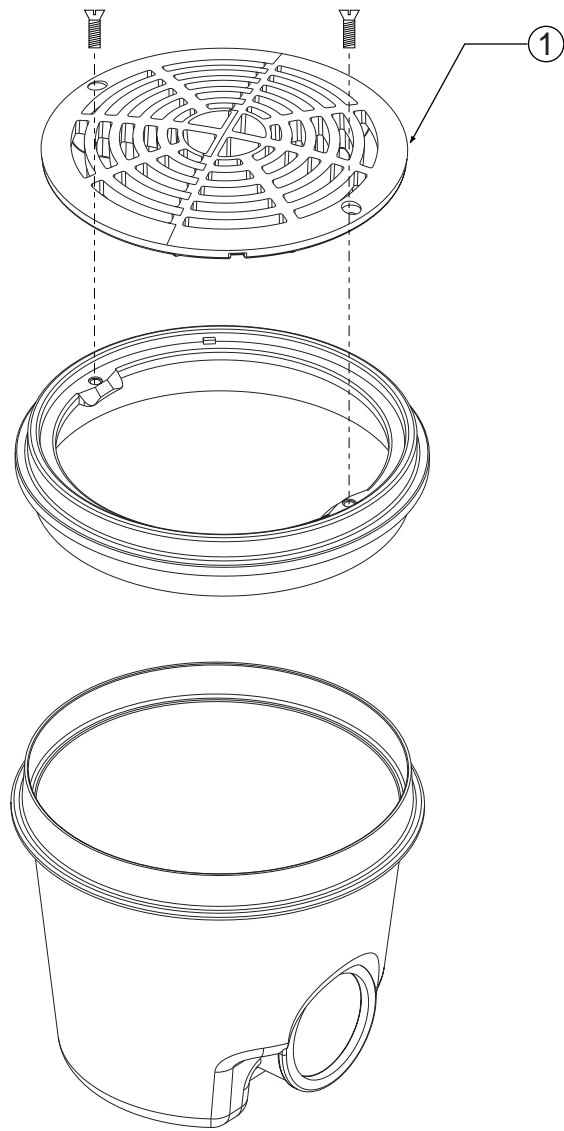

Figure 2.

REPLACEMENT PARTS



GEYSER MAIN DRAIN - P/N 500019

Item No.	Part No.	Description	Qty.
1	543112	Grate Replacement Kit	1
Kit includes: Grate, Screws, and Instruction Manual			

SAVE THESE INSTRUCTIONS.

Pentair Pool Products
1620 Hawkins Ave., Sanford, NC 27330 • (919) 774-4151
10951 West Los Angeles Ave., CA 93021 • (805) 523-2400

