

Panasonic®

Operating Instructions Manual de instrucciones

42" High Definition Hospitality Plasma Display Pantalla de plasma de alta definición de 42" para la industria hotelera

Model No. **TH-42PRT12U**
Número de modelo



HDMI™
HIGH-DEFINITION MULTIMEDIA INTERFACE

The illustration shown is an image.
Before connecting, operating or adjusting this product, please read these instructions completely.
Please keep this manual for future reference.

La ilustración mostrada es una imagen.
Antes de conectar, utilizar o ajustar este producto, lea completamente este manual de instrucciones;
y guárdelo para consultarlo en el futuro en caso de ser necesario.

English

Español



The lightning flash with arrow-head within a triangle is intended to tell the user that parts inside the product are a risk of electric shock to persons.



The exclamation point within a triangle is intended to tell the user that important operating and servicing instructions are in the papers with the appliance.

WARNING : To prevent damage which may result in fire or shock hazard, do not expose this apparatus to rain or moisture.
Do not place containers with water (flower vase, cups, cosmetics, etc.) above the set.
(including on shelves above, etc.)

WARNING : 1) To prevent electric shock, do not remove cover. No user serviceable parts inside. Refer servicing to qualified service personnel.
2) Do not remove the grounding pin on the power plug. This apparatus is equipped with a three pin grounding-type power plug. This plug will only fit a grounding-type power outlet. This is a safety feature. If you are unable to insert the plug into the outlet, contact an electrician.
Do not defeat the purpose of the grounding plug.

This video monitor is designed to display television content from a separate TV tuner. Full-power analog TV broadcasting in the United States will end (as required by law) on February 17, 2009, after which full-power TV broadcasts will be digital only. If this device is used after that date to record or display programming from a product with a TV tuner that relies on a TV antenna, that product would need to contain a digital tuner, or a TV Converter would be necessary to tune the digital signal received with a TV antenna. Analog TVs should continue to work as before for other purposes (e.g., for watching low-power TV stations still broadcasting in analog, watching pre-recorded movies, or playing video games). When a Converter is used with an older television receiver or directly with this product, a signal splitter might be necessary to continue to receive low-power analog broadcasts via an antenna. For more information, please see www.DTV.gov or 1-888-CALL-FCC. For information on the TV Converter program, and on government coupons that may be used toward the purchase of one, see www.dtv2009.gov, or call the NTIA at 1-888-DTV-2009. Please check with your cable or satellite service provider if you have questions about your cable or satellite set-top box.

Important Safety Instructions

- 1) Read these instructions.
- 2) Keep these instructions.
- 3) Heed all warnings.
- 4) Follow all instructions.
- 5) Do not use this apparatus near water.
- 6) Clean only with dry cloth.
- 7) Do not block any ventilation openings. Install in accordance with the manufacturer's instructions.
- 8) Do not install near any heat sources such as radiators, heat registers, stoves, or other apparatus (including amplifiers) that produce heat.
- 9) Do not defeat the safety purpose of the polarized or grounding-type plug. A polarized plug has two blades with one wider than the other. A grounding type plug has two blades and a third grounding prong. The wide blade or the third prong are provided for your safety. If the provided plug does not fit into your outlet, consult an electrician for replacement of the obsolete outlet.
- 10) Protect the power cord from being walked on or pinched particularly at plugs, convenience receptacles, and the point where they exit from the apparatus.
- 11) Only use attachments / accessories specified by the manufacturer.
- 12) Use only with the cart, stand, tripod, bracket, or table specified by the manufacturer, or sold with the apparatus. When a cart is used, use caution when moving the cart / apparatus combination to avoid injury from tip-over.
- 13) Unplug this apparatus during lightning storms or when unused for long periods of time.
- 14) Refer all servicing to qualified service personnel. Servicing is required when the apparatus has been damaged in any way, such as power-supply cord or plug is damaged, liquid has been spilled or objects have fallen into the apparatus, the apparatus has been exposed to rain or moisture, does not operate normally, or has been dropped.
- 15) To prevent electric shock, ensure the grounding pin on the AC cord power plug is securely connected.



Dear Panasonic Customer

Welcome to the Panasonic family of customers. We hope that you will have many years of enjoyment from your new Plasma Display.

To obtain maximum benefit from your set, please read these Instructions before making any adjustments, and retain them for future reference.

Retain your purchase receipt as well, and record the model number and serial number of your set in the space provided on the rear cover of these instructions.

Table of Contents

Important Safety Instructions.....	3	Initial selections.....	18
Table of Contents	4	Selecting the input signal	18
FCC STATEMENT.....	5	Selecting the On-Screen Menu Language	18
Safety Precautions	6	Basic Controls	19
Maintenance.....	7	Remote Control Transmitter	20
Accessories	8	ASPECT Controls	21
Accessories Supplied	8	On-Screen Menu Display	22
Remote Control Batteries	8	PICTURE Menu	24
Attaching the Pedestal to the Plasma Display.....	9	SOUND Menu	25
Location.....	10	SETUP Menu	26
Preparation for Wall-hanging.....	10	PC Setup	27
Optional Accessory / AC Cord Connection.....	11	HOTEL MODE Setup.....	28
Connections.....	12	Hotel Mode Menu List	29
AV connection.....	13	Troubleshooting	30
Component (YPbPr) connection.....	13	PC Input Signals	31
PC Input Terminals connection.....	14	Specifications	32
SERIAL Terminals connection	15	Panasonic Professional Flat Panel Display	
HDMI connection.....	16	Limited Warranty	33
Audio Out connection	16	LIMITED WARRANTY STATEMENT	34
Power ON / OFF	17	Customer Service.....	35
Using the Power Switch	17		
Using the Power Button.....	17		

FCC STATEMENT

This equipment has been tested and found to comply with the limits for a Class B digital device, pursuant to Part 15 of the FCC Rules. These limits are designed to provide reasonable protection against harmful interference in a residential installation. This equipment generates, uses and can radiate radio frequency energy and, if not installed and used in accordance with the instructions, may cause harmful interference to radio communications. However, there is no guarantee that interference will not occur in a particular installation. If this equipment does cause harmful interference to radio or television reception, which can be determined by turning the equipment off and on, the user is encouraged to try to correct the interference by one or more of the following measures:

- Reorient or relocate the receiving antenna.
- Increase the separation between the equipment and receiver.
- Connect the equipment into an outlet on a circuit different from that to which the receiver is connected.
- Consult the dealer or an experienced technician for help.

This device complies with Part 15 of the FCC Rules. Operation is subject to the following two conditions: (1) This device may not cause harmful interference, and (2) this device must accept any interference received, including interference that may cause undesired operation.

FCC CAUTION:

To assure continued compliance, follow the attached installation instructions and use only shielded interface cables when connecting to computer or peripheral devices. Any changes or modifications not expressly approved by Panasonic Corp. of North America could void the user's authority to operate this device.

FCC Declaration of Conformity

Model No. TH-42PRT12U

Responsible Party:	Panasonic Corporation of North America One Panasonic Way 1F-10, Secaucus, NJ 07094
Contact Source:	Panasonic Professional Display Company Panasonic Plasma Concierge 1-800-973-4390

CANADIAN NOTICE:

This Class B digital apparatus complies with Canadian ICES-003.

Note:

Do not allow a still picture to be displayed for an extended period, as this can cause a permanent image retention to remain on the Plasma Display.

Examples of still pictures include logos, video games, computer images, teletext and images displayed in 4:3 mode.

Trademark Credits

- VGA is a trademark of International Business Machines Corporation.
- Macintosh is a registered trademark of Apple Computer, USA.
- SVGA, XGA, and SXGA are registered trademarks of the Video Electronics Standard Association.
Even if no special notation has been made of company or product trademarks, these trademarks have been fully respected.
- HDMI, the HDMI logo and High-Definition Multimedia Interface are trademarks or registered trademarks of HDMI Licensing LLC.

Safety Precautions



CAUTION

This Plasma Display is for use only with the following optional accessories. Use with any other type of optional accessories may cause instability which could result in the possibility of injury.

(All of the following accessories are manufactured by Panasonic Corporation.)

- Wall-hanging bracket (angled)TY-WK4P1RW
- ATSC Tuner with Terminal BoardDTB1510TB

Always be sure to ask a qualified technician to carry out set-up.

Small parts can present choking hazard if accidentally swallowed. Keep small parts away from young children. Discard unneeded small parts and other objects, including packaging materials and plastic bags/sheets to prevent them from being played with by young children, creating the potential risk of suffocation.

■ When using the Plasma Display

Do not bring your hands, face or objects close to the ventilation holes of the Display.

- Top of the Display is usually very hot due to the high temperature of exhaust air being released through the ventilation holes. Burns or personal injuries can happen if any body parts are brought too close. Placing any object near the top of the display could also result in heat damages to the object as well as to the Display if its ventilation holes are blocked.

Be sure to disconnect all cables before moving the Display.

- Moving the Display with its cables attached might damage the cables which, in turn, can cause fire or electric shock.

Disconnect the power plug from the wall outlet as a safety precaution before carrying out any cleaning.

- Electric shocks can result if this is not done.

Disconnect the power plug from the wall outlet before installing the tuner.

- Electric shocks can result if this is not done.

Clean the power cable regularly to prevent it from becoming dusty.

- Built-up dust on the power cord plug can increase humidity which might damage the insulation and cause fire. Unplug the cord from the wall outlet and clean it with a dry cloth.

This Display radiates infrared rays, therefore it may affect other infrared communication equipment. Install your infrared sensor in a place away from direct or reflected light from your Display.

• Note:

Do not allow a still picture to be displayed for an extended period, as this can cause a permanent image retention to remain on the Plasma Display.

Examples of still pictures include logos, video games, computer images, teletext and images displayed in 4:3 mode.

WARNING

■ Setup

Do not place the Plasma Display on sloped or unstable surfaces.

- The Plasma Display may fall off or tip over.

Do not place any objects on top of the Plasma Display.

- If water spills onto the Plasma Display or foreign objects get inside it, a short-circuit may occur which could result in fire or electric shock. If any foreign objects get inside the Plasma Display, please consult an Authorized Service Center.

Do not cover the ventilation holes.

- Doing so may cause the Plasma Display to overheat, which can cause fire or damage to the Plasma Display.

Transport only in upright position!

- Transporting the unit with its display panel facing upright or downward may cause damage to the internal circuitry.

When using the pedestal (optional accessory), leave a space of 3 15/16" (10 cm) or more at the top, left and right, and 2 3/4" (7 cm) or more at the rear, and also keep the space between the bottom of the display and the floor surface. If using some other setting-up method, follow the manual of it.

■ AC Power Supply Cord

The Plasma Display is designed to operate on 110 - 127 V AC, 50/60 Hz.

Do not use any power supply cord other than that provided with this unit.

- Doing so may cause fire or electric shocks.

Securely insert the power cord plug as far as it will go.

- If the plug is not fully inserted, heat may be generated which could cause fire. If the plug is damaged or the wall socket plate is loose, they should not be used.

Do not handle the power cord plug with wet hands.

- Doing so may cause electric shocks.

Do not do anything that might damage the power cable. When disconnecting the power cable, hold the plug, not the cable.

- Do not make any modifications, place heavy objects on, place near hot objects, heat, bend, twist or forcefully pull the power cable. Doing so may cause damage to the power cable which can cause fire or electric shock. If damage to the cable is suspected, have it repaired at an Authorized Service Center.

If the Plasma Display will not be used for a long period of time, unplug the power cord from the wall outlet.

■ If problems occur during use

If a problem occurs (such as no picture or no sound), or if smoke or an abnormal odor is detected from the Plasma Display, unplug the power cord immediately.

- Continuous use of the Display under these conditions might cause fire or permanent damage to the unit. Have the Display evaluated at an Authorized Service Center. Services to the Display by any unauthorized personnel are strongly discouraged due to its high voltage dangerous nature.

If water or foreign objects get inside the Plasma Display, if the Plasma Display is dropped, or if the cabinet becomes damaged, disconnect the power cord plug immediately.

- A short may occur, which could cause fire. Contact an Authorized Service Center for any repairs that need to be made.

Maintenance

The front of the display panel has been specially treated. Wipe the panel surface gently using only a cleaning cloth or a soft, lint-free cloth.

- If the surface is particularly dirty, wipe with a soft, lint-free cloth which has been soaked in pure water or water in which neutral detergent has been diluted 100 times, and then wipe it evenly with a dry cloth of the same type until the surface is dry.
- Do not scratch or hit the surface of the panel with fingernails or other hard objects, otherwise the surface may become damaged. Furthermore, avoid contact with volatile substances such as insect sprays, solvents and thinner, otherwise the quality of the surface may be adversely affected.

If the cabinet becomes dirty, wipe it with a soft, dry cloth.

- If the cabinet is particularly dirty, soak the cloth in water to which a small amount of neutral detergent has been added and then wring the cloth dry. Use this cloth to wipe the cabinet, and then wipe it dry with a dry cloth.
- Do not allow any detergent to come into direct contact with the surface of the Display. If water droplets get inside the unit, operating problems may result.
- Avoid contact with volatile substances such as insect sprays, solvents and thinner, otherwise the quality of the cabinet surface may be adversely affected or the coating may peel off. Furthermore, do not leave it for long periods in contact with articles made from rubber or PVC.

Accessories

Accessories Supplied

Check that you have the Accessories and items shown 

☐ Operating Instruction book

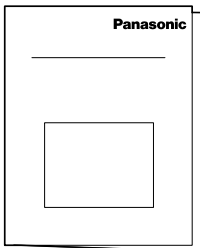

☐ Remote Control Transmitter
TNQ4CM051



☐ Batteries for the Remote Control
Transmitter (AA Size x 2)

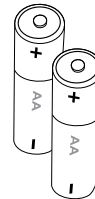

☐ HDMI cable
(for TH-42PRT12U)

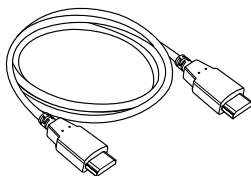

☐ AC Cord

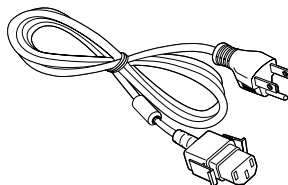

☐ Pedestal
● TBLX0132
→ p. 9

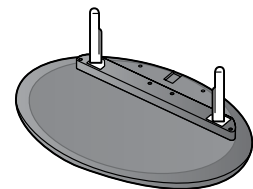

Remote Control Batteries

Requires two AA batteries.

1. Push the hook to release, then open the battery cover.

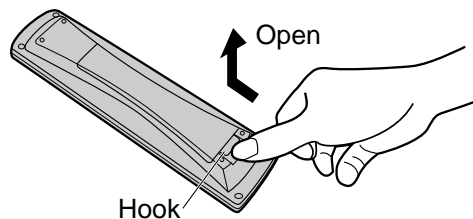

2. Insert batteries - note the correct polarity (+ and -).

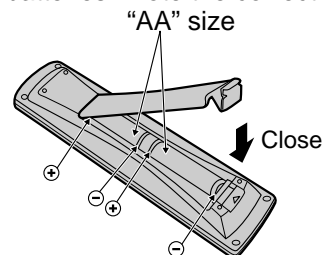

Helpful Hint:

For frequent remote control users, replace old batteries with Alkaline batteries for longer life.

Precaution on battery use

Incorrect installation can cause battery leakage and corrosion that will damage the remote control transmitter. Disposal of batteries should be in an environment-friendly manner.

Observe the following precautions:

1. Batteries should always be replaced as a pair. Always use new batteries when replacing the old set.
2. Do not combine a used battery with a new one.
3. Do not mix battery types (example: "Zinc Carbon" with "Alkaline").
4. Do not attempt to charge, short-circuit, disassemble, heat or burn used batteries.
5. Battery replacement is necessary when the remote control acts sporadically or stops operating the Plasma Display.
6. Do not burn or breakup batteries.

Batteries must not be exposed to excessive heat such as sunshine, fire or the like.

Attaching the Pedestal to the Plasma Display

- **WARNING:**
- **Do not disassemble or modify the pedestal.**
 - Otherwise the Plasma Display may fall over and become damaged, and personal injury may result.
- **CAUTION:**
- **Do not use any other Plasma Displays.**
 - Otherwise the Plasma Display may fall over and become damaged, and personal injury may result.
- **Do not use the pedestal if it becomes warped or physically damaged.**
 - If you use the pedestal while it is physically damaged, personal injury may result. Contact your nearest Panasonic dealer immediately.
- **During set-up, make sure that all screws are securely tightened.**
 - If insufficient care is taken to ensure screws are properly tightened during assembly, the pedestal will not be strong enough to support the Plasma Display, and it might fall over and become damaged, and personal injury may result.
- **Ensure that the Plasma Display does not fall over.**
 - If the Plasma Display is knocked or children climb onto the pedestal with the Plasma Display installed, the Plasma Display may fall over and personal injury may result.
- **Two or more people are required to install and remove the Plasma Display.**
 - If two or more people are not present, the Plasma Display may be dropped, and personal injury may result.

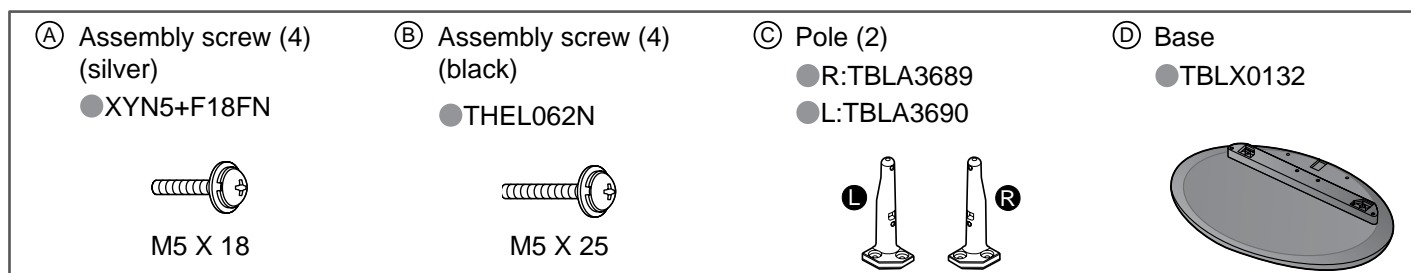

■ Assembling the pedestal

Use the four assembly screw Ⓐ to fasten the left and right poles to the base securely.

- Make sure that the screws are securely tightened.
- Forcing the assembly screws the wrong way will strip the threads.
- "L" or "R" mark is stamped on the bottom of the pole.

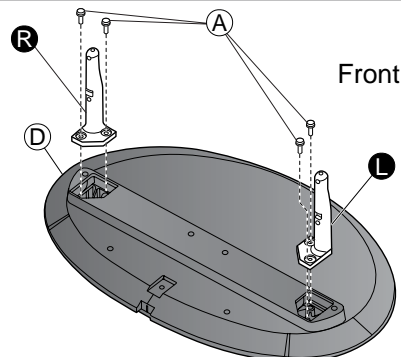

■ Securing the Plasma Display

Use the four assembly screw Ⓑ to fasten securely.

- Make sure that the screws are securely tightened.
- Carry out the work on a horizontal and level surface.

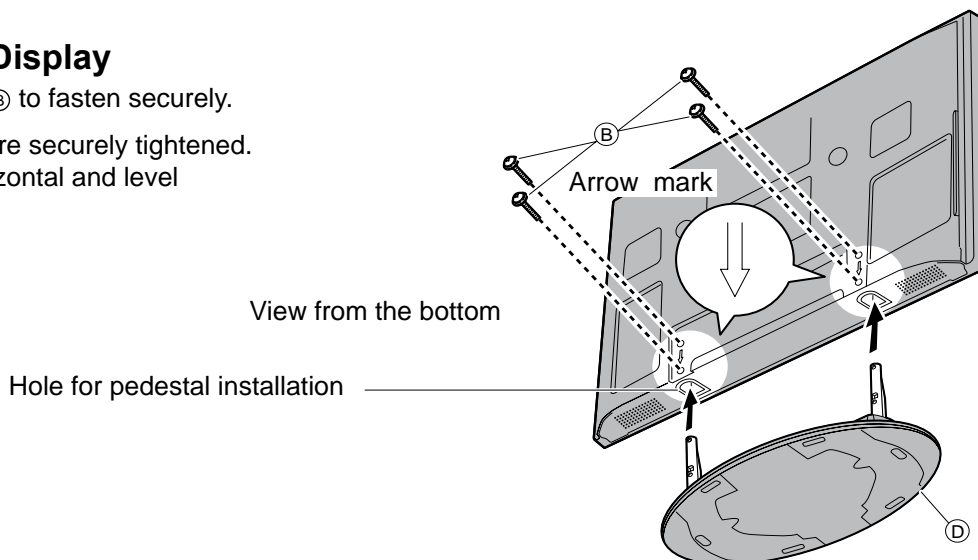

Location

Place the display at a comfortable distance for viewing. Avoid placing it where sunlight or other bright light (including reflections) will fall on the screen.

Use of some types of fluorescent lighting can reduce remote control transmitter range.

Adequate ventilation is essential to prevent an internal component failure. Keep away from areas of excessive heat or moisture.

■ How to use the pedestal

Adjust the stand to your desired angle.

The stand angle can be rotated 15° to the right / left.

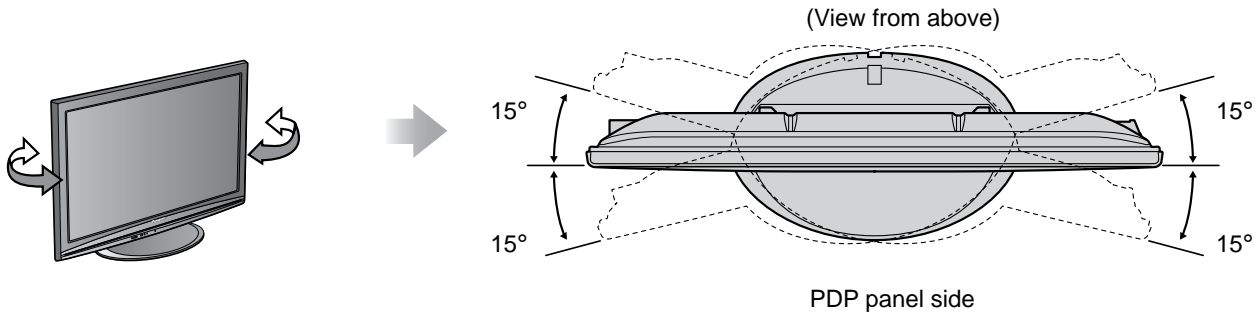

Preparation for Wall-hanging

Before mounting the display on the wall, you must remove the pedestal from the display.

Follow the steps below:

1 Disconnect all the cables from the display.

2 Remove the pedestal.

Ⓐ Remove the four screws.

Ⓑ Pull out the pedestal.

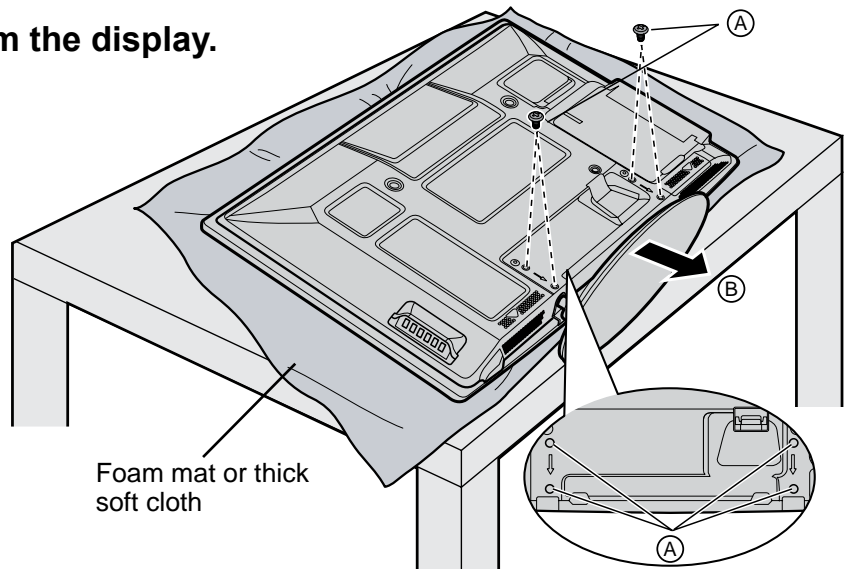

• WARNING

- Failure to use a Panasonic bracket or choosing to mount the unit yourself will be done at the risk of the consumer. Any damage resulting from not having a professional installer mount will void your unit's warranty.
- Always be sure to ask a qualified technician to carry out set-up. Incorrect fitting may cause equipment to fall, resulting in injury and product damage.
- Do not mount this Plasma display directly below ceiling lights (such as spotlights, floodlights, or halogen lights) which typically give off high heat. Doing so may warp or damage plastic cabinet parts.

Optional Accessory / AC Cord Connection

Optional Accessory

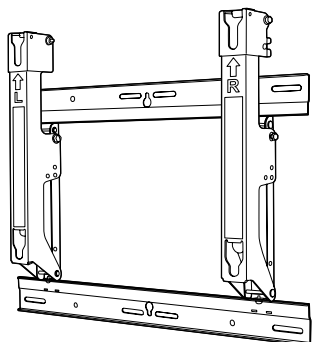

Wall-hanging bracket (angle)

● TY-WK4P1RW

- **Note:**
- In order to maintain the Plasma display's performance and safety, be absolutely sure to ask your dealer or a licensed contractor to secure the wall-hanging brackets.
- Carefully read the instructions accompanying the Plasma display stand or pedestal, and be absolutely sure to take steps to prevent the Plasma display from tipping over.
- Handle the Plasma display carefully during installation since subjecting it to impact or other forces may cause its panel to crack.

AC Cord Connection

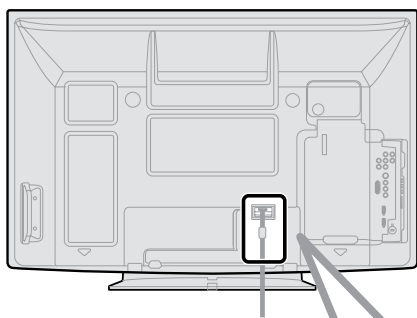

To attach

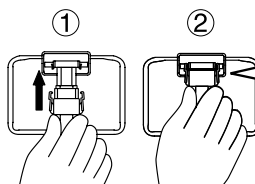

Insert it firmly until the tabs on both sides click into place.

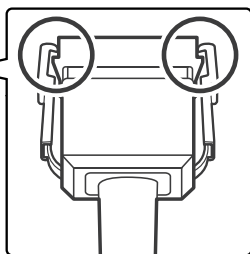

To remove

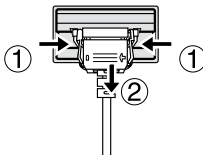

Keep pushing both side snaps and pull down.

Connections

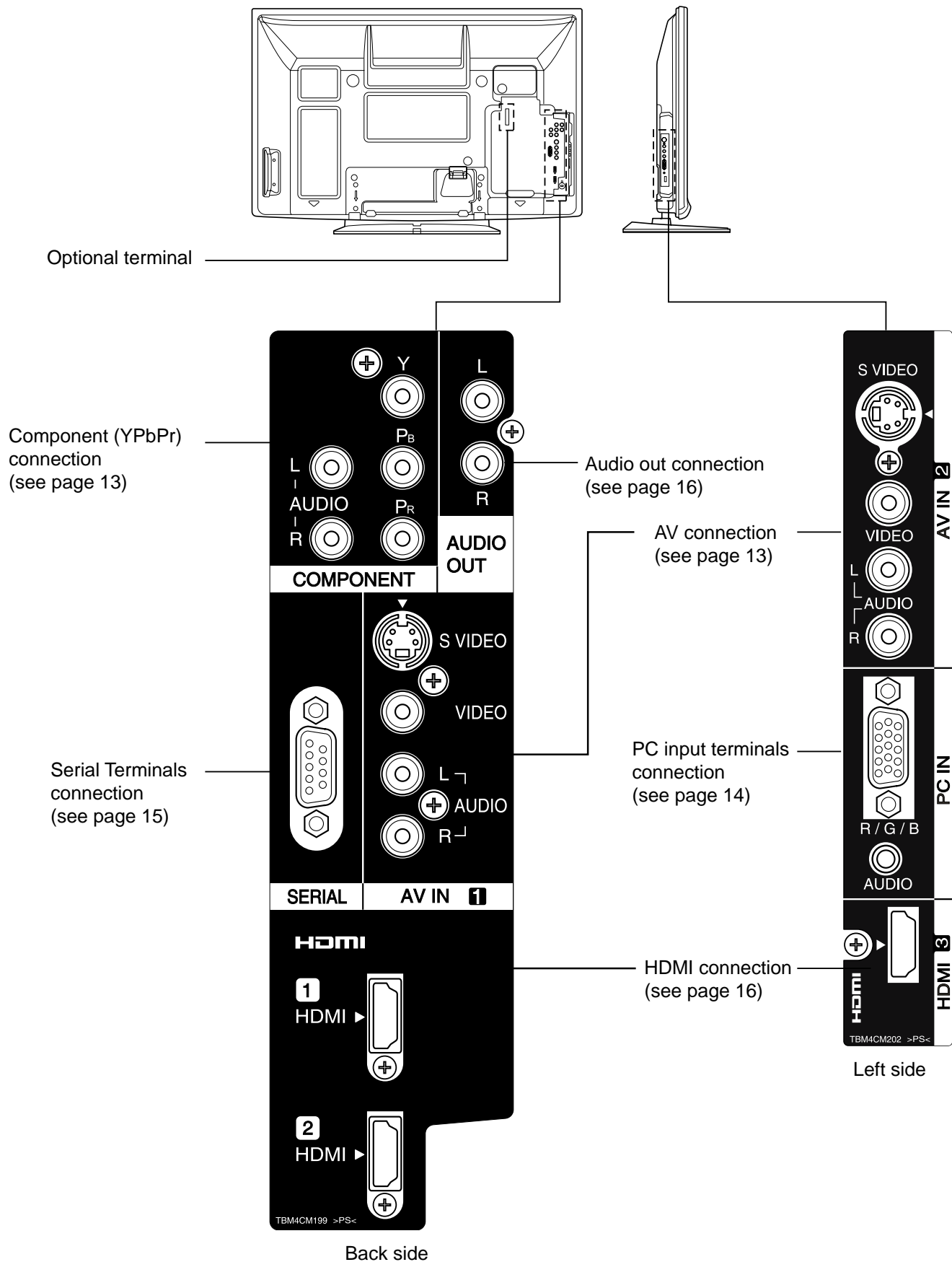

AV connection

Example of input signal source

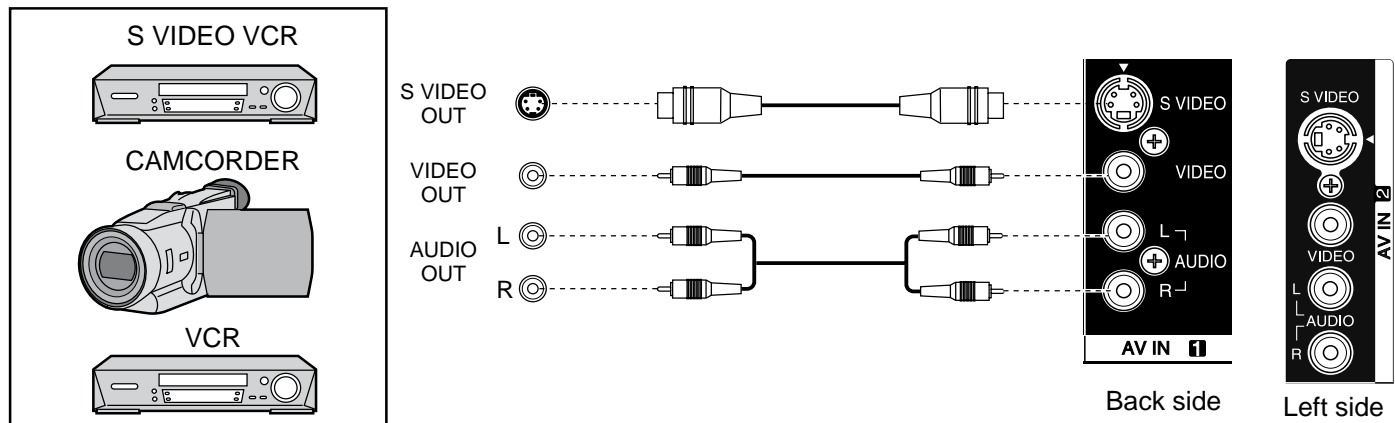

Notes:

- Additional equipment and cables shown are not supplied with this set.
- If S Video and Video devices are both connected, the S Video input signal is the priority source.

Component (YPbPr) connection

Example of input signal source

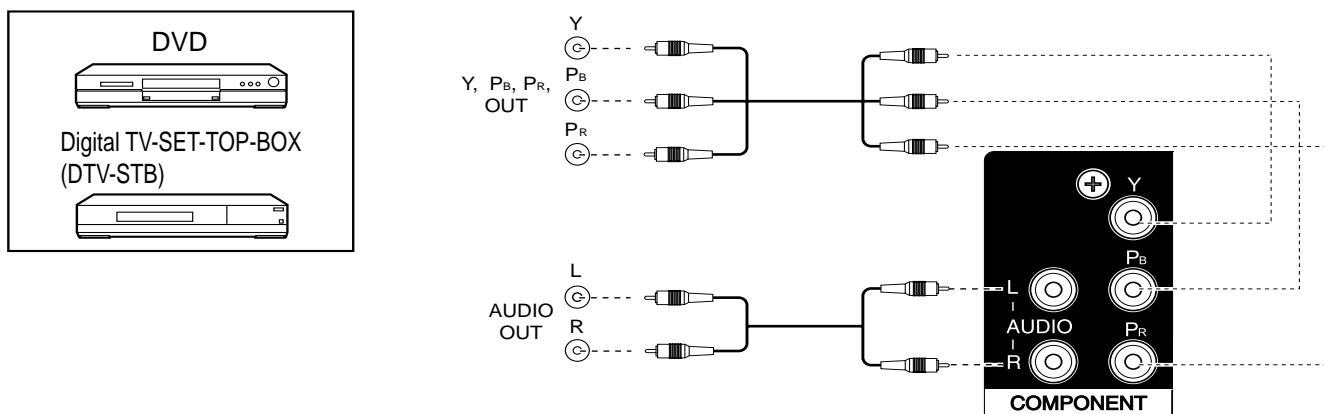

Note:

Additional equipment and cables shown are not supplied with this set.

PC Input Terminals connection

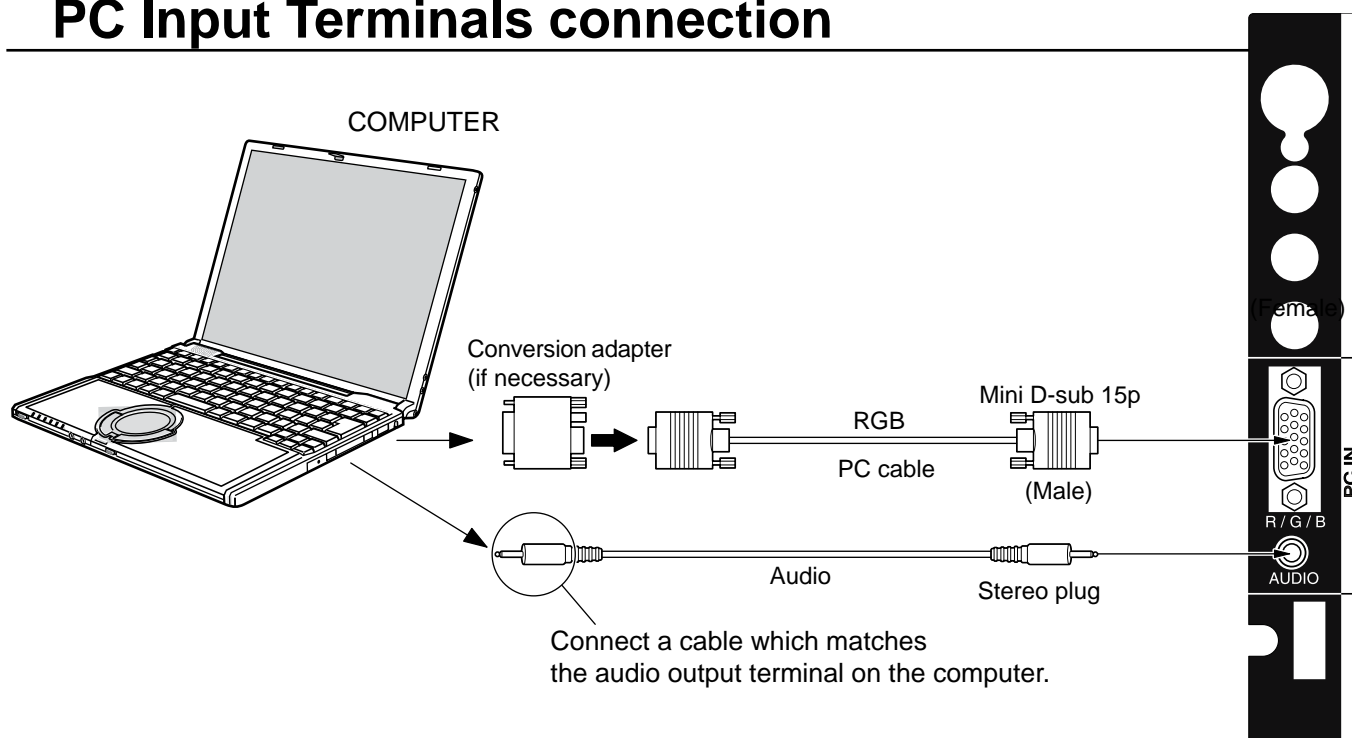

Notes:

- Computer signals which can be input are those with a horizontal scanning frequency of 15 to 79.97 kHz and vertical scanning frequency of 48 to 75 Hz. (However, the image will not be displayed properly if the signals exceed 1,200 lines.)
- The display resolution is a maximum of 768 x 768 dots when the aspect mode is set to "4:3" and 1,024 x 768 dots when the aspect mode is set to "FULL". If the display resolution exceeds these maximums, it may not be possible to show fine detail with sufficient clarity.
- The PC input terminals are DDC2B-compatible. If the computer being connected is not DDC2B-compatible, you will need to make setting changes to the computer at the time of connection.
- Some PC models cannot be connected to the set.
- There is no need to use an adapter for computers with DOS/V compatible Mini D-sub 15P terminal.
- The computer shown in the illustration is for example purposes only.
- Additional equipment and cables shown are not supplied with this set.
- Do not set the horizontal and vertical scanning frequencies for PC signals which are above or below the specified frequency range.
- Component Input is possible with the pin 1, 2, 3 of the Mini D-sub 15P Connector.
- Applicable input signals for Mini D-sub 15P (see page 31).

Signal Names for Mini D-sub 15P Connector

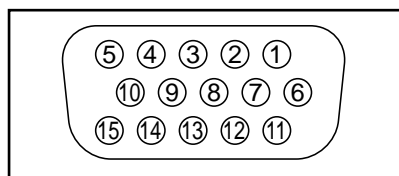

Pin Layout for PC Input Terminal

Pin No.	Signal Name	Pin No.	Signal Name	Pin No.	Signal Name
①	R	⑥	GND (Ground)	⑪	NC (not connected)
②	G	⑦	GND (Ground)	⑫	SDA
③	B	⑧	GND (Ground)	⑬	HD/SYNC
④	NC (not connected)	⑨	+5 V DC	⑭	VD
⑤	GND (Ground)	⑩	GND (Ground)	⑮	SCL

SERIAL Terminals connection

The SERIAL terminal is used when the Display is controlled by a computer.

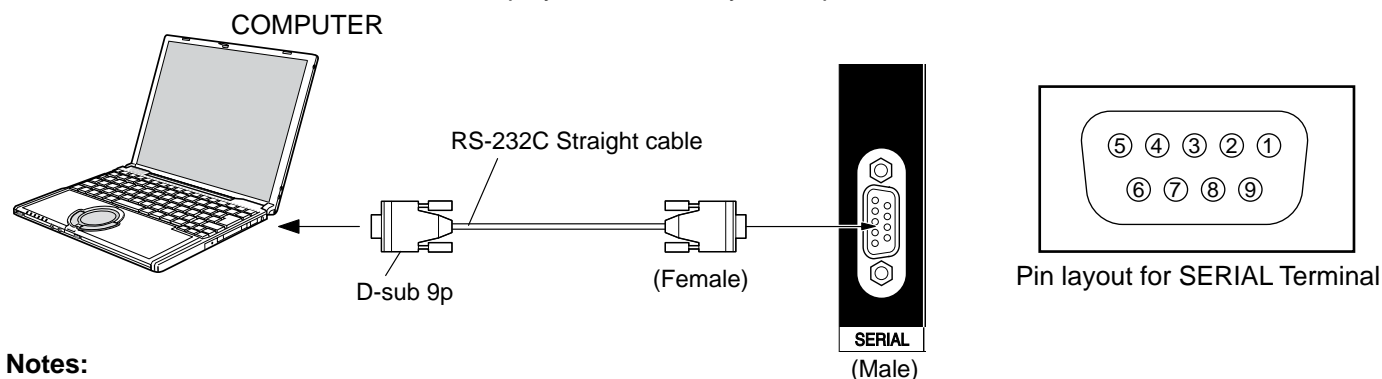

Notes:

- Use the RS-232C straight cable to connect the computer to the Display.
- The computer shown is for example purposes only.
- Additional equipment and cables shown are not supplied with this set.

The SERIAL terminal conforms to the RS-232C interface specification, so that the Display can be controlled by a computer which is connected to this terminal.

The computer will require software which allows the sending and receiving of control data which satisfies the conditions given below. Use a computer application such as programming language software. Refer to the documentation for the computer application for details.

Signal names for D-sub 9P connector

Pin No.	Details
②	RXD
③	TXD
⑤	GND
④ • ⑥	Non use
⑦ • ⑧	Non use
① • ⑨	NC

These signal names are those of computer specifications.

Communication parameters

Signal level	RS-232C compliant
Synchronization method	Asynchronous
Baud rate	9600 bps
Parity	None
Character length	8 bits
Stop bit	1 bit
Flow control	-

Basic format for control data

The transmission of control data from the computer starts with an STX signal, followed by the command, the parameters, and lastly an ETX signal in that order. If there are no parameters, then the parameter signal does not need to be sent.

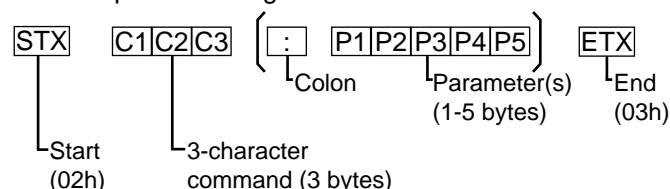

Notes

- If multiple commands are transmitted, be sure to wait for the response for the first command to come from this unit before sending the next command.
- If an incorrect command is sent by mistake, this unit will send an ER401 command back to the computer.

Communication parameters

Command	Parameter	Control details
PON	None	Power ON
POF	None	Power OFF
AVL	**	Volume 00 - 63
AMT	0	Audio MUTE OFF
	1	Audio MUTE ON
IMS	None RF1 AV1 AV2 YU1 HD1 HD2 HD3 PC1	Input select (toggle) RF input AV1 input AV2 input YPbPr input HDMI 1 input HDMI 2 input HDMI 3 input PC input
DAM	None FULL JUST NORM	Screen mode select (toggle) 16:9 JUST 4:3

With the power off, this display responds to PON command only.

HDMI connection

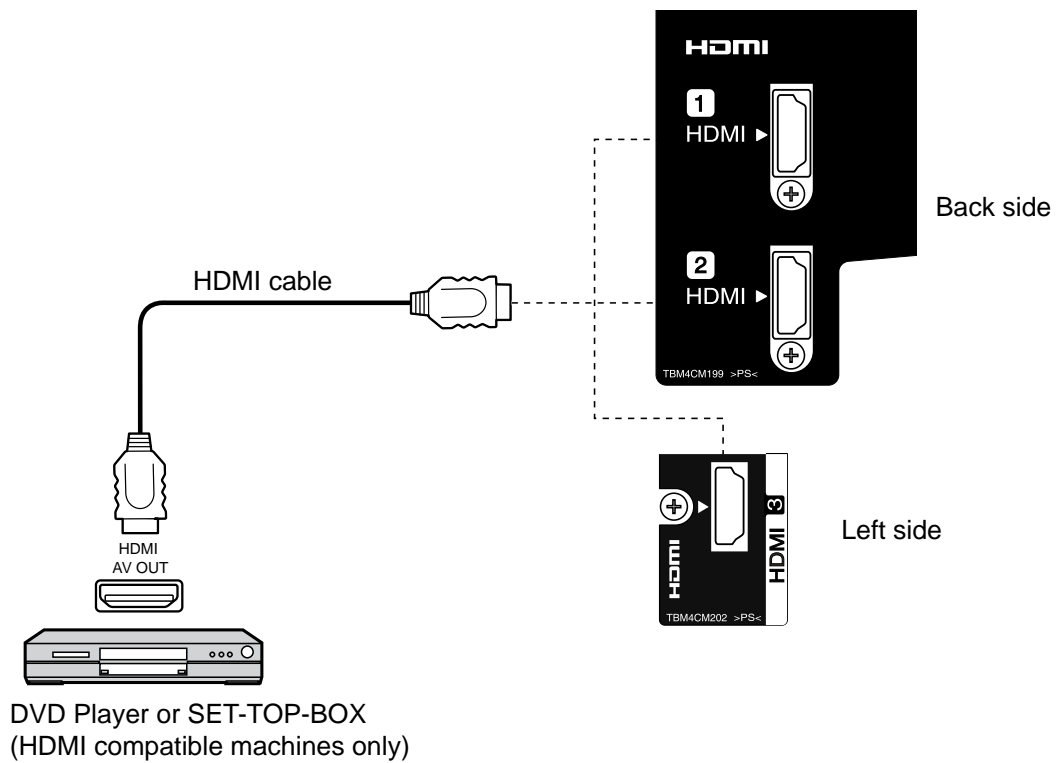

Note:

1. Additional equipment and HDMI cables shown are not supplied with this set.
2. HDMI version 1.2.

Audio Out connection

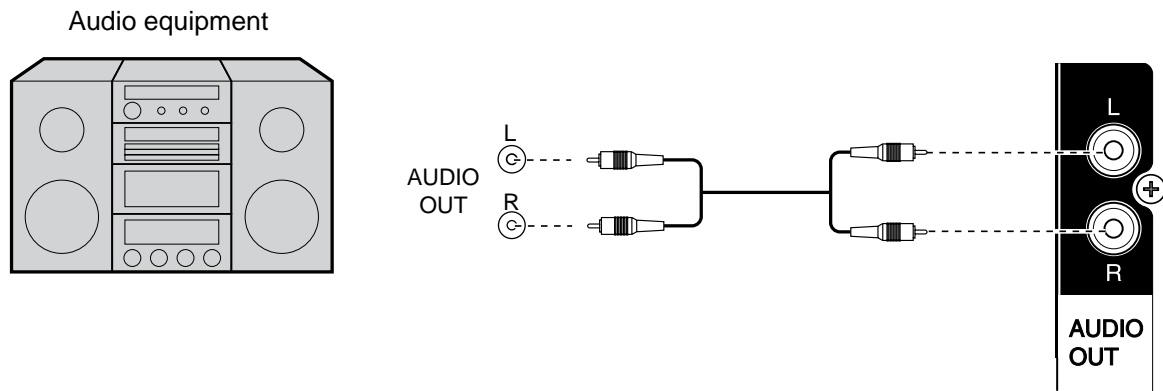

Note:

Additional equipment and cables shown are not supplied with this set.

Power ON / OFF

Using the Power Switch

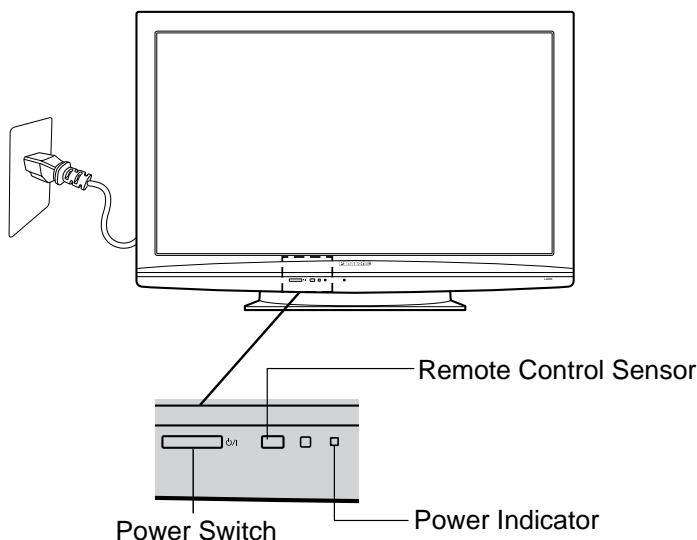

1 Connect the AC cord to the Plasma Display (see page 11).

2 Connect the plug to the Wall Outlet.

3 Press the Power switch on the Plasma Display to turn the set on.

Power Indicator: Green

When the Plasma Display is on, press the Power switch on the Plasma Display to turn the set off.

Power Indicator: Red (Standby)

Using the Power Button

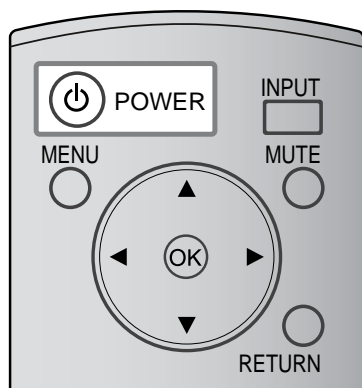

POWER

Press the  POWER button on the remote control to turn the Plasma Display on.

Power Indicator: Green

Press the  POWER button on the remote control to turn the Plasma Display off.

Power Indicator: Red

• **Note:**

The Plasma Display will still consume power as long as the AC cord is connected to the wall outlet. Unplug the AC cord to cut-off power.

Initial selections

Selecting the input signal

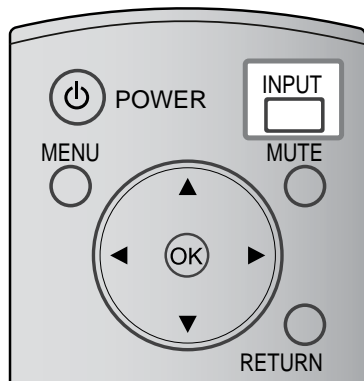

Press repeatedly until the desired input source signal is displayed on the screen.

Input signals will change as follows:

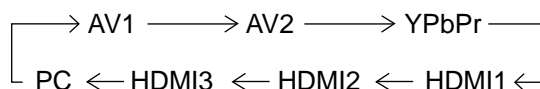

• Note:

Selecting is also possible by pressing the INPUT button on the unit.
RF mode will not be selected if the tuner box is not installed into the Optional terminal.

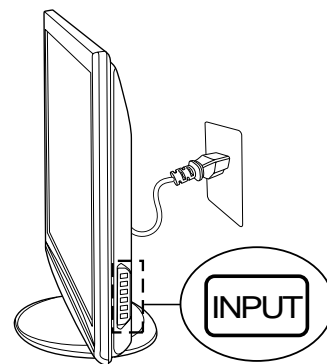

Selecting the On-Screen Menu Language

1 Display the menu screen.

2 Select "Setup Menu".

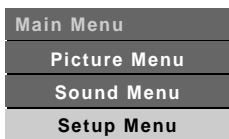

3 Select "LANGUAGE".

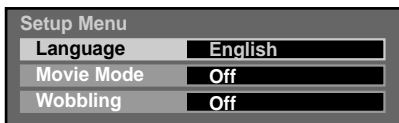

4 Select your preferred language.

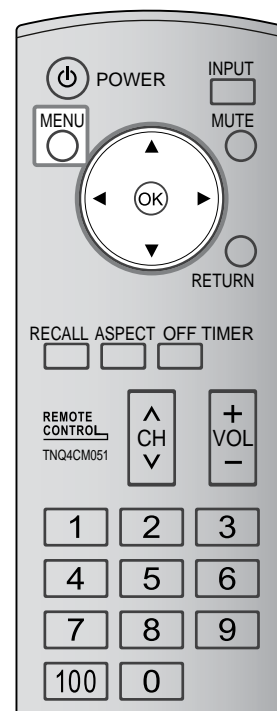
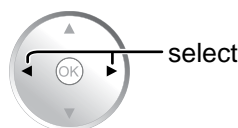
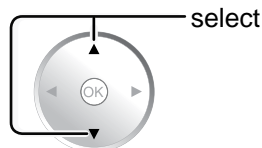
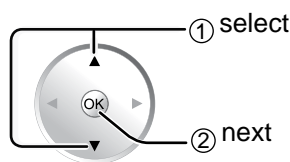

Basic Controls

Main Unit

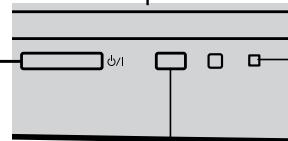
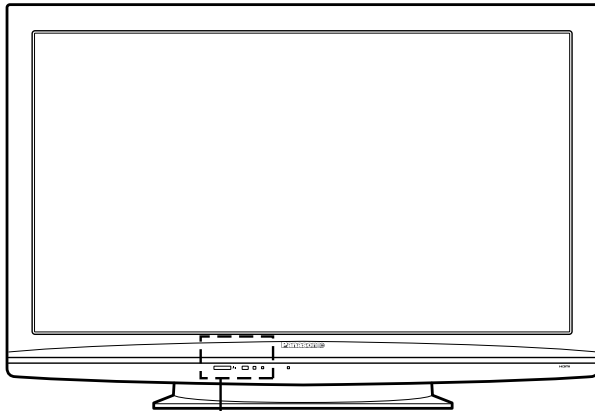

Remote control sensor

Power On / Off Switch

Power Indicator

The Power Indicator will light.

- Power-OFF ... Indicator not illuminated
- Standby Red (The Plasma Display will still consume power as long as the AC cord is still connected to the wall outlet.)
- Power-ON..... Green

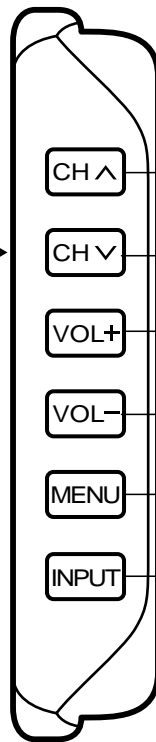
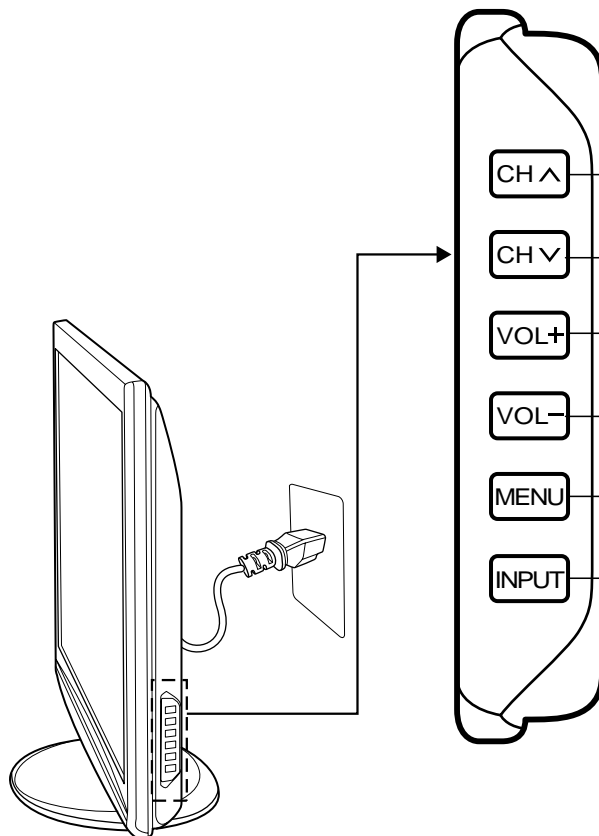

Channel Adjustment

Press to change to the next or previous channel.

Volume Adjustment

Press "+" to increase volume or press "-" to reduce volume.

MENU Screen ON (see page 22)

This button is locked by initial setting.

INPUT button (see page 18)

Remote Control Transmitter

POWER button

The Plasma Display must first be plugged into the wall outlet. Press this button to turn the Plasma Display on, from standby mode. Press it again to turn the Plasma Display Off to standby mode.

MENU button

Displays the menu screen. (see page 22)

OK button

Press to make selections.

POSITION buttons

RECALL button

Press to display the current input signal mode.

ASPECT button

Press to adjust the aspect. This button can be used only in AV input signal. (see page 21)

Channel buttons

Press the buttons to adjust the channel. These buttons are also used for to adjusting digital channel when a tuner pack is installed. For more information, please refer to the tuner pack's manual.

INPUT button (see page 18)

Sound mute On / Off

Press this button to mute the sound. Press again to reactivate sound. Sound is also reactivated when power is turned off or volume level is changed.

RETURN button

Press the RETURN button to return to previous menu screen.

OFF TIMER button

The Plasma Display can be preset to switch to standby mode after a fixed period. Each time the button is pressed, the timer is changed with an interval of 10 minutes.

→10 →20 →30 →40 →50
OFF ←120 ←.....60←

When the timer is set, the TV will display a notification countdown 3 minutes before it switches to standby mode.

Volume Adjustment

Press the Volume Up “+” or Down “-” button to increase or decrease the sound volume level.

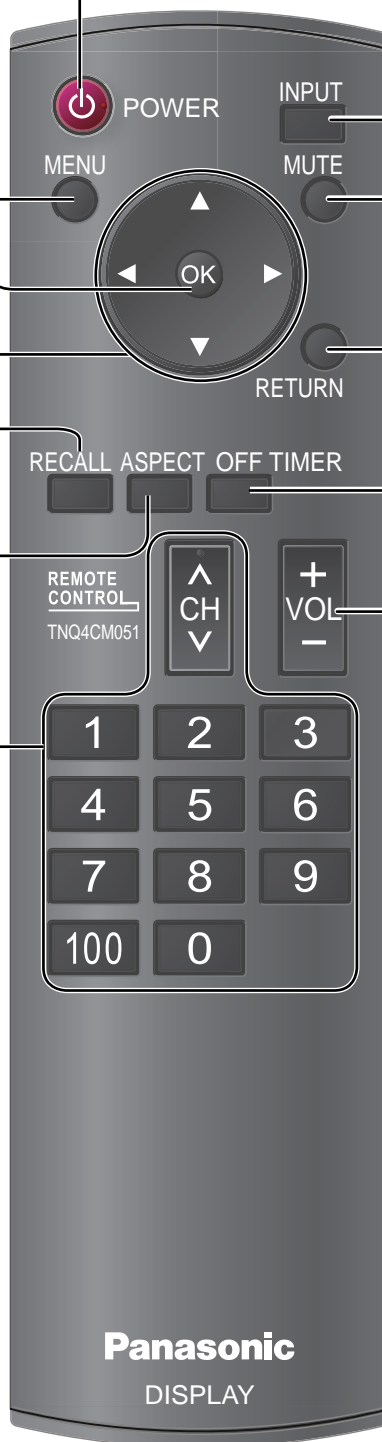

ASPECT Controls

The Display will allow you to enjoy viewing the picture at its maximum size, including wide screen cinema format picture.

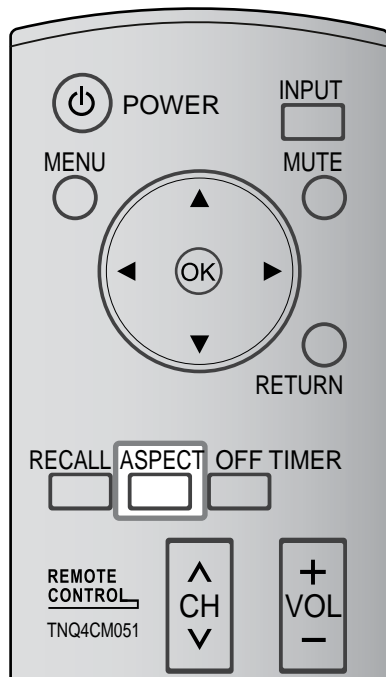

Press repeatedly to change the aspect.

For "AV" signal input:

→ 16:9 → JUST → 4:3 →

For "YPbPr", "HDMI" and "PC" signal input:

The aspect ratio is fixed at 16:9.

Aspect mode	Picture	Enlarged screen	Description
16:9			The display of the pictures fills the screen. In the case of SD signals, pictures with a 4:3 aspect ratio are enlarged horizontally, and displayed. This mode is suited to displaying anamorphic pictures with a 16:9 aspect ratio.
JUST			Pictures with a 4:3 aspect ratio are enlarged horizontally so that the picture distortion is minimized. The display of the areas around the left and right edges of the screen is slightly elongated.
			Pictures with a 4:3 aspect ratio are enlarged horizontally so that the picture distortion is minimized. The left and right edges of the pictures are cut off. The display of the areas around the left and right edges of the screen is slightly elongated.
4:3			Pictures with a 4:3 aspect ratio are displayed with their original aspect ratio. Side panels are displayed at the left and right edges of the screen.
			Pictures with a 4:3 aspect ratio are displayed with their original aspect ratio. The left and right edges of the pictures are masked by side panels.

On-Screen Menu Display

Various menus allow you to make settings for the picture, sound, and other functions so that you can enjoy watching Display best suited for you.

1 Display the menu screen.

Remote Control

 — Press the menu button.

Unit

Press the MENU button.

2 Select the menu.

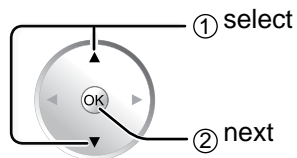
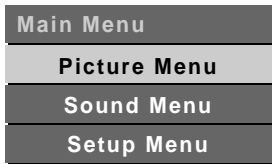

- ① Press the CH buttons to select the menu.
- ② Press the MENU button.

3 Select the item.

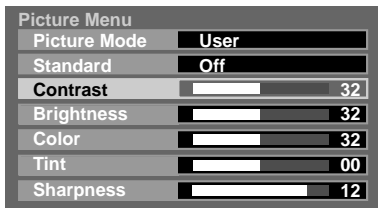

(Example: PICTURE menu)

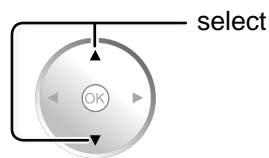

Press the CH < or > buttons to select the item.

4 Adjust or select.

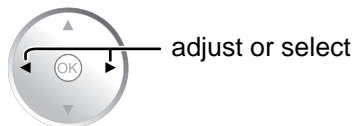

Press the VOL + or – buttons.

5 Exit the menu.

 — Press to return to the previous menu.
Press several times until you exit the menu.

Press the INPUT button several times until you exit the menu.

Overview

Note:
Menu that cannot be adjusted is grayout. Adjustable menu changes depending on signal, input and menu setting.

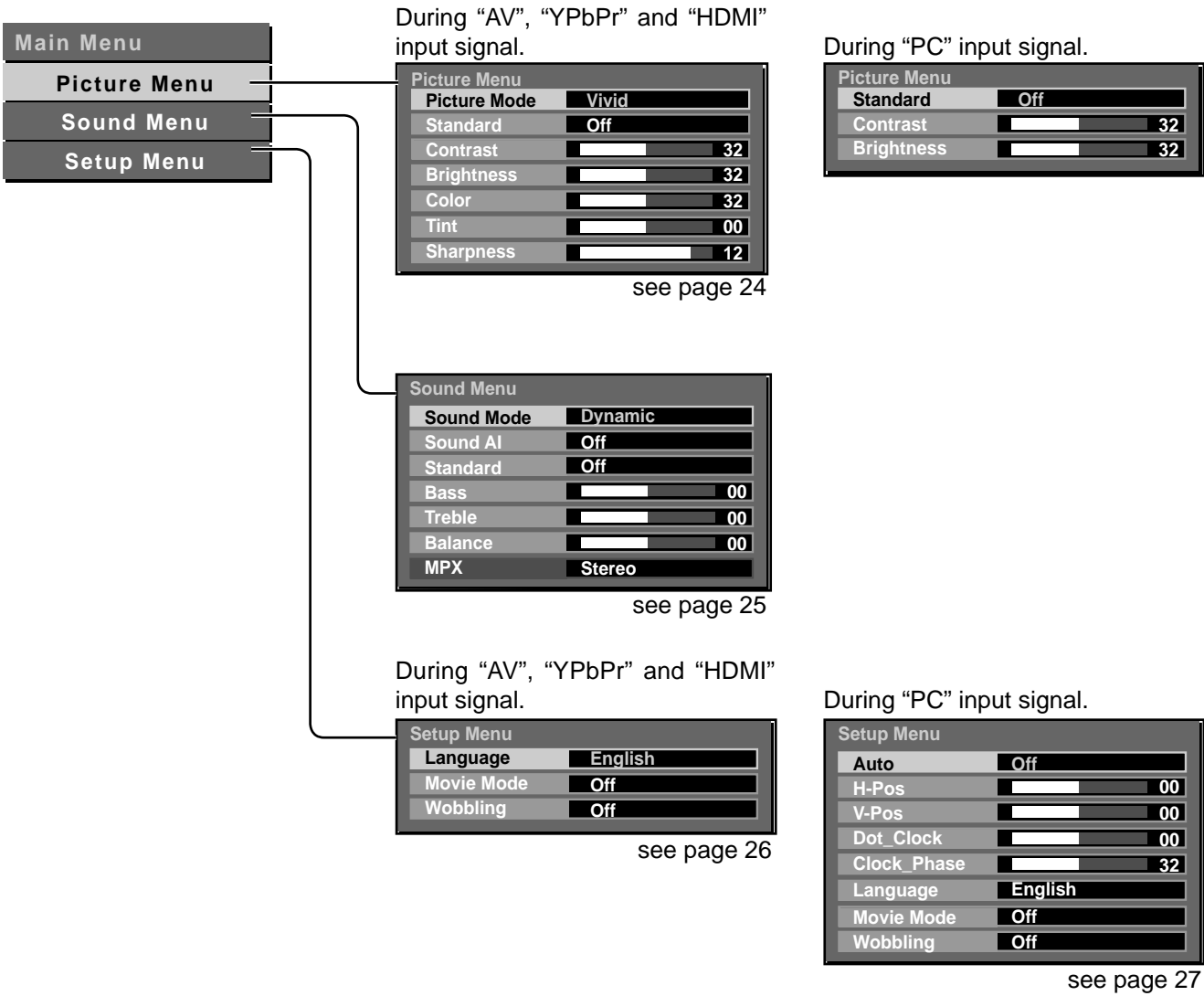

PICTURE Menu

1 Press  to display the menu screen.

2 Select **Picture Menu**.

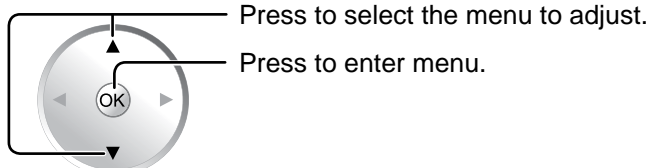

3 Select to adjust each item.

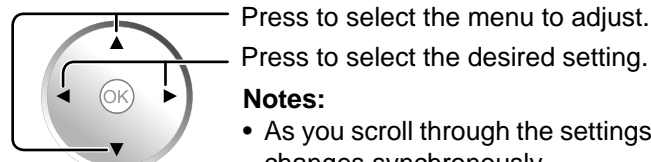

Notes:

- As you scroll through the settings, the Plasma Display changes synchronously.
- Menu items that cannot be adjusted are grayed out. Adjustable menu changes depending on signal, input and menu setting.

4 Press  repeatedly to exit the menu.

During "AV", "YPbPr", and "HDMI" input signal.

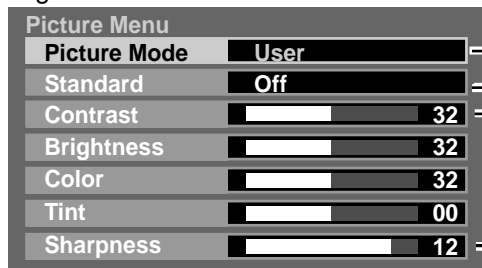

During "PC" input signal.

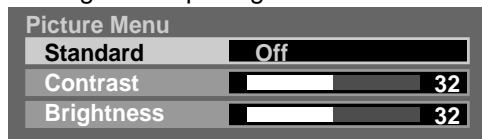

Press the ◀ or ▶ buttons to switch between modes.

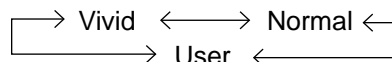

Vivid

Provides enhanced picture contrast and sharpness for viewing in a well-lit room.

Normal

Recommended for normal viewing conditions with subdued room lighting.

User

Customizes each item according to the user's preference.

Standard (Off / On)

Select **On** to reset all picture to the factory default settings.

Contrast / Brightness / Color / Tint / Sharpness

Depending on the selected **Picture Mode**, these items have preset settings.

To adjust each setting according to the user's preference, set **Picture Mode** to **User**, then press the ◀ or ▶ buttons.



Item	Details
Contrast	Adjusts the white areas.
Brightness	Adjusts the dark areas.
Color	Adjusts the color intensity.
Tint	Adjusts the natural flesh tones.
Sharpness	Adjusts the clarity of outline detail.

SOUND Menu

1 Press  to display the menu screen.

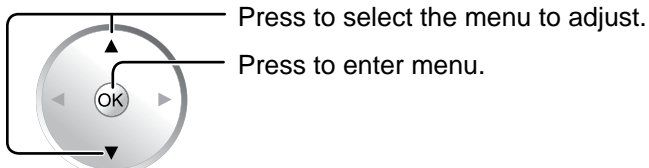

2 Select **Sound Menu**.

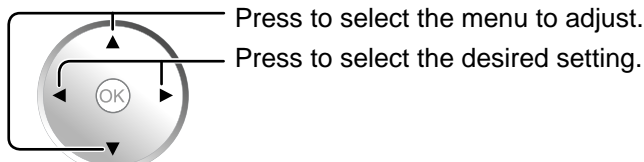

3 Select to adjust each item.



4 Press  repeatedly to exit the menu.

Sound Menu	
Sound Mode	Dynamic
Sound AI	Off
Standard	Off
Bass	 00
Treble	 00
Balance	 00
MPX	Stereo

Press the ◀ or ▶ buttons to switch between modes.

→ Mono ← Stereo ←
→ M2 ← M1 ←

Note: Adjustable only in RF mode (when a tuner pack is installed).

Press the ◀ or ▶ buttons to switch between modes.

→ Dynamic ← Music ←
→ Normal ←

Dynamic

Accentuates sharp sounds.

Music

Stresses the sense of sharp sounds.

Normal

Emits the original sound.

Sound AI (Off / On)

Select **On** to equalize overall volume levels across all external inputs.

Standard (Off / On)

Select **On** to reset Bass, Treble, and Balance settings to factory defaults.

Press the ◀ or ▶ buttons to adjust settings.



Bass

Adjusts low pitch sounds.

Treble

Adjusts pitch sounds.

Balance

Adjusts the left and right volumes.

SETUP Menu

1 Press  to display the menu screen.

2 Select **Setup Menu**.

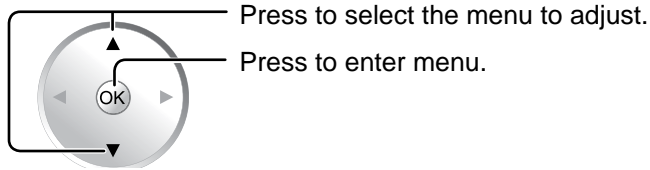

3 Select to adjust each item.

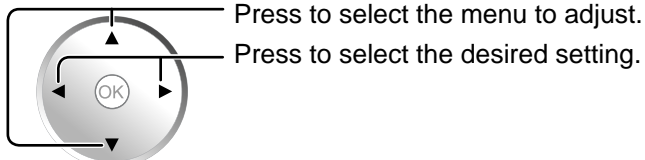

4 Press  repeatedly to exit the menu.

During "AV", "YPbPr", and "HDMI" input signal.

Setup Menu	
Language	English
Movie Mode	Off
Wobbling	Off

Press the ◀ or ▶ buttons to switch between menu languages.



Movie Mode (Off / On)

When **On**, the display attempts to reproduce a more natural interpretation of sources such as movie pictures, which are recorded at 24 frames per second. If the picture is not stable, turn this setting to **Off**.

Wobbling (Off / On)

When **On**, automatically shifts the display image to prevent image retention of sharper contour image. The shift is done every 30 seconds and is unnoticeable to the eye.

PC Setup

1 Press  to display the menu screen.

2 Select **Setup Menu**.

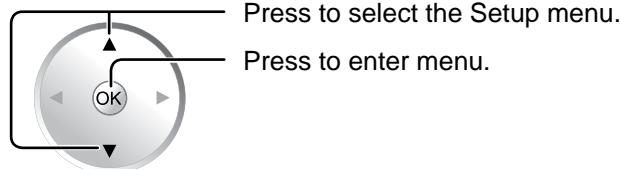

3 Select to adjust each item.

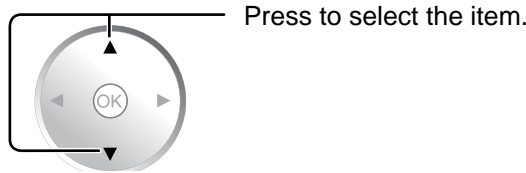

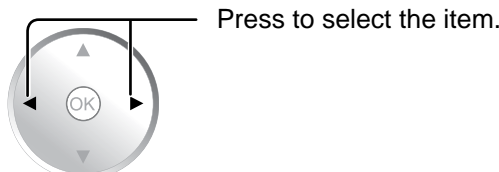

4 Adjust the setting.



5 Press  repeatedly to exit the menu.

During "PC" input signal.

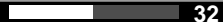
Setup Menu	
Auto	Off
H-Pos	 00
V-Pos	 00
Dot_Clock	 00
Clock_Phase	 32
Language	English
Movie Mode	Off
Wobbling	Off

On / Off

Select **On** to automatically adjust H-Pos, V-Pos, Dot_Clock, and Clock_Phase.

Press the ◀ or ▶ buttons to adjust settings.



H-Pos

Adjust the horizontal position.

V-Pos

Adjust the vertical position.

Dot_Clock

Periodic striped pattern interference (noise) may occur when a striped pattern is displayed. If this happens, adjust Dot_Clock to minimize such noise.

Clock_Phase

Eliminate the flickering and distortion.

Notes:

- If the PC is not connected, some items are unadjustable.
- Unadjustable items are grayed out.
- As you scroll through the settings, the Plasma Display changes synchronously.

HOTEL MODE Setup

The Hotel Mode is a special function which allows users to configure settings to suit certain locations or applications.

1 Press  to display the menu screen.

2 Select **Setup Menu**.

Main Menu
Picture Menu
Sound Menu
Setup Menu

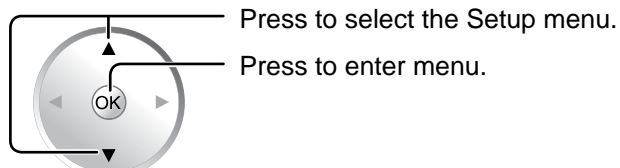

3 Select **Movie Mode**.

Setup Menu	
Language	English
Movie Mode	Off
Wobbling	Off

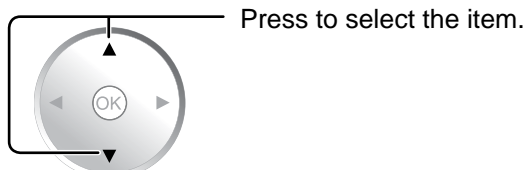

4 Press and hold  for more than 3 seconds.





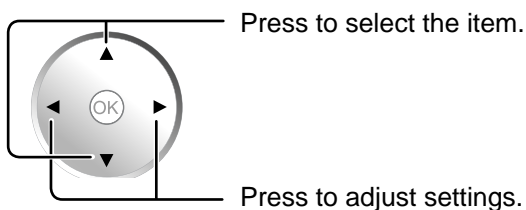

5 Select the item and set desired settings.

Setup Menu	
Initial Input	Off
Onscreen Display	Off
Initial VOL Level	Off
Maximum VOL Level	Off
Input Lock	Off
Button Lock	Menu
Remocon User Level	Off



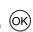

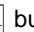





6 Press  repeatedly to exit the menu.

Hotel Mode Menu List

Item	Details
Initial Input	<p>Off ↔ AV1 ↔ AV2 ↔ YPbPr ↔ HDMI1 ↔ HDMI2 ↔ HDMI3 ↔ PC Adjusts the input signal when the unit is turned on.</p> <p>Off: The input signal when the power was last turned off is set.</p> <p>Note: This menu is available only when "Input Lock" is "Off".</p>
Onscreen Display	<p>Off: Onscreen information is not displayed. On: Onscreen information is displayed. On 1: Onscreen information is displayed, except some RS-232C communication information is not displayed.</p>
Initial VOL Level	<p>Used to set the volume level at power-on.</p> <p>Off: The volume is set to the same level as when the power was last turned off. 0 to 63: The volume is set to the selected level.</p> <p>Note: It is not possible to select an Initial VOL Level setting which is higher than the Maximum VOL Level setting.</p>
Maximum VOL Level	<p>Used to set the volume level so that it will not exceed the maximum setting.</p> <p>Off: No restrictions are placed on the volume level. 0 to 63: The volume is restricted to the selected level.</p> <p>Note: It is not possible to select a Maximum VOL Level setting which is lower than the Initial VOL Level setting.</p>
Input Lock	<p>Off ↔ AV1 ↔ AV2 ↔ YPbPr ↔ HDMI1 ↔ HDMI2 ↔ HDMI3 ↔ PC Locks the input switch operation.</p> <p>Off: Input switch can be used.</p>
Button Lock	<p>Used to restrict the operation of the buttons on the main unit.</p> <p>Off: All the buttons on main unit can be used. Menu: Locks the Menu button on the main unit. On: Locks all the buttons on the main unit except the Power button.</p>
Remocon User Level	<p>Off ↔ User1 ↔ User2 ↔ User3</p> <p>Off: You can use all of the buttons on the remote control. User1: You can only use  POWER, , , ,  buttons on the remote control. User2: You can only use  POWER button on the remote control. User3: Locks all the buttons on remote control.</p> <p>Note: Hotel Mode menu may not be accessed when you select "User2" or "User3". When this happens, press and hold the VOL - key on the display, then press the OK button on the remote control. The message "Are you sure to out the mode?" will appear, select Yes.</p>

Troubleshooting

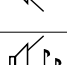
Before you call for service, determine the symptoms and make a few simple checks as shown below.

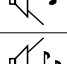
Symptoms		Checks
Picture	Sound	
 Interference	 Noisy Sound	Electrical Appliances Cars / Motorcycles Fluorescent light
 Normal Picture	 No Sound	Volume (Check whether the mute function has been activated on the remote control.)
 No Picture	 No Sound	Not plugged into AC outlet Not switched on PICTURE and BRIGHTNESS/Volume setting (Check by pressing the power switch or stand-by button on the remote control.)
 No Picture	 Normal Sound	If a signal with a non-applicable color system format, or frequency is input, only the input terminal indication is displayed.
 No Color	 Normal Sound	Color controls set at minimum level. (see page 24)
No remote control operations can be performed.		Check whether the batteries have discharged completely and, if they have not, whether they were inserted properly. Check whether the remote control sensor is exposed to an outdoor light or a strong fluorescent light. Check whether the remote control designed specifically for use with the unit is being used. (The unit cannot be operated by any other remote control.)
A cracking sound is sometimes heard from the unit.		If there is nothing wrong with the picture or sound, this is the sound of the cabinet undergoing very slight contractions in response to changes in the room temperature. There are no adverse effects on the performance or other aspects.
The top or bottom of the picture on the screen is cut off when I use the zoom function.		Adjust the position of the picture on the screen.
Areas at the top and bottom of the screen where the image is missing appear when I use the zoom function.		When using a video software program (such as a cinema size program) with a screen wider than one in the 16:9 mode, blank areas separate from the images are formed at the top and bottom of the screen.
This Plasma Display uses special image processing. Hence a slight time lag may occur between image and audio, depending on the type of input signal. However, this is not a malfunction.		

Plasma Display panel

Symptoms	Check
It takes a while for the picture to appear.	The unit digitally processes the various signals in order to reproduce esthetically pleasing images. As such, it sometimes takes a few moments for the picture to appear when the power has been turned on, when the input has been switched or when the images for the main picture and sub picture on the two screens are swapped.
The edges of the images flicker.	Due to the characteristics of the system used to drive the panel, the edges may appear to flicker in the fast-moving parts of the images: This is normal and not indicative of malfunctioning.
The brightness on both sides of images in 4:3 mode changes.	When viewing the side panels at the "BRIGHT" or "MID" setting, the brightness on both sides may change depending on the kind of program shown: This is normal and not indicative of malfunctioning.
There may be red spots, blue spots, green spots and black spots on the screen.	This is a characteristic of liquid crystal panels and is not a problem. The liquid crystal panel is built with very high precision technology giving you fine picture details. Occasionally, a few non-active pixels may appear on the screen as fixed points of red, blue, green, or black. Please note this does not affect the performance of your Plasma Display.
 <p>Image retention appears</p>	Image retention may occur. If you display a still picture for an extended period, the image might remain on the screen. However, it will disappear after a while. This is not considered as malfunction.

PC Input Signals

Applicable input signals for Mini D-sub 15P

Signal name	Horizontal frequency (kHz)	Vertical frequency (Hz)	Dot clock frequency (MHz)
640 x 480 @ 60 Hz	31.47	59.93	25.18
640 x 480 @ 72 Hz	37.86	72.81	31.5
800 x 600 @ 56 Hz	35.16	56.25	36.0
800 x 600 @ 60 Hz	37.88	60.32	40.0
800 x 600 @ 72 Hz	48.08	72.19	50.0
800 x 600 @ 75 Hz	46.88	75.00	49.5
1024 x 768 @ 60 Hz	48.36	60.00	65.0
1024 x 768 @ 70 Hz	56.48	70.07	75.0
1024 x 768 @ 75 Hz	60.02	75.03	78.75

Note: Signals without the above specifications may not be displayed properly.

Specifications

	TH-42PRT12U	
Power Source	110 - 127 V AC, 50/60 Hz	
Power Consumption		
Power on	286 W	
Stand-by condition	Under 1 W	
Aspect Ratio	16:9	
Screen size	36.2" x 20.3" x 41.6"	
(W x H x Diagonal)	(92.2 cm x 51.8 cm x 105.7 cm)	
(No. of pixels)	786,432 (1024 (W) x 768 (H))	
Operating condition		
Temperature	32 °F - 104 °F (0 °C - 40 °C)	
Humidity	20 % - 80 %	
Applicable Input signals		
PC signals	VGA, SVGA, XGA	
Connection terminals		
AV1, AV2	VIDEO IN (RCA PIN JACK x 2) 1.0 Vp-p (75 Ω) S VIDEO IN (MINI DIN 4PIN x 2) Y:1.0 Vp-p (75 Ω), C: 0.286 Vp-p (75 Ω) AUDIO IN (RCA PIN JACK x 4) 0.5 Vrms	
YPbPr	Y (RCA PIN JACK x 1) 1.0 Vp-p (75 Ω) Pb/Pr (RCA PIN JACK x 2) 0.7 Vp-p (75 Ω) AUDIO IN (RCA PIN JACK x 4) 0.5 Vrms	
PC IN	(MINI D-SUB 15PIN) G 0.7 Vp-p (75 Ω) B 0.7 Vp-p (75 Ω) R 0.7 Vp-p (75 Ω) HD/VD: 1.0 - 5.0 Vp-p (high impedance) AUDIO IN (M3 JACK) 0.5 Vrms	
HDMI1 - HDMI3	TYPE A Connector x 3	
AUDIO OUT	RCA PIN JACK x 2 0.5 Vrms	
RS-232C	EXTERNAL CONTROL TERMINAL (D-SUB 9PIN) RS-232C COMPATIBLE	
Dimensions (W x H x D)		
Including pedestal	40.5" x 27.7" x 13.1" (W 1029 x H 704 x D 334 mm)	
Display Set only	40.5" x 26.0" x 4.1" (W 1029 x H 661 x D 105 mm)	
Mass (weight)		
Including pedestal	approx. 62.2 lbs	
Display Set only	approx. 57.8 lbs	
Sound		
Audio Output	20W [10 W + 10 W] (10 % THD)	

Note:

Design and specifications are subject to change without notice. Mass and dimensions shown are approximate.

(for the U.S.A and Puerto Rico)

Panasonic Professional Display Company
 Unit of Panasonic Corporation of
 North America
 One Panasonic Way 1F-10
 Secaucus, NJ 07094

Panasonic Professional Flat Panel Display Limited Warranty

Panasonic Professional Display Company. (referred to as "the Warrantor") will repair this product and all included accessories with new or refurbished parts, free of charge in the USA or Puerto Rico, of the original purchase in the event of a defect in materials or workmanship as follows:

Models or Parts	Part Warranty	Labor Warranty
Professional Flat Panel Display	2 Years	2 Years

On-site or carry-in service in the **USA and Puerto Rico** may be obtained during the warranty period by contacting Panasonic Professional Display Company Service toll free at 1-800-973-4390.

This warranty is extended only to the original purchaser and is non transferable. A purchase receipt or other proof of date of original purchase will be required before warranty service is rendered.

This warranty only covers failures due to defects in materials or workmanship, which occur during normal use. The warranty does not cover damage which occur in shipment, or failures which are caused by products not supplied by the warrantor, or failures which result from improper installation, set-up adjustments, improper

antenna, inadequate signal pickup, maladjustment of consumer controls, improper operation, power line surge, improper voltage supply, lighting damage, or service by anyone other than an authorized repair facility, or damage that is attributable to acts of God.

LIMITS AND EXCLUSIONS

There are no express warranties except as listed above.

THE WARRANTOR SHALL NOT BE LIABLE FOR INCIDENTAL OR CONSEQUENTIAL DAMAGES (INCLUDING, WITHOUT LIMITATION, DAMAGE TO DISCS) RESULTING FROM THE USE OF THIS PRODUCT, OR ARISING OUT OF ANY BREACH OF THE WARRANTY. ALL EXPRESS AND IMPLIED WARRANTIES, INCLUDING THE WARRANTIES OF MERCHANTABILITY AND FITNESS FOR PARTICULAR PURPOSE, ARE LIMITED TO THE APPLICABLE WARRANTY PERIOD SET FORTH ABOVE.

Some states do not allow the exclusion or limitation of incidental or consequential damages, or limitations on how long an implied warranty lasts, so the above exclusions or limitations may not apply to you. This warranty gives you specific legal rights and you may other rights, which vary from state to state.

If you have a problem with this product that is not handled to your satisfaction, then write the Consumer Affairs Department at the Company address indicated above.

In the USA and Puerto Rico
 FOR SERVICE
 CALL TOLL FREE
 1-800-973-4390

(for Canada)

Panasonic Canada Inc.
 5770 Ambler Drive, Mississauga, Ontario L4W 2T3
LIMITED WARRANTY STATEMENT

Panasonic Canada Inc. (also known as PCI) warrants this product to be free of defects in material and workmanship under normal use during the applicable warranty coverage period described below. PCI agrees to repair, or at its option, exchange, any part that becomes defective. However, the product must be purchased and serviced in Canada. The product or part that shows evidence of defect must be delivered prepaid or carried in to an authorized Panasonic Broadcast Service Center. This warranty does not cover shipping costs.

The warranty coverage period is one year for both parts and labour beginning with the date of original end user purchase, subject to the exceptions as stated below. Repaired or replacement parts supplied during the warranty coverage period carry the unexpired portion of the original warranty coverage period. Proof of product purchase is a condition of warranty service. The owner must produce the product purchase receipt or other satisfactory evidence of date of original purchase.

This warranty does not apply to external appearance items, such as handles, knobs, safety windows, etc. This warranty does not apply to any part, or parts, of the product, installed, altered, repaired or misused in any way that, in the opinion of PCI, affects the reliability of or detracts from the performance of the product.

For products requiring routine preventive maintenance, that maintenance must be performed in order to maintain warranty coverage.

Serial numbers that have been altered, defaced or removed void this warranty. This warranty does not cover replacements or repairs necessitated by loss or damage resulting from any cause beyond the control of PCI.

Marking or retained images (sometimes called "burn-in") resulting from the display of fixed images on video display products are not defects and are not covered under this warranty.

THIS EXPRESS, LIMITED WARRANTY IS IN LIEU OF ALL OTHER WARRANTIES, EXPRESS OR IMPLIED, INCLUDING ANY IMPLIED WARRANTIES OF MERCHANTABILITY AND FITNESS FOR A PARTICULAR PURPOSE. IN NO EVENT WILL PANASONIC CANADA INC. BE LIABLE FOR ANY SPECIAL, INDIRECT OR CONSEQUENTIAL DAMAGES.

In certain instances, some jurisdictions do not allow the exclusion or limitation of incidental or consequential damages, or the exclusion of implied warranties, so the above limitations and exclusions may not be applicable.

WARRANTY COVERAGE PERIOD EXCEPTIONS

Item	Parts	Labour
Video Tape	30 days—Replacement only (content not covered)	N/A
P2/SD Cards	(Content not covered)	N/A
Video Heads	1 year or 2,000 hrs. (prorated) Whichever comes first	1 year or 2,000 hrs. Whichever comes first
D5 Video heads	1 year or 1,000 hrs. Whichever comes first	1 year or 1,000 hrs. Whichever comes first
Maintenance Items	90 days	90 days
Colour Camera CCD Imaging Block	2 years	1 year
BT-H Series LCD Monitors	2 years	1 year
* DLP™ Projectors	3 years or 17,000 hrs. Whichever comes first	3 years or 17,000 hrs. Whichever comes first
* LCD Projectors above 2,500 ANSI Lumens	3 years or 2,500 hrs. Whichever comes first	3 years or 2,500 hrs. Whichever comes first.
* LCD Projectors below 2,500 ANSI Lumens	3 years or 1,500 hrs. Whichever comes first	3 years or 1,500 hrs. Whichever comes first
Projector Lamps	50% of the rated lamp life or 1 year. Whichever comes first	50% of the rated lamp life or 1 year. Whichever comes first.
103 inch Plasma displays	3 year (burn-in not covered)	3 year
Hard Drive Disk Unit	1 year plus balance (if any) of the original Manufacturer's Limited Warranty. (Content not covered)	1 year

- Dust, smoke, rental/staging environment and twenty-four/seven operation, dramatically decreases the interval between performances of routine preventive maintenance required to maintain this warranty coverage.

Warranty Service

If the product needs to be shipped for service, carefully pack (preferably in the original carton) and enclose a letter, detailing the complaint. Send prepaid and adequately insured to the local authorized Panasonic Service Centre in your area or to Panasonic Technical Support and Product Services Department, 5770 Ambler Drive, Mississauga, Ontario, L4W 2T3. Shipping to the latter location requires a return authorization before shipment. No liability is assumed for loss or damage to the product while in transit.

Customer Service

Customer Service Directory

Obtain information products and operative assistant; localize the closer distributor or Service Center; buy spare parts and accessories by our web site to Latin American:

<http://www.lar.panasonic.com>

Also you may contact us directly by our Contact Center:

Panama	800-PANA (800-7262)
Colombia	1-8000-94PANA (1-8000-947262) - National Line 635-PANA (635-7262) - Bogota Line
Ecuador	1800-PANASONIC (1800-726276)
Costa Rica	800-PANA737 (800-7262737)
El Salvador	800-PANA (800-7262)
Guatemala	1-801-811-PANA (1-801-811-7262)
Chile	800-260602 From a cell phone: 245-2520
Venezuela	800-PANA-800 (800-7262-800)
Uruguay	0-800-PANA (0800-7262)

Mexico Service

To obtain information in the Republic of Mexico contact us at:

[email: atencion.clientes@mx.panasonic.com](mailto:atencion.clientes@mx.panasonic.com)

Or you may contact us in the next following phones numbers:

01800-VIP-PANA (01800-847-7262) - Interior
(55) 5000-1200 - Mexico D.F. and Metropolitan Area

Customer's Record

The model number and serial number of this product can be found on its back cover. You should note this serial number in the space provided below and retain this book, plus your purchase receipt, as a permanent record of your purchase to aid in identification in the event of theft or loss, and for Warranty Service purposes.

Model Number _____

Serial Number _____

© Panasonic Corporation 2009

Panasonic Professional Display Company

Unit of Panasonic Corporation of North America

Executive Office :

One Panasonic Way 1F-10, Secaucus, NJ 07094

EASTERN ZONE : One Panasonic Way 4E-7 Secaucus, NJ 07094 (201) 348-7621

Mid-Atlantic/New England : One Panasonic Way 4E-7 Secaucus, NJ 07094 (201) 348-7621

Southeast Region : 1225 Northbrook Parkway, Ste 1-160 Suwanee GA 30024 (770)338-6835

Central Region : 1707 N Randall Road E1-C-1, Elgin, IL 60123 (847)468-5200

WESTERN ZONE : 3330 Cahuenga Blvd W., Los Angeles, CA 90068 (323) 436-3500

Dallas Region : 6226 Abington Way, Houston, TX 77008 (713) 802-2726

No. CA/Northwest Region : 5870 Stone Ridge, #3, Pleasanton, CA (925) 416-5108

Government Marketing Department : 52 West Gude Drive, Rockville, MD 20850 (301) 738-3840

Panasonic Canada Inc.

5770 Ambler Drive

Mississauga, Ontario

L4W 2T3

Printed in Taiwan.