

Panasonic®

Basic Owner's Manual

Digital Camera

Model No. DMC-FH25

DMC-FH24

DMC-FH5

DMC-FH2

LUMIX

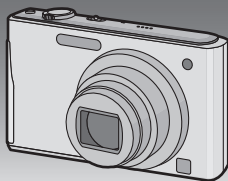

Before connecting, operating or adjusting this product, please read the instructions completely.



More detailed instructions on the operation of this camera are contained in "Owner's Manual for advanced features (PDF format)" in the supplied CD-ROM. Install it on your PC to read it.



For USA and Puerto Rico assistance, please call: 1-800-211-PANA(7262) or, contact us via the web at: <http://www.panasonic.com/contactinfo>



VQT3D29

Dear Customer,

Thank you for choosing Panasonic!

You have purchased one of the most sophisticated and reliable products on the market today. Used properly, we're sure it will bring you and your family years of enjoyment. Please take time to fill in the information on the below. The serial number is on the tag located on the underside of your Camera. Be sure to **retain this manual** as your convenient Camera information source. Please note that the actual controls and components, menu items, etc. of your Digital Camera may look somewhat different from those shown in the illustrations in this Owner's Manual.

Carefully observe copyright laws.

- Recording of pre-recorded tapes or discs or other published or broadcast material for purposes other than your own private use may infringe copyright laws. Even for the purpose of private use, recording of certain material may be restricted.

Model No. _____

Serial No. _____



A lithium ion battery that is recyclable powers the product you have purchased. Please call 1-800-8-BATTERY for information on how to recycle this battery.

Information for Your Safety

WARNING:

TO REDUCE THE RISK OF FIRE, ELECTRIC SHOCK OR PRODUCT DAMAGE,

- **DO NOT EXPOSE THIS APPARATUS TO RAIN, MOISTURE, DRIPPING OR SPLASHING AND THAT NO OBJECTS FILLED WITH LIQUIDS, SUCH AS VASES, SHALL BE PLACED ON THE APPARATUS.**
- **USE ONLY THE RECOMMENDED ACCESSORIES.**
- **DO NOT REMOVE THE COVER (OR BACK); THERE ARE NO USER SERVICEABLE PARTS INSIDE. REFER SERVICING TO QUALIFIED SERVICE PERSONNEL.**

THE SOCKET OUTLET SHALL BE INSTALLED NEAR THE EQUIPMENT AND SHALL BE EASILY ACCESSIBLE.

■ Product identification marking

Product	Location
Digital camera	Bottom
Battery charger	Bottom

FC **Panasonic**
DMC-FH25

FC **Panasonic**
DMC-FH24

FC **Panasonic**
DMC-FH5

FC **Panasonic**
DMC-FH2

FCC Note:

This equipment has been tested and found to comply with the limits for a Class B digital device, pursuant to Part 15 of the FCC Rules. These limits are designed to provide reasonable protection against harmful interference in a residential installation. This equipment generates, uses, and can radiate radio frequency energy and, if not installed and used in accordance with the instructions, may cause harmful interference to radio communications. However, there is no guarantee that interference will not occur in a particular installation. If this equipment does cause harmful interference to radio or television reception, which can be determined by turning the equipment off and on, the user is encouraged to try to correct the interference by one or more of the following measures:

- Reorient or relocate the receiving antenna.
- Increase the separation between the equipment and receiver.
- Connect the equipment into an outlet on a circuit different from that to which the receiver is connected.
- Consult the dealer or an experienced radio/TV technician for help.

FCC Caution: To assure continued compliance, follow the attached installation instructions and use only shielded interface cables with ferrite core when connecting to computer or peripheral devices.

Any changes or modifications not expressly approved by the party responsible for compliance could void the user's authority to operate this equipment.

Declaration of Conformity

Trade Name: Panasonic

Model No.: DMC-FH25

DMC-FH24

DMC-FH5

DMC-FH2

Responsible party: Panasonic Corporation of North America
One Panasonic Way, Secaucus, NJ 07094

Support Contact: Panasonic Consumer Electronics Company
1-800-211-PANA (7262)

This device complies with Part 15 of the FCC Rules. Operation is subject to the following two conditions: (1) This device may not cause harmful interference, and (2) this device must accept any interference received, including interference that may cause undesired operation.

■ About the battery pack

CAUTION

Battery pack (Lithium ion battery pack)

- Use the specified unit to recharge the battery pack.
- Do not use the battery pack with equipment other than the specified unit.
- Do not get dirt, sand, liquids, or other foreign matter on the terminals.
- Do not touch the plug terminals (+ and –) with metal objects.
- Do not disassemble, remodel, heat or throw into fire.

If any electrolyte should come into contact with your hands or clothes, wash it off thoroughly with water.

If any electrolyte should come into contact with your eyes, never rub the eyes. Rinse eyes thoroughly with water, and then consult a doctor.

CAUTION

Danger of explosion if battery is incorrectly replaced. Replace only with the same or equivalent type recommended by the manufacturer. Dispose of used batteries according to the manufacturer's instructions.

- Do not heat or expose to flame.
- Do not leave the battery(ies) in an automobile exposed to direct sunlight for a long period of time with doors and windows closed.

Warning

Risk of fire, explosion and burns. Do not disassemble, heat above 60 °C (140 °F) or incinerate.

■ About the battery charger

CAUTION!

DO NOT INSTALL OR PLACE THIS UNIT IN A BOOKCASE, BUILT-IN CABINET OR IN ANOTHER CONFINED SPACE. ENSURE THE UNIT IS WELL VENTILATED. TO PREVENT RISK OF ELECTRIC SHOCK OR FIRE HAZARD DUE TO OVERHEATING, ENSURE THAT CURTAINS AND ANY OTHER MATERIALS DO NOT OBSTRUCT THE VENTILATION VENTS.

Battery charger

This battery charger operates on AC between 110 V and 240 V.

But

- In the U.S.A. and Canada, the battery charger must be connected to a 120 V AC power supply only.
- When connecting to an AC supply outside of the U.S.A. or Canada, use a plug adaptor to suit the AC outlet configuration.

■ Cautions for Use

- **DMC-FH25** **DMC-FH5** **DMC-FH2**
Do not use any other AV cables except the supplied one.

- **DMC-FH24**
Always use a genuine Panasonic AV cable (DMW-AVC1; optional).
- Do not use any other USB connection cables except the supplied one.

Keep this unit as far away as possible from electromagnetic equipment (such as microwave ovens, TVs, video games etc.).

- If you use this unit on top of or near a TV, the pictures and/or sound on this unit may be disrupted by electromagnetic wave radiation.
- Do not use this unit near cell phones because doing so may result in noise adversely affecting the pictures and/or sound.
- Recorded data may be damaged, or pictures may be distorted, by strong magnetic fields created by speakers or large motors.
- Electromagnetic wave radiation generated by microprocessors may adversely affect this unit, disturbing the pictures and/or sound.
- If this unit is adversely affected by electromagnetic equipment and stops functioning properly, turn this unit off and remove the battery or disconnect AC adaptor (DMW-AC5PP; optional). Then reinsert the battery or reconnect AC adaptor and turn this unit on.

Do not use this unit near radio transmitters or high-voltage lines.

- If you record near radio transmitters or high-voltage lines, the recorded pictures and/or sound may be adversely affected.

-If you see this symbol-

Information on Disposal in other Countries outside the European Union

This symbol is only valid in the European Union.
If you wish to discard this product, please contact your local authorities or dealer and ask for the correct method of disposal.



Contents

Information for Your Safety	3
Standard Accessories	9
Names of the Components	10
Charging the Battery	13
• Charging	13
• Approximate operating time and number of recordable pictures	15
About the Built-in Memory/the Card	16
Inserting and Removing the Card (optional)/the Battery	17
Setting Date/Time (Clock Set).....	19
• Changing the Clock Setting	19
Selecting the [Rec] Mode	20
Taking pictures using the automatic function (IA : Intelligent Auto Mode)	21
• Scene Detection.....	22
Motion Picture Mode	23
Playing Back Pictures ([Normal Play])	24
Deleting Pictures	24
Setting the Menu	25
Reading the Owner's Manual (PDF format)	26
Specifications	28
Digital Camera Accessory System	32
Digital Camera Accessory Order Form	33
Limited Warranty (ONLY FOR U.S.A. AND PUERTO RICO)	34

■ About illustrations in this owner's manual

The procedure is described for **DMC-FH25** as an example.

Standard Accessories

Check that all the accessories are supplied before using the camera.
Product numbers correct as of January 2011. These may be subject to change.

- 1 Battery Pack*
(Indicated as **battery pack** or **battery** in the text)
Charge the battery before use.
- 2 Battery Charger
(Indicated as **battery charger** or **charger** in the text)
- 3 USB Connection Cable
- 4 **DMC-FH25** **DMC-FH5** **DMC-FH2**
AV Cable
- 5 CD-ROM
 - Software:
Use it to install the software to your PC.
 - Owner's Manual
- 6 Hand Strap





* When purchasing a spare battery, please purchase an optional battery (DMW-BCK7PP).

• SD Memory Card, SDHC Memory Card and SDXC Memory Card are indicated as **card** in the text.

• **The card is optional.**
You can record or play back pictures on the built-in memory when you are not using a card.

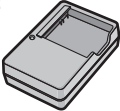
• For information about optional accessories, refer to the "Digital Camera Accessory System".

• If any accessories are lost, customers should contact Panasonic's parts department at 1 800 833-9626 for further information about obtaining replacement parts.

<p>1</p>  <p>NCA-YN101G</p>	<p>2</p>  <p>DE-A91B</p>
<p>3</p> 	<p>DMC-FH25 DMC-FH24 K1HY08YY0019</p> <p>DMC-FH5 DMC-FH2 K1HY08YY0015</p>
<p>4</p> 	<p>DMC-FH25 K1HY08YY0020</p> <p>DMC-FH5 DMC-FH2 K1HY08YY0016</p>
<p>5</p>  <p>VFF0726</p>	<p>6</p>  <p>VFC4297</p>

Names of the Components

- 1 Flash
- 2 Lens
- 3 Self-timer indicator
AF Assist Lamp

DMC-FH25 DMC-FH24

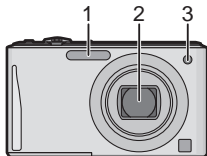

DMC-FH5 DMC-FH2

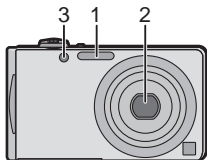

- 4 LCD monitor
- 5 [MENU/SET] button
- 6 [DISP.] button
- 7 [Q.MENU]/Delete/Cancel button
- 8 [MODE] button
- 9 [Rec]/[Playback] selector switch

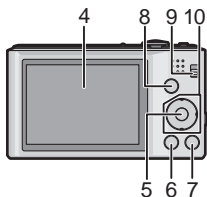

10 Cursor buttons

- (A): ▲/Exposure compensation
- (B): ▼/Macro Mode
AF Tracking
- (C): ◀/Self-timer
- (D): ▶/Flash setting

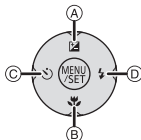

In this owner's manual, the cursor buttons are described as shown in the figure below or described with ▲/▼/◀/▶.
e.g.: When you press the ▼ (down) button

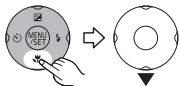

or **Press ▼**

11 Strap eyelet

- Be sure to attach the strap when using the camera to ensure that you will not drop it.

12 Lens barrel

13 [AV OUT/DIGITAL] socket

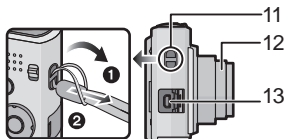

- 14 Camera ON/OFF switch
15 Zoom lever
16 Speaker
- Do not cover the speaker with your fingers.

- 17 Microphone
18 Shutter button

- 19 **DMC-FH25** **DMC-FH24**
[E.ZOOM] button

- 20 Tripod receptacle
21 Card/Battery door

- 22 DC coupler cover

- When using an AC adaptor, ensure that the Panasonic DC coupler (DMW-DCC10; optional) and AC adaptor (DMW-AC5PP; optional) are used.
- Always use a genuine Panasonic AC adaptor (DMW-AC5PP; optional).
- It is recommended to use a fully charged battery or AC adaptor (DMW-AC5PP; optional) and DC coupler (DMW-DCC10; optional) when recording motion pictures.
- If while recording motion pictures using the AC adaptor and the power supply is cut off due to a power outage or if the AC adaptor is disconnected etc., the motion picture being recorded will not be recorded.

- 23 **DMC-FH5** **DMC-FH2**
Release lever

DMC-FH25 **DMC-FH24**

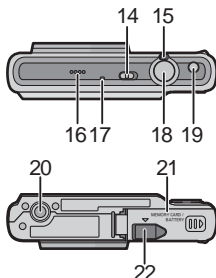

DMC-FH5 **DMC-FH2**

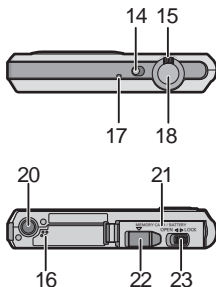

Charging the Battery

■ About batteries that you can use with this unit

Supplied battery or dedicated optional batteries (DMW-BCK7PP) can be used with this unit.

It has been found that counterfeit battery packs which look very similar to the genuine product are made available to purchase in some markets. Some of these battery packs are not adequately protected with internal protection to meet the requirements of appropriate safety standards. There is a possibility that these battery packs may lead to fire or explosion. Please be advised that we are not liable for any accident or failure occurring as a result of use of a counterfeit battery pack. To ensure that safe products are used we would recommend that a genuine Panasonic battery pack is used.

- Use the dedicated charger and battery.

Charging

- The battery is not charged when the camera is shipped. Charge the battery before use.
- Charge the battery with the charger indoors.

- 1** Attach the battery paying attention to the direction of the battery.



- 2** Connect the charger to the electrical outlet.

- Disconnect the charger from the electrical socket and detach the battery after charging is completed.

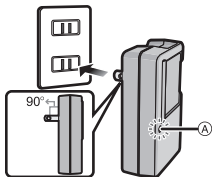

■ About the [CHARGE] indicator

The [CHARGE] indicator turns on:

The [CHARGE] indicator (A) is turned on during charging.

The [CHARGE] indicator turns off:

The [CHARGE] indicator (A) will turn off once the charging has completed without any problem.

• When the [CHARGE] indicator flashes

- The battery temperature is too high or too low. It is recommended to charge the battery again in an ambient temperature of between 10 °C to 30 °C (50 °F to 86 °F).
- The terminals of the charger or the battery are dirty. In this case, wipe them with a dry cloth.

■ Charging time

	Supplied battery	Optional battery
Charging time	Approx. 115 min	Approx. 120 min

Approximate operating time and number of recordable pictures

DMC-FH25 DMC-FH24

	Supplied battery	Optional battery
Capacity of the battery	660 mAh	680 mAh
Number of recordable pictures	Approx. 250 pictures	Approx. 255 pictures
Recording time	Approx. 125 min	Approx. 127 min

DMC-FH5

	Supplied battery	Optional battery
Capacity of the battery	660 mAh	680 mAh
Number of recordable pictures	Approx. 260 pictures	Approx. 265 pictures
Recording time	Approx. 130 min	Approx. 132 min

DMC-FH2

	Supplied battery	Optional battery
Capacity of the battery	660 mAh	680 mAh
Number of recordable pictures	Approx. 270 pictures	Approx. 275 pictures
Recording time	Approx. 135 min	Approx. 137 min

Recording conditions by CIPA standard

- CIPA is an abbreviation of [Camera & Imaging Products Association].
- Normal Picture Mode
- Temperature: 23 °C (73.4 °F)/Humidity: 50%RH when LCD monitor is on.
- Using a Panasonic SD Memory Card (32 MB).
- Starting recording 30 seconds after the camera is turned on. (When the Optical Image Stabilizer function is set to [ON].)
- **Recording once every 30 seconds** with full flash every second recording.
- Rotating the zoom lever from Tele to Wide or vice versa in every recording.
- Turning the camera off every 10 recordings and leaving it until the temperature of the battery decreases.

	Supplied battery	Optional battery
Playback time	Approx. 200 min	Approx. 205 min

About the Built-in Memory/the Card

Built-in Memory

- **Memory size: Approx. 70 MB**
- The access time for the built-in memory may be longer than the access time for a card.

Card

The following cards, which conform to the SD video standard, can be used with this unit.

(These cards are indicated as **card** in the text.)

Type of card which can be used with this unit	Remarks
SD Memory Card (8 MB to 2 GB)	<ul style="list-style-type: none">• Use a card with SD Speed Class* with “Class 6” or higher when recording motion pictures.• SDHC Memory Card can be used with SDHC Memory Card or SDXC Memory Card compatible equipment.• SDXC Memory Card can only be used with SDXC Memory Card compatible equipment.• Check that the PC and other equipment are compatible when using the SDXC Memory Cards. http://panasonic.net/avc/sdcard/information/SDXC.html• Only the cards with capacity listed left can be used.
SDHC Memory Card (4 GB to 32 GB)	
SDXC Memory Card (48 GB, 64 GB)	

* SD Speed Class is the speed standard regarding continuous writing. Check via the label on the card, etc.

e.g.:



- Please check the website for updated information:
<http://panasonic.jp/support/global/cs/dsc/>
(This Site is English only.)

-  **Note**
- Keep the Memory Card out of reach of children to prevent swallowing.

Inserting and Removing the Card (optional)/the Battery

- Check that this unit is turned off.
- We recommend using a Panasonic card.

DMC-FH25 DMC-FH24

1 Slide the card/battery door to open it.

- Always use genuine Panasonic batteries (NCA-YN101G; supplied or DMW-BCK7PP; optional).
- If you use other batteries, we cannot guarantee the quality of this product.

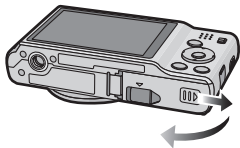

2 Battery: Being careful about the battery orientation, insert all the way until you hear a locking sound and then check that it is locked by lever (A). Pull the lever (A) in the direction of the arrow to remove the battery.

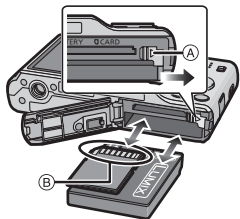

Card: Push it securely all the way until you hear a “click” while being careful about the direction in which you insert it. To remove the card, push the card until it clicks, then pull the card out upright.

(B): Do not touch the connection terminals of the card.

3 ①: Close the card/battery door.

②: Firmly slide the card/battery door to the end until you hear a locking sound.

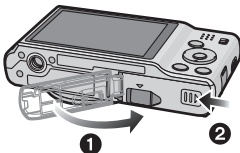

1 Slide the release lever in the direction of the arrow and open the card/battery door.

- Always use genuine Panasonic batteries (NCA-YN101G; supplied or DMW-BCK7PP; optional).
- If you use other batteries, we cannot guarantee the quality of this product.

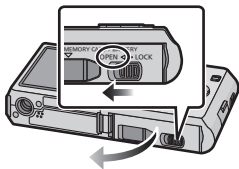

2 **Battery:** Being careful about the battery orientation, insert all the way until you hear a locking sound and then check that it is locked by lever (A).

Card: Push it securely all the way until you hear a “click” while being careful about the direction in which you insert it. To remove the card, push the card until it clicks, then pull the card out upright.

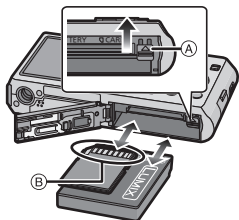

(B): Do not touch the connection terminals of the card.

3 **1:** Close the card/battery door.

2: Slide the release lever in the direction of the arrow.

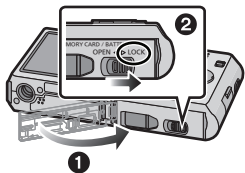

Setting Date/Time (Clock Set)

• The clock is not set when the camera is shipped.

1 Slide the [Rec]/[Playback] selector switch to [📷] and then turn the camera on.

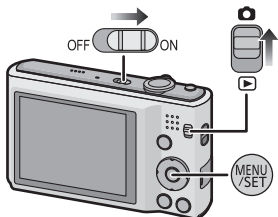

2 Press [MENU/SET].

3 Press ◀/▶ to select the items (year, month, day, hour, minute, display sequence or time display format), and press ▲/▼ to set.



• You can cancel without setting the clock by pressing [🗑️]/[↶].

4 Press [MENU/SET] to set.

5 Press [MENU/SET].

Changing the Clock Setting

Select [Clock Set] in the [Rec] or [Setup] menu, and press [MENU/SET].

• It can be changed in steps **3** and **4** to set the clock.

Selecting the [Rec] Mode

- 1** Slide the [Rec]/[Playback] selector switch to [📷].
- 2** Press [MODE].
- 3** Press ▲/▼/◀/▶ to select the mode.
- 4** Press [MENU/SET].

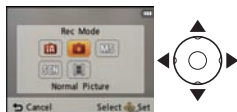
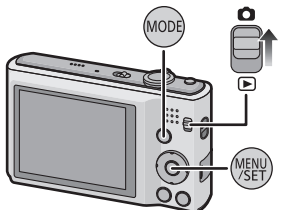

■ List of [Rec] Modes

iA Intelligent Auto Mode
The subjects are recorded using settings automatically selected by the camera.
📷 Normal Picture Mode
The subjects are recorded using your own settings.
MS My Scene Mode
Pictures are taken using previously registered recording scenes.
SCN Scene Mode
This allows you to take pictures that match the scene being recorded.
🎞 Motion Picture Mode
This mode allows you to record motion pictures with audio.



[Rec] Mode: 

Taking pictures using the automatic function (: Intelligent Auto Mode)

The camera will set the most appropriate settings to match the subject and the recording conditions so we recommend this mode for beginners or those who want to leave the settings to the camera and take pictures easily.

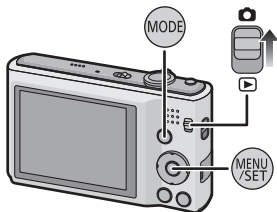
- 1** Slide the [Rec]/[Playback] selector switch to , and then press [MODE].



- 2** Press /// to select [Intelligent Auto], and then press [MENU/SET].

- 3** Press the shutter button halfway to focus.

- The focus indication ① (green) lights when the subject is focused.
- The AF area ② is displayed around the subject's face by the Face Detection function. In other cases, it is displayed at the point on the subject which is in focus.









- 4** Press the shutter button fully (push it in further), and take the picture.



Scene Detection

When the camera identifies the optimum scene, the icon of the scene concerned is displayed in blue for 2 seconds, after which its color changes to the usual red.

 →	 [i-Portrait]	
	 [i-Scenery]	
	 [i-Macro]	
	 [i-Night Portrait]	• Only when [iA] is selected
	 [i-Night Scenery]	
	 [i-Sunset]	

- [iA] is set if none of the scenes are applicable, and the standard settings are set.
- When [iA] or [iA] is selected, the camera automatically detects a person's face, and it will adjust the focus and exposure. **(Face Detection)**

Motion Picture Mode

- 1 Slide the [Rec]/[Playback] selector switch to , and then press [MODE].

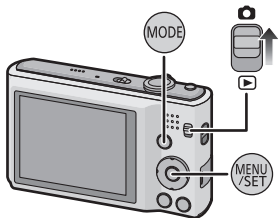

- 2 Press /// to select [Motion Picture], and then press [MENU/SET].

- 3 Press the shutter button halfway to focus and then press it fully to start recording.

(A) Available recording time

(B) Elapsed recording time

- The focus and zoom are fixed to the setting when recording starts (the first frame).

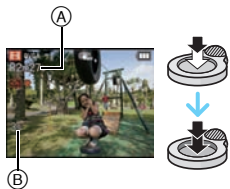

- 4 Press the shutter button fully to stop recording.

Note

- Motion pictures can be recorded continuously up to 2 GB. The maximum available recording time for up to 2 GB only is displayed on the screen.

[Playback] Mode: 

Playing Back Pictures ([Normal Play])

- 1 Slide the [Rec]/[Playback] selector switch to .

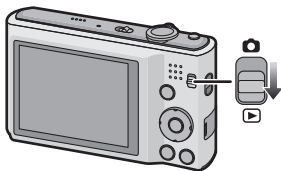

- 2 Press ◀ or ▶.

- After selecting the motion picture, press ▲ to start playback.



[Playback] Mode: 

Deleting Pictures

Once deleted, pictures cannot be recovered.

- Pictures on the built-in memory or the card that are being played back will be deleted.

Select the picture to be deleted, and then press / .

- Confirmation screen is displayed.
Picture is deleted by selecting [Yes].

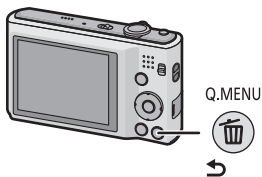

Setting the Menu

1 Press [MENU/SET].



2 Press ◀/▶ to select menu and then press [MENU/SET].

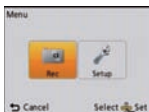

3 Press ▲/▼ to select the menu item and then press [MENU/SET].

- Screen at right is an example of selecting [AF Mode] in [Rec] mode Menu.

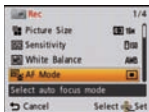

4 Press ▲/▼ to select the setting and then press [MENU/SET].

- Depending on the menu item, its setting may not appear or it may be displayed in a different way.
- Screen at right is an example to set the [AF Mode] from [□] (1-area-focusing) to [👤] (Face Detection).

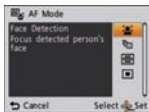

■ Close the menu

Press [🗑️/↶] several times or press the shutter button halfway.

Reading the Owner's Manual (PDF format)

More detailed instructions on the operation of this camera are contained in “Owner's Manual for Advanced Features (PDF format)” in the supplied CD-ROM. Install it on your PC to read it.

■ For Windows

- 1** Turn the PC on and insert the CD-ROM containing the Owner's Manual (supplied).
- 2** Click the [Owner's Manual].
- 3** Select the desired language and then click [Owner's Manual] to install.
Ⓐ To return to the install menu.
- 4** Double click the “Owner's Manual” shortcut icon on the desktop.

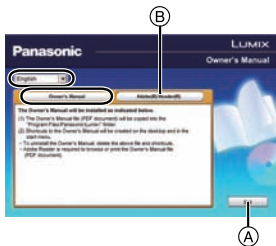

■ When the Owner's Manual (PDF format) will not open

You will need Adobe Acrobat Reader 5.0 or later or Adobe Reader 7.0 or later to browse or print the Owner's Manual (PDF format).

Insert the CD-ROM containing the Owner's Manual (supplied), click  and then follow the messages on the screen to install.

(Compatible OS: Windows 2000 SP4/Windows XP SP3/Windows Vista SP2/Windows 7)

- You can download and install a version of Adobe Reader that you can use with your OS from the following Web Site.

<http://get.adobe.com/reader/otherversions>

■ To uninstall the Owner's Manual (PDF format)

Delete the PDF file from the "Program Files\Panasonic\Lumix\" folder.

- When the contents in the Program Files folder cannot be displayed, click the [Show the contents of this folder] to display them.

■ For Macintosh

1

Turn the PC on and insert the CD-ROM containing the Owner's Manual (supplied).

2

Open the "Manual" folder in the CD-ROM and then copy the PDF file with the desired language inside the folder.

3

Double click the PDF file to open it.

Specifications



Digital Camera:

Information for your safety

Power Source:	DC 5.1 V
Power Consumption:	1.1 W (When recording) 0.7 W (When playing back)

Camera effective pixels	DMC-FH25 DMC-FH24 DMC-FH5 16,100,000 pixels
	DMC-FH2 14,100,000 pixels
Image sensor	DMC-FH25 DMC-FH24 DMC-FH5 1/2.33" CCD, total pixel number 16,600,000 pixels, Primary color filter
	DMC-FH2 1/2.33" CCD, total pixel number 14,500,000 pixels, Primary color filter
Lens	DMC-FH25 DMC-FH24 Optical 8× zoom, f=5 mm to 40 mm (35 mm film camera equivalent: 28 mm to 224 mm)/F3.3 (Wide) to F5.9 (Tele)
	DMC-FH5 DMC-FH2 Optical 4× zoom, f=5 mm to 20 mm (35 mm film camera equivalent: 28 mm to 112 mm)/F3.1 (Wide) to F6.5 (Tele)
Digital zoom	Max. 4×
Extended optical zoom	DMC-FH25 DMC-FH24 Max. 18× (When set to 3,000,000 pixels [3M] or less)
	DMC-FH5 Max. 9× (When set to 3,000,000 pixels [3M] or less)
	DMC-FH2 Max. 8.4× (When set to 3,000,000 pixels [3M] or less)

Focus range	Normal	DMC-FH25 DMC-FH24 50 cm (1.64 feet) (Wide)/2 m (6.56 feet) (Tele) to ∞
		DMC-FH5 DMC-FH2 50 cm (1.64 feet) (Wide)/1 m (3.28 feet) (Tele) to ∞
	Macro/ Intelligent auto/ Motion picture	5 cm (0.17 feet) (Wide)/1 m (3.28 feet) (Tele) to ∞
	Scene Mode	There may be differences in the above settings.
Shutter system	Electronic shutter+Mechanical shutter	
Burst recording		
Burst speed	DMC-FH25 DMC-FH24 Approx. 1.7 pictures/second	
	DMC-FH5 DMC-FH2 Approx. 2.0 pictures/second	
Number of recordable pictures	Depends on the remaining capacity of the built-in memory/card.	
Hi-speed burst		
Burst speed	DMC-FH25 DMC-FH24 Approx. 4 pictures/second	
	DMC-FH5 DMC-FH2 Approx. 6 pictures/second	
	[3M (4:3), 2.5M (3:2) or 2M (16:9) is selected as the picture size.]	
Number of recordable pictures	When using the built-in memory: Approx. 15 pictures (immediately after formatting) When using a Card: Max. 100 pictures (differs depending on the type of Card and the recording conditions)	
Shutter speed	8 seconds to 1/1600th of a second [Starry Sky] Mode: 15 seconds, 30 seconds, 60 seconds	
Exposure (AE)	Program AE Exposure compensation (1/3 EV Step, -2 EV to +2 EV)	
Metering mode	Multiple	

LCD monitor	2.7" TFT LCD (4:3) (Approx. 230,000 dots) (field of view ratio about 100%)
Flash range	DMC-FH25 DMC-FH24 Approx. 60 cm (1.97 feet) to 5.8 m (19.0 feet) (Wide, [ ISO] is set)
	DMC-FH5 DMC-FH2 Approx. 40 cm (1.32 feet) to 3.3 m (10.8 feet) (Wide, [ ISO] is set)
Microphone	Monaural
Speaker	Monaural
Recording media	Built-in Memory (Approx. 70 MB)/SD Memory Card/ SDHC Memory Card/SDXC Memory Card
Recording file format	
Still Picture	JPEG (based on "Design rule for Camera File system", based on "Exif 2.3" standard)/DPOF corresponding
Motion pictures	"QuickTime Motion JPEG" (motion pictures with audio)
Interface	
Digital	"USB 2.0" (High Speed)
Analog video/ audio	NTSC, Audio line output (monaural)
Terminal	
[AV OUT/ DIGITAL]	Dedicated jack (8 pin)
Dimensions (excluding the projecting parts)	DMC-FH25 DMC-FH24 Approx. 99.2 mm (W)×56.5 mm (H)×27.8 mm (D) [3.9"(W)×2.2"(H)×1.1"(D)]
	DMC-FH5 DMC-FH2 Approx. 94.3 mm (W)×53.5 mm (H)×18.8 mm (D) [3.7"(W)×2.1"(H)×0.7"(D)]

Mass (weight)	DMC-FH25 DMC-FH24 Approx. 152 g/0.33 lb (with card and battery) Approx. 135 g/0.30 lb (excluding card and battery)
	DMC-FH5 Approx. 121 g/0.27 lb (with card and battery) Approx. 104 g/0.23 lb (excluding card and battery)
	DMC-FH2 Approx. 118 g/0.26 lb (with card and battery) Approx. 101 g/0.22 lb (excluding card and battery)
Operating temperature	0 °C to 40 °C (32 °F to 104 °F)
Operating humidity	10%RH to 80%RH
Language select	[ENGLISH]/[ESPAÑOL]

Battery Charger (Panasonic DE-A91B):

Information for your safety

Input:	~ 110 V to 240 V, 50/60 Hz, 0.2 A
Output:	== 4.2 V, 0.43 A





Equipment mobility: Movable

Battery Pack (lithium-ion) (Panasonic NCA-YN101G):

Information for your safety

Voltage/capacity:	3.6 V/660 mAh
--------------------------	---------------

Digital Camera Accessory System

Accessory#	Illustration	Description
DMW-BCK7PP		Battery Pack
DMW-AC5PP		AC Adaptor *1
DMW-DCC10		DC Coupler *1
DMW-AVC1		AV Cable *2
RP-SDW64GU1K RP-SDW48GU1K RP-SDW32GU1K RP-SDW16GU1K RP-SDW08GU1K RP-SDW04GU1K		Class 10 64 GB SDXC Memory Card Class 10 48 GB SDXC Memory Card Class 10 32 GB SDHC Memory Card Class 10 16 GB SDHC Memory Card Class 10 8 GB SDHC Memory Card Class 10 4 GB SDHC Memory Card
RP-SDN16GU1A RP-SDN08GU1A RP-SDN04GU1A RP-SDN02GU1A		Class 4 16 GB SDHC Memory Card Class 4 8 GB SDHC Memory Card Class 4 4 GB SDHC Memory Card Class 4 2 GB SD Memory Card

Product numbers correct as of January 2011. These may be subject to change.

*1 The AC Adaptor (optional) can only be used with the designated Panasonic DC Coupler (optional). The AC adaptor (optional) cannot be used by itself.

*2 **DMC-FH24** only

•NOTE: Accessories and/or model numbers may vary between countries. Consult your local dealer.

Digital Camera Accessory Order Form

Please photocopy this form when placing an order.

1. Digital Camera Model # _____

2. Items Ordered

Accessory #	Description	Price Each	Quantity	Total Price
Subtotal				
Your State & Local Sales Tax				
Shipping & Handling				6.95
Total Enclosed				

3. Method of payment (check one)

- Check of Money Order enclosed (NO C.O.D.SHIPMENTS)
- VISA Credit Card # _____
- MasterCard Expiration Date _____
- Discover Customer Signature _____

Make Check or Money Order to: PANASONIC ACCESSORIES

(Please do not send cash)

4. Shipping information (UPS delivery requires complete street address)

Ship To:

Mr.

Mrs.

Ms. _____

First

Last

Phone#:

Day () _____

Street Address

Night () _____

City

State

Zip

TO OBTAIN ANY OF OUR DIGITAL CAMERA ACCESSORIES YOU CAN DO ANY OF THE FOLLOWING:

VISIT YOUR LOCAL PANASONIC DEALER

OR

CALL PANASONIC'S ACCESSORY ORDER LINE AT 1-800-332-5368

[6 AM-6 PM M-F, PACIFIC TIME]

OR

MAIL THIS ORDER TO: PANASONIC SERVICE AND TECHNOLOGY COMPANY

ACCESSORY ORDER OFFICE

20421 84th Avenue South Kent, WA. 98032

Limited Warranty (ONLY FOR U.S.A. AND PUERTO RICO)

Panasonic Consumer Electronics Company,
Division of Panasonic Corporation of North America
One Panasonic Way, Secaucus, New Jersey 07094

Panasonic Digital Still Camera Products Limited Warranty

Limited Warranty Coverage (For USA and Puerto Rico Only)

If your product does not work properly because of a defect in materials or workmanship, Panasonic Consumer Electronics Company (referred to as “the warrantor”) will, for the length of the period indicated on the chart below, which starts with the date of original purchase (“warranty period”), at its option either (a) repair your product with new or refurbished parts, (b) replace it with a new or a refurbished equivalent value product, or (c) refund your purchase price. The decision to repair, replace or refund will be made by the warrantor.

Product or Part Name	Parts	Labor
Digital Still Camera	1 year	1 year
CCD	6 months	90 days
SD Memory Cards, Rechargeable Battery Pack (defective exchange)	90 days	Not Applicable

During the “Labor” warranty period there will be no charge for labor. During the “Parts” warranty period, there will be no charge for parts. This Limited Warranty excludes both parts and labor for non-rechargeable batteries, antennas, and cosmetic parts (cabinet). This warranty only applies to products purchased and serviced in the United States or Puerto Rico. This warranty is extended only to the original purchaser of a new product which was not sold “as is”.

Mail-In Service

For assistance in the U.S.A. and Puerto Rico in obtaining repairs, please ship the product prepaid to:

**Panasonic Exchange Center
4900 George McVay Drive
Suite B
McAllen, TX 78503
panacare@us.panasonic.com**

When shipping the unit, carefully pack, include all accessories, and send it prepaid, adequately insured and preferably in the original carton. If Lithium Ion batteries are shipped by air the package must be labeled "Contains Lithium Ion Battery (No lithium metal)". Damaged batteries are prohibited from shipment by US Mail. Batteries must be securely packed in a manner to prevent short-circuiting and a package cannot contain more than 3 Lithium Ion batteries. Include a letter detailing the complaint, a return address and provide a daytime phone number where you can be reached. A valid registered receipt is required under the Limited Warranty.

IF REPAIR IS NEEDED DURING THE WARRANTY PERIOD, THE PURCHASER WILL BE REQUIRED TO FURNISH A SALES RECEIPT/PROOF OF PURCHASE INDICATING DATE OF PURCHASE, AMOUNT PAID AND PLACE OF PURCHASE. CUSTOMER WILL BE CHARGED FOR THE REPAIR OF ANY UNIT RECEIVED WITHOUT SUCH PROOF OF PURCHASE.

Limited Warranty Limits And Exclusions

This warranty ONLY COVERS failures due to defects in materials or workmanship, and DOES NOT COVER normal wear and tear or cosmetic damage. The warranty ALSO DOES NOT COVER damages which occurred in shipment, or failures which are caused by products not supplied by the warrantor, or failures which result from accidents, misuse, abuse, neglect, mishandling, misapplication, alteration, faulty installation, set-up adjustments, misadjustment of consumer controls, improper maintenance, power line surge, lightning damage, modification, introduction of sand, humidity or liquids, commercial use such as hotel, office, restaurant, or other business or rental use of the product, or service by anyone other than a Factory Service Center or other Authorized Servicer, or damage that is attributable to acts of God.

THERE ARE NO EXPRESS WARRANTIES EXCEPT AS LISTED UNDER “LIMITED WARRANTY COVERAGE”.

THE WARRANTOR IS NOT LIABLE FOR INCIDENTAL OR CONSEQUENTIAL DAMAGES RESULTING FROM THE USE OF THIS PRODUCT, OR ARISING OUT OF ANY BREACH OF THIS WARRANTY.

(As examples, this excludes damages for lost time, travel to and from the servicer, loss of or damage to media or images, data or other memory or recorded content. The items listed are not exclusive, but for illustration only.)

ALL EXPRESS AND IMPLIED WARRANTIES, INCLUDING THE WARRANTY OF MERCHANTABILITY, ARE LIMITED TO THE PERIOD OF THE LIMITED WARRANTY.

Some states do not allow the exclusion or limitation of incidental or consequential damages, or limitations on how long an implied warranty lasts, so the exclusions may not apply to you.

This warranty gives you specific legal rights and you may also have other rights which vary from state to state. If a problem with this product develops during or after the warranty period, you may contact your dealer or Service Center. If the problem is not handled to your satisfaction, then write to the warrantor's Consumer Affairs Department at the addresses listed for the warrantor.

PARTS AND SERVICE, WHICH ARE NOT COVERED BY THIS LIMITED WARRANTY, ARE YOUR RESPONSIBILITY.

Customer Services Directory (United States and Puerto Rico)

Obtain Product Information and Operating Assistance; locate your nearest Dealer or Service Center; purchase Parts and Accessories; or make Customer Service and Literature requests by visiting our Web Site at:

<http://www.panasonic.com/help>

or, contact us via the web at:

<http://www.panasonic.com/contactinfo>

You may also contact us directly at:

1-800-211-PANA (7262)

Monday-Friday 9am-9pm, Saturday-Sunday 10am-7pm EST

For hearing or speech impaired TTY users, TTY: 1-877-833-8855

Accessory Purchases (United States and Puerto Rico)

Purchase Parts, Accessories and Instruction Books online for all Panasonic Products by visiting our Web Site at:

<http://www.pstc.panasonic.com>

Or, send your request by E-mail to:

npcparts@us.panasonic.com

You may also contact us directly at:

1-800-332-5368 (Phone) 1-800-237-9080 (Fax Only)

(Monday-Friday 9am-9pm EST)

Panasonic Service and Technology Company

20421 84th Avenue South, Kent, WA 98032

(We accept Visa, MasterCard, Discover Card, American Express, and Personal Checks)

For hearing or speech impaired TTY users, TTY: 1-866-605-1277

As of November 2009

- SDXC Logo is a trademark of SD-3C, LLC.
- QuickTime and the QuickTime logo are trademarks or registered trademarks of Apple Inc., used under license therefrom.
- This product uses "DynaFont" from DynaComware Corporation. DynaFont is a registered trademark of DynaComware Taiwan Inc.
- Other names, company names, and product names printed in these instructions are trademarks or registered trademarks of the companies concerned.



Panasonic Consumer Electronics Company,
Division of Panasonic Corporation of North America
One Panasonic Way, Secaucus, NJ 07094

© Panasonic Corporation 2011

Printed in China