

CM01-type protective T-bus connector

CM01

- (1) Waterproof and dustproof, can be used outdoors
- (2) Flexible configuration, according to the actual needs of the output port 1-4
- (3) All imports of waterproof terminals, locking cable
- (4) 3.81mm high-quality built-in connector, easy wiring
- (5) Protection grade IP65
- (6) Support the supply functions, easy to set up large-scale field system
- (7) Anti-jamming capability, available four-core shielded bus
- (8) High-quality engineering plastic, durable
- (9) Matching power with power indicator can be



Product Overview

CM01 is the practical application of engineering, the response to the needs of the actual project development and for connecting field bus cables and power modules for the site acquisition and communication media services. According to the different needs of field installation, T-extension-side bus connector with extension exports ranging from 0-4 months. The specific choice of the scene need to be connected according to the temperature to set the number of acquisition modules, when connected with the export extension 0, that is used as a junction box termination resistors. T-Bus connector on the RS485 bus in frequent, CAN (CanOpen) bus, the bus can also be used for HART, Foundation Fieldbus, Profibus bus, LonWorks bus and other bus system for bus connection.

The standard T-connector on both sides of the waterproof connector can be fastened PGA16 10.3-14mm diameter of the bus cable. The following interfaces that can be accessed by 4.5-8mm PGA7 between the cables. Waterproof plug the cable can also be based on the user's weight matching. Temperature required for installation location of the point according to the site to select the placement of T-box. T models require intensive use, select the cellular output.

T-box field bus interface board identified as J2, the five-pin plug, pin definition of the interface as shown below

X1, X2 Terminal Block for the field bus, field bus cables, please do not plug into the X3, X4 or X5 Terminal Block.

Applications

1, RS485 bus 2, CAN (CanOpen) Bus 3, HART bus 4, Foundation Fieldbus
5, Profibus bus 6, LonWorks bus 7, bus cable to be connected to other occasions

Technical parameters

No.	Project	Description
1	Support the bus cable diameter	10.3-14mm
2	Support the extension cable diameter	4.5-8mm
3	Protection class	IP65
4	Support the communication cable length	> 100m
5	Operating Environment	-55℃ ~ +80℃
6	Material	Engineering Plastics
7	Mounting Hole Size	146X50 (See detailed dimensions)

Pin Definition

When the T-box is connected with the power module to CAN bus system, for example, the connector pins on the motherboard are defined as follows

Grade	Help	Cable core color
L	T-Bus-site AC power input connector	Red
N	T-Bus-site AC power input connector	Black
T+	Dominant signal field	Yellow
T-	Implicit signal field	Blue
GND	System Ground	Shield

When only the system bus connection, no additional power supply module with

Grade	Help	Cable core color
L	DC voltage input terminal (positive)	Red
N	DC voltage input terminal (negative)	Black
T+	Dominant signal field	Yellow
T-	Implicit signal field	Blue
GND	System Ground	Shield

Wiring diagram

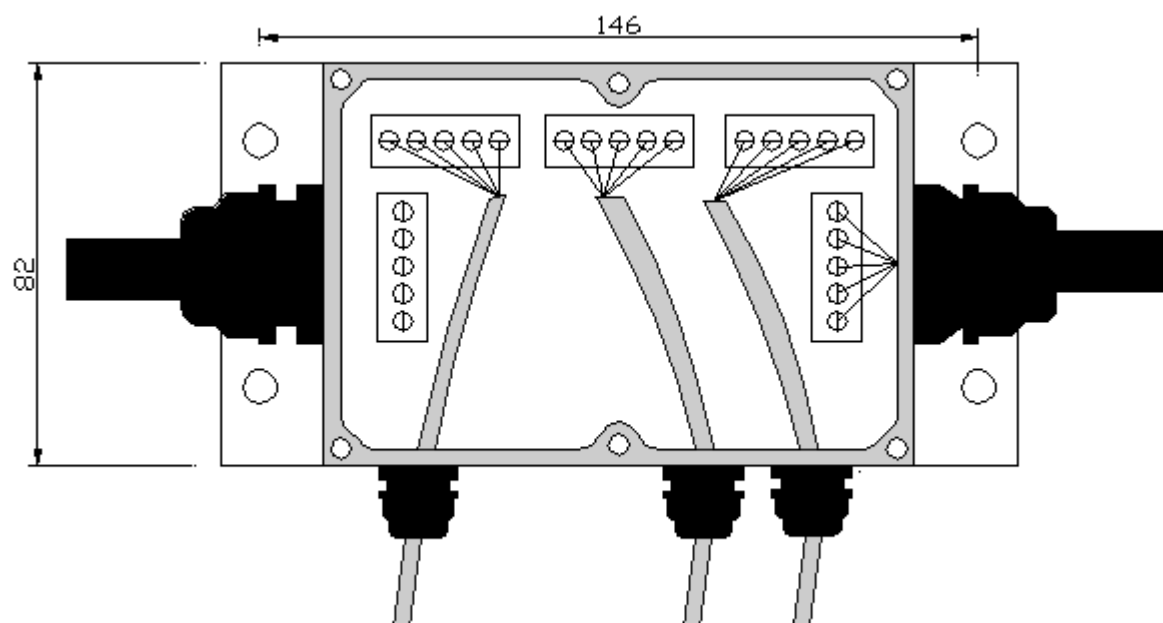



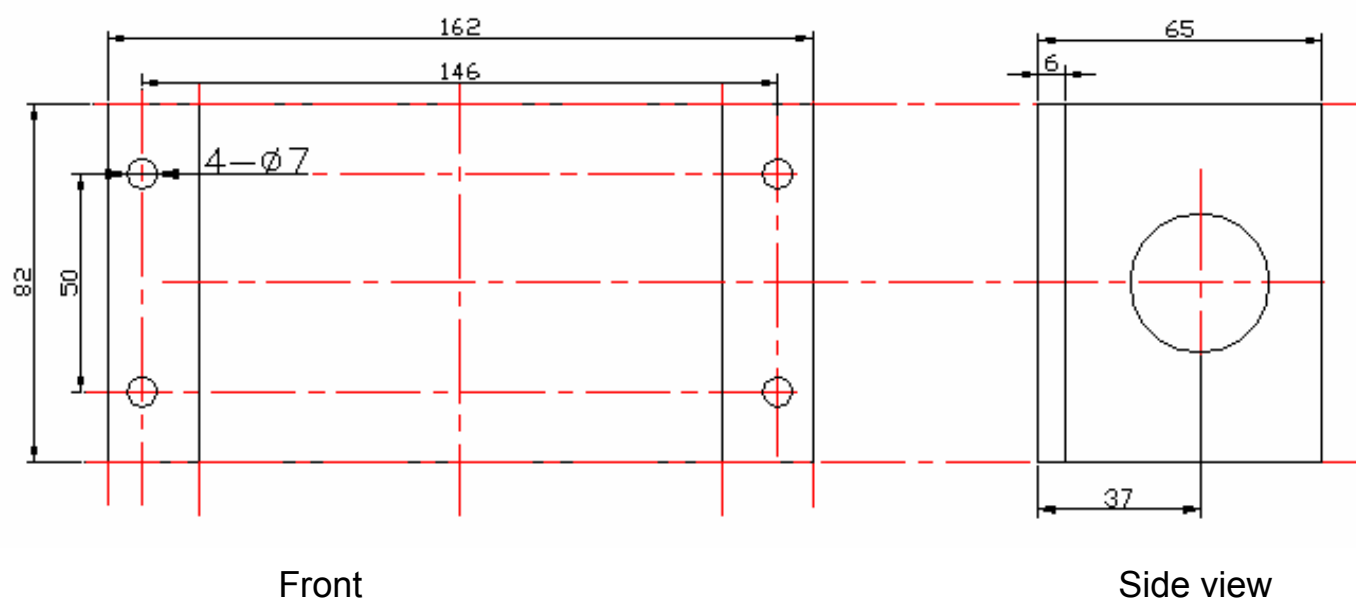

Dimensions

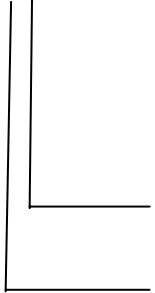

Installation

Installation must be marked on the wall the size of four as shown above inflation spiral tube, and then tighten the installation.

Ordering and Selection

Pictures	Product Type	Help	Order
	CM01-1	Single Line Output	<p>CM01-XX</p>  <p>P with power and air power for the non-Extension Number</p> <p>Single Line output, with power, then the order number:CM01-1N Without power, the order number for the CM01-1</p>
	CM01-2	Dual Line Output	
	CM01-3	Three Line Output	
	CM01-4	Four regional output	



ShangHai Sonbest Industry Co.,Ltd

Tel: +86 021 51083595

Website: <http://www.sonbest.com>

ShangHai , China