

SiCompact A2 MAXI

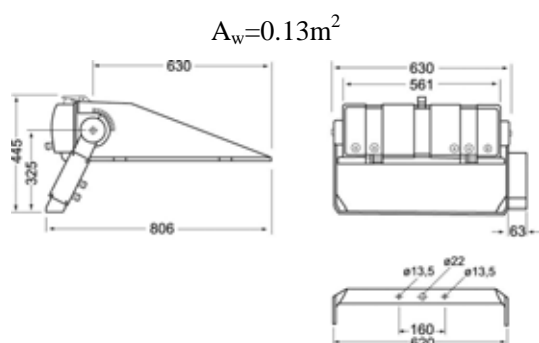

尺寸图 (Dimension Drawing):



配光曲线 (LDC)

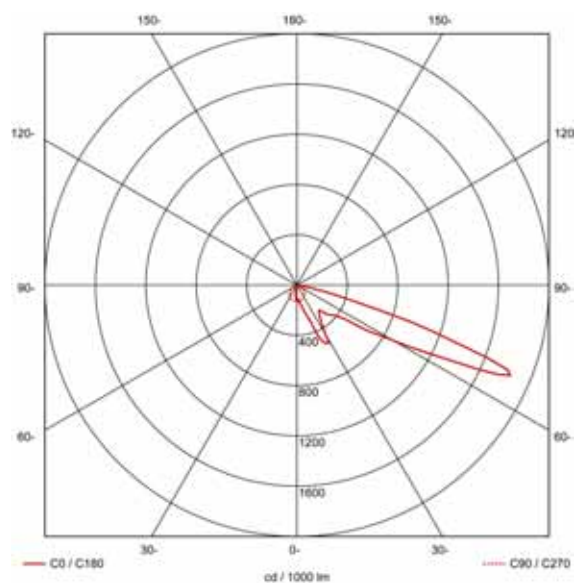

规格说明 / Specifications

品牌/Brand	西特科/Siteco
型号/Model	5NA 759 7-1WB02
产地/Origin	德国/Germany
光源/Lamp	欧司朗双端端弧金卤灯 / OSRAM HQI-TS
光源产地/Lamp Origin	德国/Germany
功率/Wattage	1,000/2,000W
光通量/Lumen	95,000/200,000lm
光效/Luminous efficiency	95/100lm/W
色温/Color temperature	5,900/5,800K
显色性/Color rendering	>=90
寿命/Life span	见说明文件
电压/Voltage	220-230V/50Hz
电流/Current	9.6/11.3A
灯具效率/Efficiency	80.5%
灯体/Housing	高压高纯铸铝 / Die-cast aluminum
反射器/Reflector	高纯净阳极氧化铝 (99.9%) / High grade anodized aluminum (99.9%)
镇流器/Ballast	详见规格表 / Pls. refer to the specification list
防护等级/IP rating	IP65
电气保护等级 / Protection Class	I类/PCI
灯具尺寸及重量 Dimensions & Weight	参见尺寸图 / Pls. refer to the dimension drawing. 重量=26.0Kg/Weight=26.0Kg
其它/Others	<ul style="list-style-type: none"> 非对称配光, 窄光束 / Asymmetrical Light Distribution, Narrow beam 配分体式电器箱/Remote control gear 灯罩为平板安全玻璃 / Safety cover glass 配有角度调节装置, 可方便调节角度/Integrate angle adjuster, protection against twisting 可直接开启灯体后部, 更换光源无需工具, 开启后自动断电/Lamp replacement by opening back of housing without tool, automatic power cut-off by opening rear of housing 压强平衡系统, 内有空气渗透膜, 可防止冷凝水在玻璃罩内部形成/Pressure equalization system with air-permeable connector for avoidance of condensation 灯体外观设计紧凑, 风阻面积及重量小于同类产品 / Compact appearance design, with smaller wind area & weight 防球击/Ball proofed 可实现瞬时热启动功能, 启动时间小于1毫秒 Hot instant restrike type available, with restriking period less than 1 millisecond

备注: 佑昌西特科照明(廊坊)有限公司保留未经事先通知而作任何修改的权利, 特别是具体的数值, 产品规格表中的插图、描述、订货号及其他声明可以变更。