



规格如有变动，恕不另行通知。  
商标是荷兰皇家飞利浦电子有限公司(Koninklijke Philips Electronics N.V.)  
或这些商标各自所有者的财产。  
2006©皇家飞利浦电子有限公司(Koninklijke Philips Electronics N.V.)。  
保留所有权利。  
[www.philips.com](http://www.philips.com)

## SHB1300 型蓝牙耳机 / SHB1300 Bluetooth headset

<b>SC</b>	用户手册	2
<b>EN</b>	User manual	10



# PHILIPS

## 目錄

- 4 开始
- 4 为耳机充电
- 4 将耳机与移动电话配对
- 5 开启耳机
- 5 关闭耳机
- 5 连接蓝牙耳机
- 6 使用耳机
- 6 接听呼入电话
- 6 转接电话
- 6 将麦克风静音
- 6 结束通话
- 6 语音拨号
- 7 重拨最后拨出的号码
- 7 拒绝呼入电话
- 7 调节扬声器音量
- 7 佩戴蓝牙耳机
- 佩戴选项
- 8 问题解答和支持
- 8 规格
- 9 认证、批准、声明

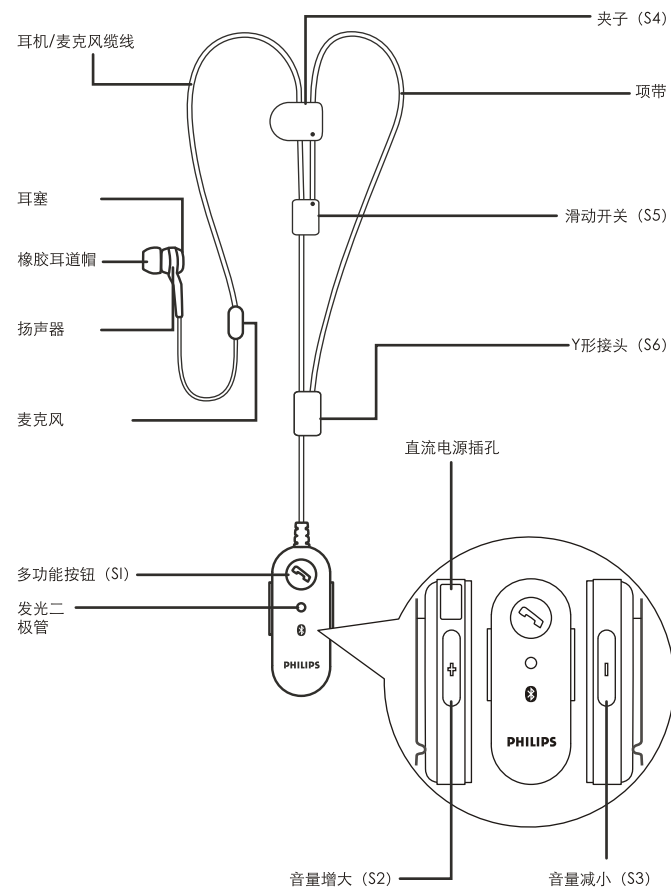

## 蓝牙耳机 SHB1300型

恭喜您！您已经购买了顶级飞利浦蓝牙耳机。借助SHB1300型耳机，您就可以使用支持蓝牙功能的手机，进行便利的免提通讯。本使用手册将帮助您快速启动，并获取耳机的最佳性能。

## 开始

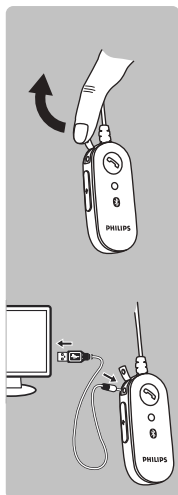

### 为耳机充电

在您首次使用耳机之前，请将电池充电6小时，使其达到最佳的电池容量及使用寿命。

只使用原装USB缆线为耳机充电。使用其它充电器可能损坏或者破坏耳机！

将USB缆线插入USB端口，然后将USB缆线连接到耳机的充电插座。在充电期间，发光二极管（LED）指示灯将会持续显示红色。一旦指示灯熄灭，即表示充电结束。标准的充电时间为3小时。

如果电池电量降低，耳机的发光二极管就会闪现红色，而不是绿色。同时每隔几分钟您就会听到一次较短的哔哔声。请您在再充电前结束通话，因为将USB缆线和耳机连接就会将耳机置入充电模式，并且会使进行中的通话中断。

### 将耳机与移动电话配对

在您首次与移动电话使用之前，您的蓝牙耳机必须要与移动电话配对。通过“配对”，将在移动电话与耳机之间建立一个唯一加密链接。

1. 在开始配对之前，确保耳机(HS)已经关闭、充电完毕、并且已经断开了充电缆线

2. 如需激活配对模式，请按住多功能按钮SI，直到发光二极管开始红、绿交替闪烁。耳机将会在配对模式保持4分钟。在4分钟之后，如需恢复配对模式，再重复以上步骤即可。
3. 按照移动电话的操作说明，开始配对过程。要特别注意，该过程将会涉及一系列操作：进入一个叫作“Setup”、“Bluetooth”或者“Connectivity”的菜单，然后选择该选项以发现或者搜索蓝牙设备。几秒钟的搜索时间之后，您的移动电话就应该显示已经找到了“Philips SHB1300”。
4. 在移动电话上选择耳机的时候，您一定要确认配对，并且要输入一个密码或者PIN码（个人识别码）。请输入“0000”（4个零）作为耳机的PIN码。

如果耳机的绿色发光二极管，每3秒钟闪烁一次，即表示配对成功。如果您的电话提示您是否想更改耳机名称，您也可以确认“Philips SHB1300”或者进行修改。现在，您就可以通话了！

如果配对没有按照预期进行，请关闭耳机和电话，等待10秒钟后，再次开启耳机和电话，并重复步骤1 - 4。

### 开启耳机

在耳机关闭状态下，按住多功能按钮，直至绿色发光二极管亮起1秒钟，并伴随一声低音和高音信号音，就表明耳机已经启动。一旦耳机启动，绿色发光二极管就会每隔3秒钟闪烁一次。

### 关闭耳机

当耳机处于开启状态的时候，按住SI多功能按钮3秒钟。如果听到一声高音并伴随一声低音，就表明耳机已被关闭。在释放SI按钮之前，发光二极管就一直保持红色。

### 连接蓝牙耳机

配对只需要在初始设置时一次完成即可。在初始配对之后，请按照这些简单的步骤，将您的蓝牙耳机与您的移动电话连接：

- 确保已经启动了移动电话的蓝牙功能。
- 开启耳机。

几秒钟之后，耳机与移动电话之间的连接就会建立起来。如果移动电话提示您是否接受与耳机的连接，请确认以便建立蓝牙链接。现在，您就可以通话了！

## 使用耳机

### 接听呼入电话

当有电话呼入的时候，耳机就会响起。按多功能按钮S1即可接听电话。在通话过程中，绿色发光二极管将会快速闪烁（每秒钟一次）。

**转接电话**（只有在移动电话支持此功能时才可用）

在通话时，电话可以从蓝牙电话转接到耳机，也可以从耳机转接到蓝牙电话。

如需将呼入电话从耳机转接到蓝牙电话，请按照电话的使用说明进行操作。

如需将呼入电话从蓝牙电话转接到耳机：按一次S1按钮，呼入电话就会被转接到耳机。

### 将麦克风静音

如需在通话过程中，将麦克风静音：

- 同时按住音量控制按钮S2和S3大约1秒钟即可。在静音功能启动期间，您将会听到定期的哔哔声。

**如需结束静音功能：**

- 同时按下音量控制按钮S2和S3，定期的哔哔声就会停止。

### 结束通话

按S1即可结束正在进行的通话。在呼叫断开之后，绿色发光二极管就会每3秒钟闪烁一次。

**语音拨号**（只有在移动电话支持此功能时才可用）

- 确保移动电话的语音拨号功能已经正确设置。
- 快速按下耳机上的多功能按钮S1。
- 在听到语言拨号信号之后（四个音调 – 从低音到高音），请念出记录在移动电话中的人名。几秒钟之内，呼叫就会接通。

**重拨最后拨出的号码**（只有在移动电话支持此功能时才可用）

如需重拨最后拨出的号码，请按住音量减低按钮S3两秒钟，就会听到一声低音，表明正在试图重拨。

**拒绝呼入电话**（只有在移动电话支持此功能时才可用）

如需拒绝呼入电话，请按住多功能按钮S1，直到您听到一声较长的哔哔声，然后释放该按钮。

### 调节扬声器音量

在通话过程中：

- 按下并释放S2，即可增大扬声器的音量，和
- 按下并释放S3，即可减小扬声器的音量。

如果您听到按键音，就表明音量已经增大或者减小。如果音量达到最高或者最低音，就会有一个较高的信号音提醒你。

## 佩戴蓝牙耳机

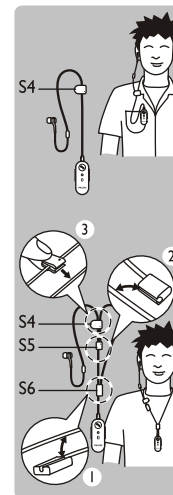

### 佩戴选项

可以用金属夹子将蓝牙耳机附在衣服上，也可以戴在脖子上。

如需从夹子固定方式改变到项链佩戴方式，可以按照以下三种步骤安装项带：

- 将Y形接头(S6)连接到耳塞缆线上靠近蓝牙设备的位置。
- 将滑动开关(S5)连接到耳塞缆线上夹子(S4)的下方。
- 将夹子(S4)固定到耳塞缆线上，以便固定滑动开关的位置。

任何时候您都可以把项带从耳塞缆线上拆下来。

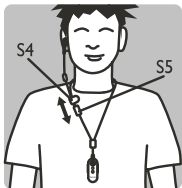

如需调节项带的松紧：

- 打开夹子（S4）
- 将耳塞缆线上的滑动开关（S5）往上或者往下移动
- 用夹子（S4）固定您想要的长度

要想佩戴舒适，请从随机附送三个橡胶耳道帽中选择最贴合您耳朵的一个，并将其固定在耳塞缆线上。

### 问题解答和支持

问题	可能原因	解决方法
蓝牙耳机没有开启。	电量太低。	替电池充电。
与移动电话之间没有连接	蓝牙功能被取消。	启动移动电话上的蓝牙功能，然后开启耳机。
移动电话找不到耳机	耳机可能不是在配对模式。 (耳机只在配对模式保持4分钟)。	按照前面介绍的方式，将耳机设置为配对模式。
	配对功能已被重新设置。	按照前面介绍的方式，启动配对流程。
重拨功能无效。	您的移动电话可能不支持该功能。	
语音拨号无效。	您的移动电话可能不支持该功能。	
耳机不能充电或者充电速度非常缓慢	USB端口不供电或者提供非常少的电量。	USB端口应能提供500mA的电流。试一试您的PC机背面上或能提供电源的USB集线器上的其它USB端口。

\*请访问[www.philips.com/support](http://www.philips.com/support)，以获取更多支持。

### 规格

可充电锂离子电池  
符合蓝牙1.2、HSP、HFP  
范围：达33英尺 / 10米  
标准待机时间：200小时  
标准通话时间：长达7小时  
标准充电时间：3小时

如果设计和规格有任何变更，恕不另行通知。通话时间和待机时间可能有相应变化。

### 认证、批准、声明



商标  
蓝牙文字标记和图标归 **Bluetooth SIG** 拥有。荷兰皇家飞利浦电子股份有限公司对该标记的任何使用都是经授权进行的。其它商标和商品名称都归属于相应的所有者。

产品中有毒有害物质或元素的名称及含量

部件名称 (Name of the Parts)	有毒有害物质或元素 (Hazardous/toxic Substance)					
	铅 (Pb,Lead)	汞 (Hg, Mercury)	镉 (Cd,Cadmium)	六价铬 (Chromium 6+)	多溴联苯 (PBB)	聚溴二苯醚 (PBDE)
线路板 & 电子元器件 (PCBA)	0	0	0	0	0	0
外壳 (Housing)	0	0	0	0	0	0
耳机 (Headset)	0	0	0	0	0	0
电池 (Battery)	0	0	0	0	0	0
USB充电线 (USB Charger Cable)	0	0	0	0	0	0
说明书 (User Manual)	0	0	0	0	0	0
包材 (Packaging Materials)	0	0	0	0	0	0

0: 表示该有毒有害物质在该部件所有均质材料中的含量均在SJ/T11363-2006标准规定的限量要求以下。  
X: 表示该有毒有害物质至少在该部件的某一均质材料中的含量超出SJ/T11363-2006标准规定的限量要求。  
(企业可在此处, 根据实际情况对上表中打“x”的技术原因进行进一步说明。)

## Contents

- 12 Getting started**
  - 12 Charging your headset
  - 12 Pair your headset to your mobile phone
  - 13 Turn your headset on
  - 13 Turn your headset off
  - 13 Connecting your Bluetooth headset
- 14 Using your headset**
  - 14 Answering incoming calls
  - 14 Transferring calls
  - 14 Muting the microphone
  - 14 Ending calls
  - 14 Voice dialing
  - 15 Redial last dialed number
  - 15 Reject incoming calls
  - 15 Adjusting speaker volume
- 15 Wearing your Bluetooth headset**
  - Wearing options
- 16 Problem solving & support**
- 16 Specifications**
- 17 Certifications, approvals, statements**

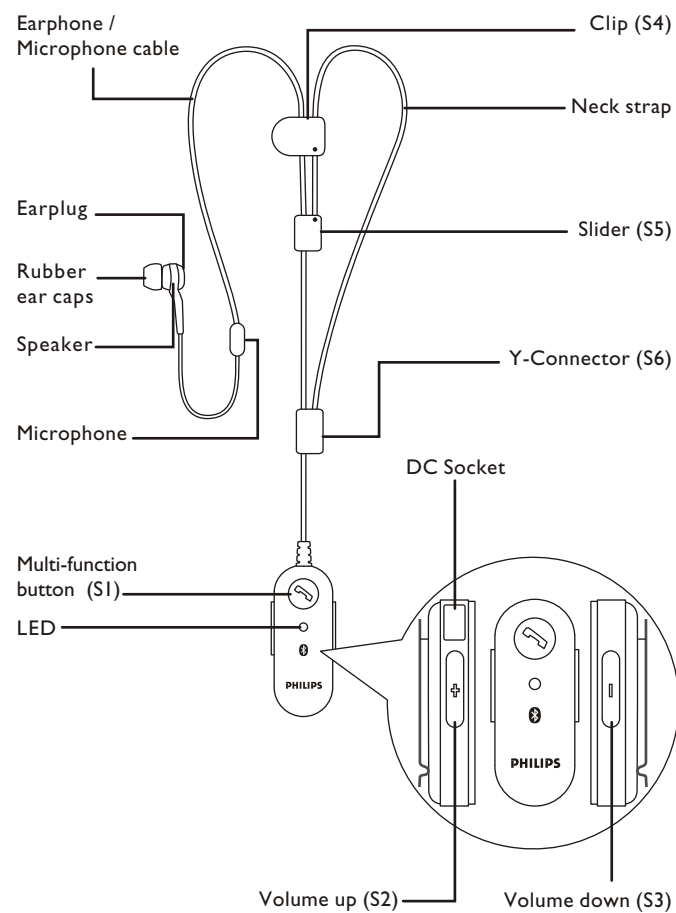

## Bluetooth headset SHB1300

Congratulations! You have just bought a state-of-the-art Philips Bluetooth headset. With the Philips SHB1300 you can enjoy convenient hands-free communication with your Bluetooth enabled phone. This instruction manual will help you to get started quickly and achieve the best performance from your headset.

## Getting started

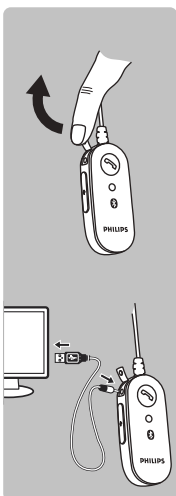

### Charging your headset

Before you use your headset for the first time charge the battery for 6 hours for optimum battery capacity and lifetime.

Use only the original USB cable for charging. Using another charger may damage or destroy your headset!

Plug the USB cable into a USB port and connect the cable to the headset's charging socket. During charging the LED indicator will show a steady red light. Charging is completed once the LED has switched off. Typically a full charge will take 3 hours.

The headset LED will flash red instead of green when the battery is low and you will hear a short beep every few minutes. Finish your call before re-charging as connecting the USB cable to the headset will put your headset in charging mode and could cut an ongoing call.

### Pair your headset to your mobile phone

Your Bluetooth headset must be paired to your mobile phone before using it for the first time with your phone. "Pairing" will establish a unique encrypted link between your mobile phone and your headset.

1. Make sure the headset (HS) is turned off, charged and disconnected from the charging cable before you start pairing.

2. To activate pairing mode press and hold the multi function button S1 until the LED starts flashing red and green alternately. The HS will remain in pairing mode for 4 minutes, to resume pairing after 4 minutes repeat the steps above.
3. Follow the operating instructions for your mobile phone to start the pairing process. Typically this involves accessing a menu called "Setup", "Bluetooth" or "Connectivity" and selecting the option to discover or search for Bluetooth devices. After several seconds search time your phone should indicate that it has found the "Philips SHB1300".
4. Upon selecting the headset on your mobile phone typically you will need to confirm the pairing and enter a passkey or PIN. Please enter the headset's PIN "0000" (4 zeros).

The headset LED will flash green every 3 seconds, indicating successful pairing. If your phone asks whether you want to change the headset's name, you may confirm the "Philips SHB1300" name or change it. You are now ready to talk!

If pairing does not occur as expected turn the headset and phone off and wait for 10 seconds. Turn the headset and phone on again and repeat Steps 1-4.

### Turn your headset on

While the headset (HS) is turned off, press and hold the multi function button until a green LED signal for 1 second and a low tone followed by a high tone will indicate that the HS is powered up. Once the HS is powered up a green LED will flash every 3 seconds.

### Turn your headset off

While the HS is powered up, press and hold the multi function button S1 for 3 seconds. A high tone followed by a low tone will indicate that the HS is powered down. The LED indicator will remain red until S1 is released.

### Connecting your Bluetooth headset

Pairing needs to be done only once for the initial setup. After the initial pairing follow these simple steps to connect your Bluetooth headset to your mobile phone:

- Make sure Bluetooth is enabled on your mobile phone.
- Turn on the headset

After a few seconds the connection between your headset and mobile phone will be established. If prompted by your mobile phone whether to accept the connection with the headset please confirm in order to establish the Bluetooth link. You are now ready to talk!

## Using your headset

### Answering incoming calls

The HS will ring when a call comes in. Press the multi function button S1 to answer the call. The green LED will flash fast (once a second) while the call is in progress.

### Transferring calls (Available if supported by your mobile phone)

During your call, calls can be transferred from the Bluetooth phone to the HS and from the HS to the Bluetooth phone.

To transfer a call from HS to the Bluetooth phone, please follow the operating instructions of your phone.

To transfer a call from the Bluetooth phone to the HS: press S1 once; the call will be transferred to the HS.

### Muting the microphone

To mute the microphone during an active call:

- Press the volume control buttons S2 and S3 simultaneously for about a second. A periodic beep tone will be heard while the mute function is active.

To end the mute function:

- Press the volume control buttons S2 and S3 simultaneously. The periodic beep tone will stop.

### Ending calls

Press S1 to end an ongoing call. After the call is disconnected, the green LED will flash once every three seconds.

### Voice dialing (Available if supported by your mobile phone)

1. Make sure the voice dialing function is properly set up in your mobile phone.
2. Press the multi function button S1 on the HS shortly.
3. After hearing the voice dial signal (four tones- low to high pitch), say the name of the person as recorded in your mobile phone. The call will be connected within a few seconds.

### Redialing the last dialed number (Available if supported by your mobile phone)

To redial the last dialed number, press and hold the volume down key S3 for 2 seconds. A short low tone will indicate an attempt to redial.

### Rejecting incoming calls (Available if supported by your mobile phone)

To reject an incoming call, press the multi function button S1 and hold it until you hear a long beep tone, then release it.

### Adjusting speaker volume

During a call:

- Press and release S2 to increase the speaker volume and
- Press and release S3 to decrease the speaker volume.

A key tone will indicate any increase or decrease of the volume. A higher pitch signal tone will alert you when the volume level reaches its maximum or minimum.

## Wearing your Bluetooth headset

### Wearing options

The Bluetooth headset can be attached to your garment with the metal clip or be worn around the neck.

To change from clip on style to necklace style, attach the neck strap in three steps:

1. Attach the Y-connector (S6) to the earplug cable close to Bluetooth device.
2. Attach the slider (S5) to the earplug cable beneath the clip (S4).
3. Fix the slider position by attaching the clip (S4) to the earplug cable.

You can detach the neck strap from the earplug cable at any time.

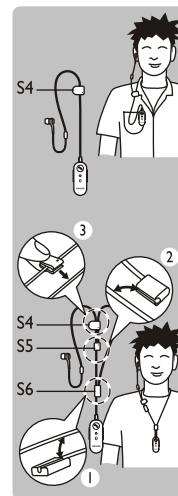



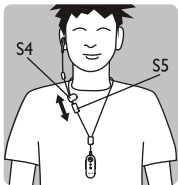

To adjust the neckband in size:

- Open the clip (S4)
- Move the slider (S5) up or downward on the earplug cable
- Fix your preferred length with the clip (S4)

For optimal wearing comfort choose one of the three included rubber ear caps that best fits your ear and place it on the earplug.

## Problem solving & support

Problem	Possible cause	Solution
Bluetooth headset does not switch on.	Battery is very low.	Charge the battery.
No connection to mobile phone.	Bluetooth disabled.	Enable Bluetooth on your mobile phone and turn the HS on.
Mobile phone cannot find headset	Headset may not be in pairing mode. (HS stays in pairing mode for 4 min.)	Put HS in pairing mode as described above.
	Pairings may have been reset.	Start the pairing process as describe above.
Redialing does not work.	Your mobile phone may not support this feature.	
Voice dialing does not work.	Your mobile phone may not support this feature.	
The headset is not charging or charging very slowly	The USB port provides no, or too little power.	Your USB port should provide 500mA. Try another USB port at the back of your PC or on a powered USB hub.

\*Please visit [www.philips.com/support](http://www.philips.com/support) for additional support.

## Specifications

Rechargeable Lithium-Ion battery  
 Bluetooth 1.2 compliant, HSP, HFP  
 Range: Up to 33 feet / 10 meters  
 Typical standby time: 200 hours  
 Typical talk time: 7 hours  
 Typical charging time: 3 hours

Design and specifications are subject to change without notice. Talk time and stand-by time may vary.

## Certifications, approvals, statements



### Trademarks

The Bluetooth word mark and logos are owned by the Bluetooth SIG, Inc. and any use of such marks by Koninklijke Philips Electronics N.V. is under license. Other trademarks and trade names are those of their respective owners.