

SF84 系列电动阀用于控制冷水或热水空调系统管道的开启或关闭，达到控制室温之目的。驱动器由单向磁滞同步电机驱动，阀门弹簧复位。阀门不工作时处于常闭状态，当需要工作时，由温控器提供一个开启信号，使电动阀接通交流电源而动作，开启阀门，冷冻水或热水进入风机盘管，为房间提供冷气或暖气；当室温达到温控器设定值时，温控器令电动阀断电，复位弹簧使阀门关闭，从而截断进入风机盘管的水流。通过阀门关闭和开启，使室温始终保持在温控器设定的温度范围内。。

SF84 系列电动阀之驱动器与阀体采用螺套联接方式，可以在阀门安装之后再安装驱动器，现场装配，接线灵活、方便。驱动器之平面设计可以贴近墙面安装，占用空间小。产品可靠耐用，工作噪音低，并能在隐蔽式风机盘管装置内常出现的高温环境可靠工作。

材质说明和技术数据：

材 料	阀 体	黄铜整件铸造	介质温度	2~94℃ (36~201°F)
	阀 杆	不锈钢(AISI303)	湿 度	100%
	密封材料	EPT 橡胶	环境温度	0~60℃
	驱动器底盘	压铸铝合金	储存温度	-20~65℃ 最大相对湿度为不凝露
	驱动器盖	阻燃 ABS		
工作介质		冷水/热水	保护等级	IP40

SF84 主要技术参数

阀门形式	连接	Kv 值	关闭压差 (kPa)	阀体承压 (MPa)	驱动器参数			
					额定电压	功率	驱动方式	动作时间
常闭二通	G3/4	2.5	100	1.6	220 VAC	2W	电机驱动 弹簧复位	开：10 秒 关：5 秒
	G1	4.0	60					

SF84 系列电动阀外形尺寸

规格	尺寸(mm)		
	A	B	D
DN20 二通	65	125	32
DN25 二通	71	135	42

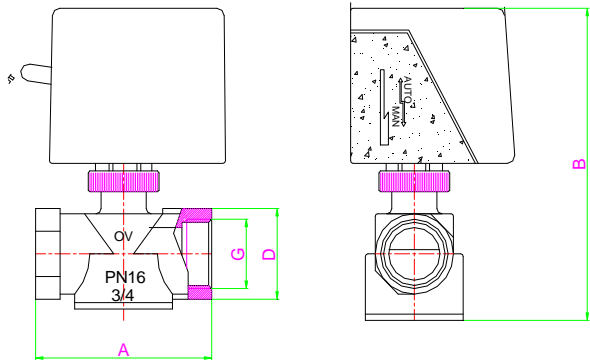

操作及注意事项

马达罩壳应防止滴水渗入。当阀装于水平管道时，安装位置与平面夹角不超过 90° ，如图 2 所示。当阀门装在垂直管道上时，马达罩壳必须防止滴水渗入。

拨动手动操作杆时应缓慢移动，当手动杆沿箭头指向慢慢移动并按进缺口内卡住，阀门处于常开状态，每当电流首次通过电动阀时，手动杆会再设定至自动位置。

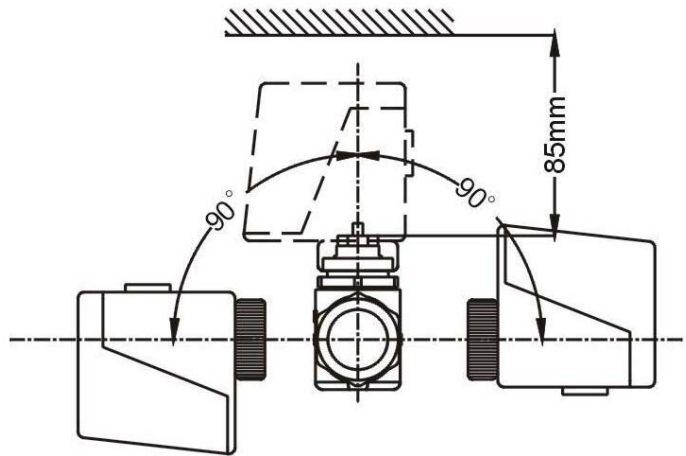

安装注意事项：

- 1、安装时确认阀体水流的方向是正确的
- 2、确认所接的电压符合驱动器规定要求
- 3、安装或修理时，应切断电源，以防损坏设备或触电

Motorized Valve SF84 is used to control the opening and closing for the pipe of cooling/hot water air-conditions series so as to control the temperature and regulate flux coefficient. Actuator is driven by unilateralism hysteretic synchronous motor with spring return. When valves are not worked, they are normal-closed. When the valve is working, the thermostat will provide an opening signal to make valve turn-on AC electrical source and open. Then cooling/hot water will enter into the coil and supply the cold/hot to the room. When the room temperature rises up to the set point, the thermostat will make the valve power off. At the same time the valve will be closed by return spring and the water to the coil will be shut off. The room temperature will be kept in the setting range all the time through the opening and closing of the valve.

The actuator is connected with the valve body by nut. It can be mounted later after the valve body has been mounted on the pipe already. It has convenient-mounted and flexible wire-connection characteristics. The actuator flat design can be mounted very near the wall, occupied small space. This product is reliable, long-life, and low noise. It can work in high temperature that often appears inside the fan of concealment.

Material instruction Technical Specifications

Material	Body	Cast brass	Medium temperature	2~94℃ (36~201°F)
	Stem	AISI303 Stainless steel	humidity	100%
	Seal material	EPT Rubber	environment temperature	0~60℃
	Actuator plate	ZL101	Storage temperature	-20~65℃ the most face to face humidity is uncured
	Actuator cover	UL94V-0		
Working medium		water	Protect step	IP40

SF84 Technical Specifications

Type	Size	kv	Max Pressure Difference (kPa)	Pressure (MPa)	Actuator Main Technical Specification			
					Rated Voltage	Power	Driving Way	Operating Time
Normal-closed 2-way	G3/4	2.5	100	1.6	220 VAC	2W	Driven by Synchronous hysteretic motor, and returned by spring	Full opening time: About 10 seconds when power-on; Closing time: About 5 seconds when power-off
	G1	4.0	60					

SF84 Dimension

type	Dimension(mm)		
	A	B	D
DN20	65	125	32
DN25	71	135	42

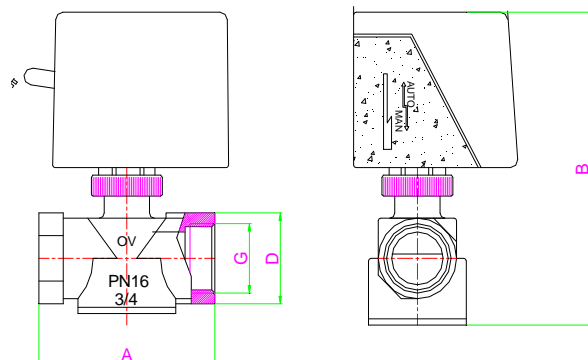

Mounting and Operation Instruction

The cover of motor should be prevented from dripping. When the valve is mounted on horizontal pipe, the angle must be positioned less than 90° (see Figure 2). When the valve is mounted on vertical pipe, it must be prevented from dripping.

Move the manual operating lever slowly and hold in the retaining notch, and then the valve is in normal-opened position. When the valve is first powered on, the lever goes back to the automatic position again.

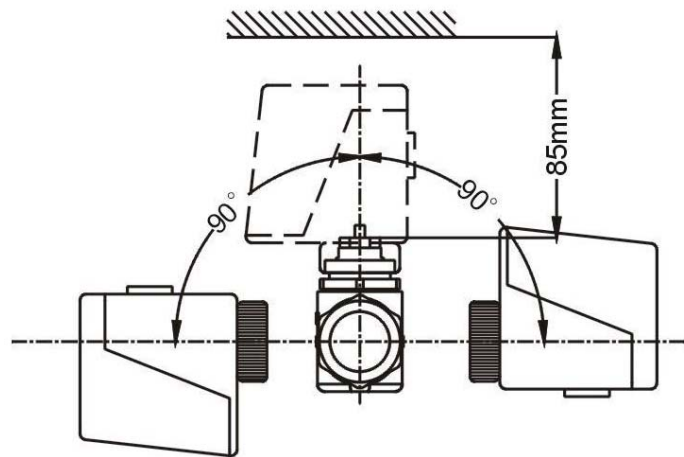

Picture 2 installation position

Installation

- 1、 When installation, please note the arrow direction of the valve.
- 2、 The used voltage is according to actuator
- 3、 When installation or repair, must turn off the electrical source