



8532
Cool Only Thermostat
OPERATING INSTRUCTIONS



SEE REVERSE FOR INSTALLATION INSTRUCTIONS

Your new digital thermostat has been designed to provide accurate control and display of room temperature. In addition, it also will display all relevant information pertaining to your system.

The clearly marked buttons and informative display make it extremely easy to understand and simple to use.

Please take a few moments to read the brief instructions and familiarize yourself with the various functions in order to obtain maximum benefit from this truly unique electronic control.

GENERAL INFORMATION

The thermostat normally displays room temperature, mode of operation and whether cooling is currently on. The six buttons on the front of the unit allow complete control of the equipment.

Raising or lowering the setpoints in cooling is as simple as pushing a button. In addition, you may choose to display the temperature in °F or °C.

The thermostat also allows you to select continuous fan operation (useful when using an air cleaner) or have the fan come on with the equipment.

USER CONTROLS

MODE

Select the desired mode of operation by pressing the MODE button repeatedly:

❄ – controls cooling system only (the word COOL is displayed for 5 seconds).

OFF – The word OFF is displayed and the equipment will not operate.

COOLING ❄

Select the temperature you want your equipment to maintain while in the cooling mode by pressing and holding the ▼ or ▲ buttons. The temperature setpoint is displayed for 5 seconds.

FAN 🌀

The fan will come on automatically when the system is operating, but there is no indication of this on the display. To select continuous fan operation, press the FAN button and the display will show 🌀. This is recommended for electronic air cleaners or continuous ventilation requirements.

INSTALLER NOTES

This page intentionally left blank.

USER CONTROLS (Cont'd)

OUTDOOR (ODT) BUTTON

When the outdoor temperature sensor option is connected to your thermostat, you can display the current outdoor temperature by pressing the OUTDOOR button. If the option is not connected, the thermostat will display – 🌡.

DAY/NIGHT BUTTON

When the thermostat initially is installed, the display will show the ☀ symbol for your day temperature. By pressing the DAY/NIGHT button or closing the CLK1 and CLK2 terminals on the back of the thermostat you may select an alternate or night 🌙 temperature. (The thermostat will remember this setpoint.) Simply press the DAY/NIGHT button to alternate between temperature settings.

CELSIUS / FAHRENHEIT

Simultaneously press ▼ and ▲ to switch between °F and °C temperature display.

USER CONTROLS (Cont'd)

LIMITED OVERRIDE

When the keyboard is locked (switch #2 ON), the user may override the temperature setpoint for 1 hour by pressing either the ▼ or ▲ button. The range of temperature override is ±3°F or ±3°C from the programmed daytime setpoint.

CLOCK TERMINALS (OPTION)

CLK1 – CLK2

Your thermostat is equipped with remote clock terminals. By connecting a remote clock/timer (DSP-AT or equivalent) the thermostat can alternate between the day and night setpoints automatically.

REMOTE SENSOR (OPTION)

RS1 – RS2 – RS+V

The thermostat is designed to accept the electronic remote sensor, which will allow you to locate your thermostat in an area away from view. Indoor and outdoor sensors are available separately.

POWER FAILURES

Your thermostat employs the latest developments in solid state electronic technology.

One of the unique features of your thermostat is that no battery is required to maintain your selected setpoints in the event of a power loss as the memory is unaffected by power failures of any duration.

When power is restored, the thermostat will continue operating as if the power had never been off.

TEMPERATURE ACCURACY

Full temperature accuracy will be realized only after the thermostat has been installed and powered for at least one hour.

ELECTRONIC PROGRAMMABLE THERMOSTAT
TWO YEAR LIMITED WARRANTY

Your Research Products Corporation Aprilaire™ Thermostat unit is expressly warranted for two (2) years from the date of installation to be free from defects.

Research Products Corporation's exclusive obligation under this warranty shall be to supply, without charge, a replacement for any thermostat which is found to be defective within a two (2) year period and which is returned no later than thirty (30) days after said two (2) year period by you to either your original supplier or to Research Products Corporation, Madison, Wisconsin, 53701, together with the model number, manufacturing code number and installation date of the thermostat. THIS WARRANTY SHALL NOT OBLIGATE RESEARCH PRODUCTS CORPORATION FOR ANY LABOR COSTS AND SHALL NOT APPLY TO DEFECTS IN WORKMANSHIP OR MATERIALS FURNISHED BY YOUR INSTALLER AS CONTRASTED TO DEFECTS IN THE THERMOSTAT ITSELF.

IMPLIED WARRANTIES OF MERCHANTABILITY OR FITNESS FOR A PARTICULAR PURPOSE SHALL BE LIMITED IN DURATION TO THE AFORESAID TWO (2) YEAR PERIOD. RESEARCH PRODUCTS CORPORATION'S LIABILITY FOR INCIDENTAL OR CONSEQUENTIAL DAMAGES, OTHER THAN DAMAGES FOR PERSONAL INJURIES, RESULTING FROM ANY BREACH OF THE AFORESAID IMPLIED WARRANTIES OR THE ABOVE LIMITED WARRANTY IS EXPRESSLY EXCLUDED. THIS LIMITED WARRANTY IS VOID IF DEFECT(S) RESULT FROM FAILURE TO HAVE THIS UNIT INSTALLED BY A QUALIFIED HEATING AND AIR CONDITIONING CONTRACTOR. IF THE LIMITED WARRANTY IS VOID DUE TO FAILURE TO USE A QUALIFIED CONTRACTOR, ALL DISCLAIMERS OF IMPLIED WARRANTIES SHALL BE EFFECTIVE UPON INSTALLATION.

Some states do not allow limitations on how long an implied warranty lasts or the exclusion or limitation of incidental or consequential damages so the above exclusion or limitations may not apply to you. This warranty gives you specific legal rights and you may also have other rights which vary from state to state.

This equipment if installed in strict accordance with the manufacturers instructions, complies with the limits for a Class B computing device pursuant to Subpart J of Part 15 of FCC rules.

INSTALLATION INSTRUCTIONS

LOCATION

To ensure proper operation, the thermostat should be mounted on an inside wall in a frequently occupied area of the building. In addition, its position must be at least 18" (46cm) from any outside wall, and approximately 5' (1.5m) above the floor in a location with freely circulating air of an average temperature.

BE SURE TO AVOID THE FOLLOWING LOCATIONS:

- behind doors or in corners where freely circulating air is unavailable
- where direct sunlight or radiant heat from appliances might affect control operation
- on an outside wall
- adjacent to, or in line with, conditioned air discharge grilles, stairwells, or outside doors
- where its operation may be affected by steam or water pipes or warm air stacks in an adjacent partition space, or by an unheated/uncooled area behind the thermostat
- where its operation will be affected by the supply air of an adjacent unit
- near sources of electrical interference such as arcing relay contacts

THERMOSTAT INSTALLATION

1. Insert a flat blade screwdriver or coin 1/8" into the slot located in the bottom center of the thermostat case and twist 1/4 turn. When you feel or hear a click, grasp the case from the bottom two corners and separate from the subbase as shown in the diagram at the right. Some models require more force than others when separating due to the number of terminals on the subbase.
2. Swing the thermostat out from the bottom.
3. Lift the thermostat up and off the subbase.
4. Place the rectangular opening in the subbase over the equipment control wires protruding from the wall and, using the subbase as a template, mark the location of the two mounting holes (exact vertical mounting is necessary only for appearance).
5. Use the supplied anchors and screws for mounting on drywall or plaster; drill two 3/16" (5mm) diameter holes at the marked locations; use a hammer to tap the nylon anchors in flush to the wall surface and fasten subbase using the supplied screws. (Do not overtighten!)
6. Connect the wires from your system to the thermostat terminals as shown in the wiring diagrams. Carefully dress the wires so that any excess is pushed back into the wall cavity or junction box. Ensure that the wires are flush to the plastic subbase. The access hole should be sealed or stuffed to prevent drafts from affecting the thermostat.

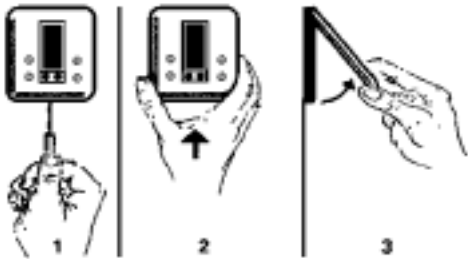

REPLACING THE THERMOSTAT ON THE SUBBASE

1. Position the thermostat on the hinged tabs located at the top of the subbase.
2. Gently swing the thermostat down and press on the bottom center edge until it snaps in place.

SLIDE SWITCH SETTINGS

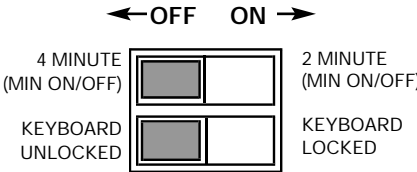
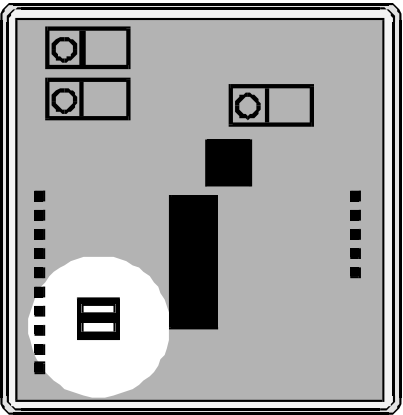

SPECIFICATIONS

Rated Voltage	20-30 VAC, 24 nominal
Rated Current	0.08 Amps to 1.5 Amps continuous per output with surges to 4 Amps Maximum.
Control Range	Cooling: 60° to 108°F in 1° Steps 16° to 40°C in 1° Steps
Thermostat Measurement Range	28° to 124°F or 0° to 48°C
O.D.T. Display Range	-50° to 124°F or -48° to 48°C
Control Accuracy	±.5°C at 20°C ±1°F at 68°F

NOTE: This thermostat contains electronic circuitry replacing the conventional mechanical anticipator.

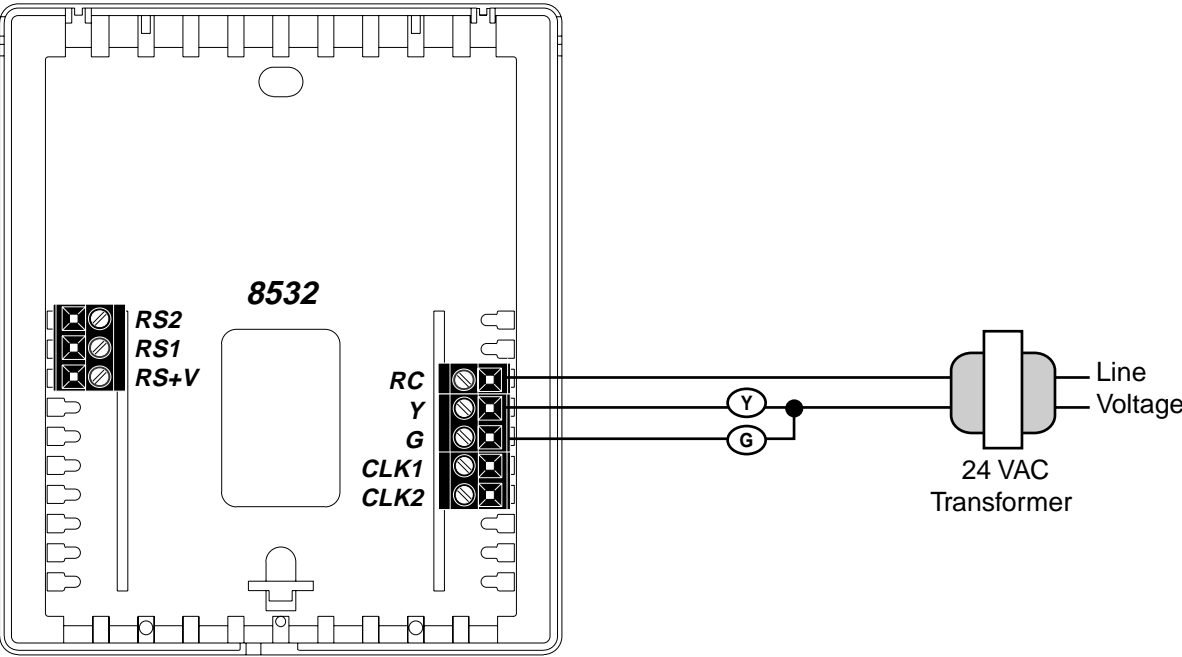

OUTPUT TERMINAL FUNCTIONS

- RC24 VAC supply from cooling equipment
- YCooling energized on a call for cooling
- GFan energized
- CLK1 . .Use with remote clock/timer
- CLK2 for alternate setpoints
- RS2For outdoor temperature sensor
- RS1 and/or indoor remote sensor options.
- RS+V Refer to the instructions included with the sensors.