

3M MP8780 Multimedia Projector Quick Setup Instructions

Connection Terminals

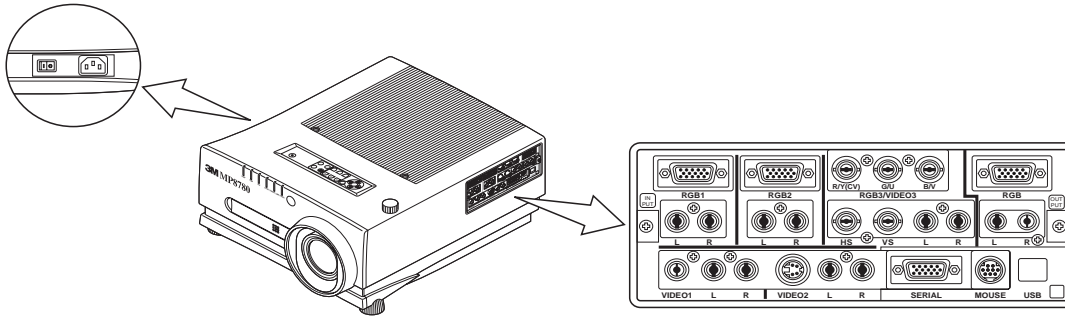

Cable Connections: Always turn power off when making any cable connections.

Computer Connections

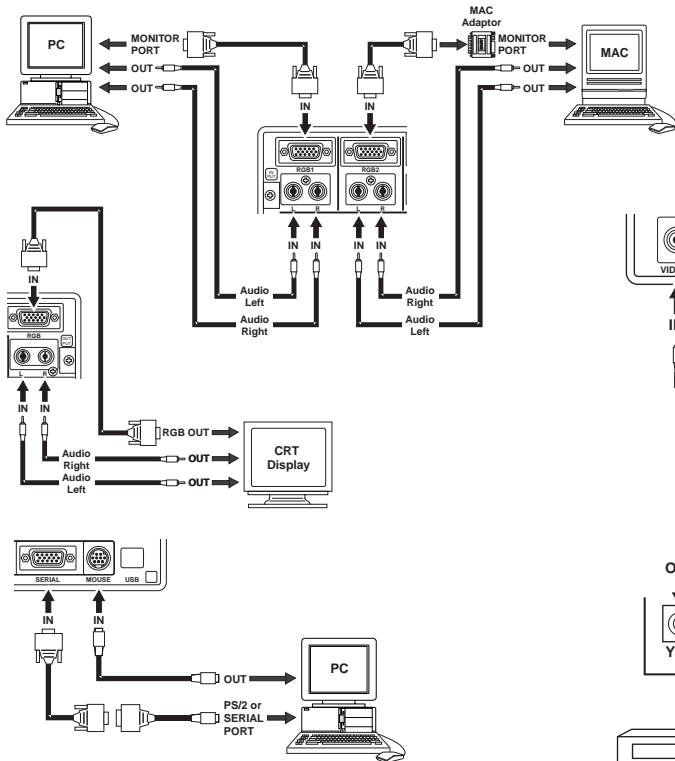

Video Connections

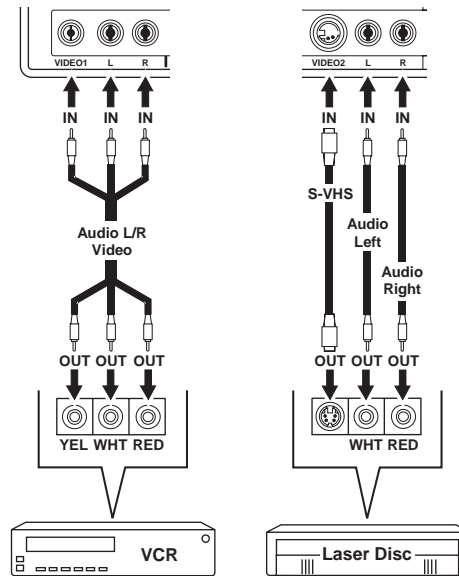

BNC Connections

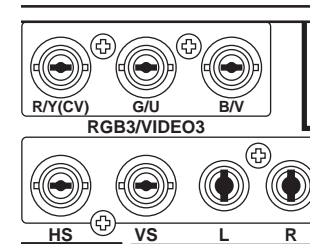

There are four kinds of usage for BNC connectors:

	Purpose	Usage of BNC					Menu Selection	
		R/Y(CV)	G/U	B/V	HS	VS	Selection1	Selection2
Usage 1	RGB Input	Red	Green	Blue	HS	VS	RGB3	
Usage 2	Component Input	Y	U	V	NC	NC	VIDEO3	YUV
Usage 3	CV	CV	NC	NC	NC	NC	VIDEO3	CV/S
Usage 4	S-video	Y	C	NC	NC	NC	VIDEO3	CV/S

(Note): NC No Connection

Usage 1: Selecting "RGB" determines the usage of BNC as RGB Input.

Usage 2: Selecting "VIDEO3" and "YUV" determines the usage of BNC as Component Input.

Usage 3/4: Selecting "VIDEO3" and "CV/S" determines the usage of BNC as CV or S. Usage of BNC as CV or S is determined automatically by detecting input signal by the projector.

Technical Assistance & Product Information

1-800-328-1371

E-mail: techsupport@mmm.com

3M MP8780 Multimedia Projector Quick Setup Instructions

Projector Packout

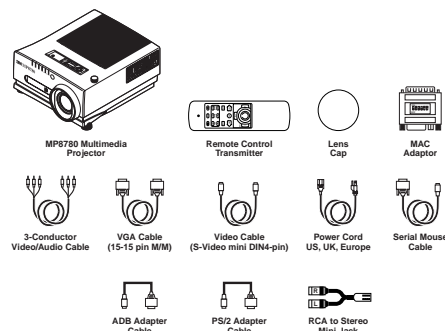

Optional Accessories:

- RS-232 control cable (1)
- Gender Changer SVGA
MAC Monitor Adaptor (1)
- USB mouse cable (1)

Remote Control Transmitter

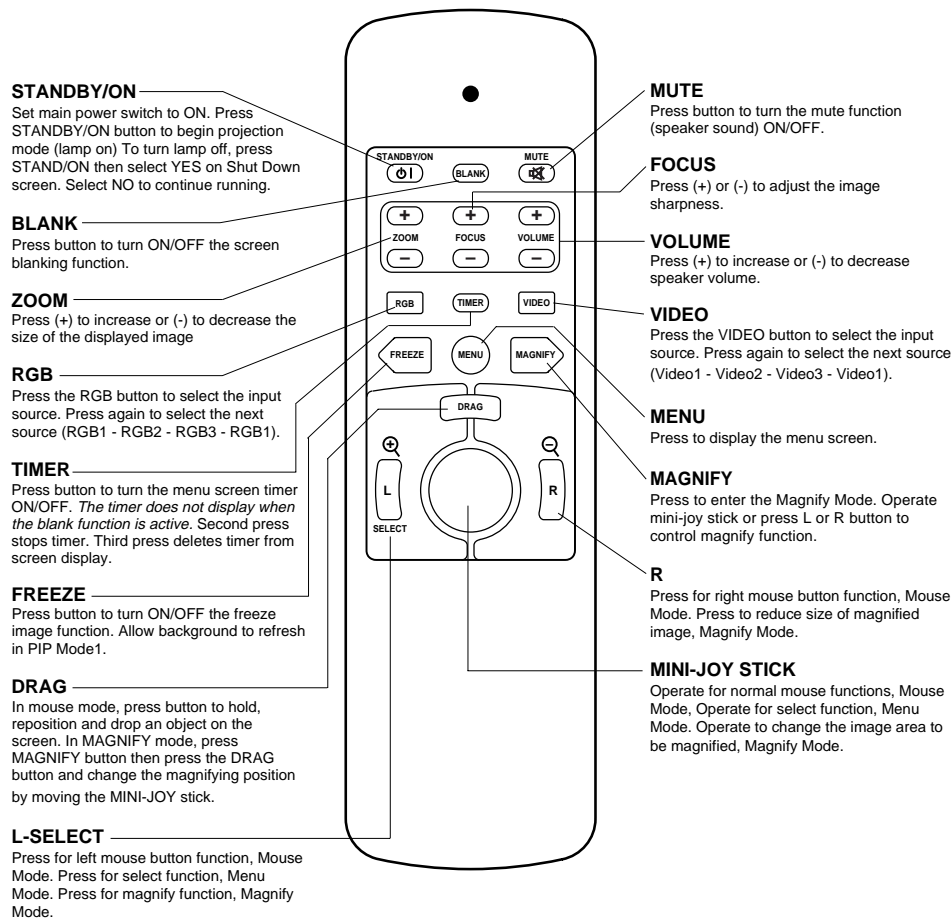

Projector Controls

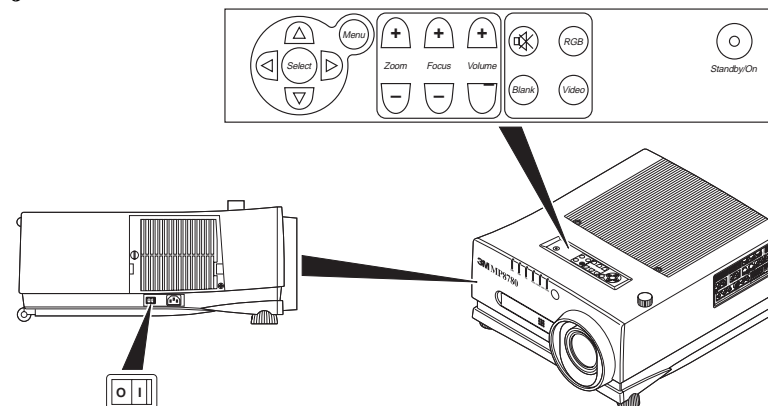

Projector Startup

1. Make all cable connections and line hookups with the power off.
2. Turn the **POWER SWITCH** of the projector on. The ON indicator will light up orange.
3. Press the **STANDBY/ON** . The ON indicator blinks (green) and then lights (green). The ON indicator will blink green during warm-up and lamp ignition. When power is turned off, there is a 90 second reset period before the STANDBY/ON button will function again.
4. Adjust the screen size by pressing the **ZOOM +/-** button.
5. Adjust the sharpness by pressing the **FOCUS +/-** button.
6. Turn on all connected equipment. Refer to section 2.3.
7. Press the **RGB/VIDEO** button on the projector or remote to select the source of the signal to be projected on the screen. The selected signal input is displayed at the top right of the screen. The display will show the **last selected input source** before power was turned off.

Projector Shutdown

1. In projection mode, press the **STANDBY/ON** button. The Shut Down screen will display. Select the YES option (press arrow button or mini-joy stick) to turn off. The fan will continue to run for approximately 90 seconds.
2. Turn the **MAIN POWER SWITCH** of the projector off.

Caution

Do not turn off the POWER SWITCH before pressing the STANDBY/ON button. After the STANDBY/ON button is pressed, the fan rotates for about 90 seconds to cool the projector.

3. Attach lens cap to protect projection lens.
4. Disconnect cables if moving projector to new location.