

Quick Guide

DVD VIDEO Recorder D-RW2SU

1 Choosing a Disc

1-1 For playback only This unit is compatible to play the following discs.

Disc	Mark	Specification	Disc	Mark	Specification
DVD video disc		<ul style="list-style-type: none"> 12cm (4 3/4 in.) / 8cm (3 1/4 in.) Region codes: The number inside the globe refers to region of the world. This unit can play DVDs that are labeled for ALL or for Region 1. 	Audio CD (CD-DA)		12cm (4 3/4 in.) / 8cm (3 1/4 in.)
		<ul style="list-style-type: none"> Color system: NTSC 	CD-R		<ul style="list-style-type: none"> 12cm (4 3/4 in.) CD-DA FORMAT, MP3, WMA*, JPEG files
			CD-RW		

DVD is a trademark of DVD Format/Logo Licensing Corporation.

*This DVD/CD player cannot playback the disc contents protected by Windows Media Digital Rights Management (DRM).



Microsoft, Windows Media, and the Windows logo are either registered trademarks or trademarks of Microsoft Corporation in the United States and/or other countries.

1-2 For recording / playback

This unit can record to DVD-R and DVD-RW discs. DVD-R discs can only be recorded once, and cannot be erased. DVD-RW discs can be recorded and erased many times. DVD-R discs can only be recorded in Video mode, while DVD-RW discs can select a recording format between Video mode and VR mode.

Disc type	Disc format	Functions	Attributes
 DVD-RW: 1-4x	Video mode	Playing, limited recording, limited editing	8cm/12cm, single-sided, single layer disc Approx. max. recording time (SEP mode): 600 minutes (4.7GB) (for 12cm) 180 minutes (1.4GB) (for 8cm)
	VR mode	Playing, recording, Original/Playlist editing	
 DVD-R: 2x.4x.8x	Video mode	Playing, limited recording, limited editing	8cm/12cm, single-sided, single layer disc Approx. max. recording time (SEP mode): 600 minutes (4.7GB) (for 12cm) 180 minutes (1.4GB) (for 8cm)

- We strongly recommend using any DVD-R 2x, DVD-RW 4x and MAXELL DVD-R 16x disc to assure good recording quality.
- Discs that have been tested and are proven to be compatible with this recorder:
VERBATIM DVD-R 8x VERBATIM DVD-RW 2x
MAXELL DVD-R 16x JVC DVD-RW 4x

2

Connections

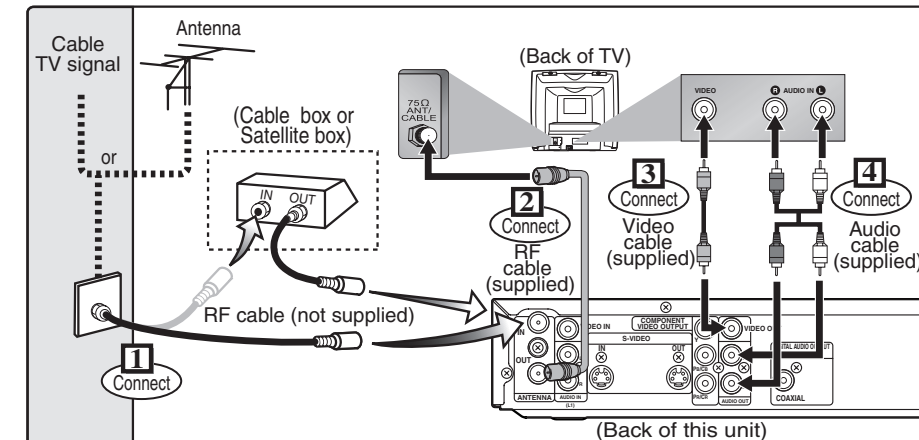

- Both A/V and RF cables must be connected to the TV for operation.
- See page 26 of the Owner's Manual for the connection with the RF modulator.

3

Watching TV/DVD

After all the necessary connections,

- Turn on the equipment connected to the recorder.
 - Select the corresponding video input on your television.
- Perform these selections whenever you operate the recorder.

3-1 DVD Playback

Press **[OPEN/CLOSE]** to open the disc tray.

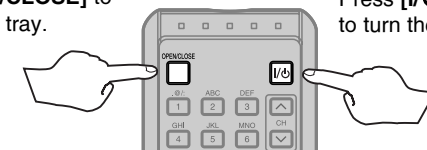

Press **[I/O ON/STANDBY]** to turn the unit on.

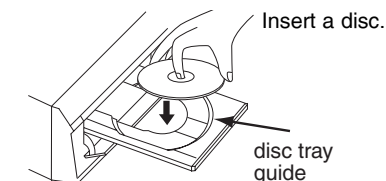

3-2 Initial Setting

1. Turn on this unit for the first time, "Initial Setting" will appear. Using **[▲ / ▼]**, select your desired language for the OSD. Then press **[ENTER]** to go to next step.

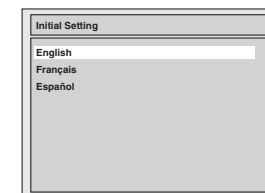

2. Press **[ENTER]** to start Channel Preset. The unit will start getting channels available in your area.

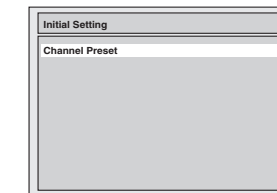

3. Clock Setting menu will appear. Press **[ENTER]** twice, default date will appear.

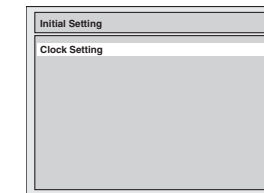

4. Using **[▲ / ▼]**, enter the date (month / day / year). Press **[◀ / ▶]** to move the cursor.

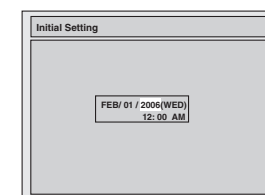

5. Using **[▲ / ▼]**, enter the time (hour / minute). Press **[◀ / ▶]** to move the cursor.

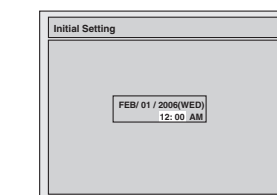

6. Press **[▲ / ▼]** to select "AM" or "PM". Press **[ENTER]**.

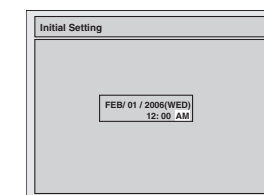

TV Program will automatically appear. (usually near channel 0)

Turn to the back side of this sheet.

4

DVD Recording

4-1 Easy Recording

Select the recording mode.

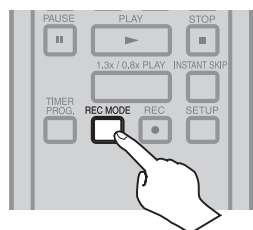

Select the desired channel.

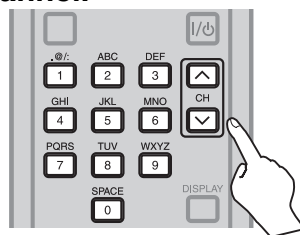

Record on DVD disc.

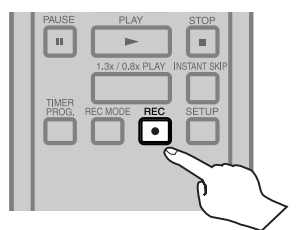

Stop the recording.

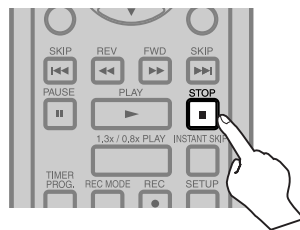

How to select the recording mode:

Disc Size	Recording mode	Recording time	Video/Sound Quality
8cm Disc	XP	18 min	★★★★★
	SP	36 min	★★★★★
	LP	72 min	★★★★
	EP	108 min	★★★
	SLP	144 min	★★
12cm Disc	SEP	180 min	★
	XP	60 min	★★★★★
	SP	120 min	★★★★★
	LP	240 min	★★★★
	EP	360 min	★★★
	SLP	480 min	★★
	SEP	600 min	★

Press repeatedly to select desired recording time.

Recording times appear on the TV screen (30 minutes to 8 hours).
Recording will start.

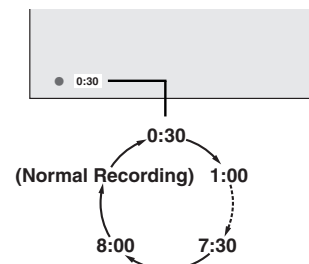
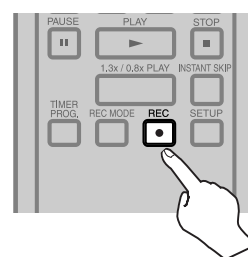

When the unit reaches the specified time, it will be turned off automatically.

After all recordings, finalize your disc.

After recording, you must finalize the disc in order to play on other units. To finalize the disc, see page 74 of the owner's manual.

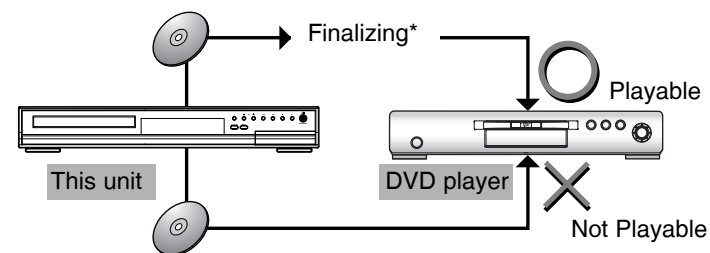

* You cannot finalize discs recorded in other DVD recorders.

4-2 Timer Recording

- You can set up to 8 programs (once, daily or weekly).
- Be sure to set the clock before starting a timer programming.

Press [TIMER PROG.].

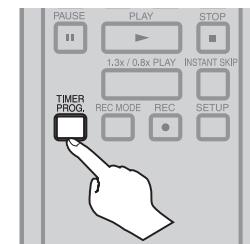

Timer Programming list appears.

Select any blank line with [▲ / ▼] and press [ENTER].

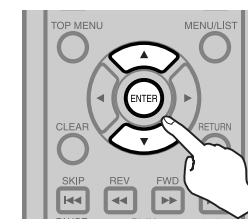
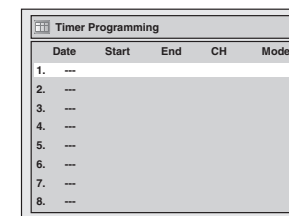

Set the date.

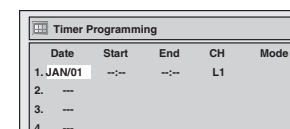

Move to next

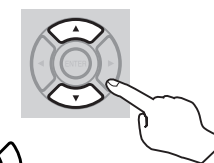

Set start and end time.

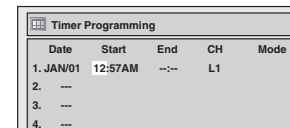

Move to next

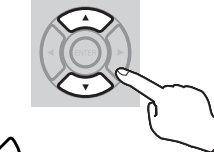

Select the channel number to record.

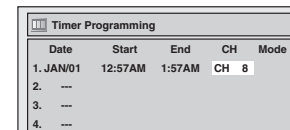

Move to next

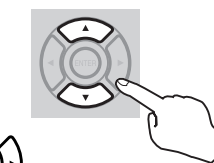

Select the recording speed.

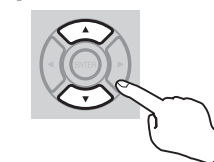
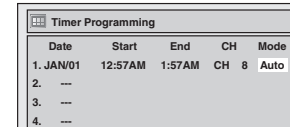

Save the Timer Program setting.

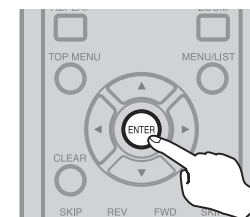

Timer Recording is now set.

When pressing [▼] at the current date, the Date will change as follows:
e.g. January 1st at present

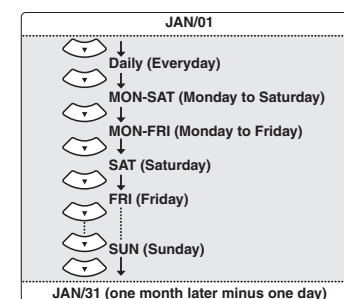

Set the Timer Standby mode

Turn the unit off.

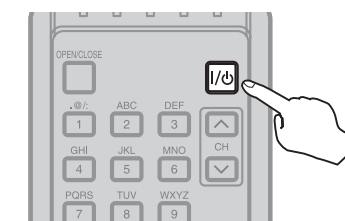

Ⓢ indicator will appear on the front panel display.



Hints for DVD Recording

- Formatting is not needed when inserting a new disc. **UNIT AUTOMATICALLY PREPARES THE DISC FOR RECORDING.**
- Timer Recording will not work when the power is on.