

JVC



COMPACT COMPONENT SYSTEM

CA-NXG7



NX-G3

—Consists of CA-NXG3 and SP-NXG5

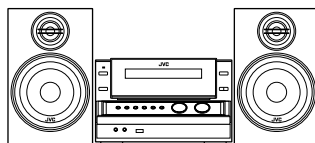

MP3/WMA/WAV

MPEG-4
ASF PLAYBACK

Digital Direct Progressive Scan



Vario BASS



(CA-NXG7)



(CA-NXG7)

INSTRUCTIONS

GVT0259-001B
[US/UN/UB/UG/UX/A/UW]

Warnings, Cautions and Others

CAUTION

The  button in any position does not disconnect the mains line.

Disconnect the mains plug to shut the power off completely (the STANDBY lamp goes off).

The MAINS plug or an appliance coupler is used as the disconnect device, the disconnect device shall remain readily operable.

- When the system is on standby, the STANDBY lamp lights red.
- When the system is turned on, the STANDBY lamp goes off.

The power can be remote controlled.

CAUTION

To reduce the risk of electrical shocks, fire, etc.:

1. Do not remove screws, covers or cabinet.
2. Do not expose this appliance to rain or moisture.

IMPORTANT FOR LASER PRODUCTS

1. CLASS 1 LASER PRODUCT
2. **CAUTION:** Do not open the top cover or cabinet. There are no user serviceable parts inside the unit; leave all servicing to qualified service personnel.
3. **CAUTION:** Visible and/or invisible class 1M laser radiation when open. Do not view directly with optical instruments.
4. REPRODUCTION OF LABEL: CAUTION LABEL, PLACED INSIDE THE UNIT.

CAUTION	ATTENTION	AVISO	WARNING	注意	CAUTION
VISIBLE AND/OR INVISIBLE CLASS 1M LASER RADIATION WHEN OPEN, DO NOT VIEW DIRECTLY WITH OPTICAL INSTRUMENTS	ATTENTION LASER VISIBLE ET/OU INVISIBLE DE CLASSE 1M LORS QU'ON Ouvre L'APPAREIL NE PAS REGARDER DIRECTEMENT AVEC DES INSTRUMENTS OPTIQUES	ADVERTENCIA LASER DE CLASE 1M VISIBLE Y/O INVISIBLE CUANDO SE ABRINTO, NO MIRAR DIRECTAMENTE CON INSTRUMENTOS OPTICOS	VISIBLE AND/OR INVISIBLE CLASS 1M LASER RADIATION WHEN OPEN, DO NOT VIEW DIRECTLY WITH OPTICAL INSTRUMENTS	レーザー光線 の放射があります 開いた状態で 直接見ないで ください 望遠鏡等の 光学器具を用 いて直接見ないで ください	VISIBLE AND/OR INVISIBLE CLASS 1 LASER RADIATION WHEN OPEN, DO NOT VIEW WITH OPTICAL INSTRUMENTS
MODELS 1-2001 SWS OPTICAL	SWA OPTICAL	SWA OPTICAL	SWA OPTICAL	SWA OPTICAL	SWA OPTICAL

CAUTION

- Do not block the ventilation openings or holes.
(If the ventilation openings or holes are blocked by a newspaper or cloth, etc., the heat may not be able to get out.)
- Do not place any naked flame sources, such as lighted candles, on the apparatus.
- When discarding batteries, environmental problems must be considered and local rules or laws governing the disposal of these batteries must be followed strictly.
- Do not expose this apparatus to rain, moisture, dripping or splashing and that no objects filled with liquids, such as vases, shall be placed on the apparatus.

CAUTION:

Excessive sound pressure from earphones or headphones can cause hearing loss.



[European Union only]

CAUTION:

Battery shall not be exposed to excessive heat such as sunshine, fire or the like.

Caution: Proper Ventilation

To avoid risk of electric shock and fire, and to prevent damage, locate the apparatus as follows:

1. Front: No obstructions and open spacing.
2. Sides/Top/ Back: No obstructions should be placed in the areas shown by the dimensions below.
3. Bottom: Place on the level surface. Maintain an adequate air path for ventilation by placing on a stand with a height of 10 cm or more.

Front view

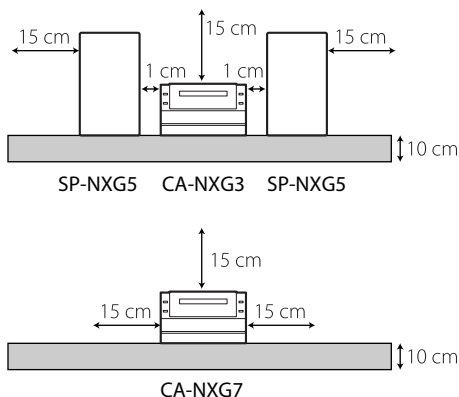

Side view

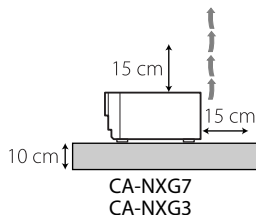

Introduction

Thank you for purchasing a JVC product. Please read all instructions carefully before operation, to ensure your complete understanding and to obtain the best possible performance from the System.

Precautions

Installation

- Install the System in a location with adequate ventilation to prevent internal heat build-up in the System.



DO NOT install the System in a location near heat sources, or in a place subject to direct sunlight, excessive dust or vibration.

- Install in a place which is level, dry and neither too hot nor too cold—between 5°C and 35°C.
- Leave sufficient distance between the System and the TV.
- Keep the speakers away from the TV to avoid interference with the TV.

Power sources

- When unplugging the System from the wall outlet, always pull on the plug, not the power cord.



DO NOT handle the power cord with wet hands.

Moisture condensation

Moisture may condense on the lens inside the System in the following cases:

- After starting to heat the room
- In a damp room
- If the System is brought directly from a cold to a warm place.

Should this occur, the System may malfunction. In this case, leave the System turned on for a few hours until the moisture evaporates, unplug the power cord, then plug it in again.

Internal heat

- Make sure there is good ventilation around the System. Poor ventilation could overheat and damage the System.



DO NOT block the ventilation openings or holes. If they are blocked by a newspaper or cloth, etc., the heat may not be able to get out.

Others

Should any metallic object or liquid fall into the System, unplug the power cord and consult your dealer before operating any further.



DO NOT disassemble the System since there are no user serviceable parts inside.

- If you are not going to operate the System for an extended period of time, unplug the power cord from the wall outlet.

If anything goes wrong, unplug the power cord and consult your dealer.

How to Read This Manual

- Button and control operations are explained in the table below.
- Some related tips and notes are explained later in the sections “Learning More about This System” and “Troubleshooting,” but not in the same section explaining the operations. (INFO indicates that the content has some information).
- Illustrations used in this manual is mainly of CA-NXG7. They may look different from the model you have.

	Indicates that you press the button briefly .
	Indicates that you press the button briefly and repeatedly until the option you want is selected.
	Indicates that you press one of the buttons.
	Indicates that you press and hold the button for a specified period.
	Indicates that you turn the control in the specified direction(s).
	Indicates that this operation is only possible using the remote control.
	Indicates that this operation is only possible using the main unit.

Contents

Playable Disc/File Types	3
Connections	4
Rear panel	4
Preparing the remote control	6
Changing the Color System and Scanning Mode	7
Front panel	7
Display Indicators	8
Daily Operations—Playback	9
Listening to the Radio	10
Playing Back a Disc/USB Mass Storage Class Device	12
Playing Back a Digital Audio Player	14
Sound & Other Adjustments	15
Adjusting the Sound	15
Creating a Soothing Tone for Your Ear —MY SOUND	16
Creating 3-Dimensional Sound Field —3D Phonic	17
Creating a Spacious Sound Field for Headphones—HP Surround	17
Making Dialogues Clear —Clear Voice	17
Selecting the Sound Modes	17
Creating Your Own Sound Modes —User Mode	18
Presetting Automatic DVD Sound Increase Level	19
Changing the Display Brightness	19
Setting the ECO (ecology) Mode	19
Changing the Picture Tone	19
Setting the Clock	20
Turning Off the Power Automatically	21
Prohibiting Disc Ejection—Child Lock	21
Unique Video Disc/File Operations	22
Selecting the Audio Track	22
Selecting the Subtitle Language	23
Selecting the View Angle	23
Special Effect Playback	23

Advanced Playback Operations 25

Programming the Playing Order —Program Play	25
Playing at Random—Random Play	26
Playing Repeatedly	27

Recording and Editing Operations 28

Recording from a Disc	29
Giving (Editing) Titles to Tracks or Groups	30
Erasing the Tracks or Groups	32

Enjoying Karaoke (only for CA-NXG7) ... 33

Singing Along (Karaoke)	33
Adjusting the Sound Track for Karaoke	34
Scoring Your Karaoke Skill	34
Changing the Karaoke Setting	35
Reserving Karaoke Songs —Karaoke Program Play	37

On-Screen Operations 38

On-screen Bar Operations	38
Control Screen Operations	41

Daily Timer Operations 43

Setting the Daily Timer	43
-------------------------------	----

Setup Menu Operations 45

Initial Settings	45
------------------------	----









Additional Information 47

Learning More about This System	47
Operating JVC's TVs Using the Remote Control	50
Maintenance	51
Optical Digital Out Signals	51
Troubleshooting	52
Display Messages for Recording or Editing Operations	54
Language Code List	54
Specifications	55

Parts Index 56

Remote control	56
Main unit	56

Playable Disc/File Types

   	
MP3/WMA/WAV MPEG-4 <small>ASF PLAYBACK</small>	
   	
<ul style="list-style-type: none"> CD-R/-RW: Recorded in the Audio CD, Video CD, and SVCD formats. MP3, WMA, WAV, JPEG, MPEG-1, MPEG-2, ASF and DivX files written in accordance with the "ISO 9660" format can also be played. 	
<ul style="list-style-type: none"> DVD-R/-RW, +R/+RW: MP3, WMA, WAV, JPEG, MPEG-1, MPEG-2, ASF and DivX files written in the UDF-Bridge format can be played. 	
<ul style="list-style-type: none"> DVD-R/-RW: Recorded in the DVD Video format and the DVD Video Recording (VR) format. 	
<ul style="list-style-type: none"> +R: Recorded in the DVD Video format. 	
<ul style="list-style-type: none"> DVD-ROM: MP3, WMA, WAV files. 	
<ul style="list-style-type: none"> USB mass storage class device: MP3, WMA, WAV, JPEG, MPEG-1, MPEG-2, ASF and DivX* files. 	

In addition to the above discs/files, this System can play back audio data recorded on CD-Extra and CD-G (CD-Graphics).

- The following discs cannot be played back: DVD-RAM, CD-I (CD-I Ready), CD-ROM, and Photo CD.
- Playing back these discs will generate noise and damage the speakers.
- CD Text and DVD Text can be played, but Text information will not be shown on the display.
- It is possible to play back finalized +R/+RW discs.
- "DVD Logo" is a trademark of DVD Format/Logo Licensing Corporation.
- This System can play back EVERIO file (see page 48) recorded on DVD, CD*, and USB mass storage class device*.

* Only when the maximum bit rate is less than 2 Mbps.

About color system

This System accommodates both NTSC and PAL system and can play back discs/files recorded in either system.

To change the color system, see page 7.

Note on Region Code

DVD players and DVDs have their own Region Code numbers. This System can play back only DVDs with an appropriate Region Code number.

- For details, see page 55.
- "REGION ERR" appears if DVD with a wrong Region Code is loaded.

Ex.: For Southeast Asia



Caution for DualDisc playback

The Non-DVD side of a "DualDisc" does not comply with the "Compact Disc Digital Audio" standard. Therefore, the use of the Non-DVD side of a DualDisc in this product may not be recommended.

IMPORTANT: Before playing a disc/file, make sure of the following...

- Turn on the TV and select an appropriate input mode on the TV to view the pictures or on-screen displays.
 - For disc/file playback, you can change the initial setting to your preference. See "Setup Menu Operations" on page 45.
- If "⊗" appears on the TV screen when you press a button, the disc/file cannot perform the operation you have tried to do.

- When playing a multi-channel encoded software, the System properly converts the multi-channel signals into 2 channels, and emits the downmixed sound from the speakers. To enjoy the powerful sound of these multi-channel encoded software, connect a proper decoder or an amplifier with a proper built-in decoder to the OPTICAL DIGITAL OUTPUT terminal on the rear.

How to cancel the demonstration

Press and hold DEMO button on the main unit (until "DEMO CLEAR" appears on the display) while on standby.

- Refer to the attached sheet "Information about the demonstration function."

Connections INFO

Do not connect the power cord until all other connections have been made.

- Connect VIDEO OUT directly to the video input of your TV. Connecting VIDEO OUT to a TV via a VCR may interfere with your viewing when playing back copy-protected discs/files. Connecting VIDEO OUT to an integrated TV/VCR system may also interfere with your viewing.

Supplied accessories

Check to be sure that you have all the following items.

- FM antenna (×1)
- AM loop antenna (×1)
- Composite video cord (×1)
- Remote control (×1)
- Batteries (×2)
- AC plug adapter (×1)
(Not supplied for Australia, Hong Kong, Thailand and the Middle East.)

If any items are missing, consult your dealer immediately.

Rear panel

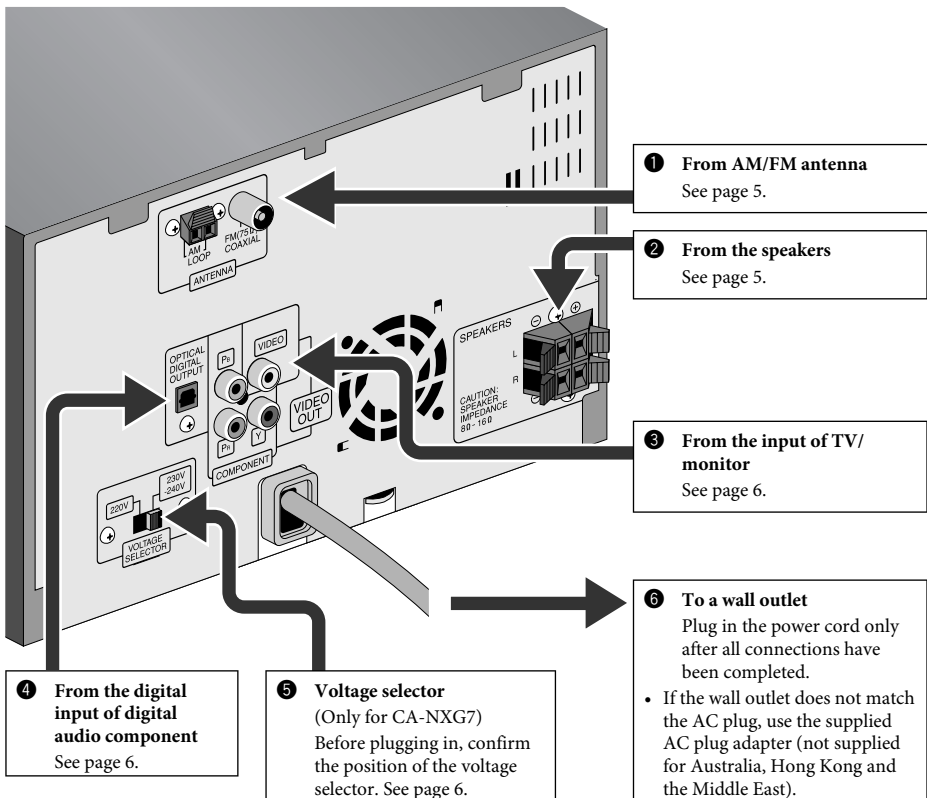

* The illustration above is for CA-NXG7.

1 AM/FM antenna

To assemble the AM loop antenna

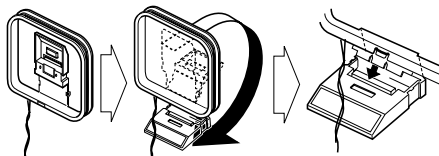

To connect AM/FM antenna

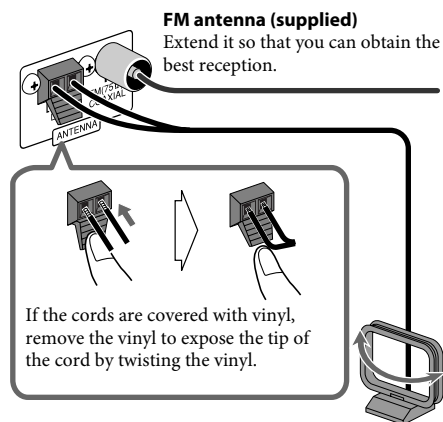

AM loop antenna (supplied)
Turn it until the best reception is obtained.

For better FM reception

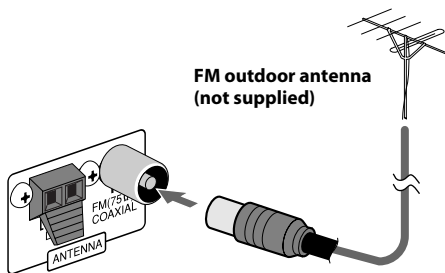

Disconnect the supplied FM antenna, and connect to an outdoor FM antenna using a 75 Ω wire with coaxial type connector (IEC or DIN45325).

2 Speakers

When connecting the speaker cords, match the polarity of the speaker terminals.

CA-NXG7: red to (+) and black to (-)

NX-G3: blue to (+) and black to (-)

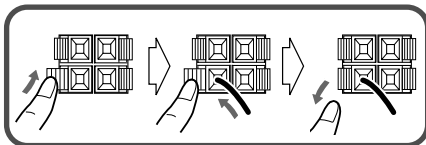

CA-NXG7

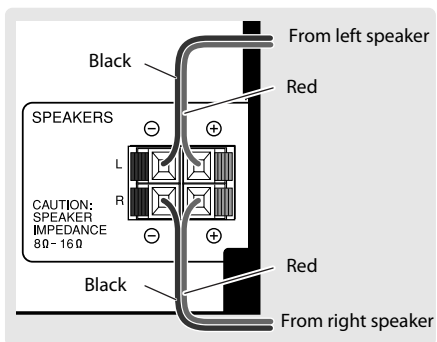

NX-G3

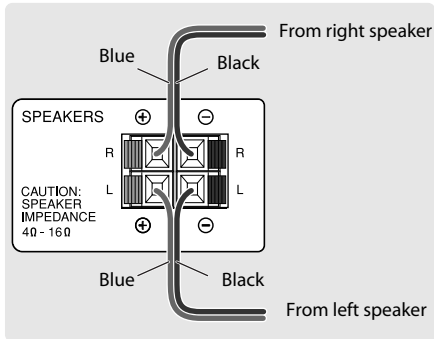

- DO NOT connect more than one speaker to each terminal.
- DO NOT push or pull the speakers as this will damage the foot spacers at the bottom of the speakers.

3 TV/monitor

Connect either a component video cord or a composite video cord.

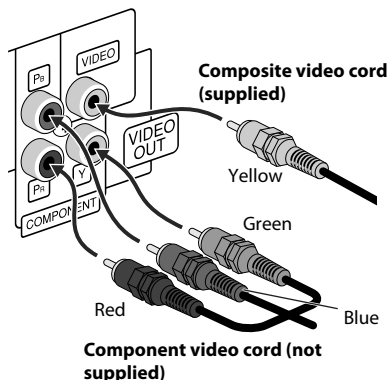

- To select progressive scanning mode (see page 7), use COMPONENT jacks.
- After connecting a TV, select the appropriate video signal output according to the color system. See “Changing the Color System and Scanning Mode” on page 7.

4 Digital audio component

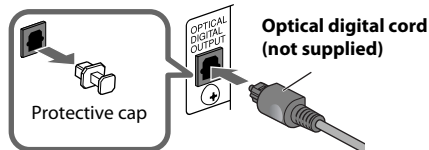

- Set “DIGITAL AUDIO OUTPUT” in the “AUDIO” menu correctly according to the connected digital audio equipment (see page 46).
- The digital signal through the OPTICAL DIGITAL OUTPUT terminal is transmitted only when “DVD/CD” is selected as the source.

5 Voltage selector (only for CA-NXG7)

- This operation is not required for Saudi Arabian models and Australian models.

Use a screwdriver to slide the voltage selector so that it is pointing to the correct voltage in the area you are plugging in the unit. (See also the back cover page.)

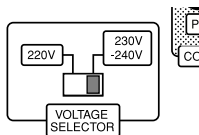

Preparing the remote control

Insert the battery into the remote control by matching the polarity (+ and -) correctly.

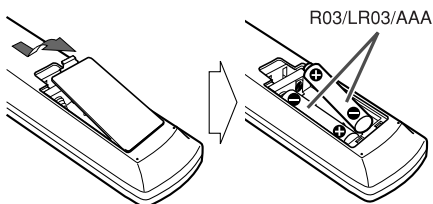

If the range or effectiveness of the remote control decreases, replace both batteries.

When using the remote control

Point the top of the remote control towards the remote sensor as directly as possible. If you operate it from a diagonal position, the operating range (approx. 5 m) may be shorter.

Changing the Color System and Scanning Mode

INFO

You can select the video output to match it to the color system of your TV (NTSC or PAL).

- If you connect a progressive TV through the COMPONENT jacks, you can enjoy a high quality picture by selecting progressive scanning mode.
- You can change the setting only while playback is stopped.

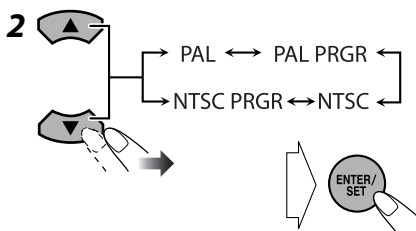
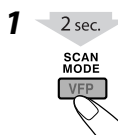

NTSC / PAL NTSC or PAL Interlaced scanning.
For a conventional NTSC or PAL TV.

**NTSC PRGR/
PAL PRGR** NTSC or PAL Progressive scanning.
For a progressive NTSC or PAL TV.

- The PRGR indicator lights up on the display.

Front panel

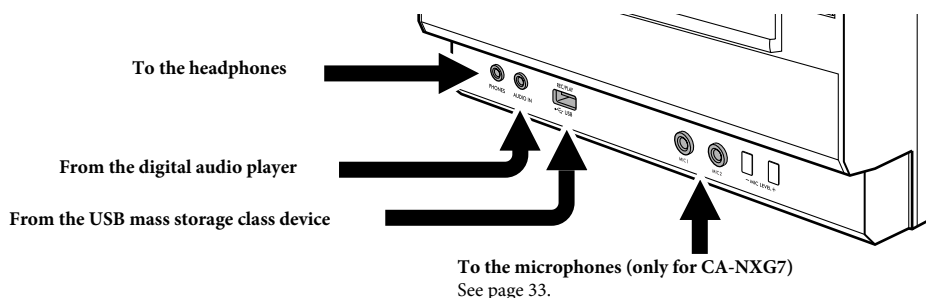

When connecting a USB mass storage class device

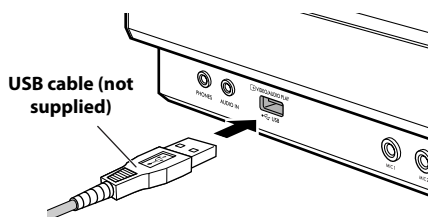

- When connecting with a USB cable, use the USB 2.0 cable whose length is less than 1 m.
- You can connect a USB mass storage class device such as a USB flash memory device, hard disk drive, multimedia card reader, etc. to this System.
- You cannot connect a computer to the USB REC/PLAY (🔌) terminal of the System.

- You cannot connect JVC Everio camcorder to the USB REC/PLAY (🔌) terminal of the System.
- Noise and static electricity may stop the USB mass storage class device sound. In this case, disconnect and connect the USB mass storage class device again after turning off the System.

When connecting a digital audio player

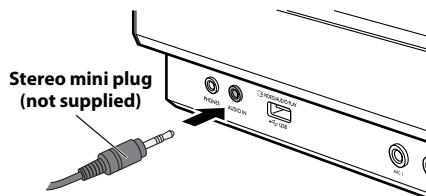

From audio output (or headphone out, etc.)

- See page 14 for audio input level.

Display Indicators

The indications on the display tell you a lot of things while you are operating the System.
Before operating the System, be familiar with when and how the indicators illuminate on the display.

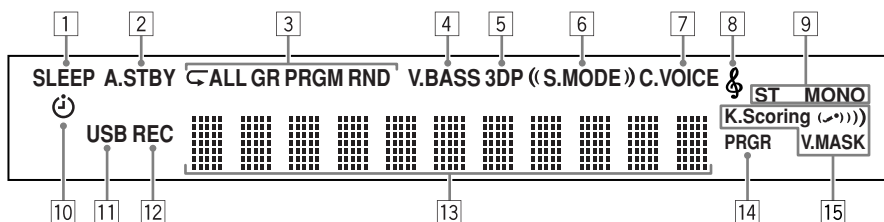

- 1 SLEEP indicator
 - Lights when the Sleep Timer is activated. (See page 21.)
- 2 A.STBY (Auto Standby) indicator (See page 21.)
 - Lights when Auto Standby is activated.
 - Flashes when playback stops with Auto Standby activated.
- 3 Playback mode indicators
 - PRGM: lights when Program Play is activated. (See page 25.)
 - RND: lights when Random Play is activated. (See page 26.)
 - Repeat Mode indicators (See page 27.)
 - **ALL**: lights when REPEAT ALL is activated.
 - **GR**: lights when REPEAT GRP is activated.
 - **⏮**: lights when any Repeat Mode other than above is activated.
- 4 V. BASS indicator
 - Lights when VARIO BASS is activated. (See page 15.)
- 5 3DP indicator
 - Lights when 3D Phonic is activated. (See page 17.)
- 6 Sound Mode indicators (See page 17.)
 - S.MODE: lights when one of the Sound Modes is activated.
 - **(())**: lights when one of the Sound Modes with surround effect is activated.
- 7 C. VOICE (Clear Voice) indicator
 - Lights when Clear Voice is activated. (See page 17.)
- 8 **🎵** (My Sound) indicator
 - Lights when MY SOUND is activated. (See page 16.)
- 9 FM reception indicators (See page 11.)
 - ST (Stereo): lights while an FM stereo station with sufficient signal strength is tuned in.
 - MONO (Monaural): lights while receiving an FM stereo station in monaural.
- 10 Daily Timer indicators (See page 43.)
 - **🕒**: lights when Daily Timer is on standby or is being set; flashes while it is working.
- 11 USB indicator
 - Lights when USB is selected as the source. (See page 12.)
- 12 REC (Recording) indicator
 - Lights when recording started. (See page 29.)
- 13 Main display
- 14 PRGR (Progressive) indicator
 - Lights when the progressive scanning mode is selected. (See page 7.)
- 15 Karaoke operation indicators (only for CA-NXG7) (See page 33.)
 - K.Scoring: lights when Karaoke Scoring is activated; flashes when Karaoke Scoring is in use.
 - **(🎤)**: lights when Mic Mixing is activated.
 - **)))**: lights when Echo is activated.
 - V.MASK: lights when Vocal Masking is activated.

Daily Operations—Playback INFO

In this manual, operations using the remote control are mainly explained; however, you can use the buttons and controls on the main unit if they have the same (or similar) name and marks.

To prevent accidental injuries, do not touch the front panel while it is opening or closing.

Remote control

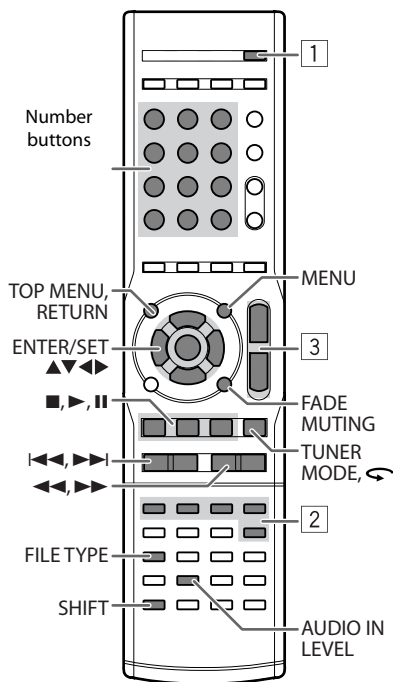

Main unit

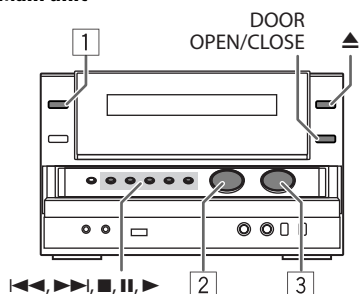

1 Turn on the power.

On the remote:	On the main unit:
AUDIO 	

- The STANDBY lamp on the main unit turns off.
- The front panel opens automatically.

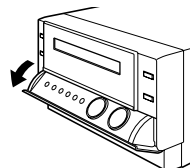

2 Select the source.

On the remote:	On the main unit:
DVD/CD USB FM AM AUDIO IN	

- Playback automatically starts if the selected source is ready.

3 Adjust the volume.

You can adjust the volume level from "VOLUME MIN" (level 0) to "VOLUME MAX" (level 31).

On the remote:	On the main unit:
CA-NXG7: TV VOL AUDIO VOL 	NX-G3: AUDIO VOL

■ To turn off (standby) the System

AUDIO

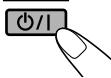

The STANDBY lamp on the main unit lights in red.

- A small amount of power is always consumed even while on standby.

■ To open/close the front panel

On the remote:	On the main unit:
<p>1 sec TUNER/PLAY MODE</p>	<p>DOOR OPEN/CLOSE</p>

■ To drop the volume in a moment



To restore the volume, press again, or adjust the volume level.

For private listening

Connect a pair of headphones to the PHONES jack on the main unit. The sound will no longer come out of the speakers. "HPHONE IN" appears on the display for a while. **Be sure to turn down the volume before connecting or putting on the headphones.**

- Disconnecting the headphones will activate the speakers again.



DO NOT turn off (standby) the System with the volume set at an extremely high level; otherwise, the sudden blast of sound may damage your hearing, speakers and/or headphones when you turn on the System or start playback.

How to select a number

MARK 1	ABC 2	DEF 3
GHI 4	JKL 5	MNO 6
PQRS 7	TUV 8	WXYZ 9
SLEEP 10	A, STBY 0	CLOCK/TIMER ±10

Examples:

To select number 5, press 5.
To select number 10, press 10.
To select number 15, press \geq 10, 1, then 5.
To select number 30, press \geq 10, 3, then 0.
To select number 125, press \geq 10, \geq 10, 1, 2, then 5.

Listening to the Radio

INFO

■ To select the AM tuner interval spacing



Some countries space AM stations 9 kHz apart, and other countries use 10 kHz spacing.

1 Select "TUNER AM."

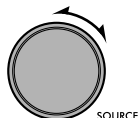

2 Select the AM tuner interval spacing.

To select 9 kHz:

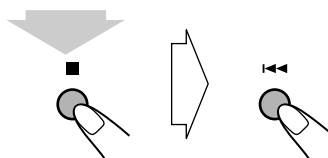

(while holding...)

AM 9kHz

To select 10 kHz:

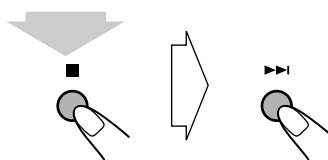

(while holding...)

AM 10kHz

■ To select the band (FM or AM)



■ To tune in to a station

While FM or AM is selected...



Frequency starts changing on the display.
When a station (frequency) with sufficient signal strength is tuned in, the frequency stops changing.

- When you repeatedly press the button, the frequency changes step by step.

To manually stop the search, press either button.

If the FM reception is poor



The MONO (monaural) indicator lights on the display. Reception will improve though stereo effect is lost—Monaural reception.

To restore the stereo effect, press the button again.
The MONO (monaural) indicator disappears.

■ To preset the stations

You can preset 30 FM and 15 AM stations.

1 Tune in to a station you want to preset.

- You can also store the monaural reception mode for FM preset stations if it is selected.

2 Activate the preset number entry mode.



- Finish the following process while the indication on the display is flashing.

3 Select a preset number for the station you store.



- To select a number, see “How to select a number” on page 10.

4 Store the station.



■ To tune in to a preset station

1 Select the band (FM or AM).



2 Select the preset number for the station you stored.



- To select a number, see “How to select a number” on page 10.

Playing Back a Disc/USB Mass Storage Class Device

INFO

To insert a disc

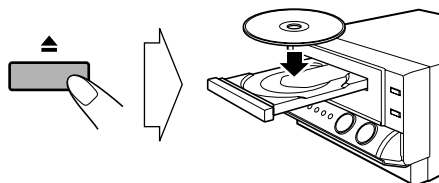

- When using an 8 cm disc, place it on the inner circle of the disc tray.

To close the disc tray, press ▲ again.

- If you press DVD/CD ►/■, disc tray closes automatically and playback starts (depending on how the disc is programmed internally).

To connect a USB mass storage class device

- For connecting a USB mass storage class device, see page 7.
- Always set volume level to the minimum level when connecting or disconnecting a USB mass storage class device.
- To disconnect a USB mass storage class device safely, turn off the System before disconnecting it.

■ To play back a disc/USB mass storage class device

To start:	
<p>Disc</p>	<p>USB mass storage class device</p>
To pause:	To stop:
To release, press ►.	

- You can use the control screen shown on the TV. (For still/moving picture files, it appears while playback is stopped.) For details, see page 41.

Resume function

The System can store the stop point, and when you start playback again by pressing ►, DVD/CD ►/■ or USB ►/■ (even while on standby), it starts from the position where you have stopped—Resume Play.

To stop completely while Resume is activated, press ■ twice. (To deactivate Resume, see “RESUME” in “OTHERS” menu on page 46.)

On-screen guide icons

- During playback, the following icons may appear on the TV:



At the beginning of a scene containing multi-angle views.



At the beginning of a scene containing multi-audio sounds.



At the beginning of a scene containing multi-subtitles.

- The following icons will also be shown on the TV to indicate your current operation.



- To deactivate the on-screen guide icon, see “ON SCREEN GUIDE” in “OTHERS” menu on page 46.

■ To select the file type

If different types of playable files (audio/still picture/moving picture) are recorded, select a file type to play.

While playback is stopped...

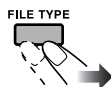

- You can also select the file type using Setup Menu. See “FILE TYPE” in “PICTURE” menu on page 46.

■ To select a title/group

- Not applicable for DVD-VR.
- While playing...

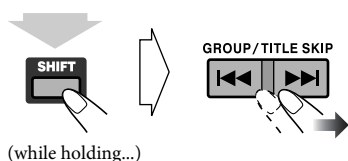

■ To select a chapter/track/file

- For SVCD/VCD, cancel PBC (see page 14).

While playing...



- When you press for the first time, you will go back to the beginning of the current chapter/track/file.

■ To locate a particular portion

- This does not function for JPEG files.

While playing...

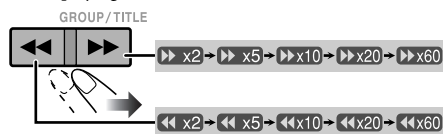

- For MP3/WMA/WAV/MPEG-1/MPEG-2/ASF/DivX files, the search speed and indications on the TV are different from those above.
- No sound comes out if searching is carried out while showing the moving picture.

To return to normal playback, press .

For DivX/MPEG-1/MPEG-2 files, each time you press the or button, you can skip to a scene by 30 seconds or 5 minutes depending on the files.

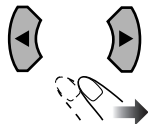

■ To locate an item directly

To select a title/group

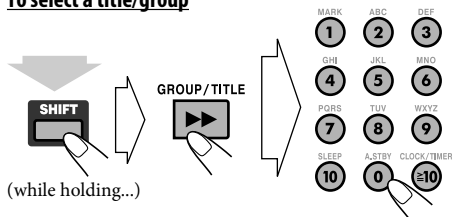

- To select a number, see “How to select a number” on page 10.

To select a chapter/track/file

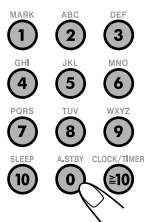

- To select a number, see “How to select a number” on page 10.

■ To play back using the disc menu

For DVD Video:

1 Show the disc menu.

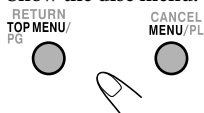

2 Select an item on the disc menu.

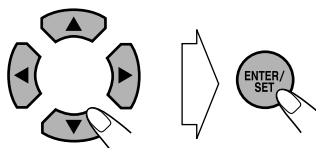

- For some discs, you can also select items by entering the number using the number buttons.

For SVCD/VCD with PBC:

While playing a disc with PBC, “PBC” appears on the display.

When disc menu appears on the TV, select an item on the menu. Playback of the selected item starts.

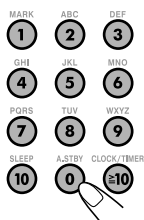

- To select a number, see “How to select a number” on page 10.

To move to the next or previous page of the current menu:

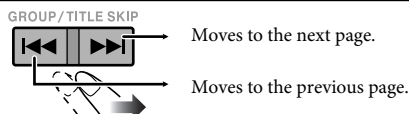

To return to the previous menu:

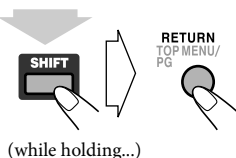

To cancel PBC, press ■, then select a track by using the number buttons (see page 10). Playback starts with the selected track.

To reactivate PBC, press ■ (twice if Resume is turned on), then press DVD/CD ►/II.

Playing Back a Digital Audio Player

- For connecting a digital audio player, see page 7.

You can listen to the digital audio player connected to the AUDIO IN jack.

- Make sure to turn down the volume on the System to minimum level before starting playback.



■ To adjust the audio input level



If the sound from the device connected to the AUDIO IN jack is too loud or too quiet, you can preset the audio input level through the AUDIO IN jack (without changing the volume level).

While “AUDIO IN” is selected as the source...

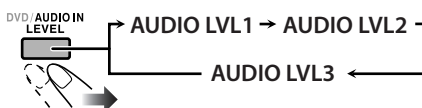

- As the number of the level increases, the preset input level is increased.

Sound & Other Adjustments

Remote control

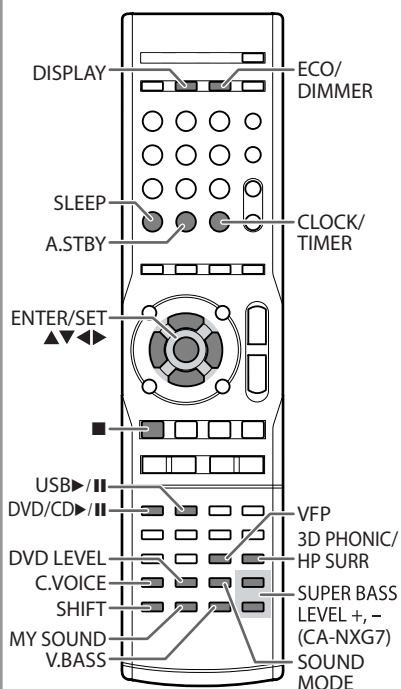

Main unit

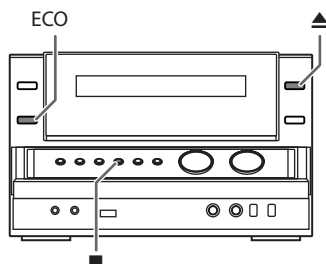

Adjusting the Sound

INFO

Remote ONLY

■ Applying an Optimal Bass Sound Effect —VARIO BASS

VARIO BASS function adjusts bass sound characteristics to create a sound suitable for the playback source of your preference.

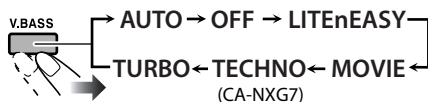

AUTO	The System automatically applies TURBO, LITeEASY, MOVIE or TECHNO according to the playback source (initial setting).
LITeEASY	Suitable for Karaoke and classical music. You can obtain a comfortable bass sound.
MOVIE	Suitable for a video source and playback of external component. You can obtain a strong bass sound.
TECHNO (only for CA-NXG7)	Suitable for disco or techno music. You can obtain a strong bouncy bass sound.
TURBO	Suitable for most kinds of music and playback of external component. You can obtain a balanced bass sound.
OFF	No sound effect.

■ Reinforcing the bass sound —SUPER BASS

You can adjust the bass level from level 1 to level 5.

- This function is available only on CA-NXG7.

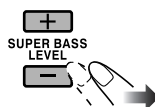

Creating a Soothing Tone for Your Ear—MY SOUND



The sound tone you can hear is different in individuals. MY SOUND creates an appropriate equalization pattern for your listening condition.

■ To set up MY SOUND

1 Select “DVD/CD” or “USB” as the source.

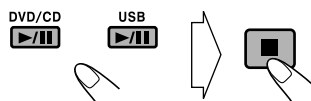

2 Enter MY SOUND setup.

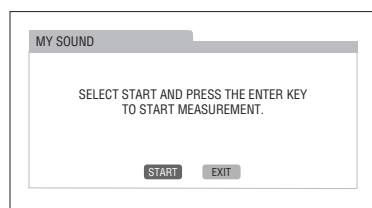

On the TV

“MY SOUND” and “MEASURE” appear alternately on the display.

3 Start the measurement.

A test tone comes out of the speakers.

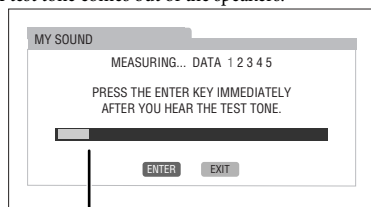

On the TV
Signal level

4 Memorize the measurements.



Each time you hear a test tone, press the button. You hear 5 test tones from the speakers.

5 Select a preset number from 1 to 3 to store the equalization pattern.

After finishing the measurement, an appropriate equalization pattern is created and it is shown in white on the TV screen.

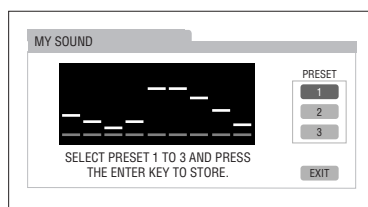

On the TV

- The last equalization pattern stored into the selected preset number is shown in green.
- To return to the measurement, select “EXIT” on the TV screen then press ENTER/SET.

6 Store the equalization pattern.



- To store other equalization patterns, press the button again and repeat steps 3 to 6.

To exit MY SOUND setup



■ To select the preset MY SOUND

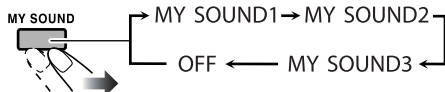

- This does not function for DivX file.

Creating 3-Dimensional Sound Field

—3D Phonic



- This only functions while listening to disc/USB mass storage class device.
- This does not function for MPEG-1/MPEG-2/ASF/DivX files.

While playing...

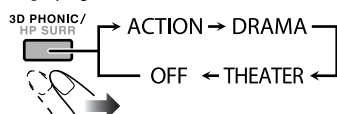

ACTION	Suitable for action movies and sports programs.
DRAMA	Creates natural and warm sound. Enjoy movies in a relaxed mood.
THEATER	Enjoy sound effects like in a major theater.
OFF	Canceled.

Creating a Spacious Sound Field for Headphones—HP Surround



- This only functions while listening to disc/USB mass storage class device.
- This does not function for MPEG-1/MPEG-2/ASF/DivX files.

1 Connect headphones to the System.

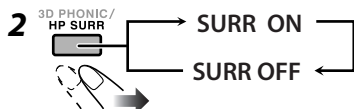

SURR ON	HP Surround is activated.
SURR OFF	Canceled.

Making Dialogues Clear

—Clear Voice



Clear Voice works for multi-channel software which contains a center channel signal and for 2-channel software with 3D Phonic activated.

- This only functions while listening to disc/USB mass storage class device.



Selecting the Sound Modes



You can select one of the preset Sound Modes.

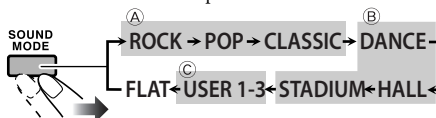

A SEA (Sound Effect Amplifier) Modes

ROCK	Boosts low and high frequency. Good for acoustic music (initial setting).
POP	Good for music with an emphasis on vocal.
CLASSIC	Good for classical music.

B Surround Modes*

DANCE	Increases resonance and bass.
HALL	Adds depth and brilliance to the sound.
STADIUM	Adds clarity and spreads the sound, as in an outdoor stadium.

C User Modes

USER1/2/3	Your individual mode stored in memory. See "Creating Your Own Sound Modes—User Mode" on the next page.
------------------	--

* Surround elements are added to the SEA elements to create being-there feel in your room.

- While one of the Sound Modes is activated, S.MODE indicator lights up.
- While one of the Sound Modes with surround effect is activated, "()" lights up.

To cancel the Sound Mode, select "FLAT."

Creating Your Own Sound Modes

User Mode



You can adjust the preset Sound Modes to create your own Sound Modes which suit your taste. The changed settings can be stored as the USER1, USER2 and USER3 Modes.

1 Select one of the preset Sound Modes.

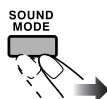

- To create your own Sound Mode with surround effect, select DANCE, HALL or STADIUM.

2 Start editing the selected Sound Mode.



3 Select the SEA parameter you want to adjust.

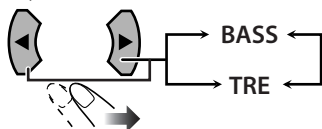

BASS To adjust the bass sound.

TRE To adjust the treble sound.

4 Adjust the parameter.



BASS +2

- You can adjust the bass and treble level from -4 to +4.
- Repeat steps 3 and 4 to adjust the other parameters.

5 Finish the adjustment.



6 Select one of the User Modes to store your setting into.

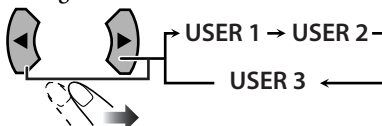

7 Store the setting.



MEMORY

- You can adjust the SEA pattern temporarily by doing the operation on steps 1 to 4. The adjustment is cleared when you change the sound mode to another mode.

Presetting Automatic DVD Sound Increase Level



DVD sound is sometimes recorded at a lower level than other discs and sources. You can set the increase level for the currently loaded DVD, so you do not have to adjust the volume when you change the source.

- This only functions for DVD Video and DVD-VR.

While “DVD/CD” is selected as the source...

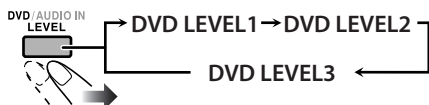

As the number increases, the DVD sound level is increased.

Changing the Display Brightness



You can dim the display.

While the System is turned on...

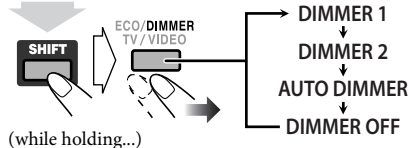

DIMMER 1 Dims the display and turns off the blue illumination on the main unit.

DIMMER 2 Dims the display more than DIMMER 1 and turns off the blue illumination on the main unit.

AUTO DIMMER Dims the display automatically to the same level as DIMMER 2 when moving pictures or still pictures are being played back.

DIMMER OFF Normal brightness.

Setting the ECO (Ecology) Mode



Setting the ECO mode allows you to reduce power consumption by turning the display off while on standby.

While the System is on standby...

On the remote:

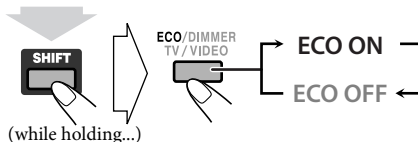

On the main unit:

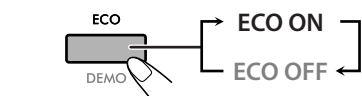

Changing the Picture Tone



While showing a playback picture on the TV, you can select a preset picture tone, or adjust it and store your own preference.

■ To select a preset picture tone

1 While playing, display VFP setting screen.

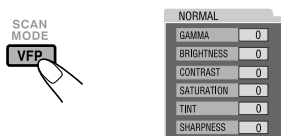

On the TV

2 Select a preset picture tone.

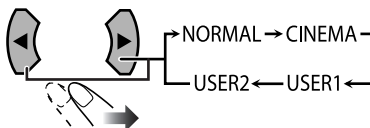

NORMAL Normally select this.

CINEMA Suitable for a movie source.

USER1/USER2 You can adjust parameters and can store the settings. (See the next page.)

To clear the screen, press VFP again.

■ To adjust the picture tone

1 Select "USER1" or "USER2."

- Follow steps 1 and 2 explained in "To select a preset picture tone."

2 Select a parameter you want to adjust.

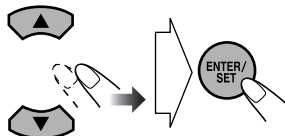

GAMMA	Adjust if the neutral color is bright or dark (-3 to +3).
BRIGHTNESS	Adjust if the entire picture is bright or dark (-8 to +8).
CONTRAST	Adjust if the brightness ratio is unnatural (-7 to +7).
SATURATION	Adjust if the picture is whitish or blackish (-7 to +7).
TINT	Adjust if the human skin color is unnatural (-7 to +7).
SHARPNESS	Adjust if the picture is indistinct (-8 to +8).

3 Adjust the parameter.

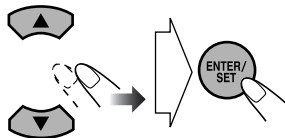

4 Repeat steps 2 and 3 to adjust other parameters.

To clear the screen, press VFP again.

Setting the Clock

INFO

Remote ONLY



Without setting the built-in clock, you cannot use Daily Timer (see page 43).

- To exit the clock settings, press CLOCK/TIMER (while holding SHIFT) as required.
- To correct a mis-entry during the process, press CANCEL (while holding SHIFT). You can return to the previous step.

1 Activate the clock setting mode.

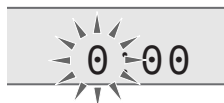
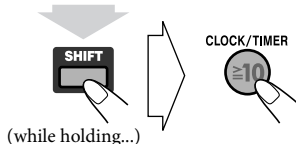

- If you have already adjusted the clock before, press the button repeatedly until the clock setting mode is selected.

2 Adjust the hour, then the minute.

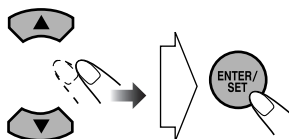

Now the built-in clock starts working.

■ To check the current clock time during playback

- The information displayed and its order vary with the source.

Ex.: While playing a disc...

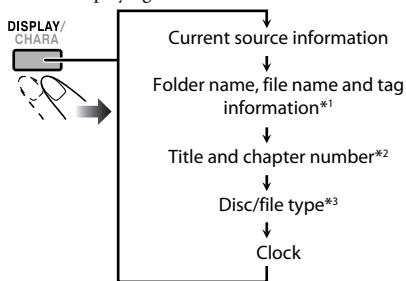

*1 Only for MP3/WMA/WAV files.

*2 Only while playing back the following discs/files:

DVD-VR: Program number/Play List number and chapter number.

MP3/WMA/WAV/JPEG/MPEG-1/MPEG-2/ASF/DivX files: Group and file number.

DVD Video: Title and chapter number.

*3 Only while disc or USB playback is stopped.

Turning Off the Power Automatically



■ Auto Standby

- This only functions while “DVD/CD” or “USB” is selected as the source.

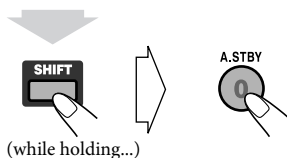

A.STBY indicator lights on the display.

When the playback stops, the A.STBY indicator starts flashing. If no operation is done for about 3 minutes while the indicator is flashing, the System turns off (standby) automatically.

- Changing the source to “TUNER FM,” “TUNER AM,” or “AUDIO IN” temporarily deactivates Auto Standby.

To cancel this function, press and hold A.STBY (while holding SHIFT) again.

■ Sleep Timer

You can set the shut-off time so that you can go to bed without turning off the System yourself.

1 Specify the time (in minutes).

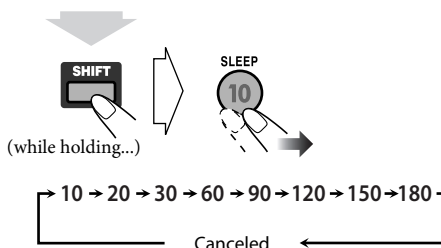

2 Wait until the set time disappears.

To check the time remaining until the shut-off time, press SLEEP (while holding SHIFT) once.

- If you press the button repeatedly, you can change the shut-off time.

Prohibiting Disc Ejection

— Child Lock



You can lock the disc tray so that no one can eject the loaded disc.

While the disc tray is closed...

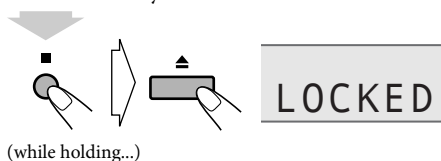

To cancel the prohibition, repeat the same procedure. “UNLOCKED” appears on the display.

Unique Video Disc/File Operations

Remote control

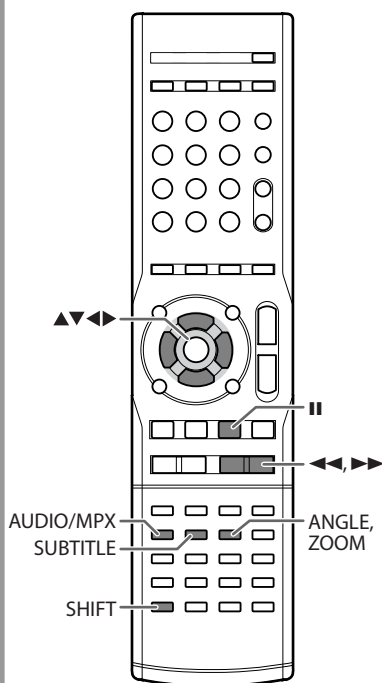

Selecting the Audio Track

INFO

Remote ONLY

For DivX files/DVD Video: While playing back a chapter/file containing several audio languages, you can select the language to listen to.

For DVD-VR/SVCD/VCD: While playing back a track, you can select the audio channel to listen to.

- For DVD Video/DVD-VR/SVCD/VCD: You can also select the audio track using the on-screen bar (see page 38).

AUDIO/MPX



While playing a DVD Video...

Ex.:

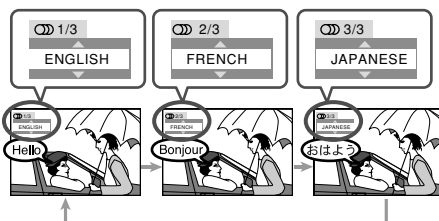

While playing a DivX file...

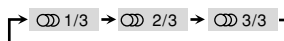

While playing a DVD-VR or SVCD/VCD...

SVCD

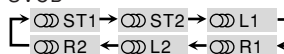

DVD-VR/VCD

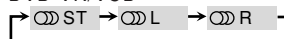

ST1/ST2/ST

To listen to normal stereo (2-channel) playback.

L1/L2/L

To listen to the left audio channel.

R1/R2/R

To listen to the right audio channel.

- SVCD can have 4 audio channels. SVCD usually uses these 4 channels to record two 2-channel recordings (ST1/ST2).

Selecting the Subtitle Language Remote ONLY

For DivX files/DVD Video: While playing back a chapter/file containing subtitles in different languages, you can select the subtitle language to display on the TV.

For DVD-VR: While playing, you can turn the subtitles on or off.

For SVCD: While playing, you can select the subtitles even if no subtitles are recorded on the disc.

- For DVD Video/DVD-VR/SVCD: You can also select the subtitle language using the on-screen bar (see page 38).

While playing a DivX file/DVD Video...

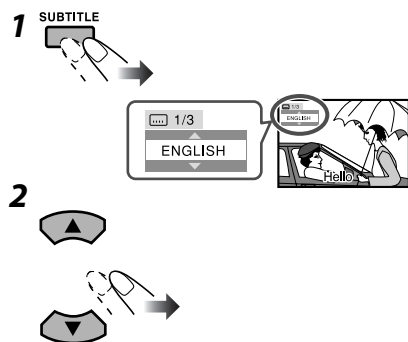

While playing a DVD-VR...

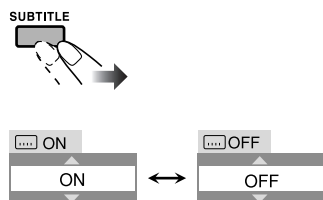

While playing an SVCD...

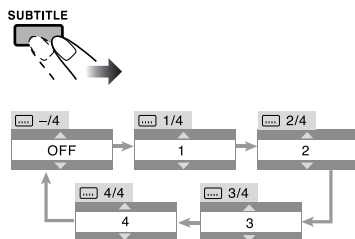

Selecting the View Angle Remote ONLY

For DVD Video only: While playing back a chapter containing multi-view angles, you can view the same scene from different angles.

- You can also select the view angle using the on-screen bar (see page 38).

While playing...

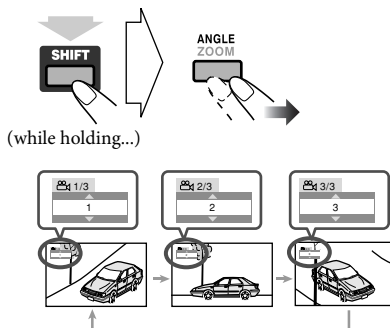

Special Effect Playback

INFO

Still picture playback

While playing...



Still picture is displayed.

To resume normal playback, press ►.

■ Frame-by-frame playback

- This function is used only while playing DVD Video/ DVD-VR/SVCD/VCD.

1 Display the still picture.



2 Advance the still picture frame by frame.



To resume normal playback, press ►.

■ Slow-motion playback



- This function is used only while playing DVD Video/ DVD-VR/SVCD/VCD.

1 Display the still picture.



2 Select slow motion speed.

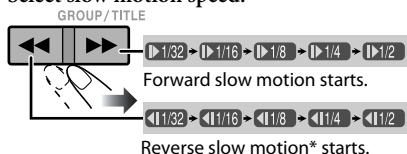

* Only available for DVD Video.

To resume normal playback, press ►.

■ To replay the previous scenes (One-Touch Replay)



- This function is only used while playing DVD Video/ DVD-VR.

While playing...



The playback position moves back about 10 seconds before the current position (only within the same title for DVD Video).

■ Zoom



1 While playing...

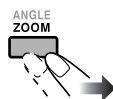

While playing a DVD Video/DVD-VR/SVCD/VCD and MPEG-1/MPEG-2/DivX file:

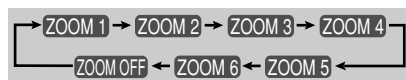

While playing a JPEG file (not available during slide-show):

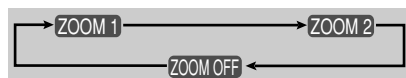

2 Move the zoomed-in position.

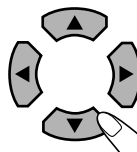

To cancel Zoom, press ZOOM repeatedly until "ZOOM OFF" appears on the TV.

Advanced Playback Operations

Remote control

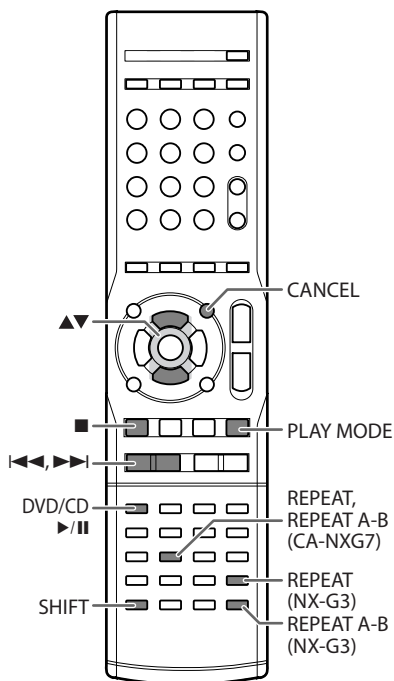

Programming the Playing Order

Program Play

INFO



You can arrange the playing order of the chapters/tracks/files (up to 99) before you start playback.

- Program Play can be used for CD, VCD, SVCD, DVD Video, and MP3/WMA/WAV files on a disc.
- Resume does not work for Program Play.

- Before starting playback, activate Program Play.



PROGRAM		
No	Group/Title	Track/Chapter
1		
2		
3		
4		
5		
6		
7		
8		
9		
10		

On the display

On the TV

- Select chapters/tracks/files you want for Program Play using the number buttons.

- To select a number, see "How to select a number" on page 10.

For DVD Video and MP3/WMA/WAV files:

- ① Select a title or group number.
- ② Select a chapter or track/file number.

- Repeat step 2 until you complete your program.

- Start playback.



Playback starts in the order you have programmed.

To skip:	To pause:	To stop:
<p>GROUP/TITLE SKIP</p>	<p>DVD/CD</p> <p>To release, press the same button again.</p>	

■ To check the programmed contents

Before or after playback...

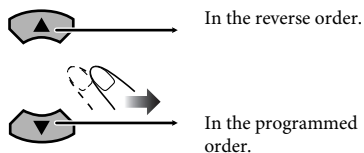

- You can also use ◀◀ or ▶▶ to check the programmed contents.

■ To modify the program

Before or after playback...

To erase the last step:	
<p>(while holding...)</p>	
To erase the entire program:	To add another step in the program:
<p>(while holding...)</p>	<p>2 sec.</p> <p>Repeat step 2 on page 25.</p>

To exit Program Play

Before or after playback...



Playing at Random

Random Play



You can play all chapters or tracks at random.

- Random Play cannot be used for the USB mass storage class device, DVD-VR and JPEG/MPEG-1/ MPEG-2/DivX files on a disc, and some DVDs.

1 Before starting playback, activate Random Play.



2 Start playback.



Playback starts in random order.
Random Play ends when the entire disc has been played.

To skip a chapter/ track:	To pause:	To stop:
<p>GROUP/TITLE SKIP</p>	<p>To release, press the same button again.</p>	

To exit Random Play

Before or after playback...

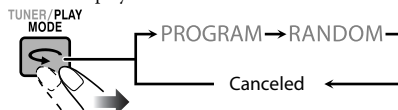

Playing Repeatedly

INFO



- For DVD Video/DVD-VR/SVCD/VCD/CD: You can also select the repeat mode using the on-screen bar (see page 39).

For DVD Video:

While playing...

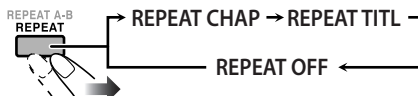

For CD/SVCD/VCD:

While playing (without PBC for SVCD/VCD) or before playback...



For DVD-VR:

While playing an Original Program...

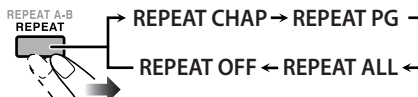

While playing a Play List...

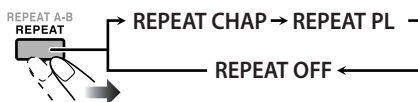

For MPEG-1/MPEG-2/ASF/DivX/MP3/WMA/WAV files:

While playing or before playback...

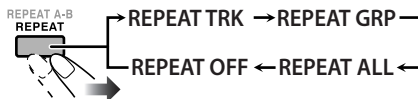

For JPEG files during slide-show:

While playing or before playback...

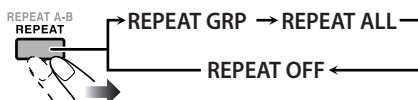

REPEAT CHAP	Repeats the current chapter.
REPEAT TITL	Repeats the current title.
REPEAT TRK	Repeats the current track/file.
REPEAT GRP	Repeats the current group.
REPEAT PG	Repeats the current program.
REPEAT PL	Repeats the current Play List.
REPEAT ALL	Repeats all the contents or programmed tracks/files.
REPEAT OFF	Canceled.

* During Program Play and Random Play, the repeat mode changes as follows for all discs.

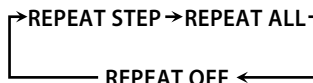

A-B Repeat

You can repeat playback of a desired portion by specifying the beginning (point A) and the ending (point B).

- A-B Repeat cannot be used for AV files and some DVDs.

1 While playing (without PBC for SVCD/VCD), select the start point (A).

CA-NXG7:

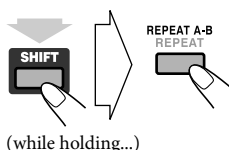

NX-G3:



2 Select the end point (B).

Press the same button again.

- You can search for the end point using the ►► button.

To cancel A-B Repeat, press REPEAT A-B again.

- A-B Repeat will also be canceled when you stop play or skip the chapter or track.

Recording and Editing Operations

Remote control

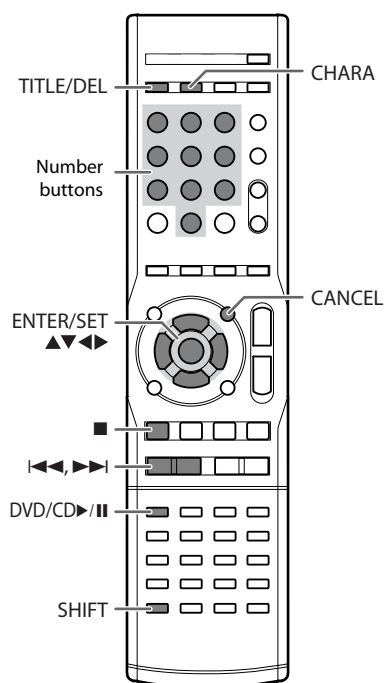

Main unit

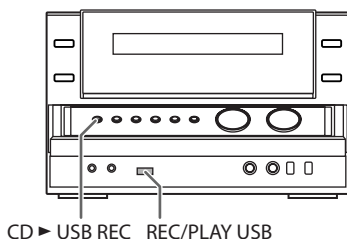

Before You Start Recording

- It may be unlawful to record or play back copyrighted material without the consent of the copyright owner.
- The recording level is not affected by the volume.
- Sound adjustments (see page 15) does not affect recordings.
- Random Play and Repeat mode are canceled in the recording mode.
- You cannot record or edit tracks while Mic Mixing (see page 33) is activated or while you are setting My Sound (see page 16).
- You can record up to 999 tracks to the USB device. If you try to record a track after recording 999 tracks, "TRACK FULL" appears on the display and the track will not be recorded.
- The tracks which are recorded to the USB device will be converted into MP3 format.
- You cannot start recording into a USB device while "READING" is shown on the display.
- Some USB devices have limit of recordable track number in the root group. Select another group or make a new group to record tracks when the number of target tracks to record is over the limit.
- Do not disconnect a USB device while playing/recording/editing. It may cause malfunction.

About SCMS (Serial Copy Management System)

The System uses the Serial Copy Management System which allows only first-generation digital copies to be made of premastered software such as regular CDs. If you try to record from a duplicated CD-R or CD-RW into the USB device, "SCMS ERROR" appears on the display.

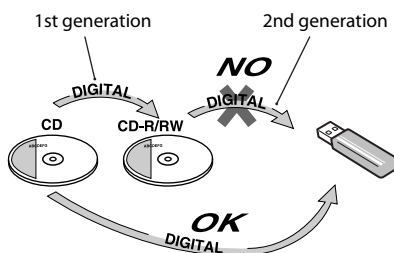

Recording from a Disc

You can record tracks in digital recording from an Audio CD onto the USB device.

- Do not vibrate the System while recording/editing tracks. Take care especially while the REC indicator is flashing or while "EDITING" is shown on the display. It may damage the recorded tracks on the USB device.

Before recording...

Connect a recordable USB device to the USB REC/PLAY (🔌➡️) terminal. (See also page 7.)

1 Start and stop playback of the disc.



2 Select the first track you want to record.



The System records from the track to the last one.

3 Enter recording mode.

CD➡️USB REC



(on the main unit)

4 Select a group to record tracks into.



- The group information is also displayed on the TV screen.

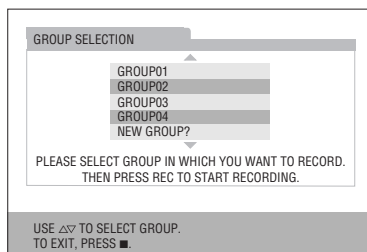

- If "NEW GROUP?" is selected, the System will automatically create the new group as "001_group." If "001_group" already exists, "002_group," "003_group," etc. will be created.

5 Start recording.

CD➡️USB REC



Both recording and playback start at the same time. When playback ends, recording also stops.

- You cannot change the source while recording.
- If Program Play is activated (see "Programming the Playing Order—Program Play" on page 25), the tracks are recorded in the programmed order.

To stop recording manually:	To record the playing track (1 track):
	<p>During play or pause...</p> <p>CD➡️USB REC</p> <p>(on the main unit)</p> <p>Then, follow the steps 4 and 5 above.</p>

Giving (Editing) Titles to Tracks or Groups

INFO 

You can give titles to the tracks (up to 24 characters) and groups (up to 28 characters) in the USB device.

- While playing, you cannot edit track/group titles.

1 Start and stop playback of the USB device.

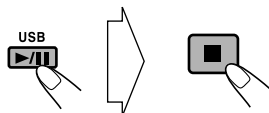

2 Select a track/group you want to edit.

To select a track:



To select a group:

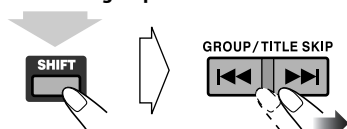

(while holding...)

3 Select the track/group title editing mode.

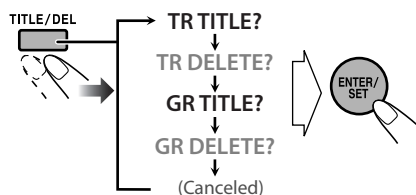

TR TITLE? For editing a track title

GR TITLE? For editing a group title

4 Enter a title.

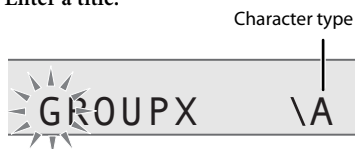

Ex.: When "GR TITLE?" is selected in step 3

- For entering a title, see "How to enter titles" on page 31.
- You can also enter a title using the TV on-screen.

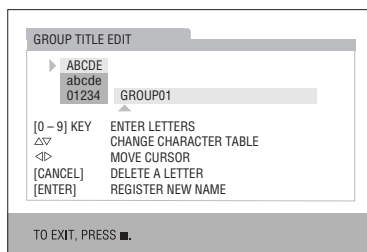

5 Finish the procedure.



EDITING

To give title to other groups/tracks, repeat steps 2 to 5.

To give title to a new group before recording

When you record tracks into "NEW GROUP?" in step 4 of "Recording from a Disc" on page 29, you can give a group title before starting to record.

1 After selecting "NEW GROUP?" in step 4 of "Recording from a Disc" on page 29...



2 Edit the group title by following step 4 in the previous column.

3 Finish the procedure.



Recording starts.

See page 54 for more information about the warning messages shown on the display.

■ How to enter titles

1 Select the character type.

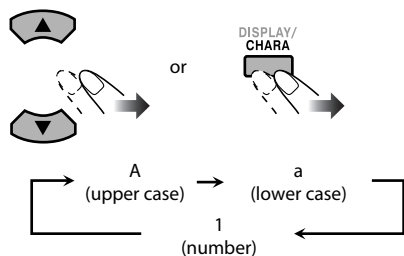

2 Enter a character.

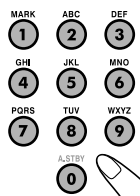

- Several characters are assigned to one button. Press the button repeatedly until the desired character is displayed.
- For available characters, refer to "Available Characters" on the next column.

3 Confirm the entry.



- "NO TITLE" appears on the display if no characters is entered in step 2. Enter a title.

Available Characters

Button	Uppercase character	Lowercase character	Numerical character
MARK 1	(Space), !, #, \$, %, &, ', (,), +, -, ., =, @, _ • Some symbols may not appear on the display.		1
ABC 2	ABC	abc	2
DEF 3	DEF	def	3
GHI 4	GHI	ghi	4
JKL 5	JKL	jkl	5
MNO 6	MNO	mno	6
PQRS 7	PQRS	pqrs	7
TUV 8	TUV	tuv	8
WXYZ 9	WXYZ	wxyz	9
A-STBY 0	—	—	0

To move the character entry position

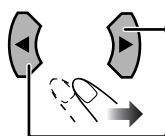

Move the entry position to the right.

Move the entry position to the left.

To erase a character

When the character entry position is on the character you want to erase...

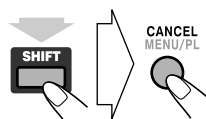

(while holding...)

To enter a space

Select the space by pressing MARK. (See “Available Characters” on page 31.)

- You can also enter a space at the end of a title by pressing ► (cursor key).

To quit title entry



- The entered titles are not stored.

Erasing the Tracks or Groups



You can erase tracks/groups on the USB device.

- Once the tracks are erased, you cannot resume them.

1 Start and stop playback of the USB device.

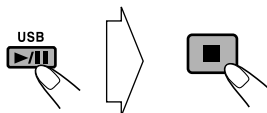

2 Select a track/group you want to erase.

To select a track:

GROUP/TITLE SKIP



To select a group:

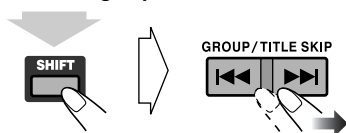

(while holding...)

3 Select the track/group erase mode.

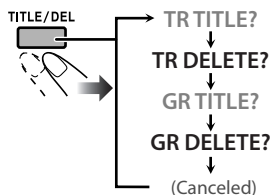

TR DELETE? For deleting a track

GR DELETE? For deleting a group

4 Confirm the selection.



DELETE OK?

- To quit erasing, press CANCEL (while holding SHIFT).

5 Erase your selection.



EDITING

- If a group contains only one file and you delete the file, the group is also deleted.

Enjoying Karaoke (only for CA-NXG7) INFO

Remote control

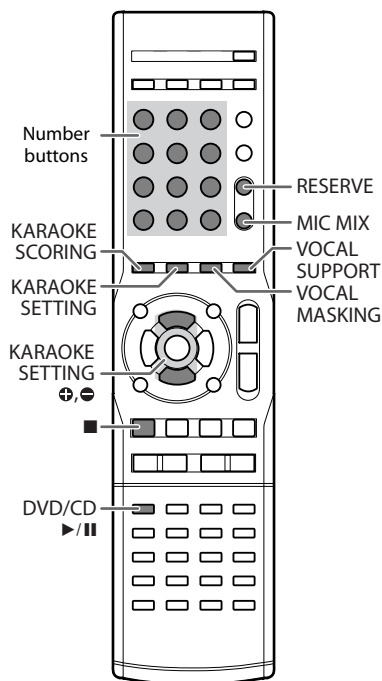

Main unit

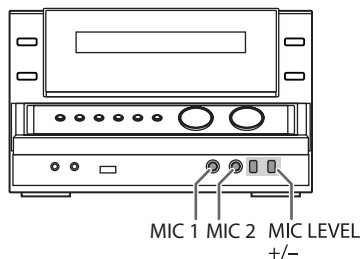

IMPORTANT

- Always set MIC LEVEL to “MIN” (0) when connecting or disconnecting the microphone.
- MIC LEVEL adjustment is valid for both microphones connected to the MIC 1 and MIC 2 jacks.
- MIC LEVEL and MIC LVL mentioned in this Instructions carry the same meaning.

Singing Along (Karaoke)

You can enjoy singing along (Karaoke) by using one or two microphones.

1 Connect the microphone(s) (not supplied) to the MIC 1 and/or MIC 2 jack.

Mic Mixing will be automatically activated.

MIC IN

2 Start playing a source.

- For Karaoke discs: Select a desired audio channel. See “Selecting the Audio Track” on page 22.

3 Sing into the microphone.

4 Adjust the microphone level and volume.

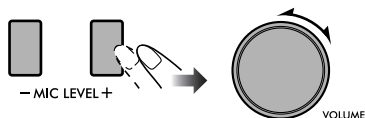

DO NOT keep the microphones connected while they are not in use.

■ To use only microphones

Select “DVD/CD” or “USB” in step 3, and stop the playback.

■ To cancel the Mic Mixing

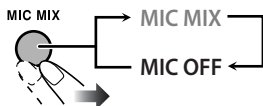

Adjusting the Sound Track for Karaoke



You can adjust the sound track for Karaoke.

- **For stereo (2-channel) source:** By selecting VOCAL MASK, you can reduce the lead vocal—Vocal Masking.
- **For Karaoke disc:** By selecting L CHANNEL or R CHANNEL, you can select the audio channel to play. While Mic Mixing is activated...

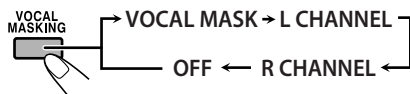

VOCAL MASK	Reduce the vocal from stereo (2-channel) source.
L CHANNEL	Reproduces only the left audio channel.
R CHANNEL	Reproduces only the right audio channel.

To return to normal playback, select “OFF.”

■ To restore the vocal temporarily

This function allows you to recover the lead vocal temporarily for your reference while singing. While Vocal Masking, L CHANNEL or R CHANNEL is activated...



The vocal or stereo effect will be restored temporarily.

To return to Vocal Masking, L CHANNEL or R CHANNEL, press the same button again.

Scoring Your Karaoke Skill

INFO



This System can score your Karaoke skill by comparing your singing along with the vocal on the playback source.

- This function is available only for disc/USB mass storage class device playback.
- It is recommended to select the sound track as follows (see page 22):

For Karaoke DVD Video: Select a sound track with vocal.

For Karaoke SVCD/CD: Select “ST,” “ST1” or “ST2.”

- After selecting a sound track, select VOCAL MASK, L CHANNEL or R CHANNEL using the VOCAL MASKING button (see the previous column).

1 Select “DVD/CD” or “USB” as the source.

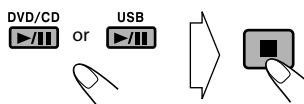

2 Connect the microphone(s) (not supplied) to the MIC 1 and/or MIC 2 jack.

Mic Mixing will be activated.

- If a microphone is already connected and Mic Mixing is not activated, use the MIC MIX button to reactivate Mic Mixing (see page 33).

3 Activate Karaoke Scoring.



KSCORE ON

K.Scoring (←)

- During Karaoke Scoring, scoring will start when playback is started.
- **To cancel Karaoke Scoring before playback,** press the same button again. “KSCORE OFF” appears on the display.

4 Start playback and sing into the microphone.

Scoring starts.

- The K.Scoring indicator flashes during scoring.
- Adjust echo level and key if you want. (See “To apply an echo to your voice” and “To adjust the key” on page 35.)
- When you press ◀◀ or ▶▶, Karaoke Scoring is canceled and restarts from the selected track/file.

Result of the scoring

After the song ends, playback stops and the score board appears on the TV screen with fanfare.

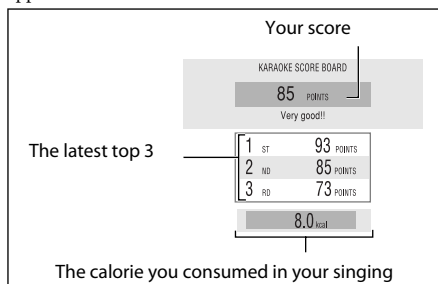

- When you press **II**, scoring is canceled. When playback starts again, scoring starts from that point.
- If you do not sing for about 2 minutes after Karaoke Scoring starts, Karaoke Scoring is canceled.
- To obtain a correct scoring result, it is recommended to sing the song completely. If the singing time is less than 3 minutes, the scoring result may be "0" or incorrect.

To stop the playback in the middle of the song, press

■. Karaoke Scoring is not canceled and your singing along is scored until that time.

To activate Karaoke Scoring in the middle of the song, press KARAOKE SCORING. "SCORING" and "START" appear on the display, then scoring starts from that point.

To deactivate Karaoke Scoring in the same song during playback, press KARAOKE SCORING.

"SCORING" and "CANCEL" appear on the display.

- Once you deactivate Karaoke Scoring in the same song during playback, pressing KARAOKE SCORING switches "KSCORE ON" and "KSCORE OFF" alternately.
- When you reactivate Karaoke Scoring in the same song during playback and "KSCORE ON" is selected, scoring starts from the next track.

Changing the Karaoke Setting



You can change five settings for Karaoke.

- To escape from Karaoke setting, wait for several seconds after the setting is done.

■ To apply an echo to your voice

1

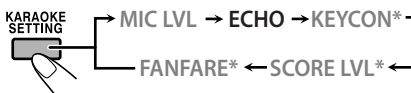

* Appears only when "DVD/CD" or "USB" is selected as the source with Mic Mixing activated.

2 Adjust the echo level.

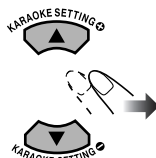

- You can adjust the echo level from ECHO OFF (no effect) to ECHO 6.

■ To adjust the key

- This function is available only for CD/VCD/SVCD/ DVD Video and Audio files.
- Key adjustment will be canceled when you deactivate Mic Mixing, or select another disc, track or file.

1

Select "DVD/CD" or "USB" as the source.

2 Connect the microphone(s) (not supplied) to the MIC 1 and/or MIC 2 jack.

Mic Mixing will be automatically activated.

- If a microphone is already connected and Mic Mixing is not activated, use the MIC MIX button to reactivate Mic Mixing (see page 33).

3 Start playback.



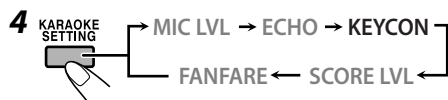

5 Adjust the key.

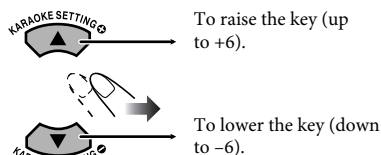

To return to normal key, select "0."

■ To change the calculation level

You can change the scoring level of Karaoke Scoring.

- This function is available only for disc/USB mass storage class device playback.

1 Select "DVD/CD" or "USB" as the source.

2 Connect the microphone(s) (not supplied) to the MIC 1 and/or MIC 2 jack.

Mic Mixing will be automatically activated.

- If a microphone is already connected and Mic Mixing is not activated, use the MIC MIX button to reactivate Mic Mixing (see page 33).

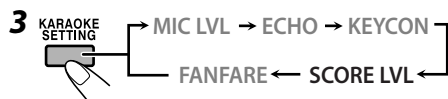

4 Select the scoring level setting.

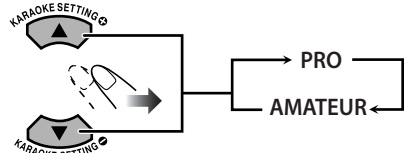

PRO Calculation level is strict.

AMATEUR Calculation level is lenient.

■ To turn on/off the fanfare

You can turn the fanfare on or off for Karaoke Scoring.

- This function is available only for disc/USB mass storage class device playback.

1



2 Select the fanfare setting.

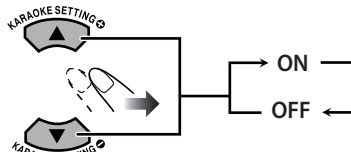

■ To change the mic volume

- You can also change the mic volume by pressing MIC LEVEL +/- on the main unit. (See page 33.)

1

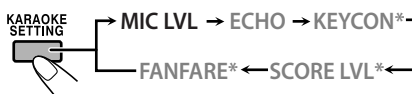

* Appears only when "DVD/CD" or "USB" is selected as the source with Mic Mixing activated.

2 Select the volume level.

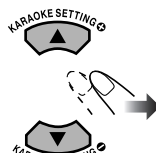

- The mic volume level can be adjusted in 16 steps (MIN (0) – MAX (15)).

Reserving Karaoke Songs—Karaoke Program Play



You can determine the playback order of the titles, chapters, tracks or files on the disc player. You can program up to 12 steps.

- This function is not available for files in a USB mass storage class device.

1 Select “DVD/CD” as the source.

2 Connect the microphone(s) (not supplied) to the MIC1 or MIC2 jack.

Mic Mixing will be automatically activated.

- If a microphone is already connected and Mic Mixing is not activated, use the MIC MIX button to reactivate Mic Mixing (see page 33).

3 Activate Karaoke Program Play.

RESERVE



No	Gr/Tt	Tr/Chap
1		
2		
3		
4		
5		

- The PRGM indicator flashes during this mode.

4 Select songs you want for Karaoke Program Play.

Press the number buttons to select a song in the following order.

① Select a title/group.

② Select a chapter/track/file.

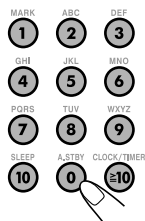

- To select a number, see “How to select a number” on page 10.
- To cancel the procedure, press RESERVE. The PRGM indicator disappears.

5 Start playback.



Karaoke Reserve screen disappears and playback starts in the order you have programmed.

- For the Karaoke Program Play with Karaoke Scoring:** Each time the song ends, playback stops and the score board appears. Press ► to start playback of the next track.

6 Sing into the microphone.

7 Adjust the microphone level and volume.

■ To check the programmed contents

RESERVE



Karaoke Reserve screen appears.

- You cannot display Karaoke Reserve screen while Karaoke Scoring is in use.

■ To modify the program

While Karaoke Reserve screen is shown on the TV...

To erase the unwanted step:

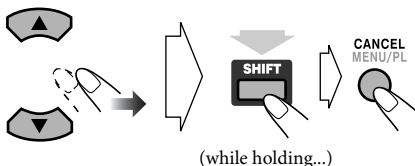

(while holding...)

To erase the entire program, repeat the procedure.

To add steps in the program:

Repeat step 4.

On-Screen Operations

Remote control

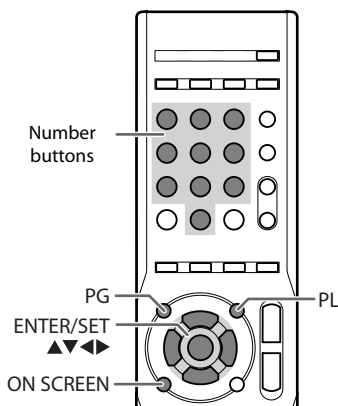

On-screen Bar Operations INFO Remote ONLY

You can check the source information (disc/USB mass storage class device) and playback status by using the on-screen bar (not applicable for MP3/WMA/WAV/JPEG files). You can also use some functions when playing back DVD Video/DVD-VR/SVCD/VCD/CD.

On-screen Bar Information

DVD Video

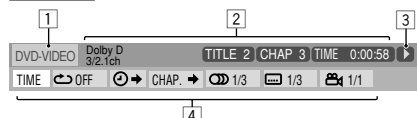

DVD-VR

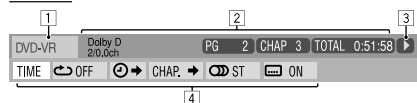

SVCD

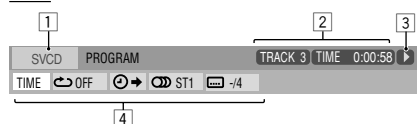

VCD

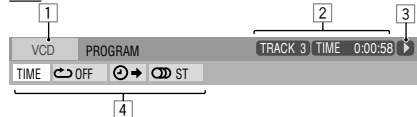

CD

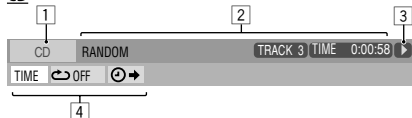

MPEG-1/MPEG-2/ASF/DivX files on a disc



MPEG-1/MPEG-2/ASF/DivX files in a USB mass storage class device



1 Disc/source

2 Playback information

Dolby D	Audio format
3/2.1 ch, 2/0.0 ch	Channel number
PROGRAM, RANDOM	Current play mode
TITLE 2	Current title
CHAP 3	Current chapter
TRACK 14	Current track
PG 2	Current program
PL 2	Current Play List
TIME 0:00:58	Time indication

3 Operation modes

	Playback
	Forward/Reverse search
	Forward/Reverse slow-motion
	Pause
	Stop

4 Function icons (on the pull-down menu)

TIME	Select to change the time indications.
	Select to repeat playback.
	Select for time search.
CHAP. →	Select for chapter search.
	Select to change the audio language or channel (see also page 22).
	Select to change subtitle language (see also page 23).
	Select to change the view angle (see also page 23).

■ To operate using the On-screen Bar

Ex.: Selecting a subtitle (French) for DVD Video

While "DVD/CD" is selected as the source...

1 Display the entire on-screen bar.

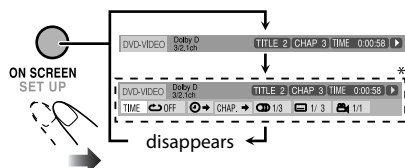

* This does not appear for MPEG-1/MPEG-2/DivX files.

2 Select (highlight) the item you want.

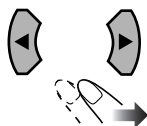

3 Display the pop-up window.

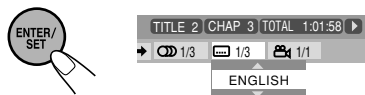

4 Select the desired option in the pop-up window.

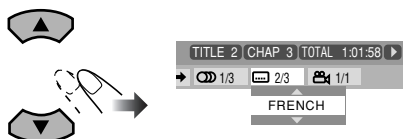

5 Finish the setting.

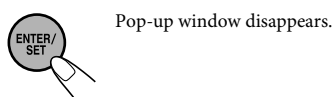

To remove the on-screen bar



■ To change the time information

You can change the time information on the on-screen bar and the display on the main unit.

1 While playing, display the entire on-screen bar.



2 Make sure [TIME] is selected (highlighted).

3 Change the time indication.



TIME Elapsed playing time of the current chapter/track (not applicable for DVD-VR).

REM Remaining time of the current chapter/track (not applicable for DVD-VR).

TOTAL Elapsed disc time.

T. REM Remaining time of title (DVD Video)/program (DVD-VR)/disc (SVCD/VCD).

■ Repeat Play

- See also page 27.

1 While playing (without PBC for SVCD/VCD), display the entire on-screen bar.

- Repeat mode can also be selected before starting playback (not applicable for DVD Video/DVD-VR).

2 Select [OFF].

3 Display the pop-up window.



4 Select the repeat mode you want.

A-B	Repeats a desired portion (see the next column).
TITLE*	Repeats the current title.
ALL	Repeats the disc (not applicable for DVD) or programmed track.
CHAPTER**	Repeats the current chapter.
TRACK**	Repeats the current track.
OFF	Cancels Repeat Play.

* While playing a DVD-VR, "PG" appears, and while playing a Play List, "PL" appears.

** During Program Play and Random Play, "STEP" appears.

5 Finish the setting.



■ A-B Repeat

You can repeat playback of a desired portion by specifying the beginning (point A) and the ending (point B).

- A-B Repeat cannot be used for MP3/WMA/WAV/JPEG/MPEG-1/MPEG-2/ASF/DivX files and some DVDs.

1 While playing, display the entire on-screen bar.

2 Select OFF.

3 Display the pop-up window.



4 Select "A-B."

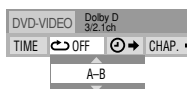

5 Select the start point (A).



6 Select the end point (B).



A-B Repeat starts. The selected portion plays repeatedly.

- You can search for the end point using the button.

To cancel A-B Repeat, repeat steps 1 to 3, and select "OFF" in step 4.

- A-B Repeat will also be canceled when you stop play or skip the chapter or track.

■ Time Search

You can move to a particular point by specifying the elapsed playing time from the beginning.

- This function is not available during Program Play and Random Play.

1 While playing (without PBC for SVCD/VCD), display the entire on-screen bar.

- Time Search can also be used before starting playback (not applicable for DVD Video/DVD-VR).

2 Select .

3 Display the pop-up window.



4 Enter the time.

You can specify the time in hours/minutes/seconds.



Examples:

To move to a point of 1 (hours): 02 (minutes): 00 (seconds), press 1, 0, 2, 0, then 0.

To move to a point of 54 (minutes): 00 (seconds), press 0, 5, 4, 0, then 0.

- It is always required to enter the hour digit (even "0" hours), but it is not required to enter the final zeros (the last two digits in the examples above).
- To correct a mis-entry, press to erase the last entry.

Continued on the next page.

5 Confirm your entry.



The System starts playing the disc from the selected playing time.

Chapter Search

For DVD Video/DVD-VR: You can search for the chapter number to play.

- This function is not available during Program Play and Random Play.

1 While playing, display the entire on-screen bar.

2 Select **CHAP. →**.

3 Display the pop-up window.



4 Enter the desired chapter number.

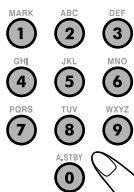

Examples:

To select chapter 5, press 5.

To select chapter 10, press 1, then 0.

To select chapter 15, press 1, then 5.

To select chapter 30, press 3, then 0.

- To correct a mis-entry, press the number buttons until the desired number is shown in the pop-up window.

5 Confirm your entry.



The System starts playing the selected chapter.

Control Screen Operations



You can search for and play the desired items through the control screen for DVD-VR and MP3/WMA/WAV/JPEG/MPEG-1/MPEG-2/ASF/DivX files.

Control screen for DVD-VR

The control screen is superimposed onto the TV screen when you call up Original Program (PG) or Play List (PL).

To select playback type

To display the Original Programs:	To display the Play Lists:
To remove the list, press the same button again.	

Ex.: When Original Program is selected.

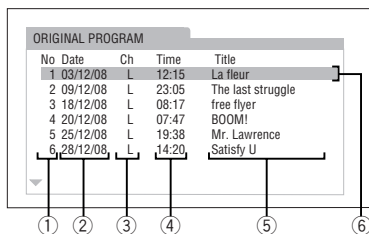

Ex.: When Play List is selected.

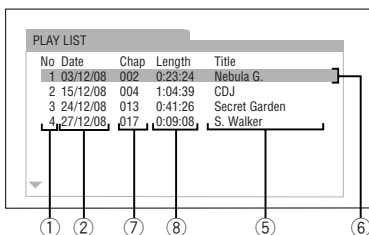

- Listed number
- Recording/creating date
- Recording channels
- Recording time
- Title
- Highlight bar (current selection)
- Chapters included
- Playback time

To select an item in the list and start playback

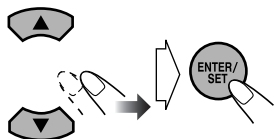

- If you move the highlight bar while playing back, the selected item starts playback automatically.

■ Control screen for MP3/WMA/WAV/JPEG/MPEG-1/MPEG-2/ASF/DivX files

The control screen appears on the TV when the System detects MP3/WMA/WAV/JPEG/MPEG-1/MPEG-2/ASF/DivX files on the loaded disc or connected USB mass storage class device.

- For JPEG/MPEG-1/MPEG-2/ASF/DivX, it appears when playback is stopped.

Ex.: While playing an MP3 file on a disc.

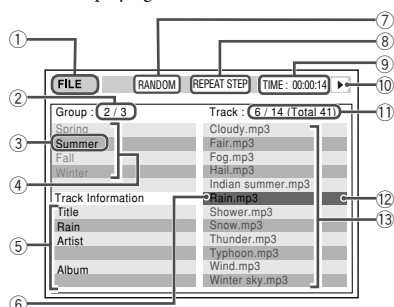

- 1 Current source
FILE: Current source is "DVD/CD."
USB: Current source is "USB."
- 2 Current group number/total group number
- 3 Current group
- 4 Group list
- 5 File information (only for MP3/WMA/WAV files)
- 6 Current file
- 7 Random Play/Program Play setting (not applicable for the files in the USB mass storage class device)
- 8 Repeat Play setting
- 9 Elapsed playing time of the current file (not applicable for JPEG files)
- 10 Operation status icon
- 11 Current file number/total number of files in the current group (total number of files on the loaded disc/USB mass storage class device)
- 12 Highlight bar (current selection)
- 13 File list

- If different types of playable files (audio/still picture/moving picture) are recorded on a disc or USB mass storage class device, select a file type to play (see page 12).

To move the highlight bar between group list and file list

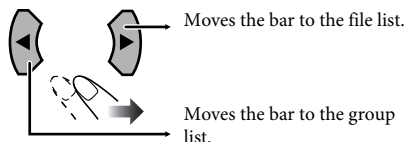

To select an item in the list

- Move the highlight bar to the desired item.
- If you move the highlight bar while playing back an MP3/WMA/WAV file, the selected track starts playback automatically.

To start playback

For JPEG:	
	The selected file (still picture) is displayed until you change it.
	Slide-show playback starts. Each file (still picture) is shown on the screen for about 3 seconds, then changes one after another. • To cancel slide-show and display the current still picture, press II .
For the other files:	
	Playback starts with the selected track. • Pressing DVD/CD ▶/II or USB ▶/II also starts playback.

- Once you start to play back a picture, the control screen disappears.
- To show the control screen, press TOP MENU or MENU.

Daily Timer Operations

Remote control

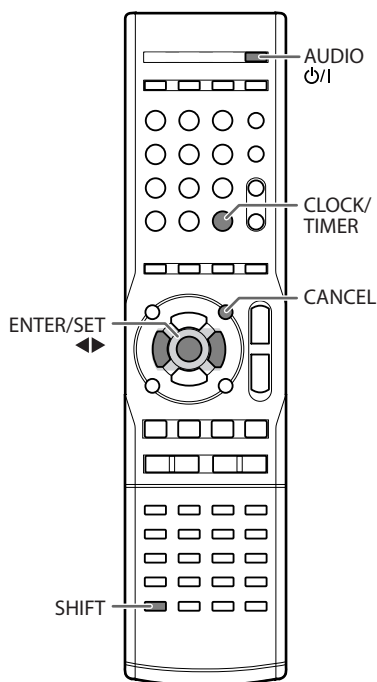

How Daily Timer works

Once the Daily Timer has been set, the timer indicator (⌚) is lit on the display. Daily Timer is activated at the same time everyday until the timer is turned off manually (see "To turn on or off the Daily Timer" on page 44).

When the on-time comes

The System turns on, tunes in to the specified station or starts playing from the specified source, and gradually increases the volume level to the preset level after about 30 seconds.

- While Daily Timer is working, the timer indicator (⌚) flashes on the display.

When the off-time comes

The System stops playback, and turns off (on standby) automatically.

- The timer setting remains in memory until you change it.

1 Select the timer setting mode.

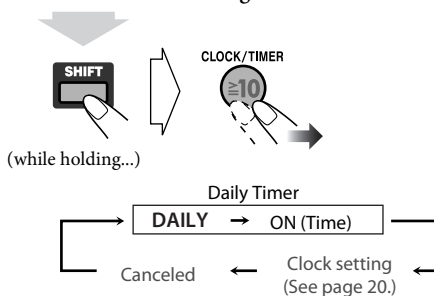

Setting the Daily Timer

INFO Remote ONLY

Using Daily Timer, you can wake up with your favorite music.

- Finish the timer setting at least 2 minutes before the on-time.
- To exit the timer settings, press CLOCK/TIMER (while holding SHIFT) as required.
- To correct a mis-entry during process, press CANCEL (while holding SHIFT). You can go back to the previous step.



- When the clock has not been set, pressing CLOCK/TIMER makes the System enter the clock setting mode (see page 20).

2 Set the timer as you like.

Repeat the procedure for the following settings until finished.

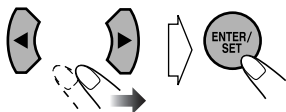

- ① Set the hour then the minute for on-time.
- ② Set the hour then the minute for off-time.
- ③ Select the playback source—"DISC," "USB," "TUNER AM," "TUNER FM," or "AUDIO IN."
- ④ For "TUNER AM" or "TUNER FM": Select a preset channel.

For "DISC": Select the title/group number, then the chapter/track/file number*.

For "USB": Select the group number, then the track/file number*.

- ⑤ Select the volume level.

- You can adjust the volume level ("0" to "MAX" and "VOLUME -"). If you select "VOLUME -," the volume is set to the same level as when the System was last turned off.

Once settings are completed, the timer setting information appears in sequence.

3 Turn off the System (on standby), if you have set the timer with the System turned on.



* You cannot select the 151st and over.

■ To turn on or off the Daily Timer

Since Daily Timer is activated at the same time everyday, you may need to cancel it on some particular days.

To cancel the Daily Timer

1 Select "DAILY."

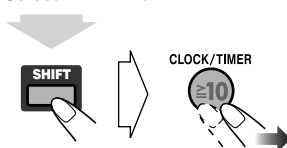

(while holding...)



2 Turn off the Timer.

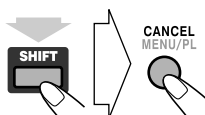

(while holding...)

To turn on the Daily Timer

1 Select "DAILY."

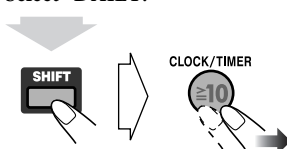

(while holding...)

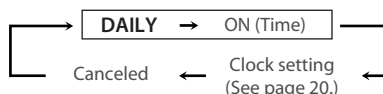

2 Activate the Timer.



3 Wait until the indication disappears.

Setup Menu Operations INFO

Remote control

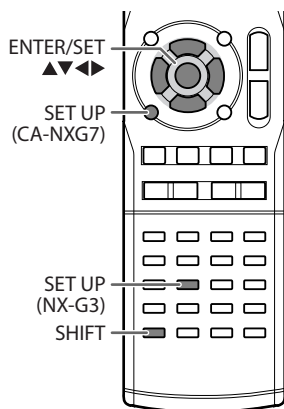

Initial Settings



You can change the settings of the System.

- The Setup Menu can be used only when “DVD/CD” or “USB” is selected as the source.

1 Press SET UP while playback is stopped.

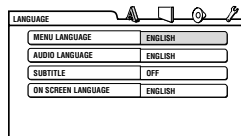

2 Press ► (or ◀) to select the menu.

3 Press ▼ (or ▲) to move to select the item.



4 Press ENTER/SET.

5 Press ▼ (or ▲) to select the options, then press ENTER/SET.

To remove a preference display

Press SET UP.

Menu	Item	Contents
LANGUAGE 	MENU LANGUAGE	You can select the initial menu language for DivX files/DVD Video. (See page 54.)
	AUDIO LANGUAGE	You can select the initial audio language for DivX files/DVD Video. (See page 54.)
	SUBTITLE	You can select the initial subtitle language for DivX files/DVD Video. (See page 54.)
	ON SCREEN LANGUAGE	You can select “ ENGLISH ,” “ CHINESE ” or “ SPANISH ” as the on-screen language.
PICTURE 	MONITOR TYPE <div> </div>	<p>You can select the monitor type to match your TV when you play back picture recorded for wide-screen televisions.</p> <p>16:9 NORMAL/16:9 MULTI NORMAL (Wide-screen television): Select this when the aspect ratio of your wide-screen TV is fixed to 16:9.</p> <p>16:9 AUTO/16:9 MULTI AUTO (Wide-screen television): Select this when your TV is an ordinary wide-screen TV.</p> <p>4:3 LB/4:3 MULTI LB (Letter Box conversion): For a conventional (4:3) TV. Displays a wide-screen picture to fit the width of the TV screen keeping the aspect ratio.</p> <p>4:3 PS/4:3 MULTI PS (Pan Scan conversion): For a conventional (4:3) TV. The picture is zoomed in to fill the screen vertically and the left and right sides of the picture are cut off.</p> <ul style="list-style-type: none"> By selecting “MULTI” mode, the color system of the System changes automatically to match the color system of the picture. For the color system setting, see page 6.

Menu	Item	Contents
 PICTURE	PICTURE SOURCE	<p>You can obtain optimal picture quality by selecting the source type of the video source.</p> <p>AUTO: Normally, select this option. The System recognizes the picture type (film or video source) of the current picture according to its information.</p> <p>FILM: For a film source picture.</p> <p>VIDEO: For a video source picture.</p>
	SCREEN SAVER	<p>You can set the screen saver function (ON or OFF). If no operation is done for about 5 minutes, the TV screen dims.</p>
	FILE TYPE	<p>You can select the file type to play.</p> <p>AUDIO: To play MP3/WMA/WAV files.</p> <p>STILL PICTURE: To play JPEG files.</p> <p>VIDEO: To play MPEG-1/MPEG-2/DivX files.</p>
 AUDIO	DIGITAL AUDIO OUTPUT	<p>Set this item correctly when using the OPTICAL DIGITAL OUTPUT terminal on the rear.</p> <p>PCM ONLY: When connecting to audio equipment which is compatible with only linear PCM signals.</p> <p>DOLBY DIGITAL/PCM: When connecting to a Dolby Digital decoder or an amplifier with a built-in Dolby Digital decoder.</p> <p>STREAM/PCM: When connecting to a DTS decoder or an amplifier with a built-in DTS decoder.</p>
	DOWN MIX	<p>This setting is effective for digital audio output if “DIGITAL AUDIO OUTPUT” is set to “PCM ONLY.”</p> <p>DOLBY SURROUND: Select this when connecting to a surround decoder.</p> <p>STEREO: Select this when connecting to a stereo receiver, MD player, etc.</p>
	D. RANGE COMPRESSION	<p>You can enjoy powerful audio even at a low volume level while playing Dolby Digital software.</p> <p>AUTO: Select to apply the effect to multi-channel encoded software.</p> <p>ON: Select to always use this function.</p>
 OTHERS	RESUME	<p>You can select Resume.</p> <p>ON: The System resumes playback from the position where playback has been stopped.</p> <p>OFF: Resume is deactivated.</p>
	ON SCREEN GUIDE	<p>Activate (ON) or deactivate (OFF) the on-screen guide (see page 12).</p>
	DivX REGISTRATION	<p>The System has its own Registration Code.</p> <p>If necessary, you can confirm it.</p> <p>Once you have played back a DivX file in which the Registration Code is recorded, the System's Registration Code is overwritten for copyright protection.</p>

Additional Information

Learning More about This System

■ Connections (see pages 4 to 7)

- Make sure the antenna conductors do not touch any other terminals, connecting cords or the power cord. Also, keep the antennas away from metallic parts of the System, connecting cords, and the power cord. These could cause poor reception.
- Use only speakers with the same speaker impedance as indicated by the speaker terminals on the rear of the System.
- The speakers are magnetically shielded to avoid color distortions on TVs. However, if not installed properly, it may cause color distortions. So, pay attention to the following when installing the speakers.
 - When placing the speakers near a TV set, turn off the TV's main power switch or unplug it before installing the speakers.
Then wait at least 30 minutes before turning on the TV's main power switch again.
 - Some TVs may still be affected even though you have followed the above instructions. If this happens, move the speakers away from the TV.

Changing the Color System and Scanning Mode:

- You cannot change the scanning mode to progressive in the following cases:
 - When your TV does not support the progressive video input.
 - When you have not connected your TV to the system using a component video cord.

■ Daily Operations—Playback (see pages 9 to 14)

- Instead of pressing Φ/I , the System is turned on by pressing one of the source buttons, the DOOR OPEN/CLOSE button or \blacktriangle on the main unit.

Listening to the Radio:

- If you store a new station into an occupied preset number, the previously stored station in that number will be erased.
- When you unplug the power cord or if a power failure occurs, the preset stations will be erased in a few days. If this happens, preset the stations again.

Playing Back a Disc/USB Mass Storage Class Device:

JVC bears no responsibility for any loss of data in the USB mass storage class device while using this System.

- When you change the source to “DVD/CD” or “USB,” it may take a while to activate the source.
- While the System is reading a disc, the source may not change to “USB” properly. In this case, press \blacksquare , then change the source to “USB.”
- On some discs, the actual operations may be different from what is explained in this manual due to the programming and disc structure; such differences are not a malfunction of this System.
- The System recognizes up to 999 tracks (files) per group, and 99 groups per disc/USB mass storage class device. The total number of tracks (files) that the System can detect is 4 000.
 - If there are any unplayable files in a folder, those files are also counted in the total file number.
 - Playable files which do not belong to any groups are handled as GROUP1.
- For playback of files in the USB mass storage class device...
 - When connecting a USB mass storage class device, refer also to its manual.
 - Connect one USB mass storage class device to the System at a time. Do not use a USB hub.
 - You cannot charge any USB mass storage class device through the USB REC/PLAY ($\bullet \leftrightarrow$) terminal.
 - While playing back a file in a USB mass storage class device, do not disconnect the device. It may cause malfunction on both the System and the device.
 - This System is compatible with USB 2.0 Full Speed.
 - You cannot play back a file larger than 2 Gigabytes.
 - When playing a file of a large transfer rate, frames or sounds may be dropped during playback.
 - This System cannot recognize a USB mass storage class device whose rating is other than 5 V and exceeds 500 mA.
 - This System may not play back some USB mass storage class devices and does not support DRM (Digital Rights Management).
 - It will take some time to start up a digital audio player whose contents are larger than 1 Gigabyte.

- For DVD-VR playback...
 - This System can play only a disc of UDF-Bridge format.
 - For details about DVD-VR format and Play List, refer to the manual of the recording equipment.
- For MP3/WMA/WAV playback...
 - MP3/WMA/WAV discs require a longer readout time than regular CDs. (It depends on the complexity of the group/file configuration.)
 - Some MP3/WMA/WAV files cannot be played back and will be skipped. This results from their recording processes and conditions.
 - This System can play only a disc of ISO 9660 Level 1 or Level 2.
 - This System can play back MP3/WMA/WAV files with the extension code `<.mp3>`, `<.wma>`, or `<.wav>` (regardless of the letter case—upper/lower).
 - It is recommended that you make each MP3/WMA/WAV files as following conditions:
 - For MP3/WMA files: At a sample rate of 44.1 kHz and at a data transfer rate of 128 kbps. This System cannot play back files made at a bit rate of less than 64 kbps.
 - For WAV files: At a sample rate of 44.1 kHz and at a quantization rate of 16 bit Linear PCM.
- For JPEG files playback...
 - It is recommended that you record a file at 640 x 480 resolution. (If a file has been recorded at a resolution of more than 640 x 480, it will take a long time to be shown.)
 - This System can play back JPEG files with the extension code `<.jpg>` or `<.jpeg>` (regardless of the letter case—upper/lower).
 - This System may not play back JPEG files properly if they are recorded from a device other than a digital camera.
- For MPEG-1/MPEG-2 playback...
 - This System can play back MPEG-1/MPEG-2 files with the extension code `<.mpg>`, `<.mpeg>`, or `<.mod>*`.

** `<.mod>` is an extension code used for the MPEG-2 files recorded by JVC Everio camcorders. The MPEG-2 files with the `<.mod>` extension code cannot be played back if HD format is used or its maximum bit rate is more than 2 Mbps.*
 - The stream format should conform to MPEG system/program stream.
 - 720 x 576 pixels (25 fps) / 720 x 480 pixels (30 fps) is recommended for the highest resolution.
 - This System also supports the resolutions of 352 x 576 / 480 x 576 / 352 x 288 pixels (25 fps) and 352 x 480 / 480 x 480 / 352 x 240 pixels (30 fps).
 - The file format should be MP@ML (Main Profile at Main Level)/SP@ML (Simple profile at Main Level)/MP@LL (Main Profile at Low Level).
 - Audio streams should conform to MPEG1 Audio Layer-2 or MPEG2 Audio Layer-2.
- For ASF playback...
 - This System can play back ASF files with the extension code `<.asf>` (regardless of the letter case—upper/lower).
 - This System supports ASF files whose resolution is 352 x 288 pixels or less.
 - Some recorded files may not be able to played back depending on file characteristics, kind of digital still/video cameras, or recording conditions.
- For DivX playback...
 - This System can play only a disc of UDF-Bridge format. “Multi-border” is not supported.
 - The System supports all versions of DivX® video (including DivX® 6).
 - The System supports DivX files whose resolution is 720 x 480 pixels or less (30 fps), and 720 x 576 pixels or less (25 fps).
 - Audio stream should conform to Dolby Digital, MPEG1 Audio Layer-2 or MPEG Audio Layer-3 (MP3).
 - This System can play back DivX files with the extension code `<.divx>` `<.div>` `<.avi>` (regardless of the letter case—upper/lower).
 - The System does not support GMC (Global Motion Compression).
 - The file encoded in the interlaced scanning mode may not be played back correctly.

■ Sound & Other Adjustments (see pages 15 to 21)

Adjusting the Sound:

- This function also affects the sound through the headphones.

Creating a Soothing Tone for Your Ear —MY SOUND:

- MY SOUND setup is prohibited for certain file format.
- MY SOUND setup is prohibited during recording/editing or while Mic Mixing is activated.

Setting the ECO (Ecology) Mode:

- You cannot activate the ECO mode while the Daily Timer is turned on.
- If you turn on the Daily Timer while the ECO mode is activated, the ECO mode is canceled.

Setting the Clock:

- “0:00” will flash on the display until you set the clock.
- The clock may gain or lose 1 to 2 minutes per month. If this happens, reset the clock.

■ Unique Video Disc/File Operations (see pages 22 to 24)

Selecting the Audio Track:

- On some discs/files, you cannot change audio language during playback.

Special Effect Playback:

- During slow-motion playback, no sound will be emitted.
- While zoomed in, the picture may look coarse.

■ Advanced Playback Operations (see pages 25 to 27)

Programming the Playing Order—Program Play:

- While programming steps...
 - Your entry will be ignored if you have tried to program an item number that does not exist (for example, selecting track 14 on a disc that only has 12 tracks).
 - For MP3/WMA/WAV files, you can program up to 99 files.
 - You cannot select the 151st or later tracks.

Playing Repeatedly:

- A-B Repeat is available only within the same title/program/track.

■ Recording and Editing Operations (see pages 28 to 32)

Giving (Editing) Titles to Tracks or Groups:

- When a track is recorded, a title is automatically given to the track. When you want to give a new title to the track, delete the old title, then enter your desired title.

■ Enjoying Karaoke (see pages 33 to 37)

General:

- You cannot enjoy all the Karaoke functions with DVD-VR, video files and picture files.
- While the System is turned on, connecting a microphone automatically activates Mic Mixing and all the Karaoke related functions.
- While the System is turned off, connecting a microphone does not activate Mic Mixing and any other Karaoke related function. In this case, press MIC MIX after turning the System on.
- You cannot activate Mic Mixing during recording/editing or My Sound setup.

Adjusting the Sound Track for Karaoke:

- The Vocal Masking setting is not applied to the optical digital output signals through the OPTICAL DIGITAL OUTPUT terminal.
- On some music, Vocal Masking does not provide the correct effect.

Scoring Your Karaoke Skill:

- You can also activate Karaoke Scoring while playing back. In this case, the scoring starts from that point. But cancel Karaoke Scoring and set Karaoke Scoring again in the same track during the playback, scoring starts from next track.
- While Karaoke Scoring is in use, you cannot deactivate Mic Mixing or use MIC MIX, RESERVE and number buttons.
- Activating Karaoke Scoring cancels Repeat Play.
- You cannot use Karaoke Scoring during Program Play, Random Play, or recording. However, you can turn Karaoke Scoring on and off by using KARAOKE SCORING button during these play modes.
- The ranking (top 3) is cleared when you turn off the System.

Reserving Karaoke Songs—Karaoke Program Play:

- You can use RESERVE button when a microphone is plugged in. However, you can cancel Karaoke Program Play using the button even if a microphone is not plugged in. In case you reactivate Karaoke Program Play, plug in a microphone.
- When the track starts playback, that track number will be erased from the Karaoke Reserve screen (the programmed contents will remain until you erase it).
- For some VCD, the Karaoke Scoring result may not appear at the end of the track if PBC is activated. In this case, press ■ to view your scoring result.

■ On-Screen Operations (see pages 38 to 42)

On-screen Bar Operations:

- A-B Repeat is available only within the same title/program/track.

■ Daily Timer Operations (see pages 43 and 44)

Setting the Daily Timer:

- If you do not specify the preset station or track number correctly while setting a timer, the currently selected station or the first track will be played when the timer is activated.
- When you unplug the power cord or if a power failure occurs, the timer will be canceled. You need to set the clock first, then the timer again.
- If you set DVD Video as the source, Daily Timer will not work correctly.
- If you set the Sleep Timer after Daily Timer starts playing the selected source, Daily Timer is canceled.

■ Setup Menu Operations (see pages 45 and 46)

General:

- If the upper and lower parts of the menu are cut off, adjust the picture size control of the TV.

LANGUAGE menu:

- When the language you have selected for “MENU LANGUAGE,” “AUDIO LANGUAGE,” or “SUBTITLE” is not recorded, the original language is used as the initial language.

PICTURE menu—MONITOR TYPE:

- Even if “4:3 PS” is selected, the screen size may become 4:3 letter box while playing a disc/file. This depends on how the discs are recorded.
- When you select “16:9” for a picture whose aspect ratio is 4:3, the picture changes slightly due to the process of converting the picture width.

OTHERS menu—ON SCREEN GUIDE:

- The setup menu and on-screen bar will be displayed (and recorded) even if this function is set to “OFF.” Subtitles and the information for zoom-in always appear on the display regardless of this setting.

Operating JVC's TVs Using the Remote Control

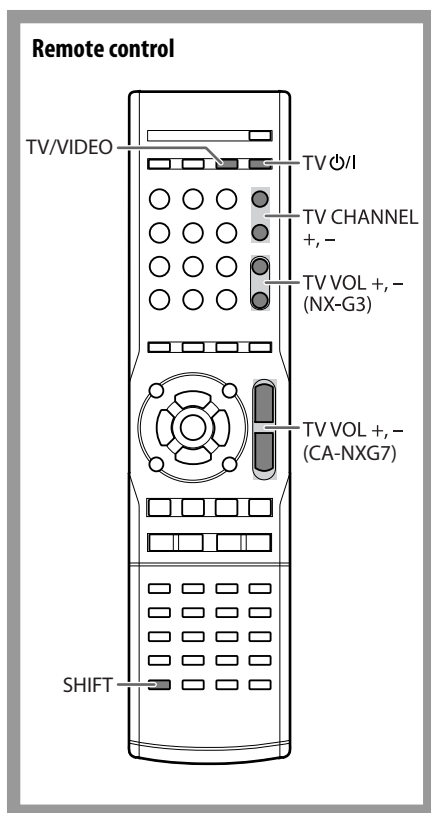

You can use the remote control to operate JVC's TVs.

TV ϕ/I	Turn on/off TV.
TV/VIDEO	Change the input mode.
TV CHANNEL +, -	Change the channel.
TV VOL +, - (NX-G3)	Adjust the TV volume.

While holding SHIFT, press...

TV VOL +, - (CA-NXG7)	Adjust the TV volume.
------------------------------	-----------------------

Maintenance

To get the best performance of the System, keep your discs and mechanism clean.

■ Handling Discs

- Remove the disc from its case by holding it at the edge while pressing the center hole lightly.
- Do not touch the shiny surface of the disc, or bend the disc.
- Put the disc back in its case after use to prevent warping.
- Be careful not to scratch the surface of the disc when placing it back in its case.
- Avoid exposure to direct sunlight, extreme temperature, and moisture.

To clean the disc:

Wipe the disc with a soft cloth in a straight line from center to edge.

■ Cleaning the System

- Stains should be wiped off with a soft cloth. If the System is heavily stained, wipe it with a cloth soaked in water-diluted neutral detergent and wrung well, then wipe clean with a dry cloth.
- Since the System may deteriorate in quality, become damaged or get its paint peeled off, be careful about the following:
 - DO NOT wipe it with a hard cloth.
 - DO NOT wipe it forcefully.
 - DO NOT wipe it with thinner or benzene.
 - DO NOT apply any volatile substance such as insecticides to it.
 - DO NOT allow any rubber or plastic to remain in contact for a long time.

Optical Digital Out Signals

DIGITAL AUDIO OUTPUT Playback disc/file		Output Signals		
		STREAM/PCM	DOLBY DIGITAL/ PCM	PCM ONLY
DVD Video	with 48 kHz, 16/20/24 bit Linear PCM	48 kHz, 16 bit Linear PCM*		
	with 96 kHz, Linear PCM	48 kHz, 16 bit Linear PCM		
	with Dolby Digital	Dolby Digital bitstream		48 kHz, 16 bit Linear PCM
	with DTS	DTS bitstream	48 kHz, 16 bit Linear PCM	
DVD-R/-RW in DVD-VR format	with 48 kHz, 16/20/24 bit Linear PCM	48 kHz, 16 bit Linear PCM*		
	with Dolby Digital	Dolby Digital bitstream		48 kHz, 16 bit Linear PCM
SVCD/VCD/CD		44.1 kHz, 16 bit Linear PCM/48 kHz, 16 bit Linear PCM		
CD with DTS		DTS bitstream	44.1 kHz, 16 bit Linear PCM	
MP3/WMA/WAV/MPEG-1/MPEG-2/ ASF		32/44.1/48 kHz, 16 bit Linear PCM		
DivX	with MP2, MP3	32/44.1/48 kHz, 16 bit Linear PCM		
	with Dolby Digital	Dolby Digital bitstream		32/44.1/48 kHz, 16 bit Linear PCM

* While playing some DVDs, digital signals may be emitted at 20 bits or 24 bits (at their original bit rate) through the OPTICAL DIGITAL OUTPUT terminal if the discs are not copy-protected.

Troubleshooting

■ General

Adjustments or settings are suddenly canceled before you finish.

- ⇒ There is a time limit. Repeat procedure again.

Operations are disabled.

- ⇒ The built-in microprocessor may malfunction due to external electrical interference. Unplug the power cord and then plug it back in.

Unable to operate the System from the remote control.

- ⇒ The path between the remote control and the remote sensor on the System is blocked.
- ⇒ The batteries are exhausted.

No sound is heard.

- ⇒ Speaker connections are incorrect or loose.
- ⇒ Headphones are connected.

No picture appears on the TV screen.

- ⇒ The video cord connections are incorrect or loose.

No picture is displayed on the TV screen, the picture is blurred, or the picture is divided into two parts.

- ⇒ The System is connected to a TV which does not support progressive video input.
- ⇒ Incorrect scanning mode is selected (see page 7).
- ⇒ When you unplug the power cord and plug it back again, the scanning mode may change back to the initial setting (see page 7).

The left and right edges of the picture are missing on the screen.

- ⇒ Select "4:3 LB/4:3 MULTI LB" for "MONITOR TYPE" (see page 45).

■ Radio Operations

Hard to hear broadcasts because of noise.

- ⇒ Antenna connections are incorrect or loose.
- ⇒ The AM loop antenna is too close to the System.
- ⇒ The FM antenna is not properly extended and positioned.

■ Disc/USB mass storage class device Playback Operations

The disc does not play.

- ⇒ You have inserted a disc whose Region Code is not correct. ("REGION ERR" appears on the display.)
- ⇒ The disc is placed upside down. Place the disc with the label side facing up.

ID3 Tag on an MP3 file cannot be shown.

- ⇒ There are two types of ID3 Tag—Version 1 and Version 2. This System can only show ID3 Tag Version 1.

Groups and tracks are not played back as you expect.

- ⇒ The playing order is determined when the groups and tracks were recorded. It depends on the writing application.

MP3, WMA, WAV, JPEG, MPEG-1, MPEG-2, ASF or DivX files are not played back.

- ⇒ The disc or the USB mass storage class device may contain different types of files (ex. MP3/WMA/WAV/JPEG). In this case, you can only play back the files selected by pressing FILE TYPE (see page 12).
- ⇒ You have changed the "FILE TYPE" setting after the System read the disc or the USB mass storage class device. In this case, reload the disc or disconnect the USB mass storage class device and connect it again.

The disc sound is discontinuous.

- ⇒ The disc is scratched or dirty.

No subtitle appears on the display though you have selected the initial subtitle language.

- ⇒ Some DVDs/DivX files are programmed not to display any subtitle initially. If this happens, press SUBTITLE after starting playback (see page 23).

Audio language is different from the one you have selected as the initial audio language.

- ⇒ Some DVDs/DivX files are programmed to always use the original language initially. If this happens, press AUDIO/MPX after starting playback (see page 22).

The disc tray does not open or close.

- ⇒ The power cord is not plugged in.
⇒ Child Lock is in use. "LOCKED" appears on the display (see page 21).

■ Recording and Editing Operations

Unable to record into the USB device.

- ⇒ The capacity of the USB device is full. Erase some tracks.
⇒ There have been 999 tracks or group on the USB device you want to record into. Erase unwanted tracks.
⇒ The USB device is write-protected.
⇒ The connected USB device is incompatible to this System.

Unable to assign title to tracks on the USB device.

- ⇒ When a track is damaged, you cannot edit that track. In this case, turn off the System and turn on again.
⇒ The USB device is write-protected.

■ Timer Operations

Daily Timer does not work.

- ⇒ The System has been turned on when the on-time came. Timer starts working only when the System is turned off.

Daily Timer does not start playback.

- ⇒ The loaded disc is a DVD Video. Change the disc.

- Manufactured under license from Dolby Laboratories. "Dolby" and the double-D symbol are trademarks of Dolby Laboratories.
- "DTS" is a registered trademark of DTS, Inc. and "DTS2.0+Digital Out" is a trademark of DTS, Inc.
- "Official DivX® Ultra Certified product" "Plays all versions of DivX® video (including DivX® 6) with enhanced playback of DivX® media files and the DivX® Media Format" "DivX, DivX Ultra Certified, and associated logos are trademarks of DivX, Inc. and are used under licence."
- Microsoft and Windows Media are either registered trademarks or trademarks of Microsoft Corporation in the United States and/or other countries.
- This product incorporates copyright protection technology that is protected by U.S. patents and other intellectual property rights. Use of this copyright protection technology must be authorized by Macrovision, and is intended for home and other limited viewing uses only unless otherwise authorized by Macrovision. Reverse engineering or disassembly is prohibited.
- "CONSUMERS SHOULD NOTE THAT NOT ALL HIGH DEFINITION TELEVISION SETS ARE FULLY COMPATIBLE WITH THIS PRODUCT AND MAY CAUSE ARTIFACTS TO BE DISPLAYED IN THE PICTURE. IN CASE OF 525 OR 625 PROGRESSIVE SCAN PICTURE PROBLEMS, IT IS RECOMMENDED THAT THE USER SWITCH THE CONNECTION TO THE 'STANDARD DEFINITION' OUTPUT. IF THERE ARE QUESTIONS REGARDING OUR TV SET COMPATIBILITY WITH THIS MODEL 525p AND 625p DVD PLAYER, PLEASE CONTACT OUR CUSTOMER SERVICE CENTER."
- USE OF THIS PRODUCT IN ANY MANNER THAT COMPLIES WITH THE MPEG-4 VISUAL STANDARD IS PROHIBITED, EXCEPT FOR USE BY A CONSUMER ENGAGING IN PERSONAL AND NON-COMMERCIAL ACTIVITIES.

Display Messages for Recording or Editing Operations

NO DEVICE

- No USB device is connected or the connected USB device is not compatible with this System.

PROHIBIT

- The USB device is prohibited from editing file/group.
- The same title has been recorded.

DATA FULL

- The capacity of memory for USB device is full.

TRACK FULL

- The USB device exceeds the maximum number of files it can store.

PROTECTED

- The USB device is write-protected.

SCMS ERROR

- You have tried to copy from a duplicated disc to the USB device.

SAME TITLE

- The name you entered is already used by another file/group.

NO TITLE

- No name is entered (blank) when editing the file/group name.

DEVICE ERR

- The unit has failed to read the USB device.

CANT REC

- The music cannot be recorded.

Language Code List

AA	Afar	GD	Scots Gaelic	MI	Maori	SN	Shona
AB	Abkhazian	GL	Galician	MK	Macedonian	SO	Somali
AF	Afrikaans	GN	Guarani	ML	Malayalam	SQ	Albanian
AM	Ameharic	GU	Gujarati	MN	Mongolian	SR	Serbian
AR	Arabic	HA	Hausa	MO	Moldavian	SS	Siswati
AS	Assamese	HI	Hindi	MR	Marathi	ST	Sesotho
AY	Aymara	HR	Croatian	MS	Malay (MAY)	SU	Sundanese
AZ	Azerbaijani	HY	Armenian	MT	Maltese	SV	Swedish
BA	Bashkir	IA	Interlingua	MY	Burmese	SW	Swahili
BE	Byelorussian	IE	Interlingue	NA	Nauru	TA	Tamil
BG	Bulgarian	IK	Inupiak	NE	Nepali	TE	Telugu
BH	Bihari	IN	Indonesian	NL	Dutch	TG	Tajik
BI	Bislama	IS	Icelandic	NO	Norwegian	TH	Thai
BN	Bengali, Bangla	IW	Hebrew	OC	Occitan	TI	Tigrinya
BO	Tibetan	JI	Yiddish	OM	(Afan) Oromo	TK	Turkmen
BR	Breton	JW	Javanese	OR	Oriya	TL	Tagalog
CA	Catalan	KA	Georgian	PA	Panjabi	TN	Setswana
CO	Corsican	KK	Kazakh	PS	Pashto, Pushto	TO	Tonga
CY	Welsh	KL	Greenlandic	PT	Portuguese	TR	Turkish
DA	Danish	KM	Cambodian	QU	Quechua	TS	Tsonga
DZ	Bhutani	KN	Kannada	RM	Rhaeto-Romance	TT	Tatar
EL	Greek	KO	Korean (KOR)	RN	Kirundi	TW	Twi
EO	Esperanto	KS	Kashmiri	RO	Rumanian	UK	Ukrainian
ET	Estonian	KU	Kurdish	RW	Kinyarwanda	UR	Urdu
EU	Basque	KY	Kirghiz	SA	Sanskrit	UZ	Uzbek
FA	Persian	LA	Latin	SD	Sindhi	VI	Vietnamese
FI	Finnish	LN	Lingala	SG	Sangho	VO	Volapuk
FJ	Fiji	LO	Laothian	SH	Serbo-Croatian	WO	Wolof
FO	Faroese	LT	Lithuanian	SI	Singhalese	XH	Xhosa
FY	Frisian	LV	Latvian, Lettish	SL	Slovenian	YO	Yoruba
GA	Irish	MG	Malagasy	SM	Samoan	ZU	Zulu

Specifications

■ Amplifier section—CA-NXG7/CA-NXG3 (NX-G3)

Output Power:

CA-NXG7: 240 W (120 W + 120 W) at 8 Ω
(10% THD)

CA-NXG3: 40 W (20 W + 20 W) at 4 Ω
(10% THD)

Audio Input: AUDIO IN:

Stereo min. (Ø 3.5 mm)

500 mV/47 kΩ (at "AUDIO LVL3")

250 mV/47 kΩ (at "AUDIO LVL2")

125 mV/47 kΩ (at "AUDIO LVL1")

Digital output: OPTICAL DIGITAL OUTPUT:

-21 dBm to -15 dBm (660 nm

±30 nm)

Digital input: USB REC/PLAY

VIDEO OUT:

Color system: NTSC/PAL (interlaced/
progressive)

VIDEO (Composite): 1 V(p-p)/75 Ω

COMPONENT: (Y) 1 V(p-p)/75 Ω

(P_B/P_R) 0.7 V(p-p)/75 Ω

Speaker impedance:

CA-NXG7: 8 Ω - 16 Ω

CA-NXG3: 4 Ω - 16 Ω

■ Tuner section

FM tuning range: 87.50 MHz - 108.00 MHz

AM (MW) tuning range:

531 kHz - 1 710 kHz (at 9 kHz)

530 kHz - 1 710 kHz (at 10 kHz)

For Saudi Arabia: 531 kHz - 1 602 kHz (at 9 kHz)

530 kHz - 1 600 kHz (at 10 kHz)

■ Disc player section

Region codes: Middle East: 2
South East Asia: 3
Central and South America,
Australia: 4

Playable disc:

- DVD Video/CD/VCD/SVCD
- CD-R/CD-RW (CD/SVCD/VCD/MP3/WMA/
WAV/JPEG/MPEG-1/MPEG-2/ASF/DivX
format)
- DVD-R/-RW (DVD-VR/DVD Video/MP3/
WMA/WAV/JPEG/MPEG-1/MPEG-2/ASF/
DivX format)
- +R (DVD Video/MP3/WMA/WAV/JPEG/
MPEG-1/MPEG-2/ASF/DivX format)
- +RW (MP3/WMA/WAV/JPEG/MPEG-1/MPEG-
2/ASF/DivX format)
- DVD-ROM (MP3/WMA/WAV format)

Dynamic range: 80 dB

Horizontal resolution: 500 lines

Wow and flutter: Immeasurable

■ USB section

Playable files: MP3/WMA/WAV/JPEG/MPEG-1/
MPEG-2/ASF/DivX format

USB specification: Compatible with USB 2.0 Full Speed

Compatible device: Mass storage class

Compatible system: FAT16, FAT32

Bus power supply: DC 5 V \pm 500 mA

■ General—CA-NXG7

Power requirements:

AC 220 V / AC 230 V - AC 240 V,

~ (adjustable with the voltage

selector), 50 Hz / 60 Hz

For Saudi Arabia: AC 220 V ~, 50 Hz / 60 Hz

For Australia: AC 240 V ~, 50 Hz

Power consumption:

70 W (at operation)

13 W (at standby)

1.3 W or less (at ECO mode)

Dimensions (approx.):

250 mm × 158 mm × 259 mm

(W/H/D)

Mass (approx.): 5.0 kg

■ General—CA-NXG3 (NX-G3)

Power requirements:

AC 110 V - AC 240 V ~, 50 Hz /
60 Hz

For Australia: AC 240 V ~, 50 Hz

Power consumption:

35 W (at operation)

3.5 W (at standby)

1.0 W or less (at ECO mode)

Dimensions (approx.):

250 mm × 158 mm × 259 mm

(W/H/D)

Mass (approx.): 3.0 kg

■ Speakers—SP-NXG5 (NX-G3)

Type: 2-way 2-speaker bass reflex type
(Magnetically shielded)

Speaker units: Tweeter: 4 cm cone x 1

Woofer: 12 cm cone x 1

Impedance: 4 Ω

Power handling capacity: 20 W

Frequency Range: 50 Hz - 28 000 Hz

Dimensions (approx.):

155 mm × 250 mm × 168 mm

(W/H/D)

Mass (approx.): 2.1 kg each

■ Supplied Accessories

See page 4.

*Design and specifications are subject to change
without notice.*

Parts Index

Remote control

▲▼▶◀		DVD LEVEL	19	SHIFT	
ENTER/SET		ECO	19	Press and hold together with another button when you want to use the function printed in green.	
■		FADE MUTING	10		
▶		FILE TYPE	12		
II		FM	10	SLEEP	21
◀◀, ▶▶		GROUP/ TITLE	13	SOUND MODE	17
◀◀, ▶▶		GROUP/ TITLE SKIP	13	SUBTITLE	23
↺	10, 24	HP SURR	17	SUPER BASS LEVEL	15
Number buttons	10	KARAOKE SCORING	34	TITLE/DEL	30
3D PHONIC	17	KARAOKE SETTING	35	TOP MENU	13
AM	10	MENU	13	TUNER MODE	11
ANGLE	23	MIC MIX	33	TV ◀/▶	50
A.STBY	21	MY SOUND	16	TV CHANNEL +, -	50
AUDIO ◀/▶	9	ON SCREEN	39	TV/VIDEO	50
AUDIO IN	14	PG	41	TV VOL	50
AUDIO IN LEVEL	14	PL	41	USB ▶/II	12
AUDIO/MPX	22	PLAY MODE	25	V.BASS	15
AUDIO VOL	9	REPEAT	27	VFP	19
CANCEL		REPEAT A-B	27	VOCAL MASKING	34
CHARA	31	RESERVE	37	VOCAL SUPPORT	34
CLOCK/ TIMER	20, 43	RETURN	14	ZOOM	24
C.VOICE	17	SCAN MODE	7		
DIMMER	19	SET UP	45		
DISPLAY	21				
DVD/CD	12				
▶/II					

CA-NXG7

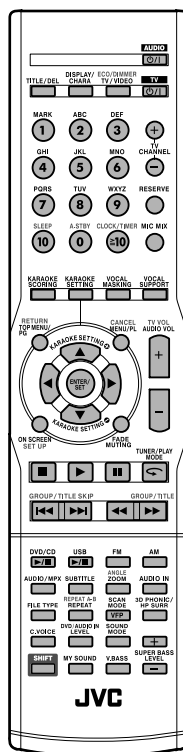

NX-G3

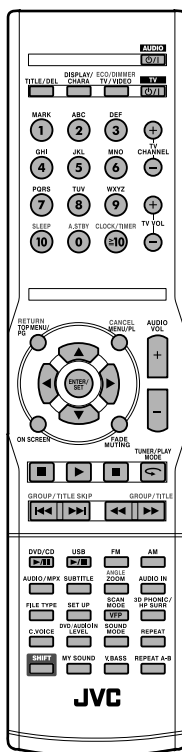

Main unit

◀/▶	9	ECO	19
▲	12	MIC1	33
II		MIC2	33
■		MIC LEVEL+, -	33
▶		PHONES	7
◀◀, ▶▶		REC/PLAY	7
AUDIO IN	7	USB	
CD ▶ USB REC	29	SOURCE	9
DEMO	3	VOLUME	9
DOOR OPEN/CLOSE	9		

CA-NXG7

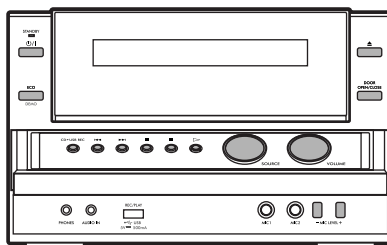

For CA-NXG7:

Mains (AC) Line Instruction (not applicable for Europe, U.S.A., Canada, and U.K.)

CAUTION for mains (AC) line

(Excluding Saudi Arabian model and Australian model)

BEFORE PLUGGING IN, do check that your mains (AC) line voltage corresponds with the position of the voltage selector switch provided on the outside of this equipment and, if different, reset the voltage selector switch, to prevent from a damage or risk of fire/electric shock.

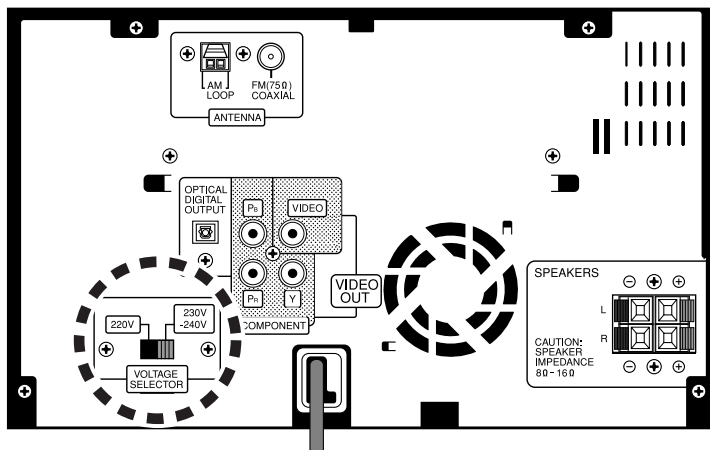

JVC