

may not be treated as household waste. Instead it shall  
and electronic equipment. By ensuring this product is  
the environment and human health, which could oth-  
led information about recycling of this product, please  
here you purchased the product.

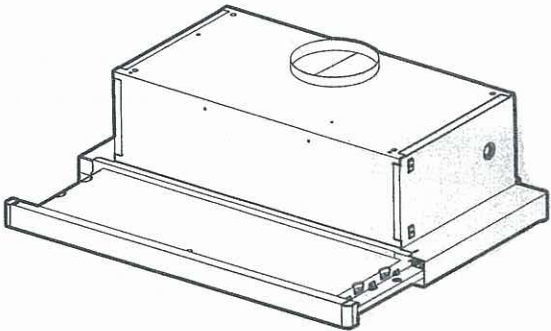

Instructions Manual

.....	3
.....	4
.....	5
.....	7
.....	8

# RECOMMENDATIONS AND SUGGESTIONS

## INSTALLATION

- The manufacturer will not be held liable for any damages resulting from incorrect or improper installation.
- The minimum safety distance between the cooker top and the extractor hood is 650 mm.
- Check that the mains voltage corresponds to that indicated on the rating plate fixed to the inside of the hood.

- For Class I appliances, check that the domestic power supply guarantees adequate earthing.

Connect the extractor to the exhaust flue through a pipe of minimum diameter 120 mm. The route of the flue must be as short as possible.

- Do not connect the extractor hood to exhaust ducts carrying combustion fumes (boilers, fireplaces, etc.).
- If the extractor is used in conjunction with non-electrical appliances (e.g. gas burning appliances), a sufficient degree of aeration must be guaranteed in the room in order to prevent the backflow of exhaust gas. The kitchen must have an opening communicating directly with the open air in order to guarantee the entry of clean air.

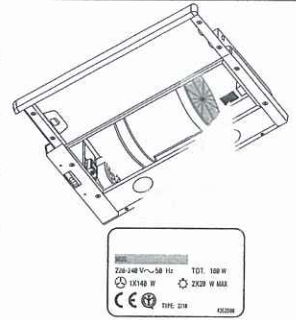

## USE

- The extractor hood has been designed exclusively for domestic use to eliminate kitchen smells.
- Never use the hood for purposes other than for which it has been designed.
- Never leave high naked flames under the hood when it is in operation.
- Adjust the flame intensity to direct it onto the bottom of the pan only, making sure that it does not engulf the sides.
- Deep fat fryers must be continuously monitored during use: overheated oil can burst into flames.
- The hood should not be used by children or persons not instructed in its correct use.

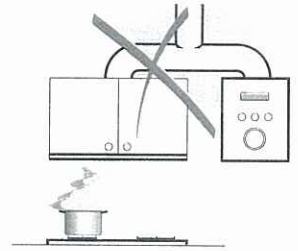

## MAINTENANCE

- Switch off or unplug the appliance from the mains supply before carrying out any maintenance work.
- Clean and/or replace the Filters after the specified time period.
- Clean the hood using a damp cloth and a neutral liquid detergent.

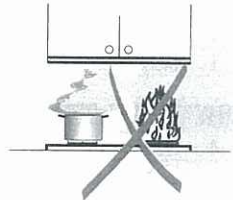

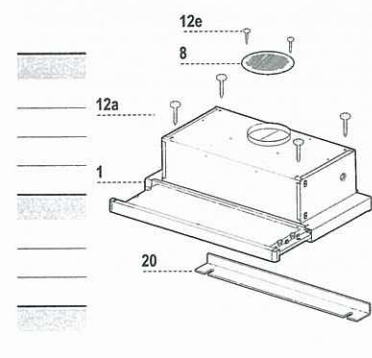
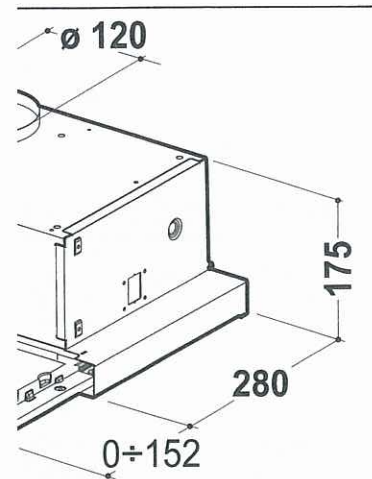

# INSTALLATION

## Drilling the Support surface and Fitting the Hood

### SCREW FITTING

- The hood support surface must be 135 mm above the bottom surface of the wall units.
- Drill the support with a  $\varnothing 4,5$  mm drill bit, using the drilling template provided.
- Cut a hole  $\varnothing 125$  mm in size on the support surface, using the drilling template provided.
- Fix using the 4 screws **12a** (4,2 x 44,4) provided.

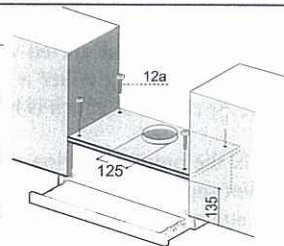

### SNAP-ON FITTING

- The hood can be installed either directly on the bottom surface of the wall units (min. 650 mm above the hob) using snap-on side supports.
- Cut a fitted opening in the bottom surface of the wall unit, as shown.
- Insert the hood until the side supports snap into place.
- Lock in position by tightening the screws **Vf** from underneath the hood.

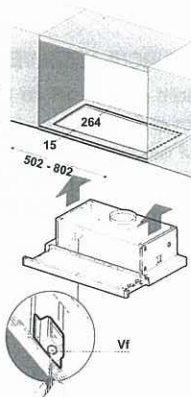

### CLOSING ELEMENT

- The space between the edge of the hood and the rear wall can be closed by applying the element **20** provided, using the screws supplied for this purpose.

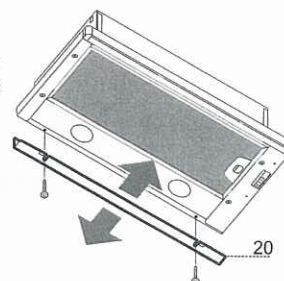

## USE

### Control panel

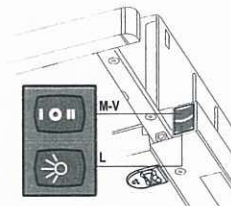
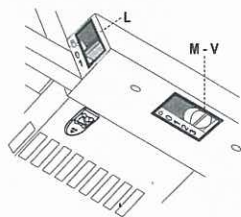

<b>L</b>	<b>Light</b>	Switches the lighting system on and off.	<b>L</b>	<b>Light</b>	Switches the lighting system on and off.
<b>M</b>	<b>Motor</b>	Switches the extractor motor on and off.	<b>M</b>	<b>Motor</b>	Switches the extractor motor on and off.
<b>V</b>	<b>Speed</b>	Sets the operating speed of the extractor:	<b>V</b>	<b>Speed</b>	Sets the operating speed of the extractor:
		1. Low speed, used for a continuous and silent air change in the presence of light cooking vapour.			1. Low speed, used for a continuous and silent air change in the presence of light cooking vapour.
		2. Medium speed, suitable for most operating conditions given the optimum treated air flow/noise level ratio.			2. Medium speed, suitable for most operating conditions given the optimum treated air flow/noise level ratio.
		3. Maximum speed, used for eliminating the highest cooking vapour emission, including long periods.			

12e  
8  
125

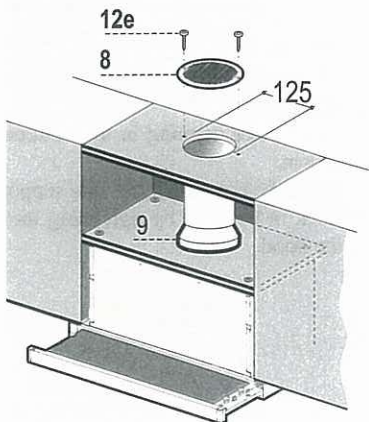

ON  
ch having a contact gap of at least 3  
after installing the hood, pull it out