

FUTEK MODEL LLW600
STK# FSH01853

DONUT/ THRU HOLE COMPRESSION ONLY LOAD CELL W/ REMOVABLE LOAD BUTTON
(Previously Q07474)

Drawing Number: FI1130

INCH [mm] R.O.= Rated Output

WIRING CODE (CC1)

+Excitation	-Excitation	+Signal	-Signal
RED PIN 'A'	BLACK PIN 'B'	GREEN PIN 'C'	WHITE PIN 'D'
+Sense	-Sense		
SHIELD PIN 'E'	SHIELD PIN 'F'		

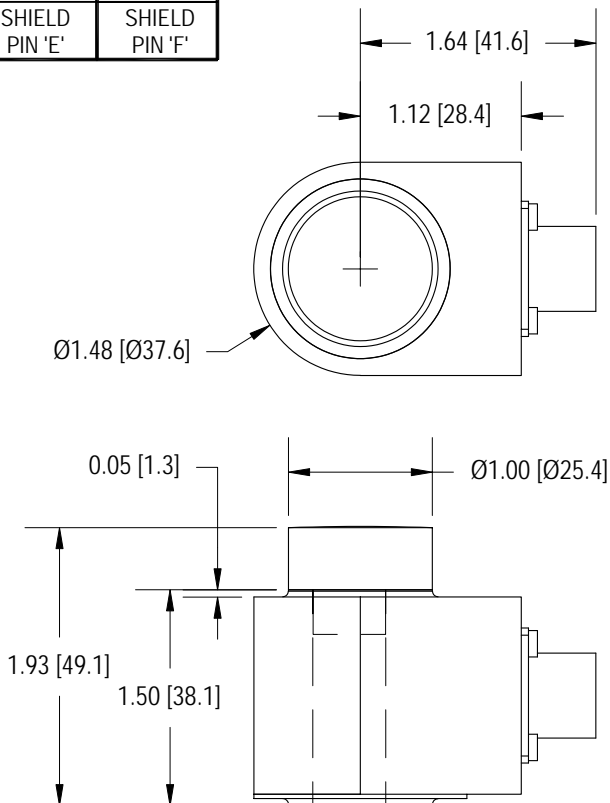
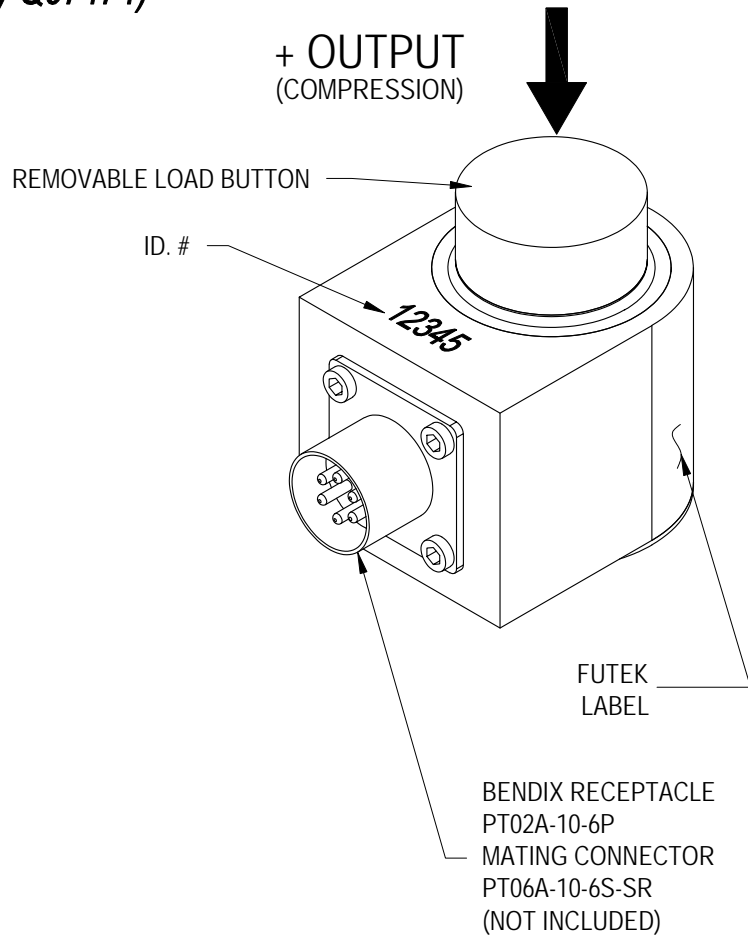

SPECIFICATIONS:

RATED OUTPUT	2 mV/V nom.
CAPACITY	30 klb [133 kN]
SAFE OVERLOAD	150% of R.O.
ZERO BALANCE	±1% of R.O.
EXCITATION (VDC OR VAC)	18 MAX
BRIDGE RESISTANCE	350 Ω nom.
NONLINEARITY	±0.5% of R.O.
HYSTERESIS	±0.5% of R.O.
NONREPEATABILITY	±0.1% of R.O.
TEMP. SHIFT ZERO	±0.005% of R.O./°F [0.01% of R.O./°C]
TEMP. SHIFT SPAN	±0.005% of LOAD/°F [0.01% of LOAD/°C]
COMPENSATED TEMP.	60 to 160°F [15 to 72°C]
OPERATING TEMP.	-40 to 200°F [-40 to 93°C]
WEIGHT	50 oz [1417 g]
MATERIAL (FLEXURE)	17-4PH S.S.
MATERIAL (COVER)	ALUMINUM
DEFLECTION	0.001 [0.03] nom.
CONNECTOR: BENDIX 6 Pin Receptacle (PT02A-10-6P)	
ACCESSORIES AND RELATED INSTRUMENTS AVAILABLE	
CALIBRATION (STD)	5 pt. COMPRESSION; 60.4K Ω SHUNT CAL. VALUE
CALIBRATION TEST EXCITATION	10 VDC

MCP01272 - REMOVABLE LOAD BUTTON

