

FUTEK MODEL LLW460
STK# FSH00765

Drawing Number: FI1087

INCH [mm] R.O.= Rated Output

WIRING CODE (WC1)			
+Excitation	-Excitation	+Signal	-Signal
RED	BLACK	GREEN	WHITE
Shield			
FLOATING			

FORCE/LOAD WASHER LOAD CELL (Previously L2700)

+ OUTPUT
(COMPRESSION)

ID. #

FUTEK
LABEL

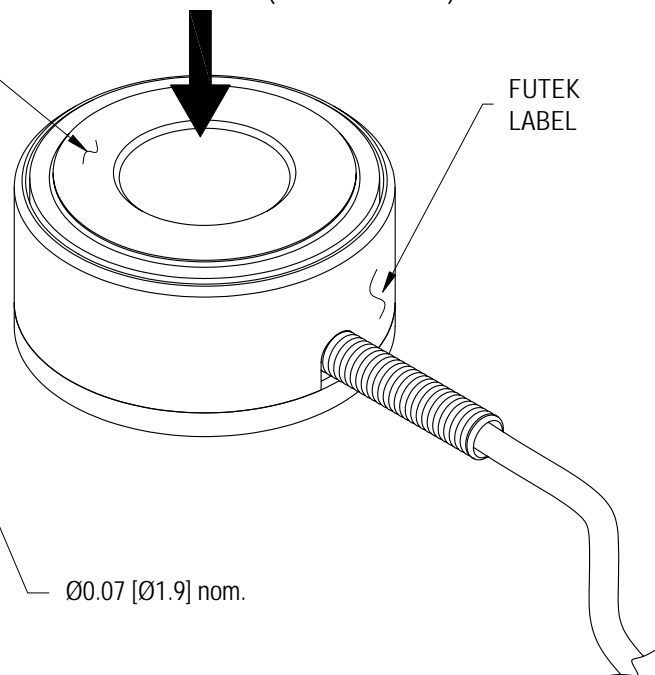
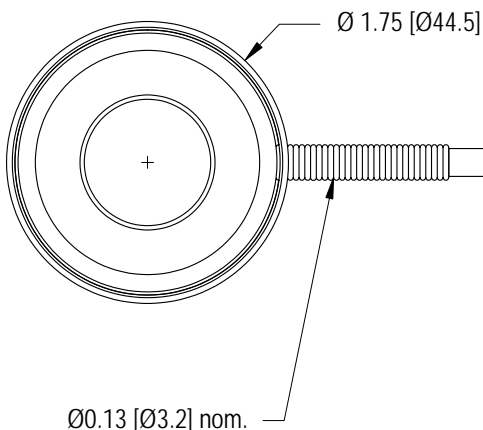

MOUNTING SURFACES SHOULD BE FLAT AND
PARALLEL FOR OPTIMUM PERFORMANCE

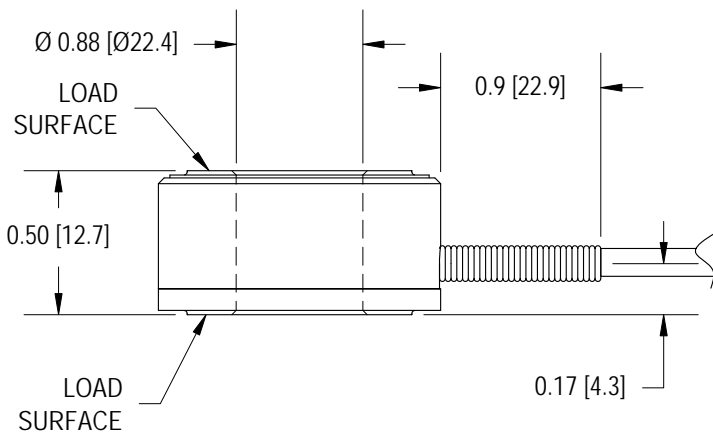

SPECIFICATIONS:

RATED OUTPUT	2 mV/V nom.
CAPACITY	60klb [267kN]
SAFE OVERLOAD	150% of R.O.
ZERO BALANCE	±10% of R.O.
EXCITATION (VDC OR VAC)	18 MAX
BRIDGE RESISTANCE	350 Ω nom.
TEMP. SHIFT ZERO	±0.02% of R.O./°F [0.036% of R.O./°C]
TEMP. SHIFT SPAN	±0.01% of LOAD/°F [0.018% of LOAD/°C]
COMPENSATED TEMP.	60 to 160°F [15 to 72°C]
OPERATING TEMP.	-45 to 200°F [-42 to 93°C]
MATERIAL	17-4PH S.S.
WEIGHT	3.5 oz [100 g]
DEFLECTION	0.001 [0.03] nom.
BOLT SIZE	7/8 in.
CABLE:#29 AWG, 4 Conductor, Spiral Shielded Teflon Cable 10 ft [3 m] Long	
ACCESORIES AND RELATED INSTRUMENTS AVAILABLE	
CALIBRATION (STD)	5 pt. COMPRESSION; 60.4 K Ω SHUNT CAL. VALUE
CALIBRATION TEST EXCITATION	10 VDC

HARDENED WASHER
STK# MCP00725

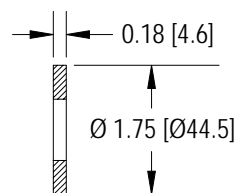

FUTEK
ADVANCED SENSOR TECHNOLOGY, INC.

This drawing is submitted solely for the information and exclusive use of the original addressee. It is not to be divulged in whole or in part, by any firm or individual without written permission from FUTEK

10 THOMAS
IRVINE, CA 92618 USA
1-800-23-FUTEK (38835)

INTERNET:
<http://www.futek.com>