

FUTEK MODEL LCM675 STOCK# FSH02674

HIGH CAPACITY THREADED ROD LOAD CELL

Drawing Number: FI1272

INCH [mm] | R.O.= Rated Output

WIRING CODE (CC1)

+Excitation	-Excitation	+Signal	-Signal
RED PIN 'A'	BLACK PIN 'B'	GREEN PIN 'C'	WHITE PIN 'D'
+Sense	-Sense		
ORANGE PIN 'E'	BLUE PIN 'F'		

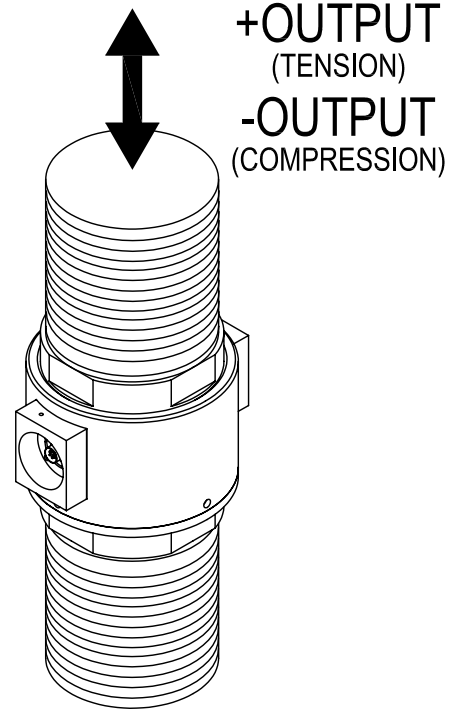
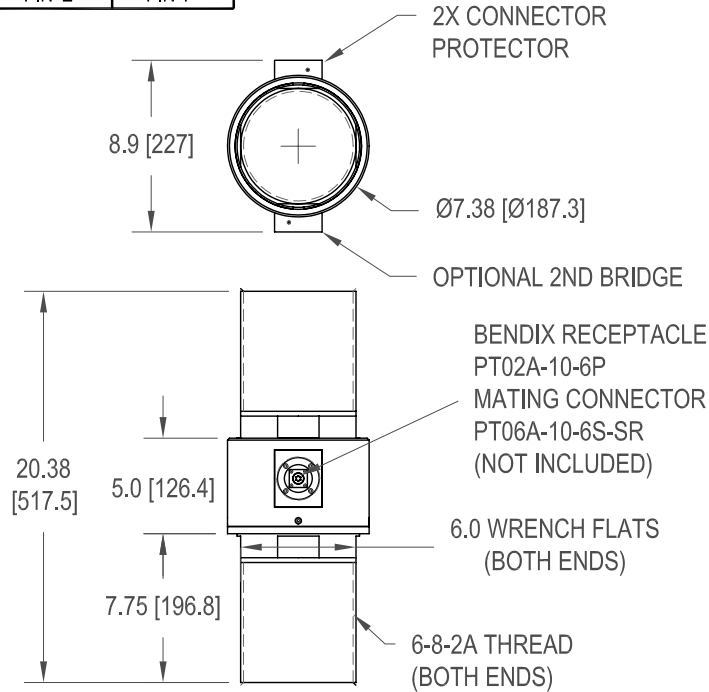

SPECIFICATIONS:

RATED OUTPUT	2 mV/V nom.
CAPACITY	700000 lb
SAFE OVERLOAD	150% of R.O.
ZERO BALANCE	±3% of R.O.
EXCITATION (VDC OR VAC)	20 MAX
BRIDGE RESISTANCE	350 Ω nom
NONLINEARITY	±0.25% of R.O.
NONREPEATABILITY	±0.1% of R.O.
TEMP. SHIFT ZERO	±0.02% of R.O./°F [0.04% of R.O./°C]
TEMP. SHIFT SPAN	±0.02% of LOAD/°F [0.04% of LOAD/°C]
COMPENSATED TEMP.	60 to 160°F [15 to 72°C]
OPERATING TEMP.	-60 to 200°F [-50 to 93°C]
WEIGHT (SENSOR)	165 lb
WEIGHT (CLEVIS PIN)	205 lb
MATERIAL (FLEXURE)	17-4PH S.S.
CONNECTOR: 6 Pin Bendix Receptacle PT02A-10-6P	
ACCESSORIES AND RELATED INSTRUMENTS AVAILABLE	
CALIBRATION (AVAILABLE)	5 pt TENSION and or COMPRESSION
CALIBRATION TEST EXCITATION	10 VDC
DUAL BRIDGE AVAILABLE	

OPTIONAL TONGUE SHACKLE FEMALE

STOCK# FSH02691

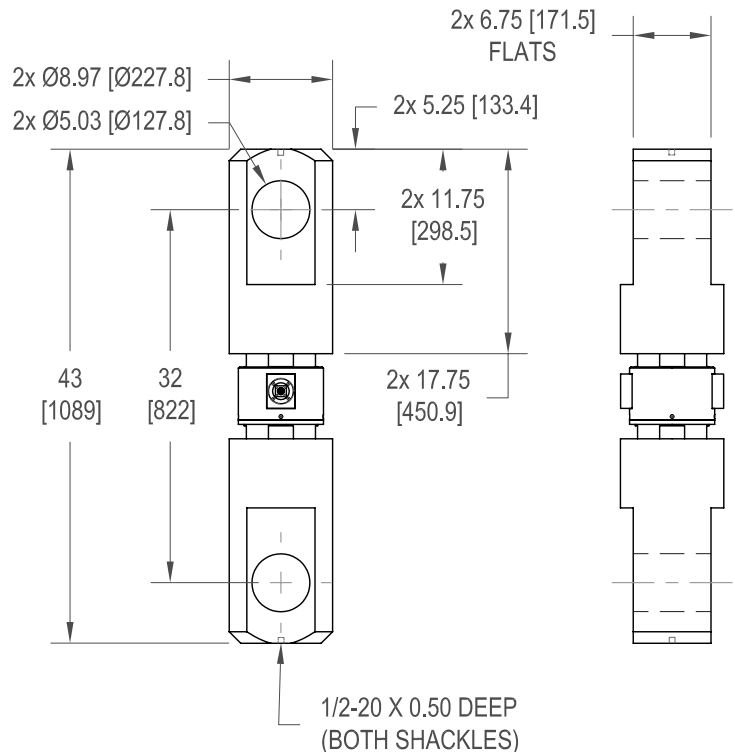

FUTEK
ADVANCED SENSOR TECHNOLOGY, INC.

This drawing is submitted solely for the information and exclusive use of the original addressee. It is not to be divulged in whole or in part, by any firm or individual without written permission from FUTEK

CAGE CODE # 1X8M6

10 THOMAS
IRVINE, CA 92618 USA
1-800-23-FUTEK (38835)

INTERNET:
<http://www.futek.com>