

A3+ INKJET PRINTER
Epson Stylus® Photo R3000

EPSON
EXCEED YOUR VISION

Limitless expression Unrivalled performance

**MICRO
PIEZO™**

Epson MicroPiezo™ print head is built with extreme durability. Enjoy unrivalled color print quality and speed with Epson Stylus® Photo R3000 – the solution for economical and professional digital printing.

- **Achieve greater color vibrancy in every print**
Epson UltraChrome® K3 Ink with Vivid Magenta delivers client-specific spot colors in the deep blue-magenta range
- **Increase productivity with high capacity ink cartridges**
Less downtime changing ink cartridges means more uptime for creativity
- **Advanced and simple media handling with new precision front-feed mechanism**
Simplify loading process and reduce the printer's footprint with front-feeding paper tray for Fine Art media and rear paper feed support
- **Economic print solution with fast throughput saves you time and money**
Auto switching of Photo Black and Matte Black saves time and minimizes wastage of media and ink. With fast throughput, enjoy faster print speed without compromising on image quality

MICRO PIEZO™

Epson MicroPiezo™ print head is built with extreme durability. Enjoy unrivalled color print quality and speed with Epson Stylus® Photo R3000 – the solution for economical and professional digital printing.



Epson Stylus® Photo R3000

ACHIEVE GREATER COLOR VIBRANCY IN EVERY PRINT

Epson UltraChrome® K3 Ink with Vivid Magenta is made for professional desktop printers. Containing Vivid Magenta and Vivid Light Magenta, this high-density, 9-color pigment ink delivers the vibrant blues and violets that your creativity craves plus ultra-wide gamut and accurate color with virtually no color shifts.



INCREASE PRODUCTIVITY WITH HIGH CAPACITY INK CARTRIDGES



You can now devote more time to production and less time for maintenance with the high capacity ink cartridges – something that any busy professional will appreciate.

ADVANCED AND SIMPLE MEDIA HANDLING WITH NEW PRECISION FRONT-FEED MECHANISM

A new precision front-feed mechanism and redesigned paper path work to ease fine art paper handling. Fine art paper, which previously had to be fed from the rear by manually attaching a guide, can now be loaded from the front. This eliminates the need for rear feeding thus effectively reduces the printer's footprint.

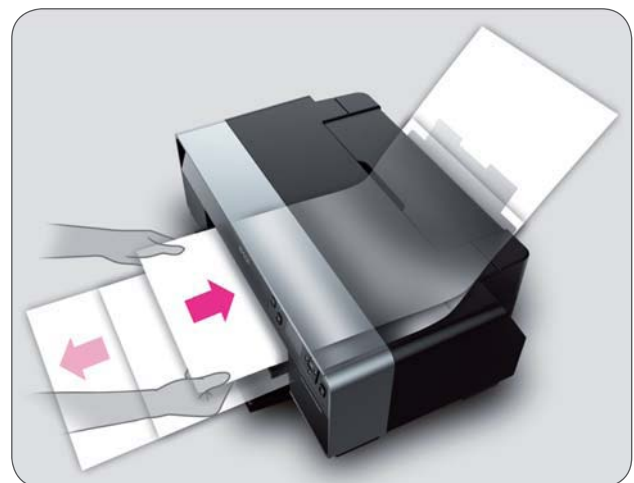

Fine art paper path

ECONOMIC PRINT SOLUTION WITH FAST THROUGHPUT SAVES YOU TIME AND MONEY

Both Photo Black and Matte Black ink cartridges are loaded simultaneously. You can switch between the two black inks via the printer driver to match the media in use. Photo Black produces prints with minimal gray for rich and highly detailed prints while Matte Black significantly increases ink density when printing on more absorbent matte surfaces.

Photo Black ink



Recommended media
Photo media

Matte Black ink



Recommended media
Fine art, matte or plain paper



ULTRA-SMALL INK DROPLETS FOR A SMOOTHER LOOK

Epson's breakthrough Variable-Sized Droplet technology produces ink droplets of only 2 picoliters* – the smallest ever in an Epson UltraChrome® K3 Ink printer. Positioned on media with incredible precision, the tiny droplets dramatically reduce graininess to achieve clearer skies, velvety clouds and unblemished skin tones.

* When printing at 5760 x 1440 dpi

MICROPIEZO® PRINT HEAD

Equipped with a MicroPiezo® Print Head, this new printer produces crisp, precise dots that exhibit minimal misting and satellites. Optimized for Epson UltraChrome® K3 Ink with Vivid Magenta and employing Epson Variable-Sized Droplet technology, this state-of-the-art print head generates drops as small as 2 picoliters* and delivers noticeably faster print times. Moreover, an ink-repellent coating decreases maintenance while increasing reliability.



* When printing at 5760 x 1440 dpi

WIFI/ETHERNET-ACCESSIBILITY



With WIFI/Ethernet function, the Epson Stylus® Photo R3000 can be shared within workgroups, making it ideal for any photo studio, graphics house or SOHO. Support for USB 2.0 further expands connectivity options while WIFI access extends to new generation PEDs like iPad and iPhone.

SUPERLATIVE MONOCHROME PRINTS

Experience Epson's three-level black ink technology and discover a new level of beauty. Rich blacks blend with subtle shades of gray for stunning tonal gradation that faithfully reproduces what the eye sees, or what your mind imagines. With a high D-max, the deeper blacks realize a realm of expression you never thought possible in a desktop printer.



2.5" COLOR LCD MONITOR

Check printer status at a glance on the bright, roomy color LCD monitor. The large size increases readability of messages, ink levels and menu settings. In addition, the new monitor displays on-screen instructions that show you how to feed special media such as fine art paper or board paper – and perform other operations.



Eco Features

- Uses approx. 13% less total power than the previous model, even with the addition of WIFI and Ethernet functions, realising improved energy saving performance and usability. ^{*1}
- Equipped with new power management function, "Automatic off mode". ^{*2}
- Uses fewer cartridges and saves resources with high-capacity ink cartridges.
- ENERGY STAR® qualified.
- EU RoHS compliant. ^{*3}
- Saves up to 50% of paper supply with manual, two-sided printing. ^{*4}
- Saves even more by printing multiple pages on a single sheet.

^{*1} Power consumption compared to Epson Stylus® Photo R2880. The value is based on evaluation conditions used at Epson. This was calculated as 5 sheets of A4 color documents printed/day, with 1 day defined as 8 hours with the power on and 16 hours with the power off. (Calculation condition does NOT consider "Automatic off mode") Power consumption will vary according to the customer's printer usage conditions.

^{*2} "Auto off mode" conforms to the power management requirement (EC/1275/2008) of the European ErP directive that will come into effect from 2013.

^{*3} This product restricts the use of cadmium, mercury, lead, hexavalent chromium, polybrominated Biphenyls (PBB), and Polybrominated Diphenyl Ethers (PBDE).

^{*4} Two-sided printing may not be supported by Mac®

Better Products for a Better Future™

For more information on Epson's environmental programmes, visit www.epson.com/environment

PARTNERS IN PERFECTION

Epson Specialty Media

All Epson genuine media is designed to complement Epson genuine inks and printers to produce prints of exceptional quality.

Media

Premium Luster Photo Paper 260
Premium Glossy Photo Paper 250
Premium SemiGloss Photo Paper 250
Premium Glossy Photo paper 170
Premium SemiGloss Photo Paper 170
Premium Glossy Photo Paper

Cut Sheet/Roll

16" / 24" / 44" / 60"
16" / 24" / 36" / 44" / 60"
16" / 24" / 36" / 44" / 60"
16.5" / 24" / 35" / 44"
16.5" / 24" / 35" / 44"
A3+ / A2

Epson Ink Cartridges



Epson inks are designed to work specifically with your Epson printer to deliver quality, vibrant and long-lasting prints.

Epson Stylus® Photo R3000

SPECIFICATIONS

Epson Stylus® Photo R3000



Weight 15.0 kg (33.0 lb)

* 1440 x 1440dpi on Photo Paper
with border

INK CARTRIDGES

PHOTO BLACK	C13T157190
CYAN	C13T157290
VIVID MAGENTA	C13T157390
YELLOW	C13T157490
LIGHT CYAN	C13T157590
VIVID LIGHT MAGENTA	C13T157690
LIGHT BLACK	C13T157790
MATTE BLACK	C13T157890
LIGHT LIGHT BLACK	C13T157990

EPSON is the registered trademark of Seiko
Epson Corporation.All other product names and other company
names used herein are for identification
purposes only and are the trademarks or
registered trademarks of their respective
owners.EPSON disclaims any and all rights in those
marks. Scan/Print samples shown herein
are simulations. The actual product design
and contents may vary. Specifications are
subject to change without notice.

PRODUCT CODE	C11CA86411
PRINTING TECHNOLOGY	Epson MicroPiezo™ Printhead
PRINT QUALITY MAXIMUM PRINT RESOLUTION MINIMUM DOT SIZE	5760 x 1440 dpi 2.0 pl
PRINT SPEED* A4 PHOTO A3+ PHOTO	Approx. 117 sec Approx. 195 sec
INK TECHNOLOGY NOZZLE CONFIGURATION	Epson UltraChrome® K3 Ink with Vivid Magenta Cyan, Vivid Magenta, Yellow, Photo Black, Light Cyan, Vivid Light Magenta, Light Black, Light Light Black, Matte Black
PAPER HANDLING PAPER FEED METHOD	Automatic Sheet Feeder Front Fine Art Paper Path Roll Paper Front Thick Paper Path CD/DVD
PRINTING AREA PAPER SIZE	Cut sheet: 89mm (3.5") - 329mm (13") Roll paper: 329mm (13") only (2" core)
THICKNESS (ASF) THICKNESS (FRONT FINE ART PAPER PATH) THICKNESS (FRONT THICK PAPER PATH)	0.08 - 0.3 mm 0.3 - 0.7 mm 0.7 - 1.3 mm
CONTROL PANEL	2.5" Colour LCD
INTERFACES USB WIRELESS ETHERNET	High-speed USB 2.0, PictBridge WIFI (IEEE 802.11 b/g/n) 10BASE-T/100BASE-TX
SUPPORTED OS	Windows XP / Vista / 7 (32/64bit) Mac OS X 10.4.11 or later
UTILITY SOFTWARE	Epson Easy Photo Print Epson Print CD EpsonNet Setup
ENVIRONMENTAL CHARACTERISTICS TEMPERATURE HUMIDITY	10 - 35°C (operating) -20 - 40°C (storage) 20 - 80% No condensation (operating) 5 - 85% No condensation (storage)
DIMENSION AND WEIGHT DIMENSION (W X D X H) STORAGE PRINTING WEIGHT	616 x 369 x 228 mm 24.25" x 14.53" x 8.98" 616 x 814 x 424 mm 24.25" x 32.05" x 16.69" Approx. 15.0 kg / 33.0 lb (main unit only)
ELECTRICAL SPECIFICATION VOLTAGE POWER CONSUMPTION PRINTING SLEEP MODE	AC 100 - 240V 50/60Hz Approx. 21W Approx. 3.7W (220 - 240V)
ACOUSTIC NOISE LEVEL SOUND PRESSURE LEVEL (LpAm) SOUND POWER LEVEL (LwAd)	38dB(A) 4.6B(A)

EPSON PHILIPPINES CORPORATION

8th Floor Anson's Centre
23 ADB Avenue, Ortigas Center
Pasig City 1605, Philippines
TEL: (+632) 706-2609
FAX: (+632) 706-2665

EPSON Customer Care

Toll Free: (PLDT) 1800-1069-37766
(Digitel) 1800-3-0037766Metro Manila: (02) 441-9030
(02) 706-2609 (press 2)Website: <http://customer-care.epson.com.ph>
Email: customer-care@epc.epson.com.ph

Dealer's Stamp

Customer Care
1-800-1069-37766www.epson.com.ph