

Bill Validator

N6 Series Installation Guide

- 4 - Way Acceptance
- Low Maintenance
- Easy Installation
- Re - Programmable
Flash ROM
- Auto Self -Adjusting
Sensor System

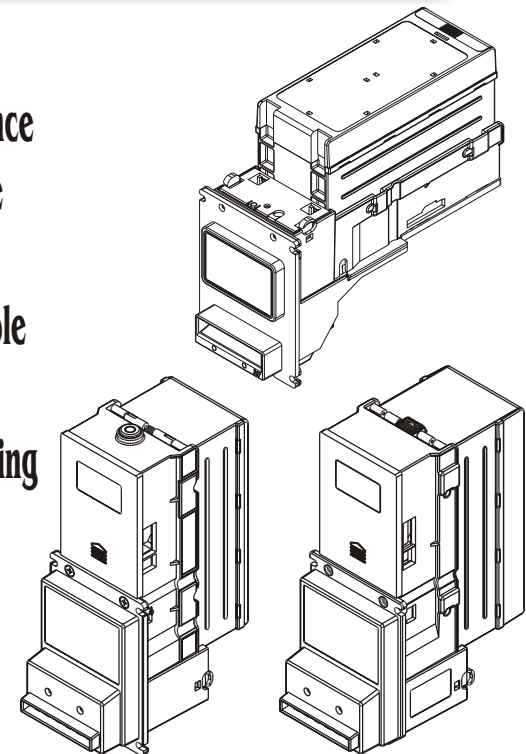

Contents

(1) N6 Bill Validator Specifications	2
(2) Bill Validator Dimensions	2
(3) LED Display	4
(4) LED Status	4
(5) Download and upgrade	4
(6) N6 Pin-out Assignments (N.I.S.R for 117V AC)	5
N.I.S.R CONNECTOR	6
N.I.S.R PIN LOCATIONS	6
(7) Cable	7
Switch Settings	<i>(Appendix)</i>

(1) N6 Bill Validator Specifications

Acceptance Rate

96% or greater

Bill insertion

4-way Acceptance

Acceptance Speed

Approx. 3 seconds
(including bill stacking)

Interfaces

N.I.S.R

Bill box Capacity

Approx. 300 bills (200~300) 3M-SBX03005
500 bills (300~500) 3M-SBX04005
800 bills (750~850) 3M-SBX08005

Weight

Approx. 2kg (shipping)

Power Sources

117V AC 0.2Amp (60HZ)

Power Consumption

Max 50 watts

Environment Range

Operating Temperature 0°C~55°C

Storage Temperature -30°C~70°C

Humidity : 30%~85% RH (no condensation)

(2) Bill Validator Dimensions

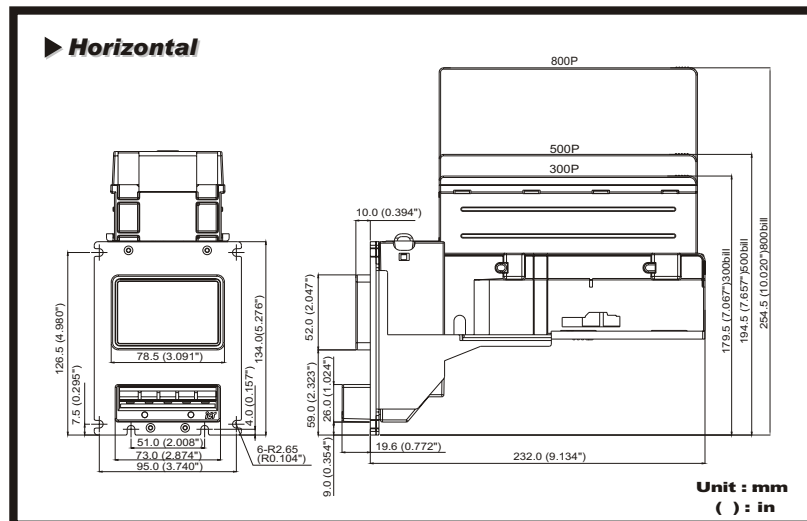

► Vertical (Sliding Block)

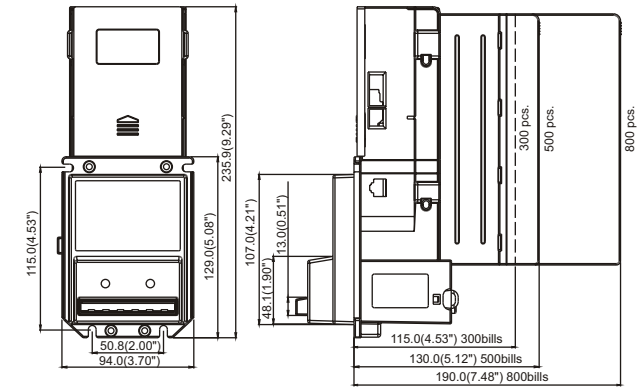

Unit : mm
() : in

(Push Button)

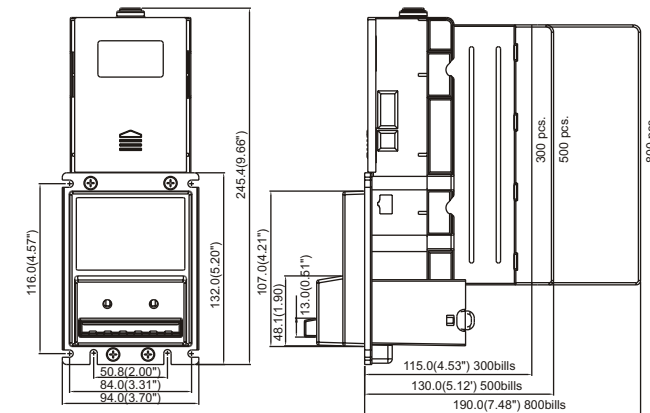

Unit : mm
() : in

(3) LED Display

The two LED lights located at the front of the unit will show the operational status of the bill validator. The LED lights will flash ON and OFF (in 500ms intervals) when the unit is ready to accept bills. The LED lights will be OFF if the unit is disabled or out of service, in which case the unit will not accept any bills.

The bill validator can only accept one bill at a time. The LED lights will be OFF and will not accept another bill while a bill is being validated in the unit. The LED lights will start to flash normally when the bill validator is ready to accept the next bill.

(4) LED Status

FLASHES	STATUS
1	bill jammed
2	disabled from system
3	sensor problem
4	reserved
5	bill box is removed
6	bill box is full of money
LED ON	POWER ON
LED OFF	POWER OFF

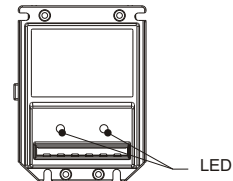

Option Switches

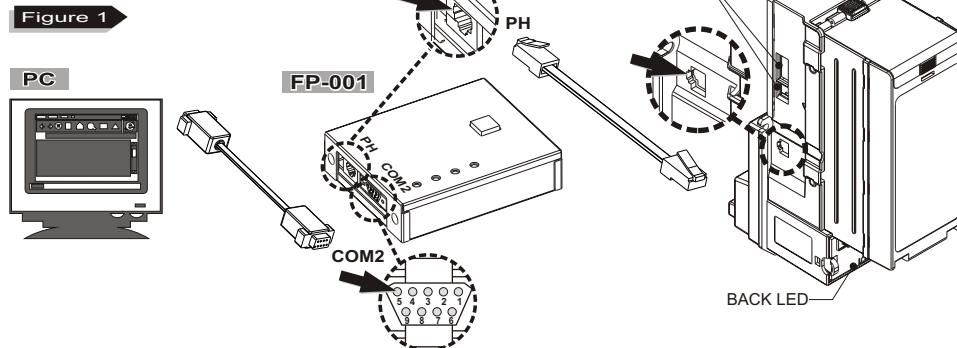

(5) Download and Upgrade

In addition to the 30-pin connector, there is also an 8-pin RJ-45 connector on the side of the bill validator designed for the purpose of downloading programs and updating validation software. The connector will be kept open under normal operation of the bill validator. It will only be used when a new software or program need to be downloaded into the flash ROM. (Figure 1)

(6) N6 Pin-out Assignments (N.I.S.R for 117V AC)

For the 117V AC version of the N6 bill validator with NISR interface, the harness (*part no. WEL-013*, see page.7 for pin-out information) has a dual-in-line 30-pin peripheral connector that connects to the side of the B.A , a 9-pin mating connector for connecting to the 117V AC power harness , and a 18-pin interface connector see next page for pin-out information to connect to the controller.

◆ 9-pin mating connector pin-out assignments:

Pin 1	Reserved	Pin 6	117VAC NEUTRAL(Power)
Pin 2	Reserved	Pin 7	Reserved
Pin 3	Reserved	Pin 8	Reserved
Pin 4	117VAC HOT (Power)	Pin 9	Reserved
Pin 5	Reserved		

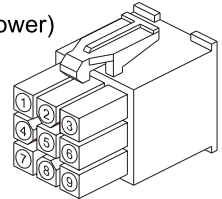

◆ Dual-in-line 30-pin peripheral connector (N6, 117V AC) pin-out assignments:

1	2	3	4	5	6	7	8	9	10	11	12	13	14	15
16	17	18	19	20	21	22	23	24	25	26	27	28	29	30

Pin 1 - Reserved	Pin 16 - Reserved
Pin 2 - DEBUG DATA OUTPUT	Pin 17 - Reserved
Pin 3 - Reserved	Pin 18 - Reserved
Pin 4 - 117V AC NEUTRAL (Power)	Pin 19 - Reserved
Pin 5 - Reserved	Pin 20 - 117V AC HOT (Power)
Pin 6 - Reserved	Pin 21 - EARTH GROUND
Pin 7 - Reserved	Pin 22 - /OUT_OF_SERVICE
Pin 8 - /INTERRUPT	Pin 23 - Reserved
Pin 9 - Reserved	Pin 24 - /ACCEPT_ENABLE
Pin 10 - GND	Pin 25 - Reserved
Pin 11 - /DATA	Pin 26 - /SEND
Pin 12 - Reserved	Pin 27 - Reserved
Pin 13 - Reserved	Pin 28 - Reserved
Pin 14 - Reserved	Pin 29 - Reserved
Pin 15 - Reserved	Pin 30 - Reserved

◆ **CAUTION:** Turn off the power before connecting or disconnecting the bill validator.

N.I.S.R CONNECTOR

INTERFACE CONNECTOR :

◆ 18-pin mating connector pin-out assignments:

Pin 1	Reserved	Pin 10	/OUT-OF-SERVICE
Pin 2	INTERRUPT	Pin 11	/DEBUG DATA
Pin 3	Reserved	Pin 12	/ACCEPT ENABLE
Pin 4	GROUND	Pin 13	Reserved
Pin 5	/DATA	Pin 14	/SEND
Pin 6	Reserved	Pin 15	Reserved
Pin 7	Reserved	Pin 16	Reserved
Pin 8	Reserved	Pin 17	Reserved
Pin 9	Reserved	Pin 18	Reserved

N.I.S.R PIN LOCATIONS

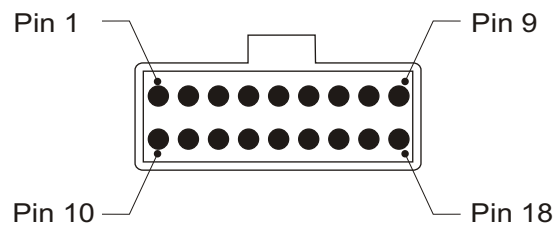

(7) Cable

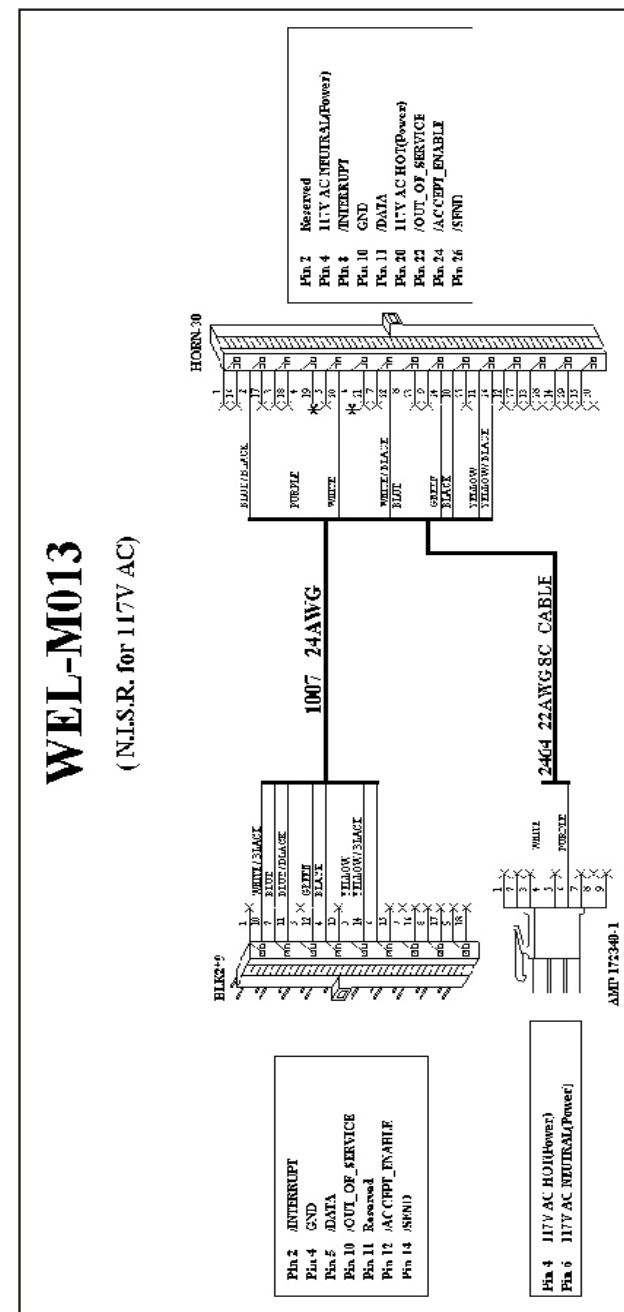

WEL-M023

(N.I.S.R. for Pa_Lo_GOLD)

