



ELECTRIC ACOUSTIC GUITAR

Owner's Manual

Thank you for choosing a Yamaha electric-acoustic guitar.
In order to make the most of the advanced features and performance provided by your guitar, please read this manual carefully before using the instrument.

PRECAUTIONS

- The output jack is an EIAJ-standard 1/4" phone jack. Be sure to use an appropriate connection cable.
- Always set the VOLUME control to "0" when plugging in or unplugging the connection cable.
- The battery check indicator (BATT.) will light briefly when a plug is inserted or removed from the output jack. This is normal and does not indicate a malfunction.
- The built-in preamplifier is automatically turned on when a plug is inserted into the output jack. When not using the instrument, or when playing it without amplification, be sure to remove the plug from the output jack so that the preamplifier power is turned off. Also, even when the power is switched off, the system consumes a small amount of power for the tuner standby mode. If the instrument is not going to be used for an extended period of time, we recommend that the battery be removed in order to avoid power consumption or leakage.

NOMENCLATURE

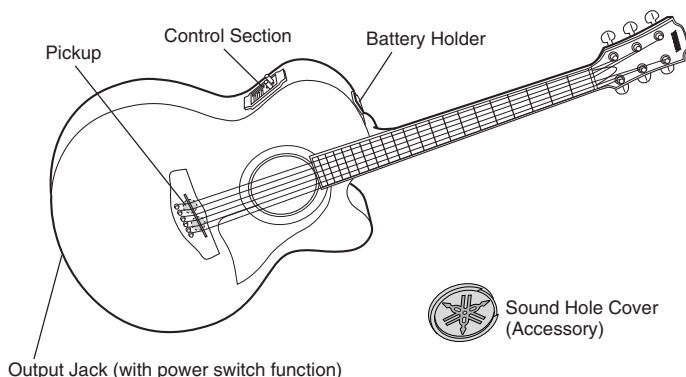

THE CONTROLS

1 VOL. (Volume) Control

Adjusts the overall output volume level.

* Make sure that the VOL. is turned to "0" before connecting or disconnecting.

2 BATT. (Battery Check) Indicator

This indicator will light when the battery needs to be replaced.

Please replace the battery as soon as possible when the BATT. indicator lights.

3 3 Band Equalizer

LOW : Boosts or cuts the level of the low frequencies.

MID : Boosts or cuts the level of the middle frequencies.

The AMF control 4 adjusts the center frequency of the band affected by this control.

HIGH : Boosts or cuts the level of the high frequencies.

4 AMF Control

Sets the center frequency of the band of frequencies affected by the MID equalizer control. The range is from 80 Hz to 10 kHz.

* This control has no effect when the MID equalizer control is set to its center ("0") position.

5 Tuner Switch

Switches the tuner ON/OFF.

6 Tuner Display

Displays tuner information.

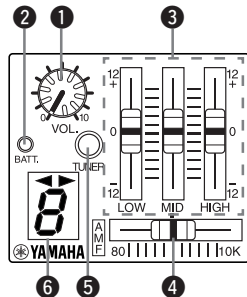

SPECIFICATIONS

System

Pickup

Pre-amplifier Controls

Output jack

Output impedance

Power supply

Battery life

SYSTEM-56: Monaural 1 way

Contact Pickup (installed inside of the body)

VOL., 3 Band (HIGH, MID, LOW) EQ control, AMF control

Combination end pin/power switch
1 k Ω

9V DC, S-006P (6F22) dry cell battery

Approx. 90 hours (without tuner)

Approx. 85 hours (with the preamp switched ON and the tuner used 1 minute every 1 hour)

* When using a manganese battery.

* Varies according to operating conditions.

Tuner

Tuning System: Chromatic type (12 semitones), A4=440Hz

Auto OFF Function: Tuner automatically switches OFF after 2 minutes.

Input: Built in pickup

Accuracy: +/- 3 cents

Accessories

- Hexagonal wrench for neck adjustment x1
- S-006P (6F22) dry cell battery x1
- Sound hole cover x1

BATTERY REPLACEMENT

Be sure to replace the battery as soon as possible when the battery check indicator lights in order to avoid reduced sound quality.

* Be sure to remove the battery if the instrument will not be used for an extended period of time in order to prevent possible damage due to battery leakage.

- 1 Press the catch on the battery holder in the direction indicated by the arrow in the illustration in order to unlock it.
- 2 Slide out the battery case.
- 3 Remove the old battery from the battery case, and insert the new battery making sure that the (+) and (-) terminals of the battery are positioned as shown in the illustration. Use only a DC9V, S-006P (6F22) or equivalent battery.
- 4 Slide the battery case back into the battery holder and press firmly so that the battery case locks into place.

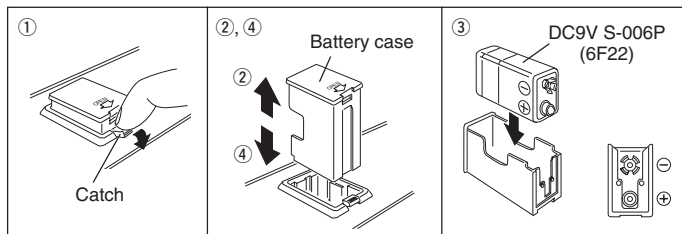

USING THE SOUND HOLE COVER

Feedback often occurs when controls are boosted on the electric acoustic guitar to match the volume of other instruments when playing in a band.

When the instrument is used under the conditions described above, the Sound Hole Cover should be inserted into the sound hole.

With the Sound Hole Cover in place, feedback is effectively reduced.

USING THE TUNER

The guitar is equipped with an A4=440Hz standard pitch tuner. The tuner's circuitry is independent from the guitar's output circuit so switching the tuner ON/OFF will have no affect on sound output.

- 1 Press the TUNER switch. While the tuner activates the ◀ and ▶ lamps light alternately.
- 2 Tune the guitar string until the note name of the desired pitch appears in the tuner's display.
The ▶ lamp indicates the pitch is low.
The ◀ lamp indicates the pitch is high.
The pitch indicator (◀ ▶) flashes slower as the string's pitch nears the note shown in the display.
- 3 The string is in tune when the ◀ and ▶ lamps both light.

* The tuner will automatically switch OFF approximately two minutes after the TUNER switch is pressed (energy saving function). To continue tuning, press the TUNER switch again.

* It may take a few seconds before the tuner can detect pitches after being switched ON.

* The note name and ◀ ▶ displays may have difficulty keeping up with irregular pitch changes. Gradually change the pitch and check when tuning.

* The tuner may have difficulty detecting notes rich with overtones or with very short sustain.