

What's in the box?

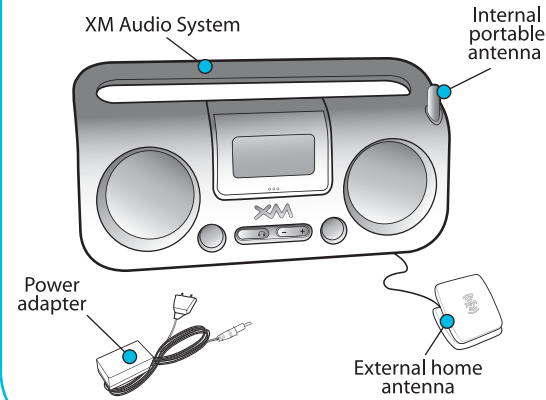

Let's get started

Grab either your Delphi Rody XT® or your Audiovox Xpress™, or any other XM Audio System compatible product

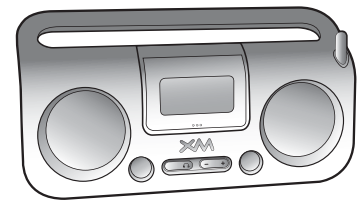
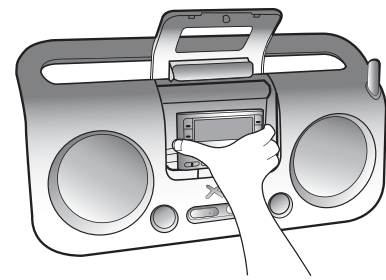
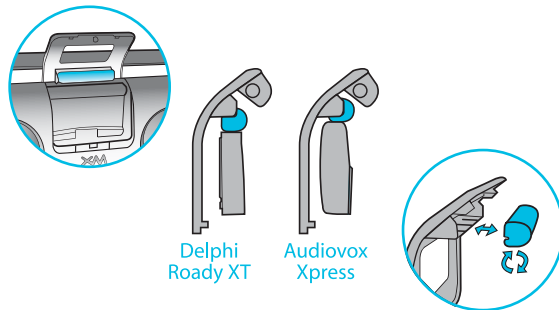
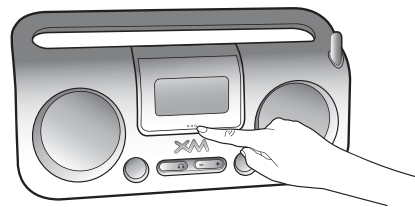
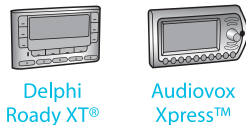

Home setup

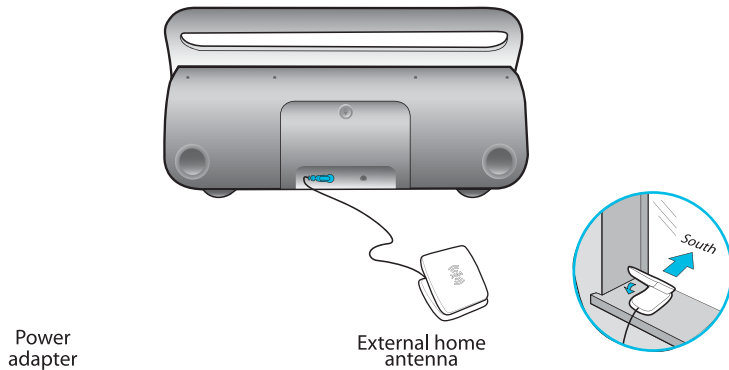
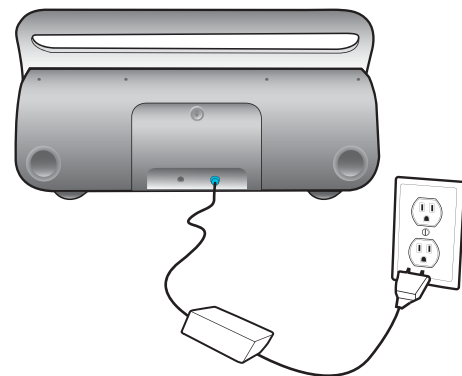

Portable setup

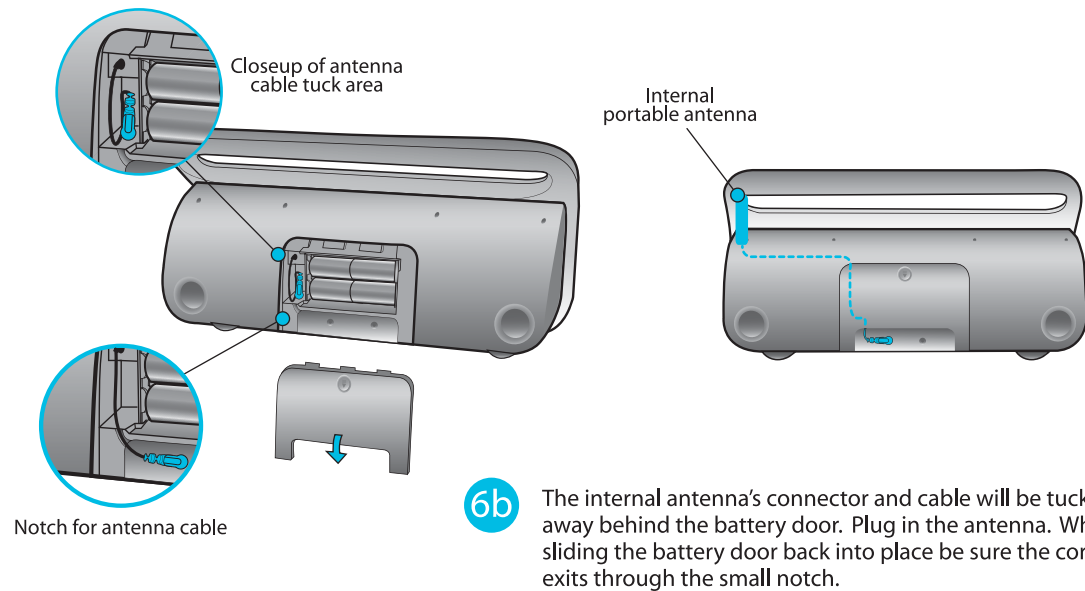
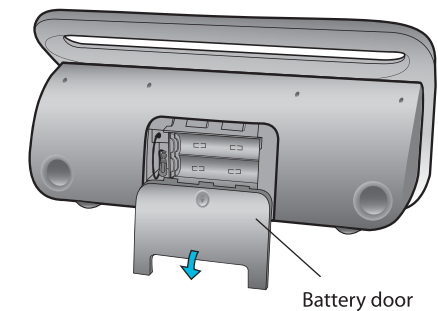

Things to know

Headphone use and volume controls

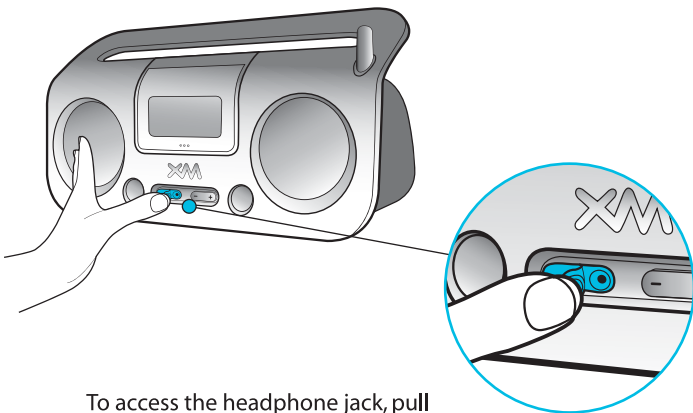
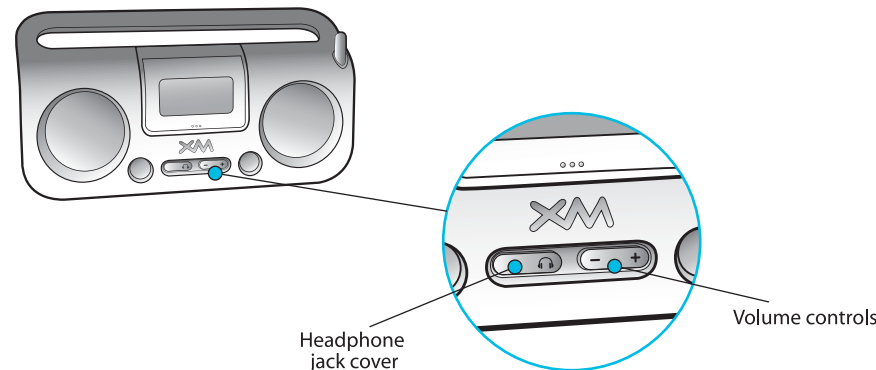

XM AUDIO SYSTEM

About XM Satellite Radio

XM Satellite Radio is the nation’s leading provider of satellite radio with more than 4 million subscribers. XM offers more than 150 digital radio channels: 67 commercial-free music channels, ranging from hip hop to opera, rock to bluegrass, big band to reggae; 64 talk radio channels, including news, sports, comedy, and children’s programming; and 21 channels of round-the-clock traffic and weather reports. Subscribers pay \$12.95 a month for the XM service, which was named Best Radio Service by the music industry’s leading magazine Billboard at the 2004 Digital Entertainment Awards. Exclusive programming on XM includes Major League Baseball® games for every team, all season long. You can listen to XM on a variety of satellite radio receivers for the vehicle, home, and portable use. In-dash XM radios are available in more than 120 vehicle models for the 2005 model year. XM is broadcast via satellite from coast to coast, so you can listen to XM continuously as you travel across the country.

Things to know

Bass and Treble

Delphi Roady XT and Audiovox Xpress

Adjust bass and treble by pressing the “menu” button, selecting “Bass + Treble,” and then setting them in the same manner as other menu functions.

This feature only appears when the RoadyXT or Audiovox XPress receiver is seated in the Audio System. If you use the receiver in a vehicle adapter or home adapter, bass and treble are automatically set to “flat.” When you return the receiver to the Audio System, bass and treble are restored to their previous settings.

Display Lighting

Delphi Roady XT

The Roady XT gives you the option of specifying how long the display and button backlight remains lit. Press the “menu” button, next select “Display Light.” You may choose from “Always On,” “10 sec,” “20 sec,” or “30 sec.”

Anytime you use your remote or press a button on your Roady XT the display and button backlight comes on for the designated time and then turns off.

Audiovox XPress

The Xpress gives you the option to turn “OFF” the display and button backlight . Press the “menu” button, then select “Brightness + Contrast.” Choose “Brightness” , turn it down as low as it can go until the backlight turns off.

Turning off the display backlight helps conserve battery power.

Precautions and Care

Power sources

- For AC operation, it is recommended that only the supplied AC power adapter is used. If you need to use another one, make sure it is a 12V, 1500mA DC adapter.
- The satellite radio receiver unit remains connected to AC power as long as the Audio Receiver is connected to the wall outlet, even if the satellite radio unit (Roady XT or Audiovox Xpress) itself has been turned off.
- Unplug the AC power adapter from the wall outlet when it is not being used for an extended period of time.
- For battery operation, use eight C size batteries.
- When the not using batteries, remove them to avoid possible damage that can be caused by battery leakage or corrosion.
- A printed icon indicating operating voltage is located next to the power jack on the rear cover.

Placement

- Do not leave the XM Audio System in a location near heat sources, or in a place subject to direct sunlight, excessive dust or mechanical shock.
- Do not place the XM Audio System on an inclined or unstable surface.
- The audio/ventilation ports must be unobstructed for the XM Audio System to operate properly and prolong the life of its components.
- If the XM Audio System is left in a car parked in the sun, shade the unit from the direct rays of the sunlight.
- The speakers contain powerful magnets. Keep credit cards and mechanical watches away from the Audio System.

Water and Dirt

- This product is designed to be water resistant, but should not be immersed in water or come in continuous contact with water.
- Before opening or shutting the receiver docking station or battery compartment panel, be sure to wipe off water, dust or sand on the outside of the unit.
- The supplied AC power adaptor is not water resistant. To prevent electrical shock, avoid using the XM Audio System near water during AC operation.
- Water in the headphone jack may cause rusting and possible malfunction.

Maintenance

- Clean the cabinet, panel and controls with a soft cloth slightly moistened with a mild detergent solution. Do not use any type of abrasive pad, scouring powder, or solvent, such as alcohol or benzene.
- Note: Unplug the AC power adapter during the cleaning to avoid any electrical shock hazard.

Troubleshooting

If you see this on the display:	You should:
NO SIGNAL Cause: the XM signal is being blocked.	Move your XM Audio System to another location, either outdoors or near a south-facing window. You may connect the external antenna to improve reception.
ANTENNA Cause: possible problem with either the internal or external XM antenna.	Connect either the internal or external antenna depending on indoor or outdoor use. Make sure the cable and connectors are not damaged or kinked.
If this happens:	You should:
Your XM Audio System will not turn on.	Check whether the power cord is plugged into the wall. Ensure batteries are fresh and inserted correctly.
You do not receive all XM channels other than 0, 1, 247.	Your XM receiver may not be activated. Contact XM at www.xmradio.com or 1-800-XM-RADIO
There is no audio.	Remove the receiver from XM Audio System and re-insert, then turn the power on. Unplug any headphones. Check the volume control. Make sure “MUTE” is not set on the remote if used.
You hear noise or interference.	Move away from any cordless telephones or electrical appliances that may cause interference.

Warranty

LIMITED ONE (1) YEAR WARRANTY

What this warranty covers.

Belkin Corporation warrants to the original purchaser of any Belkin XM Audio System, that the XM Audio System shall be free of defects in design, assembly, material, or workmanship.

What the period of coverage is.

Belkin Corporation warrants the Belkin XM Audio System for one (1) year from the original date of purchase.

What will we do to correct problems?

XM Audio System Warranty.

Belkin will repair or replace, at its option, any defective XM Audio System free of charge (except for shipping charges) for the XM Audio System.

What is not covered by this warranty?

All above warranties are null and void if the Belkin XM Audio System is not provided to Belkin Corporation for inspection upon Belkin's request at the sole expense of the purchaser, Belkin Corporation determines that the Belkin XM Audio System has been improperly installed, altered in any way or tampered with. The Belkin XM Audio System Warranty does not protect against acts of God (including but not limited to flood, earthquake, war, and vandalism), theft, normal-use wear and tear, erosion, depletion, obsolescence, abuse, damage due to low voltage disturbances (i.e. brownouts or sags) or power surges, or alteration.

How to get service.

To get service for your Belkin XM Audio System you must take the following steps:

1. Contact Belkin Corporation at 501 W. Walnut St., Compton CA 90220, Attn: Customer Service, or call (800)-223-5546. Be prepared to provide the following information:
 - a. The part number of the Belkin XM Audio System.
 - b. Where you purchased the XM Audio System.
 - c. When you purchased the XM Audio System.
 - d. Copy of original receipt.
2. Your Belkin Customer Service Representative will then instruct you on how to forward your receipt and Belkin XM Audio System and how to proceed with your claim.

Belkin Corporation reserves the right to review the damaged Belkin XM Audio System. All costs of shipping the Belkin XM Audio System to Belkin Corporation for inspection shall be borne solely by the purchaser. If Belkin determines, in its sole discretion, that it is impractical to ship the damaged equipment to Belkin Corporation, Belkin may designate, in its sole discretion, an equipment repair facility to inspect and estimate the cost to repair such equipment. The cost, if any, of shipping the equipment to and from such repair facility and of such estimate shall be borne solely by the purchaser. Damaged products must remain available for inspection until the claim is finalized. Whenever claims are settled, Belkin Corporation reserves the right to be subrogated under any existing insurance policies the purchaser may have.

How state law relates to the warranty.
THIS WARRANTY CONTAINS THE SOLE WARRANTY OF BELKIN CORPORATION, THERE ARE NO OTHER WARRANTIES, EXPRESSED OR, EXCEPT AS REQUIRED BY LAW, IMPLIED, INCLUDING THE IMPLIED WARRANTY OR CONDITION OF QUALITY, MERCHANTABILITY OR FITNESS FOR A PARTICULAR PURPOSE, AND SUCH IMPLIED WARRANTIES, IF ANY, ARE LIMITED IN DURATION TO THE TERM OF THIS WARRANTY. Some states do not allow limitations on how long an implied warranty lasts, so the above limitations may not apply to you.

IN NO EVENT SHALL BELKIN CORPORATION BE LIABLE FOR INCIDENTAL, SPECIAL, DIRECT, INDIRECT, CONSEQUENTIAL OR MULTIPLE DAMAGES SUCH AS, BUT NOT LIMITED TO, LOST BUSINESS OR PROFITS ARISING OUT OF THE SALE OR USE OF ANY BELKIN [PRODUCT], EVEN IF ADVISED OF THE POSSIBILITY OF SUCH DAMAGES. This warranty gives you specific legal rights, and you may also have other rights, which may vary from state to state. Some states do not allow the exclusion or limitation of incidental, consequential, or other damages, so the above limitations may not apply to you.

This warranty is valid in the US and Canada.

Technical Information

Dimensions

XM Audio System: 450mm(W) X 235mm(H) X 141mm(D)
Adapter: 90mm(W) X 58mm(H) X 65mm(D)

Weight:

XM Audio System: 7LBS
Adapter: 0.91Kg

Inputs and Outputs

XM antenna input: 1SMB connector
Internal antenna output:
Headphone output: 3.5 mm diameter mini stereo jack

Power

DC: normal 12V (6-16V), positive polarity, (+ inner conductor), P5 jack
Battery: 8 C cell alkaline or rechargeable

Temperature

Operating: -25°C ~ 70°C
Storage: -40°C ~ 70°C

Audio

Power: minimum 4.5W RMS per channel at 10% THD at DC12V power supply (power output is reduced when the power supply is less than 12V.)
Frequency response: 80Hz ~ 20KHz @ -10dB

Suitable Receivers

Audiovox Xpress™
Delphi Roady XT®