



The High Fidelity Hearing Instrument
USER GUIDE



Bringing HD Color to Sound.

CONGRATULATIONS ON YOUR CHOICE OF THE SEBO HD HEARING SYSTEM!

Please read this manual carefully to benefit from all of its features. With proper care and usage your new SeboTek Hearing System will provide years of outstanding performance.

By choosing SeboTek, you have taken the single most important step to better hearing. But it is also important to recognize that your new hearing instruments are just the first step in the better hearing process. The next step requires that you remain committed to wearing your hearing instruments and carefully follow the counsel and guidance of your hearing care professional.

To assist in fine-tuning the instruments to your special needs, be sure you:

- Wear your instruments faithfully
- Document what you experience, and
- Communicate your experiences to your hearing care professional.

Again, all of us at SeboTek thank you for choosing the Sebo HD Hearing System—we're sure that you and the people close to you will be glad you did!

CONTENTS

Hearing System Components	3
Installing the Battery	5
Operating Your Hearing System	7
Caring For Your Hearing System	11
Troubleshooting	13
Important Notice for Prospective Hearing Instrument Wearers	15
Dispenser Information and Children With Hearing Loss	16
Service and Warranty	17
Hearing System Record	18

Additional product information is available at www.sebotek.com

SEBO HD HEARING SYSTEM COMPONENTS

SEBO HD SERIES DIGITAL SOUND PROCESSOR AND SPEAKER LINK



DIRECTIONS FOR easyCLICK™ tips

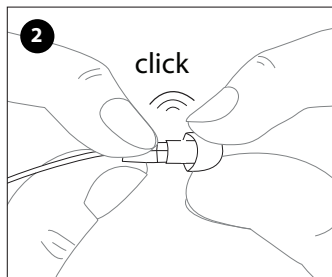
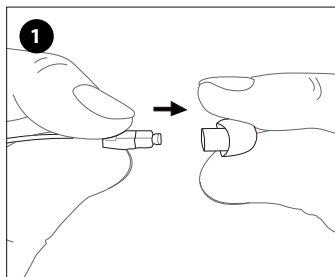
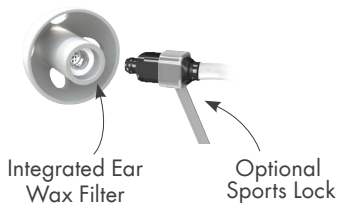

Replace easy-CLICK tip regularly as directed by your hearing care professional. *Ask your hearing care professional if your hearing instrument is equipped with easy-CLICK tips.*

INSTALLING THE BATTERY

- ❶ Open the Battery Compartment Door by gently swinging it into the open position.
- ❷ Remove the tab from a new #312 size battery.
- ❸ Place the new battery in the Battery Compartment Door with the positive (+) or flat side up as shown in Figure 3.
- ❹ Click the Battery Compartment Door closed as shown in Figure 4.



Fig. 3



Fig. 4

LOW BATTERY INDICATOR

When the Sebo HD instrument detects a low battery condition, you will hear three double beeps every five minutes. The pattern will continue until the battery is depleted.

BATTERY INFORMATION

Your Sebo HD Hearing Instrument uses one #312 battery. SeboTek recommends using zinc air batteries.

DO NOT place batteries in the refrigerator or in a dehumidifying device, as the batteries could leak and damage your hearing system.

A word of caution about batteries: **BATTERIES CAN BE HARMFUL IF SWALLOWED.** Be sure to keep batteries out of reach of small children, animals or persons of diminished mental capacity. In the event a battery is accidentally swallowed, seek prompt medical attention at the nearest emergency center, or call the National Button Battery Hotline at (202) 625-3333.

OPERATING YOUR HEARING SYSTEM

TURNING YOUR HEARING SYSTEM ON / OFF

Your Sebo HD Hearing System is automatically on whenever the Battery Compartment Door is closed. To turn your Sebo HD Hearing System off, simply open the Battery Compartment Door. Always leave the Battery Compartment Door open when not in use.

NOTE: Your SeboTek hearing instrument has a programmable power on delay setting which your hearing care professional can program for a three (3) to twelve (12) second delay when the instrument is turned on. This delay allows time for you to insert the device before it turns itself on.

CONTROL SWITCH

Your Sebo HD Hearing System may be programmed with different settings. As you change listening environments (for example: noise, quiet, traffic, telephone, outdoors, music) you can select the setting that allows you to hear most comfortably. Simply press the Control Switch located at the back of the processor (see Figure 5) until you hear a beep(s). The audible tone(s) or beep(s) will confirm the setting you have selected.

Settings are programmed by your hearing care professional for your individual needs, so it is important for you to understand how your hearing system is programmed.

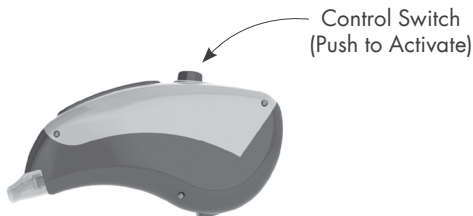

Fig. 5

INSERTING AND REMOVING YOUR HEARING SYSTEM

INSERTING YOUR SPEAKER LINK

Lubricating the Ultra Soft Tip (not needed for open style or custom earmold).

Lubrication of the ultra soft tip on the speaker link is recommended to ensure a good seal and to facilitate insertion into the ear. Lubricate the mushroom cap of the tip with a small drop of SeboTek Comfort Gel, as shown in Figure 6. Be careful not to allow any of the comfort gel to penetrate the speaker opening.

- Blue color indicates left ear.
- Red color indicates right ear.

Hold the speaker link near the speaker with your thumb and forefinger on a vertical plane (see Figure 7). Both the thumb and forefinger should be facing downward and gently insert the Ultra Soft tip into your ear canal.

Next, position the sound processor behind your ear as shown in Figure 8.

If your instrument is equipped with a Sports Lock, place into your ear as shown in Figure 9.

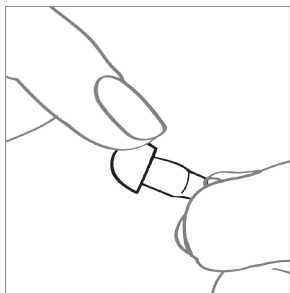

Fig. 6

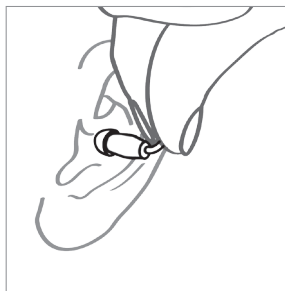

Fig. 7



Fig. 8

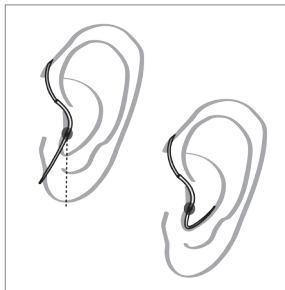

Fig. 9

CARING FOR YOUR HEARING SYSTEM

DAILY CLEANING & MAINTENANCE OF YOUR SEBO HD HEARING SYSTEM

Gently wipe down the Ultra Soft Tip, Speaker Link and Sound Processor of your Sebo HD Hearing System using an alcohol wipe (see Figure 10). Care should be taken NOT to use excessive alcohol, or a cotton ball saturated with alcohol, as this may cause damage to the Speaker or Sound Processor.

Also, visually inspect the Ultra Soft Tip to ensure that there are no tears, cuts or other damage. If you suspect any such damage, see your hearing care professional for immediate replacement of the Ultra Soft Tip, as a damaged tip could possibly come off in the ear. If a tip remains in the ear, do not be alarmed, but contact your hearing care professional or physician for immediate removal.

STORAGE

For Nightly Storage: Open the Battery Compartment Door, remove the battery and place your Sebo HD Hearing System in its protective

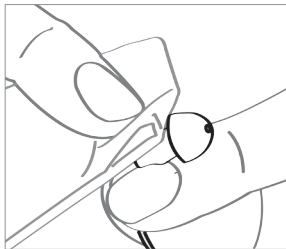

Fig. 10

case. For optimal performance, it is recommended that your Sebo HD Hearing System be kept in a dehumidifier. DO NOT place batteries in the dehumidifying device as the batteries could leak and damage your Hearing System.

For Extended Storage: Clean your Sebo HD Hearing System, remove the battery and store in a protective case in a cool, dry area to reduce the potential for damaging corrosion.

WARNING! Dropping, immersing in water or exposing your Sebo HD Hearing System to excessive heat can damage it and void the warranty.

CAUTION: HEARING-RELATED SAFETY APPLICATIONS

Although your hearing instrument is warranted, reflecting its design quality and reliability, fail-safe reliability is not implied. The hearing instrument should not be relied upon as a primary safety system in any application where injury or loss of life may result from failure of the hearing device to properly operate. No redundancy or back-up is available in either the power source or the individual and collective circuit functions of the instrument.

TROUBLESHOOTING:

NO SOUND

Possible Cause	Solution
Weak battery	Replace battery
Ear wax blockage	Replace easy-CLICK tip
Component problem	Consult your hearing care professional

NOT LOUD ENOUGH

Possible Cause	Solution
Ear wax blockage	Replace easy-CLICK tip
Programming too low	Consult your hearing care professional
Component problem	Consult your hearing care professional
Hearing loss progression	Consult your hearing care professional

INTERMITTENT (GOES OFF AND ON)

Possible Cause	Solution
Weak battery	Replace battery
Component problem	Consult your hearing care professional
Moisture	Allow aid to dry out (hearing instrument dehumidifier is recommended)

If problem persists, consult your hearing care professional.

NOT CLEAR, DISTORTED, STATIC

Possible Cause	Solution
Weak battery	Replace battery
Component problem	Consult your hearing care professional
Ear wax blockage	Replace easy-CLICK tip
<i>If problem persists, consult your hearing care professional.</i>	

TORN ULTRA SOFT TIP

Possible Cause	Solution
Finger nail or sharp objects	Consult your hearing care professional
Damage from improper insertion	Consult your hearing care professional

SORENESS (NOTE: *Mild soreness is not unusual for the first few days*)

Possible Cause	Solution
Improper placement	Adjust fit of tip to achieve comfort. Use lubricant when inserting your Sebo HD Hearing System
Improper fit of the Ultra Soft Tip	Consult your hearing care professional
Improper fit of the Speaker Link	Consult your hearing care professional

IMPORTANT NOTICE FOR PROSPECTIVE HEARING AID USERS

Good health practice requires that a person with a hearing loss have a medical evaluation by a licensed physician (preferably a physician who specializes in diseases of the ear) before purchasing a hearing aid. Licensed physicians who specialize in diseases of the ear are often referred to as otolaryngologists, otologists or otorhinolaryngologists. The purpose of medical evaluation is to assure that all medically treatable conditions that may affect hearing are identified and treated before the hearing aid is purchased.

Following the medical evaluation, the physician will give you a written statement that states that your hearing loss has been medically evaluated and that you may be considered a candidate for a hearing aid. The physician will refer you to an audiologist or a hearing aid dispenser, as appropriate, for a hearing aid evaluation.

The audiologist or hearing aid dispenser will conduct a hearing aid evaluation to assess your ability to hear with and without a hearing aid. The hearing aid evaluation will enable the audiologist or dispenser to select and fit a hearing aid to your individual needs.

If you have reservations about your ability to adapt to amplification, you should inquire about the availability of a trial-rental or purchase-option program. Many hearing aid dispensers now offer programs that permit you to wear a hearing aid for a period of time for a nominal fee after which you may decide if you want to purchase the hearing aid.

Federal law restricts the sale of hearing aids to those individuals who have obtained a medical evaluation from a licensed physician. Federal law permits a fully informed adult to sign a waiver statement declining the medical evaluation for religious or personal beliefs that preclude consultation with a physician. The exercise of such a waiver is not in your best health interest and its use is strongly discouraged.

If you elect to exercise your waiver option, you should know that hearing instruments cannot restore normal hearing, nor can they help everyone. Your success with amplification depends on your hearing loss and individual experiences. In most cases, infrequent use of a hearing instrument will not allow you to obtain full benefit from it. Furthermore, the use of a hearing instrument is only part of hearing rehabilitation and may need to be supplemented by auditory training and instruction in lip reading.

DISPENSER INFORMATION & CHILDREN WITH HEARING LOSS

Warning to Hearing Aid Dispensers

A hearing aid dispenser should advise a prospective hearing aid user to consult promptly with a licensed physician (preferably an ear specialist) before dispensing a hearing aid if the hearing aid dispenser determines through inquiry, actual observation, or review of any other available information concerning the prospective user, that the prospective user has any of the following conditions:

- (i) Visible congenital or traumatic deformity of the ear.
- (ii) History of active drainage from the ear within the previous 90 days.
- (iii) History of sudden or rapidly progressive hearing loss within the previous 90 days.
- (iv) Acute or chronic dizziness.
- (v) Unilateral hearing loss of sudden or recent onset within the previous 90 days.
- (vi) Audiometric air-bone gap equal to or greater than 15 decibels at 500 hertz (Hz), 1,000 Hz, and 2,000 Hz.
- (vii) Visible evidence of significant cerumen accumulation or a foreign body in the ear canal.
- (viii) Pain or discomfort in the ear.

Special care should be exercised in selecting and fitting a hearing aid whose maximum sound pressure level exceeds 132 decibels because there may be risk of impairing the remaining hearing of the hearing aid user. (This provision is required only for those hearing aids with a maximum sound pressure capability greater than 132 decibels (dB).)

Children with Hearing Loss

In addition to seeing a physician for a medical evaluation, a child with a hearing loss should be directed to an audiologist for evaluation and rehabilitation since hearing loss may cause problems in language development and the educational and social growth of a child. An audiologist is qualified by training and experience to assist in the evaluation and rehabilitation of a child with a hearing loss.

SERVICE AND WARRANTY

Your SeboTek sound processor and speaker link (collectively, "Hearing System") includes a limited warranty against defects in material and workmanship. Please ask your hearing care professional about the duration. All warranty claims must be submitted to SeboTek with the warranted merchandise within the warranty period. SeboTek shall repair or replace any defective merchandise covered by this warranty at SeboTek's sole expense during the Term of the manufacturer's warranty period. All warranties are void if the merchandise (or any part thereof) has been misused, abused, tampered with, or modified in any way, or if the serial number is altered, effaced or removed, or if any unauthorized repairs have been made to the merchandise. Additionally, this warranty will be void if the Speaker is used without the Clear-Sound™ Wax Guard or easy-CLICK tip.

The Ultra Soft Tips used with your Hearing System are considered maintenance or service items and are excluded from the manufacturer's limited warranty.

SeboTek shall not be liable for any special, indirect, incidental or consequential damages in connection with the use of the merchandise or for the breach of any of the obligations owed to the purchaser, or any customer of the purchaser, if any. In the event legal liability of SeboTek is established for any cause or reason whatsoever, including, without limitation for breach of warranty, the sole and exclusive liability of SeboTek and the exclusive remedy of purchaser or any customer of the purchaser shall be the recovery of an amount not exceeding the original price charged by SeboTek to the purchaser for the merchandise.

SEBOTEK MAKES NO WARRANTY, EITHER EXPRESSED OR IMPLIED, THAT THE MERCHANDISE IS MERCHANTABLE OR FIT OR SUITABLE FOR ANY PARTICULAR USE OR PURPOSE. SEBOTEK MAKES NO OTHER WARRANTY, EXPRESS OR IMPLIED, EXCEPT AS IS EXPRESSLY SET FORTH HEREIN, ALL SUCH OTHER WARRANTIES BEING HEREBY DISCLAIMED.

In the event your Hearing System needs repair, see your hearing care professional.

HEARING SYSTEM RECORD

	<u>LEFT</u>	<u>RIGHT</u>
Purchase Date
Warranty Term
Warranty Exp. Date
Sound Processor		
Model No.(s)
Sound Processor		
Serial No.(s)
Memory Settings	1.	1.
	2.	2.
	3.	3.
	4.	4.
Link Size
Link Serial No.(s)
Tip Size
Battery Size	#312	#312



2488 E. 81st St., Suite 2000, Tulsa, OK 74137, USA • www.SeboTek.com



EUROPEAN AUTHORIZED REPRESENTATIVE:

CEpartner4u, Esdoornlaan 13, 3951DB Maarssen, The Netherlands Tel.: +31(0)6 516 536 26



CE 0470

Patents US Design D501255, US Design D529612, US 5606621, US 7110562, US 7016512, US 7139404, US 7606382, AU 700444, BR PI9608669-6, CA 2224653, JP 3811731, EP 1537760, EP Design 000306733-0001 • Other Patents Pending.
© 2012 All Rights Reserved • BKT055-F400-A • Rev. 1204